

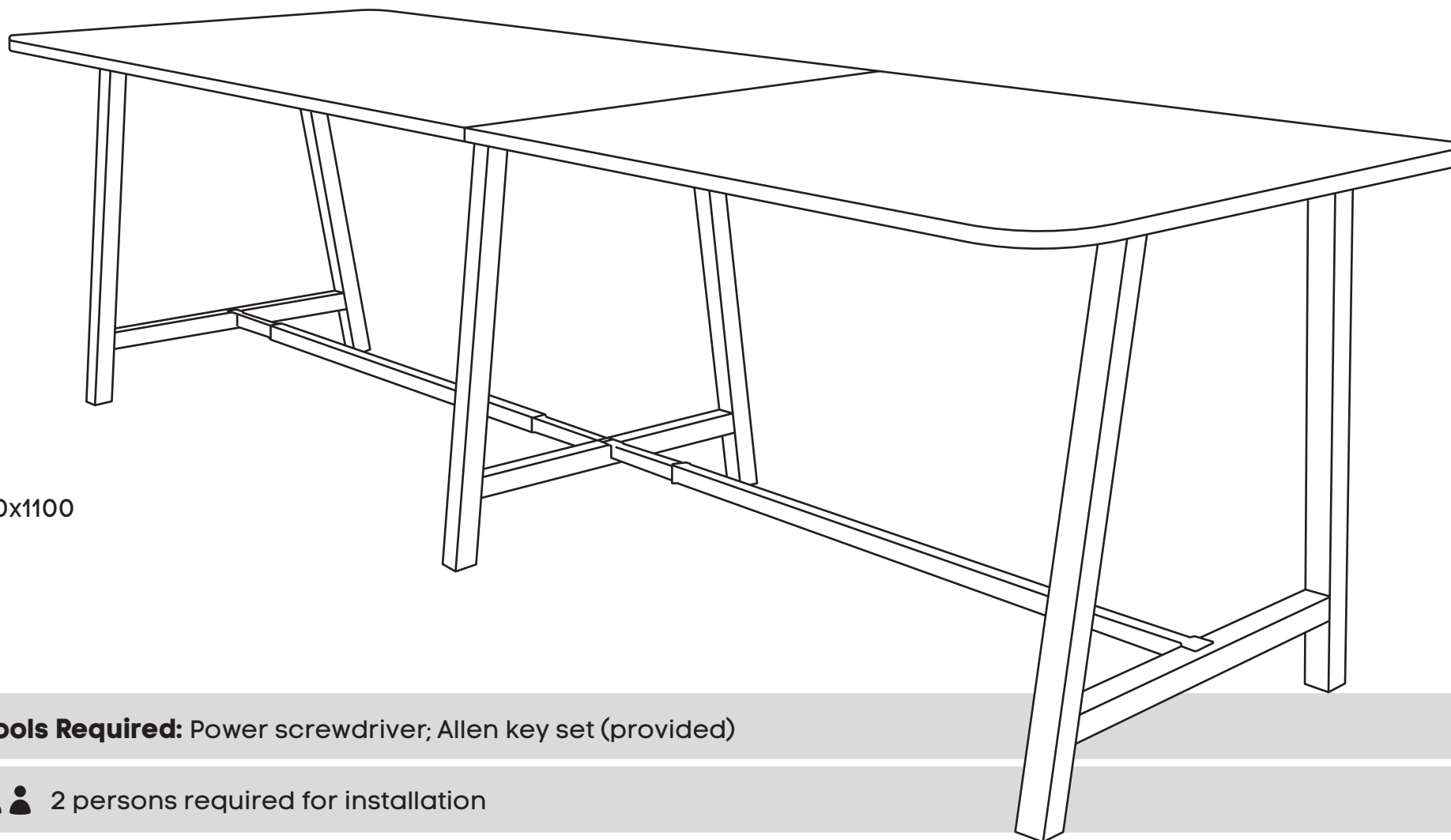

# Quadro A Leg Radius Corners Counter Table



**Size:**  
3200x1100

**Tools Required:** Power screwdriver; Allen key set (provided)

 2 persons required for installation

**Need help!**

Call us on **1300 527 665**

# Quadro A Leg Radius Corners Counter Table

## COMPONENTS

- A Table top x2
- B Leg Quadro A x3
- C Upper Beam x2 \*
- D Lower Beam x2
- E Plastic bracket x8
- F Feet x6

## SCREWS

- G M8x20MM CSK x12
- H M8x20MM Socket head x8
- I M6x20MM Socket head x6
- J M6x30MM Socket head x8

- K Allen key x2

\* Colour of the beam is always black, regardless desk frame colour.

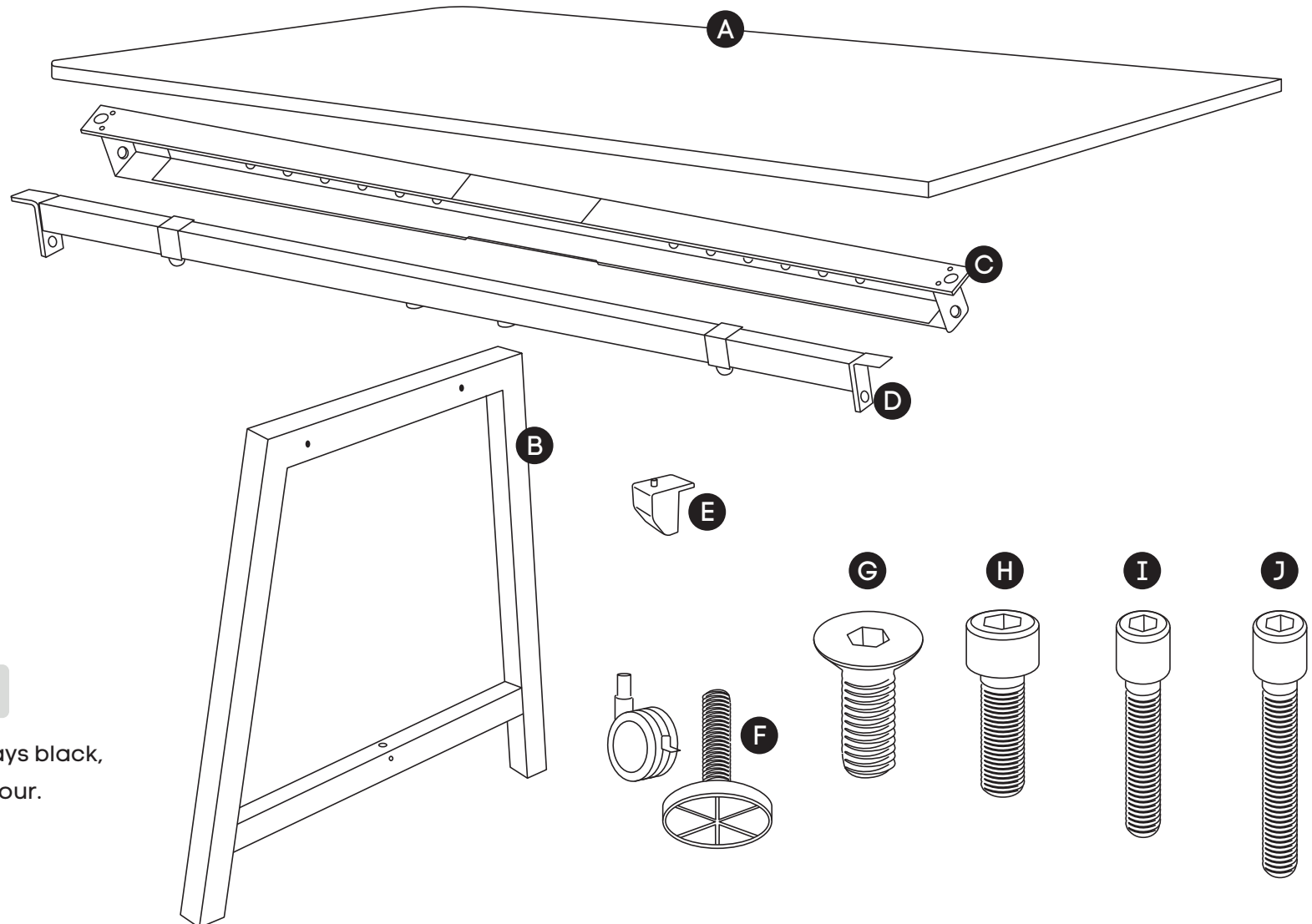

# Quadro A Leg Radius Corners Counter Table

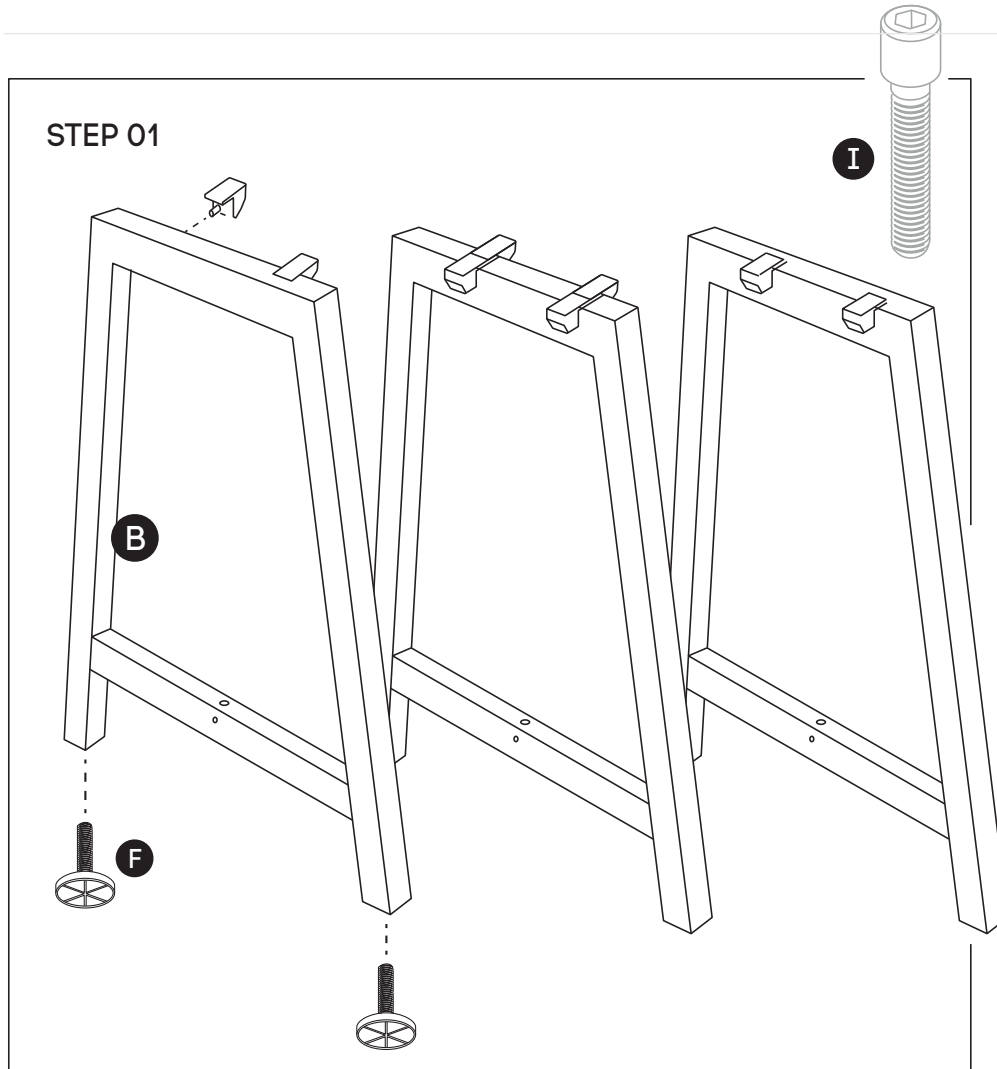

Using Allen Key provided, attach 2 plastic brackets per exterior leg (D), and 4 plastic brackets for the shared leg (as per picture above) using M6x20MM (I) Socket head screw. Screw the feet (F) to the bottom of each leg (B)

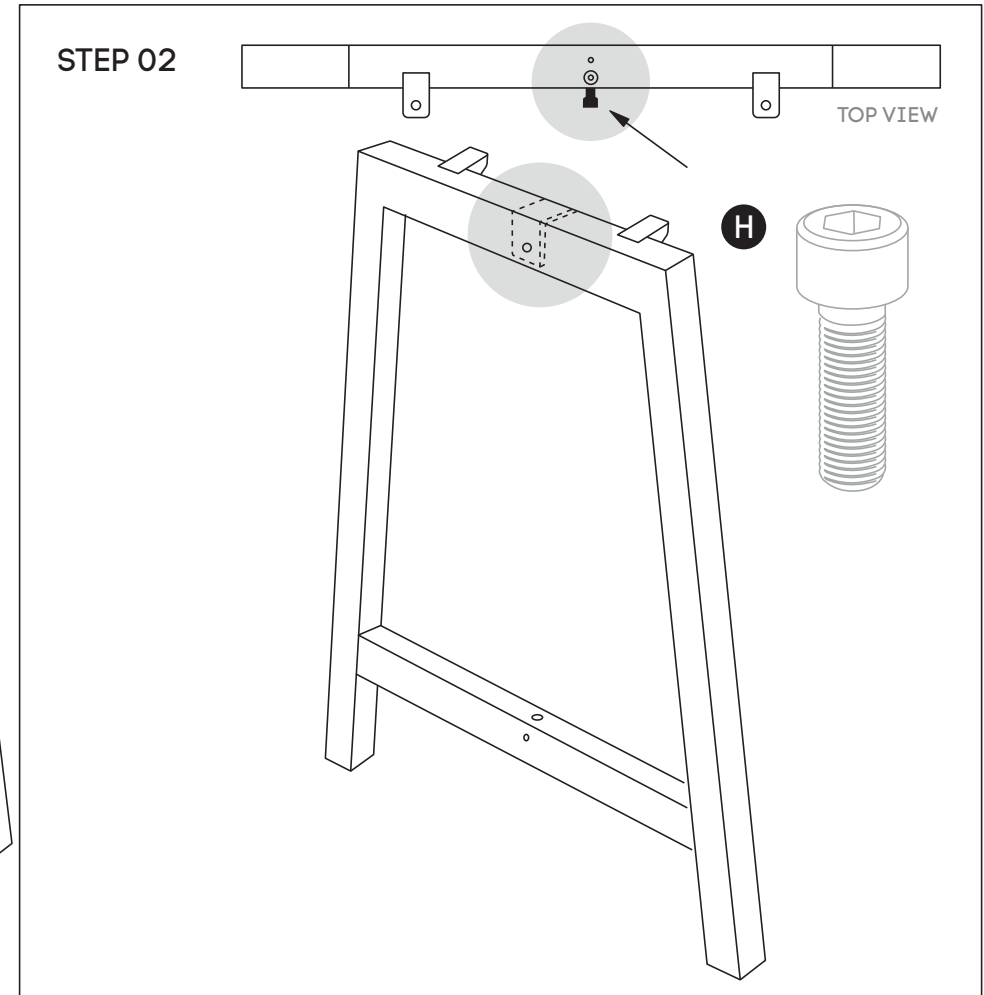

Using Allen Key provided, attach M8x20MM Socket head (H)-screw socket half way into leg for all legs (B)

# Quadro A Leg Radius Corners Counter Table

## STEP 03

Adjust extendable beam (C) to desired length using markers and secure beam at that length using screws provided

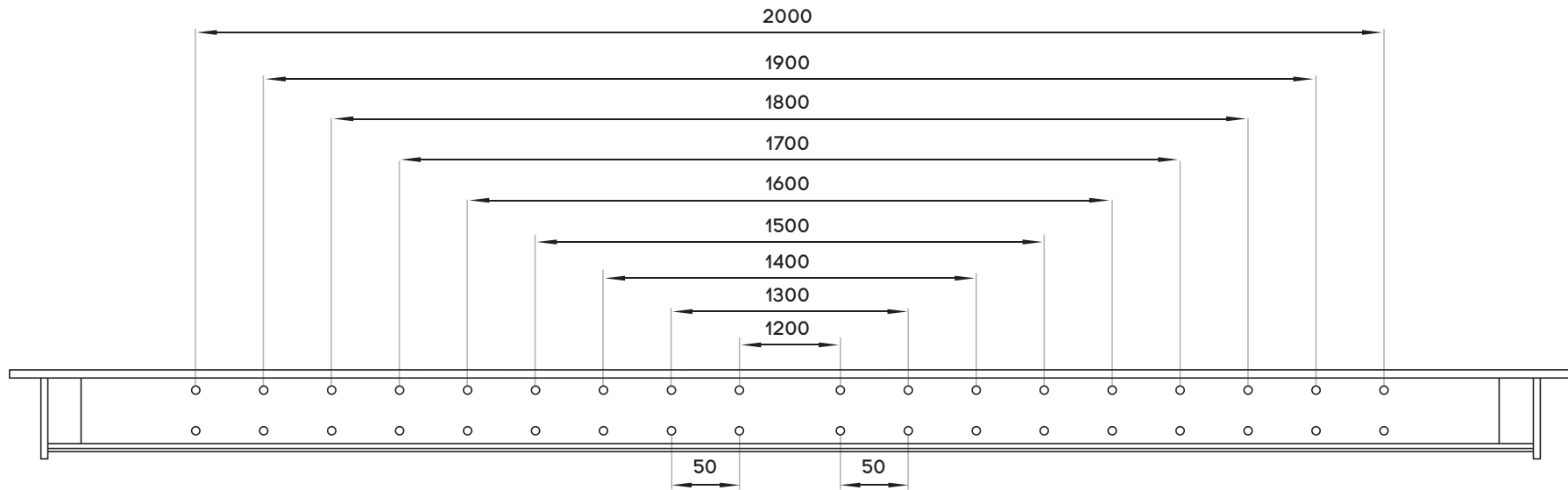
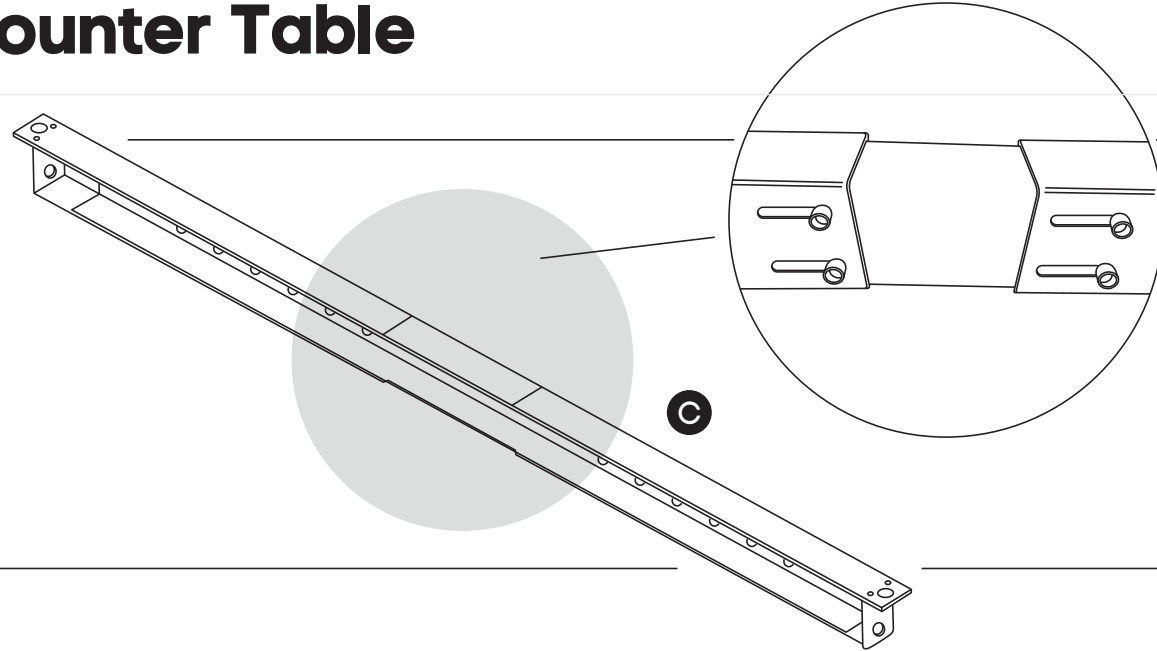

# Quadro A Leg Radius Corners Counter Table

## STEP 04

Adjust extendable beams **(D)** to desired length.

- 1 Remove plastic inserts
- 2 Loosen 2 bolts on beam using allen key
- 3 Extent lower beam to the same distance as upper beam
- 4 Insert plastic inserts back into the beam

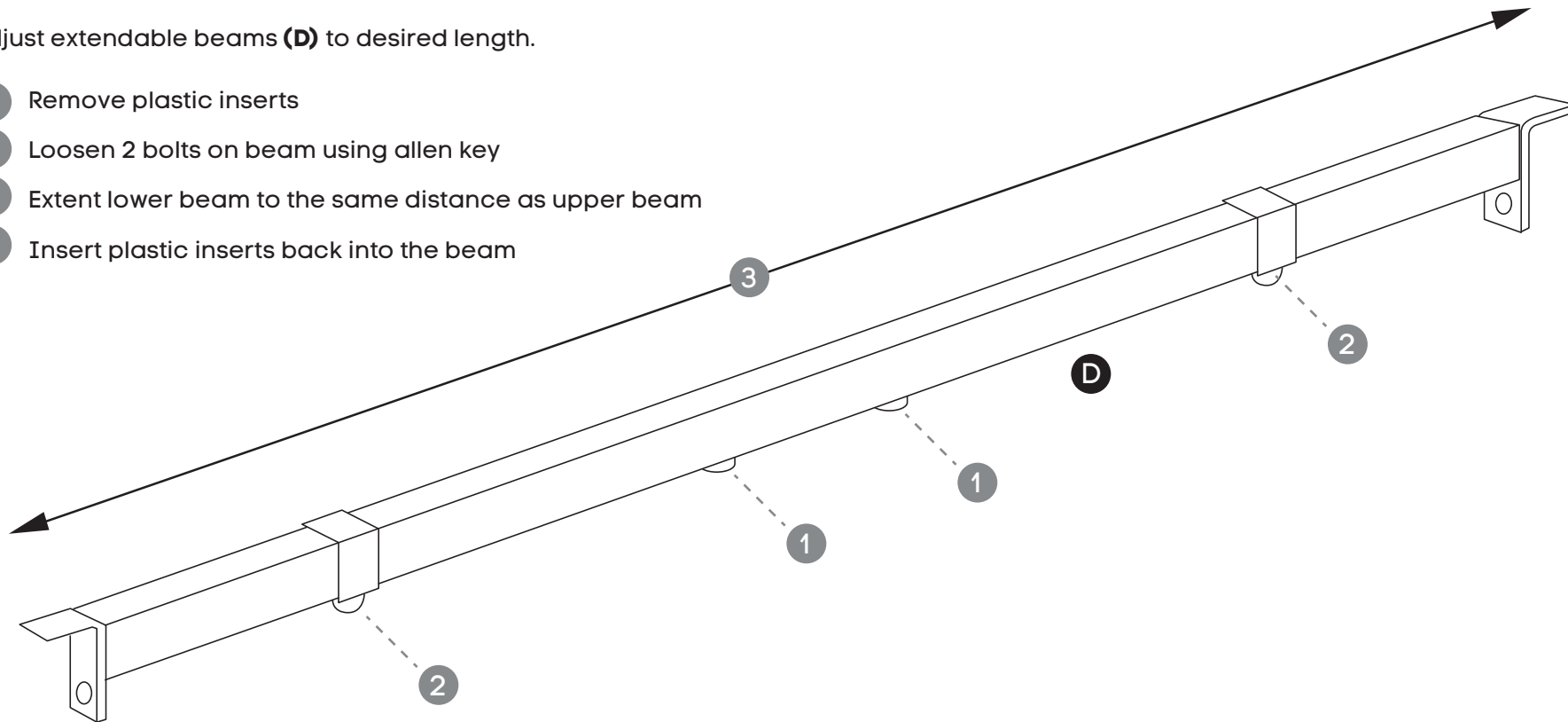

# Quadro A Leg Radius Corners Counter Table

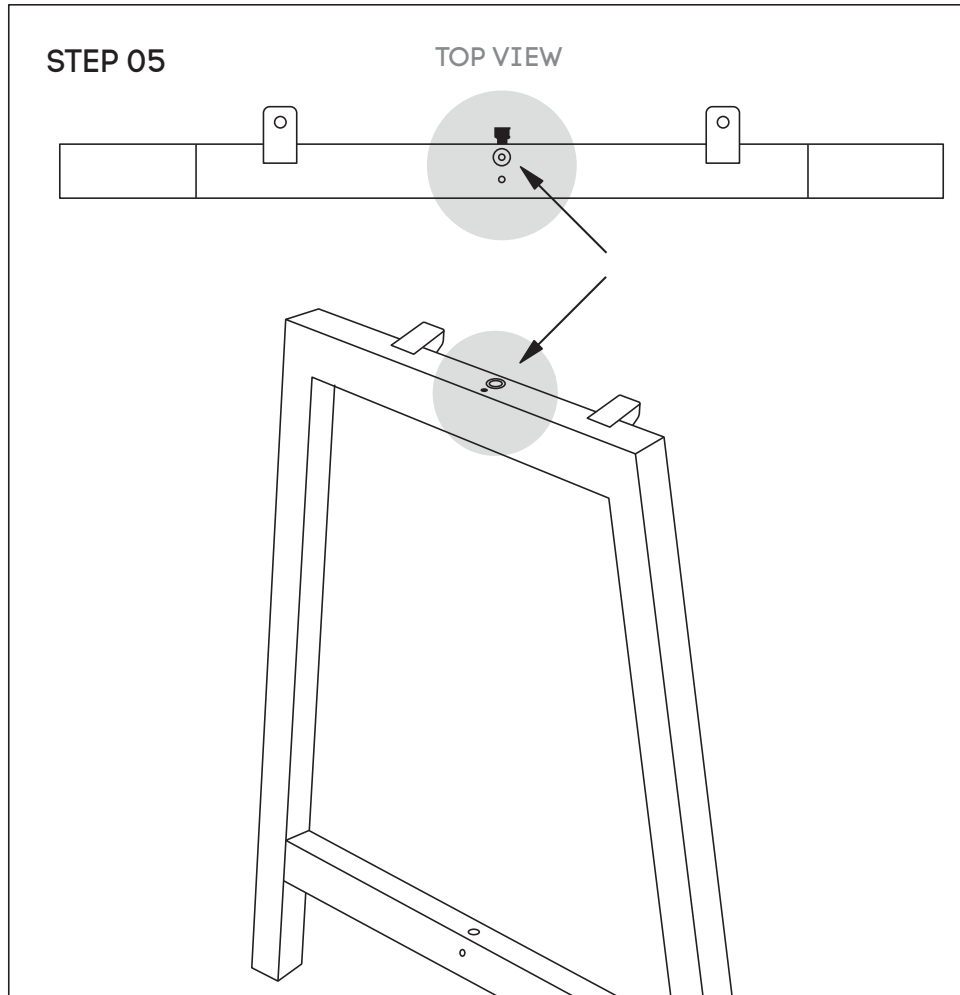

Attach Upper Beams **(C)** to legs **(B)** using nut insert in legs.  
See point attached

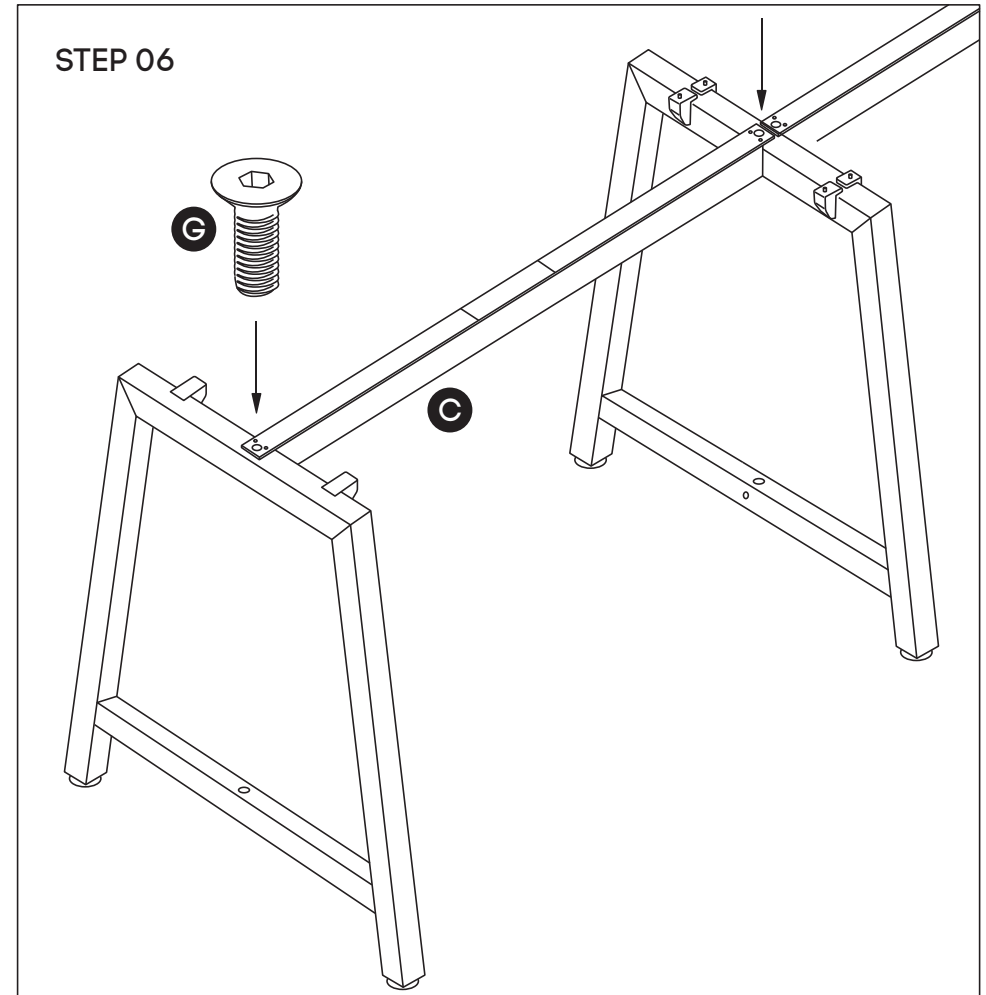

Frame looks like this. Using Allen Key, attach Upper Beam **(C)** with  
Sockets **(G)**.

**Need help!**

Call us on **1300 527 665**

# Quadro A Leg Radius Corners Counter Table

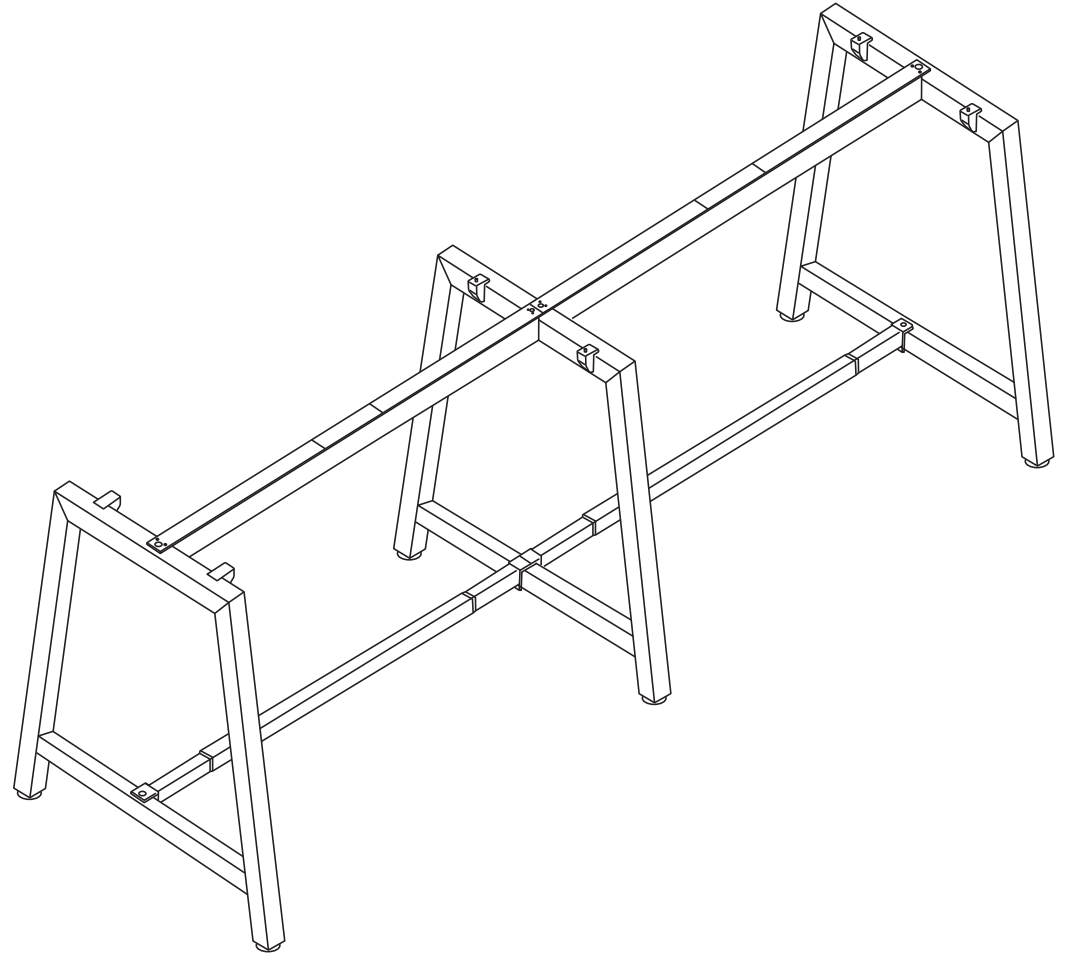
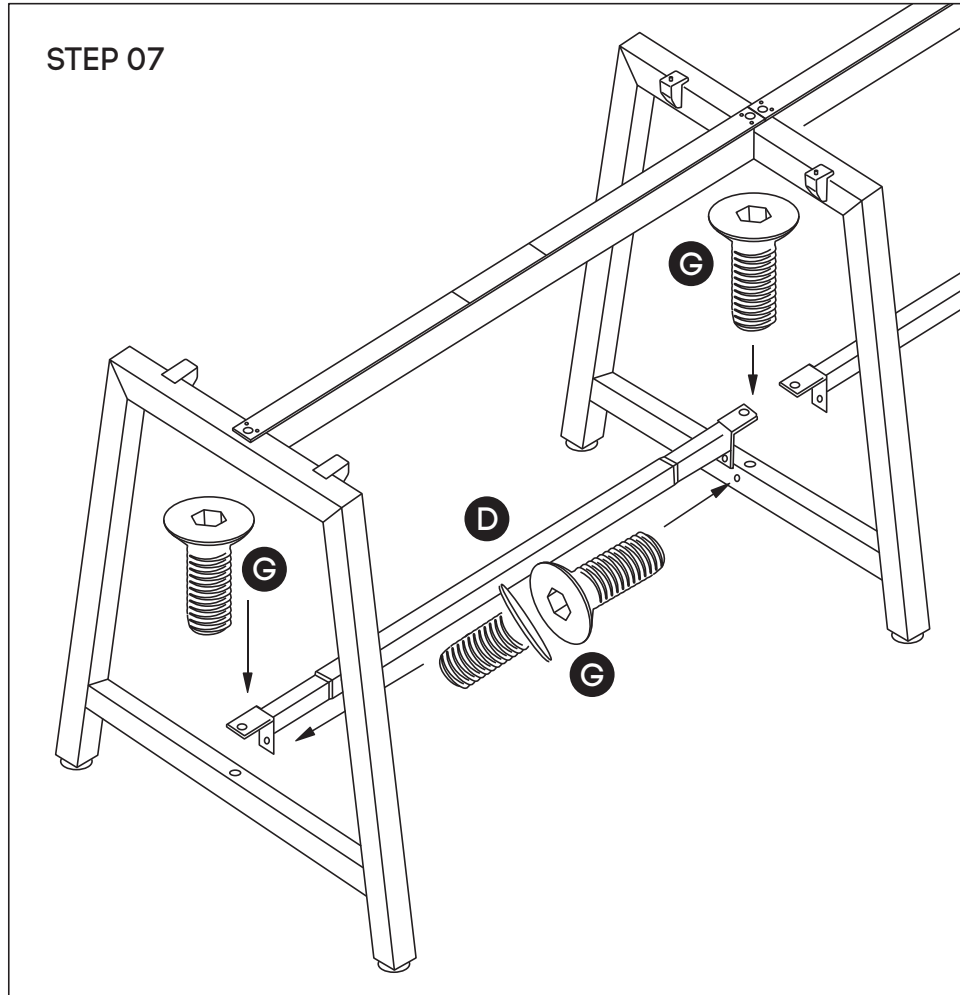

Frame looks like this. Using Allen Key. Tighen Sockets (G) on the Lower Beams (D) using Allen Key (J). Insert plastic spacers to improve regidity. Attach two Sockets (G) to the side of each lower side beam (as shown in the picture).

**Need help!**

Call us on **1300 527 665**

# Quadro A Leg Radius Corners Counter Table

jason.l

TABLE TOP  
BOTTOM VIEW

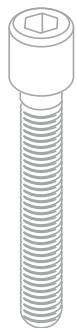
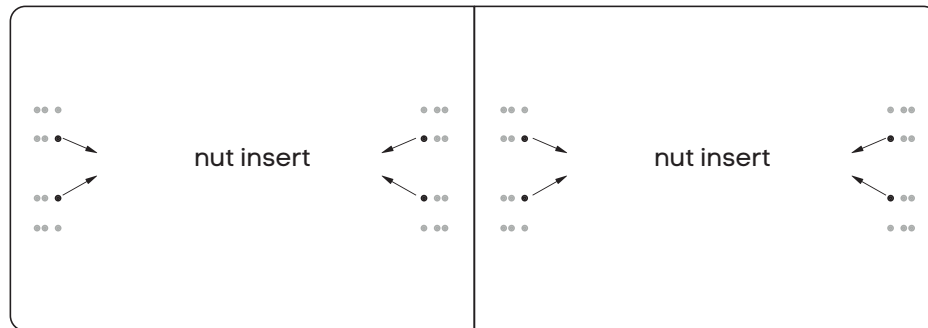

Place desktop on top of frame. Please tighten screws using M6x30MM (J) into the underneath of the tops.

STEP 08

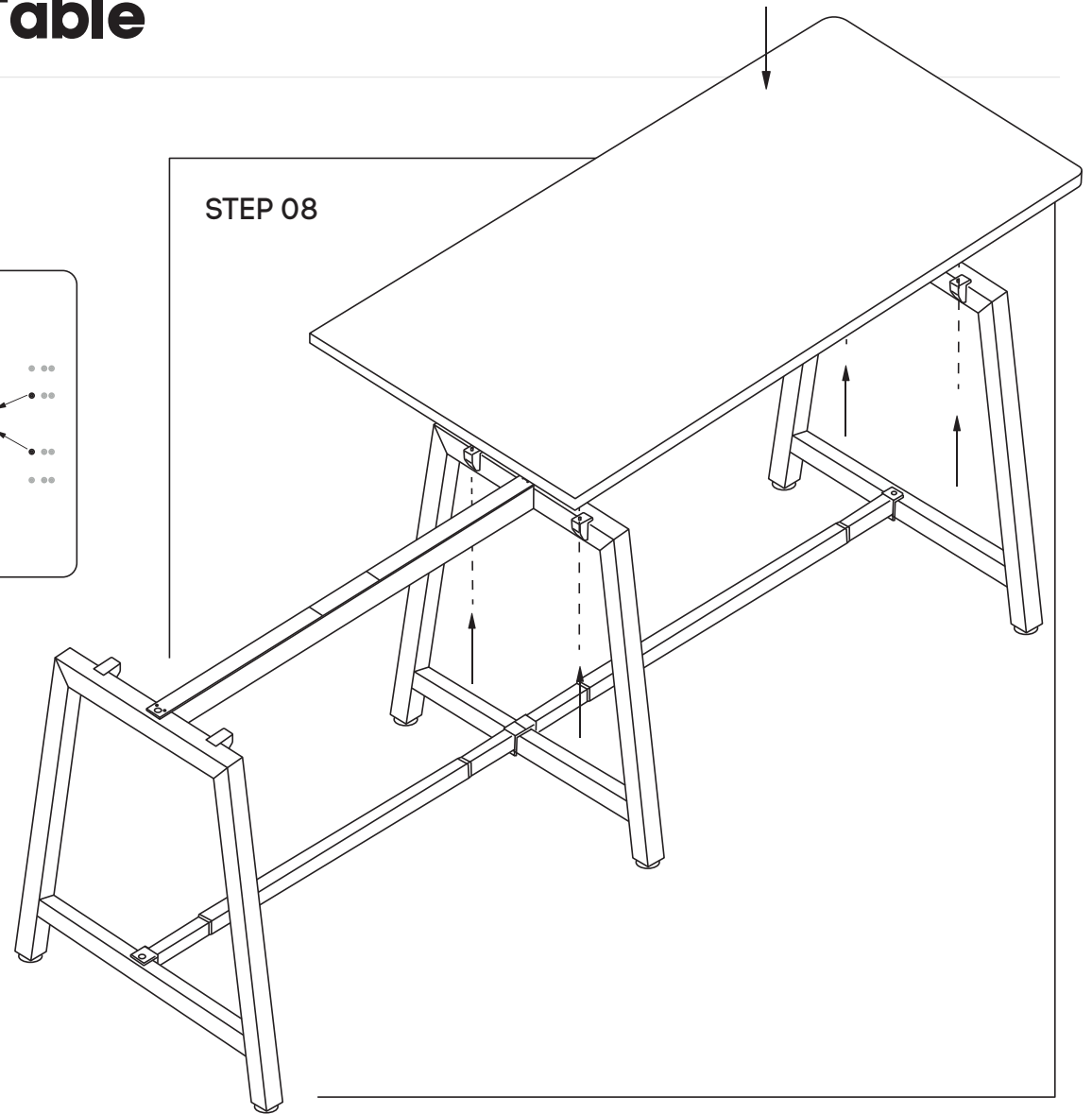



# Quadro A Leg Radius Corners Counter Table

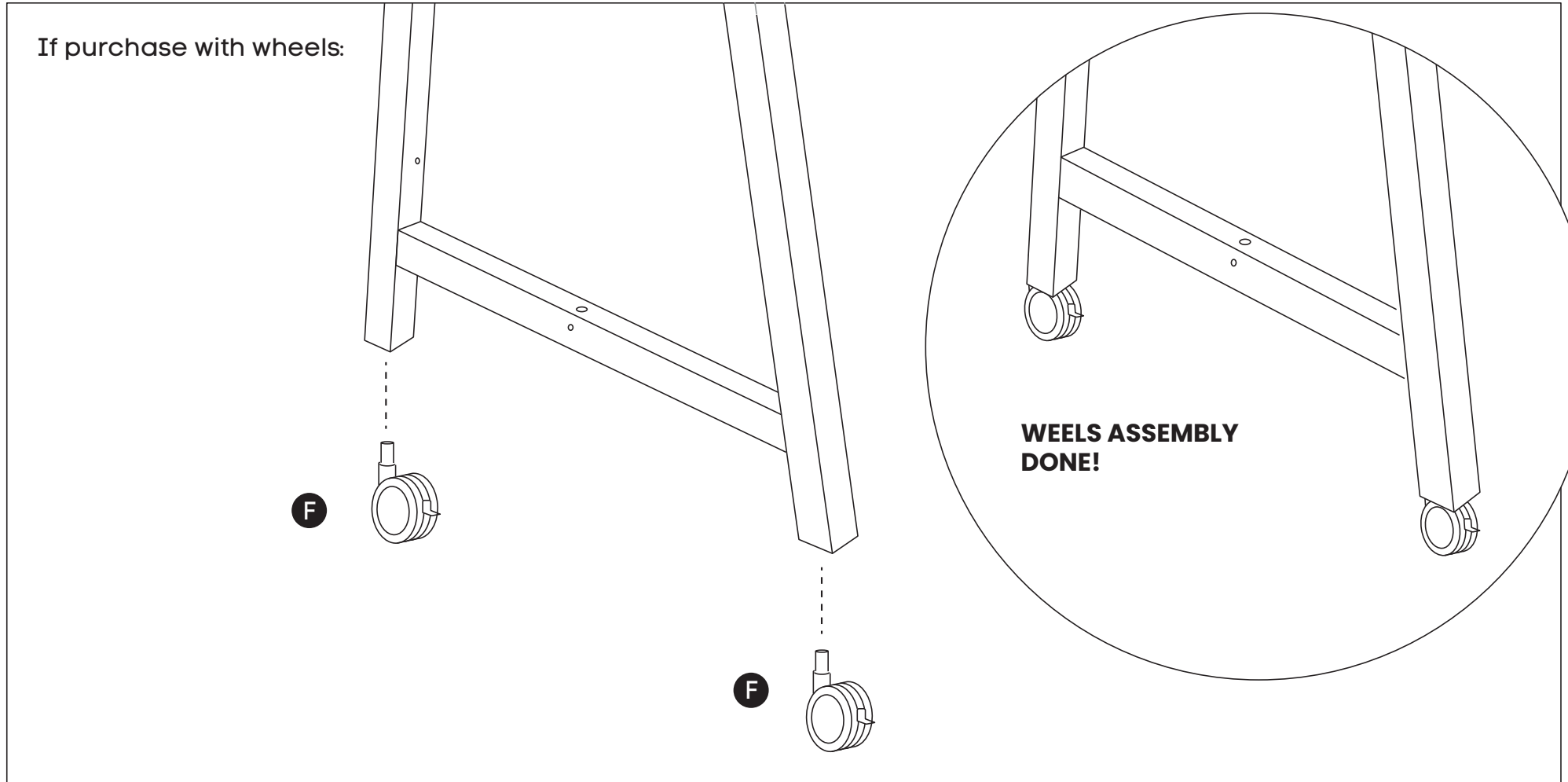

Replace Feet on the bottom of each leg with wheels **(F)**

**Need help!**

Call us on **1300 527 665**