

**ASSEMBLY INSTRUCTIONS**

# Uniform 2 Small Door Storage Cupboard with Planter Box

Size (mm): 800W x 450D x 1395H

[www.jasonl.com.au](http://www.jasonl.com.au)

**Need help!**

Call us on  
**1300 527 665**

**jason.l**  
your office furniture mate

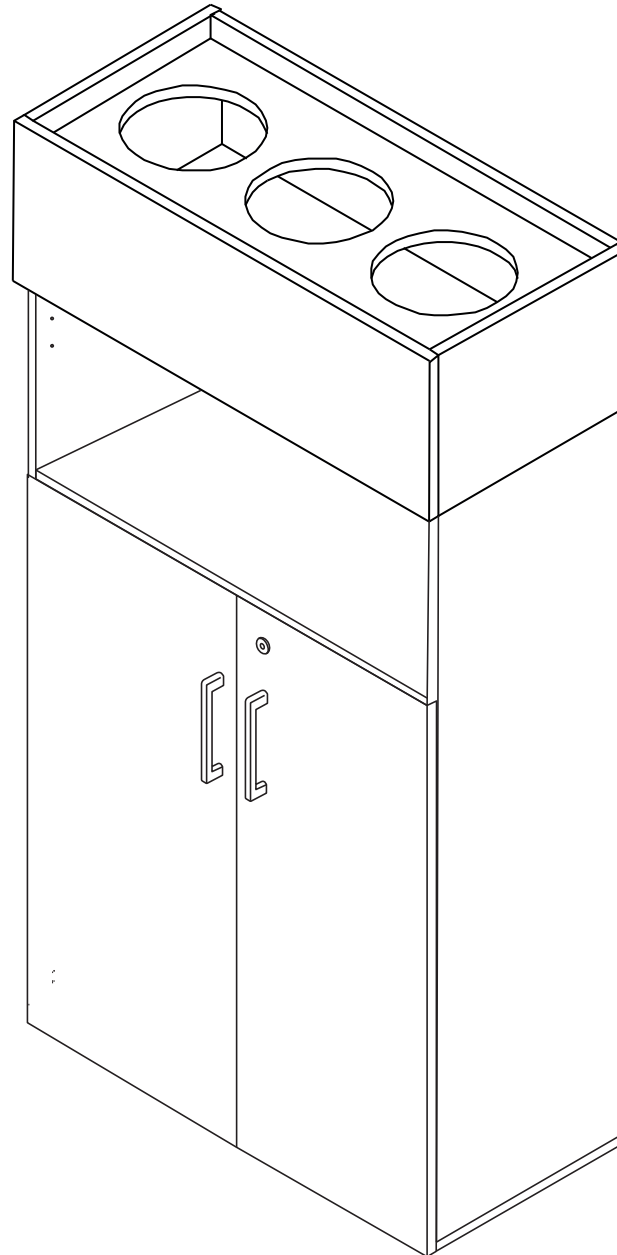

## ASSEMBLY INSTRUCTIONS

# Uniform 2 Small Door Storage Cupboard with Planter Box

Size (mm): 800W x 450D x 1395H

[www.jasonl.com.au](http://www.jasonl.com.au)

**Need help!**

Call us on  
**1300 527 665**

**jason.l**  
your office furniture mate

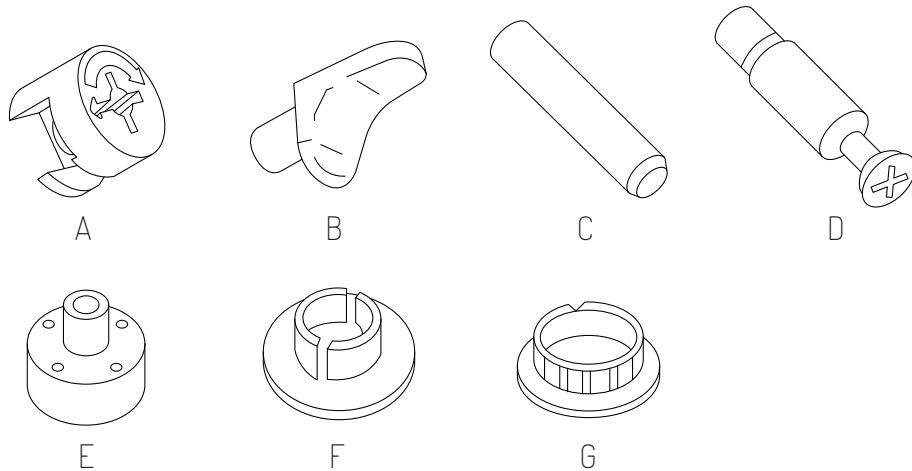

### COMPONENTS

A	Minifix Housing x16	E	Adjustable Leveller N2880 x5
B	Collar Stud x10	F	Leveller N2880 Cap x5
C	Rubber Wood Dowel M8 x40mm x12	G	Deco Cap x5
D	Minifix Connecting Bolt x16	H	Safety hook *

### PANELS

Back Panel x1  
Side Panel x2  
Base Panel x1  
Shelf Panel x2  
Top Rail x1 (\*)  
Door Panel x2

### DOOR ASSEMBLY

5/8 Door Hinge c/w Mounting Plate x4  
Chipboard Screw 4x16mm x24  
CSK Tapping Screw #4 3/4" x4  
Rim Lock CL 2/3 x1  
Pan Head Self Tapping Screw x4  
L Huwil Bracket x1  
Plate Bracket BK x1

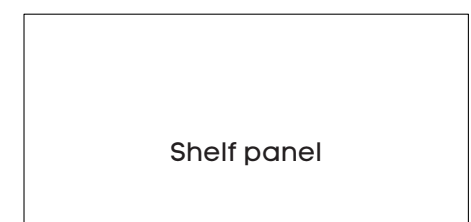
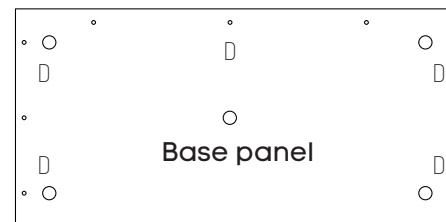
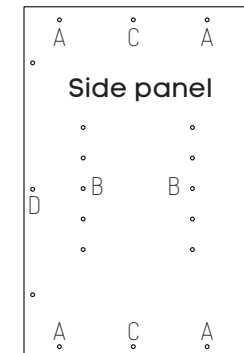
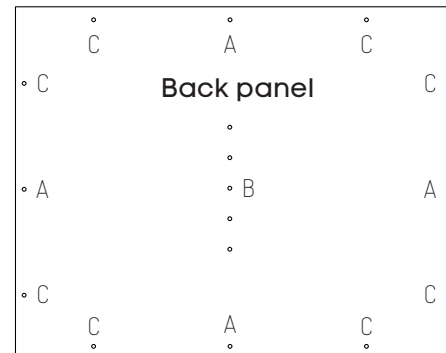

(\*) The top rail is only required when assembling this unit with doors.

## ASSEMBLY INSTRUCTIONS

# Uniform 2 Small Door Storage Cupboard with Planter Box

Size (mm): 800W x 450D x 1395H

[www.jasonl.com.au](http://www.jasonl.com.au)

**Need help!**

Call us on  
**1300 527 665**

**jason.l**  
your office furniture mate



**Function of Klix Cam**  
Turn for locking  
75° Min - 195° Max

Make sure the arrow is pointing upwards before inserting into the panel's hole.

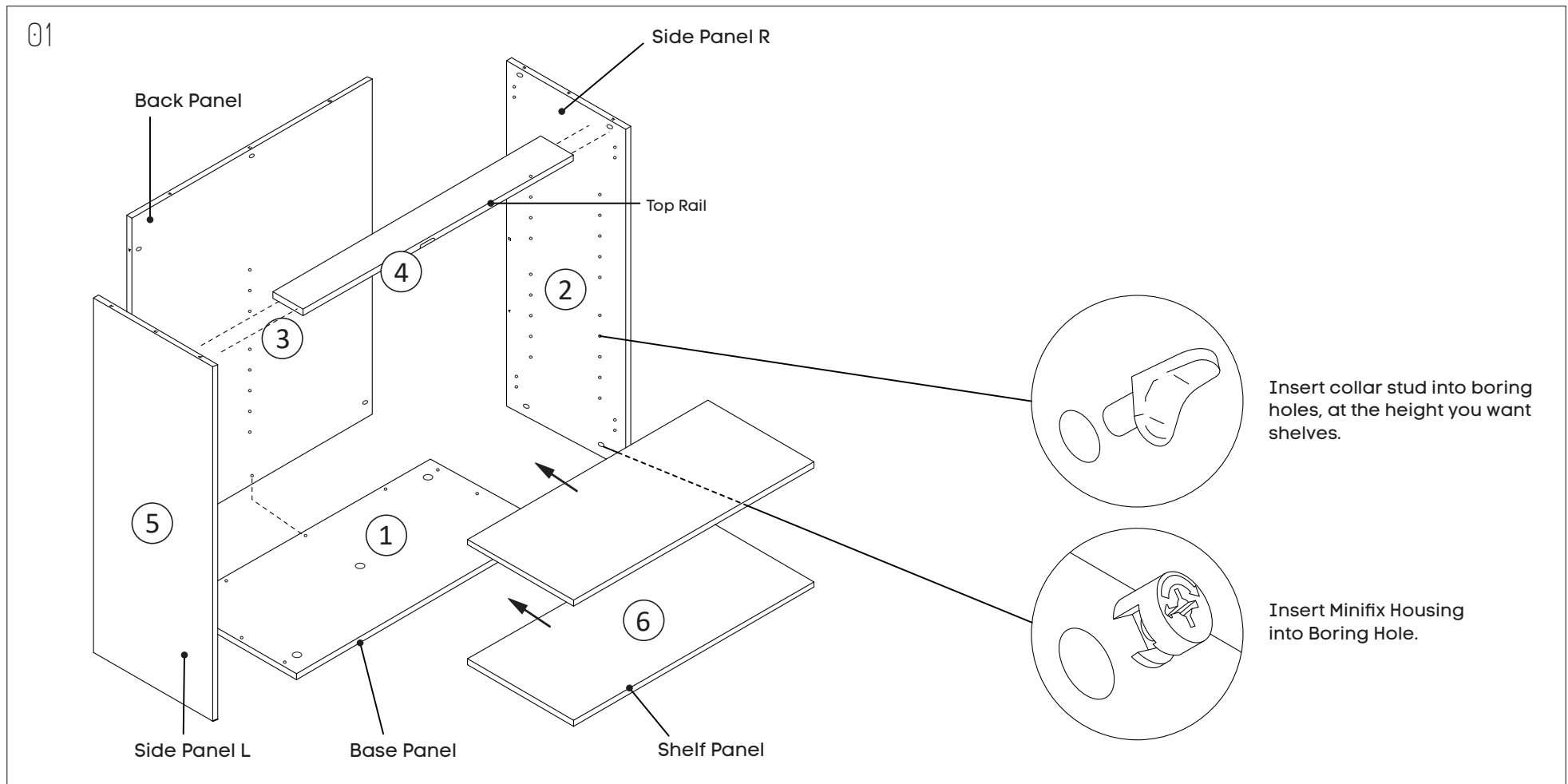

Assemble all panels in the following order.

## ASSEMBLY INSTRUCTIONS

# Uniform 2 Small Door Storage Cupboard with Planter Box

Size (mm): 800W x 450D x 1395H

[www.jasonl.com.au](http://www.jasonl.com.au)

**Need help!**

Call us on  
**1300 527 665**

**jason.l**  
your office furniture mate

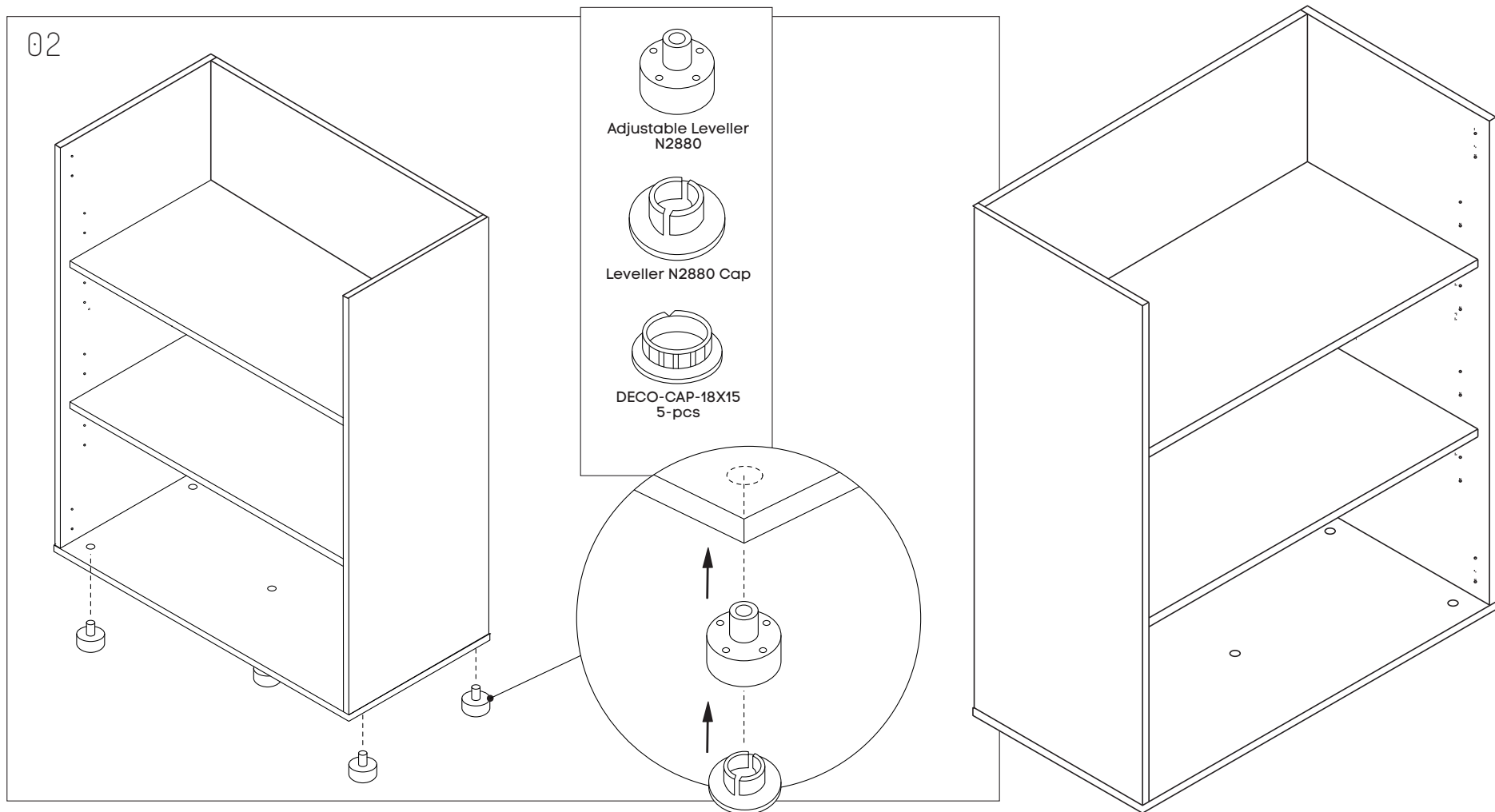

Tighten leveller into boring hole and screw the cap.  
Use DECO-CAP-18X15 to seal holes on base panel.

## ASSEMBLY INSTRUCTIONS

# Uniform 2 Small Door Storage Cupboard with Planter Box

Size (mm): 800W x 450D x 1395H

[www.jasonl.com.au](http://www.jasonl.com.au)

**Need help!**

Call us on  
**1300 527 665**

**jason.l**  
your office furniture mate

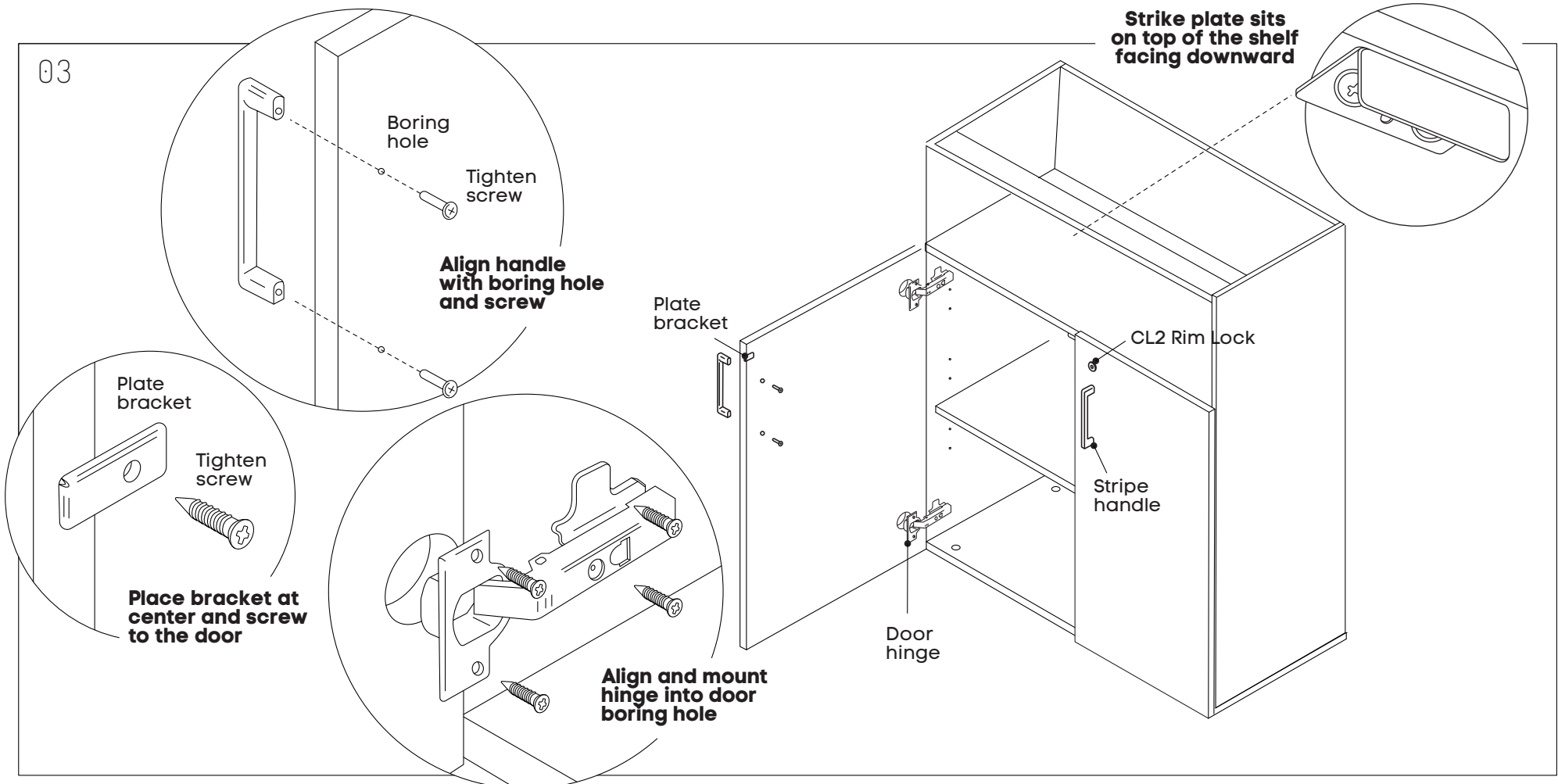

Tighten leveller into boring hole and screw the cap.  
Use DECO-CAP-18X15 to seal holes on base panel.

## ASSEMBLY INSTRUCTIONS

# Uniform 2 Small Door Storage Cupboard with Planter Box

Size (mm): 800W x 450D x 1395H

[www.jasonl.com.au](http://www.jasonl.com.au)

**Need help!**

Call us on  
**1300 527 665**

**jason.l**  
your office furniture mate



## Planter Box assembly

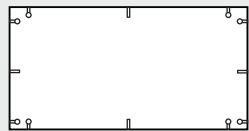

① BASE PANEL  
Qty: 1 pc

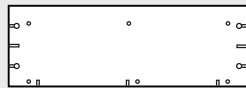

② BACK PANEL  
Qty: 1 pc



③ SIDE PANEL L  
Qty: 1 pc

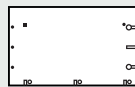

④ SIDE PANEL R  
Qty: 1 pc



⑤ FRONT PANEL  
Qty: 1 pc

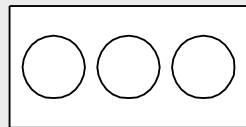

⑥ TOP PANEL  
Qty: 1 pc



Collar Stud  
262.24.710  
4 pcs



Minifix Steel  
Bolt 10259  
16 pcs



DECO-CAP  
16x5  
16 pcs

### Step 1.

Assemble component follow sequence number

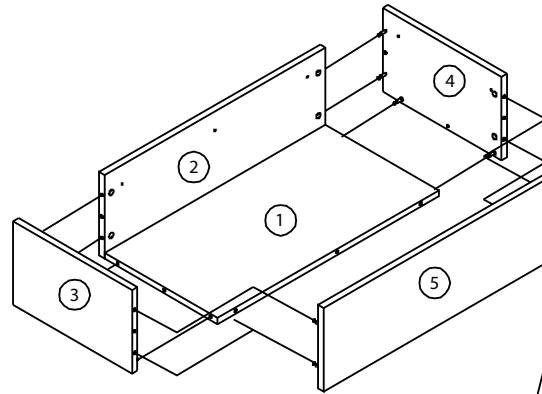

### Step 2.

Insert collar stud into boring hole

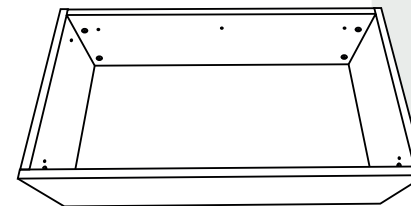
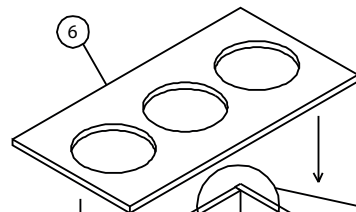

### Note:

The bottom panel should be facing down. Screws holes must be seen from the outside only.

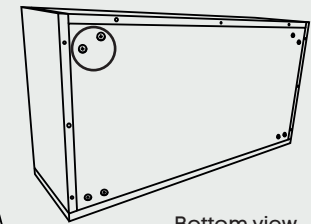

Bottom view

### Note For Minifix Cam

Important Function of Klix cam



1/4 RIGHT TURN FOR

LOCKING Make Sure The Arrow Is Pointing Upwards Before Inserting Into The Panel's Hole

## ASSEMBLY INSTRUCTIONS

# Uniform 2 Small Door Storage Cupboard with Planter Box

Size (mm): 800W x 450D x 1395H

[www.jasonl.com.au](http://www.jasonl.com.au)

**Need help!**

Call us on  
**1300 527 665**

**jason.l**  
your office furniture mate



### Step 3.

Assemble planter box bottom panel on top of carcass and complete assembly

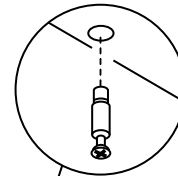
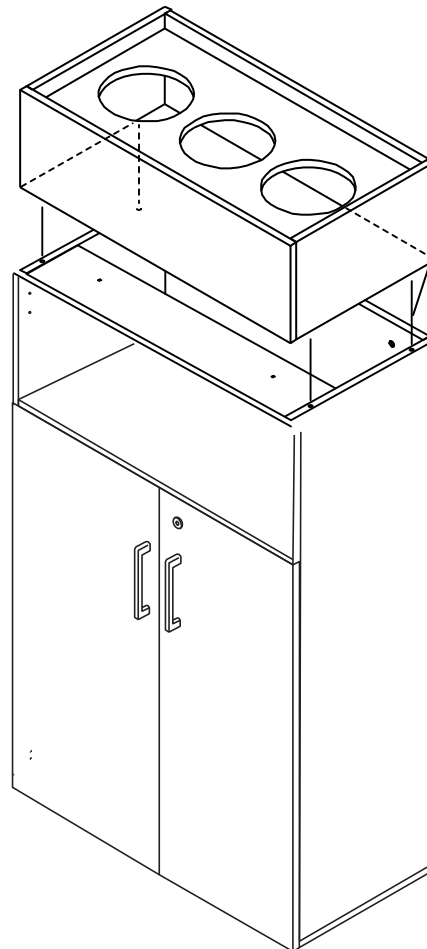

Tighten Minifix  
Connecting into  
Boring Hole.

**Complete  
assembly**

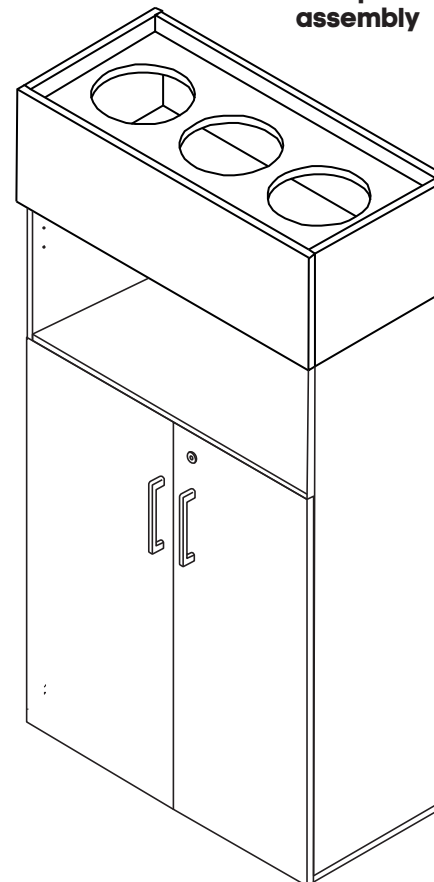

## ASSEMBLY INSTRUCTIONS

# Uniform 2 Small Door Storage Cupboard with Planter Box

Size (mm): 800W x 450D x 1395H

[www.jasonl.com.au](http://www.jasonl.com.au)

**Need help!**

Call us on  
**1300 527 665**

**jason.l**  
your office furniture mate

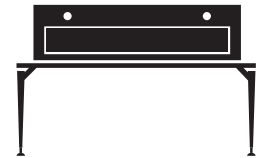

### Safety hook \*

Large furniture provides ample storage space while making your home look great. If you have kids at home, you should firmly secure your large and heavy furniture to prevent it from toppling.

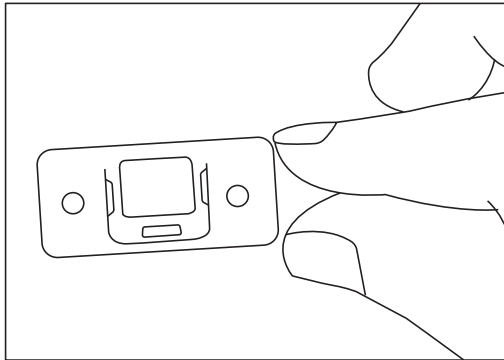

First set the location for install

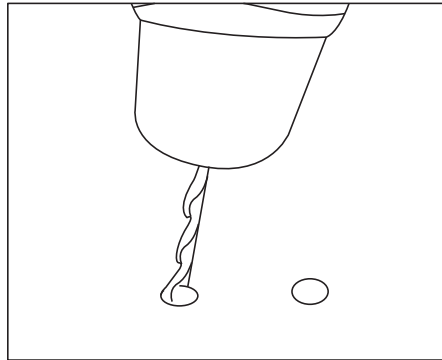

Select the location where the wall is installed and punch Ø8 mm

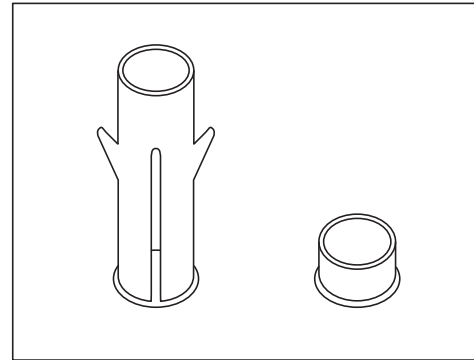

Install the screw expansion tube into the hole

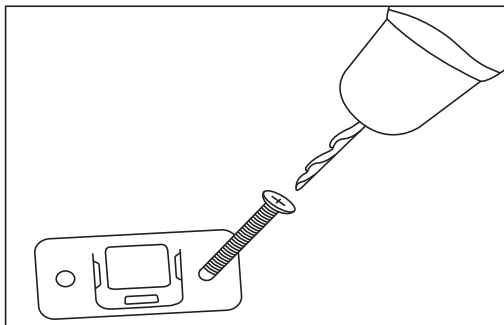

Mounting screws

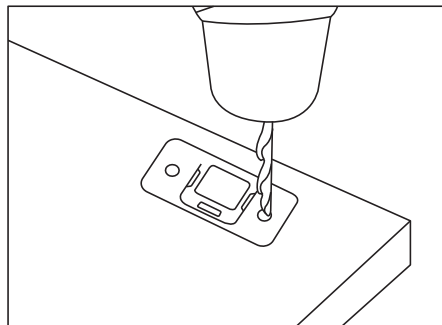

Choose a location that is fixed in the furniture

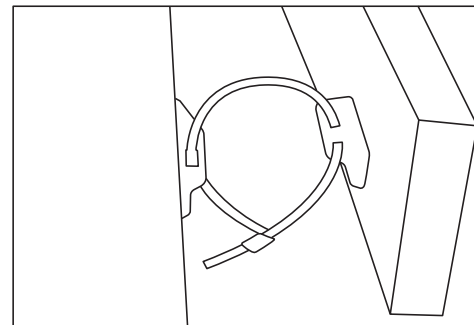

Adjust the distance of the connecting belt and complete the installation

### Components included

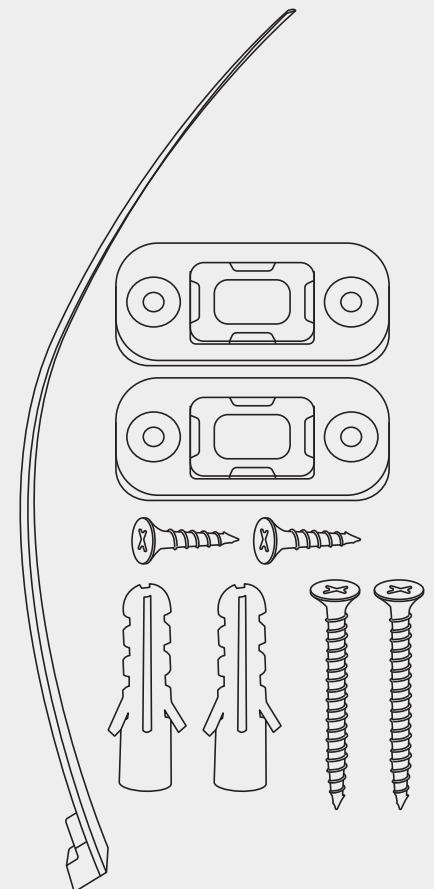

JasonL strongly recommends that the safety hook will be utilized in all circumstances to prevent falls when the bookcase is installed on uneven ground, is unevenly packed or is interfered with by pets, children, or as a result of any other household or commercial activity. We disclaim all liability for any loss occasioned in the event that the safety hook is not used or has been improperly installed