

ASSEMBLY INSTRUCTIONS

Flyby Echo screen with clamp brackets

www.jasonl.com.au

Need help!
Call us on
1300 527 665

jason.l
your office furniture mate

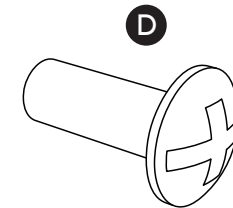
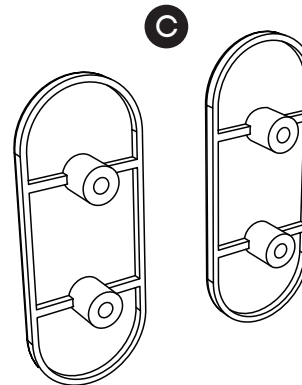
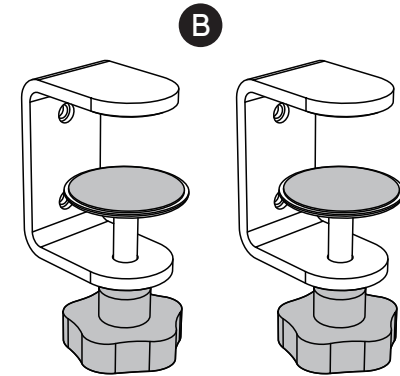
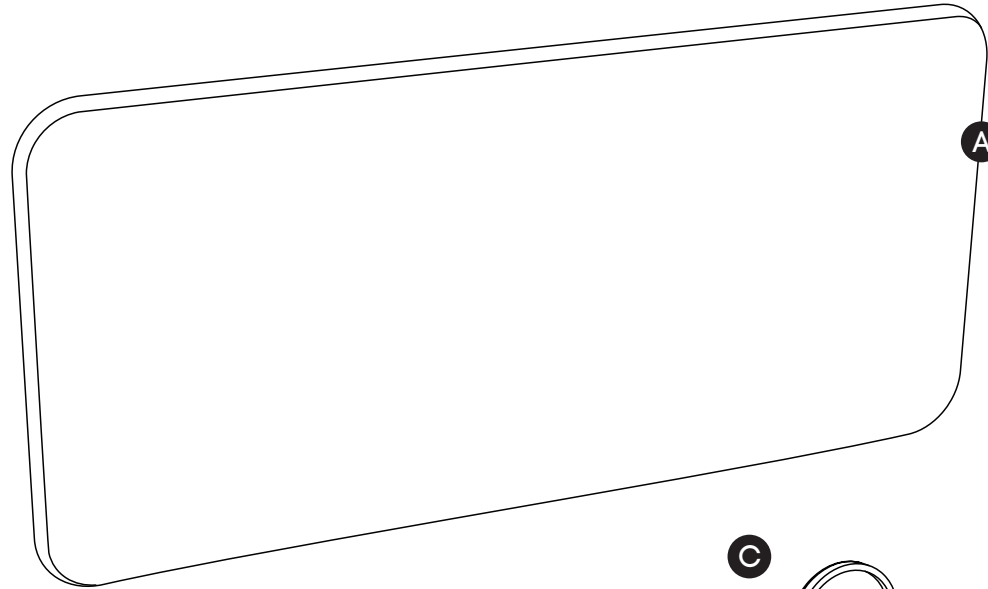

COMPONENTS

- A Echo Plate x 1
- B Clamps x2
- C Clamps cover x2
- D Screws x4

Experienced assembly is required. User will need to drill wood screws into underside of desk. No pre-drilled holes are provided for this system.



2 Persons required for installation *



Power Drill tool is required.

ASSEMBLY INSTRUCTIONS

Flyby Echo screen with clamp brackets

www.jasonl.com.au

Need help!
Call us on
1300 527 665

jason.l
your office furniture mate



STEP 01

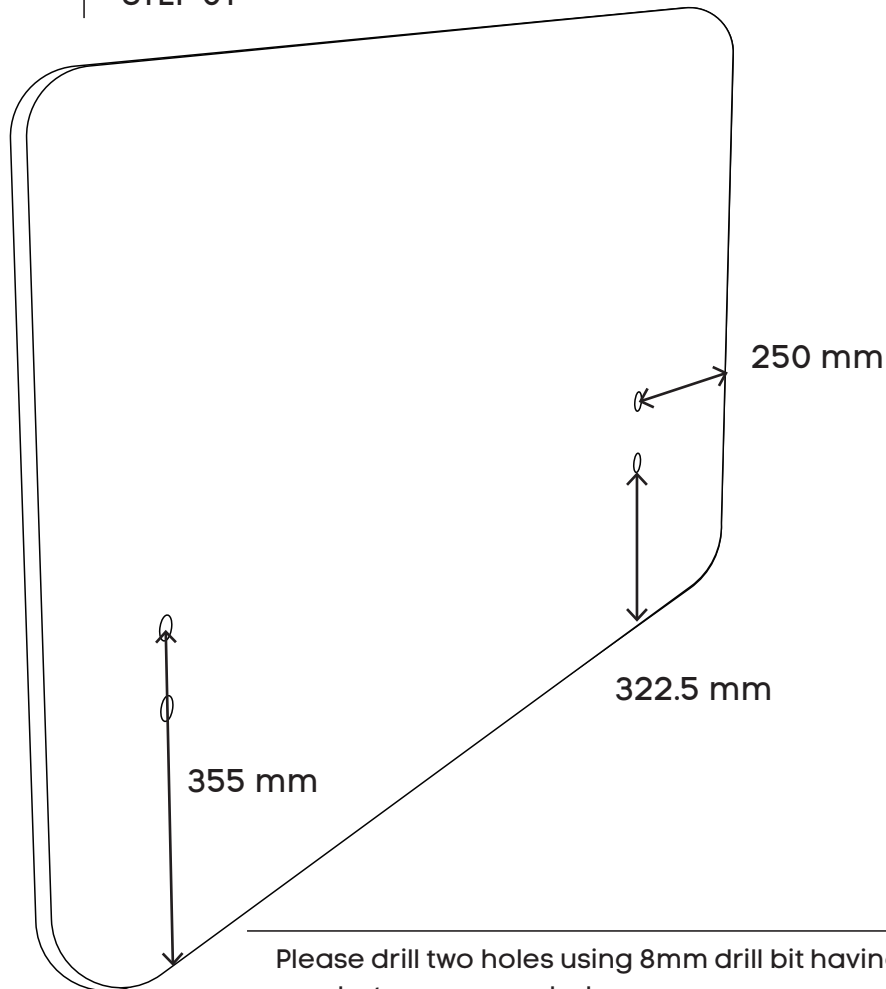

Please drill two holes using 8mm drill bit having a 32.5 mm gap between screw holes.

STEP 02

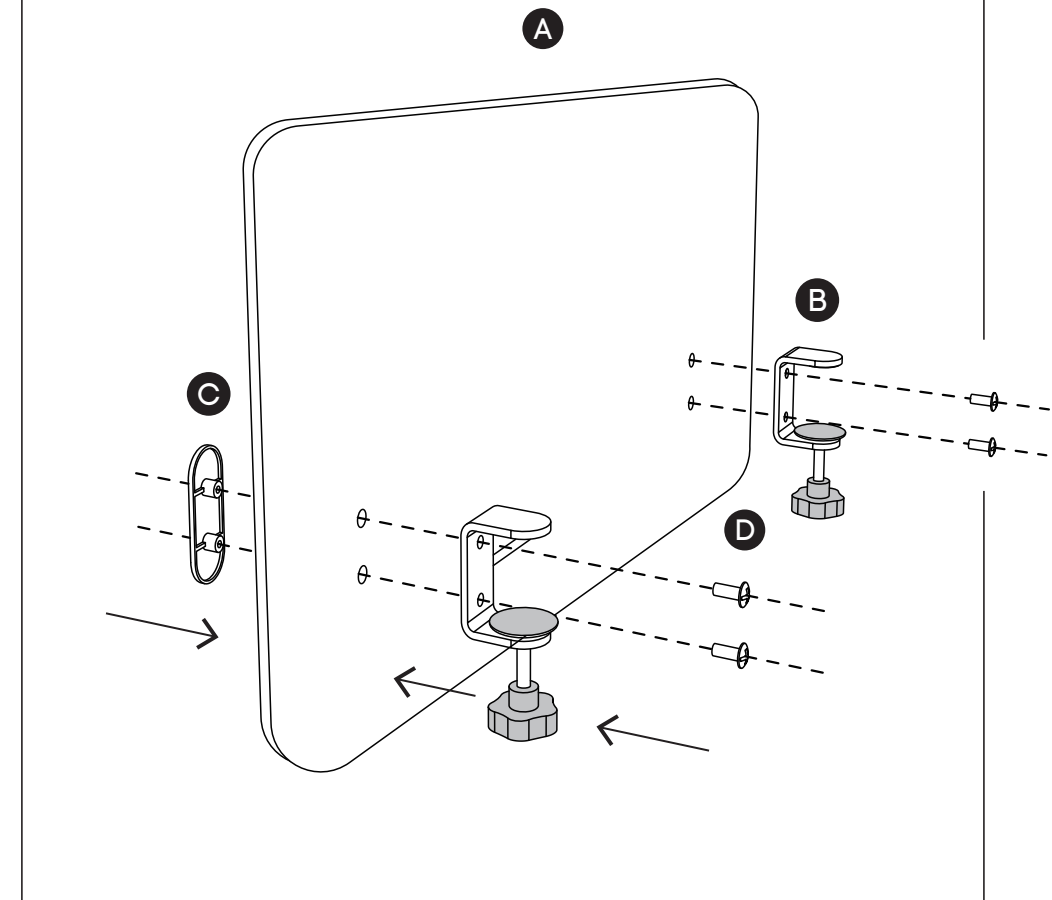

Assemble **A** plate with **B** bracket and tighten using 4 x screws provided (**D**) and apply the bracket cover **C**

ASSEMBLY INSTRUCTIONS

Flyby Echo screen with clamp brackets

www.jasonl.com.au

Need help!
Call us on
1300 527 665

jason.l
your office furniture mate



STEP 03

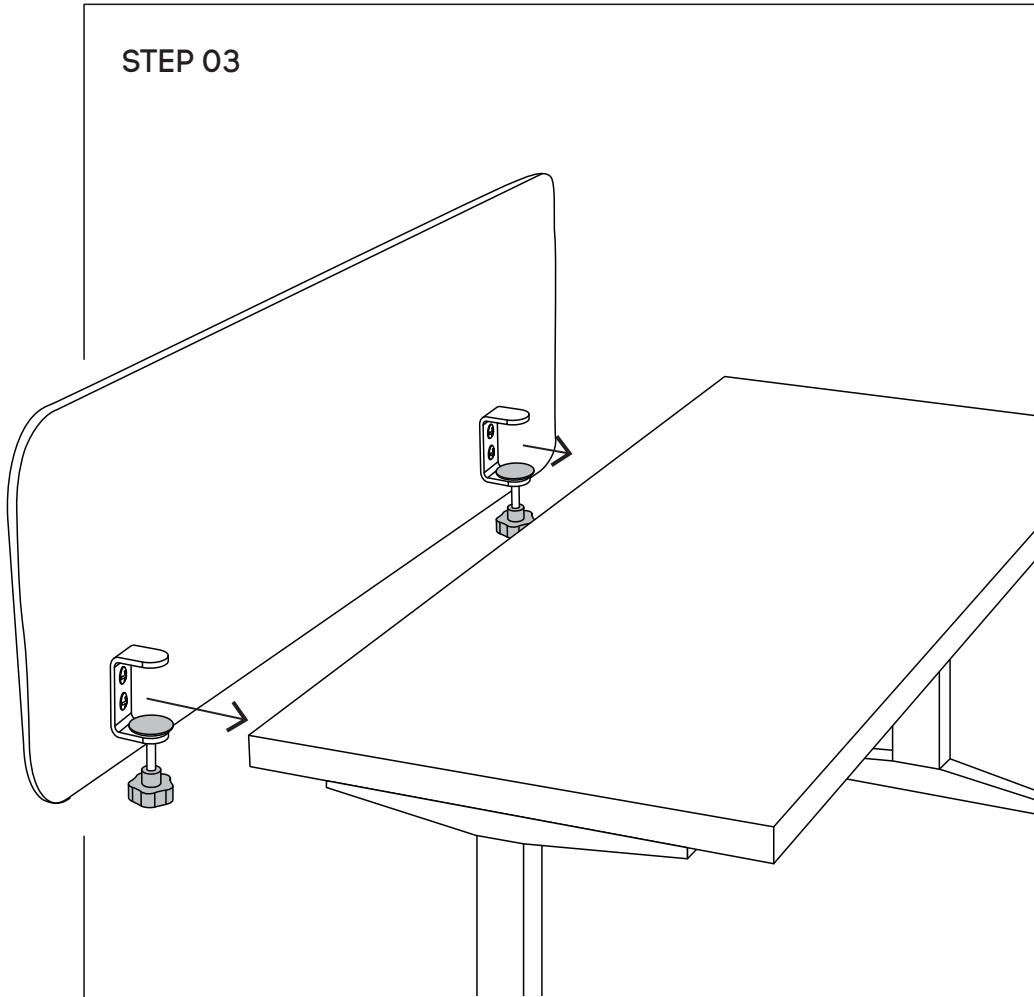

Please assemble Echo panel with desktop using clamp bracket

STEP 04

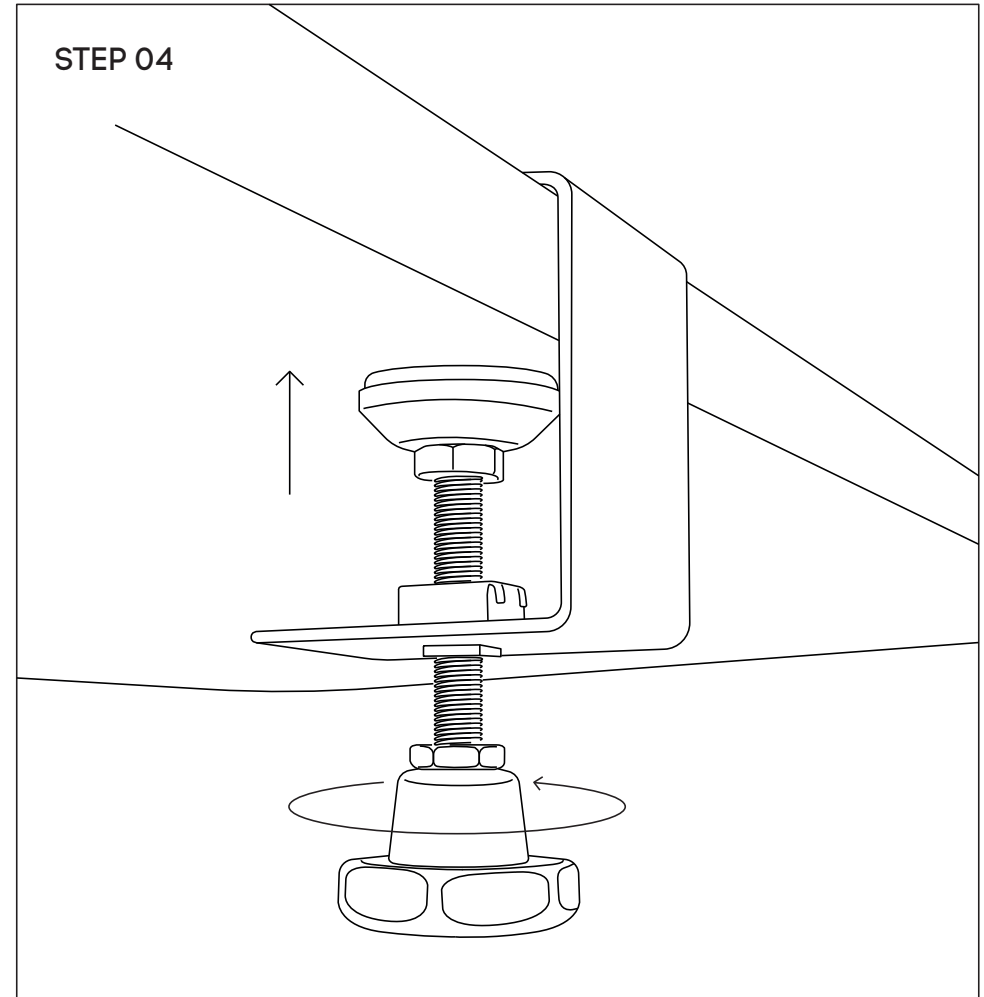

Tighten the clamp brackets on the desk but **please make sure it is still a bit loose** so that you are still able to move around the screen to its final position on desk and then **tighten the knob**.

ASSEMBLY INSTRUCTIONS
Flyby Echo screen
with clamp brackets

www.jasonl.com.au

Need help!
Call us on
1300 527 665

jason.l
your office furniture mate

