

DPG Switch In Desk Power Box

jason.l

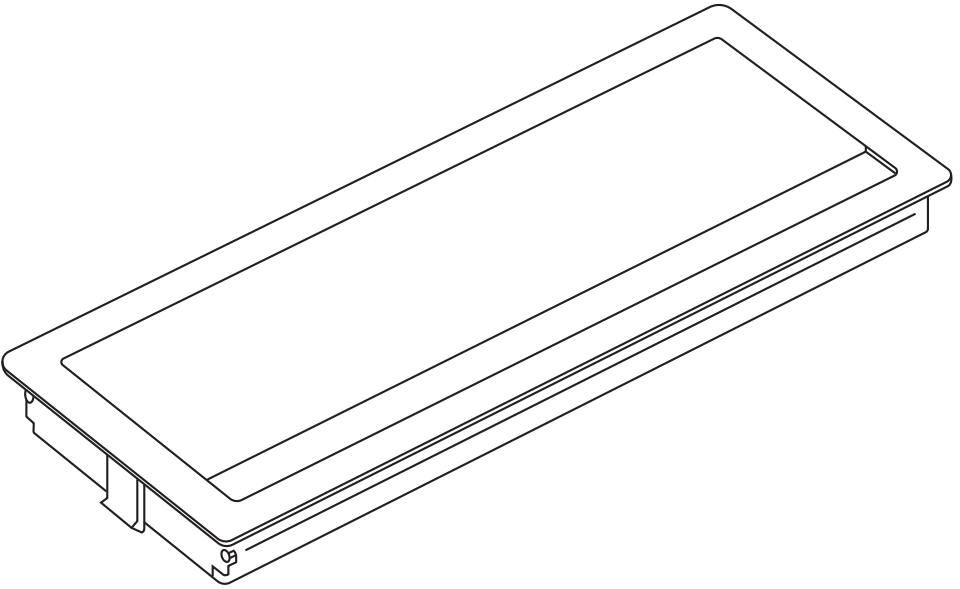

Need help!

Call us on **1300 527 665**

www.jasonl.com.au

1 of 2

DPG Switch In Desk Power Box

jason.l

How to disassemble and assemble:

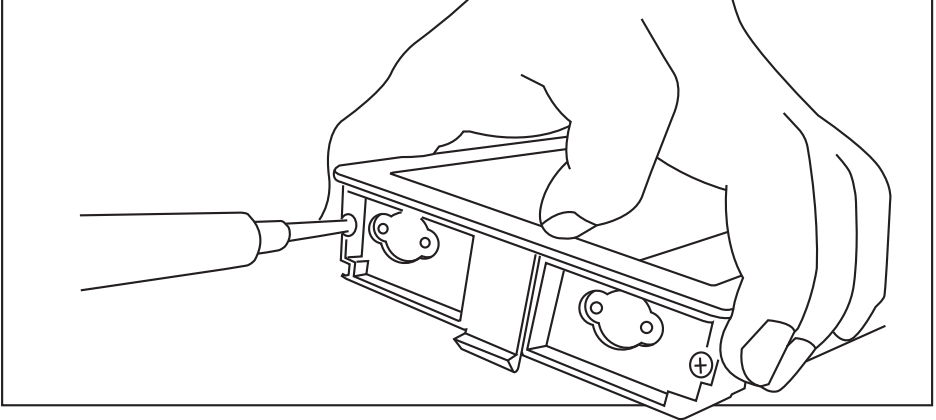

You will see two screws on the sides as illustrated in the image. Unscrew them to remove the side cover. Once you have done this on both sides, you will be able to slide the components out.

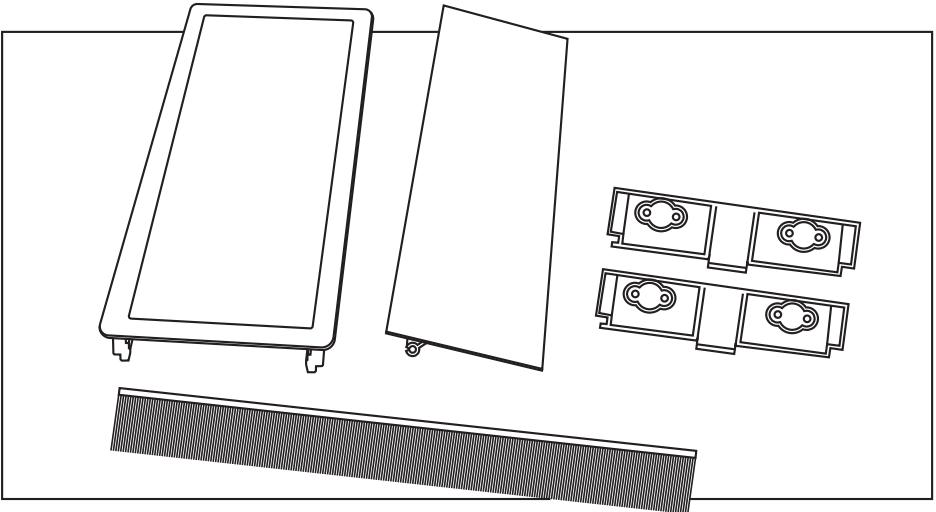

Diagram of the product completely disassembled. To reassemble, simply slide the parts back inside, place both side covers to secure all the pieces, and finally screw them in place.

Need help!

Call us on **1300 527 665**

www.jasonl.com.au

2 of 2