

ASSEMBLY INSTRUCTIONS

Blackjack Executive Office Desk

www.jasonl.com.au

Need help!

Call us on
1300 527 665

jason.l
your office furniture mate

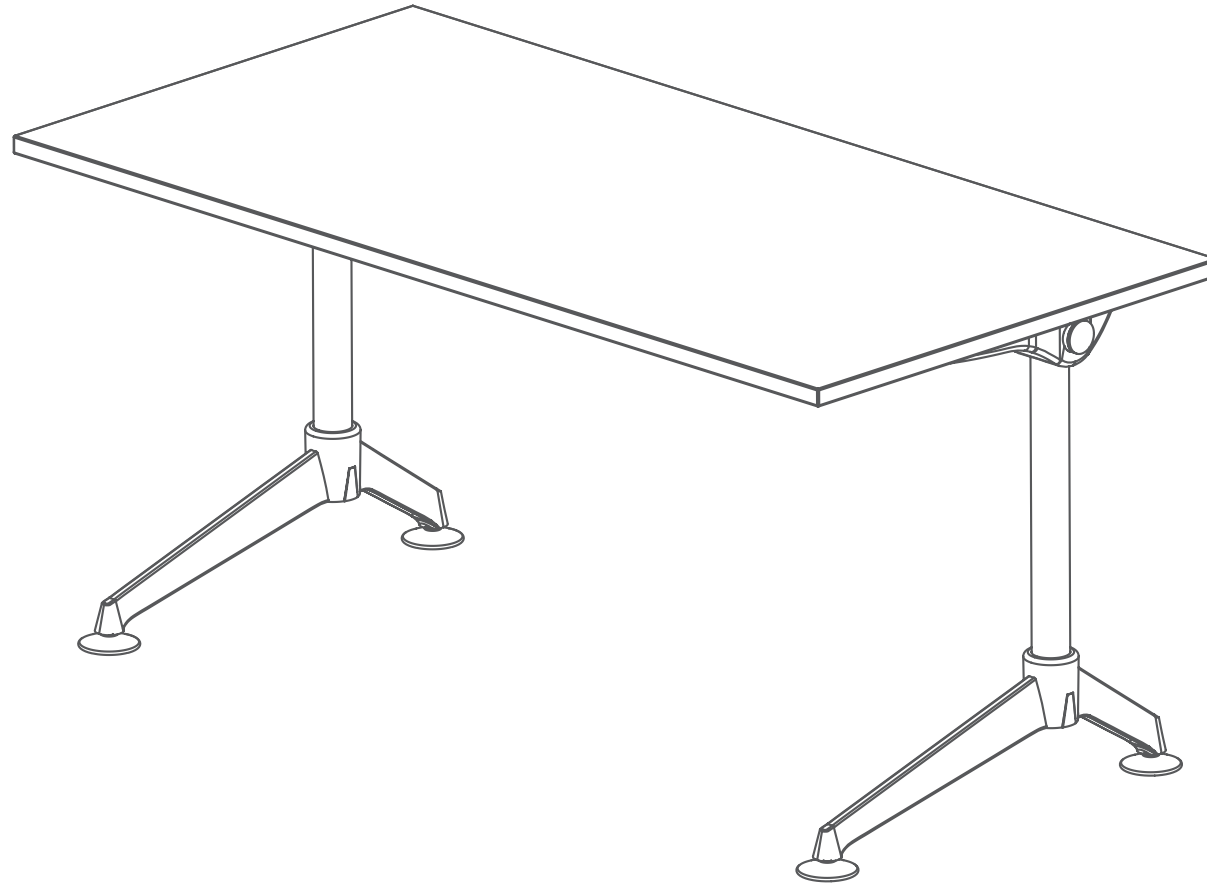

Special Note: No pre-drilled holes or nut inserts are provided.
Wood screws will be required to be drilled directly into underside of desk top.

 2 persons required for installation **Tools Required:** Power screwdriver.

Blackjack Executive Office Desk

Need help!

Call us on
1300 527 665

jason.l
your office furniture mate



Components		QTY
1	Die Cast Upper Wrist	x2
2	Top Rail	x1
3	Leg-pole Tube Ø51	x2
4	Top Rail Cap	x2
5	Large Foot	x2
6	Small Foot	x2
7	Cross Connector	x2
8	Gasket	x2
9	Collar Plug	x4
10	Foot Glide	x4

Screws		QTY
11	M10 x 30mm	x2
12	M8 x 25mm	x4
13	M5 x 30mm Self Tapping	x4
14	M8 x 16mm Grub Screw	x4
15	M10 x 110mm	x2
16	M8 x 16mm	x4

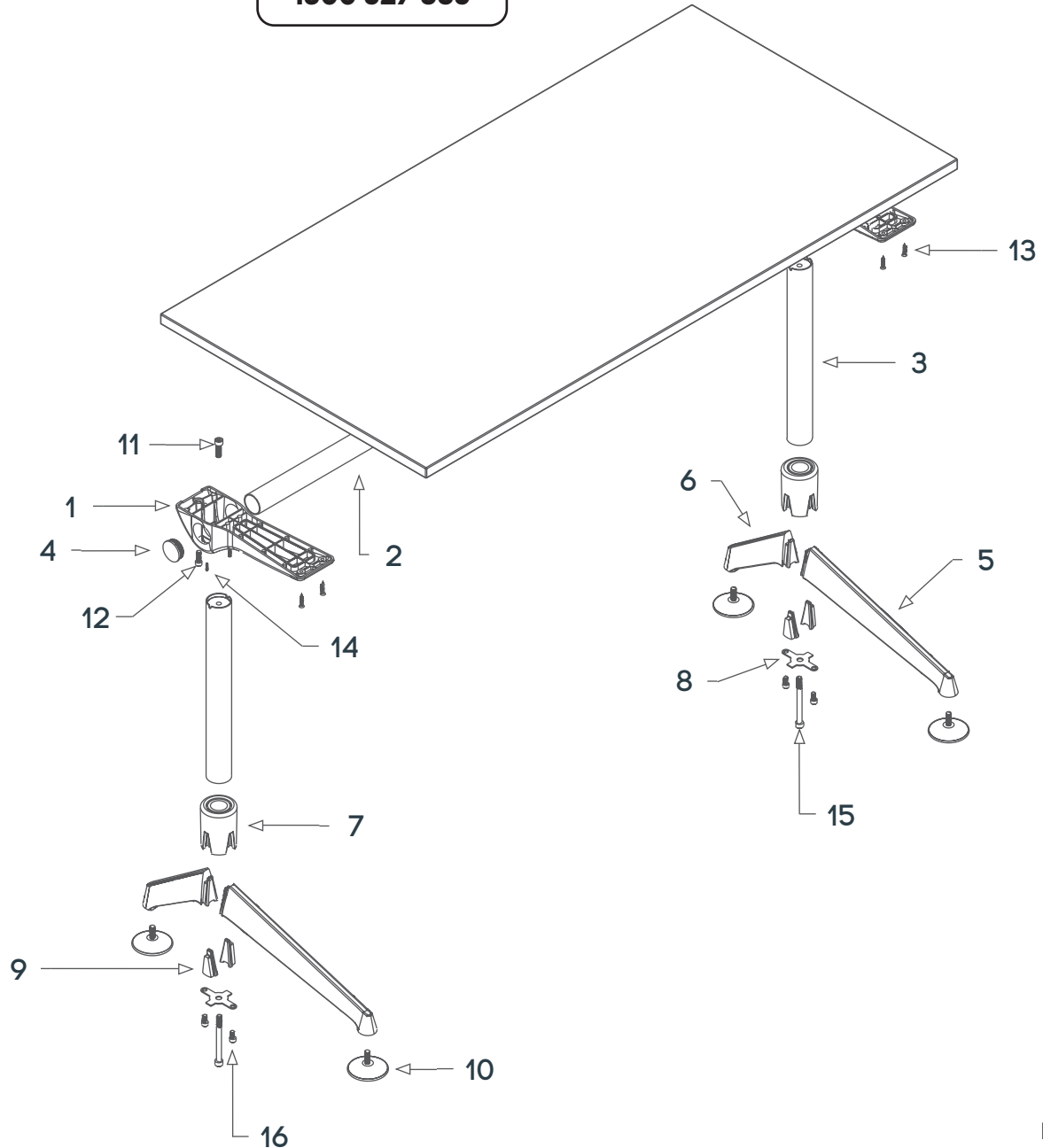

Blackjack Executive Office Desk

Need help!

Call us on
1300 527 665

jason.l
your office furniture mate



Step 1

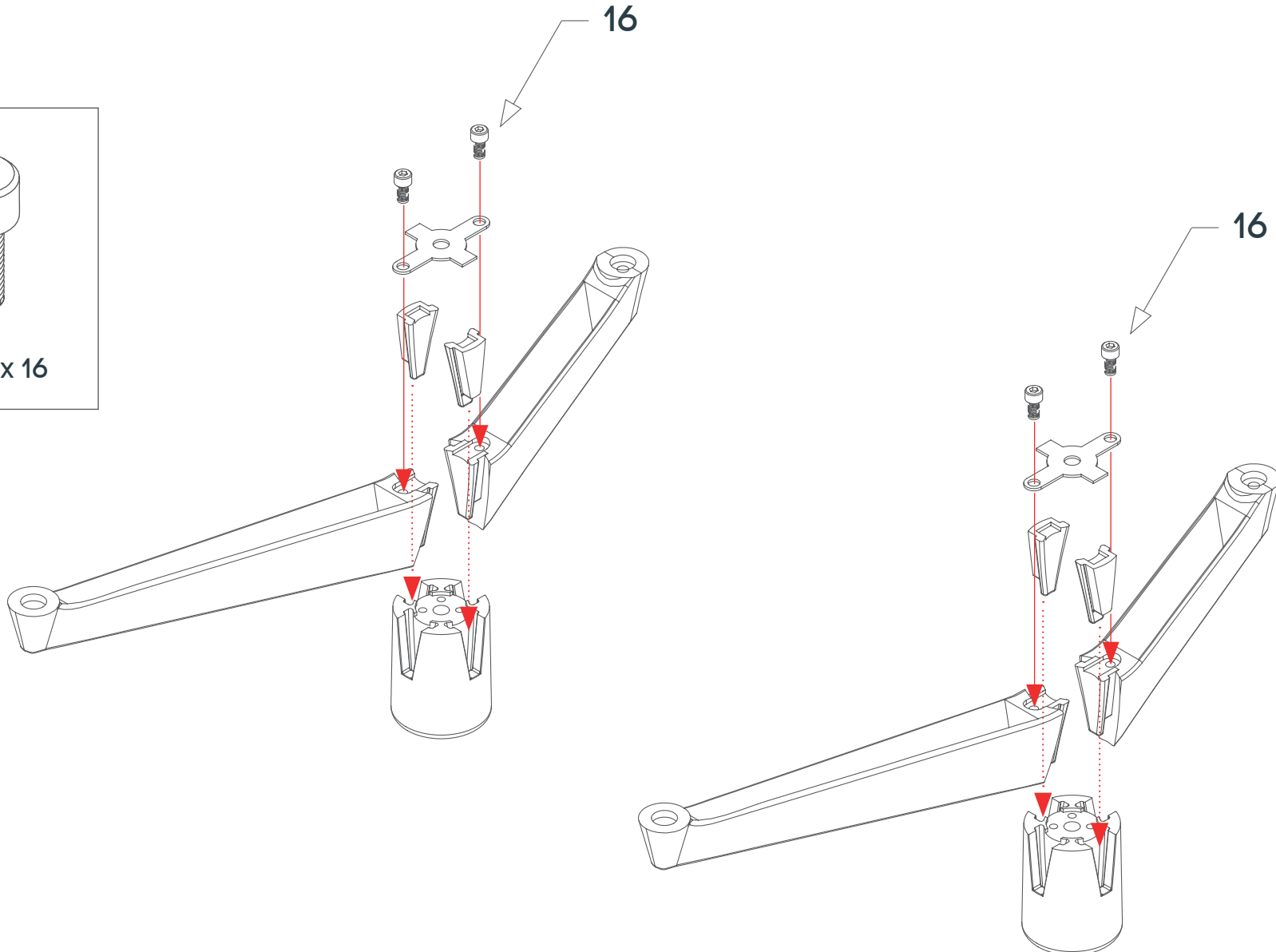
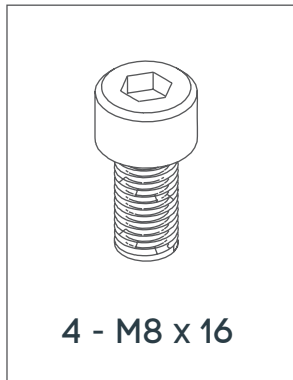

ASSEMBLY INSTRUCTIONS

Blackjack Executive Office Desk

www.jasonl.com.au

Need help!

Call us on
1300 527 665

jason.l
your office furniture mate



Step 2

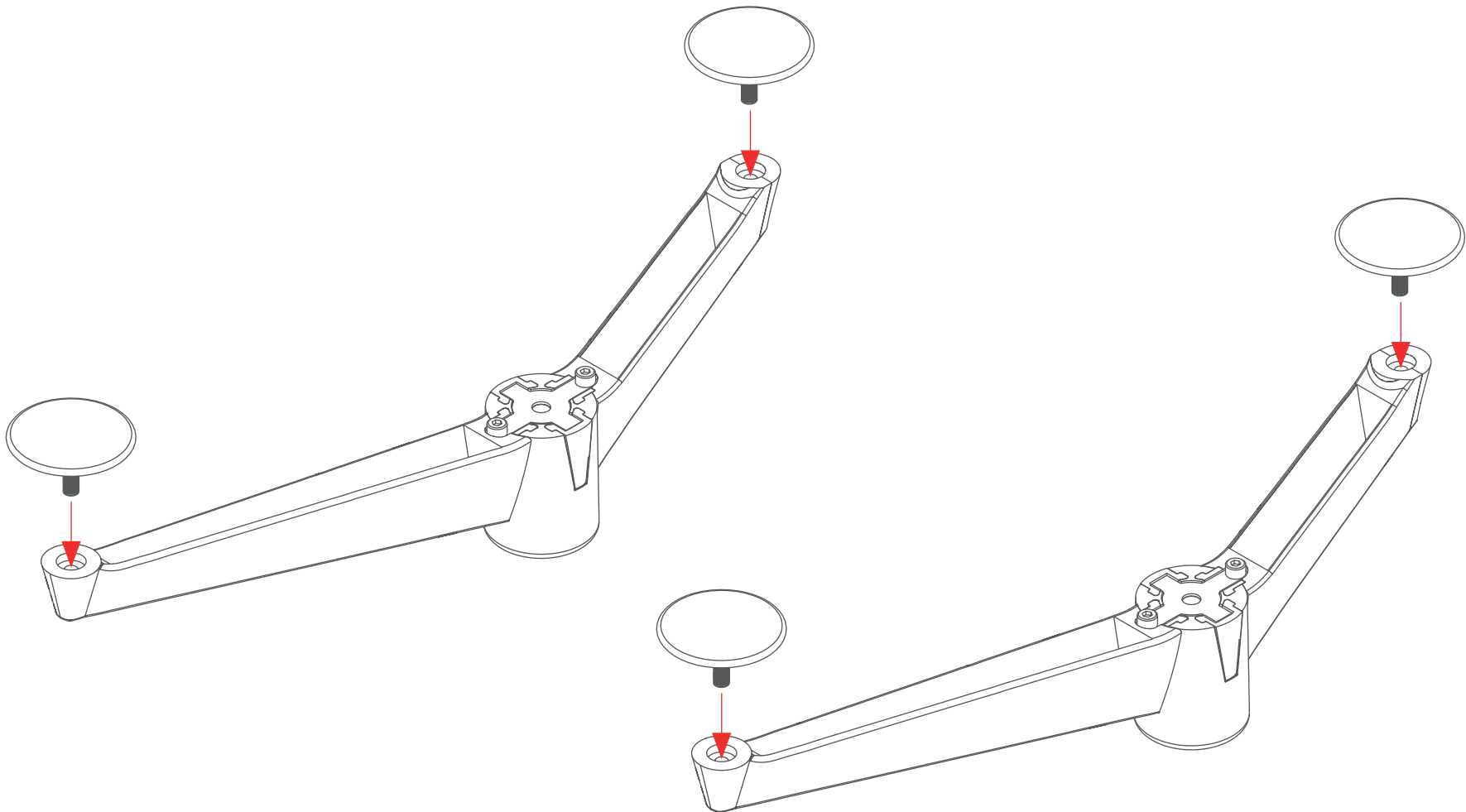

Blackjack Executive Office Desk

Need help!
Call us on
1300 527 665



Step 3

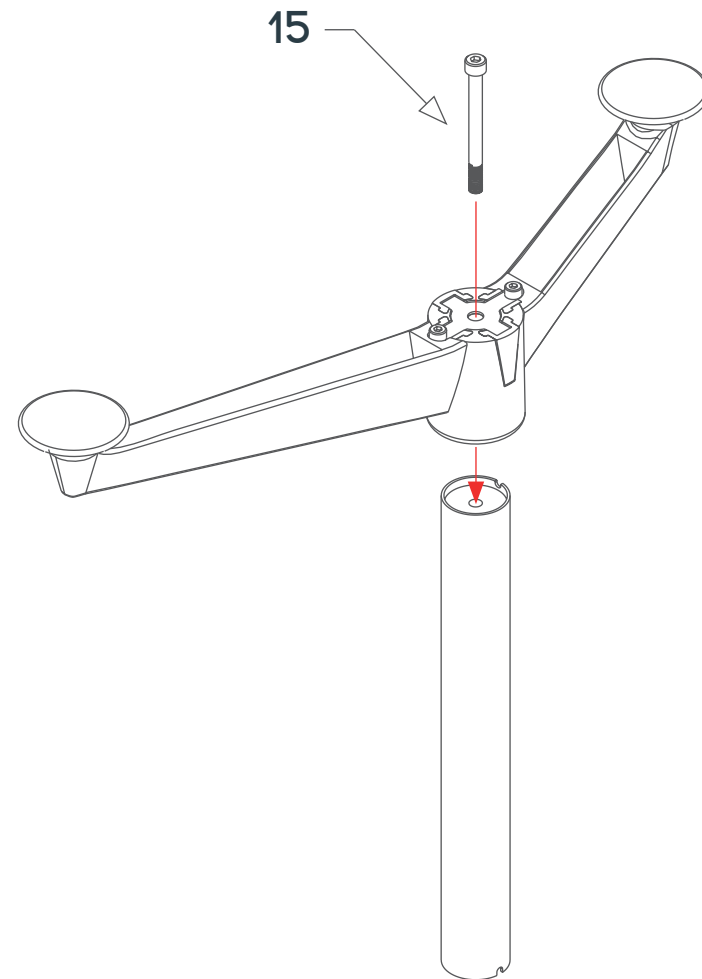
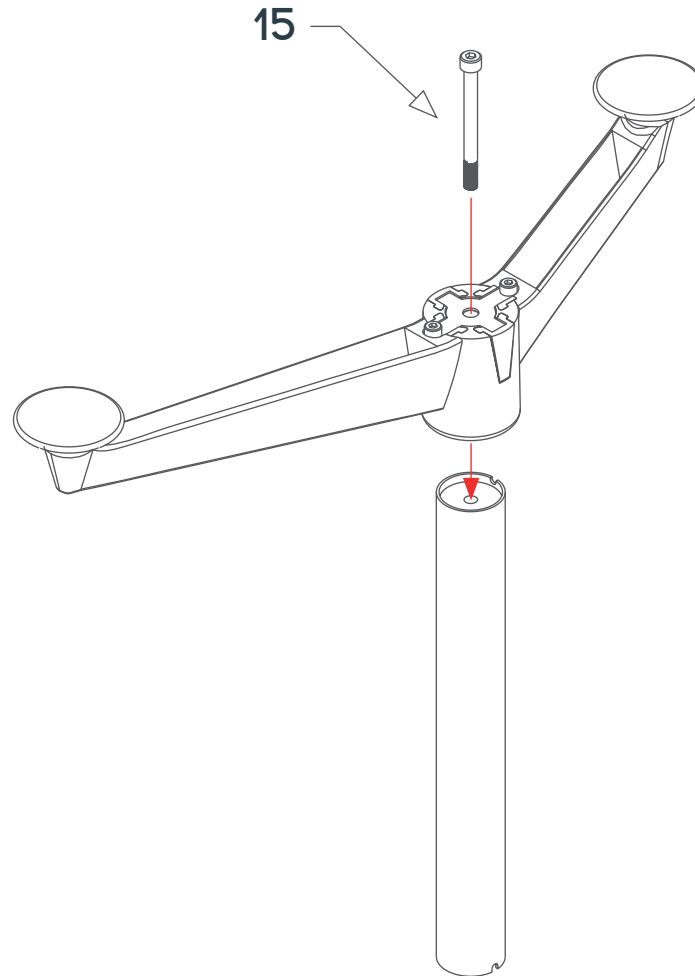
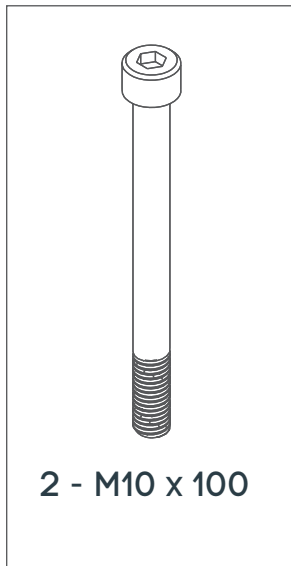

Blackjack Executive Office Desk

Need help!
Call us on
1300 527 665



Step 4

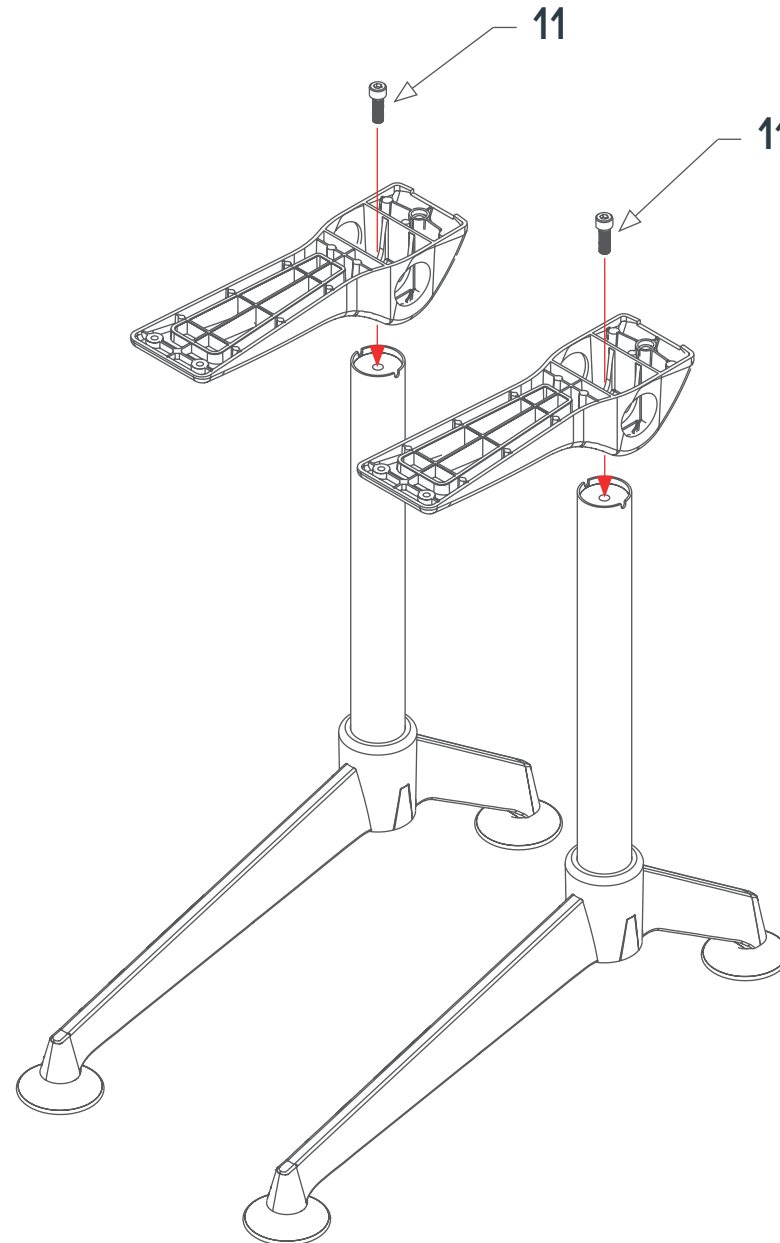
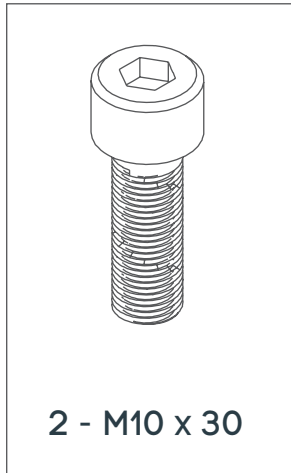

Blackjack Executive Office Desk

Need help!

Call us on
1300 527 665

jason.l
your office furniture mate



Step 5

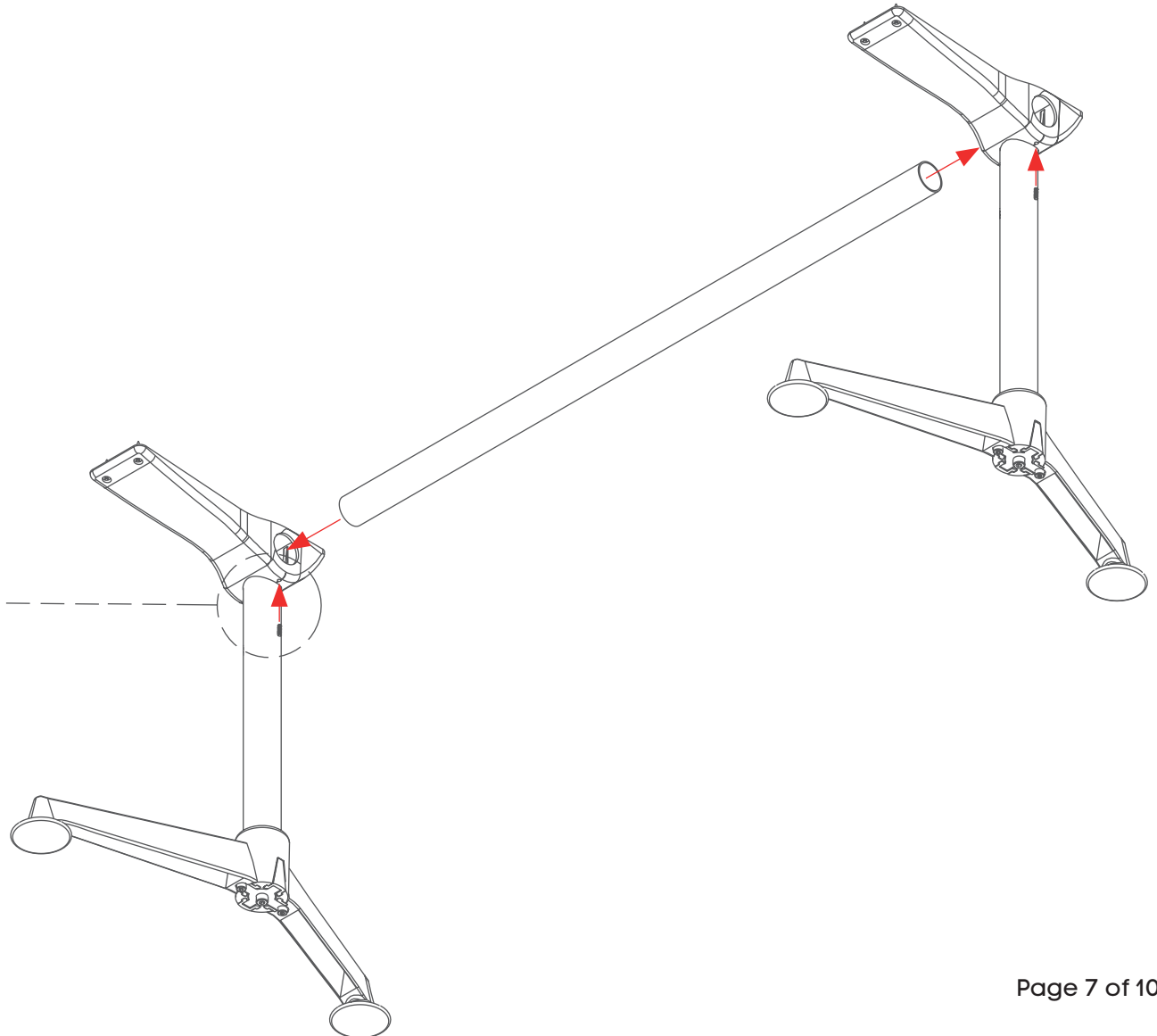
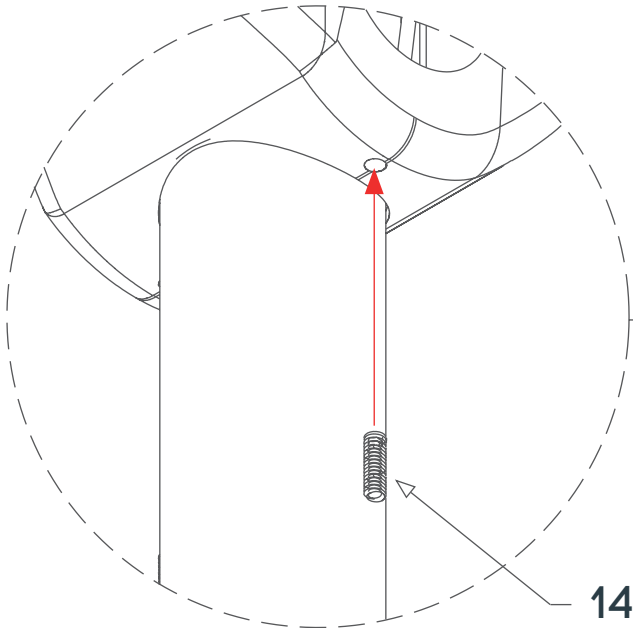
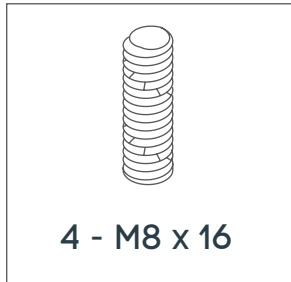

ASSEMBLY INSTRUCTIONS

Blackjack Executive Office Desk

www.jasonl.com.au

Need help!

Call us on
1300 527 665

jason.l
your office furniture mate



Step 6

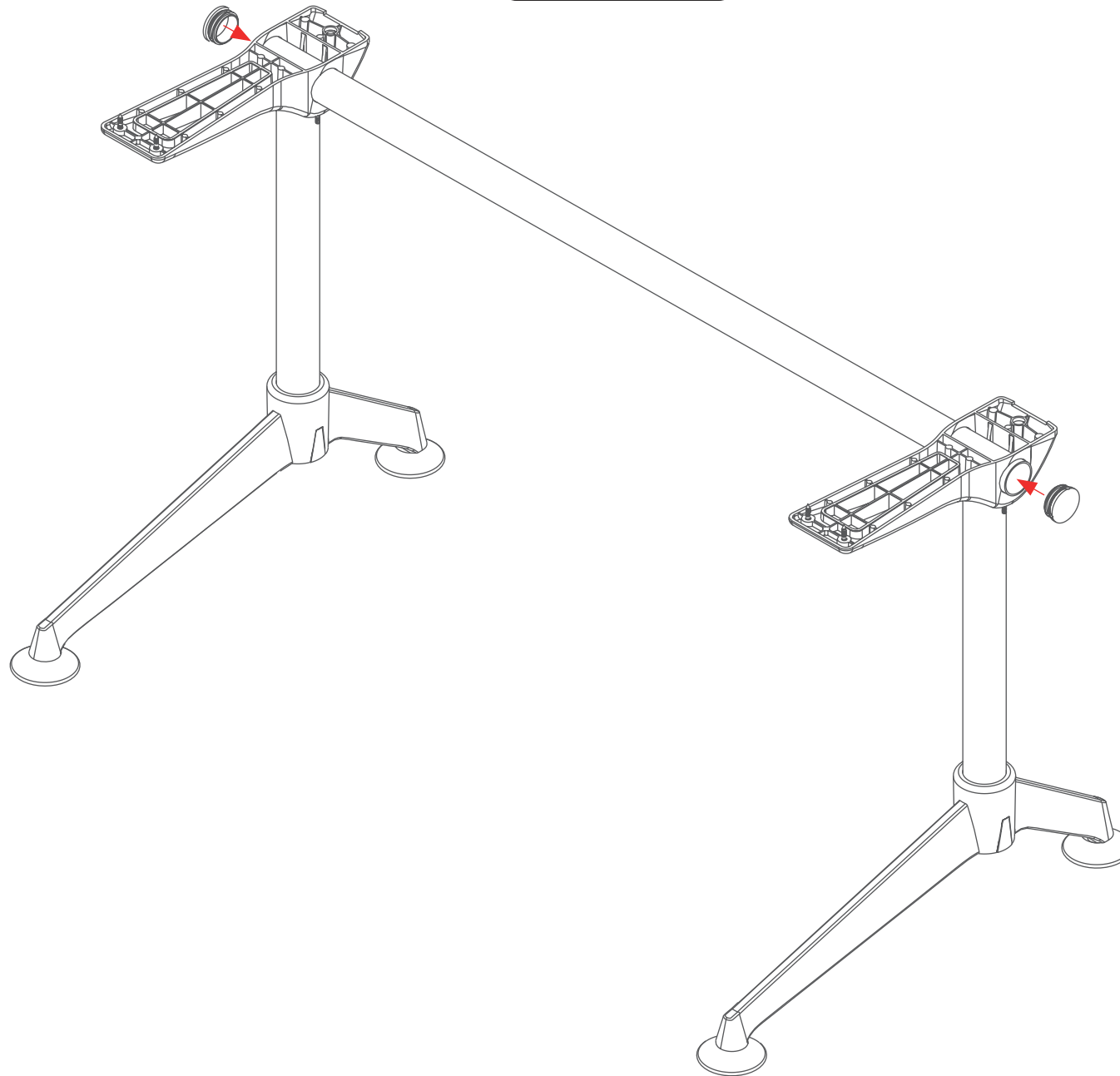

Blackjack Executive Office Desk

Need help!
Call us on
1300 527 665



Step 7

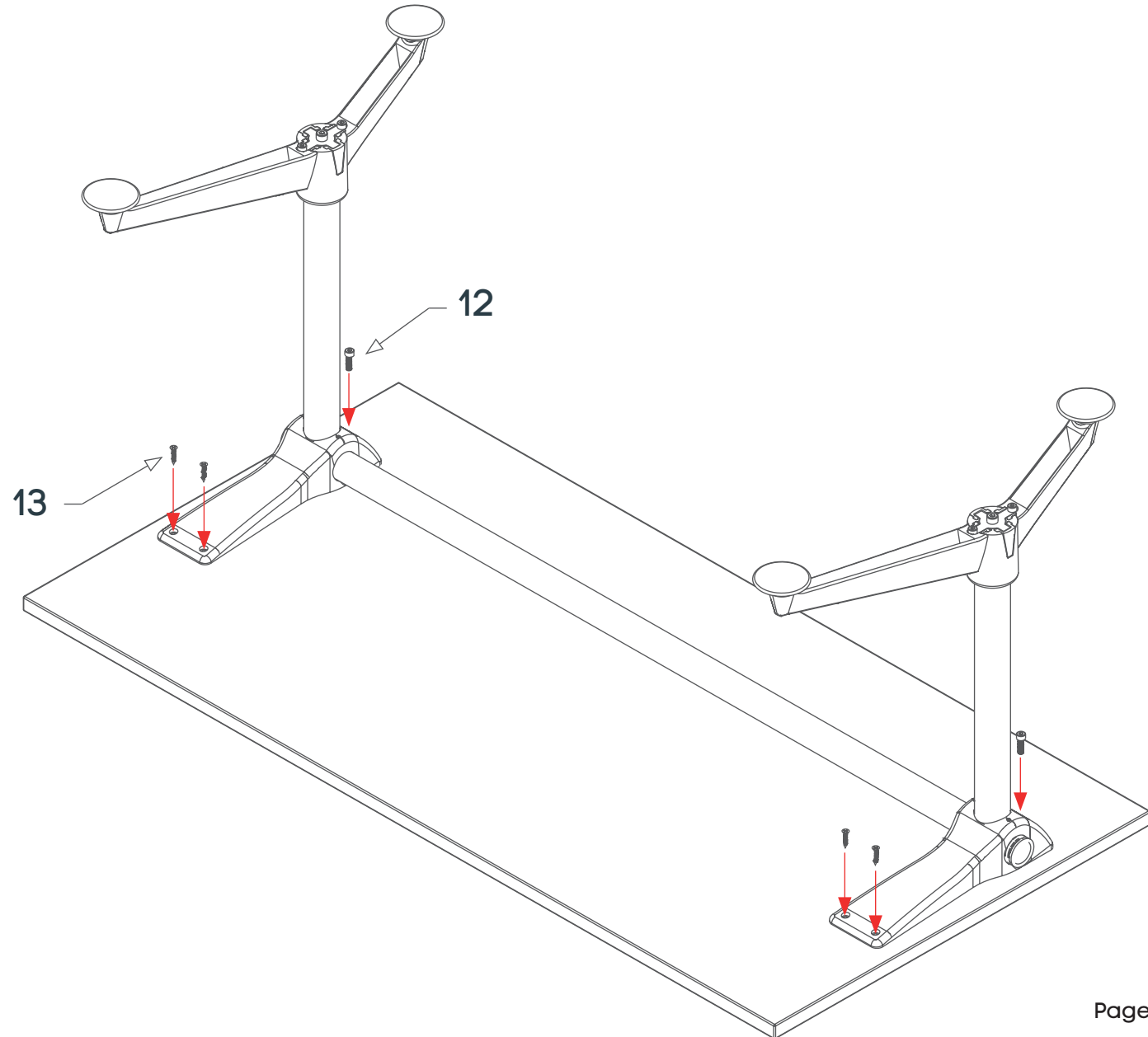
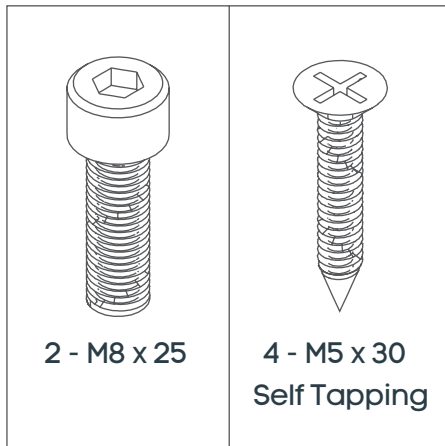

Blackjack Executive Office Desk

www.jasonl.com.au

Need help!

Call us on
1300 527 665

jason.l
your office furniture mate

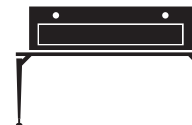

**Assembly
completed**

