



TRANSACTION TYPE:

Order Quote

Date _____ Account # _____ P.O. # _____

Company Name _____ Phone # _____

Address _____ City _____ State _____ Post Code _____ Country _____

Contact Name _____ Comments _____

Code	Description	Price
<input type="radio"/> DKA 0067	Küschall K Series	
<input type="radio"/> DKA 0000	MYKüschall special construction	Complete all information at end of script
SEATING CHOICE		
FRAME MATERIAL / ANGLE / TYPE		
<input type="radio"/> DKA 1040	Frame angle 75° to the ground, Aluminium	Not with SD 47.5-52.5cm
<input type="radio"/> DKA 1050	Frame angle 75° to the ground, Aluminium, tapered front frame	Not with SD 47.5-52.5cm or FSTF 45-47cm
<input type="radio"/> DKA 1060	Frame angle 75° to the ground, Aluminium +5cm	Not with SD ≤ 40cm or FSTF 45-49cm
<input type="radio"/> DKA 1070	Frame angle 90° to the ground, Aluminium	Not with SD 47.5-52.5cm or 5" cstrs
<input type="radio"/> DKA 1080	Frame angle 90° to the ground, Aluminium, tapered front frame	Not with SD 47.5-52.5cm, FSTF 45-47cm or 5" cstrs
<input type="radio"/> DKA 1090	Frame angle 90° to the ground, Aluminium +5cm	Not with SD ≤ 40cm, FSTF 45-49cm or 5" cstrs
SUSPENSION		
<input type="radio"/> DKA 1200	User weight 40-65kg	Only for SW 34-36cm; Not with SD 35cm
<input type="radio"/> DKA 1210	User weight 65-85kg	Only for SW 34-36cm; Not with SD 35cm
<input type="radio"/> DKA 1220	User weight 85-100kg	Only for SW 34-36cm; Not with SD 35cm
SEAT WIDTH (SW)		
<input type="radio"/> DKA 1310	32cm	Not with titanium back, tens-adj/light seat upholstery
<input type="radio"/> DKA 1315	34cm	
<input type="radio"/> DKA 1320	36cm	
<input type="radio"/> DKA 1325	38cm	
<input type="radio"/> DKA 1330	40cm	
<input type="radio"/> DKA 1335	42cm	
<input type="radio"/> DKA 1340	44cm	Not with light seat/back upholstery
<input type="radio"/> DKA 1345	46cm	Not with light seat/back upholstery
<input type="radio"/> DKA 1350	48cm	Not with light seat/back upholstery or titanium footrest
<input type="radio"/> DKA 1355	50cm	Not with light seat/back upholstery or titanium/flip-up footrests
SEAT DEPTH (SD)		
<input type="radio"/> DKA 1410	35cm	Not with +5cm frame, seat positions 1-2, light seat upholstery
<input type="radio"/> DKA 1420	37.5cm	Not with +5cm frame
<input type="radio"/> DKA 1435	40cm	Not with +5cm frame
<input type="radio"/> DKA 1450	42.5cm	
<input type="radio"/> DKA 1465	45cm	Not with light seat upholstery
<input type="radio"/> DKA 1475	47.5cm	Only with +5cm frame; not with light seat upholstery
<input type="radio"/> DKA 1490	50cm	Only with +5cm frame; not with light seat upholstery
<input type="radio"/> DKA 1495	52.5cm	Only with +5cm frame; not with light/tens-adj seat upholstery
SEAT POSITION (SP)		
<input type="radio"/> DKA 1500	Position 1 (140mm)	Most active position; Not with suspension or SD 35cm
<input type="radio"/> DKA 1510	Position 2 (125mm)	Not with SD 35cm
<input type="radio"/> DKA 1520	Position 3 (110mm)	Not with suspension
<input type="radio"/> DKA 1530	Position 4 (95mm)	
<input type="radio"/> DKA 1540	Position 5 (80mm)	Least active position; Not with suspension
BACK HEIGHT (BH)		
<input type="radio"/> DKA 1605	27cm	Not with height-adj rear-set push handles; tubular armrests only with std push handles or none
<input type="radio"/> DKA 1610	28.5cm	Tubular armrests only with std push handles or none
<input type="radio"/> DKA 1615	30cm	Tubular armrests only with std push handles or none
<input type="radio"/> DKA 1620	31.5cm	
<input type="radio"/> DKA 1625	33cm	
<input type="radio"/> DKA 1630	34.5cm	
<input type="radio"/> DKA 1635	36cm	Not with light back upholstery
<input type="radio"/> DKA 1640	37.5cm	Not with light back upholstery
<input type="radio"/> DKA 1645	39cm	Not with light back upholstery
<input type="radio"/> DKA 1650	40.5cm	Not with light back upholstery
<input type="radio"/> DKA 1655	42cm	Not with light back upholstery
<input type="radio"/> DKA 1660	43.5cm	Not with light back upholstery
<input type="radio"/> DKA 1665	45cm	Not with light back upholstery
<input type="radio"/> DKA 1670	46.5cm	Not with light back upholstery
<input type="radio"/> DKA 1675	48cm	Not with light back upholstery

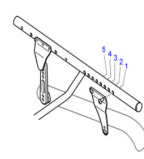

NOTE: All specifications and dimensions are approximate.
For the most current information, go to www.invacare.com.au

Küschall® K-Series

FRONT SEAT-TO-FLOOR-HEIGHT (FSTF)		
<input type="radio"/>	DKA 1740	45cm <i>Not with tapered frame or 5" casters</i>
<input type="radio"/>	DKA 1745	46cm <i>Not with tapered frame or 5" casters</i>
<input type="radio"/>	DKA 1750	47cm <i>Not with tapered frame or 5" casters</i>
<input type="radio"/>	DKA 1755	48cm
<input type="radio"/>	DKA 1760	49cm
<input type="radio"/>	DKA 1765	50cm
<input type="radio"/>	DKA 1770	51cm
<input type="radio"/>	DKA 1775	52cm
REAR SEAT-TO-FLOOR-HEIGHT (RSTF)		
<input type="radio"/>	DKA 1815	39cm <i>Not with 26" rear wheels, rear wheel extensions or siderests.</i>
<input type="radio"/>	DKA 1820	40cm <i>Not with rear wheel extensions or siderests.</i>
<input type="radio"/>	DKA 1825	41cm <i>Not with siderests.</i>
<input type="radio"/>	DKA 1830	42cm
<input type="radio"/>	DKA 1835	43cm
<input type="radio"/>	DKA 1840	44cm
<input type="radio"/>	DKA 1845	45cm
<input type="radio"/>	DKA 1850	46cm
<input type="radio"/>	DKA 1855	47cm
<input type="radio"/>	DKA 1860	48cm
<input type="radio"/>	DKA 1865	49cm
KNEE-TO-HEEL LENGTH (LLL) <i>For LLL < 39cm footplate may be high mounted. 75°: LLL ≤ FSTF -3cm; 90°: LLL ≤ FSTF -4cm</i>		
<input type="radio"/>	DKA 1918	29cm
<input type="radio"/>	DKA 1920	30cm
<input type="radio"/>	DKA 1922	31cm
<input type="radio"/>	DKA 1924	32cm
<input type="radio"/>	DKA 1926	33cm
<input type="radio"/>	DKA 1928	34cm
<input type="radio"/>	DKA 1930	35cm
<input type="radio"/>	DKA 1932	36cm
<input type="radio"/>	DKA 1934	37cm
<input type="radio"/>	DKA 1936	38cm
<input type="radio"/>	DKA 1938	39cm
<input type="radio"/>	DKA 1940	40cm
<input type="radio"/>	DKA 1942	41cm
<input type="radio"/>	DKA 1944	42cm
<input type="radio"/>	DKA 1946	43cm
<input type="radio"/>	DKA 1948	44cm
<input type="radio"/>	DKA 1950	45cm
<input type="radio"/>	DKA 1952	46cm
<input type="radio"/>	DKA 1954	47cm
<input type="radio"/>	DKA 1956	48cm
BACKREST		
BACKREST MATERIAL		
<input type="radio"/>	DKA 2000	Aluminium
<input type="radio"/>	DKA 2050	Titanium <i>Not with height-adj rear-set push handles or transportation kit</i>
BACKREST TYPE		
<input type="radio"/>	DKA 2100	Standard backrest w/backbrace
BACK UPHOLSTERY		
<input type="radio"/>	DKA 2210	Light back <i>Not with height-adj rear-set push handles, SW > 42cm or BH > 34.5cm</i>
<input type="radio"/>	DKA 2220	Tension adjustable back, premium black
<input type="radio"/>	DKA 2230	Tension adjustable back, Aero
PUSH HANDLES		
<input type="radio"/>	DKA 2400	Without push handles
<input type="radio"/>	DKA 2410	Push handles fixed, short
<input type="radio"/>	DKA 2420	Push handles fixed, long
<input type="radio"/>	DKA 2430	Height-adjustable rear set <i>Not with BH 27cm, BH 28.5-33cm with tubular armrests or light back</i>
<input type="radio"/>	DKA 2450	Foldable push handles <i>Not with BH 28.5-33cm with tubular armrests</i>
BACKREST ANGLE (BA)		
<input type="radio"/>	DKA 2500	74° angle from the seat
<input type="radio"/>	DKA 2520	78° angle from the seat
<input type="radio"/>	DKA 2540	82° angle from the seat
<input type="radio"/>	DKA 2560	86° angle from the seat
<input type="radio"/>	DKA 2580	90° angle from the seat
<input type="radio"/>	DKA 2590	94° angle from the seat

NOTE: All specifications and dimensions are approximate.
For the most current information, go to www.invacare.com.au

Küschall® K-Series

SEATING			
SEAT UPHOLSTERY			
<input type="radio"/>	DKA 2600	Standard	
<input type="radio"/>	DKA 2630	Light seat upholstery	<i>Not with SW > 42cm, SD > 42.5cm</i>
<input type="radio"/>	DKA 2610	Tension adjustable with 1 central velcro band (soft)	<i>Not with SD 52.5cm</i>
SEAT CUSHION			
<input type="radio"/>	DKA 2700	Standard seat cushion, 60mm, double foam with visco top	<input type="radio"/> CLEAR
<input type="radio"/>		Matrix PS Cushion	<i>Not all seat sizes available. Refer to Seating Catalogue</i>
<input type="radio"/>		Matrix PSP Cushion	<i>Not all seat sizes available. Refer to Seating Catalogue</i>
<input type="radio"/>		Matrix VI Cushion	<i>Not all seat sizes available. Refer to Seating Catalogue</i>
<input type="radio"/>		Matrix Libra Cushion	<i>Not all seat sizes available. Refer to Seating Catalogue</i>
SEAT BAGS			
<input type="radio"/>	DKA 2800	Seat bag, click in and removable	
<input type="radio"/>	DKA 2910	Seat upholstery bag	<i>To fix under the seat</i>
FOOTREST			
FOOTREST TYPE (TUBE/PLATE)			
<input type="radio"/>	DKA 3200	Footrest tube, rigid - Aluminium hydroformed	
<input type="radio"/>	DKA 3210	Footrest tube, rigid - Titanium	
<input type="radio"/>	DKA 3220	Carbon footplate, angle adjustable	
<input type="radio"/>	DKA 3230	Footplate, flip-up to side, angle adjustable	<i>Not with high mounted footrest, tapered frame or SW 48cm</i>
FOOTREST COVER			
<input type="radio"/>	DKA 3290	Footrest cover	<i>Not with carbon/flip-up footplate</i>
SIDE GUARDS			
SIDE GUARDS			
<input type="radio"/>	DKA 3420	Clothes guards carbon, flip back	
<input type="radio"/>	DKA 3440	Mudguards carbon, removable	<i>Not with siderests</i>
SIDERESTS			
<input type="radio"/>	DKA 3490	Siderest height adjustable, short, non-locking	<i>Not with mudguards or for RSTF < 42 cm</i>
<input type="radio"/>	DKA 3495	Siderest height adjustable, long, non-locking	<i>Not with mudguards or for RSTF < 42 cm</i>
ARMRESTS <i>Not with foldable push handles in combination with BH < 31.5cm, height-adj rear-set push handles or Alber add-on kits</i>			
<input type="radio"/>	DKA 3480	Tubular armrests, height adjustable, removable, swing-away, comfort padded	
FRAME COLOUR & CUSTOMISATION			
FRAME COLOUR			
<input type="radio"/>	DKA 4000	Space Black	
<input type="radio"/>	DKA 4010	Anthracite Grey	
<input type="radio"/>	DKA 4020	Pure White	<i>Not with Light Grey Bold Styling</i>
<input type="radio"/>	DKA 4030	Carmine Red	
<input type="radio"/>	DKA 4040	Azure Blue	
<input type="radio"/>	DKA 4100	Black Glossy	<i>Extra lead time 10+ days. Tag styling only</i>
<input type="radio"/>	DKA 4110	Ferrite	<i>Extra lead time 10+ days. Tag styling only</i>
<input type="radio"/>	DKA 4120	Slate Metallic	<i>Extra lead time 10+ days. Tag styling only</i>
<input type="radio"/>	DKA 4130	Silver Grey	<i>Extra lead time 10+ days. Tag styling only</i>
<input type="radio"/>	DKA 4140	Royal Blue	<i>Extra lead time 10+ days. Tag styling only</i>
<input type="radio"/>	DKA 4150	Ruby Red	<i>Extra lead time 10+ days. Tag styling only</i>
<input type="radio"/>	DKA 4160	Smoky Grey	<i>Extra lead time 10+ days. Tag styling only</i>
<input type="radio"/>	DKA 4170	Dynamite Orange	<i>Extra lead time 10+ days. Tag styling only</i>
<input type="radio"/>	DKA 4180	Forest Green	<i>Extra lead time 10+ days. Tag styling only</i>
STYLING			
<input type="radio"/>	DKA 4190	Bold	
<input type="radio"/>	DKA 4195	Tag	
BOLD COLOUR			
<input type="radio"/>	DKA 4200	Black	
<input type="radio"/>	DKA 4210	Dark Grey	
<input type="radio"/>	DKA 4220	Light Grey	
<input type="radio"/>	DKA 4230	Red	
<input type="radio"/>	DKA 4240	Blue	
<input type="radio"/>	DKA 4250	Gold	
TAG COLOUR			
<input type="radio"/>	DKA 4300	Black	
<input type="radio"/>	DKA 4310	Red	

**NOTE: All specifications and dimensions are approximate.
For the most current information, go to www.invacare.com.au**

Küschall® K-Series

FRONT WHEEL			
FRONT WHEEL			
		<i>For configuration please also see tables at end of form</i>	
<input type="radio"/>	DKA 5000	3" Supersport	
<input type="radio"/>	DKA 5050	4" Everyday wheel, black	
<input type="radio"/>	DKA 5100	4" Comfort wheel, black	
<input type="radio"/>	DKA 5150	4" Starec, black	
<input type="radio"/>	DKA 5200	4" EPIC Softroll, black	
<input type="radio"/>	DKA 5250	4" EPIC Softroll, silver	
<input type="radio"/>	DKA 5300	5" Everyday wheel, black	
<input type="radio"/>	DKA 5350	5" Comfort wheel, black	
<input type="radio"/>	DKA 5400	5" Starec, black	
<input type="radio"/>	DKA 5450	5" EPIC Softroll, black	
<input type="radio"/>	DKA 5500	5" EPIC Softroll, silver	
REAR WHEELS			
REAR WHEEL FIXATION			
<input type="radio"/>	DKA 6020	Standard rear wheel position	
<input type="radio"/>	DKA 6030	Light rear wheel extension (positions 1-3)	<i>Not with carbon axle or RSTF < 41cm</i>
<input type="radio"/>	DKA 6040	Rear wheel extension (positions 1-5)	<i>Not with carbon axle or RSTF < 41cm</i>
CAMBER AXLE TYPE - 1st AXLE			
<input type="radio"/>	DKA 6050	Vario-Ax, adjustable camber 1 / 3 / 7 / 10°	<i>Not with Alber add-on kits, or performance brakes</i>
<input type="radio"/>	DKA 6060	Standard axle	
<input type="radio"/>	DKA 6070	Carbon axle	<i>Not with rear wheel extensions or Alber add-on kits</i>
POSITION OF 1st AXLE			
		<i>Only with rear wheel extensions</i>	
<input type="radio"/>	DKA 6100	1st position from front	<i>When 2nd axle selected, 1st axle must be in 1st position</i>
<input type="radio"/>	DKA 6110	2nd position from front	
<input type="radio"/>	DKA 6120	3rd position from front	
<input type="radio"/>	DKA 6130	4th position from front	
<input type="radio"/>	DKA 6140	5th position from front	
CAMBER ANGLE - 1st AXLE			
<input type="radio"/>	DKA 6200	Camber 0°	
<input type="radio"/>	DKA 6210	Camber 3°	
<input type="radio"/>	DKA 6220	Camber 6°	<i>Not with Alber add-on kits</i>
CAMBER AXLE TYPE - 2nd AXLE			
		<i>Only with rear wheel extension ; 2nd axle only in 5th position from front</i>	
<input type="radio"/>	DKA 6240	Vario-Ax, adjustable camber 1 / 3 / 7 / 10°	
<input type="radio"/>	DKA 6230	Standard axle	
CAMBER ANGLE - 2nd AXLE			
		<i>Max 3° difference with 1st axle; If 1st axle is Vario-Ax 2nd axle only in 0° or 3°</i>	
<input type="radio"/>	DKA 6250	Camber 0°	
<input type="radio"/>	DKA 6260	Camber 3°	
<input type="radio"/>	DKA 6270	Camber 6°	<i>Not with Alber add-on kits</i>
QUAD QUICK RELEASE AXLE			
<input type="radio"/>	DKA 6300	Tetra Clip axle	<i>Not with Spinergy LXX</i>
REAR WHEEL SIZE			
<input type="radio"/>	DKA 6410	24"	
<input type="radio"/>	DKA 6420	25"	<i>Not with suspension, Starec wheels or spoke guards</i>
<input type="radio"/>	DKA 6430	26"	<i>Not with suspension or active brakes</i>
REAR WHEEL TYPE			
<input type="radio"/>	DKA 6510	24", 26" Küschall Starec, cross spoked	<i>Colourless Starec hub, black rim</i>
<input type="radio"/>	DKA 6520	24", 25" High Performance	<i>Black hub & rim; Not with solid tyres</i>
<input type="radio"/>	DKA 6550	24", 25" Spinergy LXX	<i>Hub, rim & spokes black; Not with solid tyres</i>
REAR WHEEL TYRE			
<input type="radio"/>	DKA 6600	24", 25", 26" Schwalbe Rightrun black/grey	
<input type="radio"/>	DKA 6640	24" Profile tyre 7 bar	
<input type="radio"/>	DKA 6620	24", 25", 26" Schwalbe Marathon Plus	<i>SmartGuard puncture protected</i>
<input type="radio"/>	DKA 6650	24" Solid tyre, profile, grey	<i>Not with High Perf or Spinergy LXX</i>
<input type="radio"/>	DKA 6660	24" Solid tyre (KIK type), black	<i>Not with High Perf or Spinergy LXX</i>
<input type="radio"/>	DKA 6630	24", 25" Schwalbe ONE	<i>V-Guard puncture resistant</i>
<input type="radio"/>	DKA 6610	24", Schwalbe Rightrun blue	<i>K-Guard puncture resistant</i>
<input type="radio"/>	DKA 6670	24" Solid light wheel	<i>Not with High Perf or Spinergy LXX</i>
ANTI FLAT			
<input type="radio"/>	DKA 6680	Anti-flat tyre tube protection	<i>Not with Marathon Plus or solid tyres</i>

NOTE: All specifications and dimensions are approximate.
For the most current information, go to www.invacare.com.au

Küschall® K-Series

HANDRIM			
<input type="radio"/>	DKA 6780	24", 25", 26" Light Alu, grey, dist 3cm	Short tabs with one hole at 3cm
<input type="radio"/>	DKA 6800	24", 25", 26" Light Alu, grey, dist 4cm	Long tabs with two holes at 3cm or 4cm, mounted at 4cm
<input type="radio"/>	DKA 6790	24", 25", 26" Light Alu, black, dist 3cm	Short tabs with one hole at 3cm
<input type="radio"/>	DKA 6700	24", 26" Supergrripp, dist 3cm	Long tabs with two holes at 3cm or 4cm, mounted at 3cm
<input type="radio"/>	DKA 6710	24", 26" Steel polished, dist 3cm	Short tabs with one hole at 3cm
<input type="radio"/>	DKA 6720	24" Titanium, dist 3cm	Short tabs with one hole at 3cm
<input type="radio"/>	DKA 6730	24" Titanium, dist 4cm	Long tabs with two holes at 3cm or 4cm, mounted at 4cm
<input type="radio"/>	DKA 6740	24" Carbolife Gekko, dist 3cm	Long tabs with two holes at 3cm or 4cm, mounted at 3cm
<input type="radio"/>	DKA 6750	24" Carbolife Gekko S, dist 3cm	Long tabs with two holes at 3cm or 4cm, mounted at 3cm
<input type="radio"/>	DKA 6760	24" Carbolife Curve L, dist 3cm	Long tabs with two holes at 3cm or 4cm, mounted at 3cm
<input type="radio"/>	DKA 6770	24" Carbolife Quadro, dist 3cm	Long tabs with two holes at 3cm or 4cm, mounted at 3cm
SPOKE GUARDS			<input type="radio"/> CLEAR
<input type="radio"/>	DKA 6900	24", 26" Transparent	Not with Spinergy LXX
<input type="radio"/>	DKA 6910	24", 26" Black	Not with Spinergy LXX
ALBER ADD ON KIT			
<input type="radio"/>	DKA 6950	E-Motion & Twion adapter plate	Only with 24" wheels and 0° camber. Includes 2 Alber antitippers
SAFETY			
BRAKES			
<input type="radio"/>	DKA 7210	Push brake, bent lever	
<input type="radio"/>	DKA 7230	Performance brake	
<input type="radio"/>	DKA 7240	Active scissor brake	
<input type="radio"/>	DKA 7250	Light Active brake	
BRAKE EXTENSION LEVER			
<input type="radio"/>	DKA 7300	Brake extension lever	Only for push brakes
ANTITIPPER Max 2x Adaptions per side (Antitipper, Tipper Aid, Cane Holder, Transit Wheels)			
<input type="radio"/>	DKA 7500	Antitipper right	
<input type="radio"/>	DKA 7510	Antitipper left	
<input type="radio"/>	DKA 7520	Antitipper both sides	
TRANSPORTATION KIT			
<input type="radio"/>	DKA 7600	Transportation kit inc seat belt and labels	Only with backrest height > 40cm
SEAT BELT			
<input type="radio"/>	DKA 7800	Seat belt	Included with transportation kit
PASSIVE LIGHTS (REFLECTORS)			
<input type="radio"/>	DKA 7900	Passive lights assembled (mounted on spokes)	
<input type="radio"/>	DKA 7910	Passive lights enclosed	
ACCESSORIES			
FRAME PROTECTION			
<input type="radio"/>	DKA 8010	Front Frame Protectors, pair	Removable
CANE HOLDER Max 2x Adaptions per side (Antitipper, Tipper Aid, Cane Holder, Transit Wheels)			
<input type="radio"/>	DKA 8200	Cane holder, right	Not with Alber Add-ons
<input type="radio"/>	DKA 8210	Cane holder, left	Not with Alber Add-ons
TRANSIT WHEELS 3" Max 2x Adaptions per side (Antitipper, Tipper Aid, Cane Holder, Transit Wheels)			
<input type="radio"/>	DKA 8300	Transit wheels 3"	Not with Alber add-on kits
AIR PUMP			
<input type="radio"/>	DKA 8500	Air pump	
TOOL KITS			
<input type="radio"/>	DKA 8550	Tool kit	
<input type="radio"/>	DKA 8600	Rear height adjustment set	
WHEEL BAG AND WHEEL KITS			
<input type="radio"/>	DKA 8680	24" Mountain bike wheels with bag	Mountain bike wheels and tyres with alu grey handrims

**NOTE: All specifications and dimensions are approximate.
For the most current information, go to www.invacare.com.au**

Küschall® K-Series

SUPPORT FOR MEASUREMENTS / MYKÜSCHALL REQUESTS

	CUSTOMIZED MEASUREMENTS	
	SW	
	SD	
	BH	
	FSTF	
	RSTF	
	LLL	
	BA	
	CAMBER	
	USER WEIGHT	
	USER SIZE	

FRAME TYPE/ANGLE/LENGTH, REAR WHEEL SIZE, LOWER LEG LENGTH, FSTF, FOOTREST TYPE

Frame	24" REAR WHEEL				25" REAR WHEEL				26" REAR WHEEL			
	FSTF	Brkt	LLL range for std mounting		FSTF	Brkt	LLL range for std mounting		FSTF	Brkt	LLL range for std mounting	
			Footube / Adj footplate	Flip-up Footplate			Footube / Adj footplate	Flip-up Footplate			Footube / Adj footplate	Flip-up Footplate
Aluminium												
75° Short	45	S	33-42	29-42	46	S	33-43	29-43	47	S	33-44	29-44
	46	S	34-43	30-43	47	S	34-44	30-44	48	S	34-45	30-45
	47	S	35-44	31-44	48	L	35-45	31-45	49	L	35-46	31-46
75° Std	48	S	37-45	33-45	49	S	37-46	33-46	50	S	37-47	33-47
	49	S	38-46	34-46	50	S	38-47	34-47	51	S	38-48	34-48
	50	S	39-47	35-47	51	L	39-48	35-48	52	L	39-49	35-49
75° +5cm	50	S	39-47	35-47	51	S	39-48	35-48	52	S	39-49	35-49
	51	S	40-48	36-48	52	S	40-49	36-49	53	S	40-50	36-50
	52	L	41-49	37-49	53	L	41-50	37-50	54	L	41-51	37-51
90° Short	45	S	33-41	29-41	46	S	33-42	29-42	47	S	33-43	29-43
	46	S	34-42	30-42	47	S	34-43	30-43	48	S	34-44	30-44
	47	S	35-43	31-43	48	L	35-44	31-44	49	L	35-45	31-45
90° Std	48	S	38-44	34-44	49	S	38-45	34-45	50	S	38-46	34-46
	49	S	39-45	35-45	50	S	39-46	35-46	51	S	39-47	35-47
	50	L	40-46	36-46	51	L	40-47	36-47	52	L	40-48	36-48
90° +5cm	50	S	40-46	36-46	51	S	40-47	36-47	52	S	40-48	36-48
	51	S	41-47	37-47	52	S	41-48	37-48	53	S	41-49	37-49
	52	L	42-48	38-48	53	L	42-49	38-49	54	L	42-50	38-50
75° Tapered	48	S	37-45		49	S	37-46		50	S	37-47	
	49	S	38-46		50	S	38-47		51	S	38-48	
	50	L	39-47		51	L	39-48		52	L	39-49	
90° Tapered	48	S	39-44		49	S	39-45		50	S	39-46	
	49	S	40-45		50	S	40-46		51	S	40-47	
	50	L	41-46		51	L	41-47		52	L	41-48	

NOTE: All specifications and dimensions are approximate.
For the most current information, go to www.invacare.com.au

Küschall® K-Series



Local Homologation number, ISO, MDA, TUV logos
The product includes all standard features
Maximum user weight: 130kg
We reserve the right to deliver a + or - tolerance of +/- 10 mm
on all measurements
We reserve the right to make technical changes without notice



**NOTE: All specifications and dimensions are approximate.
For the most current information, go to www.invacare.com.au**



Invacare Corporation www.invacare.com.au

Australia
1 Lenton Place
North Rocks NSW 2151
Australia
1800 460 460

©2014 Invacare Corporation
All rights reserved. Trademarks are identified by the symbols™ and ®. All trademarks are owned by or licensed to Invacare Corporation unless otherwise noted. Specifications and prices are subject to change without notification.