



MODÈLES: **ELEGANCE 42**

### Overall Dimensions

With Louvers

Rectangular

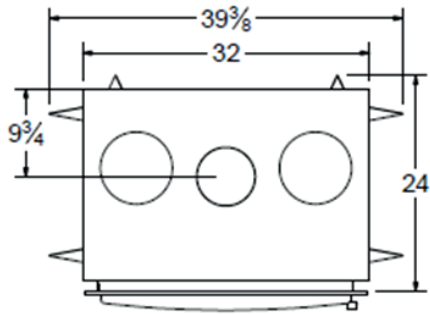

Arqued

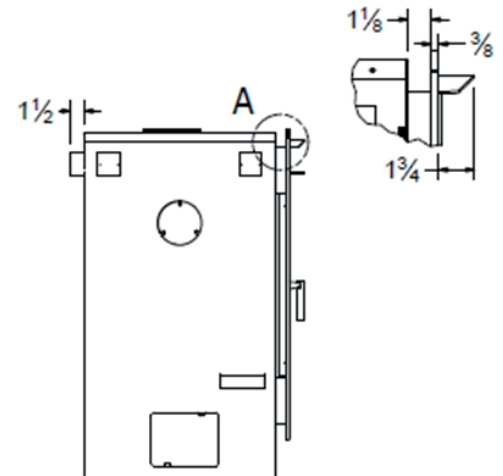
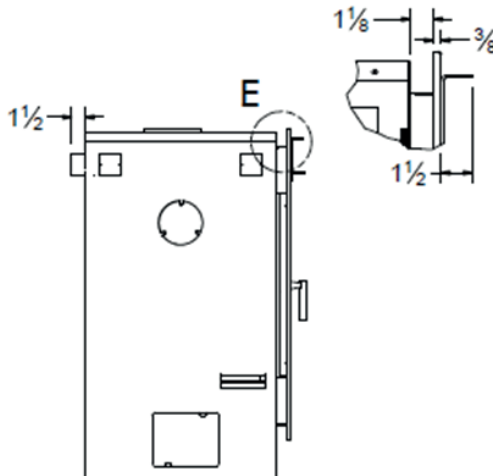
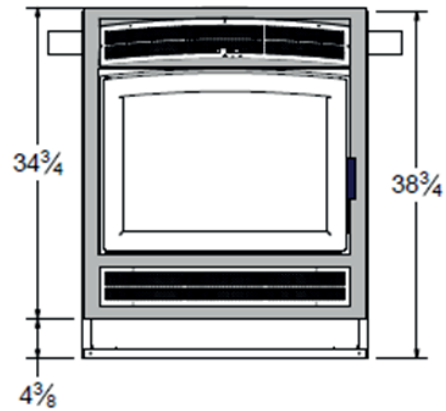
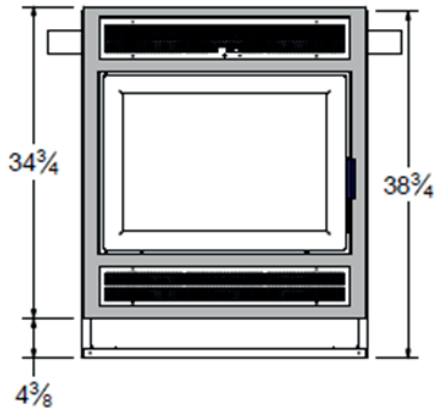
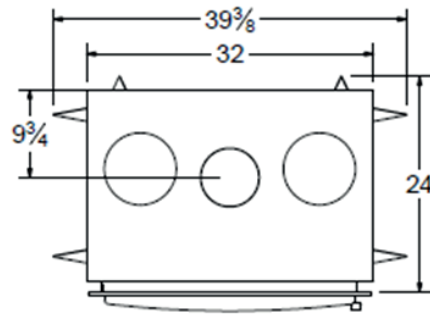



MODÈLES: **ELEGANCE 42**

**Overall Dimensions**

Clean Face

Rectangular

Arqued

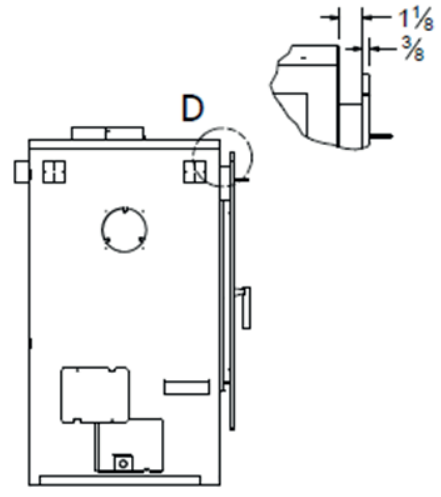
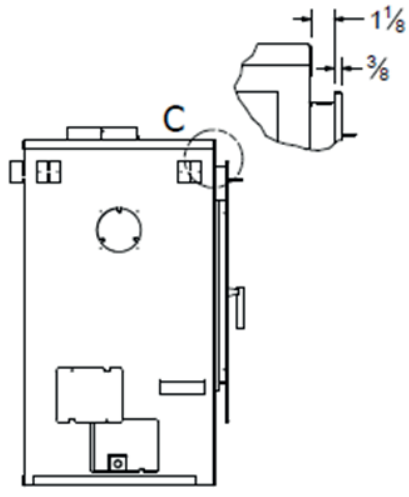
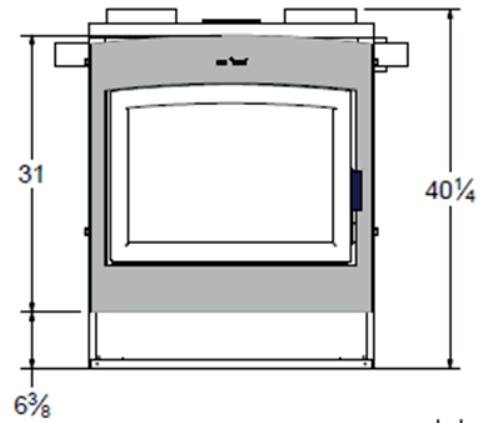
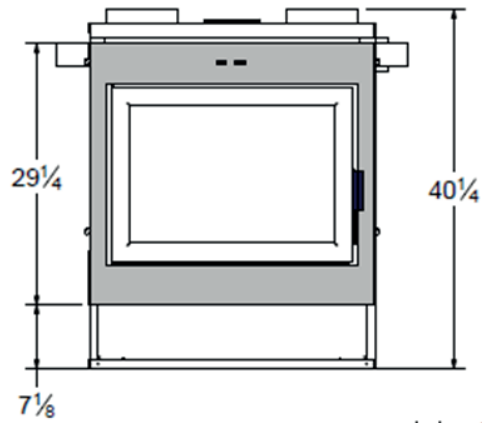
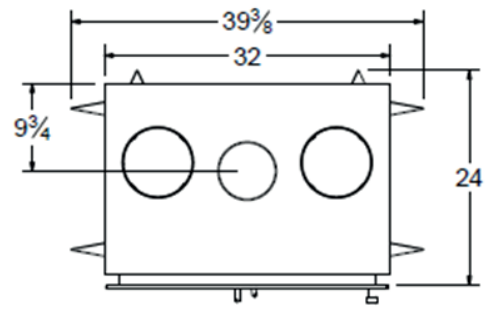
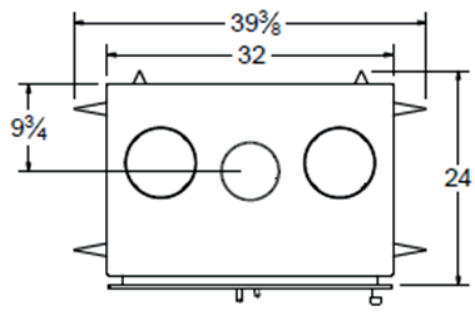

MODÈLES: **ELEGANCE 42**

**Specifications**

BTU		FIREBOX		EFFICIENCIES			VENTING		
Cordwood	EPA	Cu. Ft	Log Length	g / hr	Optimal %	LHV	Type	Diameter	Brands
100,000	26,354	3.8	23"	1.85 g	75 %	72.6 %	Class A	6-inch	All

GLASS			DIMENSIONS			BLOWER INCLUDED	
Type	Dimensions	Area sq in	Width	Depth	Height	Type	CFM
Ceramic	15.9" X 23.4"	372	39.375"	24.375"	39.125"	Variable Speed	250

**Framing and Clearances**

The Elegance 42 can be placed directly onto or against normal, combustable construction materials such as lumber, plywood, millboard, particleboard, drywall and decorative wood paneling. The fireplace should NOT be placed directly against or be in contact with an insulation material. A portion of the framing on the face of the chase must be constructed with nominal 2" x 3" or 2" x 4" metal studs and the remainder can be constructed with nominal 2" x 3" or 2" x 4" lumber. Refer to Figure 3-10 for an example of a framing design and Figure 3-11 for the framing for installations of the single linear front louver gravity kit. The framing must be nailed or screwed onto the floor and to the ceiling.

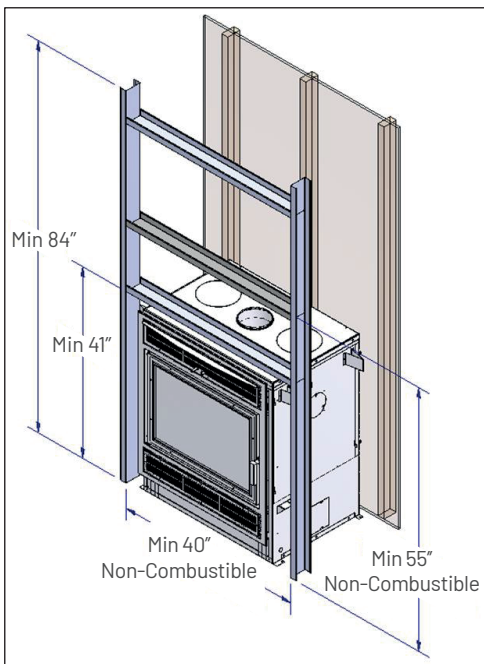

**Figure 3-10: Minimum Elegance 40 Framing Dimensions**

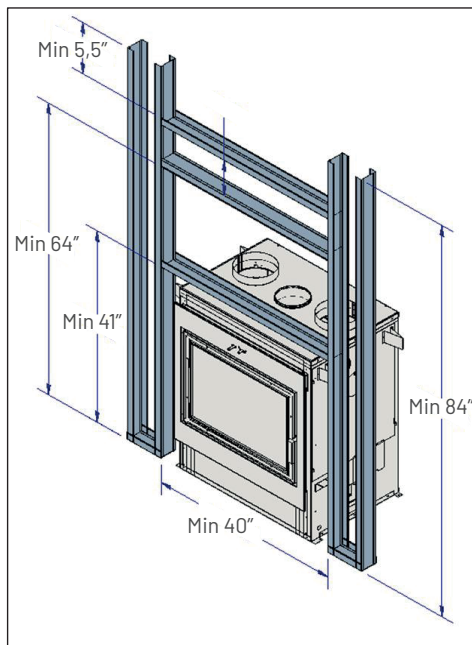

**Figure 3-11: Minimum Framing Dimensions for Single Linear Front Louver Gravity Kit Installations**

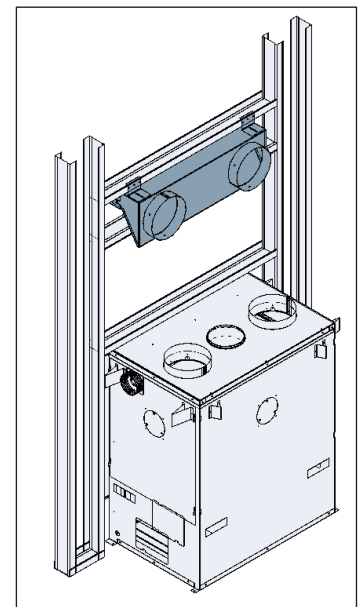

**Figure 3-26: Linear Duct/Louver Adapter Installation**

MODÈLES: **ELEGANCE 42**

## Chase Installation

A portion of the front of the chase must be constructed out non-combustible material. Refer to Figure 3-39, 3-40, and 3-41 for dimensions. Note the chase must be properly fastened onto the framing structure.

**WARNING: Do not nail or screw the chase onto the fireplace.**

For the clean face surround option, two intake openings must be constructed onto the chase, as well as two outtake openings or one if installing the linear single louver front. Refer to Figures 3-39 and 3-41 for minimum clearances.

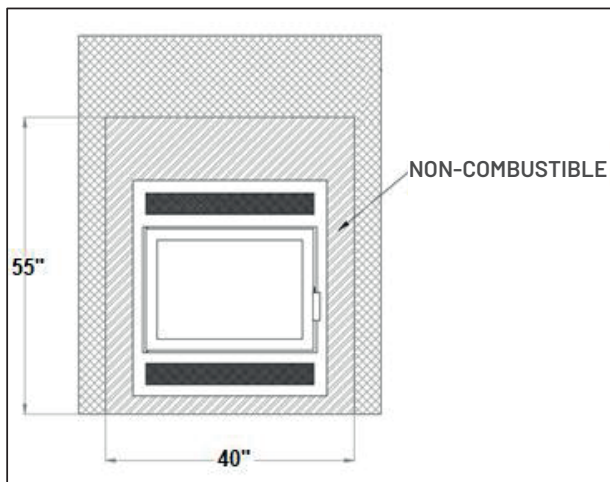

Figure 3-40: Front Chase for Traditional Surround Option

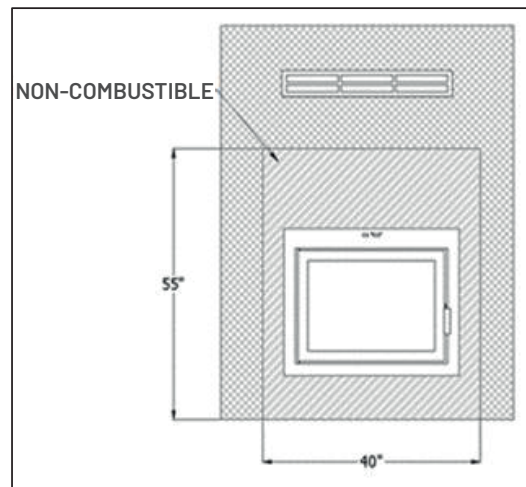

Figure 3-41: Front Chase for Clean face Linear Louver Configuration

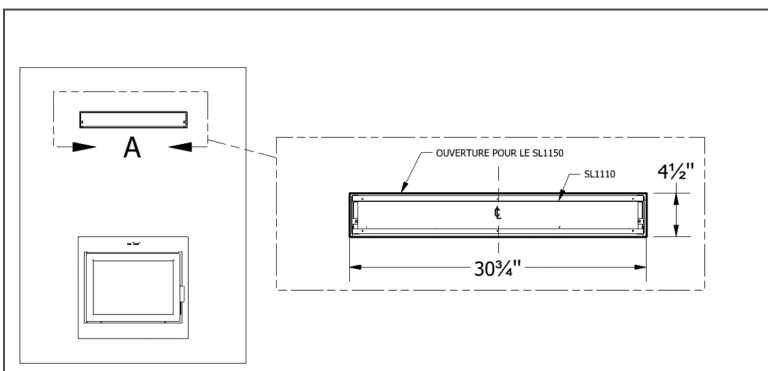

Figure 3-35: Opening for Air Outtake

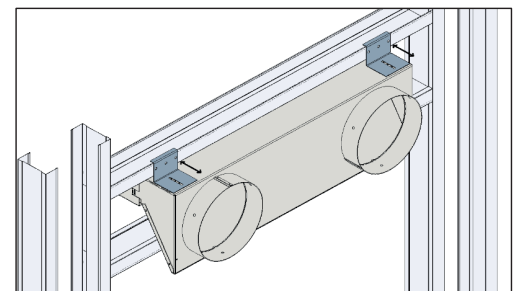

Figure 3-27: Adjustable Brackets of Linear Duct/Louver Adapter



MODÈLES: **ELEGANCE 42**

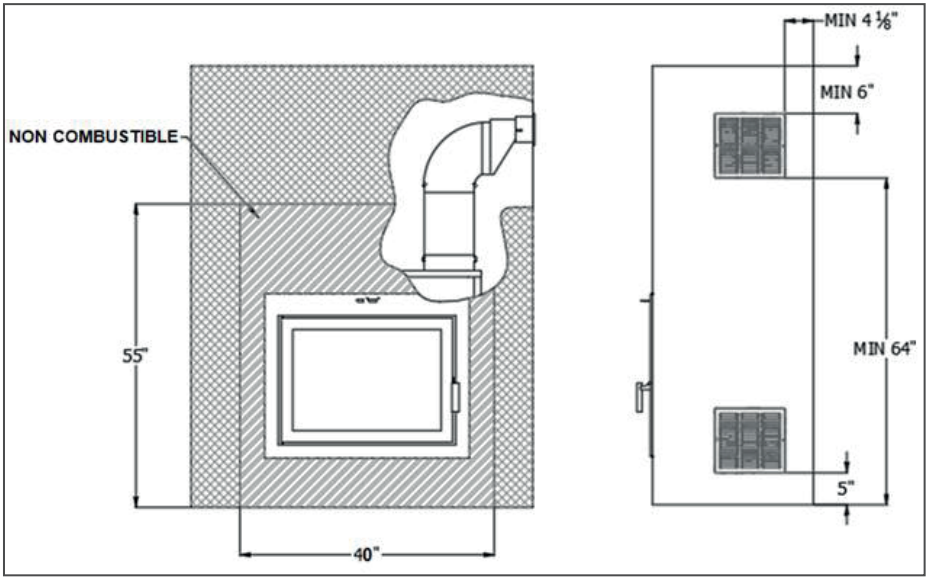

Figure 3-39: Front and Side Chase for Clean Face Dual Louver Configuration

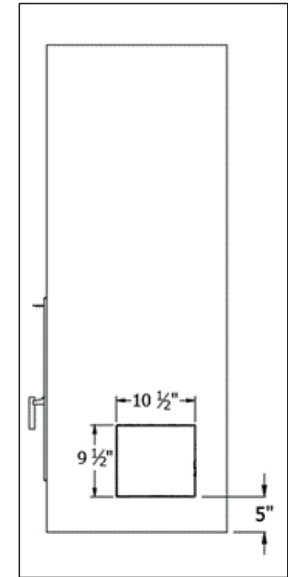

Figure 3-36: Opening for Air Intake Two Required

**Installation**

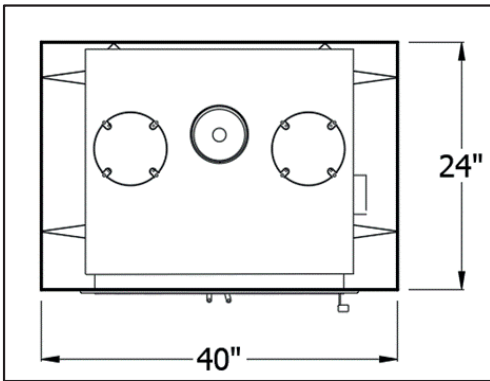

Figure 3-1: Straight Wall Installation

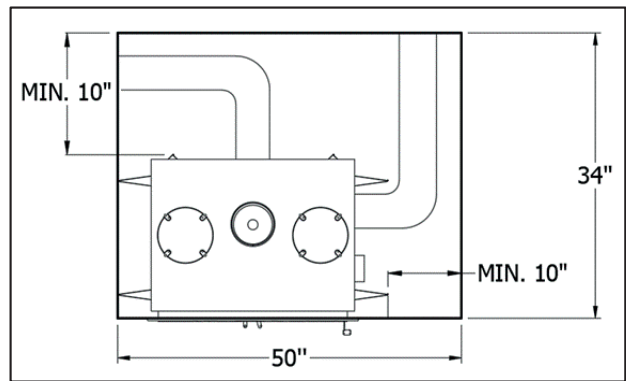

Figure 3-3: Space Required for Forced Hot Air System Installations

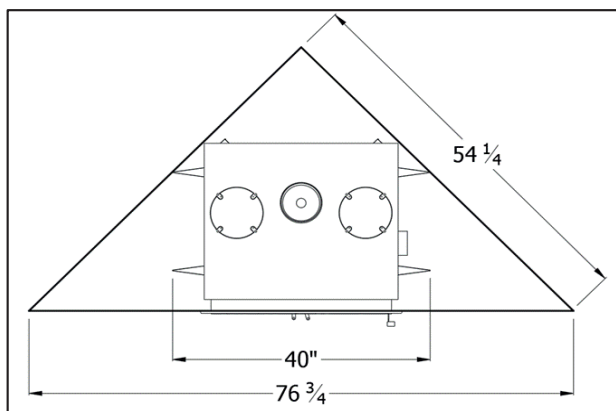

Figure 3-2: Corner Installation

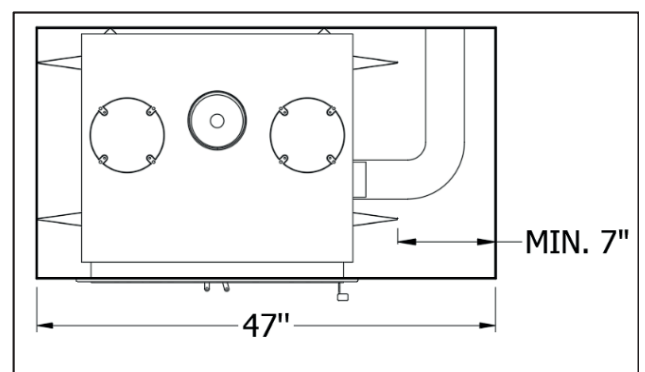

Figure 3-4: Space Required for Fresh Air Kit Installations



### MODÈLES: ELEGANCE 42

## Hearth Extension

The hearth extension of the Elegance 42 must comprise of a non-combustible material, such as steel, cement or mortar, bricks, or ceramic tiles. Note that unidentified materials may be combustible; verify product specifications prior to installation. The hearth extension must extend a minimum of 18" from the front of the door, 8" from side of the outer frame of the door and extended all the way to the unit.

**CAUTION:** Make sure to remove any carpet or fabric under the hearth extension.

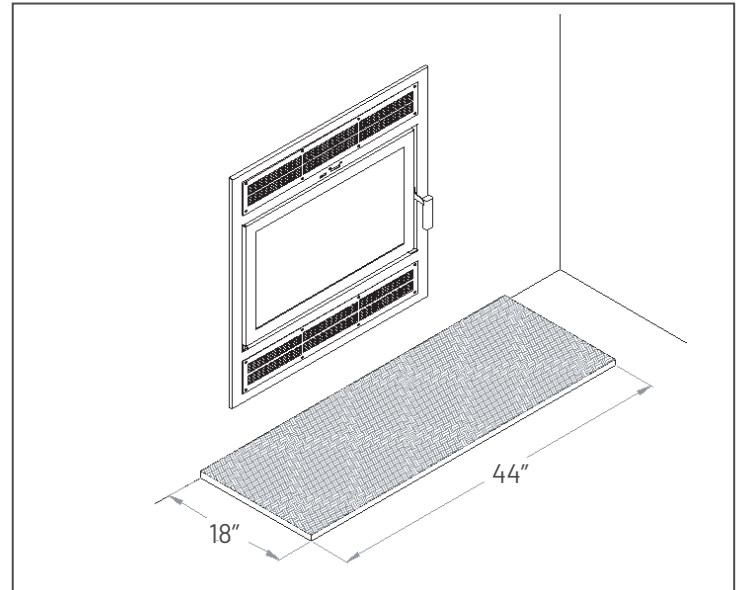

Figure 3-37: Hearth Extension

## Gravity Kit Installation

The Clean Face surround comprises no louvers; however, an intake into the chase and an outtake through gravity ducts is required for this configuration. The instructions below describe the installation of the intake openings, and the gravity ducts/ outtakes. Note that in order to connect the gravity ducts to the sides of the chase, the sides of the chase need to be constructed and the front of the chase needs to remain open; to connect the gravity ducts to the front of the chase, the sides need to remain open and the front of the chase needs to be constructed (Figure 3-24). Please note that the SUPREME KG540 kit and the UCAC8 semi-rigid insulated ducts are required for the Gravity Kit installation.

### WARNINGS :

- The gravity ducts must extend upwards from the top of the unit and cannot exceed 10 feet.
- The ducts should never extend downwards; only upwards.
- The air outtakes must be installed at a minimum of 64 inches from the floor.
- The gravity ducts must not be connected to a central heating system.
- A clearance must be maintained between the gravity ducts and the chimney.
- The intake swivel covers at the bottom sides must remain open for all Clean Face installations.

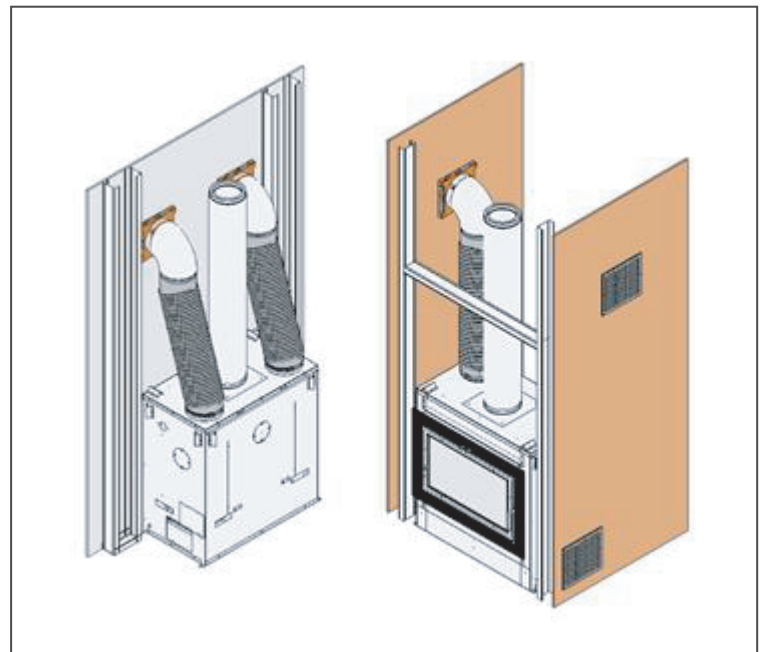

Figure 3-24: Gravity Kit Installation



MODÈLES: **ELEGANCE 42**

### Clearances to Combustibles

The clearances below must be respected to ensure safe operation of the unit under normal and extreme conditions. Failure to follow the information below is a safety hazard and may result in property damage.

**Figure 3-8: Overall Clearances**

Combustible	Clearance	Reference
Side Wall	16" (407 mm)	Outer edge of fuel door
Side Trim	4" (102 mm)	Outer edge of fuel door
Ceiling	84" (2134 mm)	Base of unit

**Figure 3-9: Combustible Mantel Clearances**

Maximum Mantle Depth	Distance from the Base of the Elegance 40 to the Bottom of the Mantle
3" (76 mm)	51.5" (1308 mm)
5" (127 mm)	53.5" (1359 mm)
7" (178 mm)	55.5" (1410 mm)

The depth of the mantle is measured from the face of the fireplace door. When the non-combustible wall is recessed, the depth of the mantle can be increased by the amount of the recess (see Figure 3-42). Note that a combustible mantle cannot be installed below the minimum clearance of 51.5" (from the bottom of the mantle to the base of the unit). A non-combustible mantle doesn't require a minimum distance from the fireplace.

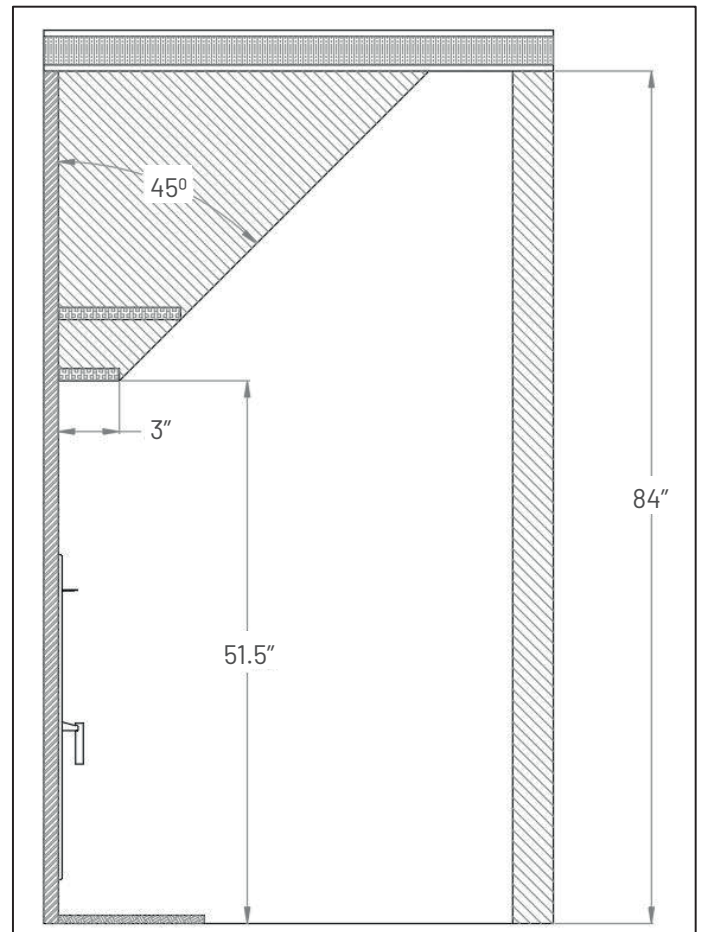

**Figure 3-42: : Mantel Clearance**