

SELECT DESIRED GAS:

- NATURAL GAS
- PROPANE

SELECT DESIRED FINISH:

- 316 MARINE GRADE STAINLESS STEEL
- BRONZE POWDER COAT
- BLACK POWDER COAT
- CUSTOM POWDER COAT SPECIFY:

TECHNICAL SPECIFICATIONS:

- HIGH FIRE - 53,000BTU/HR (NG)
47,000BTU/HR (LPG)
- LOW FIRE - 46,000BTU/HR (NG)
40,000BTU/HR (LPG)
- GAS SUPPLY PRESSURE: NG -6.5"
W.C. (MIN), 14.0" W.C. (MAX)
LPG: 10.8" W.C. (MIN), 14.0" W.C.
(MAX)
- ELECTRICAL SUPPLY: 24 VOLTS, 0.8
AMPS
- DIRECT SPARK IGNITION WITH
3-TRY LOCK OUT & AUTOMATIC
RE-LIGHT

WARRANTY:

- 3 YEARS ON 316 STAINLESS STEEL
EMITTER
- 1 YEAR ON ALL OTHER PARTS

NOTES:

1. INSTALLATION TO BE COMPLETED IN ACCORDANCE WITH MANUFACTURER'S SPECIFICATIONS.
2. DO NOT SCALE DRAWING.
3. THIS DRAWING IS INTENDED FOR USE BY ARCHITECTS, ENGINEERS, CONTRACTORS, CONSULTANTS AND DESIGN PROFESSIONALS FOR PLANNING PURPOSES ONLY. THIS DRAWING MAY NOT BE USED FOR CONSTRUCTION.
4. ALL INFORMATION CONTAINED HEREIN WAS CURRENT AT THE TIME OF DEVELOPMENT BUT MUST BE REVIEWED AND APPROVED BY THE PRODUCT MANUFACTURER TO BE CONSIDERED ACCURATE.
5. CONTRACTOR'S NOTE: FOR PRODUCT AND COMPANY INFORMATION VISIT www.CADdetails.com/info AND ENTER REFERENCE NUMBER 5029-014.

EVENGLO FIXED SERIES: MODEL **GA301T**

OPTIONAL GAS CONNECTION COVER

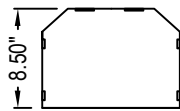
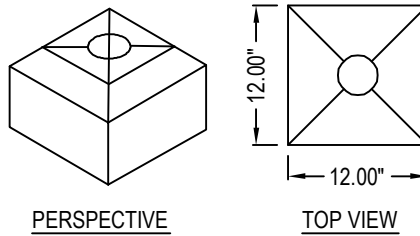

FRONT AND SIDE
ELEVATION
HEAT COVERAGE

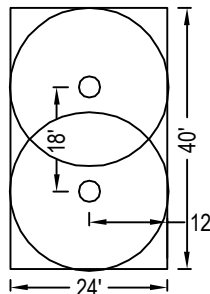

TYPICAL COVERAGE
TWO HEATERS

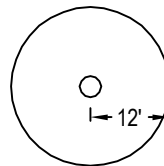

TYPICAL COVERAGE
ONE HEATER

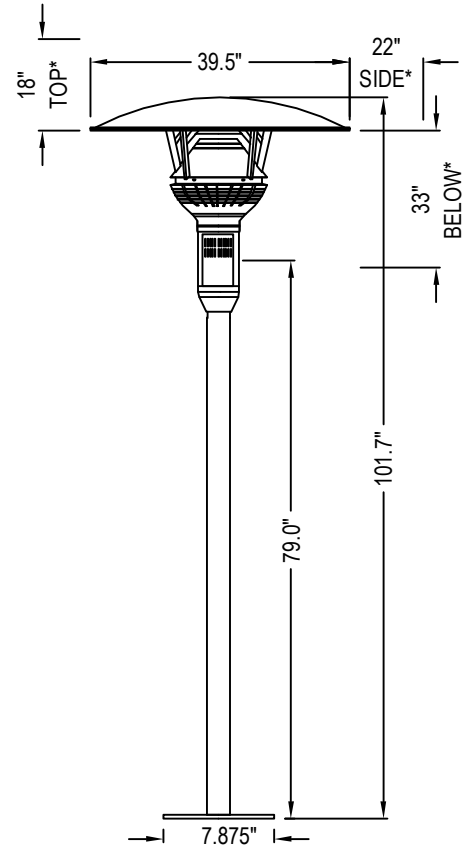

FRONT ELEVATION - MODEL GA301T

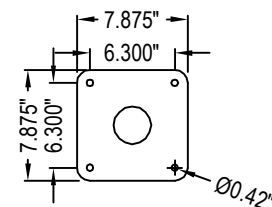

BOTTOM MOUNTING PLATE