

LEGENDAIRY Milk®

hands free

SILICONE COLLECTION CUPS

WEARABLE CUPS FOR ON THE GO!

*Wearable cups
for on the go!*

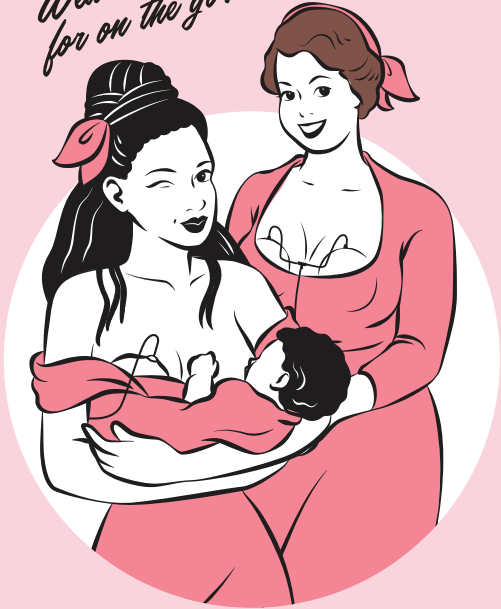

*Instructions
for use*

f | @LEGENDAIRYMILK
WWW.LEGENDAIRYMILK.COM

LEGENDAIRY Milk®



Legendairy Milk® Silicone Collection Cups

Offering you a single or double, hands-free, and mobile way to express breastmilk; our Silicone Collection Cups are designed for use anytime you like, wherever you like.

Legendairy Milk® is proud to offer the first and only system with a breast shield made from food-grade frosted silicone, for your comfort and safety. Our high-quality closed-system is free from Bisphenol A (BPA) and Diethylhexyl phthalate (DEHP).

We hope our Silicone Collection Cups support you in your pumping journey!

We'd love to hear from you! If you have feedback or wish to share your breastfeeding story with us, please send us an email at: info@legendairymilk.com

TABLE OF CONTENTS

Important information	4
What's Included	5
Cleaning	6
• Before first use	
• After each use	
• How to sanitize	
Instructions for use	
• How to single or double pump	7
• How to assemble	8
• Placement in bra	10
• Ideal bra fit	10
• Positions for expressing	11
• Disconnecting and storing milk	12
Connecting to a compatible pump	13
Troubleshooting	15
Troubleshooting breast shield size	16
Breast shield sizing guide	18
Storage of breastmilk	19
When to replace parts	20

IMPORTANT INFORMATION

PLEASE READ THIS USER MANUAL BEFORE USING LEGENDAIRY MILK COLLECTION CUPS FOR THE FIRST TIME.

- Wash your hands with soap and water and dry thoroughly before assembling parts.
- Ensure all parts are clean and dry before each use.
- Avoid harsh detergents as this may damage the product.
- Exposure to detergent may make the silicone appear cloudy over time.
- Do not use a steam sterilizer or dishwasher for any of the Collection Cup parts at any point.
- Do not boil the plastic cups, tubing or adapters at any point.
- Silicone parts can be boiled for a total of 3 minutes in a pot of boiling water before first use only. Do not boil again and only hand wash or use UV sterilization/cold water sterilization going forward.
- Store in a cool, dry space and avoid direct sunlight.
- Replace the parts or the product if it shows signs of wear or damage.
- Replace the valves every 1-2 months (2 spare valves are included).
- Please do not use a cleaning brush inside the valves as this may damage the valve or shorten its lifespan.
- This product is a personal care item, and use should not be shared between mothers.
- This device is only intended for use with compatible pumps.
- If you experience any pain while using this device, seek professional advice from a Lactation Consultant to ensure you have a correctly-fitted breast shield.
- Contains small parts which may be a choking hazard for children.

WHAT'S INCLUDED



CLEANING

1. Before first use

- a. Disassemble all parts
- b. Wash in warm soapy water (except for the tubing)
- c. Rinse well with clean water
- d. Submerge parts in pot of water (except for the tubing, adapters, and cups) and boil for no longer than 3 minutes
 - i. Use large pot to prevent parts from touching sides or bottom of pot
- e. Shake off excess water and air-dry on a dedicated rack or clean cloth

2. After each use

- a. Put aside parts that don't come in contact with breastmilk
 - i. When used correctly, tubing does not come in contact with breastmilk and does not need to be cleaned
- b. Disassemble all other parts (collection cup, silicone breast shield, valve and valve base)
- c. Rinse with cold water soon after use
- d. Wash in warm soapy water
 - i. Valves can be cleaned by gently rubbing between fingers
- e. Rinse well
- f. Shake off excess water and air-dry on a dedicated rack or clean cloth

3. How to sanitize

- a. Follow cleaning instructions 2.a through 2.e
- b. Submerge parts (except tubing, adapters, and plastic cups) in a pot of water and boil for a maximum of 3 minutes.
 - i. Use large pot to prevent parts from touching sides or bottom of pot
- c. Shake off excess water and air-dry on a dedicated rack or clean cloth

*After first sanitizing all parts (except tubing and plastic cups), please do not boil silicone parts again. Do not steam sterilize or dishwasher parts at any point. Otherwise, the parts will be damaged and the suction and fit will be affected. Handwash or use UV sterilization or cold water sterilization after first use.

INSTRUCTIONS FOR USE

How to single or double pump

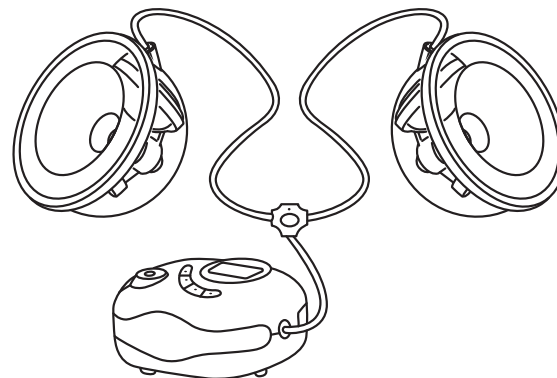
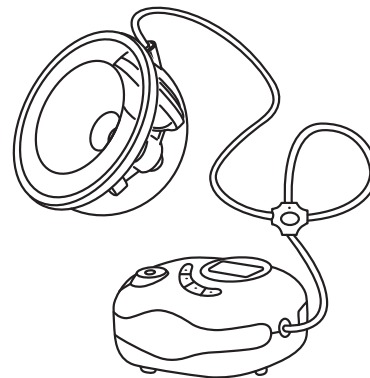

INSTRUCTIONS FOR USE

How to assemble

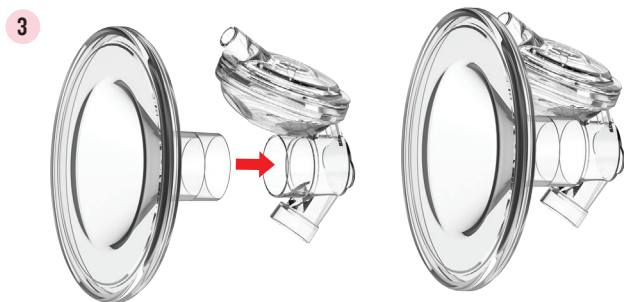
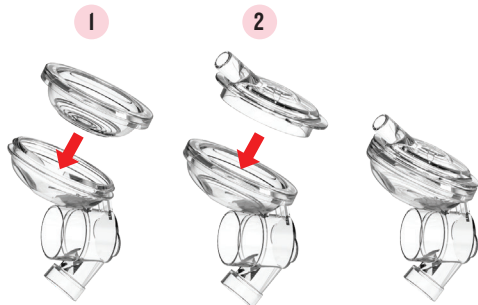

INSTRUCTIONS FOR USE

How to assemble

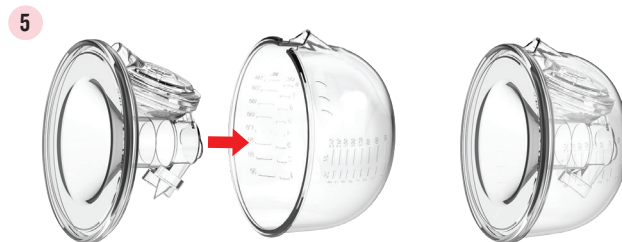
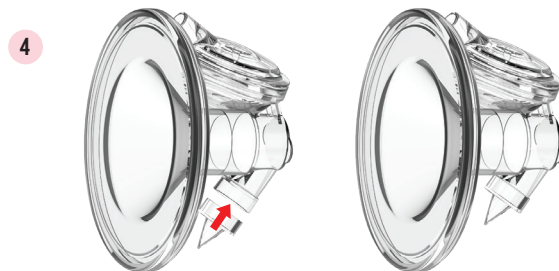

INSTRUCTIONS FOR USE

Placement in bra

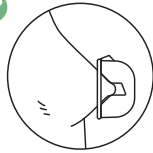
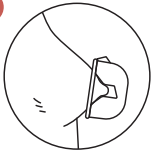
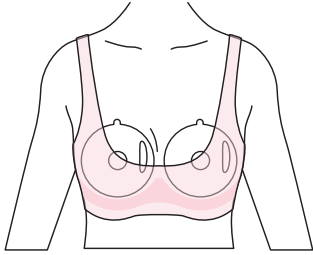

Ideal bra fit

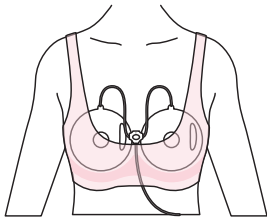

Correct nipple alignment and a supportive bra that keeps the cups securely in place will ensure your pumping sessions are comfortable and effective. Double check that you have a good seal between the funnel and your skin.

INSTRUCTIONS FOR USE

Positions for expressing

✓ IDEAL



Upright

✓ GOOD



Slightly forward

✗ MAY LEAK



Bending forward

✗ MAY LEAK



Reclining

✗ WON'T WORK

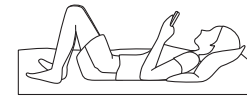

Laying back (or side)

INSTRUCTIONS FOR USE

Disconnecting and storing milk

- 1 Remove your tubing from the cups.

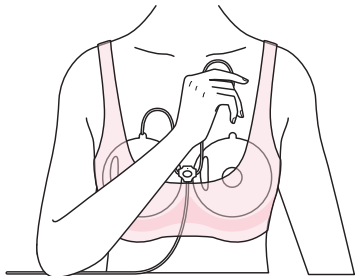

- 2 Carefully remove the cups from your bra and place them on a flat, firm surface until you're ready to transfer your milk.

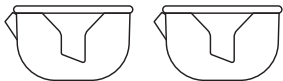

- 3 Tip! When pouring your milk, use your thumb to squeeze the breast shield to control flow.

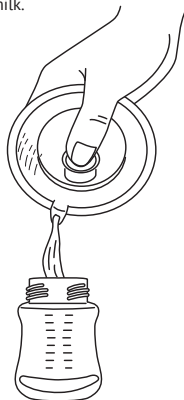

CONNECTING TO A COMPATIBLE PUMP

AMEDA Mya, Mya Joy, Finesse, Purely Yours, Purely Yours Ultra FREEMIE Independence, Liberty
SPECTRA S1, S2, M1, 9+, 9S, Synergy Gold ARDO Calypso EVENFLO Advanced
MOTIF Luna, Duo LANSINOH RUMBLE TUFF Serene Express
PHILIPS AVENT Single Electric MOMCOZY Double Electric Portable
UNIMOM Minuet ZOMEZ Z1, Z2

Tubing adapter A

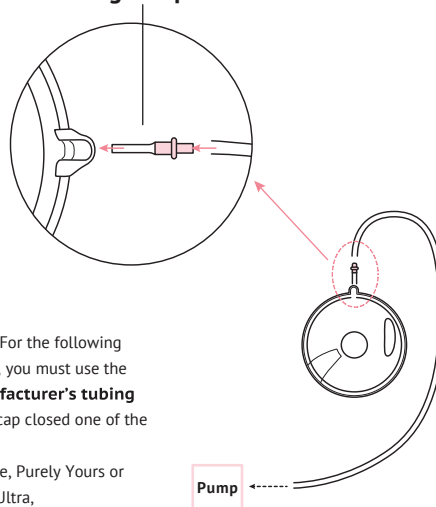

*Please note: For the following breast pumps, you must use the **pump manufacturer's tubing connector** to cap closed one of the pump ports:

Ameda Finesse, Purely Yours or Purely Yours Ultra,
Ardo Calypso, Evenflo Advanced

Pump

In order to maximize suction, using your existing pump's tubing may be preferable to using Legendairy Milk's Y-shape tubing.

CONNECTING TO A COMPATIBLE PUMP

MEDELA Lactina, Pump In Style Advanced, Pump In Style with MaxFlow, Sonata, Freestyle, Freestyle Flex, Swing Maxi, Swing

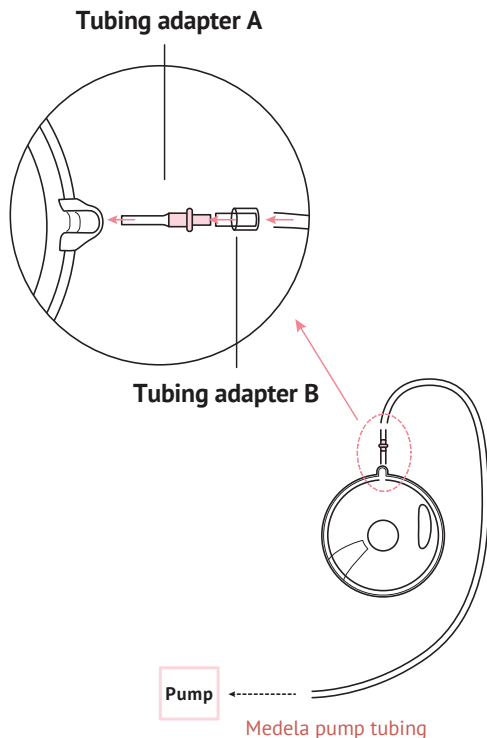

TROUBLESHOOTING

Issue	Solution
Condensation in tubing	Ensure the tubing, the silicone membranes, and membrane caps are dry before use. If condensation occurs, ensure tubing is dry before next use. Disconnect the tubing from cups and turn the pump back on to dry the tubing while you are storing your breastmilk.
Milk in tubing	Check the membranes for damage. Replace the membranes if needed and clean/replace the tubing. Do not sterilize tubing in the dishwasher, steam sterilizer, or by boiling.
Low or no suction	Make sure your pump is turned on and the suction level is set properly. Check duckbill valves for any damage or wear. Replace valves if needed. Confirm that duckbill valves are oriented in the correct position; see assembly instructions on page 9 for guidance. Check that all parts are dry and securely assembled, especially tubing Adapter A and/or B. Check tubing to ensure it is inserted into the backflow protector ports firmly with appropriate adapter(s). If using as a single pump, check that the disconnected side of the tubing is firmly inserted into the top of the Y-shape connector. Keep collection cups with adapter and tubing perpendicular and upright in bra; see page 10 for placement and bra fit instructions.
Air escaping or whistling	Some audible air is normal as air movement is part of suction control. Review 'Connecting to a Compatible Pump' on page 13 and 14 to ensure that the appropriate adapters are inserted into the tubing. Wedge Adapter A as far down as possible into the backflow protector port BEFORE you put the pump parts into the cups.
Backflow Protector/Membrane Cap opening/clicking	Separate silicone membrane from membrane cap and backflow protector and ensure that all parts are clean and dry. Examine membrane for damage or warping and replace as needed. Reattach the membrane to the backflow protector and confirm that seal is tight before closing with membrane cap.
Nipple Pain or Discomfort	Seek advice from a Lactation Consultant as comfort can be key to sustaining a breastfeeding journey. Ensure you are using well-fitted breast shields for both breasts; see page 16 for Troubleshooting Breast Shield Size. Sometimes with wearable cups, we have to size down for added comfort and improved milk output. Lubricate breast shields with a thin layer of coconut oil or Pumping Spray.

TROUBLESHOOTING BREAST SHIELD SIZE

When it comes to choosing an optimal breast shield, always go by what is most comfortable and effective for you - regardless of how it looks. Properly fitted breast shields will be 3-4 mm wider than nipples BEFORE pumping and 1-2 mm AFTER pumping, generally speaking. Women with very elastic tissue will often find that the tissue stretches and touches the inside of the breast shield funnel no matter what. If this sounds like you, you may find silicone inserts provide the most comfort because they can physically hold back the elastic tissue.

Pro Tip: The two most important factors in breast shield sizing are that they are comfortable and also maximize your milk output -- regardless of what they look like.

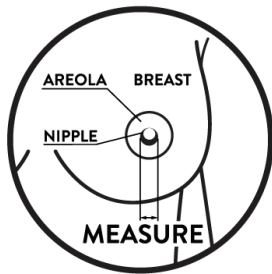

Pro Tip: Apply a light coating of coconut oil to the breast shield funnel to minimize nipple discomfort and friction.

If you're experiencing discomfort or pain while pumping, consider the following:

- Are you using a new or gently used breast pump? If used, is the motor worn down?
- Are your Silicone Collection Cup parts worn or damaged?
- Have you tried lowering the suction pressure on your breast pump?
- Is your nipple centered in the funnel?
- Is your nipple rubbing against the sides of the funnel?
- Have you measured your nipples and found an optimal breast shield size for BOTH breasts?

ARE YOU EXPERIENCING ANY OF THE FOLLOWING?

Difficulty achieving maximum output	YES	NO
Frequent clogged ducts or mastitis	YES	NO
Nipple rubbing the sides of the breast shield while pumping	YES	NO
Excessive areola pulling into the breast shield while pumping	YES	NO
Redness/irritation during or after pumping	YES	NO
Nipple noticeably white during or after pumping	YES	NO
Pain or discomfort at any point during or shortly after pumping	YES	NO
Sore/cracked nipples	YES	NO
Excessive pumping time with no or little milk output	YES	NO
Breasts still feel full after pumping	YES	NO

If you answered YES to any of the following, please consult with a lactation professional. There is no substitute for properly sized breast shields.

Do not continue to use your Silicone Collection Cups if you experience pain or discomfort while pumping. A different size funnel may be needed to optimize comfort and milk output.

BREAST SHIELD SIZING GUIDE

Use the coin method for an approximate measurement of your pre-pump nipple size.

Measure your nipple pre-pump, hand stimulated at the base where nipple meets areola. Place the nipple into the smallest hole you can comfortably fit into without forcing, this is your nipple size. Measure each side as they can differ. Properly fitted flanges will be 1-3 mm larger than nipple diameter. Please consult with a lactation professional if you're experiencing nipple pain or damage.

NO.2 ERASER	7mm
AAA BATTERY	10 mm
AA BATTERY	15 mm
DIME	18 mm
PENNY	19 mm
NICKEL	21 mm
QUARTER	24 mm

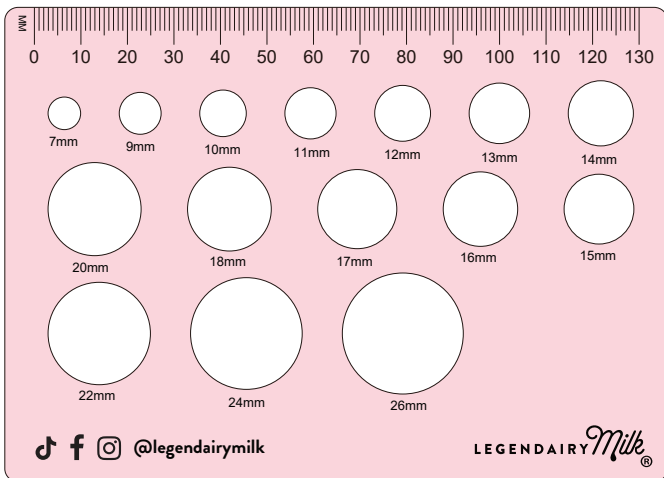





Not sure what flange size to use? Use our Printable Ruler. Download it here:

LM.2.VU/URULER

STORAGE OF BREASTMILK

LOCATION OF STORAGE	TEMPERATURE	MAXIMUM RECOMMENDED STORAGE DURATION
---------------------	-------------	--------------------------------------

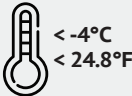
 <p>Room Temperature</p>	 <p>16-29°C 60-85°F</p>	<p>4 hours optimal 6-8 hours acceptable under very clean conditions</p>
 <p>Refrigerator</p>	 <p>~4°C ~39.2°F</p>	<p>4 days optimal 5-8 days acceptable under very clean conditions</p>
 <p>Freezer</p>	 <p>< -4°C < 24.8°F</p>	<p>6 months optimal 12 months acceptable</p>

According to the Academy of Breastfeeding Medicine, freshly expressed breastmilk may be stored safely at room temperature (10–29°C, 50–85°F) for some period of time. Studies suggest different optimal times for room temperature storage because conditions vary greatly in the cleanliness of milk expression techniques and the room temperature.

Warmer ambient temperatures are associated with faster growing bacterial counts in stored milk. For room temperatures ranging from 27°C to 32°C (29°C = 85°F), 4 hours may be a reasonable limit. For very clean expressed milk with very low bacterial counts, 6–8 hours at lower room temperatures may be reasonable, but it is best to chill or refrigerate as soon as possible if the milk will not be used during that time.

GUIDE TO REPLACING THE PARTS TO YOUR SILICONE COLLECTION CUPS



Duckbill Valves

should be replaced every
1-2 months.



Silicone membranes

that are sold as part of our Spare
Backflow Protectors should be
replaced every 4 months or sooner.

*For best results and longevity of the silicone breast shields, duckbill valves, and valve bases with backflow protectors, we recommend that they be **boiled only once before initial use** to sterilize them and not thereafter. After each subsequent use, we recommend that you disassemble the collection cups, silicone breast shields, duckbill valves, and valve bases with backflow protectors, rinse them with cold water, and then hand-wash them in warm, soapy water. They should then be rinsed well and allowed to air-dry on a dedicated rack or clean cloth. UV sterilization or cold water sterilization is also acceptable.

All compatible replacement parts available for purchase on
WWW.LEGENDAIRMILK.COM