



THE GUNBOX Gunbox Echo *Wi-Fi Edition*

Quick Start Guide

Package Contents:

- 1 – Gunbox Echo
- 2 -- RFID Key Cards
- 2 -- RFID FOB
- 1 – Micro USB Cable
- 1 – 7/64" Hex Key

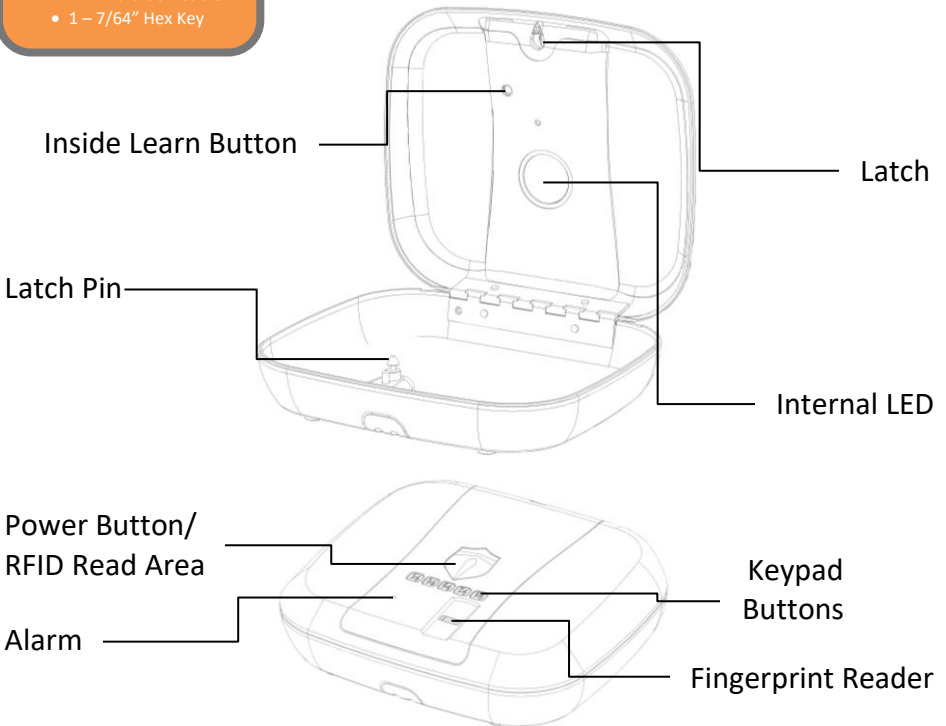

Please Charge Gunbox Echo Before Use
Software Version 3.5

Opening the Gunbox Echo with RFID

- The included RFID's (2 cards and 2 FOBs) are preprogrammed to the Gunbox Echo.
- To open the Gunbox Echo using one of the programmed RFID's:
 1. Press the power button to wake up the Gunbox Echo.
 - The blue LED will begin to blink.
 2. With the blue LED blinking, place one of the included programmed RFID's directly over the power button.
 - The green LED will light, and the Gunbox Echo will 'pop' up, making it easy to lift open.
- ****Note**** When the Gunbox Echo is plugged in, indicated by a solid blue light, the power button does not need to be pressed to wake it up.

Closing the Gunbox Echo

- The Gunbox Echo closes easily by pressing down on the top front of the Gunbox Echo. The latches are spring loaded and will automatically latch.

Programming an Additional RFID

- To program an RFID:
 1. Start with the Gunbox Echo open.
 2. Press and hold the inside learn button for 3 seconds until the Gunbox Echo begins to beep and blink blue.
 3. Within 10 seconds, place an RFID directly over the power button to program that RFID.
 4. You will hear 6 rapid beeps and the green LED will blink rapidly to indicate that the card has been programmed to the Gunbox Echo.
- Up to 10 RFID's can be programmed into the Gunbox Echo. Once 10 RFID's have been programmed, the Gunbox Echo will blink red when trying to add another RFID, and the RFID will not be programmed.

Programming a Fingerprint

- To program a fingerprint:
 1. Start with the Gunbox Echo open.
 2. Press and hold the inside learn button for 3 seconds until the Gunbox Echo begins to beep and blink blue.
 3. Within 10 seconds, place your finger on the plastic directly above the fingerprint reader and swipe your finger down over the fingerprint reader (be sure you are not swiping too fast or the fingerprint reader will not have time to scan your fingerprint properly). The Gunbox Echo LED will turn light blue while scanning the fingerprint, and then rapidly beep 3 times with the green LED blinking when the fingerprint swipe is scanned successfully.
 4. To fully program your fingerprint, continue swiping the same finger again over the fingerprint reader. This process usually takes 5-10 swipes but can require more swipes.
 5. When your fingerprint is programmed, the Gunbox Echo will beep rapidly 6 times with green and light blue LED blinks, to indicate that your fingerprint has been programmed into the Gunbox Echo.
- ****Note**** The Gunbox Echo may blink red during programming to indicate that the previous fingerprint swipe was unsuccessful. When this occurs, the Gunbox Echo is still in programming mode, continue swiping your finger to continue programming.
- If the box blinks red and buzzes, the fingerprint did not program and the fingerprint will need to go through the programming process again.
- Up to 10 fingerprints can be programmed into the Gunbox Echo. Once 10 fingerprints have been programmed, the Gunbox Echo will blink red when trying to add another fingerprint, and the fingerprint will not be programmed.

Opening with a Fingerprint

- To open the Gunbox Echo with a fingerprint:
 1. Press the power button to wake up the Gunbox Echo.
 2. Within 10 seconds, place your finger on the plastic directly above the fingerprint reader and swipe your finger down over the fingerprint reader and the Gunbox Echo will 'pop' up, making it easy to lift open.
- ****Note**** When the Gunbox Echo is plugged in, indicated by a solid blue light, the power button does not need to be pressed to wake it up.

Programming a Keypcode

- To program a keycode:
 1. Start with the Gunbox Echo open.
 2. Press and hold the inside learn button for 3 seconds until the Gunbox Echo begins to beep and blink blue.

3. Within 10 seconds, enter a keycode by pressing the keypad buttons (make sure to enter the keycode quickly, as the Gunbox Echo will time out with 5 seconds of inactivity.)
 4. With each keypad press, the Gunbox Echo will beep and blink green indicating that the key press was recorded. **** Note ** The keycode must be 5-10 digits.**
 5. After entering the keycode, press the power button to program the keycode.
 6. After programming a keycode, use the keycode to open the Gunbox Echo to make sure that the keycode was entered correctly.
- Only 1 keycode can be stored to the Gunbox Echo. Your Gunbox Echo may come preprogrammed with a keycode. If you are unable to program a new keycode to your Gunbox Echo, you will need to delete the previous code, see the section about deleting keycodes.

Opening with a Keycode

- To open the Gunbox Echo with a keycode:
 1. Press the power button to wake up the Gunbox Echo.
 2. Within 10 seconds, enter the programmed keycode using the keypad buttons and the Gunbox Echo will ‘pop’ up, making it easy to lift open.
- If you have entered an incorrect keycode, or pressed a wrong button, wait for the Gunbox Echo to time out (this will be indicated by the red LED blinking and a buzz).
- ****Note**** When the Gunbox Echo is plugged in, indicated by a solid blue light, the power button does not need to be pressed to wake it up.

Turning the Audible Alarm Feature On

- The Gunbox Echo is equipped with a tamper alarm to alert you if the Gunbox Echo has been moved.
- To turn on the alarm feature:
 1. Press the power button to wake up the Gunbox Echo.
 2. Press and hold the 1/2 and 9/0 keypad buttons for 2 seconds, until the Gunbox Echo begins to beep and blink yellow. The Gunbox Echo will be armed within 5 seconds.
 3. After 5 seconds, any movement of the Gunbox Echo will cause it to beep and blink red repeatedly until the alarm is cleared.
 - Additionally, if one of the buttons is pressed, the Gunbox Echo will blink yellow indicating that the alarm will go off within 10 seconds if a valid access method is not used to open the Gunbox Echo.
 4. The Gunbox Echo will alarm for 2 minutes and will automatically turn off and rearm if the alarm has not been cleared.
- To clear the alarm, press the power button and disarm using a programmed RFID, fingerprint or keycode. To rearm the Gunbox Echo, you will need to press and hold the 1/2 and 9/0 keypad buttons again.
- This is only for setting the audible alarm for your box, NOT to receive the Mobile Alerts to your phone.
 - ****Note**** Mobile Alerts requires a pro account from the Lynkd service.

Deleting All RFIDs

- To delete all RFID's:
 1. Press and hold the inside learn button for 3 seconds, until the Gunbox Echo begins to beep and blink blue.
 2. Hold down the 9/0 keypad button for 3 seconds, until the Gunbox Echo blinks green and beeps 3 times.
 - This indicates that all the RFID's have been successfully removed.
- ****Note**** Do not latch the lid closed if you do not have other programmed ways of opening the gun box.

Deleting All Fingerprints

- To delete all fingerprints:
 1. Press and hold the inside learn button for 3 seconds, until the Gunbox Echo begins to beep and blink blue.
 2. Hold down the 1/2 keypad button for 3 seconds, until the Gunbox Echo blinks green and beeps 3 times.
 - This indicates that all the fingerprints have been successfully removed.
- ****Note**** Do not latch the lid closed if you do not have other programmed ways of opening the gun box

Deleting the Keycode

- To delete all keycodes:
 1. Press and hold the inside learn button for 3 seconds, until the Gunbox Echo begins to beep and blink blue.
 2. Hold down the power button for 3 seconds, until the Gunbox Echo blinks green and beeps 3 times.
 - This indicates that all the keycodes have been successfully removed.

- ****Note**** Do not latch the lid closed if you do not have other programmed ways of opening the gun box
- ****Note**** If nothing is programmed into the Gunbox Echo, the latch will open, and a purple light will begin to blink. The Gunbox Echo will power down after 10 seconds but will remain open until something is programmed into it.

Updates

- The Gunbox Echo is capable of software updates over Wi-Fi. Make sure that The Gunbox, LLC has your correct email address so you will be informed when software updates become available.

Mobile Alerts/Tamper Alerts

- Purchase separate subscription for 1 year, 2 years, or 5 years through the Lynkd service. For more information visit www.lynk.com.

Charging the Gunbox Echo

- The Gunbox Echo is powered by a rechargeable battery (1500mAh LiPo).
 - The battery can work for up to 3 months without charging.
- To charge the battery:
 1. Plug the included Micro USB charge cable into the back of the Gunbox Echo.
 2. The Gunbox will begin to blink blue after 10 seconds and then remain solid blue while plugged in.
 3. A full charge will be reached within 8 hours.
- ****Note**** A 5V 2A charger is recommended for charging the Gunbox Echo (not included).
- ****Note**** Use caution when inserting and removing the cable as to not damage the connector.

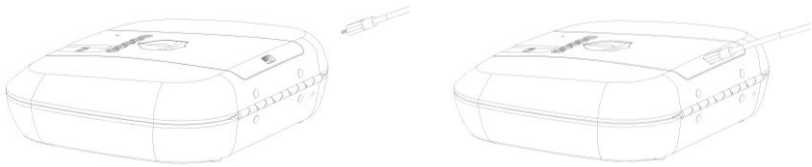

THE
G U N B O X

SAFE STORAGE. QUICK ACCESS.

The Gunbox Echo, a dba of SafeTech Products, LLC

www.thegunbox.com - techsupport@thegunbox.com - 801-331-8655