

60 Series Tube Fittings

60,000 psi (4137 bar)



510 Clinton Square
Rochester
New York
USA 14604

Tel.: 1-855-693-4638
Fax: 1-877-297-4661
E-mail: info@finelok.com



www.finelok.com

Contents

Glands - G	3
Collars - CO	3
Plugs - TP	3
Male Connectors - MC	4
Female Connectors - FC	5
Union Couplings - U	5
Reducing Union Couplings - U	6
Union Couplings (Slip Type) - SU	6
Bulkhead Couplings - BU	7
Caps - TC	7
Elbows - LU	7
Tees - TTT	8

Crosses - C	8
Anti-Vibration Gland Assemblies - AVGA	9
Coned and Threaded Nipples - CTN	9
60 Series Tubing	10

Features

- ☆ Coned-and-Threaded Connection.
- ☆ Metal-to-metal seal provides perfect leak-tight service from critical vacuum to high pressure.
- ☆ Anti-vibration connection components available.
- ☆ Fittings are easy to disconnect and retighten.
- ☆ Material is high tensile 316 stainless steel.
- ☆ Every fitting is stamped with size, material and heat code.

Composition

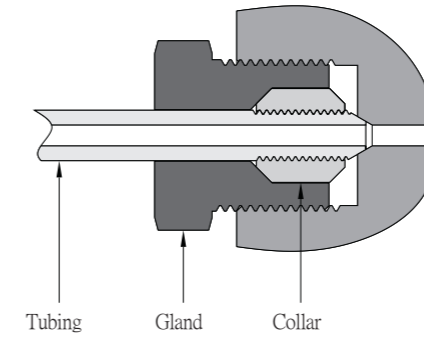

Working Pressure

Working pressure are dependent on the end connection with the lowest working pressures. Working pressure for the end connections used in this catalog are identified below.

60 Series Tube Ends

Tube O.D. in.	Working Pressure, psig (bar)				
	-423 to 100°F (-252 to 37.8°C)	200°F (93°C)	400°F (204°C)	600°F (316°C)	800°F (427°C)
1/4	60000 (4137)	60000 (4137)	57750 (3982)	54250 (3740)	50700 (3496)
3/8	60000 (4137)	60000 (4137)	57750 (3982)	54250 (3740)	50700 (3496)
9/16	60000 (4137)	60000 (4137)	57750 (3982)	54250 (3740)	50700 (3496)

Date in this table is applied only to the working temperature below 800°F (427°C), For the working temperature above 800°F (427°C) please consult FINELOK, and then we will provide you relative solutions.

NPT Pipe Thread Ends ^①

NPT Size	Working Pressure, psig (bar)
1/16	15000 (1034)
1/8	
1/4	
3/8	
1/2	
3/4	10000 (689)
1	

① No allowance is made for corrosion or erosion.

Working Temperature

Connection	Temperature Rating
60 Series Tube Ends	-423°F(-252°C) to 1200°F(649°C)
NPT Pipe Thread Ends	-325°F(-198°C) to 400°F(204°C)

Installation Instructions

☆ Refer to the Tools & Installation Instructions.

Cautions:

☆ Do not loosen or tighten fittings when system is pressurized.

Dimensions

Glands

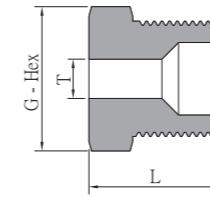

Collars

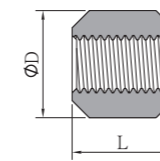

Plugs

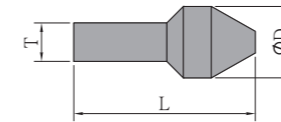

Dimensions are for reference only, subject to change.

Tube			
T - Tube O.D. in.	Ordering Number	Dimensions, in. (mm)	
		G	L
1/4	SS-G-60S4	0.63 (15.9)	0.82 (20.8)
3/8	SS-G-60S6	0.81 (20.6)	1.13 (28.7)
9/16	SS-G-60S9	1.19 (30.2)	1.50 (38.1)

Tube			
T - Tube O.D. in.	Ordering Number	Dimensions, in. (mm)	
		D	L
1/4	SS-CO-60S4	0.38 (9.6)	0.38 (9.6)
3/8	SS-CO-60S6	0.50 (12.7)	0.54 (13.7)
9/16	SS-CO-60S9	0.81 (20.6)	0.62 (15.8)

Tube			
T - Tube O.D. in.	Ordering Number	Dimensions, in. (mm)	
		D	L
1/4	SS-TP-60S4	0.38 (9.6)	1.04 (26.4)
3/8	SS-TP-60S6	0.50 (12.7)	1.35 (34.3)
9/16	SS-TP-60S9	0.81 (20.6)	1.89 (48.0)

Male Connectors

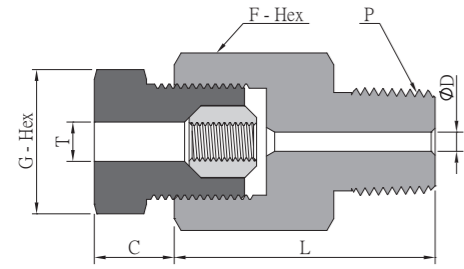

Tube			NPT Thread				
T - Tube O.D. in.	P - NPT Size in.	Ordering Number	Dimensions, in. (mm)				
			L	C	D	G	F
1/4	1/8	SS-MC-60S4-NT2	1.25 (31.8)	0.50 (12.7)	0.09 (2.3)	0.63 (15.9)	0.75 (19.1)
1/4	1/4	SS-MC-60S4-NT4	1.38 (34.9)	0.50 (12.7)	0.09 (2.3)	0.63 (15.9)	0.75 (19.1)
1/4	3/8	SS-MC-60S4-NT6	1.38 (34.9)	0.50 (12.7)	0.09 (2.3)	0.63 (15.9)	0.75 (19.1)
1/4	1/2	SS-MC-60S4-NT8	1.50 (38.1)	0.50 (12.7)	0.09 (2.3)	0.63 (15.9)	0.88 (22.2)
1/4	3/4	SS-MC-60S4-NT12	1.75 (44.5)	0.50 (12.7)	0.09 (2.3)	0.63 (15.9)	1.06 (27.0)
3/8	1/8	SS-MC-60S6-NT2	1.50 (38.1)	0.53 (13.5)	0.13 (3.3)	0.81 (20.6)	1.00 (25.4)
3/8	1/4	SS-MC-60S6-NT4	1.63 (41.3)	0.53 (13.5)	0.13 (3.3)	0.81 (20.6)	1.00 (25.4)
3/8	3/8	SS-MC-60S6-NT6	1.63 (41.3)	0.53 (13.5)	0.13 (3.3)	0.81 (20.6)	1.00 (25.4)
3/8	1/2	SS-MC-60S6-NT8	1.75 (44.5)	0.53 (13.5)	0.13 (3.3)	0.81 (20.6)	1.00 (25.4)
3/8	3/4	SS-MC-60S6-NT12	2.00 (50.8)	0.53 (13.5)	0.13 (3.3)	0.81 (20.6)	1.06 (27.0)
3/8	1	SS-MC-60S6-NT16	2.00 (50.8)	0.53 (13.5)	0.13 (3.3)	0.81 (20.6)	1.38 (34.9)
9/16	1/8	SS-MC-60S9-NT2	1.63 (41.3)	0.81 (20.6)	0.19 (4.8)	1.19 (30.2)	1.38 (34.9)
9/16	1/4	SS-MC-60S9-NT4	1.75 (44.5)	0.81 (20.6)	0.19 (4.8)	1.19 (30.2)	1.38 (34.9)
9/16	3/8	SS-MC-60S9-NT6	1.75 (44.5)	0.81 (20.6)	0.19 (4.8)	1.19 (30.2)	1.38 (34.9)
9/16	1/2	SS-MC-60S9-NT8	1.88 (47.6)	0.81 (20.6)	0.19 (4.8)	1.19 (30.2)	1.38 (34.9)
9/16	3/4	SS-MC-60S9-NT12	2.13 (54.0)	0.81 (20.6)	0.19 (4.8)	1.19 (30.2)	1.38 (34.9)
9/16	1	SS-MC-60S9-NT16	2.25 (57.2)	0.81 (20.6)	0.19 (4.8)	1.19 (30.2)	1.38 (34.9)

Female Connectors

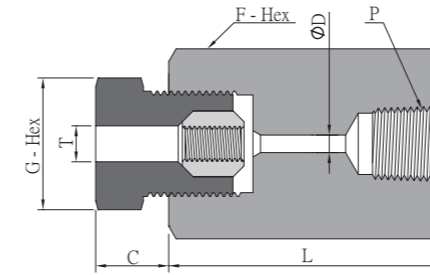

Tube			NPT Thread				
T - Tube O.D. in.	P - NPT Size in.	Ordering Number	Dimensions, in. (mm)				
			L	C	D	G	F
1/4	1/8	SS-FC-60S4-NT2	1.38 (34.9)	0.50 (12.7)	0.09 (2.3)	0.63 (15.9)	0.75 (19.1)
1/4	1/4	SS-FC-60S4-NT4	1.63 (41.3)	0.50 (12.7)	0.09 (2.3)	0.63 (15.9)	0.94 (23.8)
1/4	3/8	SS-FC-60S4-NT6	1.63 (41.3)	0.50 (12.7)	0.09 (2.3)	0.63 (15.9)	1.13 (28.6)
1/4	1/2	SS-FC-60S4-NT8	2.00 (50.8)	0.50 (12.7)	0.09 (2.3)	0.63 (15.9)	1.38 (34.9)
1/4	3/4	SS-FC-60S4-NT12	2.00 (50.8)	0.50 (12.7)	0.09 (2.3)	0.63 (15.9)	1.50 (38.1)
1/4	1	SS-FC-60S4-NT16	2.38 (60.3)	0.50 (12.7)	0.09 (2.3)	0.63 (15.9)	1.75 (44.5)
3/8	1/8	SS-FC-60S6-NT2	1.63 (41.3)	0.53 (13.5)	0.13 (3.3)	0.81 (20.6)	1.00 (25.4)
3/8	1/4	SS-FC-60S6-NT4	1.88 (47.6)	0.53 (13.5)	0.13 (3.3)	0.81 (20.6)	1.00 (25.4)
3/8	3/8	SS-FC-60S6-NT6	1.88 (47.6)	0.53 (13.5)	0.13 (3.3)	0.81 (20.6)	1.13 (28.6)
3/8	1/2	SS-FC-60S6-NT8	2.13 (54.0)	0.53 (13.5)	0.13 (3.3)	0.81 (20.6)	1.38 (34.9)
3/8	3/4	SS-FC-60S6-NT12	2.00 (50.8)	0.53 (13.5)	0.13 (3.3)	0.81 (20.6)	1.50 (38.1)
3/8	1	SS-FC-60S6-NT16	2.25 (57.2)	0.53 (13.5)	0.13 (3.3)	0.81 (20.6)	1.75 (44.5)
9/16	1/8	SS-FC-60S9-NT2	1.81 (46.0)	0.81 (20.6)	0.19 (4.8)	1.19 (30.2)	1.38 (34.9)
9/16	1/4	SS-FC-60S9-NT4	2.00 (50.8)	0.81 (20.6)	0.19 (4.8)	1.19 (30.2)	1.38 (34.9)
9/16	3/8	SS-FC-60S9-NT6	2.00 (50.8)	0.81 (20.6)	0.19 (4.8)	1.19 (30.2)	1.38 (34.9)
9/16	1/2	SS-FC-60S9-NT8	2.38 (60.3)	0.81 (20.6)	0.19 (4.8)	1.19 (30.2)	1.38 (34.9)
9/16	3/4	SS-FC-60S9-NT12	2.38 (60.3)	0.81 (20.6)	0.19 (4.8)	1.19 (30.2)	1.50 (38.1)
9/16	1	SS-FC-60S9-NT16	2.50 (63.5)	0.81 (20.6)	0.19 (4.8)	1.19 (30.2)	1.75 (44.5)

Union Couplings

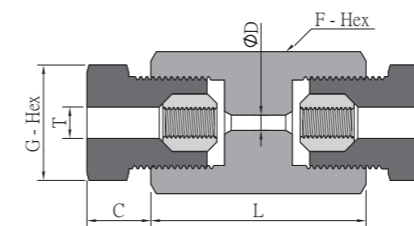

Tube		Dimensions, in. (mm)				
T - Tube O.D. in.	Ordering Number	L	C	D	G	F
1/4	SS-U-60S4	1.38 (34.9)	0.50 (12.7)	0.09 (2.3)	0.63 (15.9)	0.75 (19.1)
3/8	SS-U-60S6	1.75 (44.5)	0.53 (13.5)	0.13 (3.3)	0.81 (20.6)	1.00 (25.4)
9/16	SS-U-60S9	2.19 (55.6)	0.81 (20.6)	0.19 (4.8)	1.19 (30.2)	1.38 (34.9)

Reducing Union Couplings

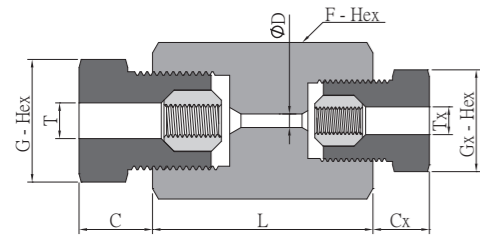

Tube			Dimensions, in. (mm)							
T - Tube O.D. in.	Tx - Tube O.D. in.	Ordering Number	L	C	Cx	D	G	Gx	F	
3/8	1/4	SS-U-60S6-60S4	1.63 (41.3)	0.53 (13.5)	0.50 (12.7)	0.09 (2.3)	0.81 (20.6)	0.63 (15.9)	1.00 (25.4)	
9/16	1/4	SS-U-60S9-60S4	1.75 (44.5)	0.81 (20.6)	0.50 (12.7)	0.09 (2.3)	1.19 (30.2)	0.63 (15.9)	1.38 (34.9)	
9/16	3/8	SS-U-60S9-60S6	2.00 (50.8)	0.81 (20.6)	0.53 (13.5)	0.13 (3.3)	1.19 (30.2)	0.81 (20.6)	1.38 (34.9)	

Union Couplings (Slip Type)

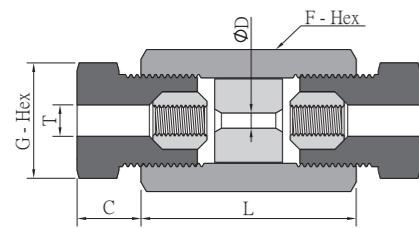

Tube		Dimensions, in. (mm)				
T - Tube O.D. in.	Ordering Number	L	C	D	G	F
1/4	SS-SU-60S4	1.38 (34.9)	0.50 (12.7)	0.09 (2.3)	0.63 (15.9)	0.75 (19.1)
3/8	SS-SU-60S6	1.75 (44.5)	0.53 (13.5)	0.13 (3.3)	0.81 (20.6)	1.00 (25.4)
9/16	SS-SU-60S9	2.19 (55.6)	0.81 (20.6)	0.19 (4.8)	1.19 (30.2)	1.38 (34.9)

Bulkhead Couplings

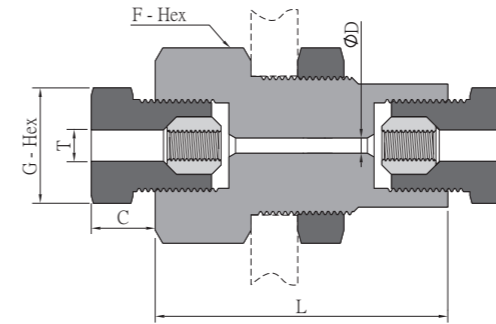

Tube		Dimensions, in. (mm)						
T - Tube O.D. in.	Ordering Number	L	C	D	G	F	Panel Hole Size	Max. Panel Thickness
1/4	SS-BU-60S4	1.88 (47.8)	0.50 (12.7)	0.09 (2.3)	0.63 (15.9)	1.06 (27.0)	0.94 (23.8)	0.38 (9.7)
3/8	SS-BU-60S6	2.38 (60.5)	0.53 (13.5)	0.13 (3.3)	0.81 (20.6)	1.38 (34.9)	1.13 (28.6)	0.38 (9.7)
9/16	SS-BU-60S9	2.75 (69.9)	0.81 (20.6)	0.19 (4.8)	1.19 (30.2)	1.88 (47.6)	1.69 (42.9)	0.38 (9.7)

Caps

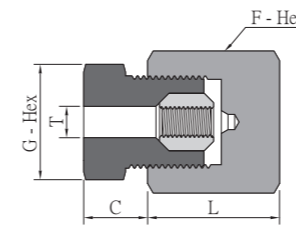

Tube		Dimensions, in. (mm)			
T - Tube O.D. in.	Ordering Number	L	C	G	F
1/4	SS-TC-60S4	0.75 (19.1)	0.50 (12.7)	0.63 (15.9)	0.75 (19.1)
3/8	SS-TC-60S6	1.13 (28.6)	0.53 (13.5)	0.81 (20.6)	1.00 (25.4)
9/16	SS-TC-60S9	1.38 (34.9)	0.81 (20.6)	1.19 (30.2)	1.38 (34.9)

Elbows

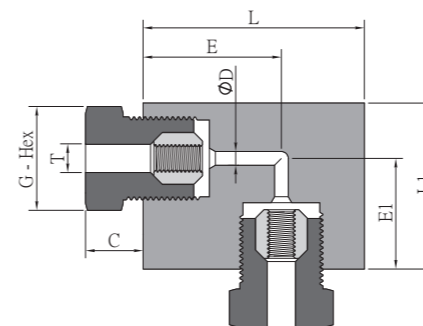

Tube		Dimensions, in. (mm)							
T - Tube O.D. in.	Ordering Number	C	D	G	L	E	L1	E1	Thickness
1/4	SS-LU-60S4	0.50 (12.7)	0.09 (2.3)	0.63 (15.9)	1.50 (38.1)	0.88 (22.4)	1.00 (25.4)	0.62 (15.7)	0.75 (19.1)
3/8	SS-LU-60S6	0.53 (13.5)	0.13 (3.3)	0.81 (20.6)	2.00 (50.8)	1.25 (31.8)	1.50 (38.1)	1.00 (25.4)	1.00 (25.4)
9/16	SS-LU-60S9	0.81 (20.6)	0.19 (4.8)	1.19 (30.2)	2.62 (66.5)	1.88 (47.8)	1.88 (47.8)	1.12 (28.4)	1.50 (38.1)

Tees

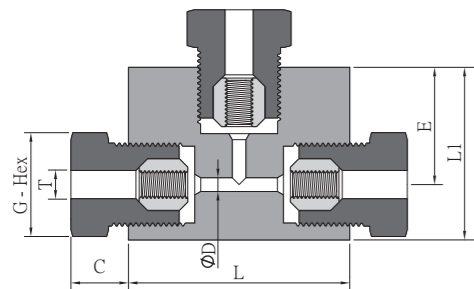

Tube		Dimensions, in. (mm)						
T - Tube O.D. in.	Ordering Number	C	D	G	L	L1	E	Thickness
1/4	SS-TTT-60S4	0.50 (12.7)	0.09 (2.3)	0.63 (15.9)	2.00 (50.8)	1.25 (31.8)	0.88 (22.4)	0.75 (19.1)
3/8	SS-TTT-60S6	0.53 (13.5)	0.13 (3.3)	0.81 (20.6)	2.00 (50.8)	1.56 (39.6)	1.06 (26.9)	1.00 (25.4)
9/16	SS-TTT-60S9	0.81 (20.6)	0.19 (4.8)	1.19 (30.2)	2.62 (66.5)	2.12 (53.8)	1.38 (35.0)	1.50 (38.1)

Crosses

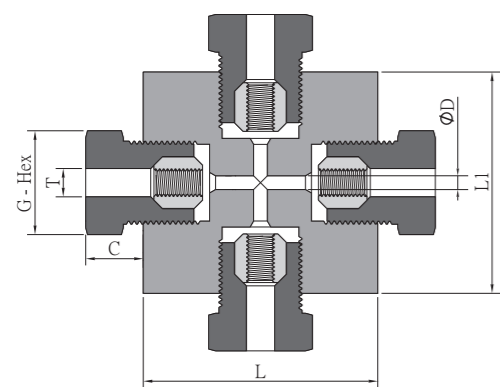

Tube		Dimensions, in. (mm)					
T - Tube O.D. in.	Ordering Number	C	D	G	L	L1	Thickness
1/4	SS-C-60S4	0.50 (12.7)	0.09 (2.3)	0.63 (15.9)	2.00 (50.8)	1.25 (31.8)	0.75 (19.1)
3/8	SS-C-60S6	0.53 (13.5)	0.13 (3.3)	0.81 (20.6)	2.00 (50.8)	2.12 (53.8)	1.00 (25.4)
9/16	SS-C-60S9	0.81 (20.6)	0.19 (4.8)	1.19 (30.2)	2.62 (66.5)	2.75 (69.9)	1.50 (38.1)

Anti-Vibration Gland Assemblies

The extreme vibration or shock, such as mobile pressure systems or long tubing runs culminating at a compressor that the tubing systems are subjected to, will be prevented by using FINELOK Anti-Vibration Gland Assemblies. These assemblies use the same reliable connection geometries as the standard FINELOK fittings, with the added advantage of essentially unlimited vibrational fatigue life. A coned and threaded tube, when subjected to unusual or excessive vibration, may fail prematurely and break at the last thread. FINELOK Anti-Vibration Gland Assembly acts to move the fulcrum of vibration away from the threaded part of the tube and onto the strong, solid wall of the tubing. A wedge-like collet firmly holds the assembly in place, virtually eliminating premature tubing failure while reliably maintaining a leakage-free connection between the tube and the connection seat.

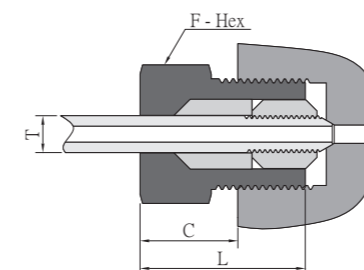

Tube		Dimensions, in. (mm)		
T - Tube O.D. in.	Ordering Number	L	G	F
1/4	SS-AVGA-60S4	0.81 (20.6)	0.50 (12.7)	0.63 (15.9)
3/8	SS-AVGA-60S6	1.12 (28.4)	0.62 (15.7)	0.81 (20.6)
9/16	SS-AVGA-60S9	1.50 (38.1)	1.00 (25.4)	1.19 (30.2)

Coned and Threaded Nipples

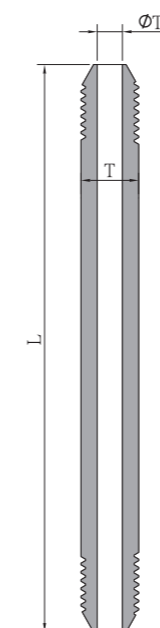

T - Tube O.D. in.	Tx - Tube I.D. in.	Ordering Number	L in. (mm)
1/4	0.083	SS-CTN-60S4-2.75	2.75 (69.9)
1/4	0.083	SS-CTN-60S4-3	3 (76.2)
1/4	0.083	SS-CTN-60S4-4	4 (101.6)
1/4	0.083	SS-CTN-60S4-6	6 (152.4)
1/4	0.083	SS-CTN-60S4-8	8 (203.2)
1/4	0.083	SS-CTN-60S4-10	10 (254.0)
1/4	0.083	SS-CTN-60S4-12	12 (304.8)
3/8	0.125	SS-CTN-60S6-3	3 (76.2)
3/8	0.125	SS-CTN-60S6-4	4 (101.6)
3/8	0.125	SS-CTN-60S6-6	6 (152.4)
3/8	0.125	SS-CTN-60S6-8	8 (203.2)
3/8	0.125	SS-CTN-60S6-10	10 (254.0)
3/8	0.125	SS-CTN-60S6-12	12 (304.8)
9/16	0.188	SS-CTN-60S9-4	4 (101.6)
9/16	0.188	SS-CTN-60S9-6	6 (152.4)
9/16	0.188	SS-CTN-60S9-8	8 (203.2)
9/16	0.188	SS-CTN-60S9-10	10 (254.0)
9/16	0.188	SS-CTN-60S9-12	12 (304.8)

60 Series Tubing

- ☆ Working pressure: 60000 psig (4137 bar).
- ☆ 316 and 304 stainless steel are standard material. Other materials are available upon request.
- ☆ Material, size, and heat code are indicated on the tubing surface.

T - Tube O.D. in.	Tx - Tube I.D. in.	Material	Basic Ordering Number	Tolerance O.D. in. (mm)
1/4	0.083	316 SS	SS-HT-60S4-	0.248/0.243(6.30/6.17)
1/4	0.083	304 SS	S4-HT-60S4-	0.248/0.243(6.30/6.17)
3/8	0.125	316 SS	SS-HT-60S6-	0.370/0.365(9.40/9.27)
3/8	0.125	304 SS	S4-HT-60S6-	0.370/0.365(9.40/9.27)
9/16	0.188	316 SS	SS-HT-60S9-	0.557/0.552(14.15/14.02)
9/16	0.188	304 SS	S4-HT-60S9-	0.557/0.552(14.15/14.02)

Add the actual foot (feet)/meter (meters) as a suffix to the basic ordering number to get the complete ordering number.

For example:

1. 10 feet length, O.D. is 1/4", I.D. is 0.083", 316 SS 60 Series tube, the complete ordering number is: **SS-HT-60S4-10**.
2. 3 meters length, O.D. is 9/16", I.D. is 0.188", 304 SS 60 Series tube, the complete ordering number is: **S4-HT-60S9-3M**.