

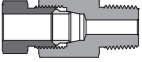

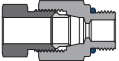

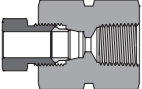



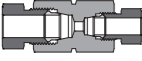

15 Series Tube Fittings and Tubes

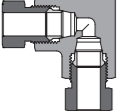
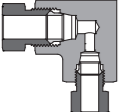
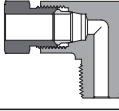
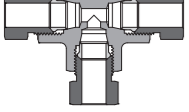
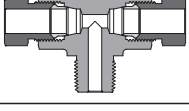
15,000 psi (1034 bar)

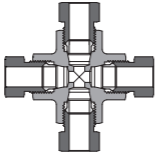
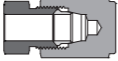

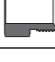
Contents

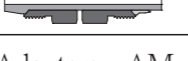
15 Series Tubing	5
15 Series Tube Fittings	
Male Connectors - MC	
NPT Thread	
	
Heavy-Duty SAE/MS	
	7
Female Connectors - FC	
	7
Unions - U	
	8
Reducing Unions - U	
	8
Bulkhead Unions - BU	
	8
Union Elbows - LU	
	9
Union Reducing Elbows - LU	
	9
Male Elbows - LM	
	9
Union Tees - TTT	
	10
Male Branch Tees - TTM	
	10

Union Crosses - C	
	10
Caps - TC	
	11
Plugs - TP	
	11
Nuts - N	
	11
Ferrules - FE	
	11
Reducers - R	
	12
Port Connectors - P	
	12
Adapters - AM	
	12

15 Series Tube Fittings and Tubes

Features

- ☆ Pressures up to 15000 psig (1034 bar).
- ☆ Fittings are easy to disconnect and retighten.
- ☆ Every fitting is stamped with size, material, and heat code.
- ☆ Radius junction design with elbows provides smooth flow path.
- ☆ Male nut threads are molybdenum disulfide-based lubricant to minimize the friction.
- ☆ Hardened threads and smoothed surface finishes extend fitting life and prevent sticking of the matching threads.

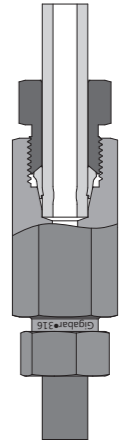

Materials of Construction

Component	Material	ASTM
Body, ferrule	316 stainless steel	A276
Nut	316 stainless steel	A276

Wetted component listed italics.

Working Pressure

Working pressure are dependent on the end connection with the lowest working pressures. Working pressure for the end connections used in this catalog are identified below.

15 Series Tube Ends

The maximum working pressure of the 15 Series tube ends at ambient temperature are rated by the used FINELOK 15 Series tubings. Refer to FINELOK 15 Series tubing data.

Heavy-Duty SAE/MS Ends

Heavy-duty SAE/MS end connections listed in this catalog are rated to 63 Mpa (9137 psig), in according to SAE J1926-2.

NPT Pipe Thread Ends ^①

NPT Size	Working Pressure, psig (bar)
1/16	15000 (1034)
1/8	
1/4	
3/8	
1/2	10000 (689)
3/4	
1	

① No allowance is made for corrosion, erosion, or elevated temperatures.

Elevated Temperature Factors

To get the maximum working pressure at elevated temperature, use the maximum working pressure at ambient temperature to multiply the factors in the table below.

Material	Temperature		Factor
	°F	°C	
316	100	38	1
	200	93	1
	300	149	1
	400	204	0.97
	500	260	0.90
	600	316	0.85
	700	371	0.82
	800	427	0.80

Working Temperature

Connection	Temperature Rating
15 Series Tube Ends	-325°F(-198°C) to 800°F(427°C)
Heavy-Duty SAE/MS Ends	0°F(-17.8°C) to 400°F(204°C)
NPT Pipe Thread Ends	-325°F(-198°C) to 400°F(204°C)

Installation Instructions

15 Series Tube Fitting (for tube O.D. 1/8", 1/4", 3/8" and 1/2")

☆Join the ferrule end directly to the body, follow the steps below:

1. Put nut and ferrule on tubing in proper sequence and orientation (Fig. 1).
2. Install finger-tight into the body of the fitting or the valve, make sure that the tubing rests firmly on the shoulder of the port (Fig. 2).
3. Tighten the nut until the tubing cannot be turned by hand, than scribe the nut and the body (Fig. 3).
4. Tighten the nut 1/4 turns with wrench while holding steady the body of the fitting or the valve (Fig. 4).

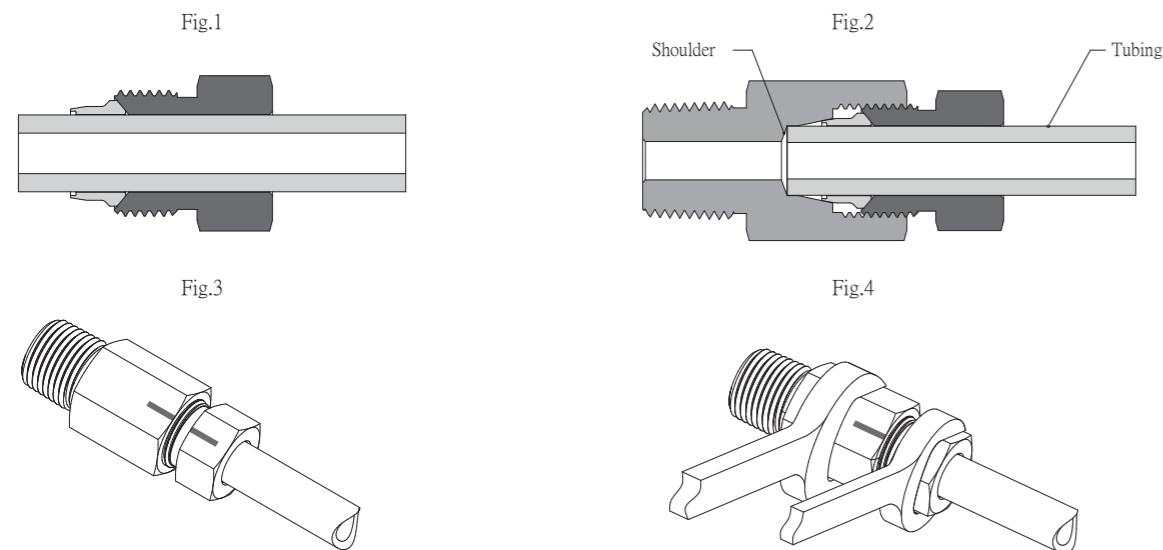

☆ First preassembly the ferrule end by using the manual preassemble tool, then join the ferrule end to the body, follow the steps below:

1. Put nut and ferrule on tubing in proper sequence and orientation (Fig. 1).
2. Install finger-tight into the preswaging tool, make sure that the tubing rests firmly on the shoulder of the port (Fig. 5).
3. Tighten the nut until the tubing cannot be turned by hand, than scribe the nut and the preswaging tool (Fig. 6).
4. Tighten the nut 1/4 turns with wrench while holding steady the preswaging tool.
5. Loosen the nut and remove the tubing with preswaged ferrule from the preswaging tool (Fig. 7).
Note: If the tubing sticks in the preswaging tool, remove the tube by gently rocking it back and forth. Do not turn the tubing.
6. Insert the ferrule end into the body of the fitting or the valve, rotate the nut finger-tight (Fig. 8).
7. Tighten the nut 1/4 turn with wrench while holding steady the body.

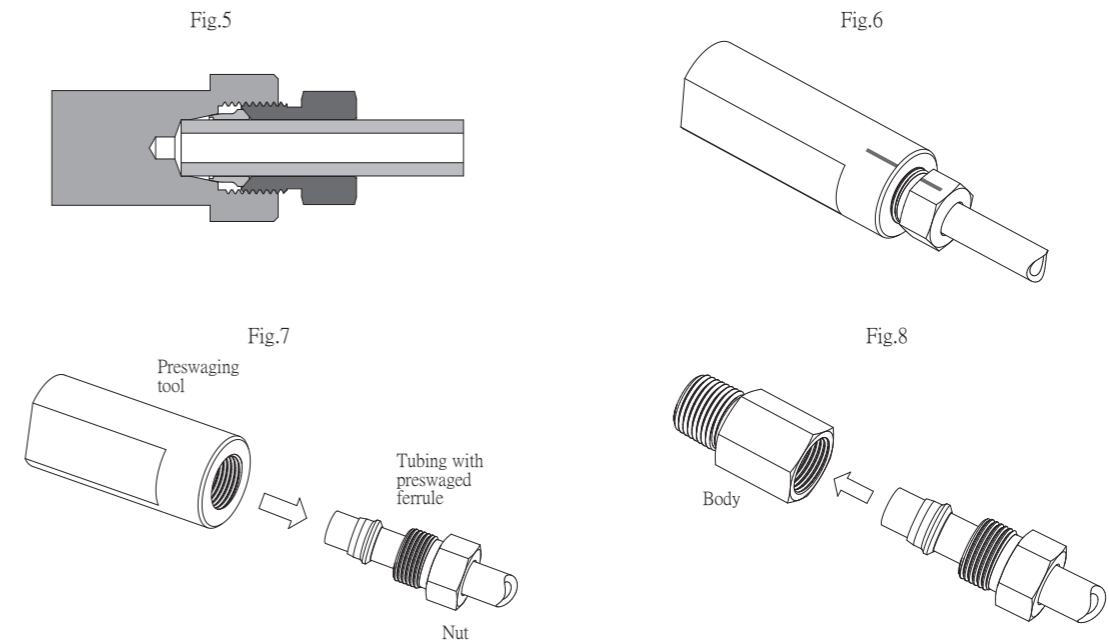

15 Series Tube Fitting (for tube O.D. 9/16" and 3/4")

☆ First preassembly the ferrule end by using the Hydraulic preassemble tool, then join the ferrule end to the body, follow the steps below:

1. Preassembly the ferrule end by using the Hydraulic preassemble tool, supporting details please see the Introduction of the Hydraulic preassemble tool.
2. Insert the ferrule end into the body of fitting or the valve, rotate the nut finger-tight.
3. Tighten the nut 1/4 turn with wrench.

Ferrule end of Reducer, Port connector and Adapter

1. The ferrule end of Reducer, Port connector and Adapter have been preassembled before delivery, the installation should follow the reinstallation instruction.

Plugs and Non-ferrule end of Port Connectors

1. Insert the Plug or non-ferrule end of Port Connector into the body of fitting or the valve, rotate the nut finger-tight.
2. Tighten the nut 1/4 turn with wrench.

Reinstallation Instructions

☆ You may disassemble and reassemble the tube fitting many times.

1. Insert the ferrule end into the body of fitting or the valve, rotate the nut finger-tight.
2. Tighten the nut 1/4 turn with wrench while holding steady the body of fitting or the valve. After frequent reassemblies, it may take less than 1/4 turn to affect a gas-tight seal and as little as 1/8 of a turn may be sufficient.

Remarks

1. The ferrule end comprising the tubing, the ferrule and the nut.
2. Do not dismounting the connection when the system is under pressure.
3. When assemble the tube fitting, hold the body with a wrench and turn the nut instead of holding the nut.
4. When install a valve with tube fitting end, hold the valve body with a wrench and turn the nut.
5. When assemble the fitting to a valve with thread, hold the valve body with a wrench and turn the body of the fitting.

Tools and Accessories

Preswaging Tool

Tube O.D.	Ordering Number
1/4 in.	PST-4
3/8 in.	PST-6
1/2 in.	PST-8

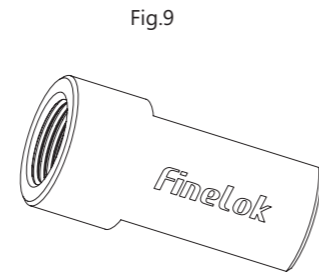

15 Series Tubing

Features

- ☆ Working pressures up to 15 000 psig (1034 bar)
- ☆ Material, size, pressure and heat code are indicated on the tubing surface

Material Standards

FINELOK 15 Series Tube Fittings Used with Heavy-Wall Annealed Stainless Steel Tubing.

Grade	UNS	Specification
316/316L	S31600/S31603	ASTM A213, 269
		ASME SA213

Working Pressure

- ☆ The allowable working pressures in the table below are based on ASME B31.3 at ambient temperature.
- ☆ To work out the allowable working pressure at elevated temperature, take allowable working pressure at ambient temperature to multiply the factors in the table of Elevated Temperature Factors in page 2.

Tube O.D. in.	Wall Thickness in.	Working Pressure ^① psig (bar)
1/8	0.037	15000 (1034)
1/4	0.083	15000 (1034)
1/4	0.065	10300 (710)
3/8	0.118	15000 (1034)
3/8	0.095	10000 (689)
1/2	0.156	15000 (1034)
1/2	0.134	11200 (772)
9/16	0.188	15000 (1034)
3/4	0.240	15000 (1034)
3/4	0.188	10000 (689)

① No allowance is made for corrosion, erosion, or elevated temperatures.

Ordering Information

Tube O.D. in.	Wall Thickness in.	Basic Ordering Number	Weight lb/ft (kg/m)
1/8	0.037	SS-15T2-037-	0.035(0.053)
1/4	0.083	SS-15T4-083-	0.15 (0.22)
1/4	0.065	SS-15T4-065-	0.13 (0.19)
3/8	0.118	SS-15T6-118-	0.33 (0.49)
3/8	0.095	SS-15T6-095-	0.29 (0.43)
1/2	0.156	SS-15T8-156-	0.58 (0.87)
1/2	0.134	SS-15T8-134-	0.53 (0.79)
9/16	0.188	SS-15T9-188-	0.77 (1.14)
3/4	0.240	SS-15T12-240-	1.33 (1.98)
3/4	0.188	SS-15T12-188-	1.15 (1.71)

Add the actual foot (feet)/meter (meters) to the basic ordering number to get the complete ordering number.

For example:

1. 10 feet length, outside diameter 1/2", wall thickness 0.156", 316 SS seamless tube, the complete ordering number is: SS-15T8-156-10.

2. 3 meters length, outside diameter 3/4", wall thickness 0.188", 316 SS seamless tube, the complete ordering number is: SS-15T12-188-3M.

15 Series Tube Fittings

Male Connectors

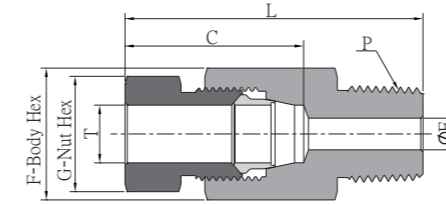

Tube			NPT Thread				
T - Tube O.D. in.	P - NPT Size	Ordering Number	Dimensions, mm				
			L	C	E	F	G
1/8	1/8	SS-MC-15S2-NT2	36.6	23.1	2.4	12.7	9.5
1/8	1/4	SS-MC-15S2-NT4	39.8	23.1	2.4	14.3	9.5
1/8	3/8	SS-MC-15S2-NT6	39.8	23.1	2.4	17.5	9.5
1/4	1/8	SS-MC-15S4-NT2	45.1	30.8	4.8	15.9	15.9
1/4	1/4	SS-MC-15S4-NT4	48.4	30.8	4.8	15.9	15.9
1/4	3/8	SS-MC-15S4-NT6	48.4	30.8	4.8	17.5	15.9
1/4	1/2	SS-MC-15S4-NT8	54.6	30.8	4.8	22.2	15.9
3/8	1/4	SS-MC-15S6-NT4	51.7	32.7	6.4	19.1	19.1
3/8	3/8	SS-MC-15S6-NT6	51.7	32.7	6.4	19.1	19.1
3/8	1/2	SS-MC-15S6-NT8	54.9	32.7	6.4	22.2	19.1
1/2	1/4	SS-MC-15S8-NT4	59.8	35.9	6.4	25.4	23.8
1/2	3/8	SS-MC-15S8-NT6	59.8	35.9	7.9	25.4	23.8
1/2	1/2	SS-MC-15S8-NT8	62.9	35.9	9.5	25.4	23.8
1/2	3/4	SS-MC-15S8-NT12	59.8	35.9	9.5	27.0	23.8
9/16	1/4	SS-MC-15S9-NT4	71.1	44.5	6.4	28.6	27.0
9/16	1/2	SS-MC-15S9-NT8	73.2	44.5	10.4	28.6	27.0
3/4	1/2	SS-MC-15S12-NT8	87.6	60.2	10.4	38.1	34.9
3/4	3/4	SS-MC-15S12-NT12	87.6	60.2	14.2	38.1	34.9
3/4	1	SS-MC-15S12-NT16	89.9	60.2	14.2	38.1	34.9

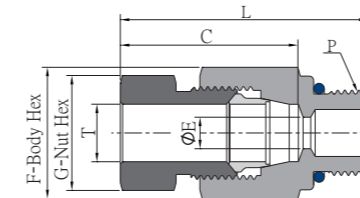

Tube			Heavy-Duty SAE/MS				
T - Tube O.D. in.	P - SAE/MS Thread Size	Ordering Number	Dimensions, mm				
			L	C	E	F	G
1/8	7/16-20	SS-MC-15S2-SH7	36.7	23.1	2.4	14.3	9.5
1/8	9/16-18	SS-MC-15S2-SH9	38.2	23.1	2.4	17.5	9.5
1/4	7/16-20	SS-MC-15S4-SH7	47.3	30.8	4.5	15.9	15.9
1/4	9/16-18	SS-MC-15S4-SH9	48.3	30.8	4.8	17.5	15.9
3/8	7/16-20	SS-MC-15S6-SH7	49.6	32.7	4.5	19.1	19.1
3/8	9/16-18	SS-MC-15S6-SH9	50.6	32.7	6.4	19.1	19.1
1/2	7/16-20	SS-MC-15S8-SH7	58.8	35.9	4.5	25.4	23.8
1/2	9/16-18	SS-MC-15S8-SH9	58.8	35.9	7.5	25.4	23.8

Female Connectors

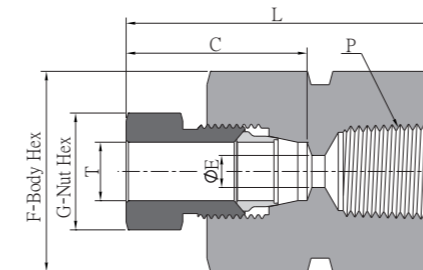

Tube			NPT Thread				
T - Tube O.D. in.	P - NPT Size	Ordering Number	Dimensions, mm				
			L	C	E	F	G
1/8	1/8	SS-FC-15S2-NT2	46.1	23.1	2.4	15.9	9.5
1/8	1/4	SS-FC-15S2-NT4	49.3	23.1	2.4	23.8	9.5
1/4	1/4	SS-FC-15S4-NT4	54.7	30.8	4.8	23.8	15.9
3/8	1/4	SS-FC-15S6-NT4	58.1	32.7	6.4	23.8	19.1
1/2	1/4	SS-FC-15S8-NT4	50.6	32.7	6.4	25.4	23.8
1/2	1/2	SS-FC-15S8-NT8	58.8	35.9	4.5	34.9	23.8
3/4	1/2	SS-FC-15S12-NT8	58.8	35.9	7.5	38.1	34.9

Unions

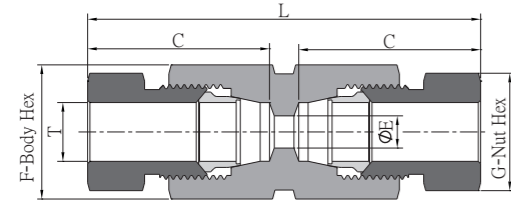

Tube		Dimensions, mm				
T - Tube O.D. in.	Ordering Number	L	C	E	F	G
1/8	SS-U-15S2	54.2	23.1	2.4	12.7	9.5
1/4	SS-U-15S4	67.8	30.8	4.8	15.9	15.9
3/8	SS-U-15S6	71.7	32.7	6.4	19.1	19.1
1/2	SS-U-15S8	81.4	35.9	9.5	25.4	23.8
9/16	SS-U-15S9	101.1	44.5	10.4	28.6	27.0
3/4	SS-U-15S12	132.9	60.2	14.2	38.1	34.9

Reducing Unions

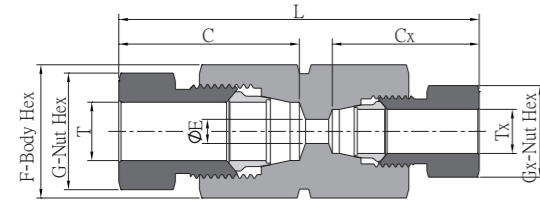

Tube		Dimensions, mm								
T - Tube O.D. in.	Tx - Tube O.D. in.	Ordering Number	L	C	Cx	E	F	G	Gx	
1/4	1/8	SS-U-15S4-15S2	61.0	30.8	23.1	2.4	15.9	15.9	9.5	
3/8	1/8	SS-U-15S6-15S2	62.9	32.7	23.1	2.4	19.1	19.1	9.5	
3/8	1/4	SS-U-15S6-15S4	69.8	32.7	30.8	4.8	19.1	19.1	15.9	
1/2	1/4	SS-U-15S8-15S4	76.2	35.9	30.8	4.8	25.4	23.8	15.9	
1/2	3/8	SS-U-15S8-15S6	76.5	35.9	32.7	6.4	25.4	23.8	19.1	
9/16	1/2	SS-U-15S9-15S8	92.2	44.5	34.1	9.5	28.6	27.0	23.8	
3/4	1/2	SS-U-15S12-15S8	108.2	60.2	34.1	9.5	38.1	34.9	23.8	

Bulkhead Unions

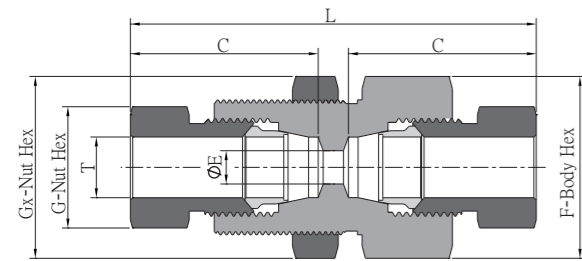

Tube		Dimensions, mm								Panel Hole Size	Maximum Panel Thickness
T - Tube O.D. in.	Ordering Number	L	C	E	F	G	Gx				
1/8	SS-BU-15S2	67.0	23.1	2.4	19.1	9.5	20.6	17.5	9.5		
1/4	SS-BU-15S4	74.3	30.8	4.8	25.4	15.9	25.4	23.8	9.5		
3/8	SS-BU-15S6	74.9	32.7	6.4	25.4	19.1	27.0	23.8	9.5		
1/2	SS-BU-15S8	90.9	35.9	9.5	34.9	23.8	34.9	28.6	9.5		
9/16	SS-BU-15S9	106.1	44.5	10.4	41.3	27.0	41.3	33.7	9.5		
3/4	SS-BU-15S12	132.9	60.2	14.2	47.6	34.9	47.6	41.7	9.5		

Union Elbows

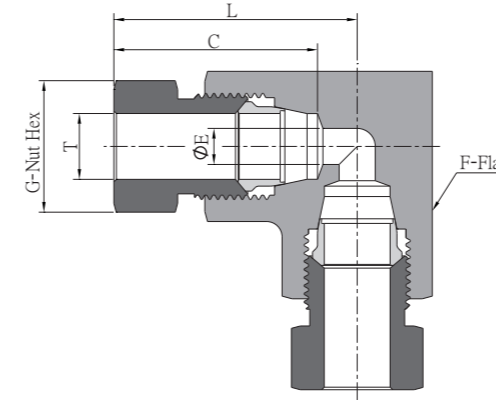

Tube		Dimensions, mm				
T - Tube O.D. in.	Ordering Number	L	C	E	F	G
1/8	SS-LU-15S2	30.3	23.1	2.4	12.7	9.5
1/4	SS-LU-15S4	38.7	30.8	4.8	15.9	15.9
3/8	SS-LU-15S6	39.0	32.7	6.4	19.1	19.1
1/2	SS-LU-15S8	47.1	35.9	9.5	25.4	23.8
9/16	SS-LU-15S9	56.9	44.5	10.4	38.1	27.0
3/4	SS-LU-15S12	76.9	60.2	14.2	38.1	34.9

Union Reducing Elbows

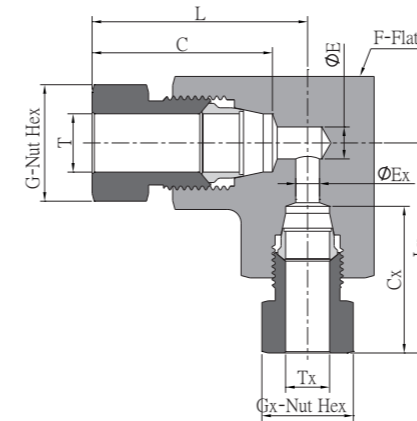

Tube		Dimensions, mm								
T - Tube O.D. in.	Tx - Tube O.D. in.	Ordering Number	L	Lx	C	Cx	Ex	F	G	Gx
1/4	1/8	SS-LU-15S4-15S2	38.7	30.3	30.8	23.1	2.4	15.9	15.9	9.5
3/8	1/8	SS-LU-15S6-15S2	39.0	30.3	32.7	23.1	2.4	19.1	19.1	9.5
3/8	1/4	SS-LU-15S6-15S4	39.0	38.7	32.7	30.8	4.8	19.1	19.1	15.9
1/2	1/4	SS-LU-15S8-15S4	47.1	45.0	35.9	30.8	4.8	25.4	23.8	15.9
1/2	3/8	SS-LU-15S8-15S6	47.1	45.3	35.9	32.7	6.5	25.4	23.8	19.1
9/16	1/2	SS-LU-15S9-15S8	56.9	54.4	44.5	34.1	9.5	38.1	27.0	23.8
3/4	1/2	SS-LU-15S12-15S8	76.9	63.8	60.2	34.1	9.5	38.1	34.9	23.8

Male Elbows

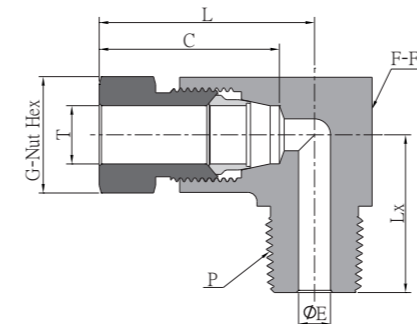

Tube		Dimensions, mm							NPT Thread	
T - Tube O.D. in.	P - NPT Size	Ordering Number	L	Lx	C	E	F	G		
1/8	1/8	SS-LM-15S2-NT2	30.3	17.5	23.1	2.4	12.7	9.5		
1/8	1/4	SS-LM-15S2-NT4	30.3	23.8	23.1	2.4	15.9	9.5		
1/8	3/8	SS-LM-15S2-NT6	33.4	25.4	23.1	2.4	19.1	9.5		
1/4	1/4	SS-LM-15S4-NT4	38.7	23.8	30.8	4.8	15.9	15.9		
1/4	3/8	SS-LM-15S4-NT6	38.7	25.4	30.8	4.8	19.1	15.9		
1/4	1/2	SS-LM-15S4-NT8	38.7	34.9	30.8	4.8	25.4	15.9		
3/8	1/4	SS-LM-15S6-NT4	39.0	25.4	32.7	6.4	19.1	19.1		
3/8	3/8	SS-LM-15S6-NT6	39.0	27.0	32.7	6.4	19.1	19.1		
3/8	1/2	SS-LM-15S6-NT8	39.0	34.9	32.7	6.4	25.4	19.1		
1/2	1/4	SS-LM-15S8-NT4	47.1	30.2	35.9	6.4	25.4	23.8		
1/2	3/8	SS-LM-15S8-NT6	47.1	30.2	35.9	7.9	25.4	23.8		
1/2	1/2	SS-LM-15S8-NT8	47.1	34.9	35.9	9.5	25.4	23.8		
9/16	1/2	SS-LM-15S9-NT8	56.9	43.9	44.5	10.4	38.1	27.0		
3/4	1/2	SS-LM-15S12-NT8	76.9	43.9	60.2	10.4	38.1	34.9		
3/4	3/4	SS-LM-15S12-NT12	76.9	43.9	60.2	14.2	38.1	34.9		

Union Tees

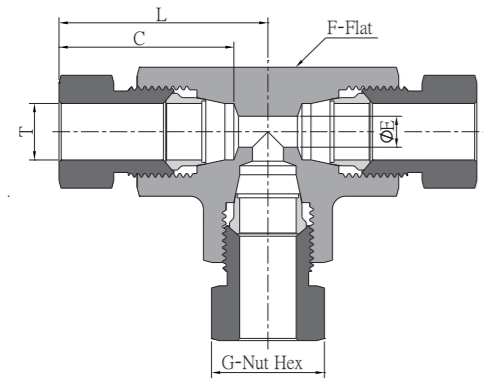

Tube		Dimensions, mm				
T - Tube O.D. in.	Ordering Number	L	C	E	F	G
1/8	SS-TTT-15S2	30.3	23.1	2.4	12.7	9.5
1/4	SS-TTT-15S4	38.7	30.8	4.8	15.9	15.9
3/8	SS-TTT-15S6	39.0	32.7	6.4	19.1	19.1
1/2	SS-TTT-15S8	47.1	35.9	9.5	25.4	23.8
9/16	SS-TTT-15S9	56.9	44.5	10.4	38.1	27.0
3/4	SS-TTT-15S12	76.9	60.2	14.2	38.1	34.9

Caps

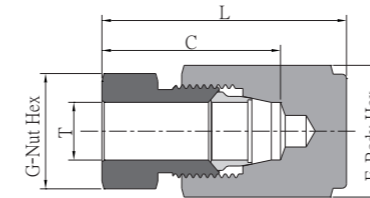

Tube		Dimensions, mm			
T - Tube O.D. in.	Ordering Number	L	C	F	G
1/8	SS-TC-15S2	27.1	23.1	12.7	9.5
1/4	SS-TC-15S4	38.7	30.8	15.9	15.9
3/8	SS-TC-15S6	41.4	32.7	19.1	19.1
1/2	SS-TC-15S8	47.1	35.9	25.4	23.8
9/16	SS-TC-15S9	56.9	44.5	28.6	27.0
3/4	SS-TC-15S12	76.9	60.2	38.1	34.9

Male Branch Tees

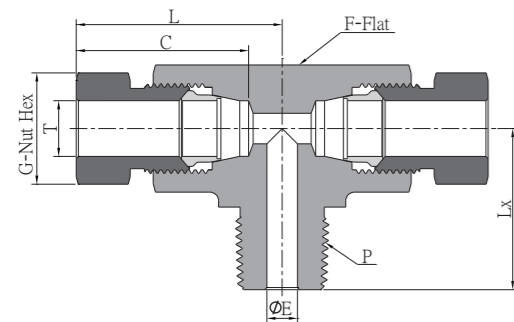

Tube		NPT Thread						
T - Tube O.D. in.	P - NPT Size	Ordering Number	Dimensions, mm					G
			L	Lx	C	E	F	
1/8	1/8	SS-TTM-15S2-NT2	30.3	19.1	23.1	2.4	12.7	9.5
1/8	1/4	SS-TTM-15S2-NT4	30.3	25.4	23.1	2.4	15.9	9.5
1/4	1/8	SS-TTM-15S4-NT2	38.7	20.6	30.8	4.8	15.9	15.9
1/4	1/4	SS-TTM-15S4-NT4	38.7	25.4	30.8	4.8	15.9	15.9
3/8	1/4	SS-TTM-15S6-NT4	39.0	27.0	32.7	6.4	19.1	19.1
1/2	1/4	SS-TTM-15S8-NT4	47.1	30.2	35.9	6.4	25.4	23.8
1/2	3/8	SS-TTM-15S8-NT6	47.1	30.2	35.9	7.9	25.4	23.8
3/4	3/4	SS-TTM-15S12-NT12	76.9	46.0	60.2	14.2	38.1	34.9

Plugs

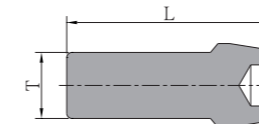

Tube		Dimensions, mm
T - Tube O.D. in.	Ordering Number	L
1/8	SS-TP-15S2	21.9
1/4	SS-TP-15S4	28.8
3/8	SS-TP-15S6	30.0
1/2	SS-TP-15S8	32.0
9/16	SS-TP-15S9	39.5
3/4	SS-TP-15S12	52.8

Nuts

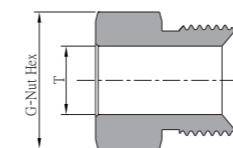

Tube		Dimensions, mm
T - Tube O.D. in.	Ordering Number	G
1/8	SS-N-15S2	9.5
1/4	SS-N-15S4	15.9
3/8	SS-N-15S6	19.1
1/2	SS-N-15S8	23.8
9/16	SS-N-15S9	27.0
3/4	SS-N-15S12	34.9

Union Crosses

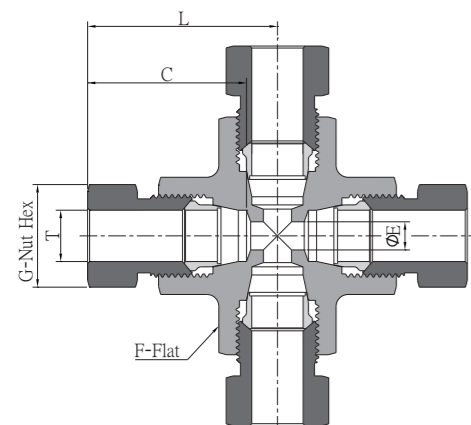

Tube		Dimensions, mm				
T - Tube O.D. in.	Ordering Number	L	C	E	F	G
1/8	SS-C-15S2	30.3	23.1	2.4	12.7	9.5
1/4	SS-C-15S4	38.7	30.8	4.8	15.9	15.9
3/8	SS-C-15S6	39.0	32.7	6.4	19.1	19.1
1/2	SS-C-15S8	47.1	35.9	9.5	25.4	23.8

Ferrules

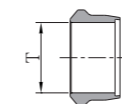

Tube		Ordering Number
T - Tube O.D. in.		
1/8		SS-FE-15S2
1/4		SS-FE-15S4
3/8		SS-FE-15S6
1/2		SS-FE-15S8
9/16		SS-FE-15S9
3/4		SS-FE-15S12

Reducers

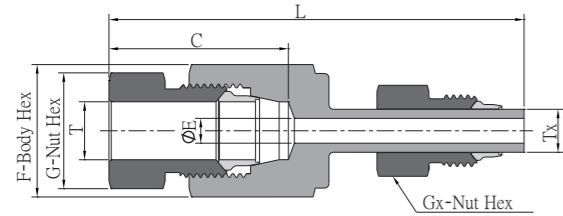

Tube			Dimensions, mm						
T - Tube O.D. in.	Tx - Tube O.D. in.	Ordering Number	L	C	E	F	G	Gx	
1/4	3/8	SS-R-15S4-FM6	73.4	30.8	4.8	15.9	15.9	19.1	
1/4	1/2	SS-R-15S4-FM8	76.6	30.8	4.8	15.9	15.9	23.8	
3/8	1/2	SS-R-15S6-FM8	79.3	32.7	6.4	19.1	19.1	23.8	
1/2	3/8	SS-R-15S8-FM6	81.9	35.9	5.3	25.4	23.8	19.1	
1/2	3/4	SS-R-15S8-FM12	118.4	34.1	9.5	25.4	23.8	34.9	
9/16	3/4	SS-R-15S9-FM12	121.7	44.5	10.4	28.6	27.0	34.9	
3/4	9/16	SS-R-15S12-FM9	125.2	60.2	7.9	38.1	34.9	27.0	

Port Connectors

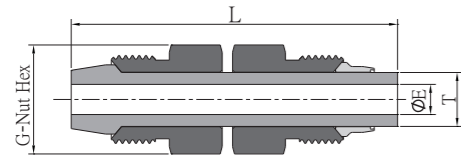

Tube		Dimensions, mm		
T - Tube O.D. in.	Ordering Number	L	E	G
1/4	SS-P-15S4	61.6	3.0	15.9
3/8	SS-P-15S6	64.7	5.3	19.1
1/2	SS-P-15S8	70.0	7.1	23.8
9/16	SS-P-15S9	83.6	7.9	27.0
3/4	SS-P-15S12	111.5	10.7	34.9

Adapters

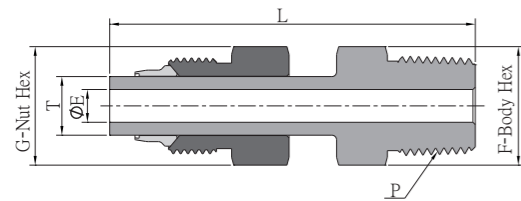

Tube			NPT Thread			
T - Tube O.D. in.	P - NPT Size	Ordering Number	Dimensions, mm			
			L	E	F	G
1/4	1/4	SS-AM-FM4-NT4	54.1	3.0	14.3	15.9
3/8	1/4	SS-AM-FM6-NT4	57.0	5.3	14.3	19.1
3/8	1/2	SS-AM-FM6-NT8	64.5	5.3	22.2	19.1
1/2	1/4	SS-AM-FM8-NT4	60.3	6.4	14.3	23.8
1/2	1/2	SS-AM-FM8-NT8	67.7	7.1	22.2	23.8
9/16	1/2	SS-AM-FM9-NT8	86.5	7.9	22.2	27.0
3/4	3/4	SS-AM-FM12-NT12	99.6	10.0	27.0	34.9

Note: Dimensions are for reference only, subject to change.