

Assembly and Parts

Models 1599, 1600, 1601 & 1602

Assembly Instructions

Models 1599, 1600, 1601 & 1602



(Parts List and Assembly on page 4)

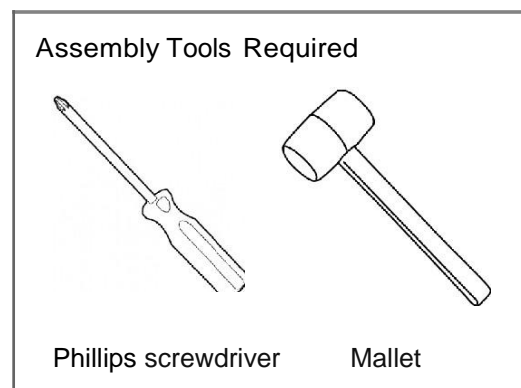
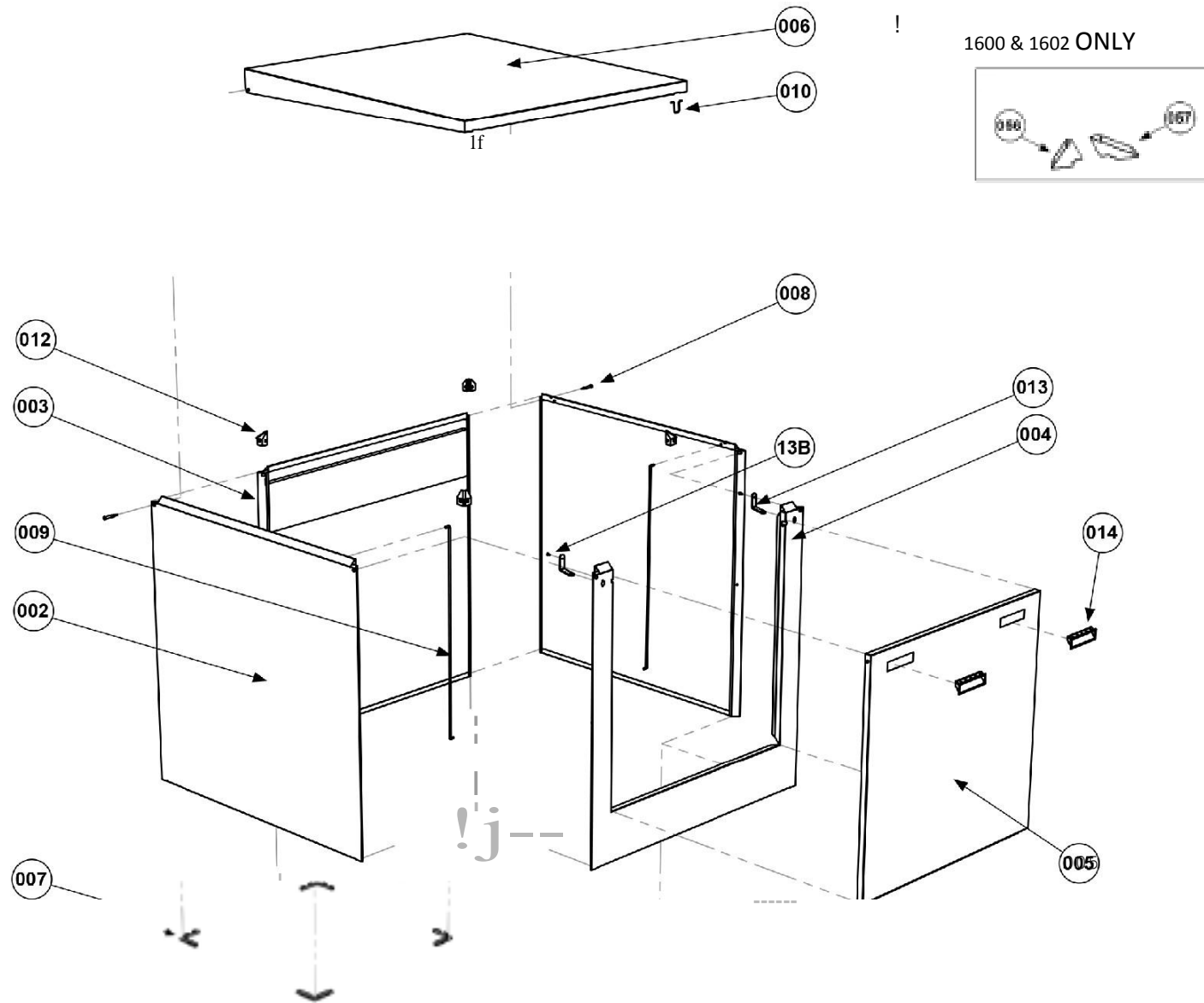

Part No.	Description	Qty
002	Side Panel	2
003	Rear Panel	1
004	Front Panel	1
005	Removable Front Door	1
006	Top Door	1
007	Corner Bracket	4
008	Hinge Pin	2
009/011	Door Stay / Gas struts	2
010	Door Latch	2
012	Plastic Cap	4
013	Lock Bracket	2
13B	Lock Screws	2
014	Door Handle	2
059	Top Corner Bracket LH (1600 & 1602)	1
060	Top Corner Bracket RH (1600 & 1602)	1

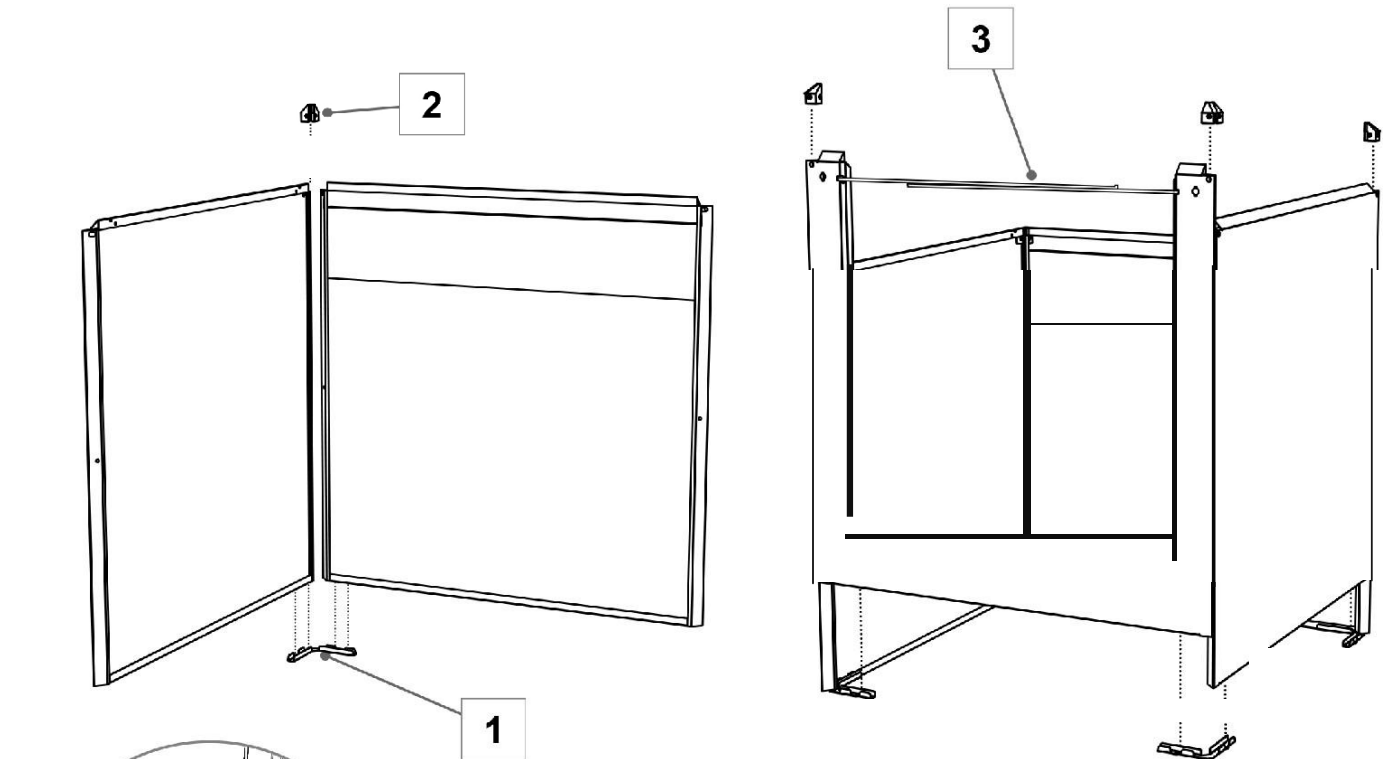

1. Locate slots on bottom of Side (002) and Rear (003) Panels and push down into Corner Bracket (007).

2. Insert Plastic Cap (012) into holes in top of Panels to join them. Tap into place with a mallet.

3. Repeat steps 1 and 2 for all panels.

Models 1600 & 1602 ONLY:
A metal dowel stabilises the front panel (004) during assembly. Detach dowel and discard AFTER completing step 3.



www.acousticbox.com.au

(02) 9620 5430

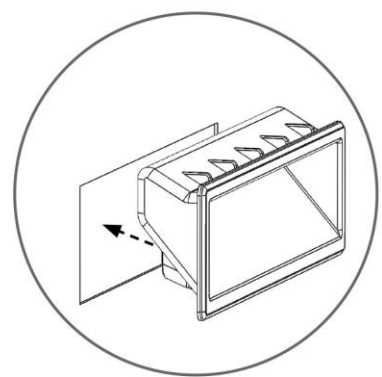
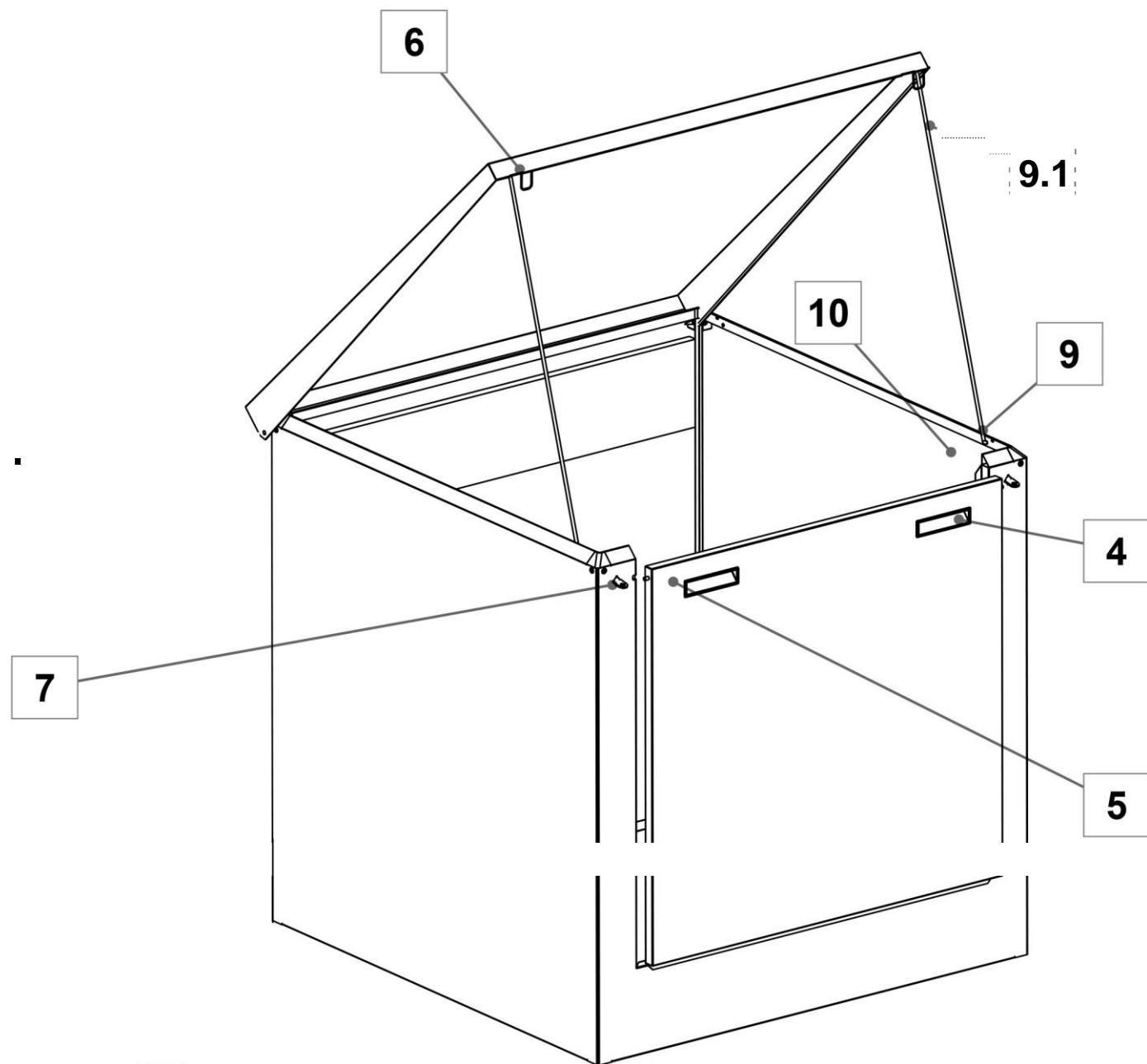

4. Push Door Handles (014) into Removable Front Door (005) until a 'click' is heard.

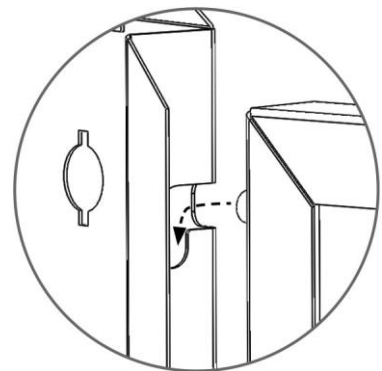

5. Insert Removable Front Door (005) into Front Panel (004). Locate studs on sides of Removable Front Panel then push slightly in and down.

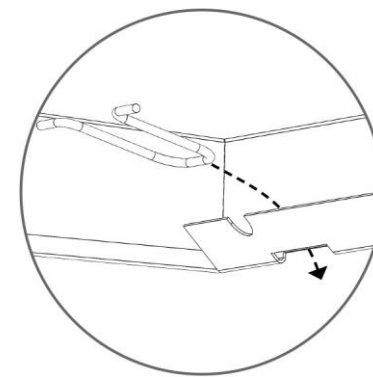

6. Insert Door Latches (010) through holes in Top Door (006).

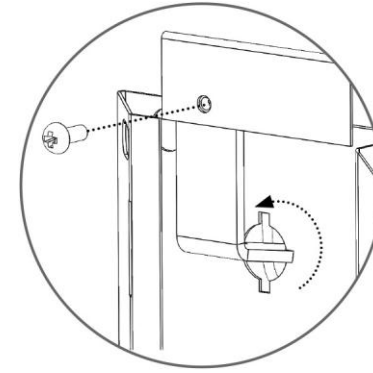

7. Connect Lock Brackets (013) to Front Panel (004) by inserting them sideways into holes. Twist into upright position and screw into place.

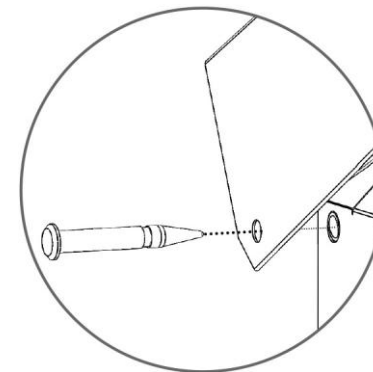

8. Attach Top Door (006) to unit with Hinge Pins (008). Tap into place with a mallet.

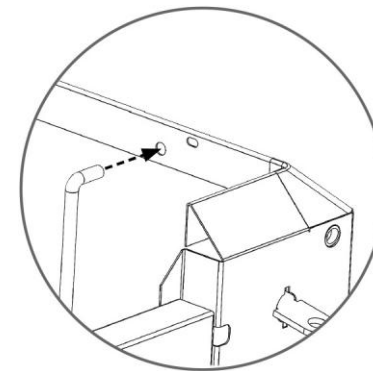

9. Insert Door Stays (009) into Side Panels.

To hold the lid open swivel door stays into place OR (for gas struts) please follow separate instructions packed with the struts

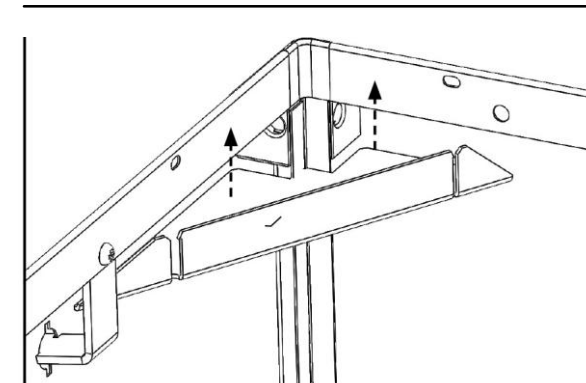

Models 1600 & 1602 ONLY:

10. Insert Top Corner Brackets (059 and 060) into Side and Front panels by Jamming in the corner and pushing upwards.