



Twin Stroke Piston Pump

**Models: 9145
9155
9175
9195**

Owner's Manual

Read this manual for complete instructions

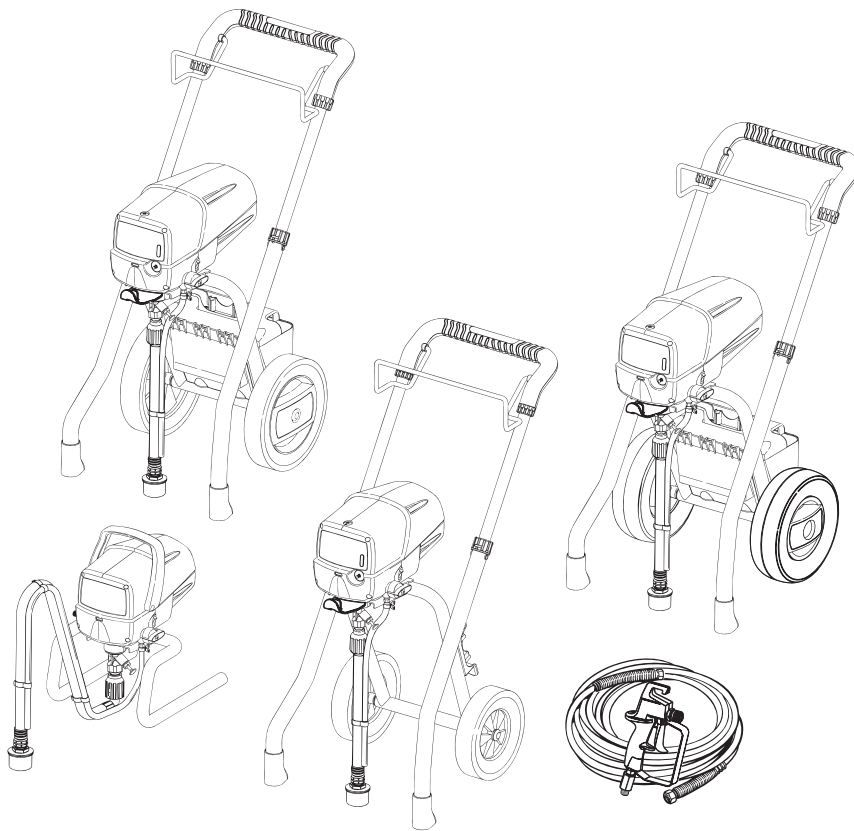

This pump is available in a stand model (9145) and cart models (9155, 9175 and 9195). All information given for the stand model applies to the cart models except where indicated.

Table of Contents

Safety.....	2-3
Components and Description	4-5
Assembly.....	6
Before You Begin	7
Locking the Spray Gun.....	7
Pressure Relief Procedure	7
Grounding the Spray Gun	7
Preparing the Sprayer.....	8
Preparing the Spray Hose.....	9
Practice / Spraying Technique	10
Spraying Troubleshooting.....	11-12
Unclogging the Spray Tip	11
Cleaning the Spray Gun Filter	12
Cleaning the Inlet Filter	12
Cleanup	13-17
Cleanup for Latex materials	13-14
Cleanup for Oil-based materials.....	15
Cleaning the Suction Set.....	16
Cleaning the Spray Gun Components.....	17
Short-Term Storage.....	18
Long-Term Storage	19
Cleaning the Inlet Valve	20
Fluid Section.....	21
Troubleshooting / Maintenance	22
Français.....	23
Español.....	45
Parts List.....	67-70
Accessories	71
Warranty.....	72



1-800-880-0993

Wagner Technical Service

Register your product online at:

<http://www.wagnerspraytech.com>

1770 Fernbrook Lane, Plymouth, MN 55447

Need Help? Call us first for answers fast. Call toll-free if you have any comments or problems with this product.

Technical service hours: Monday through Friday, 8:00 am to 4:30 pm Central Time



Important Safety Information • Read all safety information before operating the equipment. SAVE THESE INSTRUCTIONS.

To reduce the risks of fire or explosion, electrical shock and the injury to persons, read and understand all instructions included in this manual. Be familiar with the controls and proper usage of the equipment.



This symbol indicates a hazardous situation, which, if not not avoided could result in death or serious injury.

HAZARD: INJECTION INJURY

A high pressure paint stream produced by this equipment can pierce the skin and underlying tissues, leading to serious injury and possible amputation. See a physician immediately.



DO NOT TREAT AN INJECTION INJURY AS A SIMPLE CUT! Injection can lead to amputation. See a physician immediately.

The maximum operating range of the gun is 3000 PSI/207 BAR fluid pressure.

PREVENTION:

- NEVER aim the gun at any part of the body.
- Do not aim the gun at, or spray any person or animal.
- NEVER allow any part of the body to touch the fluid stream. DO NOT allow body to touch a leak in the fluid hose.
- NEVER put your hand in front of the gun. Gloves will not provide protection against an injection injury.
- ALWAYS lock the gun trigger, shut the pump off, and release all pressure before servicing, cleaning the tip or guard, changing tip, or leaving unattended. Pressure will not be released by turning off the motor. The PRIME/SPRAY knob must be turned to PRIME to relieve the pressure. Refer to the **Pressure Relief Procedure** (page 7) described in the pump manual.
- ALWAYS keep the tip guard in place while spraying. The tip guard provides some protection but is mainly a warning device.
- ALWAYS remove the spray tip before flushing or cleaning the system.
- Paint hose can develop leaks from wear, kinking and abuse. A leak can inject material into the skin. Inspect the hose before each use. Do not use hose to lift or pull equipment.
- NEVER use a spray gun without a working trigger lock and trigger guard in place.
- All accessories must be rated at or above 3000 PSI/207 BAR. This includes spray tips, guns, extensions, and hose.

NOTE TO PHYSICIAN:

Injection into the skin is a traumatic injury. It is important to treat the injury as soon as possible. DO NOT delay treatment to research toxicity. Toxicity is a concern with some coatings injected directly into the blood stream. Consultation with a plastic surgeon or reconstructive hand surgeon may be advisable.

HAZARD: HAZARDOUS VAPORS

Paints, solvents, insecticides, and other materials can be harmful if inhaled or come in contact with the body. Vapors can cause severe nausea, fainting, or poisoning.



PREVENTION:

- Use a respirator or mask if vapors can be inhaled. Read all instructions supplied with the mask to be sure it will provide the necessary protection.
- Wear protective eyewear.
- Wear protective clothing as required by coating manufacturer.



HAZARD: EXPLOSION OR FIRE

Solvent and paint fumes can explode or ignite. Property damage and/or severe injury can occur.



PREVENTION:

- Provide extensive exhaust and fresh air introduction to keep the air within the spray area free from accumulation of flammable vapors. Solvent and paint fumes can explode or ignite.
- Do not spray in a confined area.
- Avoid all ignition sources such as static electric sparks, open flames, pilot lights, electrical appliances, and hot objects. Connecting or disconnecting power cords or working light switches can make sparks. Paint or solvent flowing through the equipment is able to result in static electricity.
- Do not smoke in spray area.
- Fire extinguisher must be present and in good working order.
- Place pump at least 20 feet (6.1 meters) from the spray object in a well ventilated area (add more hose if necessary). Flammable vapors are often heavier than air. Floor area must be extremely well ventilated. The pump contains arcing parts that emit sparks and can ignite vapors.
- The equipment and objects in and around the spray area must be properly grounded to prevent static sparks.
- Keep area clean and free of paint or solvent containers, rags and other flammable materials.
- Use only conductive or grounded high pressure fluid hose. Gun must be grounded through hose connections.
- Power cord must be connected to a grounded circuit.
- Always flush unit into a separate metal container, at low pump pressure, with spray tip removed. Hold gun firmly against side of container to ground container and prevent static sparks.
- Follow the material and solvent manufacturer's warnings and instructions. Know the contents of the paints and solvents being sprayed. Read all Material Safety Data Sheets (MSDS) and container labels provided with the paints and solvents. Follow the paint and solvent manufacturer's safety instructions.
- Use extreme caution when using materials with a flashpoint below 70°F (21°C). Flashpoint is the temperature that a fluid can produce enough vapors to ignite.
- Plastic can cause static sparks. Never hang plastic to enclose a spray area. Do not use plastic drop cloths when spraying flammable materials.
- Use lowest possible pressure to flush equipment.
- Do not spray onto pump assembly.



HAZARD: EXPLOSION HAZARD DUE TO INCOMPATIBLE MATERIALS

Will cause property damage or severe injury.



PREVENTION:

- Do not use materials containing bleach or chlorine.
- Do not use halogenated hydrocarbon solvents such as bleach, mildewcide, methylene chloride and 1,1,1 - trichloroethane. They are not compatible with aluminum.
- Contact your coating supplier about the compatibility of material with aluminum.



Important Safety Information • Read all safety information before operating the equipment. SAVE THESE INSTRUCTIONS.

HAZARD: GENERAL

Can cause severe injury or property damage.

PREVENTION:

- Read all instructions and safety precautions before operating equipment.
- Follow all appropriate local, state, and national codes governing ventilation, fire prevention, and operation.
- The United States Government Safety Standards have been adopted under the Occupational Safety and Health Act (OSHA). These standards, particularly part 1910 of the General Standards and part 1926 of the Construction Standards should be consulted.
- Use only manufacturer authorized parts. User assumes all risks and liabilities when using parts that do not meet the minimum specifications and safety requirements of the pump manufacturer.
- Before each use, check all hoses for cuts, leaks, abrasion or bulging of cover. Check for damage or movement of couplings. Immediately replace the hose if any of these conditions exist. Never repair a paint hose. Replace it with another grounded high-pressure hose.
- All hoses and fittings must be secured before operating spray pump. Unsecured parts can eject at great force or leak a high pressure fluid stream causing severe injury.
- All hoses, swivels, guns, and accessories must be pressure rated at or above 3000 PSI/207 BAR.
- Do not spray outdoors on windy days.
- Wear clothing to keep paint off skin and hair.
- Do not operate or spray near children. Keep children away from the equipment at all times.
- Do not overreach or stand on an unstable support. Keep effective footing and balance at all times.
- Stay alert and watch what you are doing.
- Do not operate the unit when fatigued or under the influence of drugs or alcohol.

Important Electrical Information

NOTICE - Use only a 3-wire extension cord that has a 3-blade grounding plug and a 3-slot receptacle that will accept the plug on the product. Make sure your extension cord is in good condition. When using an extension cord, be sure to use one heavy enough to carry the current your product will draw. An undersized cord will cause a drop in line voltage resulting in loss of power and overheating. A 14 or 12 gauge cord is recommended (see chart below). If an extension cord is to be used outdoors, it must be marked with the suffix W-A after the cord type designation. For example, a designation of SJTW-A would indicate that the cord would be appropriate for outdoor use.

Cord gauge	Maximum cord length
12	200 feet
14	100 feet

Do not use more than 100 feet of spray hose. If you need to spray further than 100 feet from your power source, use more extension cord, not more spray hose.

NOTE - THE 9145 AND 9155 SERIES UNITS ARE PROVIDED WITH A NON-RESETABLE THERMAL OVERLOAD. THE 9175 AND 9195 SERIES UNITS ARE PROVIDED WITH A REPLACEABLE FUSE.

- Always disconnect the motor from the power supply before working on the equipment.

The cause of the overload should be corrected before restarting. Take to Service Center.

Grounding Instructions

This product must be grounded. In the event of an electrical short circuit, grounding reduces the risk of electric shock by providing an escape wire for the electric current. This product is equipped with a cord having a grounding wire with an appropriate grounding plug. The plug must be plugged into an outlet that is properly installed and grounded in accordance with all local codes and ordinances.

WARNING - Improper installation of the grounding plug can result in a risk of electric shock.



If repair or replacement of the cord or plug is necessary, do not connect the green grounding wire to either flat blade terminal. The wire with insulation having a green outer surface with or without yellow stripes is the grounding wire and must be connected to the grounding pin.

Check with a qualified electrician or serviceman if the grounding instructions are not completely understood, or if you are in doubt as to whether the product is properly grounded. Do not modify the plug provided. If the plug will not fit the outlet, have the proper outlet installed by a qualified electrician.

This product is for use on a nominal 120 volt circuit and has a grounding plug that looks like the plug illustrated below. Make sure that the product is connected to an outlet having the same configuration as the plug. **No adapter should be used with this product.**

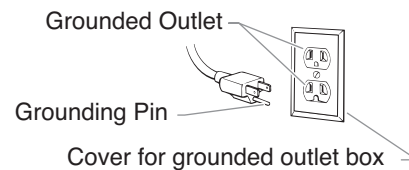

If you experience problems with your sprayer at any time during assembly, operation, or cleanup, please refer to the Troubleshooting section of this manual (page 22), or call customer service at:

1-800-880-0993

Components and Description

Components

The shipping carton for your painting system contains the following:

- Suction tube and return tube
- Pump cleaning adapter
- Spray gun with filter
- Spray tip assembly (see chart on next page)
- 25' (9145, 9155) or 50' (9175, 9195), 1/4" diameter pressure hose
- Instruction manual

Tools Needed for Assembly

- Two adjustable wrenches
- Extension cord (refer to **Important Electrical Information**, page 3).

Controls and Functions

- ON/OFF Switch** The ON/OFF switch turns the power to the sprayer on and off (O=OFF, I=ON).
- Suction tube** Fluid is drawn through the suction tube into the pump.
- Fluid Section** A piston in the fluid section moves up and down to create the suction that draws fluid through the suction tube.
- Spray Gun** The spray gun controls the delivery of the fluid being pumped. The gun model you have depends on your sprayer model (refer to **Spray Gun/Tip Chart**, next page).
- Spray Hose** The spray hose connects the gun to the pump.
- Return Tube** Fluid is sent back out through the return tube to the original container when PRIME/SPRAY knob is in PRIME position.
- Pump Cleaning Adapter** The adapter allows you to attach a garden hose to the suction tube for easy cleanup (latex materials only).
- PRIME/SPRAY Knob** The PRIME/SPRAY knob directs fluid to the spray hose when set to SPRAY or the return tube when set to PRIME. The arrows on the PRIME/SPRAY knob shows the rotation directions for PRIME and SPRAY.
The PRIME/SPRAY knob is also used to relieve pressure built up in the spray hose (see **Pressure Relief Procedure**, page 7).
- Pressure Control Dial** The pressure control dial regulates the amount of force the pump uses to push the fluid.
- Oiler** (9155, 9175, and 9195 only) The oiler is designed to provide lubrication to the fluid section of the pump.
- Pusher Stem** The pusher stem is designed to keep the inlet valve open and from sticking due to dried materials.

Specifications

Capacity:

- 9145 Up to .25 gallon (0.95 liter) / minute
 9155 Up to .29 gallon (1.10 liters) / minute
 9175 Up to .33 gallon (1.25 liters) / minute
 9195 Up to .42 gallon (1.60 liters) / minute

Power source:

- 9145 1/2 Hp universal motor
 9155 5/8 Hp universal motor
 9175 3/4 Hp permanent magnet DC motor
 9195 7/8 Hp permanent magnet DC motor

Power requirement:

15 amp minimum circuit on 115 VAC, 60 Hz current

Generator power requirement:

8000 Watt

Safety features:

Spray gun trigger lock and pressure diffuser; built-in tip safety guard; PRIME/SPRAY knob for safe pressure release.

Capability:

Sprays a variety of paints, primers, stains, preservatives and other nonabrasive materials, including pesticides and liquid fertilizers.

This pump should not be used with textured materials, block filler, or asphalt sealer.

Components and Description

This pump is available in two models: a stand model (9145) and cart models (9155, 9175 shown below, and 9195). All information given for the stand model applies to the cart models except where indicated.

NOTICE

Some of the graphics in this manual may not exactly match your sprayer and spray gun. All information and instructions given in this manual applies to all models except where noted.

Spray Gun/Tip Chart					
Sprayer Model	Gun Model	Tip	Max. Tip	Recommended Gun Filter	Spray hose length
9145	GX-05	415	415	Yellow (fine)	25 feet
9155	GX-07	415	517	Yellow (fine)	25 feet
9175	GX-07	517	519	White (medium)	50 feet
9195	GX-08	517	521	White (medium)	50 feet

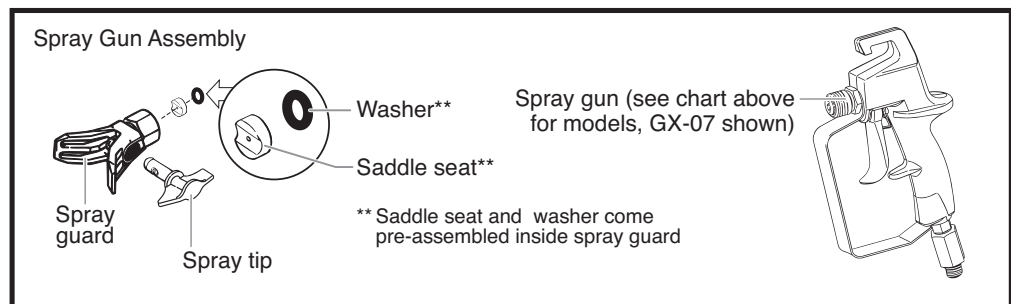
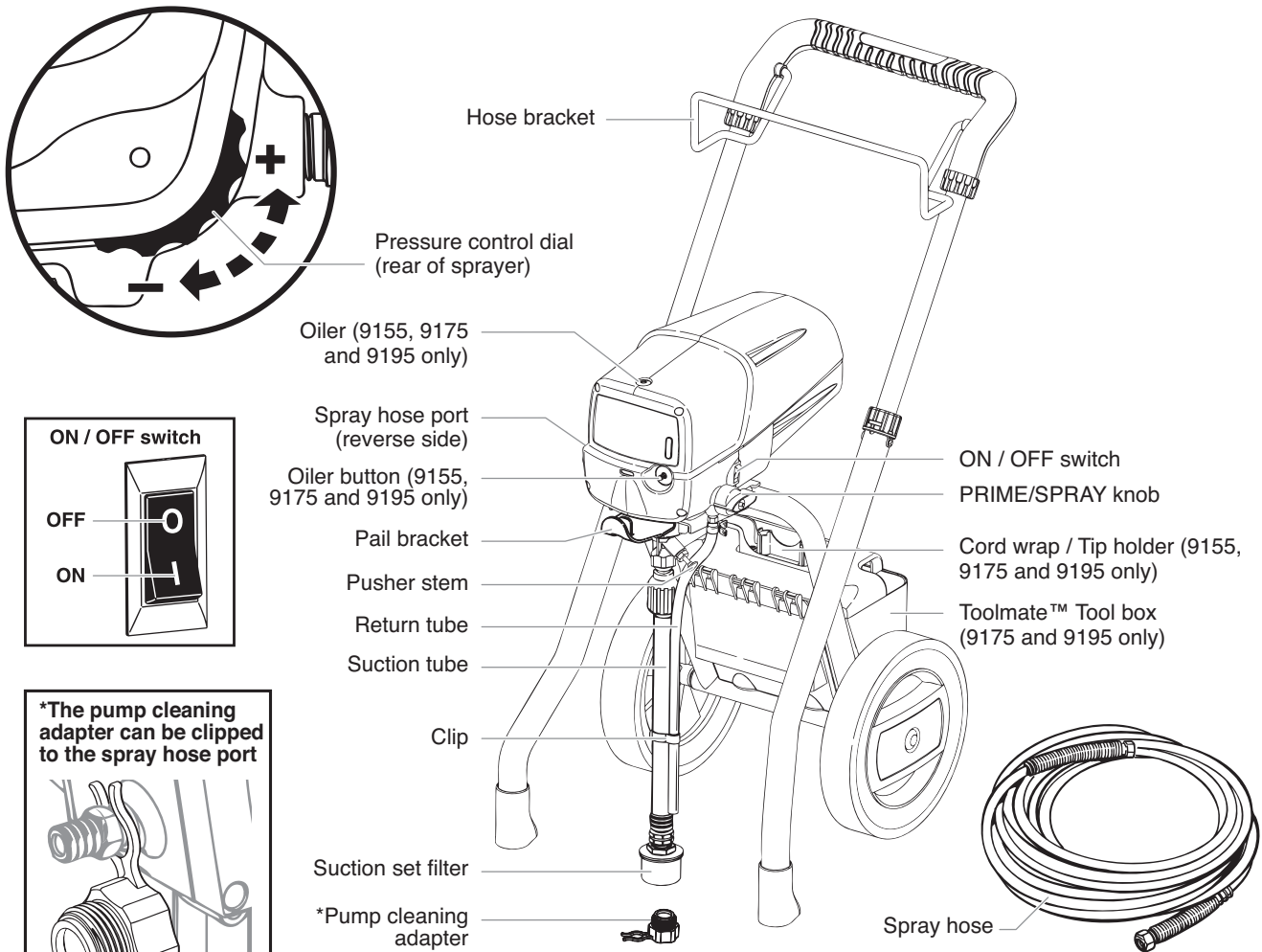

Assembly



Do not plug in the power cord until assembly is complete.

If you have one of the cart models, follow these assembly instructions. If you have the model 9145 sprayer, skip to item 4, below.

1. Twist the knobs on either side of the handle counterclockwise to unlock the handle. Pull the handle out fully, and turn knobs clockwise to lock into place.

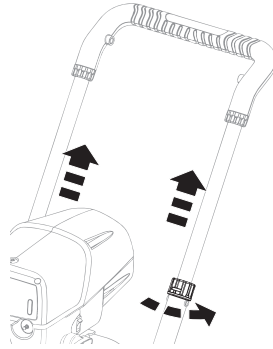

2. Insert the ends of the hose bracket into the holes of the handle as shown.

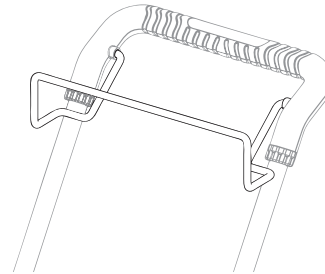

3. Attach the pail bracket. Line up the holes in the bracket with the holes in the sprayer. Insert and tighten the screws using a 3/16" allen wrench.

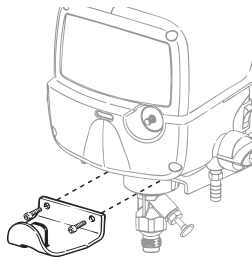

4. Thread one end of the high pressure spray hose to the spray hose port. Hold the port with an adjustable wrench, and tighten the hose with the other.

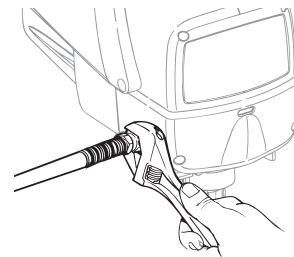

5. Thread the other end of the hose to the spray gun. Hold the gun with one adjustable wrench, and tighten the hose nut with the other.

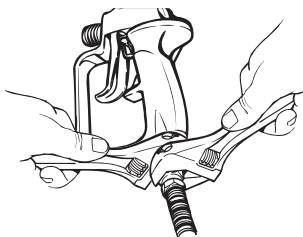

The spray tip should not be attached until after the sprayer and spray hose have been purged and primed.

6. Thread the suction tube onto the inlet valve and tighten firmly by hand. Be sure that the threads are straight so that the fitting turns freely.

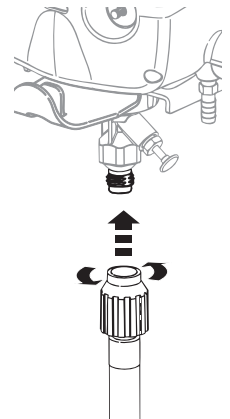

7. Press the return tube onto the return tube fitting. Squeeze clip over the return tube fitting to secure the return tube.

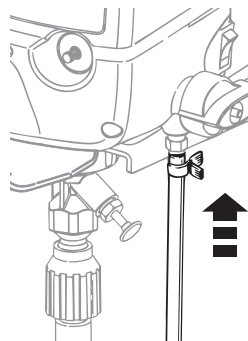

8. Verify that the seal is present inside the suction tube. Thread the inlet filter into the end of the suction tube.

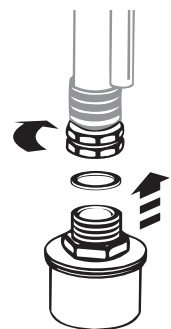

Before you Begin - This section contains instructions that will be repeated throughout this manual.

Locking the Spray Gun



Always lock the trigger off when attaching the spray tip or when the spray gun is not in use.

GX-05 / GX-07

The gun is locked when the trigger lock is at a 90° angle (perpendicular to the trigger in either direction).

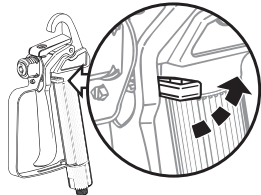

GX-05

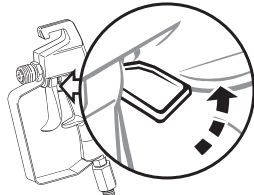

GX-07

GX-08

To lock the gun, turn the trigger lock forward and slightly down until it stops.

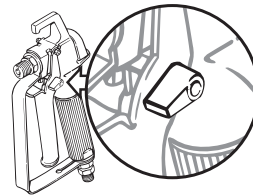

GX-08

Pressure Relief Procedure



Be sure to follow the Pressure Relief Procedure when shutting the unit off for any purpose. This procedure is used to relieve pressure from the spray hose.

1. Lock the spray gun off (see directions above). Flip the ON/OFF switch to the OFF position.

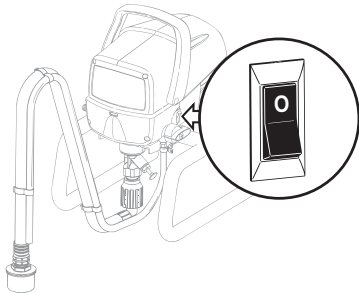

2. Turn the PRIME/SPRAY knob to PRIME.

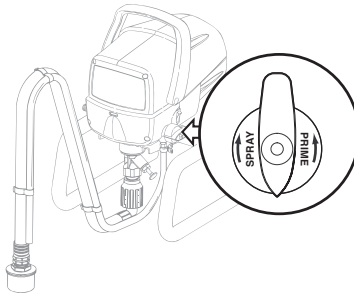

3. Unlock the spray gun and trigger spray gun into the side of the material bucket. Lock the spray gun.

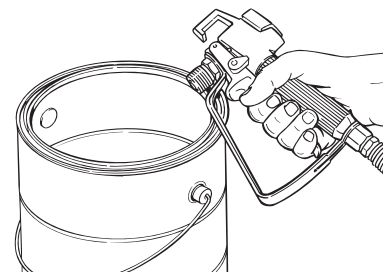

Grounding the Spray Gun (oil-based materials only)



If spraying or cleaning with oil-based materials, the spray gun must be grounded while preparing the spray hose or cleaning.

Ground the gun by holding it against the edge of a metal container while purging. Failure to do so may lead to a static electric discharge which may cause a fire.

Keep hands clear of the fluid stream.

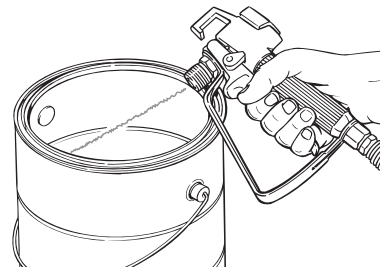

Preparing the Sprayer

All new units are performance-tested at the factory and are shipped with test fluid in the fluid section to prevent corrosion during shipment and storage. If you have already used your pump, some water or solvent used in cleaning may remain in the fluid section. Whether your sprayer is new or if you have already used it, this fluid must be purged and thoroughly cleaned out of the system prior to use. Follow the steps below.

9155, 9175 and 9195 only.

1. Remove oiler cap using a straight-slot screwdriver. Squirt separating oil P/N 0516913 supplied with your sprayer into the oiler (approximately 1 ounce). Light household oil can be substituted if necessary. Replace cap.
2. After filling, push button on front of face plate 2-5 times to lubricate the fluid section. Press once for every eight hours of usage. Be sure to check reservoir level (a) and refill as necessary.

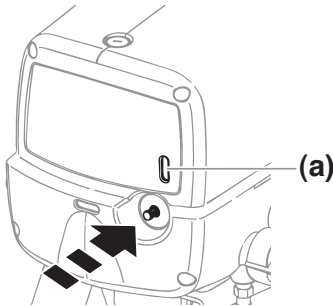
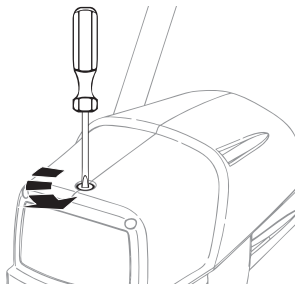

3. Fully depress the pusher stem to make sure the inlet ball is free.

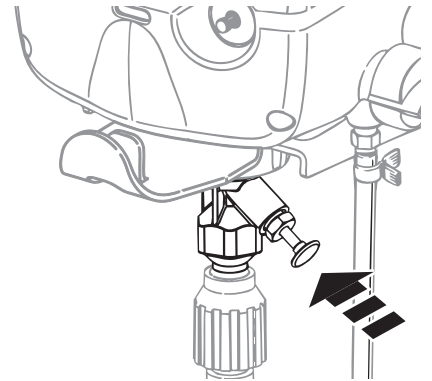

4. Place a full container of spraying material underneath the suction tube (a). Secure the return tube (b) into a waste container.

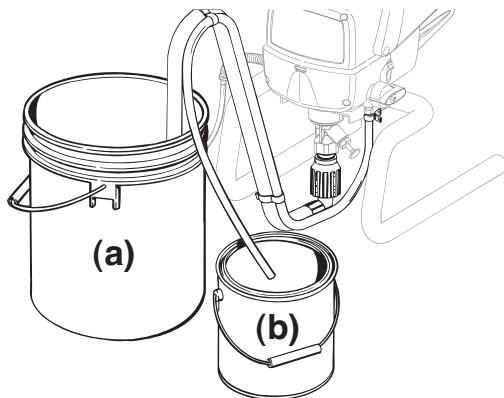

5. Turn the pressure control dial to maximum pressure (+). Turn the PRIME/SPRAY knob to PRIME.

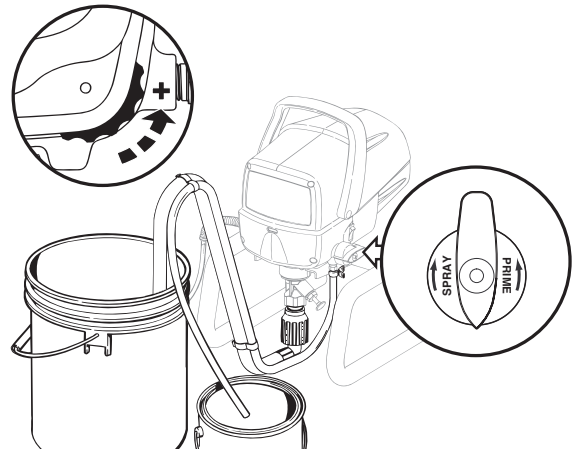

6. Plug in the sprayer and move the ON/OFF switch to the ON (I) position.

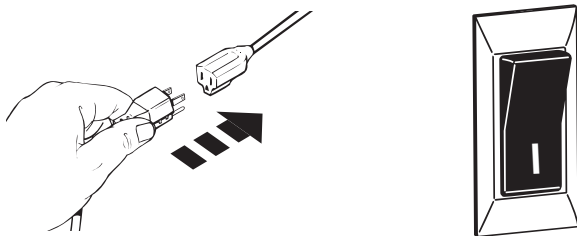

The unit will begin to draw material up the suction tube, into the pump, and out the return tube. Let the unit cycle long enough to remove test fluid from the pump, or until spray material is coming from the return tube.

7. Switch the pump OFF (O). Remove the return tube from the waste container and place it in its operating position above the container of spraying material. Use the metal clip to bind the two hoses together.

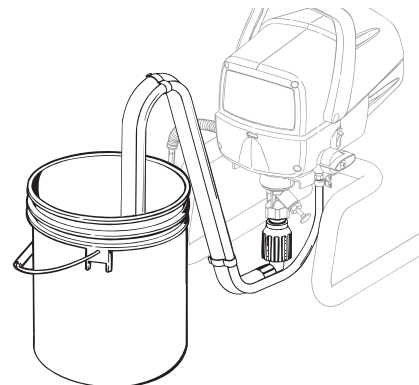

Preparing the Spray Hose and Spray Gun



The spray tip assembly should not be attached to the spray gun when purging the spray hose. Failure to comply could result in an injection injury.

1. Unlock the spray gun and turn the PRIME/SPRAY knob to PRIME.
2. PULL the trigger and aim the spray gun at the side wall of a waste container.



If using oil-based materials, the spray gun must be grounded (see [Grounding the Spray Gun](#), page 7).

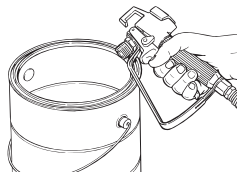
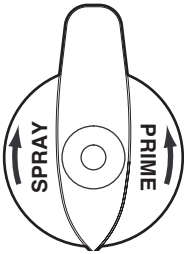

3. While pulling the trigger, switch the pump ON (I), and turn the PRIME/SPRAY knob to SPRAY. Hold the trigger until all air, water, or solvent is purged from the spray hose and material is flowing freely.

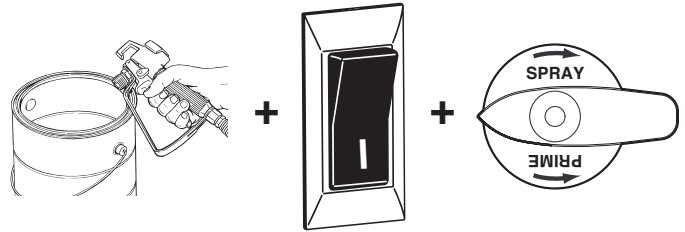

Whenever the PRIME/SPRAY knob is still on SPRAY, there will be high pressure in the hose and spray gun until the PRIME/SPRAY knob is turned to PRIME.

4. Release trigger and perform the [Pressure Relief Procedure](#), page 7).
5. Lock the spray gun trigger.
6. Make sure the saddle seat and black seal are in place inside the tip guard nut (see [Components and Description](#), page 5).
7. Insert spray tip (a) into the side of the spray guard (b). The pointed end (c) of the spray tip should be facing forward as shown.

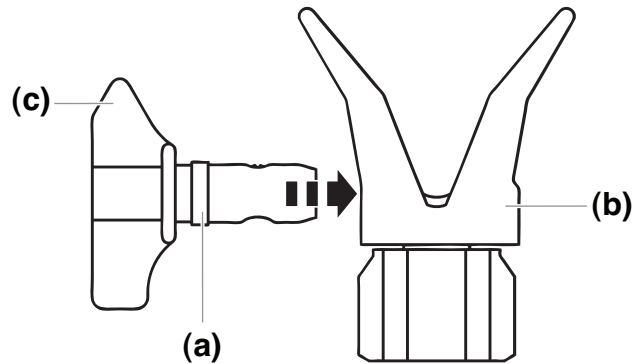

8. Thread the spray tip guard assembly onto the gun. Tighten by hand.

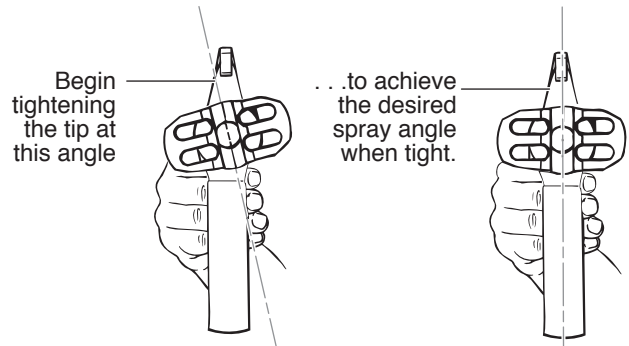
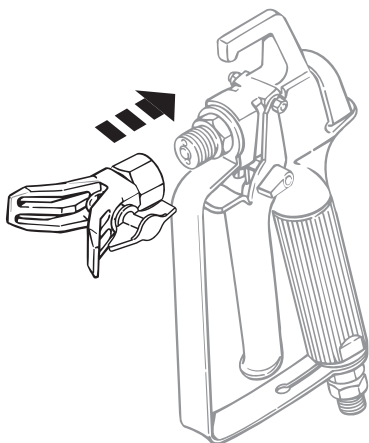

Practice / Spraying Technique

IMPORTANT: Be sure that the paint hose is free of kinks and clear of objects with sharp cutting edges.

1. Switch the pump ON (I). Turn the PRIME/SPRAY knob to SPRAY. Turn the pressure control dial to maximum pressure (+). The spray hose should stiffen as paint begins to flow through it.

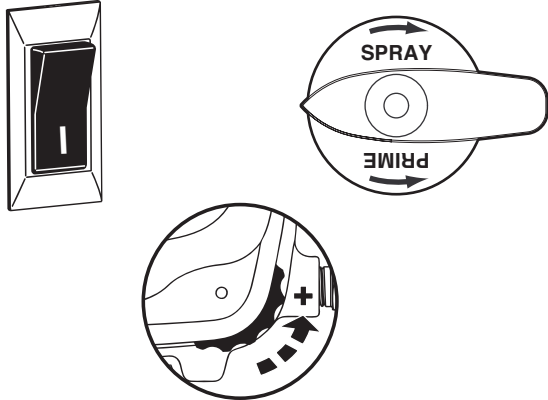

2. When motor shuts off, unlock the spray gun and spray a test area to check the spray pattern.

The motor will cycle on and off automatically as it needs pressure.

The pressure control dial can be adjusted up or down to achieve the desired spray pattern.

Good spray pattern



Paint tailing pattern (pressure too low, clogged tip)



The key to a good job is an even coating over the entire surface. This is done by using even strokes. Follow the TIPS, below.

Tip: Keep the spray gun at right angles to the surface. This means moving your entire arm back and forth rather than just flexing your wrist.

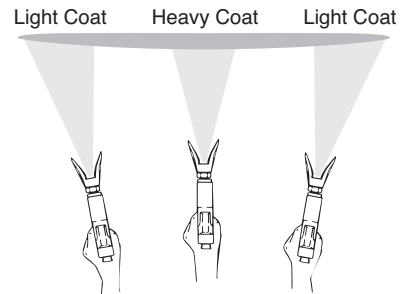

Tip: Keep the spray gun perpendicular to the surface, otherwise one end of the pattern will be thicker than the other.

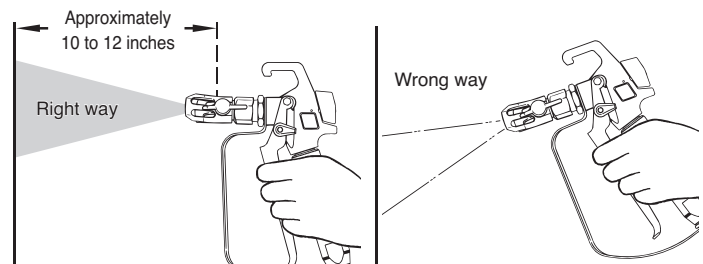

Tip: Trigger gun after starting the stroke. Release the trigger before ending the stroke. The spray gun should be moving when the trigger is pulled and released. Overlap each stroke by about 30%. This will ensure an even coating.

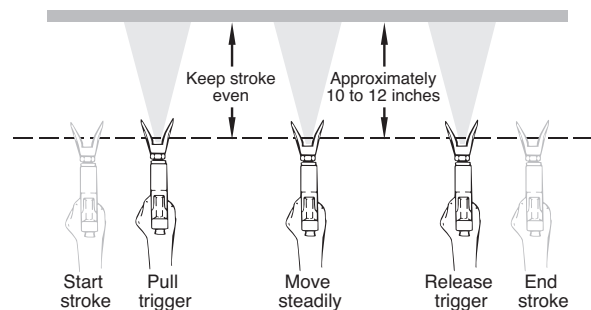

If you expect to be away from your sprayer for more than one hour, follow the **Short-Term Storage** instructions (page 18).

Spraying Troubleshooting - Unclogging the Spray Tip

If the spray pattern becomes distorted or stops completely while the gun is triggered, follow these steps.



Do not attempt to unclog or clean the tip with your finger. High pressure fluid can cause injection injury.

IMPORTANT: Do not use a needle or other sharp pointed instrument to clean the tip. The hard tungsten carbide can chip.

1. Release the trigger and lock the trigger off (see page 7). Rotate the reversible tip arrow 180° so that the point of the arrow is toward the rear of the gun (CLEAN position).

Under pressure, the spray tip may be very difficult to turn. Turn the PRIME/SPRAY knob to PRIME and trigger the gun. This will relieve pressure and the tip will turn more easily.

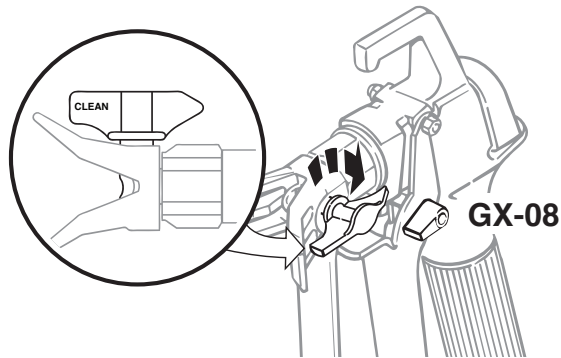

Trigger locked
(see page 7)

GX-05 / GX-07



2. Turn the PRIME/SPRAY knob to SPRAY.
3. Unlock the trigger and squeeze the trigger, pointing the gun at a scrap piece of wood or cardboard. This allows pressure in the spray hose to blow out the obstruction. When the nozzle is clean, material will come out in a straight, high pressure stream.

If material still will not spray from the spray tip, follow the [Cleaning the spray gun filter](#) instructions, page 12.

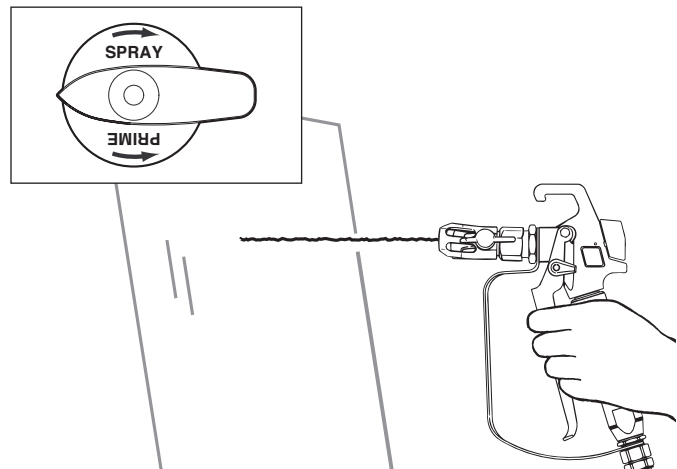

4. Release the trigger and lock the trigger off (see page 7). Reverse the tip so the arrow points forward again (SPRAY position). Unlock the gun and resume spraying.

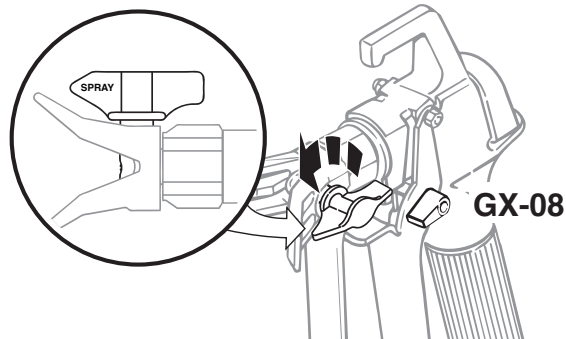

Trigger locked
(see page 7)

GX-05 / GX-07



Spraying Troubleshooting - Cleaning the Spray Gun Filter

The filter must be cleaned every time you use your sprayer. When using thicker spray materials, the filter might need to be cleaned more often.

1. Perform [Pressure Relief Procedure](#), page 7.
- 2a. **Model GX-07** - Unscrew the fitting from the bottom of the spray gun using an adjustable wrench, making sure not to lose the spring.
- 2b. **Models GX-05 and GX-08** - Unclip the trigger guard from the filter housing by pulling outward from the filter housing. Unscrew the filter housing.
3. Remove the filter from the spray gun housing and clean with the appropriate cleaning solution (warm, soapy water for latex paints, mineral spirits for oil-based materials).
4. Inspect the filter for holes (see inset, right). Replace if holes are found.

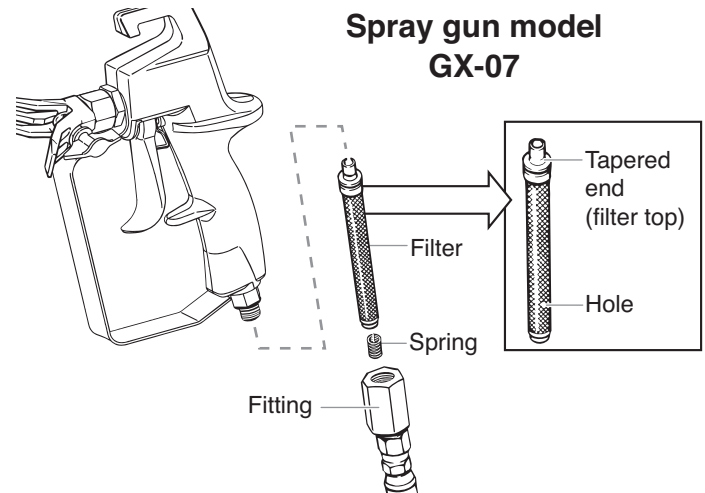

NOTE - NEVER POKE THE FILTER WITH A SHARP INSTRUMENT!

5. Replace the cleaned filter, tapered end first, into the gun housing. **The tapered end of the filter must be loaded properly into the gun. Improper assembly will result in a plugged tip or no flow from the gun.**
6. Reassemble the spray gun.

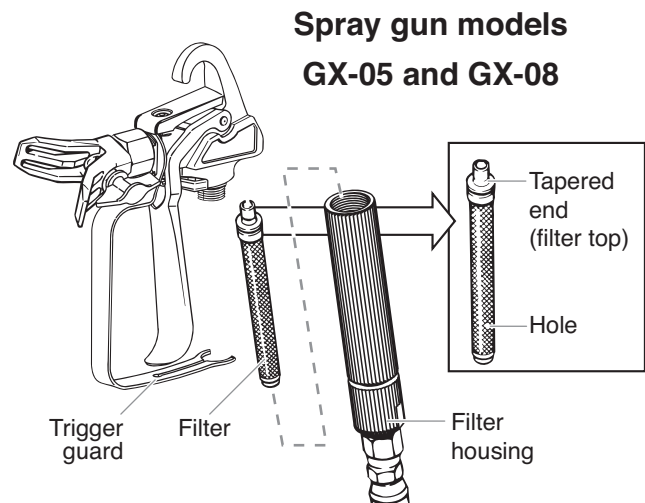

Spraying Troubleshooting - Cleaning the Inlet Filter

The screen at the bottom of the suction tube may also need cleaning. Check it every time you change spray containers.

1. Remove the filter by unscrewing it from the suction tube. Clean the filter with the appropriate cleaning solution (warm, soapy water for latex materials, mineral spirits for oil-based materials).
2. Thread the filter back into place.

If after completing all of the steps in [Spraying Troubleshooting](#) you are still experiencing problems spraying, refer to the [Troubleshooting](#) section (page 22).

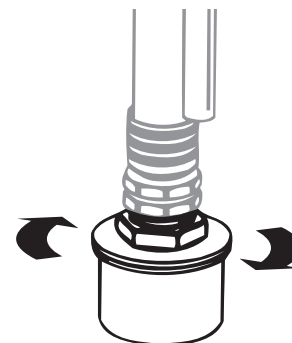

Cleanup

Important Cleaning Notes - Read before cleaning

- When using latex materials, clean your sprayer and components with water. When using oil-based materials, use mineral spirits. **DO NOT** use gasoline to clean your sprayer.
- Do not use mineral spirits on latex materials, or the mixture will turn into a jelly-like substance which is difficult to remove.
- No matter which cleaning solution you use, make sure to dispose of it properly when finished cleaning your sprayer.
- Thorough cleaning and lubrication of the sprayer is the most important step you can take to ensure proper operation after storage.



Follow these steps whenever cleaning with mineral spirits:

- Always flush spray gun at least one hose length away from spray pump.
- If collecting flushed solvents in one gallon metal container, place it into an empty five gallon container, then flush.
- Area must be free from vapors.
- Follow all cleanup instructions.
- **DO NOT** use gasoline to clean your sprayer.

Call 1-800-880-0993 if you have any problems or questions regarding the cleaning of your sprayer.

Follow these steps if you used latex materials and if you have a garden hose available. If you do not have a garden hose available, follow the Cleanup - Oil-Based Materials instructions.

1. Lock the gun and remove the spray tip assembly. Place the suction tube and return tube into an empty waste container.

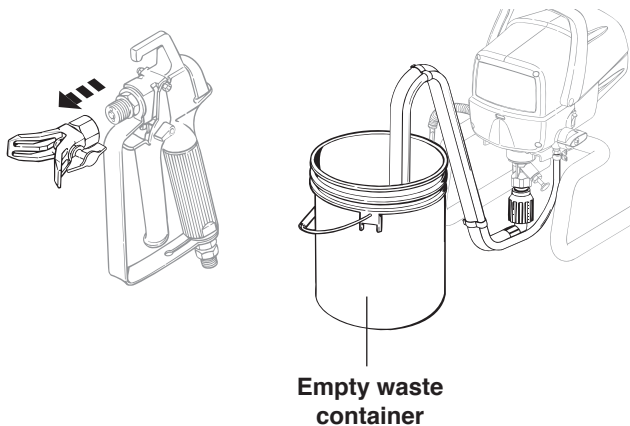

2. Using a garden hose, rinse off the suction tube, return tube and inlet filter. Empty the waste container.

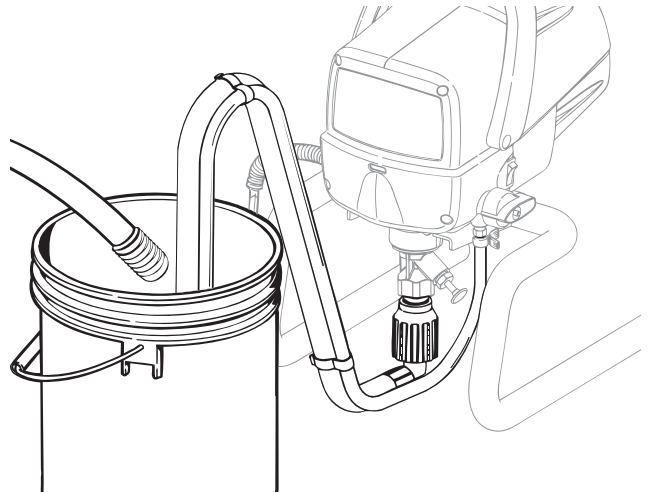

3. Remove the inlet filter from the suction tube and place into the waste container.

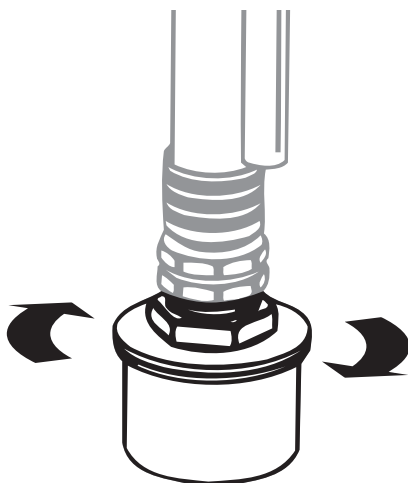

4. Verify that the seals are present inside the adapter and suction tube (a). Thread the pump cleaning adapter (b) onto a garden hose (c). Connect hose and adapter to the fitting on the end of the suction tube (d).

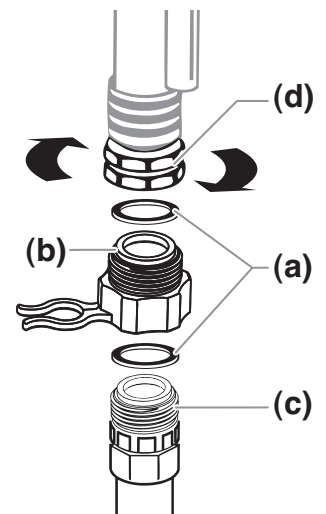

Continued on next page.

Cleanup - Latex materials (continued)

- Unclip the return tube from the suction tube and place it into the waste container. Turn the PRIME/SPRAY knob to PRIME.

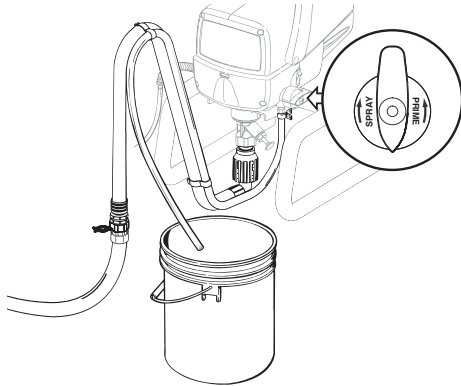

- Turn water supply on. Turn pump ON (I). Water will go into the suction tube and out through the return tube. Let pump run for a few minutes to allow the return tube to be flushed.

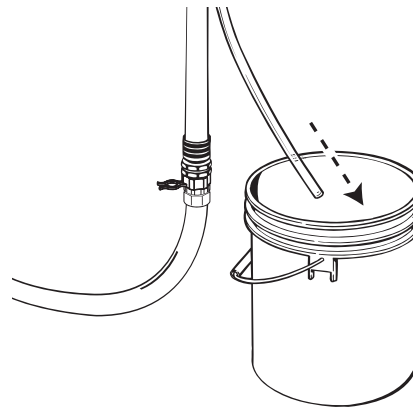

Leave pump running through steps 7 and 8.

- Place the original material container next to the waste container. Aim the spray gun into the side of the **original material container** and hold the trigger.

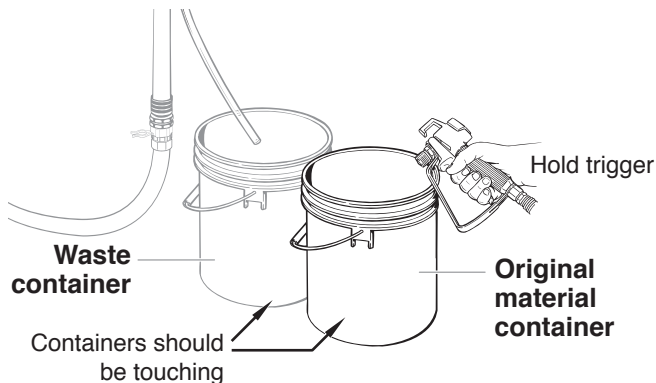

- While pulling the trigger, turn the PRIME/SPRAY knob to SPRAY to purge material from the hose back into the original container.

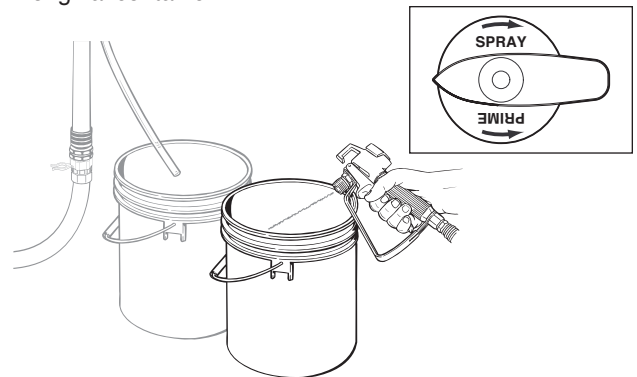

Keep holding trigger through next steps.

- When cleaning solution flows from the spray gun, keep holding the trigger and aim the spray gun into the side of the waste container.

- Trigger the gun until the fluid flowing out of the gun is clear. You may need to empty the waste container and continue flushing.

- Turn the PRIME/SPRAY knob to PRIME and trigger gun to relieve pressure.

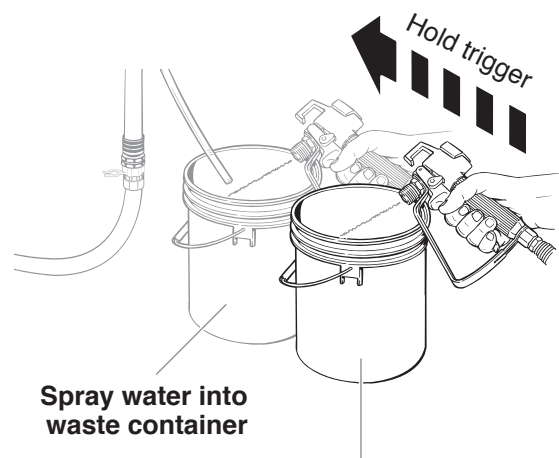

Spray material into original container

Move on to Cleaning the Spray Gun Components.

Cleanup - oil-based materials

1. Lock the gun and remove spray tip assembly. Submerge suction set into a bucket with appropriate cleaning solution.

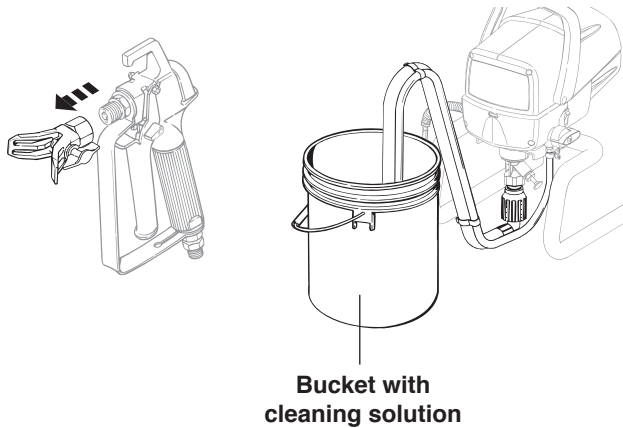

2. Place a waste container next to the original material container. Aim the spray gun into the side of the **original material container** and hold the trigger.

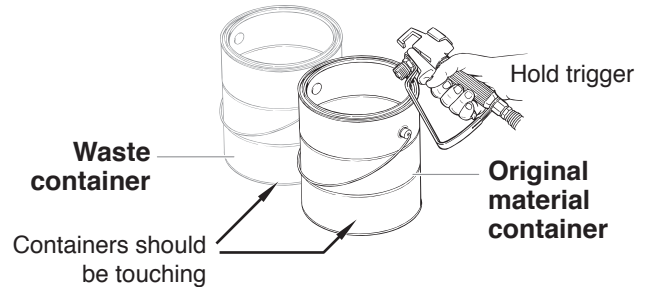

3. While pulling the gun trigger, turn the pump ON (I), and turn the PRIME/SPRAY knob to SPRAY to purge material from the hose back into the original container.

Keep holding trigger through next steps.

- Hold trigger
- Turn pump ON (I)
- Turn PRIME/SPRAY knob to SPRAY

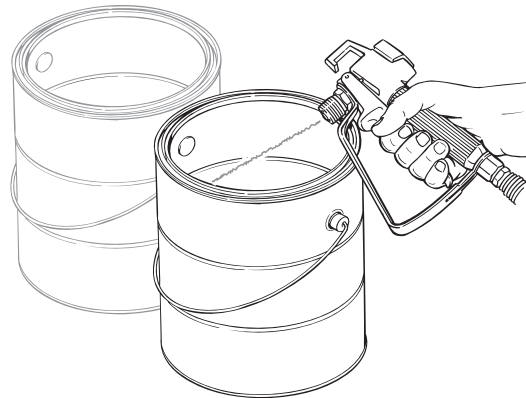

4. When cleaning solution flows from the spray gun, keep holding the trigger and aim the spray gun into the side of the waste container (**ground gun with a metal container if flushing with flammable solvent**).

5. Trigger the gun until the fluid flowing out of the gun is clear. You may need to dispose and obtain new cleaning solution.

6. Turn the PRIME/SPRAY knob to PRIME and trigger gun once to relieve pressure.

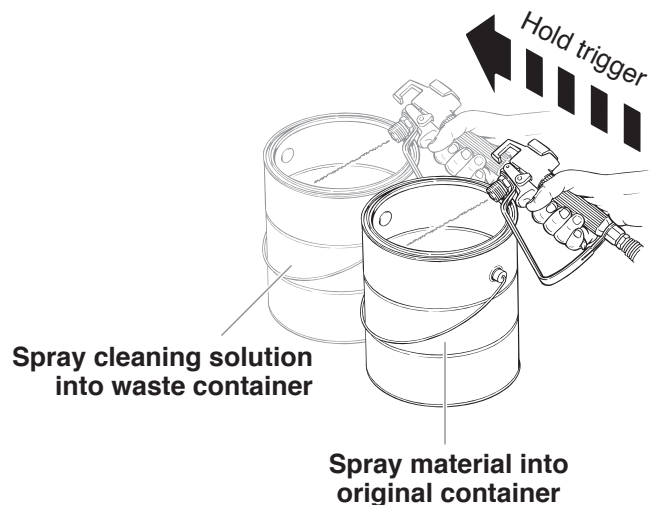

Move on to Cleaning the Suction Set.

Cleaning the Suction Set

1. Lock the gun and turn the pump OFF (O).

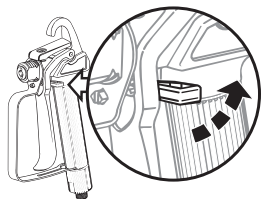

GX-05

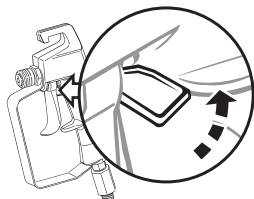

GX-07

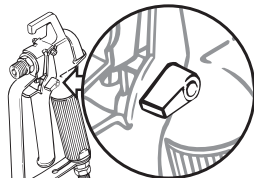

GX-08



2. Remove the suction hose and return tube and clean it using the appropriate cleaning solution. You should also wipe the threads of the inlet nut (a) and remove and clean the inlet filter.

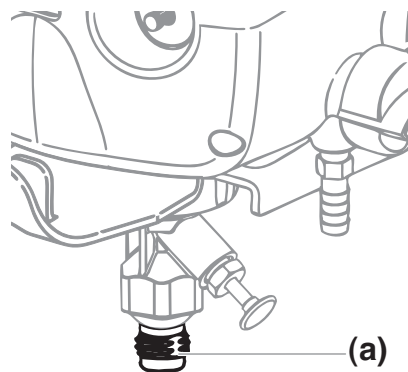

3. When suction set is clean, thread the suction tube back into the inlet valve, and replace the return tube onto the return tube fitting. Replace clip.

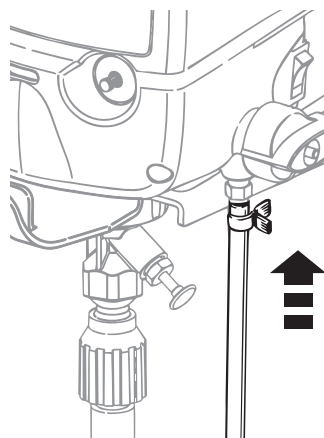
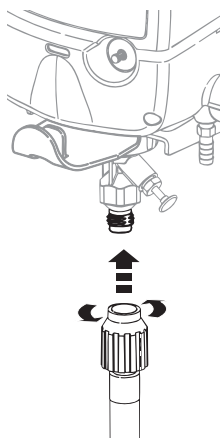

4. Submerge the suction set into a bucket of new cleaning solution.

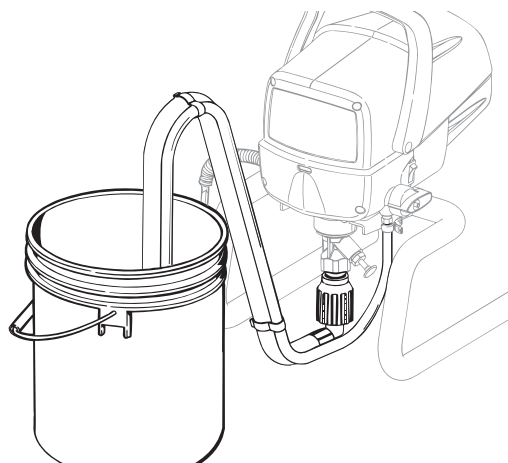

5. Turn the PRIME/SPRAY knob to PRIME. Turn the pump ON (I), and trigger the gun once into a waste container to relieve pressure.

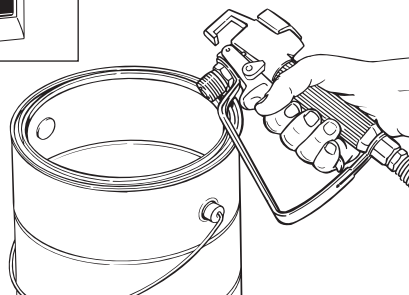
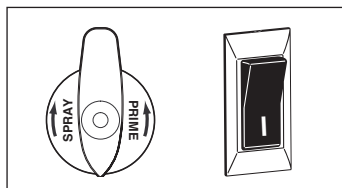

6. Let the pump circulate cleaning solution through the suction set for 2-3 minutes. Turn the pump OFF.



2 to 3 minutes

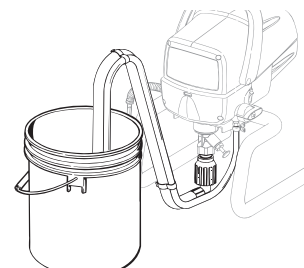

IMPORTANT!

If you used oil-based materials, you must flush the pump again using water to prepare it for storage. Repeat #1 - #11 in Cleanup- Latex materials, instructions.

Move on to **Cleaning the Spray Gun Components.**

Cleaning the Spray Gun Components

1. Make sure the pump is switched OFF (O). Make sure the PRIME/SPRAY knob is turned to PRIME. Unplug the sprayer.

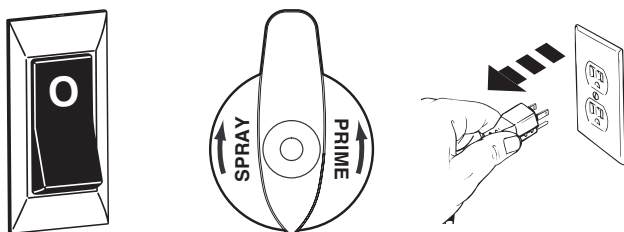

2. Remove spray gun from the paint hose using adjustable wrenches.

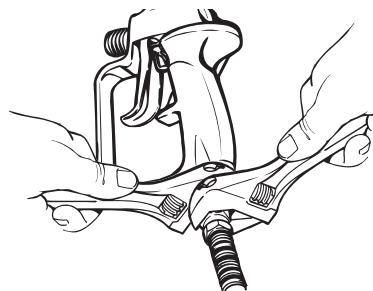

3. Remove filter from spray gun (refer to [Cleaning the Spray Gun Filter](#), page 12).

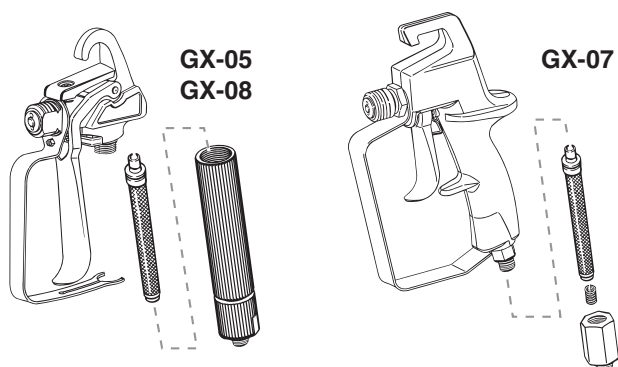

4. Remove spray tip (a) from spray guard assembly. Clean spray tip with a soft-bristled brush and the appropriate cleaning solution. Be sure to remove and clean the washer (b) and saddle seat (c) located in the rear of the spray tip assembly.

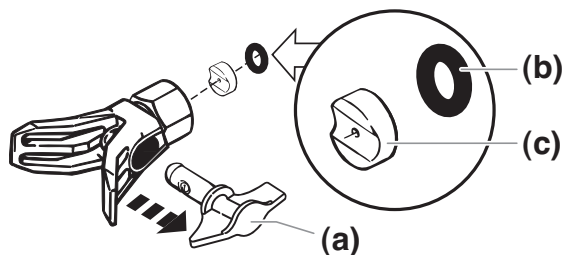

5. Install gun filter tapered-end first. Reassemble spray gun.

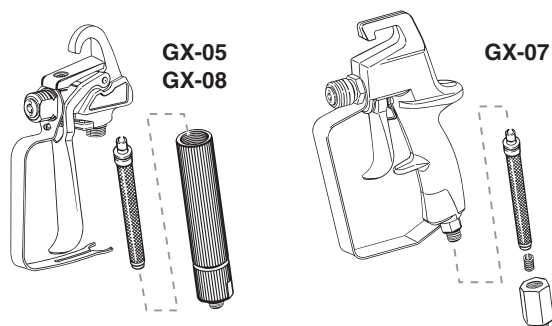

6. Install spray tip (a), saddle seat (c) and washer (b), and replace spray guard assembly.

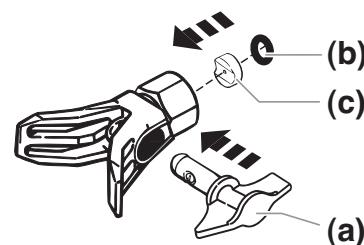

7. Thread the spray gun back onto the paint hose. Tighten with a wrench.

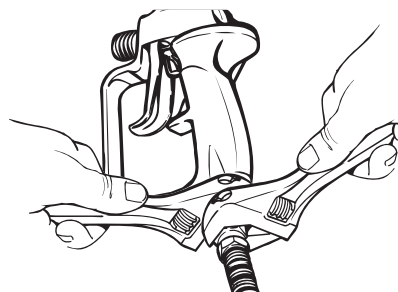

Short-Term Storage (up to 16 hours)

Follow these steps when using latex materials only. If using materials that are oil-based, follow the Cleanup and Long-Term Storage steps.

Shutdown

1. Lock the spray gun off.

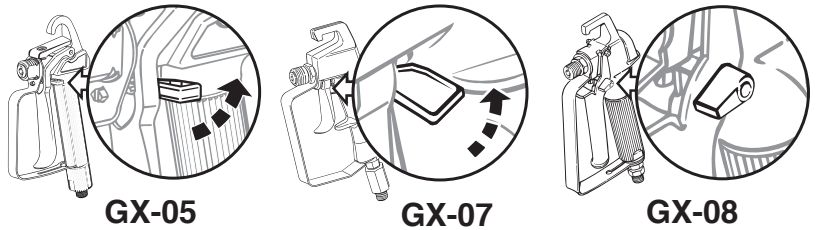

2. Turn the PRIME/SPRAY knob to PRIME. Switch the pump OFF (O). Unplug the sprayer.

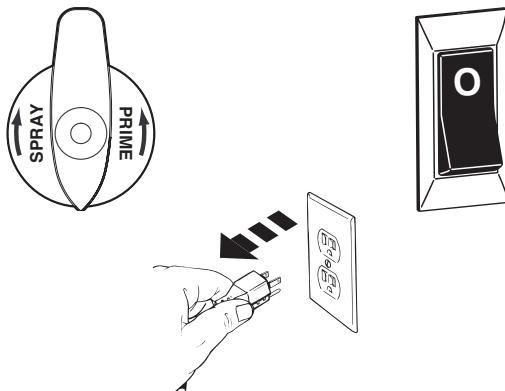

3. Pour 1/2 cup water slowly on the top of the paint to prevent the paint from drying. Wrap the spray gun assembly in a damp cloth and place it in a plastic bag. Seal the bag shut. Place the sprayer in a safe place out of the sun for short-term storage.

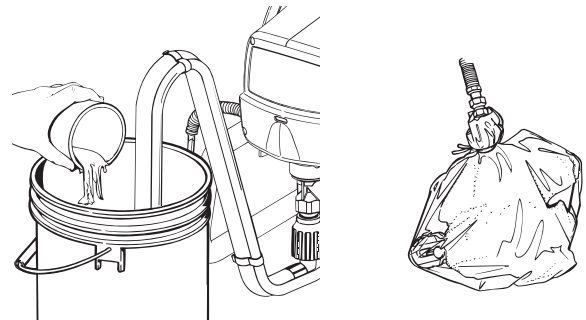

Startup

1. Remove the gun from the plastic bag. Stir the water into the paint.

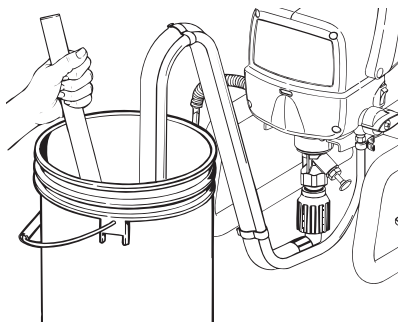

2. Turn the PRIME/SPRAY knob to PRIME. Plug sprayer in. Turn the switch to ON (I).

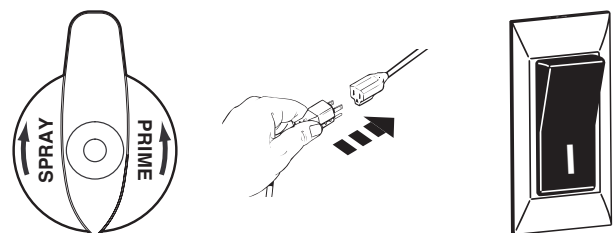

3. Turn the PRIME/SPRAY knob to SPRAY. Test the sprayer on a practice piece and begin spraying.

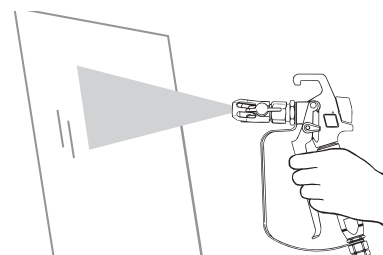

Long-Term Storage

Follow these instructions only after all cleanup steps have been performed.

1. Fill a cup or other container with two ounces of separating oil (P/N 0516913, sold separately) and submerge the inlet valve into the oil. Light household oil can be substituted.

Separating oil

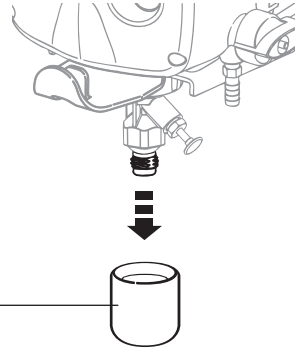

2. Place a rag over the spray hose port, and turn the switch ON (I). When the oil has been pumped from the cup, turn the pump OFF (O).

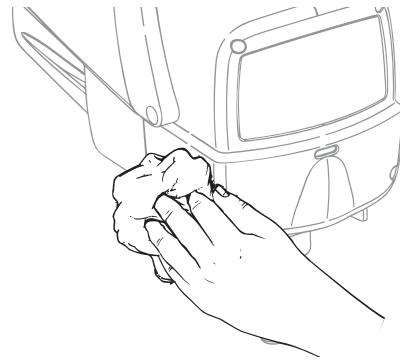

3. Wipe the entire unit, hose and gun with a damp cloth to remove accumulated paint. Replace the high pressure hose to the paint hose port.

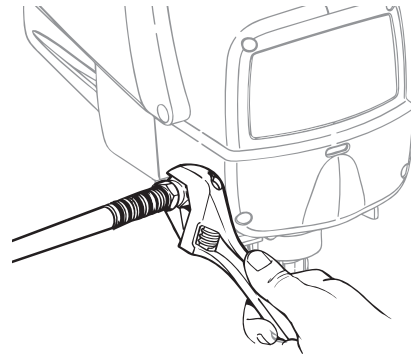

If you have a cart model (9155, 9175 or 9195), you can collapse the cart handle for easier storage.

1. Twist the knobs on either side of the cart counterclockwise.

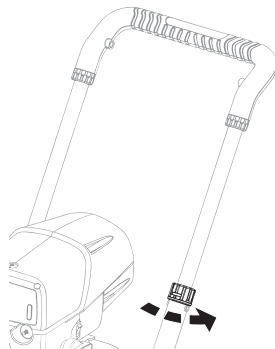

2. Slide the handle into the cart.

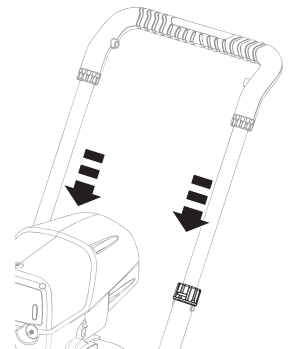

Cleaning the Inlet Valve

Cleaning or servicing the inlet valve may be required if the unit has priming problems. Priming problems may be prevented by properly cleaning the sprayer and following the long-term storage steps.

1. Remove the suction set.

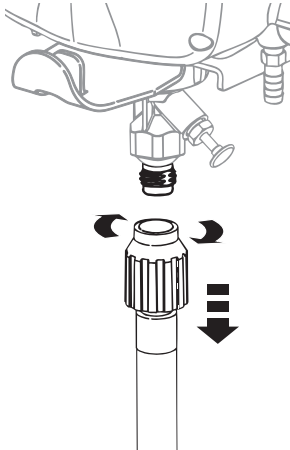

2. Unscrew the inlet valve assembly (a) from the sprayer. Visually inspect the inside and outside of the inlet valve assembly. Clean any paint residue with the appropriate cleaning solution.

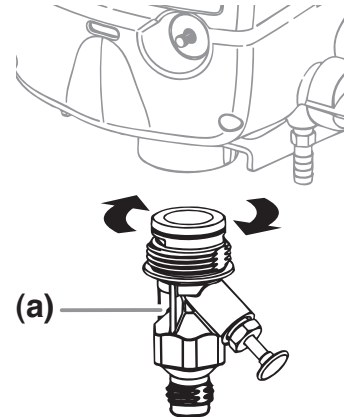

3. Lubricate the O-ring on the inlet valve (b). Replace inlet valve assembly by screwing it into the sprayer. Torque to 23-27 ft lbs (9145, 9155) or 32-38 ft lbs (9175, 9195).

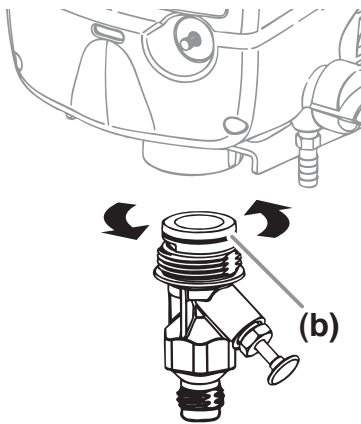

4. Replace suction set and hand-tighten.

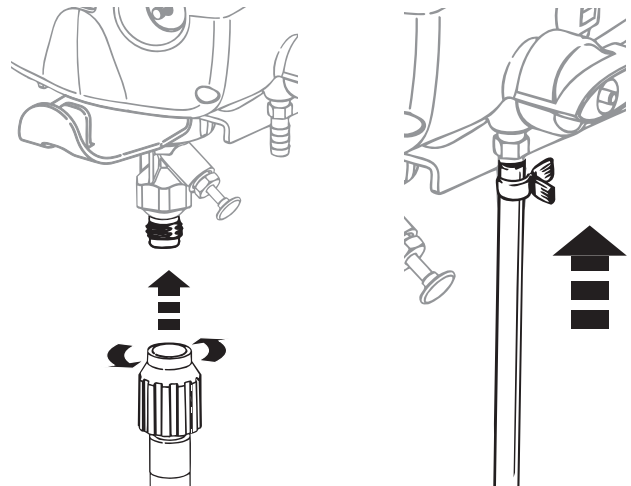

If priming problems persist, you may need to replace the inlet valve assembly. Call Technical Service (1-800-880-0993) to order new inlet valve assembly.

Fluid Section Seal Replacement Instructions

Kit Part Number 0512221A (9145 and 9155)

Kit Part Number 0516724 (9175 and 9195)



Always wear protective eye wear while servicing the pump. Be sure to follow the Pressure Relief Procedure (page 7) when shutting the unit down for any purpose, including servicing or adjusting. After performing the Pressure Relief Procedure, be sure to unplug the unit before servicing or adjusting. Area must be free of solvents and paint fumes.

Disassembly of the Fluid Section

1. Remove the suction set.
2. Remove the front cover and the four screws that secure it using a T20 Torx head driver.
3. Remove the yoke screw and washer that secures the dowel pin. The dowel pin connects the yoke to the piston.
4. Using a pliers, pull the dowel pin out.
- 5a. For models 9145 and 9155, rotate the pump shaft so the piston is in the top dead center position. This can be done by pushing on the yoke. This is required to disassemble all the parts.
- 5b. For models 9175 and 9195, inspect the yoke assembly and piston. In order to remove all the necessary parts, the piston must not be in the bottom dead center position. If the piston is at the bottom of the stroke, install the front cover and screws, turn the pump on briefly to index the piston, unplug the unit, and repeat step 2.
6. Unscrew and remove the inlet valve assembly (see page 20).
7. Remove the piston assembly by pushing down on the piston near the yoke.
8. Unscrew and remove the top nut using an adjustable wrench.
9. Remove the worn seals using a flat head screwdriver or punch. Remove the top seal from the top and the bottom seal from the bottom by pressing against the side of the seal and popping it out. Be sure not to scratch the housing where the seals are located.
10. Clean the area where the new seals are to be installed.

Assembly of the Fluid Section

1. Lubricate the new top seal with Separating Oil (P/N 0516913, sold separately) or light household oil and by hand place the seal (cup side of seal down) into the top port of the housing.
2. Place a small amount of anti-seize on the threads of the top nut. Place the top nut into the top of the housing and tighten with an adjustable wrench. This will drive the top seal into the correct position.
3. Turn the pump upside down. Lubricate the seal on the piston/seal assembly similar to the top seal. Place the piston/seal assembly into the bottom of the housing. Insert the plastic insertion tool and thread into position to properly seat the piston/seal. Thread fully until tight. Remove the insertion tool.
4. Install the new O-ring on the inlet valve assembly, lubricate with Separating Oil (P/N 0516913), thread into

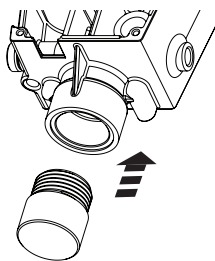

- the bottom (inlet) of the housing, and tighten with an adjustable wrench. This will drive the bottom seal into the correct position.
5. Align the piston with the yoke. Be careful not to damage the piston.
6. Apply any type of household grease to the piston and yoke area to prolong life. Apply to the holes in the yoke where the dowel is inserted.
7. Install the dowel pin to connect the yoke to the piston. The piston may have to be moved up or down to do this.
8. Install the yoke screw and washer to secure the dowel pin.
9. Turn pump right side up and apply a few drops of Separating Oil or light household oil between the top nut and piston. This will prolong the seal life.
10. Install front cover and four (4) screws.
11. Replace inlet valve. Install the suction set.

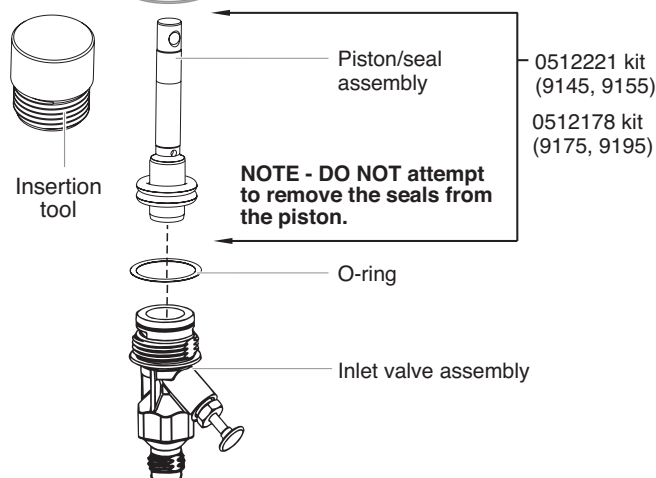
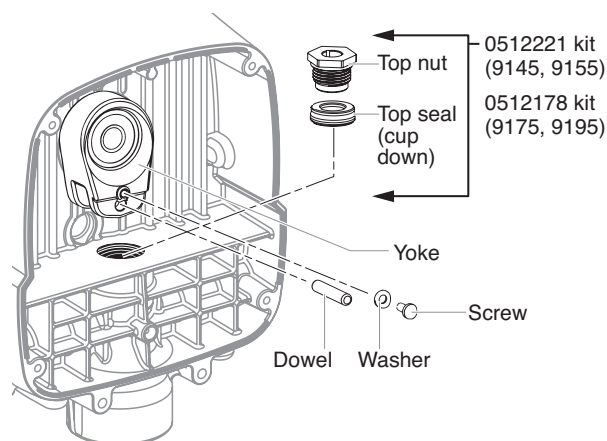

Troubleshooting / Maintenance



Before servicing, always release system pressure by following **Pressure Relief Procedure** (page 7).

Problem	Cause	Solution
A. The sprayer does not start.	<ol style="list-style-type: none"> The sprayer is not plugged in. The ON/OFF switch is set to OFF. The sprayer was turned off while still under pressure. No voltage is coming from the wall plug. The extension cord is damaged or has too low a capacity. A fuse is blown in the sprayer. There is a problem with the motor. 	<ol style="list-style-type: none"> Plug the sprayer in. Turn the ON/OFF switch to ON. Turn the pressure control knob to maximum pressure (+), or relieve pressure by turning the PRIME/SPRAY valve to PRIME. Properly test the power supply voltage. Replace the extension cord. Take sprayer to Authorized Service Center. Take sprayer to Authorized Service Center.
B. The sprayer starts but does not draw in paint when the PRIME/SPRAY knob is set to PRIME.	<ol style="list-style-type: none"> The paint bucket is empty or the suction tube is not totally immersed in the paint. The suction set is clogged. The suction tube is loose at the inlet valve. The inlet valve is stuck. The outlet valve is stuck. The inlet valve is worn or damaged. The PRIME/SPRAY valve is plugged. 	<ol style="list-style-type: none"> Refill the bucket or immerse the suction tube in paint. Clean the suction set. Clean the tube connection and tighten it securely. Clean the inlet valve. Inlet may be stuck from old paint. Depress pusher stem to release. Outlet may be stuck from old paint. Remove inlet valve. Insert pen or pencil in housing to release. Replace the inlet valve.* Take sprayer to Authorized Service Center.
C. The sprayer draws up paint but the pressure drops when the gun is triggered.	<ol style="list-style-type: none"> The spray tip is worn. The suction set screen is clogged. The gun filter is plugged. The paint is too heavy or coarse. The inlet valve assembly is damaged or worn. The suction tube is loose. 	<ol style="list-style-type: none"> Replace the spray tip with a new tip.** Clean the suction set screen. Clean or replace the proper filter. Always keep extra filters on hand. Thin or strain the paint. Replace the inlet valve.* Tighten the suction tube.
D. The PRIME/SPRAY valve is on SPRAY and there is flow through the return tube.	<ol style="list-style-type: none"> The PRIME/SPRAY valve is dirty or worn. 	<ol style="list-style-type: none"> Take sprayer to Authorized Service Center.
E. The spray gun leaks.	<ol style="list-style-type: none"> Internal parts of the gun are worn or dirty. 	<ol style="list-style-type: none"> Take the sprayer to a Authorized Service Center.
F. The tip guard assembly leaks.	<ol style="list-style-type: none"> The tip was assembled incorrectly. The washer is worn. 	<ol style="list-style-type: none"> Check the tip assembly and assemble properly (see page 17). Replace the washer.* (see page 17)
G. The spray gun will not spray.	<ol style="list-style-type: none"> The spray tip or the gun filter is plugged. The spray tip is not fully in the SPRAY position. 	<ol style="list-style-type: none"> Clean the spray tip or gun filter. Put the tip in the SPRAY position.
H. The paint pattern is tailing.	<ol style="list-style-type: none"> The pressure is set too low. The gun or the suction filter is plugged. The suction tube is loose at the inlet valve. The tip is worn. The paint is too thick. Pressure loss. 	<ol style="list-style-type: none"> Increase the pressure. Clean the filters. Tighten the suction tube fitting. Replace the spray tip. Thin the paint. Refer to Causes and Solutions for problem C.

* Special repair kits with instructions are available for these procedures. Refer to the **Maintenance** section of this manual for a list of the kits and their part numbers.

** Additional parts are available for this procedure. Refer to the **Accessories** (page 71) section of this manual for a list of the parts and their part numbers.

Daily Maintenance

The only daily maintenance necessary is thorough cleaning and lubricating after usage. Follow the cleaning and lubricating procedures in this manual.

Extended Maintenance

Some pump parts eventually wear out from use and must be replaced. The following list indicates the available repair kits for the parts replaced by each kit. However, pump performance is the only reliable indicator of when to replace wear parts. Refer to the **Troubleshooting** section for more information on when to use these kits.

Kit Part #	Description
0512221	Fluid Section Seal Kit (9145, 9155)
0512178	Fluid Section Seal Kit (9175, 9195)
0516292	Inlet valve kit (9145, 9155)
0516296	Inlet valve kit (9175, 9195)

Parts List • Liste de pièces • Lista de piezas

Model GX-05 spray gun (9145)
 Modèle du pistolet GX-05 (9145)
 Modelo de pistola GX-05 (9145)

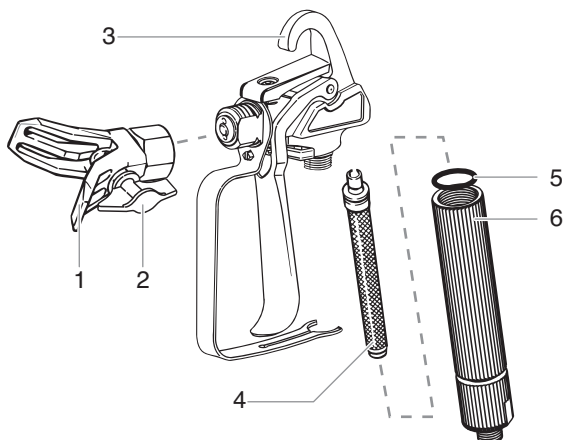

Model GX-07 spray gun (9155, 9175)
 Modèle du pistolet GX-07 (9155, 9175)
 Modelo de pistola GX-07 (9155, 9175)

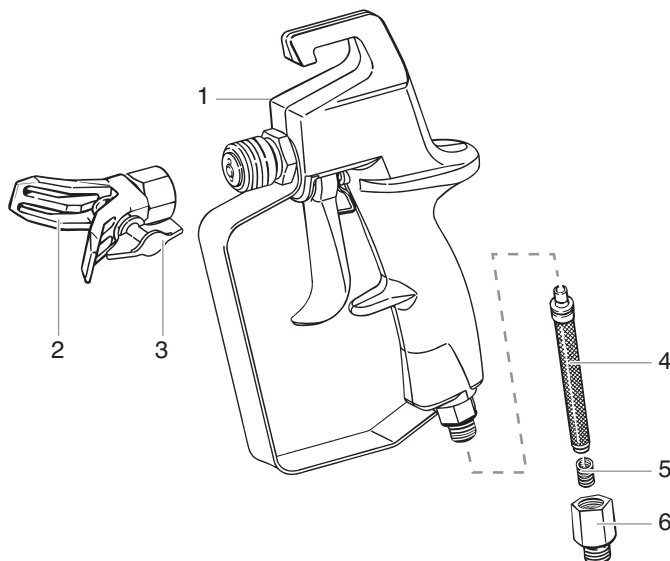

GX-05

Item Article Artículo	Part No. N° de pièce Pieza No.	English Description	Français Description	Español Descripción	Quantity Quantite Cantidad
1	0501011	Guard assembly	Protège-embout et ses composants	Ensamblaje de protección	1
2	0501415	Spray tip, 415	Embout de pulvérisation, 415	Boquilla de rociadora, 415	1
3	0523954	Complete gun assembly (no swivel)	Pistolet et ses composants (sans pivot)	Ensamblaje de la pistola (no oscilador)	1
4	0154675	Filter (yellow)*	Filtre (jaune)*	Filtro (amarillo)*	
5	0515332	Seal	Joint d'étanchéité	Sello	1
6	0515329	Filter housing	Logement de filtre	Alojamiento de filtro	1

GX-07

Item Article Artículo	Part No. N° de pièce Pieza No.	English Description	Français Description	Español Descripción	Quantity Quantite Cantidad
1	0512127	Complete gun assembly (9155)	Pistolet et ses composants (9155)	Ensamblaje de la pistola (9155)	1
	0501004	Complete gun assembly (9175)	Pistolet et ses composants (9175)	Ensamblaje de la pistola (9175)	1
1	0501011	Guard assembly	Protège-embout et ses composants	Ensamblaje de protección	1
2	0501415	Spray tip, 415	Embout de pulvérisation, 415	Boquilla de rociadora, 415	1
4	0515220	Filter (yellow, 9155)*	Filtre (jaune, 9155)*	Filtro (amarillo, 9155)*	
	0515252	Filter (white, 9175)*	Filtre (blanc, 9175)*	Filtro (blanco, 9175)*	
5	0515330	Spring	Ressort	Resorte	1
6	0278257	Cap, filter housing	Capuchon, logement de filtre	Tapa, Alojamiento de filtro	1

- * 2-pack replacement kit
- * Emballage de 2 pour rechange
- * Ensamblaje de 2 para el reemplazo

Parts List • Liste de pièces • Lista de piezas

Model GX-08 spray gun (9195)

Modèle du pistolet GX-08 (9195)

Modelo de pistola GX-08 (9195)

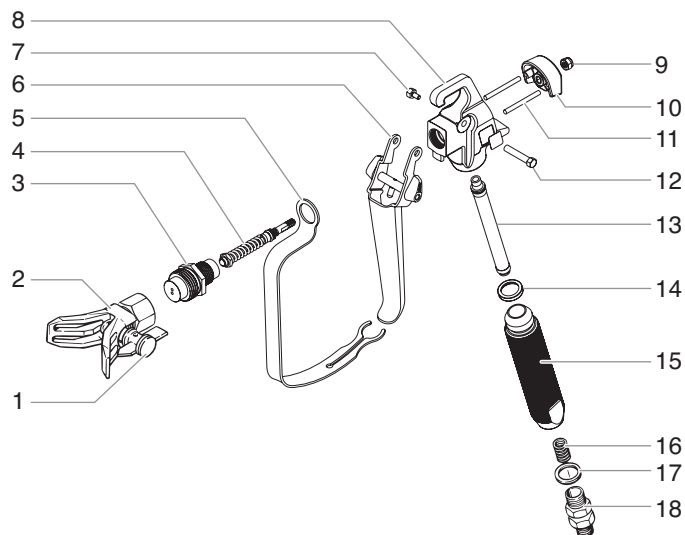

Item Article Artículo	Part No. N° de pièce Pieza No.	English Description	Français Description	Español Descripción	Quantity Quantite Cantidad
1	0501517	Tip, 517	Embout, 517	Boquilla, 517	1
2	0501011	Guard assembly	Protège-embout	Ensamblaje de la protección	1
3	0296404	Diffuser, 7/8"	Pistolet et ses composants	Difusor 7/8"	1
4	0296270	Valve spring unit	Ressort de soupape	Unidad del resorte de la válvula	1
5	0296230	Trigger guard	Protège-doigts	Protector del gatillo	1
6	0296285	Trigger assembly	Détente et ses composants	Ensemble del gatillo	1
7	580-513	Trigger screw (short)	Vis de détente (courte)	Tornillo del gatillo (corto)	1
8	0296228	Gun housing	Corps du pistolet	Alojamiento de la pistola	1
9	9910201	Hex nut	Écrou hexagonal	Tuerca hexagonal	1
10	0296222	Retainer block	Bloc de retenue	Bloque de retención	1
11	580-025	Sliding pin	Cheville coulissante	Pasador deslizante	2
12	580-512	Trigger screw (long)	Vis de détente (longtemps)	Tornillo del gatillo (de largo)	1
13	0515252	Filter (white)*	Filtre (blanc)*	Filtro (blanco)*	1
14	0296289	Washer	Rondelle	Arandela	1
15	0296342	Handle	Poignée	Mango	1
16	0296343	Spring	Ressort	Resorte	1
17	9970123	Sealing ring	Bague d'étanchéité	Aro sellador	1
18	0296301	Fitting	Raccord	Ensamblaje del collarín	1

Parts List • Liste de pièces • Lista de piezas

Suction Set

Dispositif d'aspiration

Juego de succión

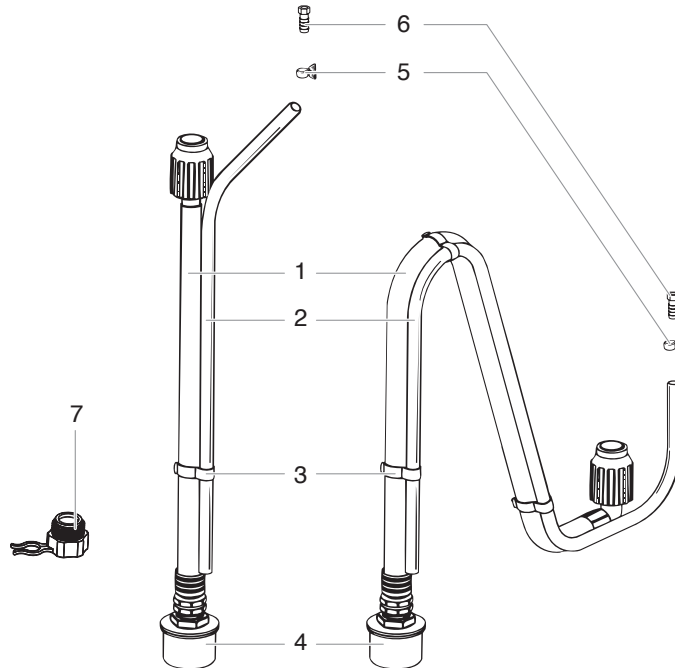

Item Article Artículo	Part No. N° de pièce Pieza No.	English Description	Français Description	Español Descripción	Quantity Quantite Cantidad
1	0516197	Suction set (9145)	Dispositif d'aspiration (9145)	Juego de succión (9145)	1
	0516196	Suction set (9155, 9175, 9195)	Dispositif d'aspiration (9155, 9175, 9195)	Juego de succión (9155, 9175, 9195)	1
2	0512389	Return tube (9155, 9175, 9195)	Tube de retour (9155, 9175, 9195)	Tubo de retorno (9155, 9175, 9195)	1
3	0512390	Clip	Agrafe	Abrazadera	1
4	0516697	Filter	Filtre	Filtro	
5	0327226	Squeeze clip	Agrafe de compression	Abrazadera del apretón	1
6	9885553	Return tube fitting	Raccord de tube de retour	Conector del tubo de retorno	1
7	0515146	Pump cleaning adapter	Adaptateur de nettoyage de pompe	Adaptador de limpieza de bomba	1

Parts List • Liste de pièces • Lista de piezas

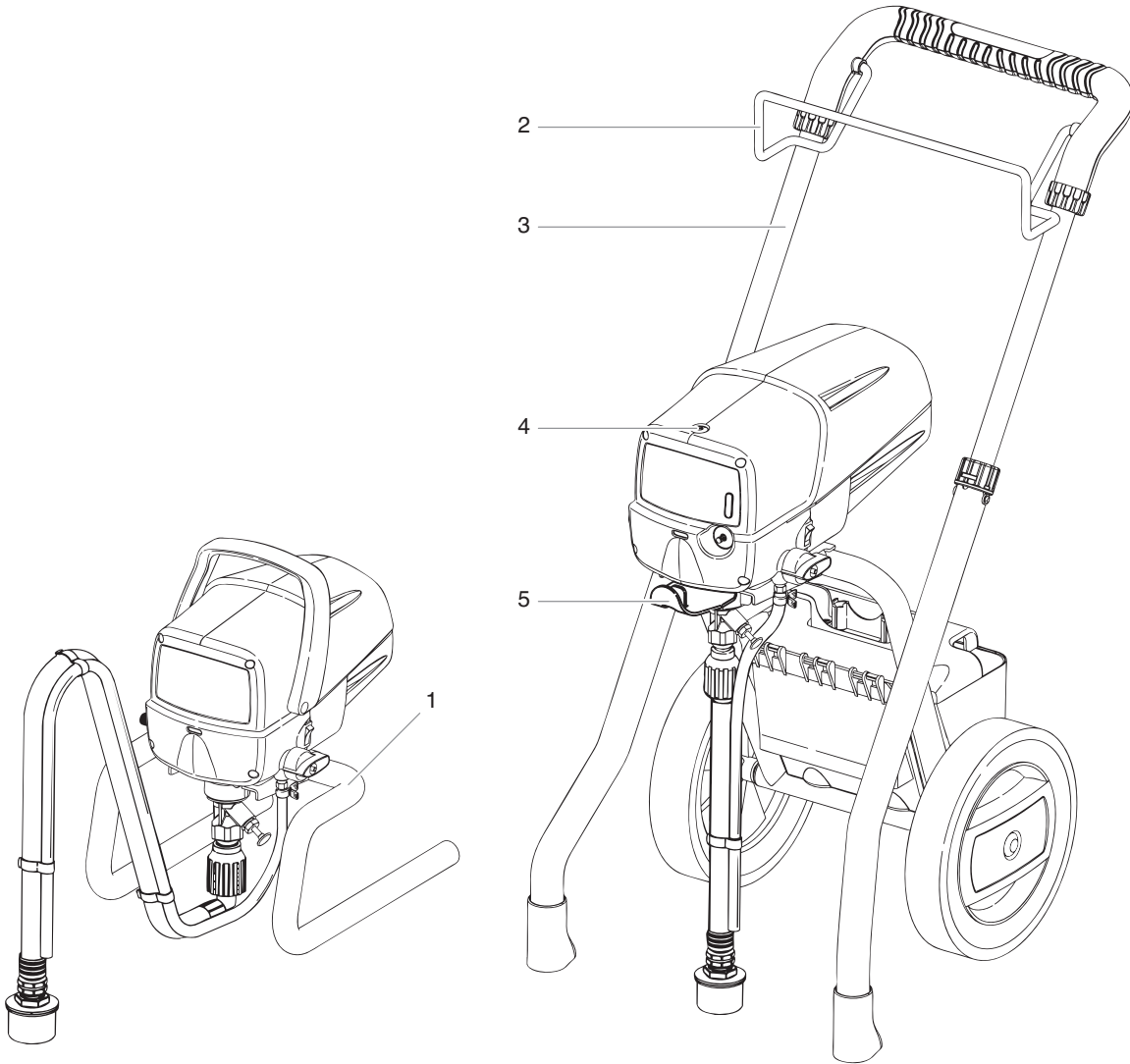

Item Article Artículo	Part No. N° de pièce Pieza No.	English Description	Français Description	Español Descripción	Quantity Quantite Cantidad
1	0516772	Stand assembly (9145 only)	Support et ses composants (9145 seulement)	Ensamblaje de soporte (9145 solamente)	1
2	0523320	Hose bracket	Support de flexible	Soporte de manguera	1
3	0523207A	Cart assembly (9155)	Chariot et ses composants (9155)	Ensamblaje de carrito (9155)	1
	0523206A	Cart assembly (9175)	Chariot et ses composants (9175)	Ensamblaje de carrito (9175)	1
	0523205A	Cart assembly (9195)	Chariot et ses composants (9195)	Ensamblaje de carrito (9195)	1
4	0516581	Oiler cap	Bouchon de graisseure	Tapa de lubricador	1
5	0523322	Pail bracket assembly	Ensamble de support du seau	Ensamblaje de soporte para el bote	1

Accessories • Accessoires • Accesorios

Item Article Artículo	English Description	Français Description	Español Descripción
0516913	Separating oil	Huile séparatrice	Lubricante de empaques
0270192	Hose, Wireless, 25' x 1/4"	Flexible, 7,6 m x 0,6 cm	Manguera 25' x 1/4"
0270118	Hose, Wireless, 50' x 1/4"	Flexible, 15,2 m x 0,6 cm	Manguera 50' x 1/4"
0093896	Hose Connector, 1/4" x 1/4"	Raccord de flexible, 0,6 cm2	Conector de manguera, 1/4" x 1/4"
0088154	Pressure Gauge (0-5000 psi)	Manomètre (0-5000 psi)	Manómetro (0-5000 psi)
0512130	Tip Extension, 12"	Rallonge d'embout, 30,5 cm	Extensión de la boquilla, 12"
0512131	Tip Extension, 24"	Rallonge d'embout, 61,0 cm	Extensión de la boquilla, 24"
0515902	Power Roller Gun Attachment	Rouleau électrique, accessoire pour pistolets	Aditamento de la pistola del rodillo automático
0155206	9" Roller Cover, 3/8" Nap	Manchon de rouleau de 22,9 cm, grain de 1,0 cm	Funda del rodillo 9", pelillo de 3/8"
0155208	9" Roller Cover, 3/4" Nap	Manchon de rouleau de 22,9 cm, grain de 1,9 cm	Funda del rodillo 9", pelillo de 3/4"
0501002	GX-08 Four Finger Airless Spray Gun	Pistolet sans air à détente allongée - métal (GX-08)	Pistola rociadora sin aire del cuatro dedos GX-08
0501004	GX-07 Two Finger Airless Spray Gun	Pistolet sans air à détente courte- métal (GX-07)	Pistola rociadora sin aire del dos dedos GX-07
0523954	GX-05 Airless Spray Gun	Pistolet sans air (GX-05)	Pistola rociadora sin aire GX-05
0501011	Guard Assembly, G-Thread	Protège-doigts, filets « G »	Ensamblaje de protección, Roscado G
0279974	3 Foot Pole Extension w/Swivel	Rallonge de manche, avec pivot, 0,9 m	Tubo de extensión de 92 cm c/oscilador
0279976	6 Foot Pole Extensionw/Swivel	Rallonge de manche, avec pivot, 1,8 m	Tubo de extensión de 1.8 m c/oscilador
0501411	411 Spray Tip	Embout de pulvérisation, 411	Boquilla rociadora 411
0501413	413 Spray Tip	Embout de pulvérisation, 413	Boquilla rociadora 413
0501415	415 Spray Tip	Embout de pulvérisation, 415	Boquilla rociadora 415
0501417	417 Spray Tip	Embout de pulvérisation, 417	Boquilla rociadora 417
0501419	419 Spray Tip	Embout de pulvérisation, 419	Boquilla rociadora 419
0501515	515 Spray Tip	Embout de pulvérisation, 515	Boquilla rociadora 515
0501517	517 Spray Tip	Embout de pulvérisation, 517	Boquilla rociadora 517
0501519	519 Spray Tip	Embout de pulvérisation, 519	Boquilla rociadora 519
0501521	521 Spray Tip	Embout de pulvérisation, 521	Boquilla rociadora 521
0156113	TR-10 Telescoping Roller, 9", 3/8" Nap	Manche de rouleau télescopique TR-10, manchon de 22,9 cm, grain de 1,0 cm	Rodillo telescópico TR-10, pelillo de 9", 3/8"
0154919	Green Gun Filter (2 pack)	Filtre de pistolet vert (quantité 2)	Filtro de pistola verde (cantidad 2)
0154675	Yellow Gun Filter (2 pack)	Filtre de pistolet jaune (quantité 2)	Filtro de pistola amarillo (cantidad 2)
0154842	White Gun Filter (2 pack)	Filtre de pistolet blanc (quantité 2)	Filtro de pistola blanco (cantidad 2)
0154918	Red Gun Filter (2 pack)	Filtre de pistolet rouge (quantité 2)	Filtro de pistola rojo (cantidad 2)
0154839	Pump Saver Plus Protector	Lubrifiant Pump Saver Plus (lubrifiant)	Protector Pump Saver Plus (lubricante)

Warranty • Garantíé • Garantía

LIMITED WARRANTY - AIRLESS PAINT SPRAY EQUIPMENT

This product, manufactured by Wagner Spray Tech Corporation (Wagner), is warranted to the original retail purchaser against defects in material and workmanship for one year from date of purchase.

This warranty does not cover damage resulting from improper use, accidents, user's negligence or normal wear. This warranty does not cover any defects or damages caused by service or repair performed by anyone other than a Wagner Authorized Service Center. This warranty does not apply to accessories.

ANY IMPLIED WARRANTY OF MERCHANTABILITY OR FITNESS FOR A PARTICULAR PURPOSE IS LIMITED TO ONE YEAR FROM DATE OF PURCHASE.

WAGNER SHALL NOT IN ANY EVENT BE LIABLE FOR ANY INCIDENTAL OR CONSEQUENTIAL DAMAGES OF ANY KIND, WHETHER FROM BREACH OF THIS WARRANTY OR ANY OTHER REASON.

If any product is defective in material and/or workmanship during the applicable warranty period, return it with proof of purchase, transportation prepaid to any Wagner Authorized Service Center. (Service Center listing is enclosed with this product.) Wagner's Authorized Service Center will either repair or replace the product (at Wagner's option) and return it to you, postage prepaid.

SOME STATES DO NOT ALLOW LIMITATIONS ON HOW LONG AN IMPLIED WARRANTY LASTS OR THE EXCLUSION OF INCIDENTAL OR CONSEQUENTIAL DAMAGES, SO THE ABOVE LIMITATION AND EXCLUSION MAY NOT APPLY TO YOU.

THIS WARRANTY GIVES YOU SPECIFIC LEGAL RIGHTS, AND YOU MAY ALSO HAVE OTHER RIGHTS WHICH VARY FROM STATE TO STATE.

GARANTIE LIMITÉE - MATÉRIEL DE PULVÉRISATION DE PEINTURE SANS AIR

Ce produit, fabriqué par Wagner Spray Tech Corporation (Wagner), est garanti, au bénéfice de l'acheteur au détail d'origine, contre tout vice de matières et toute malfaçon pour un an à compter de la date d'achat.

La présente garantie ne s'applique pas aux dégâts entraînés par une utilisation incorrecte, par la négligence de l'utilisateur ou par l'usure normale. La présente garantie ne s'applique pas non plus aux défauts ou dommages résultant de l'entretien ou de la réparation que fait une personne quelconque qui ne soit pas membre d'un centre d'entretien autorisé pour les produits Wagner. La présente garantie ne s'applique pas aux accessoires.

TOUTE GARANTIE IMPLICITE DE QUALITÉ MARCHANDE OU D'ADAPTATION À UN USAGE PARTICULIER EST LIMITÉE À UNE PÉRIODE DE 30 JOURS POUR UNE UTILISATION PROFESSIONNELLE OU DE LOCATION ET D'UNE ANNÉE POUR L'UTILISATION DOMESTIQUE, À COMPTER DE LA DATE D'ACHAT.

TOUTE GARANTIE IMPLICITE DE VENDABILITÉ OU DE CONVENANCE À UNE DESTINATION PARTICULIÈRE EST LIMITÉE À UN AN À COMPTER DE LA DATE D'ACHAT.

Si un produit est défectueux en ce qui concerne les matériaux ou l'exécution pendant la période de garantie applicable, vous devez le retourner, avec une preuve d'achat et frais de port payés, à n'importe quel centre d'entretien autorisé pour les produits Wagner. (Une liste de ces centres d'entretien est jointe à ce produit.) Le centre d'entretien autorisé pour les produits Wagner réparera ou remplacera le produit (à la discrétion de Wagner) et vous le retournera par la poste, avec frais de port payés.

CERTAINES PROVINCES INTERDISENT LES RESTRICTIONS SUR LA DURÉE D'UNE GARANTIE IMPLICITE OU L'EXCLUSION DES DOMMAGES ACCESSOIRES OU INDIRECTS. IL SE PEUT DONC QUE LA RESTRICTION ET L'EXCLUSION ÉNONCÉES CI-DESSUS NE S'APPLIQUENT PAS À VOUS.

LE PRÉSENTE GARANTIE VOUS ACCORDE DES DROITS JURIDIQUES SPÉCIFIQUES, ET VOUS AVEZ PEUT-ÊTRE D'AUTRES DROITS, QUI PEUVENT VARIER D'UNE PROVINCE À L'AUTRE.

GARANTÍA LIMITADA - EQUIPO DE ATOMIZACIÓN DE PINTURA SIN AIRE

Este producto, fabricado por Wagner Spray Tech Corporation (Wagner), está garantizado ante el comprador original contra defectos de materiales y mano de obra durante un año contado a partir de la fecha de compra.

Esta garantía no cubre los daños que sean resultado de un uso inapropiado, accidentes, negligencia del usuario o un desgaste normal. Esta garantía no cubre ningún defecto o daño que haya sido causado por los servicios o reparaciones llevadas a cabo por alguien que no sea un técnico del Centro de Servicio Autorizado de Wagner. Esta garantía no es válida para ningún accesorio.

CUALQUIER GARANTIA IMPLICITA DE COMERCIALIZACION O IDONEIDAD PARA CUALQUIER PROPOSITO EN PARTICULAR QUEDA LIMITADA A UN AÑO A PARTIR DE LA FECHA DE COMPRA.

WAGNER NO SERÁ EN NINGÚN CASO RESPONSABLE DE NINGÚN DAÑO INCIDENTAL O DE CONSECUENCIA DE NINGUNA CLASE, QUE RESULTE DE VIOLAR ESTA GARANTÍA O POR CUALQUIER OTRA RAZÓN.

Si algún producto llegara a tener defectos de material y/o mano de obra durante el período de validez de la garantía, devuélvalo junto con el comprobante de compra y flete previamente pagado, a cualquier Centro de Servicio Autorizado de Wagner. (La lista de Centros de Servicio viene adjunta con este producto.) El Centro de Servicio Autorizado de Wagner reparará o reemplazará el producto (según la opción de Wagner) y se lo devolverá, con porte previamente pagado.

ALGUNOS ESTADOS NO PERMITEN LIMITACIONES EN CUANTO A LA DURACIÓN DE UNA GARANTÍA IMPLÍCITA O LA EXCLUSIÓN DE DAÑOS INCIDENTALES O DE CONSECUENCIA, DE MANERA QUE LA LIMITACIÓN Y EXCLUSIÓN ANTERIORES PODRÍAN NO SER VÁLIDAS PARA USTED.

ESTA GARANTÍA LE CONCEDE DERECHOS LEGALES ESPECÍFICOS, PERO USTED PODRÍA TENER DERECHO A OTROS, LOS CUALES VARÍAN DE UN ESTADO A OTRO.

Wagner Spray Tech

1770 Fernbrook Lane
Plymouth, MN 55447

1-800-880-0993

U.S. Patent Nos. 6,435,846 6,599,107

Other patents pending