

# WAGNER®

## High-performance Airless Sprayer

Owner's Manual • Notice d'utilisation • Manual del Propietario

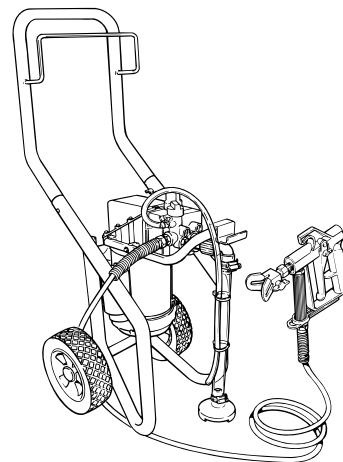

### Quick-start

Easy does it from setup to cleanup:



**1** Read all WARNINGS!  
Lire toutes les mises en garde!  
¡Lea todas las advertencias!

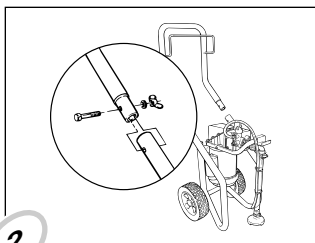

**2** Assemble the sprayer  
Monter le pulvérisateur.  
Ensamble el atomizador.



**3** Attach the tip  
Attacher la tête de pulvérisation.  
Fije la boquilla.

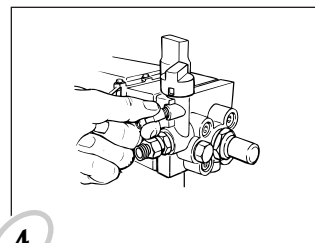

**4** Attach the return hose  
Attacher le tuyau de retour.  
Fije la manguera de retorno.

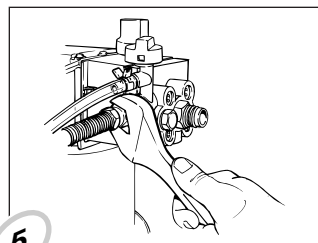

**5** Attach the paint hose  
Attacher le tuyau à fluide.  
Fije la manguera de fluido.

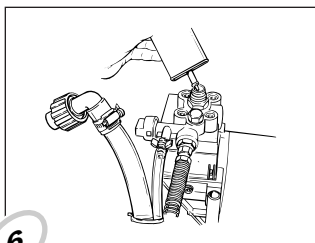

**6** Prepare to prime  
Préparer l'amorçage.  
Prepare para cebar.

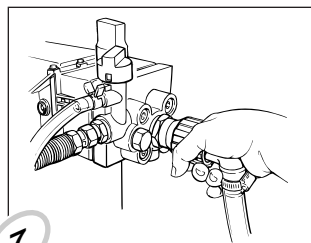

**7** Attach the suction set  
Attacher l'ensemble d'aspiration.  
Fije el equipo de succión.

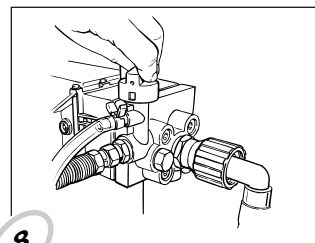

**8** Prime the pump  
Amorcer la pompe.  
Cebe la bomba.

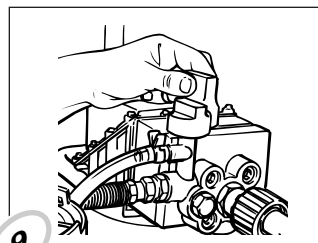

**9** Set the pressure  
Régler la pression.  
Fije la presión.

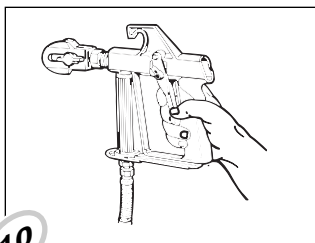

**10** Spray  
Pulvériser  
Atomice.



**11** Store temporarily  
Ranger de façon temporaire  
Almacene temporalmente

OR  
OU  
O

clean up  
nettoyer.  
limpie.

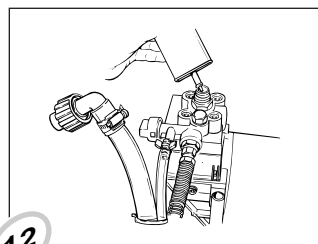

**12** Maintain  
Faire l'entretien.  
Mantenga (De mantenimiento).

**Need help? Call us first for answers fast.**  
Call Wagner toll-free if you have any comments  
or problems with this Wagner product.

**1-800-880-0993**  
**Wagner Technical Service**  
Weekdays: 8:00 - 4:30 Central time  
Weekends: 9:00 - 4:00 Central time  
1770 Fernbrook Lane, Minneapolis, MN 55447

# CONTENTS

<b>COMPONENTS</b> .....	<b>2</b>
<b>GENERAL DESCRIPTION</b> .....	<b>2</b>
Specifications .....	2
<b>SAFETY PRECAUTIONS</b> .....	<b>3-4</b>
<b>GROUNDING INSTRUCTIONS</b> .....	<b>4</b>
<b>SETUP</b> .....	<b>5-6</b>
Assembling the cart .....	5
Attaching the tip .....	5
Attaching the return hose .....	6
Attaching the paint hose .....	6
Attaching the pail bracket .....	6
<b>PRESSURE RELIEF PROCEDURE</b> .....	<b>6</b>
<b>PRIMING</b> .....	<b>7</b>
Preparing to prime .....	7
Attaching the suction set .....	7
Priming the pump .....	7
<b>SPRAYING</b> .....	<b>8-9</b>
Spraying technique .....	8
Practice .....	8
If the spray tip becomes clogged .....	9
Cleaning the spray gun filter .....	9
Cleaning the filter during the painting process .....	9
Cleaning the suction set screen .....	9
<b>CLEANUP</b> .....	<b>10-11</b>
Overnight storage .....	10
Long-term storage .....	10-11
<b>MAINTENANCE</b> .....	<b>12</b>
Removing and cleaning the inlet valves .....	12
Removing and cleaning the outlet valve .....	12
Tightening the PRIME/SPRAY knob .....	12
<b>TROUBLESHOOTING</b> .....	<b>13</b>
<b>PARTS DIAGRAMS</b> .....	<b>40-43</b>
Final Assembly .....	40
Paint Pump Assembly .....	41
Suction Set Assembly .....	42
G-06 Spray Gun .....	43
<b>FRANÇAIS</b> .....	<b>14</b>
<b>ESPAÑOL</b> .....	<b>28</b>
<b>WARRANTY</b> .....	<b>back cover</b>

# COMPONENTS

The shipping carton for your painting system contains the following:

- Cart frame with wheels, motor and pump attached.
- Cart handle.
- Pail bracket.
- Suction set and return tube.
- Spray gun and filter.
- Spray tip and gasket.
- Three bolts with washers and wing nuts.
- Pressure hose.

The following are located in the literature set with this operator's manual:

- Spare Outlet Spring P/N 0047485
- Spare Tip Seal , P/N 0156713
- Return tube fitting, P/N 0088715
- Registration card.

# GENERAL DESCRIPTION

This high performance airless sprayer is a precision power tool used for spraying many types of materials. Read and follow this instruction manual carefully for proper operating instructions, maintenance and safety information.

## Specifications

- Weight .....27 lbs.
- Capacity .....Up to .38 gallon (1.25 liters) per minute.
- Power source.....1/2 HP electric motor, totally enclosed, fan cooled.
- Power requirement .....15 amp minimum circuit on 115 VAC, 60 Hz current.
- Generator .....15 amp A/C.
- Spraying pressure .....Up to 2800 psi.
- Safety features .....Spray gun trigger lock and pressure diffuser; built-in tip safety guard; priming knob for safe pressure release.
- Portability.....Compact design, light weight for easy movement.
- Capability.....Sprays a variety of paints, oil base latex, primers, stains, preservatives and other nonabrasive materials, including pesticides and liquid fertilizers.

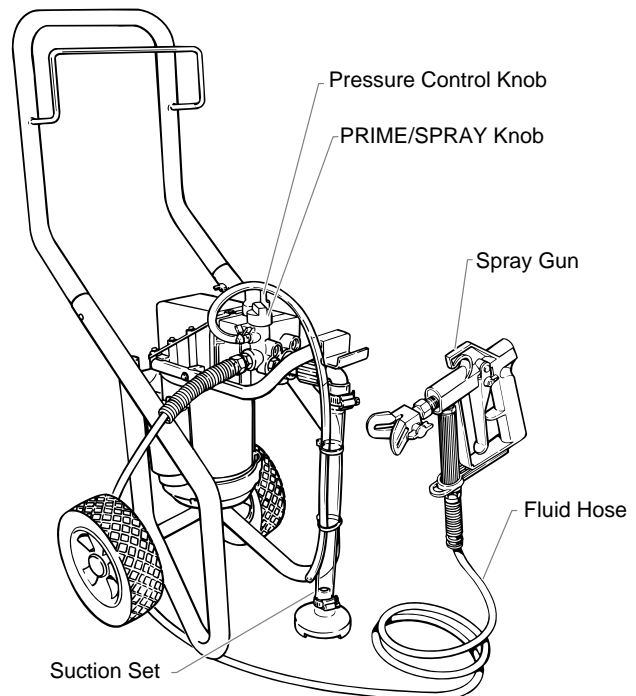

# SAFETY PRECAUTIONS

This manual contains information which must be read and understood before using the equipment. When you come to an area which has one of the following symbols, pay particular attention and make certain to heed the safeguard.



This symbol indicates a potential hazard which may cause serious injury or loss of life. Important safety information will follow.



This symbol indicates a potential hazard to you or to the equipment. Important information that tells how to prevent damage to the equipment or how to avoid causes of minor injuries will follow.

**NOTE:** Notes give important information which should be given special attention.



**THIS UNIT IS PROVIDED WITH A THERMALLY PROTECTED AUTOMATIC RESET. IF AN OVERLOAD OCCURS THE THERMALLY PROTECTED AUTOMATIC RESET DISCONNECTS THE MOTOR FROM THE POWER SUPPLY.**

- The motor will restart without warning when the protector automatically resets.
- Always disconnect the motor from the power supply before working on the equipment.
- When the thermally protected automatic reset disconnects the motor from the power supply, relieve pressure by turning the priming valve to PRIME (☉).
- Turn the ON/OFF switch to OFF.

**NOTE:** The cause of the overload should be corrected before restarting. See TROUBLESHOOTING.



**HAZARD: Injection injury - A high pressure stream of paint produced by this equipment can pierce the skin and underlying tissues, leading to serious injury and possible amputation.**

**DO NOT TREAT AN INJECTION INJURY AS A SIMPLE CUT!** Injection can lead to amputation. See a physician immediately.

**The maximum operating range of the gun is 2800 PSI fluid pressure.**

#### PREVENTION:

- NEVER aim the gun at any part of the body.
- NEVER allow any part of the body to come in contact with the fluid stream. DO NOT come in contact with a fluid stream created by a leak in the fluid hose.
- NEVER put your hand in front of the gun. Gloves will not provide protection against an injection injury.
- ALWAYS lock the gun trigger, shut the fluid pump off and release all pressure before servicing, cleaning the tip guard, changing tips, or leaving unattended. Pressure will not be released by turning off the engine. The

PRIME/SPRAY knob must be turned to PRIME (☉) to relieve the pressure. Refer to the PRESSURE RELIEF PROCEDURE described in this manual.

- ALWAYS have the tip guard in place while spraying. The tip guard provides some protection against injection injuries but is mainly a warning device.
- ALWAYS remove the spray tip before flushing or cleaning the system.
- Inspect the paint hose before each use. The paint hose can develop leaks from wear, kinking and abuse. A leak is capable of injecting material into the skin.
- NEVER use a spray gun which does not have a trigger lock or trigger guard in place and in working order.
- All accessories must be rated at or above 2800 PSI. This includes spray tips, guns, extensions, and hose.

#### NOTE TO PHYSICIAN:

**Injection into the skin is a traumatic injury. It is important to treat the injury surgically as soon as possible. DO NOT delay treatment to research toxicity. Toxicity is a concern with some coatings injected directly into the blood stream. Consultation with a plastic surgeon or reconstructive hand surgeon may be advisable.**

**HAZARD: EXPLOSION OR FIRE - Solvent and paint fumes can explode or ignite, causing property damage and/or severe injury.**

#### PREVENTION:

- Exhaust and fresh air introduction must be provided to keep the air within the spray area free from accumulation of flammable vapors.
- Avoid all ignition sources such as static electricity sparks, open flames, pilot lights, hot objects, cigarettes, and sparks from connecting and disconnecting power cords or working light switches.
- Fire extinguishing equipment must be present and in good working order.
- Keep the pump away from the spray area to avoid solvent and paint fumes.
- High velocity flow of material through equipment may develop static electricity. The equipment being used, as well as objects in and around the spray area must be properly grounded to prevent static discharge and sparks.
- Use only conductive or grounded high pressure fluid hoses for airless applications. Be sure that the gun is grounded properly through hose connections.
- Follow the material and solvent manufacturer's safety precautions and warnings.
- When flushing equipment use the lowest possible pressure.

**HAZARD: EXPLOSION HAZARD DUE TO INCOMPATIBLE MATERIALS - May cause property damage or severe injury.**

#### PREVENTION:

- Do not use bleach.
- Do not use Halogenated hydrocarbon solvents such as methylene chloride and 1,1,1 - trichloroethane. They are not compatible with aluminum and may cause an explosion. If you are unsure of a material's compatibility with aluminum, contact your coating's supplier.

## ⚠ WARNING

**HAZARD: HAZARDOUS VAPORS - Paints, solvents, insecticides, and other materials may be harmful if inhaled, causing severe nausea, fainting, or poisoning.**

**PREVENTION:**

- Use a respirator or mask whenever there is a chance that vapors may be inhaled. Read all instructions with the mask to ensure that it will provide the necessary protection against the inhalation of harmful vapors.

**HAZARD: GENERAL - May cause property damage or severe injury.**

**PREVENTION:**

- Read all instructions and safety precautions before operating any equipment.
- Comply with all appropriate local, state, and national codes governing ventilation, fire prevention, and operation.
- The United States Government Safety Standards have been adopted under the Occupational Safety and Health Act (OSHA). These standards, particularly part 1910 of the General Standards and part 1926 of the Construction Standards should be consulted.
- This high pressure airless pump is designed to be used with manufacturer authorized parts only. When using this pump with parts that do not comply with the minimum specifications and safety devices of the pump manufacturer, the user assumes all risks and liabilities.
- Before each use, check all hoses for cuts, leaks, abrasion or bulging of cover, as well as damage or movement of couplings. If any of these conditions exist, replace the hose immediately. Never repair a paint hose. Replace it with another grounded hose.
- All hoses, swivels, guns, and accessories used with this unit must be pressure rated at or above 2800 PSI.
- Do not spray on windy days.

## ⚠ CAUTION

Use only a 3-wire extension cord that has a 3-blade grounding plug and a 3-slot receptacle that will accept the plug on the product. Make sure your extension cord is in good condition. When using an extension cord, be sure to use one heavy enough to carry the current your product will draw. An undersized cord will cause a drop in line voltage resulting in loss of power and overheating. A 14 or 12 gauge cord is recommended.

**NOTE: Do not use more than 100 feet of extension cord. If you need to paint further than 100 feet from your power source, use more paint hose, not more extension cord. Shorter extension cords will ensure maximum electrical power for proper operation.**

## GROUNDING INSTRUCTIONS

This product must be grounded. In the event of an electrical short circuit, grounding reduces the risk of electric shock by providing an escape wire for the electric current. This product is equipped with a cord having a grounding wire with an appropriate grounding plug. The plug must be plugged into an outlet that is properly installed and grounded in accordance with all local codes and ordinances.

## ⚠ WARNING

**Improper installation of the grounding plug can result in a risk of electric shock.**

If repair or replacement of the cord or plug is necessary, do not connect the green grounding wire to either flat blade terminal. The wire with insulation having a green outer surface with or without yellow stripes is the grounding wire and must be connected to the grounding pin.

Check with a qualified electrician or serviceman if the grounding instructions are not completely understood, or if you are in doubt as to whether the product is properly grounded. Do not modify the plug provided. If the plug will not fit the outlet, have the proper outlet installed by a qualified electrician. This product is for use on a nominal 120 volt circuit and has a grounding plug that looks like the plug illustrated below. A temporary adapter which looks like the adapter illustrated in the figure below may be used to connect this plug to a 2 pole receptacle as shown if a properly grounded outlet is not available.

The temporary adapter should be used only until a properly grounded outlet as shown below can be installed by a qualified electrician. The green colored rigid ear lug or the grounding wire extending from the adapter must be connected to a permanent ground such as a properly grounded outlet box cover. Whenever the adapter is used, it must be held in place by a metal screw.

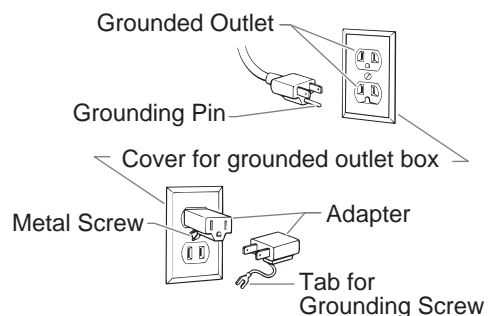

# SETUP

## Assembling the Cart

**NOTE: The sprayer should remain unplugged during assembly.**

1. Slide the cart handle onto the frame. Make certain that the hose hook is facing toward the pump.
2. Slide the bolts through the handle and frame, place a washer over the bolt ends and thread on the thumb nut.

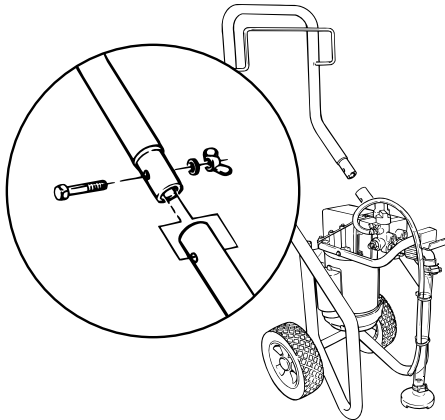

## Attaching the Tip

### Assembling the Tip

If the spray tip is disassembled:

1. Insert the tip into the spray guard and turn the tip to the spray position so that the arrow is facing toward the front of the spray gun.

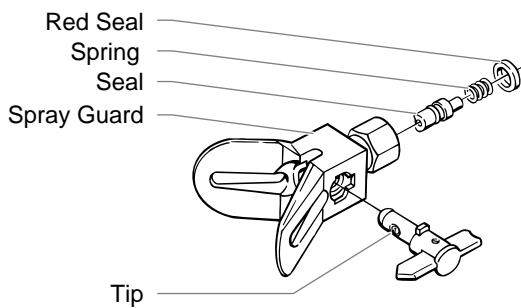

2. Insert the seal so that the curve of the seal aligns with the curve of the tip.

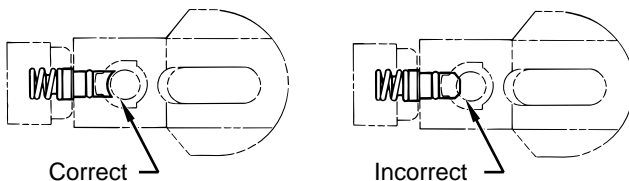

## Attaching the Tip to the Gun

1. Lock the gun by turning the gun safety switch so that it is parallel to the gun body.

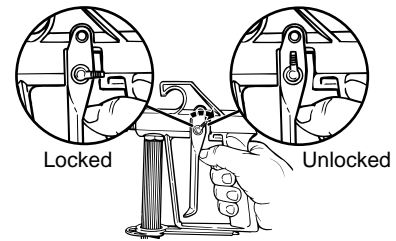

## WARNING

**POSSIBLE INJECTION HAZARD. Do not spray without the tip guard in place. Never trigger the gun unless the tip is in either the spray or the unclog position. Always engage the gun safety switch before removing, replacing or cleaning tip.**

2. Thread the spray tip onto the gun. Tighten the nut first by hand, then tighten more firmly with a wrench.

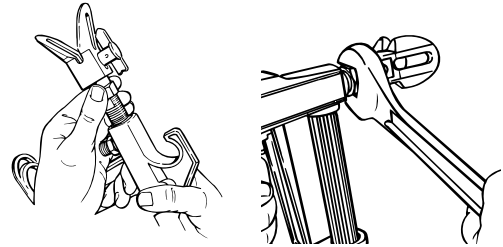

**NOTE: When attaching the tip to the gun, align the tip guard as shown in the figure below, then tighten with a wrench.**

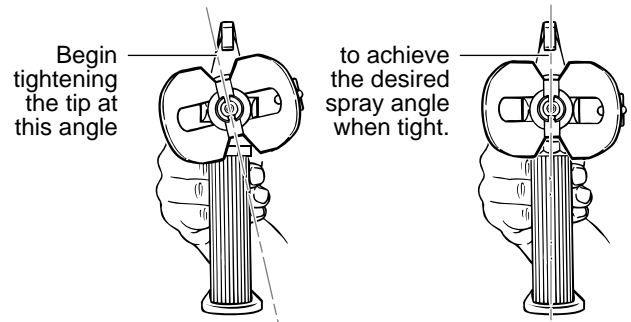

## Attaching the Return Hose

1. Be sure that the motor switch is turned to OFF.
2. Screw the brass fitting found in the literature set into the return tube port on the side of the pump and tighten firmly by hand.

**NOTE: Do not overtighten. Hand-tighten only. Some threads will be visible even when fully tightend.**

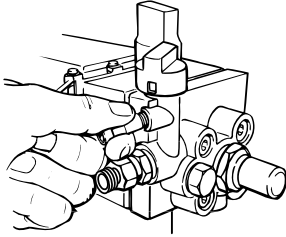

3. Press the return tube onto the brass fitting and secure with the clamp provided.

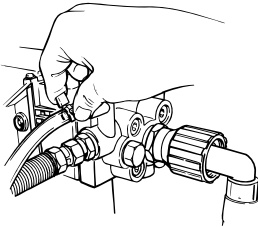

## Attaching the Paint Hose

1. Attach the high pressure hose to the paint hose port. Use an wrench to tighten the paint hose securely.

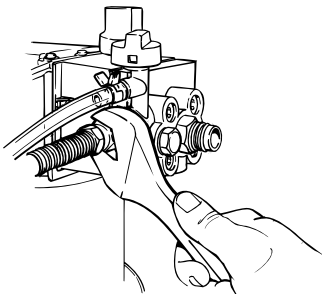

2. Attach the gun to the other end of the high pressure hose. Tighten securely with two wrenches.

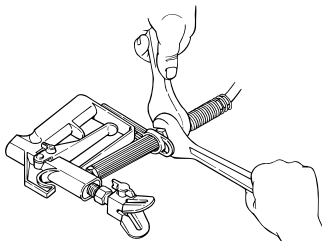

3. Plug the sprayer into a properly grounded outlet or heavy duty grounded extension cord. Do not use more than 100 feet of cord. If you must spray a long distance from a power source, use more paint hose, not more extension cords. Use a minimum size of 16 gauge for power extension cords up to 50 feet in length, or 12 to 14 gauge for power extension cords between 50 and 100 feet in length.

## Attaching the pail bracket

1. Slide the pail bracket onto the pump housing and attach with the self-tapping screws provided, one on each side of the pump assembly.

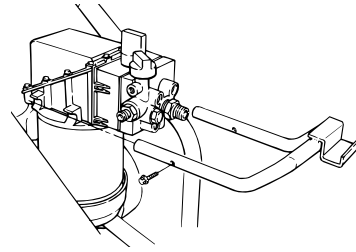

**NOTE: If you are setting the sprayer up for the first time, wait to attach the pail bracket until after you have primed the pump.**

## PRESSURE RELIEF PROCEDURE

Follow this procedure after the unit is assembled and before any operation which involves the spray gun such as cleaning and maintenance or changing tips or accessories.

1. Turn the pressure control knob counterclockwise to its lowest setting.
2. Turn the PRIME/SPRAY knob to PRIME (☺).

Pressure Control Knob → PRIME/SPRAY Knob →

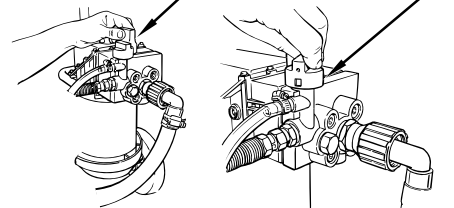

3. Trigger the gun to remove any pressure which may still be in the hose.
4. Lock the gun by turning the gun safety switch so that it is parallel to the gun body.

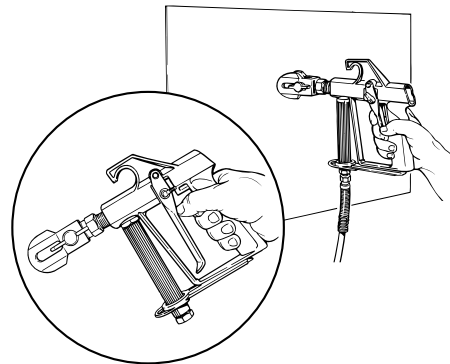

**WARNING**

**Injection hazard. Do not spray without the tip guard in place. NEVER trigger the gun unless the tip is completely turned to either the spray or the unclog position. ALWAYS engage the gun safety switch before removing, replacing or cleaning tip.**

# PRIMING

## Preparing to Prime

1. Lay the unit on its back and fill the inlet valve with water or with a light household oil.

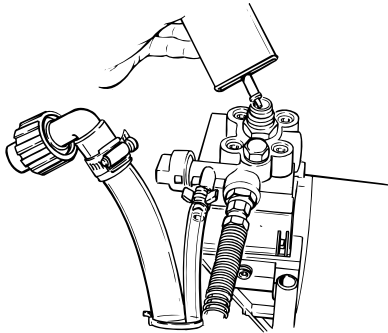

2. Make certain that the PRIME/SPRAY knob is set to PRIME (☉) and that the pressure control knob is turned counterclockwise to the lowest pressure setting.
3. Turn the motor switch to ON.
4. Increase the pressure by turning the pressure control knob clockwise 1/2 turn.
5. Force the inlet valve to open and close by pushing on it with a screwdriver or the eraser end of a pencil. It should move up and down about 1/16 of an inch. Continue until water or oil is sucked into the sprayer. This will wet the moving parts and break loose any old paint residue.

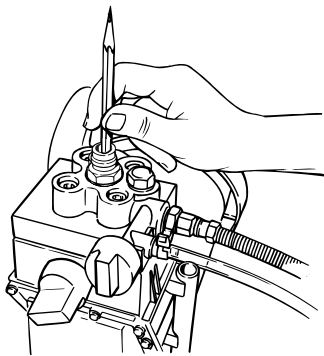

6. Put the palm of your hand over the inlet. Turn the pressure control knob clockwise to its maximum setting. You should feel suction coming from the inlet valve. If you do not, see the section on cleaning and servicing the outlet valve.

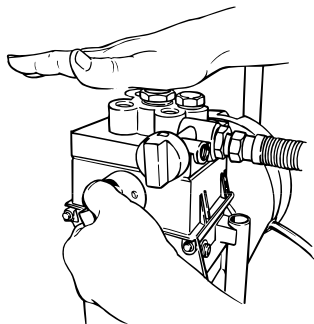

7. Turn the pressure control knob counterclockwise to the minimum pressure setting.
8. Turn the motor switch to OFF.

## Attaching the Suction Set

1. Attach the suction tube to the inlet valve and tighten firmly by hand. Be sure that the threads are straight so that the fitting turns freely.

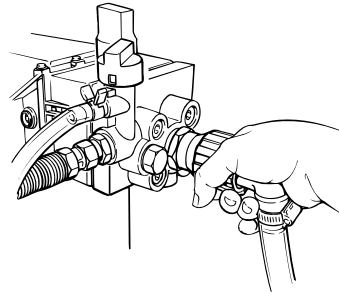

2. Place the suction tube and the return tube into the paint.
3. Hang the paint bucket onto the pail bracket.

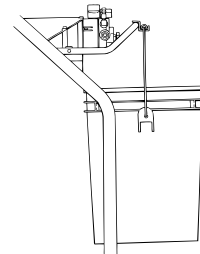

## Priming the Pump

1. Turn the pressure control knob counterclockwise to its lowest pressure setting.
2. Turn the PRIME/SPRAY knob to PRIME (☉).

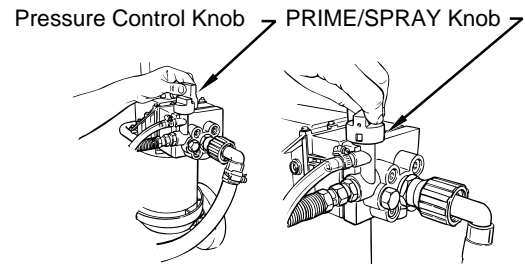

3. Turn the motor switch to ON.
4. Turn the pressure control knob clockwise to between half and full pressure. You should see the paint move through the suction tube to the pump. Let the unit prime 1 to 2 minutes after paint begins to flow through the return tube.

**CAUTION**

Always reduce the pressure to zero before changing the position of the priming knob. Failure to do so may cause damage to the paint pump diaphragm.

**CAUTION**

If the pressure control knob is reduced to zero and the PRIME/SPRAY knob is still on SPRAY (☾) while the sprayer is operating, there will be high pressure in the hose and spray gun until the priming knob is turned to PRIME (☉) or until the spray gun is triggered to relieve the pressure.

# SPRAYING

## Spraying Technique

The key to a good paint job is an even coating over the entire surface. This is done by using even strokes. Keep your arm moving at a constant speed and keep the spray gun at a constant distance from the surface. The best spraying distance is 10 to 12 inches between the spray tip and the surface.

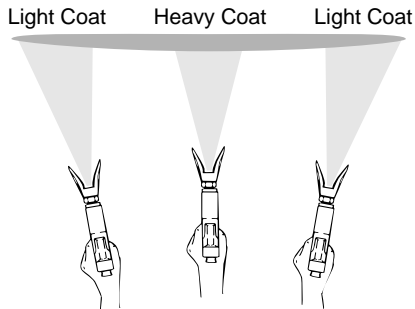

Do not flex wrist while spraying.

Keep the spray gun at right angles to the surface. This means moving your entire arm back and forth rather than just flexing your wrist.

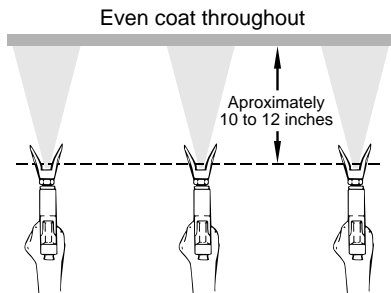

Keep stroke smooth and at an even speed.

Keep the spray gun perpendicular to the surface, otherwise one end of the pattern will be thicker than the other.

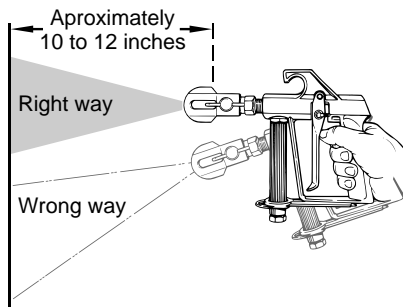

The spray gun should be triggered by turning it on and off with each stroke. This will save paint and avoid paint buildup at the end of the stroke. Do not trigger the gun during the middle of a stroke. This will result in an uneven spray and splotchy coverage.

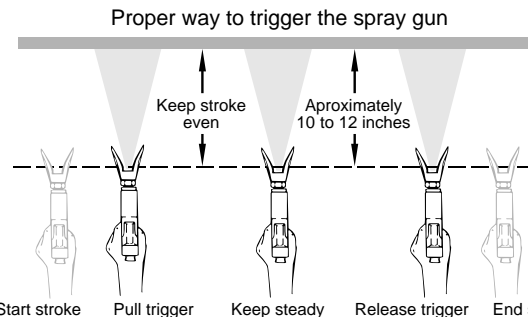

Overlap each stroke by about 30%. This will ensure an even coating. When you stop painting, lock the gun safety switch, turn the pressure control knob counterclockwise to its lowest setting and set the priming knob to PRIME (☉). Turn the motor switch to OFF and unplug the sprayer.

If you expect to be gone more than 1 hour, follow the short term clean up procedure described in the CLEANUP section of this manual.

## Practice

1. Be sure that the paint hose is free of kinks and clear of objects with sharp cutting edges.
2. Turn the pressure control knob counterclockwise to its lowest setting.
3. Turn the PRIME/SPRAY knob to SPRAY (☉).

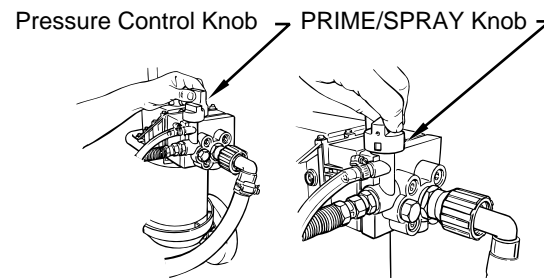

4. Turn the pressure control knob clockwise to its highest setting. The paint hose should stiffen as paint begins to flow through it.
5. Unlock the gun safety switch by turning the switch so that it is parallel to the handle.
6. Trigger the spray gun to bleed air out of the hose.
7. When paint reaches the spray tip, spray a test area to check the spray pattern.
8. Use the lowest pressure setting necessary to get a good spray pattern. If the pressure is set too high, the spray pattern will be too light. If the pressure is set too low, tailing will appear or the paint will spatter out in gobs rather than in a fine spray.



Good spray pattern



Paint tailing pattern



## If the Spray Tip Becomes Clogged

The spray gun is equipped with a reversible tip which allows you to blow out any particles of old paint or other contaminants that may obstruct the paint flow through the tip. If the spray pattern becomes distorted or stops completely while the gun is triggered on, follow these steps:

1. Release the trigger and lock the gun by turning the gun safety switch so that it is parallel to the gun body.
2. Rotate the reversible tip cylinder arrow 180° so that the point of the arrow is toward the rear of the gun.

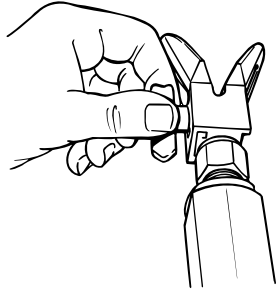

3. Unlock the trigger and squeeze it open, pointing the gun at a scrap piece of wood or cardboard. This allows pressure in the paint hose to blow out the obstruction. When the nozzle is clean, paint will come out in a straight, high pressure stream.
4. Release the trigger and re-lock it.
5. Reverse the tip so the arrow points forward again.
6. Unlock the trigger and resume spraying.

## Cleaning the Spray Gun Filter

The spray gun includes a filter to catch particles before they reach the spray tip. If this filter becomes clogged or obstructed it will reduce the flow of paint, changing the spray pattern and possibly damaging the filter.

This filter must be cleaned daily. If the material being used is old or contains hardened particles, then the filter should be cleaned approximately every 4 hours.

If the filter is not cleaned at the proper time, it will plug from the top down. When there is about 1 inch of filter that isn't plugged, the heavy flow of paint will blow pin holes in the filter. Holes in the filter will allow unwanted particles to get into the spray tip, causing the spray tip to clog.

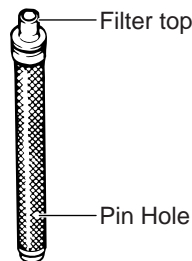

## Cleaning Filter During Painting Process

1. Turn the pressure control knob counterclockwise to the minimum setting and turn the PRIME/SPRAY knob to PRIME (☺). This will bleed off the pressure in the paint hose and filter. Trigger the gun to be sure that the pressure is gone. Refer to the PRESSURE RELIEF PROCEDURE section.
2. Lock the spray gun by turning the gun safety switch parallel to the gun body.
3. Remove the spray gun from the hose using two adjustable wrenches.
4. Unclip the bottom of the knuckle guard from the filter housing by pulling outward from the filter housing.
5. Unscrew the filter housing using an adjustable wrench on the nut at the bottom of the housing.
6. Remove the filter. Do not lose the spring and the sealing washer located in the bottom of the filter housing.
7. Clean the filter thoroughly or replace it with a new filter. To clean the filter, rinse it thoroughly in water or the type of solvent appropriate to the paint you are using. If this is not sufficient, use a natural or nylon bristle brush dipped in water or the appropriate solvent. Do not use a wire brush or any sharp instrument on the filter.
8. Insert the top of the filter into the gun body under the tip of the spray gun.

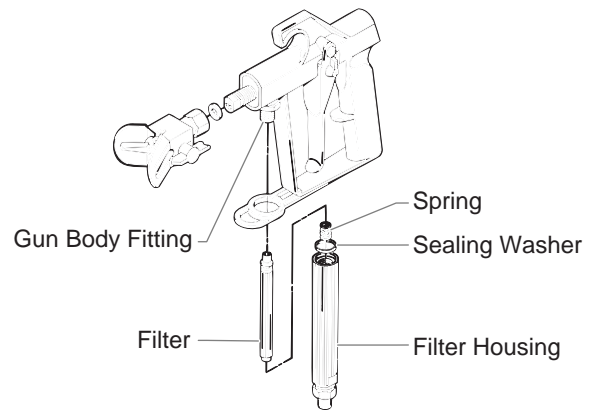

9. Replace the spring and sealing washer into the base of the filter housing.
10. Slide the filter housing over the filter and use a wrench to tighten it securely.
11. Clip the knuckle guard to the base of the filter housing.
12. Attach the hose to the gun. Use two adjustable wrenches to tighten it securely.
13. Turn the PRIME/SPRAY knob to SPRAY (☹). Increase the pressure to its previous setting and resume spraying.

## Cleaning the Suction Set Screen

The screen at the bottom of the suction set may also need cleaning. Check it every time you change paint buckets. Remove the screen by pulling it out of the retainer with a plier. Clean the screen with water or solvent and a soft-bristle brush.



# CLEAN UP

## Overnight Storage

### Shutdown

1. Lock the gun by turning the gun safety switch parallel with the gun body.
2. Turn the pressure control knob counterclockwise to the minimum setting.
3. Turn the PRIME/SPRAY knob to PRIME (☉).
4. Turn the motor switch to OFF and unplug the sprayer.
5. For latex materials only, pour 1/2 cup water slowly on the top of the paint to prevent the paint from drying. For other materials, seal the paint container with a piece of plastic while the suction tube is still in the paint.

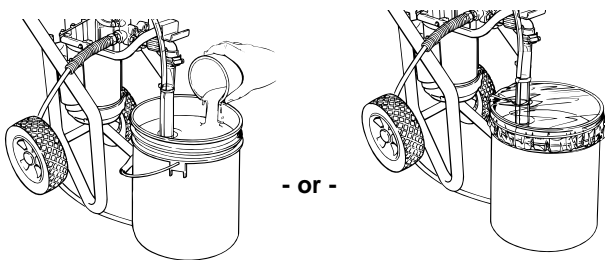

6. Wrap the spray gun assembly in a damp cloth and place it in a plastic bag. Seal the bag shut.



7. Place the sprayer in a safe place out of the sun for short-term storage.

### Startup

1. Remove the gun from the plastic bag.
2. Stir the water into the paint for latex materials. Remove the seal from the paint bucket and stir the paint for all other materials.

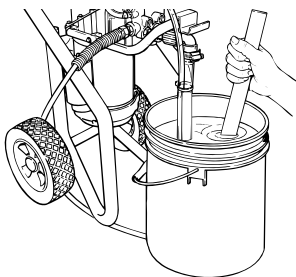

3. Check to be sure that the PRIME/SPRAY knob is set to PRIME (☉) and that the pressure is completely reduced.
4. Plug sprayer in and turn the motor switch to ON.
5. Turn the PRIME/SPRAY knob to SPRAY (☼) and gradually turn the pressure control knob clockwise to increase the pressure.
6. Test the sprayer on a practice piece and begin spraying.

## Long-term Storage

### ⚠ WARNING

Do not allow paint to build up on the motor or the motor will overheat. Do not allow flammable solvents to come in contact with the motor or they could ignite.

**NOTE:** You will need a bucket, cleaning solution, a toothbrush, a wrench and cleaning rags.

### Clearing the Suction Tube

1. Lock the gun by turning the gun safety switch parallel with the gun body.
2. Turn the pressure control knob counterclockwise to the minimum setting.
3. Turn the PRIME/SPRAY knob to PRIME (☉).
4. Turn the motor switch to OFF and unplug the sprayer.
5. Remove the suction tube from the paint and hold it above a bucket of water or solvent. Leave the return tube in the paint bucket.

**NOTE:** If spraying with latex paint, use warm soapy water for cleaning. If using oil or alkyd-based paints, use mineral spirits or paint thinner.

### ⚠ CAUTION

Do not use mineral spirits or paint thinner on latex paint, or the mixture will turn into a jelly-like substance which is difficult to remove.

6. Plug the sprayer in and turn the motor switch to ON.
7. Turn the pressure control knob to 1/2 maximum pressure. This will draw the remaining paint in the suction tube through the pump, down the return tube and into the paint bucket.
8. Turn the pressure control knob counterclockwise to the minimum pressure setting.
9. Trigger the gun to relieve pressure and lock the gun.
10. Remove the spray tip, guard and washer and place them into a container of water or appropriate solvent for the type of material with which you are painting.
11. Place the attached suction tube and return tube into a container of water or appropriate solvent for the type of material with which you are painting.
12. Increase the pressure to 1/2 the maximum pressure. Let the water or solvent circulate for 2-3 minutes to flush paint out of the pump, the suction tube and the return tube.

### Clearing the Paint Hose

1. To save paint left in the hose, release the gun safety switch and carefully trigger the gun with the spray tip removed against the inside of the paint container.

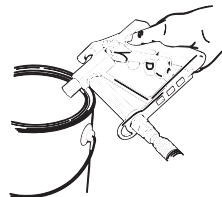

2. Turn the pressure control knob counterclockwise to the minimum pressure setting.
3. Turn the PRIME/SPRAY knob to SPRAY (☼).
4. Turn the pressure control knob slowly until paint starts to flow into the bucket. As soon as the water or solvent starts to come into the bucket, release the trigger.

- Change to clean water or solvent and continue circulating for another 5 minutes to thoroughly clean the hose, pump and spray gun.
- Turn the pressure control knob counterclockwise to its lowest setting.
- Turn the PRIME/SPRAY knob to PRIME (☺).
- Trigger the gun to remove any pressure which may still be in the hose.
- Lock the gun by turning the gun safety switch so that it is parallel to the gun body.
- Turn the motor switch to OFF.

### Clearing the Gun

- Remove the spray gun from paint hose using two adjustable wrenches.
- Remove the filter housing from the gun. Place the gun and the filter assembly into a container of water or solvent to soak.
- Cover the paint container and set it aside.
- Clean the spray tip and gun filter with a soft brush. Assemble the spray tip in the cleaning position with the arrow pointing to the back of the gun.



- Attach the paint hose to the gun and tighten using two wrenches.

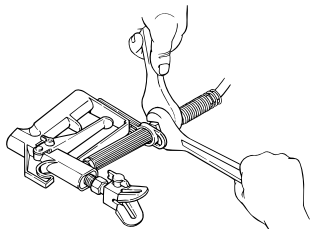

- Turn the motor switch to ON.
- Unlock gun trigger by turning the gun safety switch so that it is parallel to the gun handle.
- Turn the PRIME/SPRAY knob to SPRAY (☹) and point the gun to the side of the cleaning bucket.

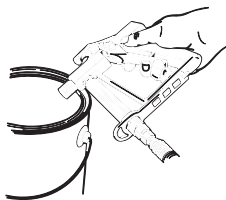

- Trigger the gun and gradually turn the pressure control knob clockwise to 1/2 pressure. Continue to trigger the gun for approximately 30 seconds.
- Turn the pressure control knob counterclockwise to its lowest setting.
- Turn the PRIME/SPRAY knob to PRIME (☺).
- Trigger the gun to remove any pressure which may still be in the hose.
- Lock the gun by turning the gun safety switch so that it is parallel to the gun body.
- Turn the motor switch to OFF.

### Preparing the Sprayer for Long-term Storage

- Remove the tip assembly and raise the suction set above the cleaning solution.
- Turn the motor to ON.
- Turn the PRIME/SPRAY knob to SPRAY (☹).
- Turn the pressure control knob clockwise to 1/2 power and allow the suction tube to run dry.
- Remove the large suction tube from the inlet valve and point the gun into the cleaning bucket.

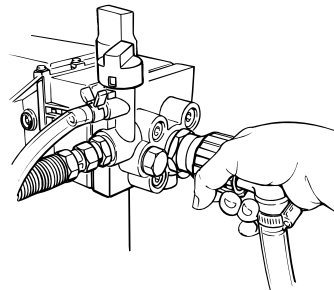

- Unlock the gun and trigger it into the cleaning bucket until the hose is pumped dry.
- Lock the gun and turn the pressure control knob counterclockwise to its lowest setting.
- Turn the PRIME/SPRAY knob to PRIME (☺).
- Lay the sprayer back on its handle so that the inlet valve is facing upward.
- Clean the threads of the inlet valve with a damp cloth.
- Fill the inlet valve with a light household oil. Slowly increase the pressure to distribute the oil through the pump.

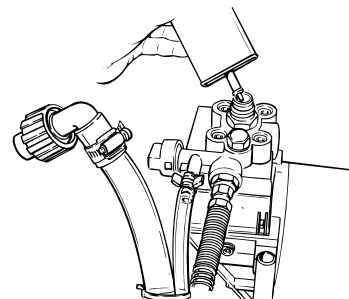

- Turn the PRIME/SPRAY knob to SPRAY (☹) to distribute the oil.
- Replace the large suction tube onto the inlet valve.

**NOTE: Proper cleaning and oiling of the pump after use are the most important steps you can take to insure proper operation after storage.**

- Turn the pressure control knob counterclockwise to its lowest setting.
- Turn the PRIME/SPRAY knob to PRIME (☺).
- Trigger the gun to remove any pressure which may still be in the hose.
- Lock the gun by turning the gun safety switch so that it is parallel to the gun body.
- Turn the motor switch to OFF.
- Remove and clean the suction set filter in clean water or the appropriate solvent. Use a soft brush. Return the suction set filter to its original position.
- Wipe the entire unit, hose and gun with a damp cloth to remove accumulated paint.

## MAINTENANCE

Follow these procedures when encountering problems indicated in the troubleshooting section.

### Removing and Cleaning the Inlet Valves

1. Be certain that the sprayer is off.
2. Remove the inlet valve assembly using a 27 millimeter socket or box end wrench.

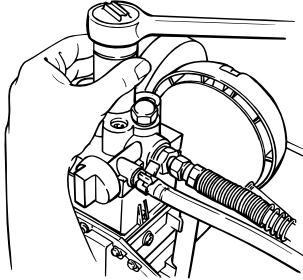

3. Test movement of the valve by pushing on it from the open end of the valve housing with a screwdriver or the eraser end of a pencil. It should move about 1/16 of an inch. If it does not move, it should be cleaned or replaced.

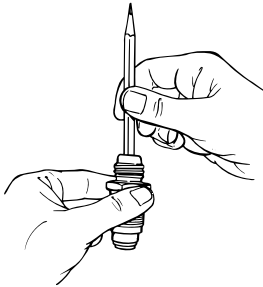

**NOTE: The inlet valve must be oiled after every job. This will reduce or eliminate priming problems the next time the sprayer is used.**

4. Thoroughly clean the valve assembly with water or the appropriate solvent. Use a small brush.
5. If you have properly cleaned the valve and water drips out of the bottom, the valve is worn and needs to be replaced. A properly seated valve filled with water and held vertically will not drip.
6. Install a new or cleaned valve in the pump block and then fill the valve with light oil or solvent.

### Removing and Cleaning the Outlet Valve

It may be necessary to remove and clean the outlet valve or to replace parts inside the valve worn out through normal use.

1. Remove the outlet cap with a wrench.

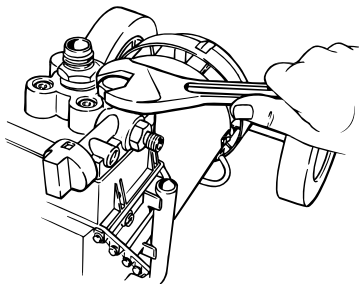

2. Leave the copper washer under the cap in place.

**NOTE: If the copper washer falls out, be sure to replace it with the same side up. The top will show the imprint of the end cap, while the bottom should be perfectly flat to match the seat in the pump casting.**

3. Remove and clean the small spring inside the valve using a wire hook or tweezers. Replace the spring if it is broken or worn.

**NOTE: This spring is manufactured to a very specific tension. Do not put in an unauthorized substitute. See the paint pump assembly parts diagram for the proper replacement part number.**

4. Remove the seat and ball assembly using a 3/8 inch allen wrench.
5. Clean all parts thoroughly. If the ball or seat show any sign of wear or damage, replace them with new parts. This carbide ball must seal tightly against its seat for the valve to function properly.
6. Cover all parts with a thin coat of light oil before reassembling.
7. Tighten the valve seat securely with the 3/8 inch allen wrench.
8. Drop in the valve ball.
9. Insert the protector and spring and replace the cap. Be sure that the copper washer is positioned properly and that the tongue on the cap fits inside the spring.
10. Tighten the cap securely with an adjustable wrench. Do not overtighten.

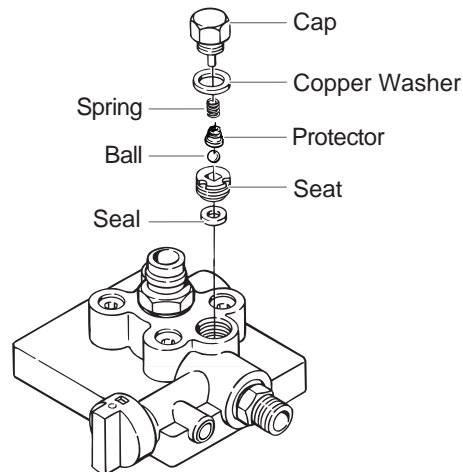

**NOTE: Wear on the ball is almost impossible to detect visually. To test for a worn outlet valve assembly, turn the pressure control knob clockwise to its highest setting and run water only through the sprayer for 10 to 15 minutes without triggering the gun.**

**If the valve is defective, the end cap will get very hot to the touch. If it is functioning properly, it will stay approximately the same temperature as the water running through it.**

### Tightening the PRIME/SPRAY Knob

Sometimes the two allen screws holding the PRIME/SPRAY knob outer cover will vibrate loose. This allows the cover to turn without changing the valve setting. If this happens, loosen the screw with a 1/16 allen wrench, turn the knob to SPRAY (P) and tighten the screw.

# TROUBLESHOOTING

## Problem

The sprayer does not start up.

## Cause

1. The sprayer is not plugged in.
2. The ON/OFF switch is set to OFF.
3. A fuse is blown in the sprayer.
4. Low or no voltage is coming from the wall plug.
5. The sprayer was turned off while still under pressure.
6. The extension cord is damaged or has too low a capacity.
7. The thermal overload on the sprayer is tripped.
8. There is a problem with the motor.

## Solution

1. Plug the sprayer in.
2. Turn the ON/OFF switch to ON.
3. Replace the blown fuse with the proper replacement.
4. Properly test the power supply voltage.
5. Turn the PRIME/SPRAY knob to PRIME.
6. Replace the extension cord.
7. Allow the motor to cool and move the sprayer to a cooler spot.
8. Take the sprayer to a Wagner Authorized Service Center.

The sprayer starts up but does not draw in paint when the PRIME/SPRAY knob is set to PRIME.

1. The unit will not prime properly or has lost prime.
2. The paint bucket is empty or the suction tube is not totally immersed in the paint.
3. The suction filter is clogged.
4. The suction tube is loose at the inlet valve.
5. The inlet valve is stuck.
6. The outlet valve is stuck.
7. The PRIME/SPRAY valve is plugged.
8. The inlet valve is worn or damaged.
9. There is a problem with the diaphragm.
10. The hydraulic oil level is low or empty.

1. Try to prime the unit again.
2. Immerse the suction tube in paint.
3. Clean the suction set filter.
4. Clean the tube connection and tighten it securely.
5. Clean the inlet valve.
6. Clean the outlet valve and replace any worn parts.
7. Take the sprayer to a Wagner Authorized Service Center.
8. Replace the inlet valve.
9. Take the sprayer to a Wagner Authorized Service Center.
10. Take the sprayer to a Wagner Authorized Service Center.

The sprayer draws up paint but the pressure drops when the gun is triggered.

1. The spray tip is worn.
2. The suction set filter is clogged.
3. The gun or spray tip filter is plugged.
4. The paint is too heavy or coarse.
5. The outlet valve assembly is dirty or worn.
6. The inlet valve assembly is damaged or worn.

1. Replace the spray tip with a new tip.
2. Clean the suction set filter.
3. Clean or replace the proper filter. Always keep extra filters on hand.
4. Thin or strain the paint.
5. Clean or replace the outlet valve assembly.
6. Replace the inlet valve.

The spray gun will not shut off.

1. The inlet or outlet valve ball or ball seat is worn.
2. Foreign matter or paint has built up between the ball and the seat.

1. Take the sprayer to a Wagner Authorized Service Center.
2. Take the sprayer to a Wagner Authorized Service Center.

The spray gun leaks.

1. Internal parts of the gun are worn or dirty.

1. Take the sprayer to a Wagner Authorized Service Center.

The tip assembly leaks.

1. The tip was assembled incorrectly.
2. A seal is worn.

1. Check the tip assembly and assemble properly.
2. Replace the seal.

The spray gun will not spray.

1. The spray tip, the gun filter or the tip filter is plugged.
2. The spray tip is in the CLEAN position.

1. Clean the spray tip, gun filter or tip filter.
2. Put the tip in the SPRAY position.

The paint pattern is tailing.

1. The pressure is set too low.
2. The gun, the tip, or the suction filter is plugged.
3. The suction tube is loose at the inlet valve.
4. The tip is worn.
5. The paint is too thick.

1. Increase the pressure.
2. Clean the filters.
3. Tighten the suction tube fitting.
4. Replace the spray tip.
5. Thin the paint.

The thermal overload tripped and shut off the sprayer.

1. The motor overheated.
2. The extension cord is too long or is too small a gauge.
3. Paint has built up on the motor.
4. The motor was started while the sprayer was under pressure.
5. The sprayer was sitting in the hot sun.

1. Allow to cool for 30 minutes.
2. Allow to cool for 30 minutes and replace the extension cord with a shorter extension or a thicker gauge cord.
3. Clean the paint from the motor.
4. Restart the sprayer in the PRIME mode.
5. Move the sprayer out of the sun.

**NOTE: When the PRIME/SPRAY valve is on SPRAY and there is flow through the return tube, remove the PRIME/SPRAY valve and clean or replace it.**

**NOTE: The electric motor should always be kept clean and dry. Paint acts as an insulator. Too much paint on the motor will cause the motor to overheat.**

# PARTS LISTING / SCHÉMAS DES PIÈCES / DIAGRAMAS DE LAS PIEZAS

## Final Assembly / Montage Final / Ensamble Fina

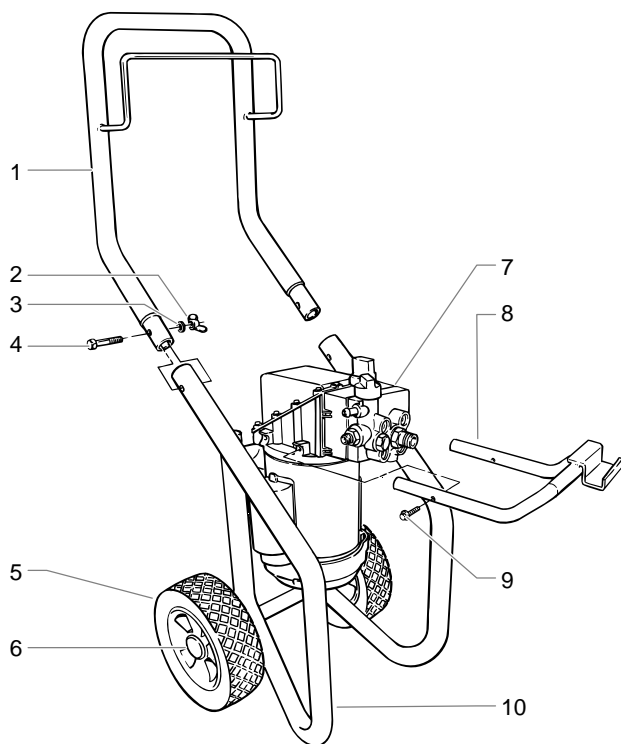

### FRANÇAIS • MONTAGE FINAL

ARTICLE	No DE PIÈCE	DESCRIPTION	QUANTITÉ
1	0270535	Guidon de chariot . . . . .	1
2	9810111	Écrou à oreilles . . . . .	1
3	9821503	Rondelle de blocage . . . . .	2
4	9800108	Boulon . . . . .	2
5	0270394	Roue . . . . .	2
6	9890104	Enjoliveur . . . . .	2
7	-----	Ensemble de pompe à peinture (voir la liste séparée) . . . . .	1
8	0270536	Support de seau . . . . .	1
9	9802519	Boulon . . . . .	2
10	0270534	Ensemble de chariot . . . . .	1

### ENGLISH • FINAL ASSEMBLY

ITEM	PART NO.	DESCRIPTION	QTY.
1	0270535	Cart handle . . . . .	1
2	9810111	Thumb nut . . . . .	1
3	9821503	Lock washer . . . . .	2
4	9800108	Bolt . . . . .	2
5	0270394	Wheel . . . . .	2
6	9890104	Hub cap . . . . .	2
7	-----	Paint pump assembly (see separate listing) . . . . .	1
8	0270536	Pail bracket . . . . .	1
9	9802519	Bolt . . . . .	2
10	0270534	Cart assembly . . . . .	1

### ESPAÑOL • ENSAMBLE FINA

ARTÍCULO	# PIEZA	DESCRIPCIÓN	CANTIDAD
1	0270535	Manubrio del carro . . . . .	1
2	9810111	Tuerca de mariposa . . . . .	1
3	9821503	Rondana de seguridad . . . . .	2
4	9800108	Perno . . . . .	2
5	0270394	Rueda . . . . .	2
6	9890104	Tapacubos . . . . .	2
7	-----	Conjunto de la bomba de pintura (vea la lista separada) . . . . .	1
8	0270536	Soporte de la cubeta . . . . .	1
9	9802519	Perno . . . . .	2
10	0270534	Conjunto del carro . . . . .	1

# Paint Pump Assembly / Ensemble de Pompe à Peinture / Conjunto de la Bomba de Pintura

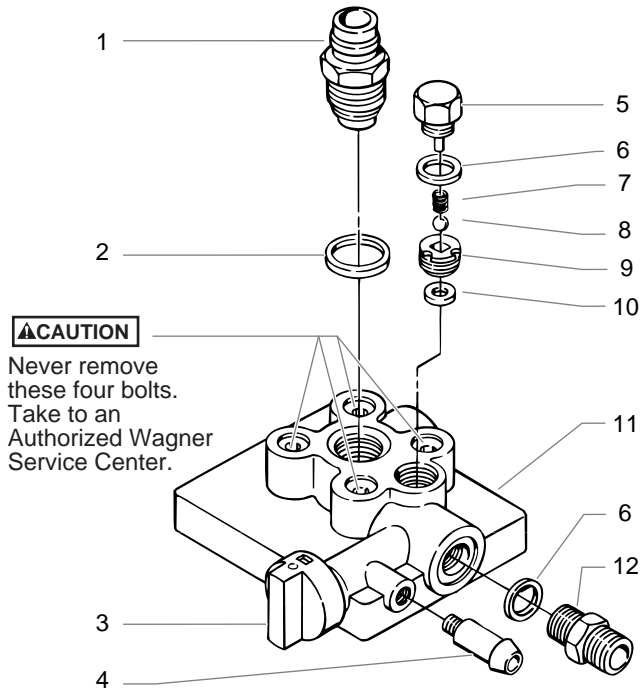

## FRANÇAIS • ENSEMBLE DE POMPE À PEINTURE

ARTICLE	No DE PIÈCE	DESCRIPTION	QUANTITÉ
1	0270526	Ensemble de soupape d'admission (comprend l'article 2) . . . . .	1
2	0089482	Rondelle d'étanchéité, en nylon . . . . .	1
3	0288748	Bouton seulement . . . . .	1
4	0088715	Raccord du tube de retour . . . . .	1
5	0089564	Capuchon de l'ensemble de sortie . . . . .	1
6	9970103	Rondelle d'étanchéité en cuivre . . . . .	2
7	0047485	Ressort de sortie . . . . .	1
8	0093635	Bille de carbure de 6 mm . . . . .	1
9	0090348	Ensemble de bille et de siège de la soupape de sortie . . . . .	1
10	0089494	Joint d'étanchéité de sortie . . . . .	1
11	0270200	Pompe à peinture avec soupape . . . . .	1
12	0288379	Raccord de sortie . . . . .	1
	0288172	Nécessaire de réparation . . . . .	1
		Remplace le support et le siège	

## ENGLISH • PAINT PUMP ASSEMBLY

ITEM	PART NO.	DESCRIPTION	QTY.
1	0270526	Valve, Inlet Assembly . . . . . (includes item 2) . . . . .	1
2	0089482	Washer, Sealing, Nylon . . . . .	1
3	0288748	Knob Only . . . . .	1
4	0088715	Fitting, Return Tube . . . . .	1
5	0089564	Cap, Outlet Assembly . . . . .	1
6	9970103	Washer, Sealing, Copper . . . . .	2
7	0047485	Spring, Outlet . . . . .	1
8	0093635	Ball, 6mm, Carbide . . . . .	1
9	0090348	Seat, Ball, Outlet Assembly . . . . .	1
10	0089494	Seal, Outlet . . . . .	1
11	0270200	Paint Pump with Valve . . . . .	1
12	0288379	Fitting, Outlet . . . . .	1
	0288172	Repair Kit . . . . .	1
		Replaces both Holder & Seat	

## ESPAÑOL • CONJUNTO DE LA BOMBA DE PINTURA

ARTÍCULO	# PIEZA	DESCRIPCIÓN	CANTIDAD
1	0270526	Válvula, Conjunto de la entrada . . . . . (incluye el artículo 2) . . . . .	1
2	0089482	Rondana, Selladura, Nailon . . . . .	1
3	0288748	Perilla solamente . . . . .	1
4	0088715	Adaptador, Tubo de retorno . . . . .	1
5	0089564	Anillo, Conjunto de la salida . . . . .	1
6	9970103	Rondana, Selladura, Cobre . . . . .	2
7	0047485	Resorte, Salida . . . . .	1
8	0093635	Bola, 6 mm, Carburo . . . . .	1
9	0090348	Asiento, Bola, Conjunto de la salida . . . . .	1
10	0089494	Sello, Salida . . . . .	1
11	0270200	Bomba de pintura con válvula . . . . .	1
12	0288379	Adaptador, Salida . . . . .	1
	0288172	Juego para reparar . . . . .	1
		Para reemplazar el sujetador y el asiento	

# 0270174 Suction Set Assembly / Ensemble d'aspiration / Conjunto del Equipo de Succión

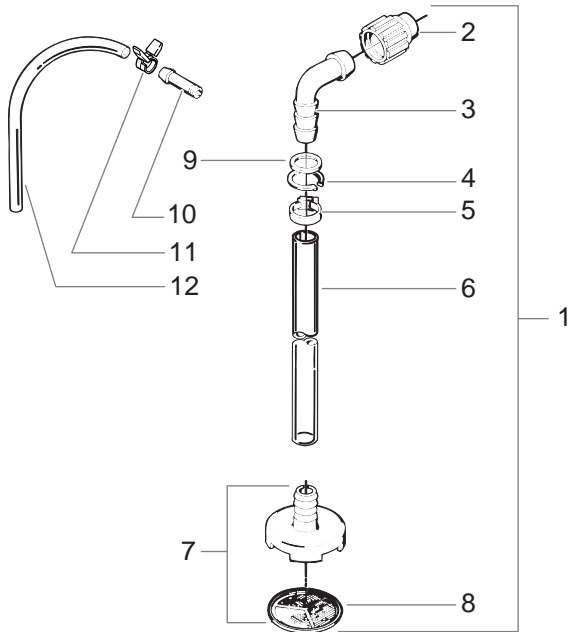

## FRANÇAIS • ENSEMBLE D'ASPIRATION

ARTICLE	No DE PIÈCE	DESCRIPTION	QUANTITÉ
1	0270133	Tube d'aspiration, au complet . . . . .	1
(comprend les articles 2 à 9)			
2	0090622	Écrou d'aspiration . . . . .	1
3	0281314	Raccord coudé 3/4 x 1 po. . . . .	1
4	0088931	Collier de retenue . . . . .	1
5	0089882	Bride . . . . .	2
6	0270360	Tuyau d'aspiration . . . . .	1
7	0270162	Boîtier de filtre et filtre. . . . .	1
8	0270369	Filtre . . . . .	1
9	0090621	Rondelle . . . . .	1
10	0088715	Raccord de tuyau de retour. . . . .	1
11	0327226	Bride . . . . .	1
12	0270363	Tube de retour . . . . .	1

## ENGLISH • SUCTION SET ASSEMBLY

ITEM	PART NO.	DESCRIPTION	QTY.
1	0270133	Suction Tube Complete . . . . .	1
(Includes Items 2 thru 9)			
2	0090622	Nut, Suction . . . . .	1
3	0281314	Elbow, Adapter, 3/4" x 1" . . . . .	1
4	0088931	Ring, Snap . . . . .	1
5	0089882	Clamp. . . . .	2
6	0270360	Hose, Suction . . . . .	1
7	0270162	Filter Housing & Filter . . . . .	1
8	0270369	Filter. . . . .	1
9	0090621	Washer . . . . .	1
10	0088715	Fitting, Return Hose . . . . .	1
11	0327226	Clamp. . . . .	1
12	0270363	Tubing, Return . . . . .	1

## ESPAÑOL • CONJUNTO DEL EQUIPO DE SUCCIÓN

ARTÍCULO	# PIEZA	DESCRIPCIÓN	CANTIDAD
1	0270133	Tubo de succión completo. . . . .	1
(incluye los artículos del 2 al 9)			
2	0090622	Tuerca, Succión . . . . .	1
3	0281314	Codo, Conexión, 3/4" x 1" . . . . .	1
4	0088931	Argolla, de Retención . . . . .	1
5	0089882	Abrazadera. . . . .	2
6	0270360	Manguera, Succión. . . . .	1
7	0270162	Caja del filtro y Filtro. . . . .	1
8	0270369	Filtro. . . . .	1
9	0090621	Rondana. . . . .	1
10	0088715	Adaptador, Manguera de retorno. . . . .	1
11	0327226	Abrazadera. . . . .	1
12	0270363	Tubo, Retorno. . . . .	1



# G-06 Spray Gun / Pistolet G-06 / G-06 Pistola de Atomización

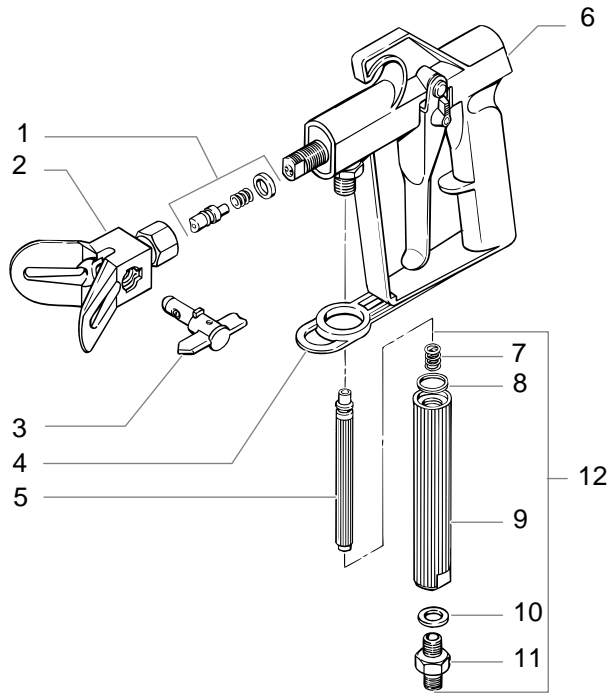

## ENGLISH • G-06 SPRAY GUN

**NOTE:** This gun is used on the CW models. If you own an EX model, refer to the manual that comes with your G-09 spray gun for part numbers.

ITEM	PART NO.	DESCRIPTION
1	0154693	Seal kit
2	0154680	Tip, body
3	0154782	Tip, .011 (oil based materials)
	0154783	Tip, .013 (oil based , latex paints and stains)
	0154784	Tip, .015 (extra thick materials)
4	0293303	Guide, hose
5	0089959	Filter
6	0293004	G-06 gun assembly (includes items 4 through 12)
7	0043590	Spring
8	0089694	Seal, nylon
9	0089692	Housing filter
10	0043260	Washer
11	0089693	Fitting
12	0089731	Filter assembly (includes items 5, 7-11)

**NOTE:** Part numbers may change without notice due to improvements and modifications.

## FRANÇAIS • PISTOLET G-06

**NOTA:** Ce pistolet est utilisé pour les modèles CW. Si vous avez un modèle EX, consultez le manuel qui accompagne votre pistolet G-09 pour obtenir les numéros de pièces.

ARTICLE	No DE PIÈCE	DESCRIPTION
1	0154693	Ensemble de joint d'étanchéité
2	0154680	Corps de tête
3	0154782	Tête, 0,011 (pour peintures à huile)
	0154783	Tête, 0,013 (pour peintures à huile, peintures au latex et teintures)
	0154784	Tête, 0,015 (pour matériaux particulièrement épais)
4	0293303	Guide de tuyau
5	0089959	Filtre
6	0293004	Ensemble de pistolet G-06 (comprend les articles 4 à 12)
7	0043590	Ressort
8	0089694	Joint d'étanchéité en nylon
9	0089692	Filtre de boîtier
10	0043260	Rondelle
11	0089693	Raccord
12	0089731	Ensemble de filtre (comprend les articles 5, 7-11)

**NOTA:** Les numéros de pièces peuvent être changés sans avis, en raison d'améliorations ou de modifications.

## ESPAÑOL • G-06 PISTOLA DE ATOMIZACIÓN

**NOTA:** Esta pistola se usa con los modelos CW. Si usted tiene un modelo EX, consulte el manual que viene con su pistola de atomización G-09 para ver los números de las piezas.

ARTÍCULO	# PIEZA	DESCRIPCIÓN
1	0154693	Juego para sellar
2	0154680	Boquilla, mango
3	0154782	TBoquilla, .011 (materiales a base de aceite)
	0154783	Boquilla, .013 (pinturas a base de aceite, de látex y tintes)
	0154784	Boquilla, .015 (materiales demasiado espesos)
4	0293303	Guía, manguera
5	0089959	Filtro
6	0293004	G-06 conjunto de la pistola (incluye los artículos del 4 al 12)
7	0043590	Resorte
8	0089694	Sello, Nailon
9	0089692	Filtro de la caja
10	0043260	Rondana
11	0089693	Adaptador
12	0089731	Conjunto del filtro (incluye los artículos 5, 7-11)

**NOTA:** Los números de las piezas pueden cambiar sin aviso debido a mejoras o modificaciones.





LIMITED WARRANTY  
AIRLESS PAINT SPRAY EQUIPMENT

This product, manufactured by Wagner Spray Tech Corporation (Wagner), is warranted to the original retail purchaser against defects in material and workmanship for 30 days from date of purchase for professional/rental use if operated in accordance with Wagner's printed recommendations and instructions. This warranty applies for one year from date of purchase for home use.

This warranty does not cover damage resulting from improper use, accidents, user's negligence or normal wear. This warranty does not cover any defects or damages caused by service or repair performed by anyone other than a Wagner Authorized Service Center. This warranty does not apply to accessories.

ANY IMPLIED WARRANTY OF MERCHANTABILITY OR FITNESS FOR A PARTICULAR PURPOSE IS LIMITED TO 30 DAYS FOR PROFESSIONAL/RENTAL USE AND ONE YEAR FOR HOME USE FROM DATE OF PURCHASE.

WAGNER SHALL NOT IN ANY EVENT BE LIABLE FOR ANY INCIDENTAL OR CONSEQUENTIAL DAMAGES OF ANY KIND, WHETHER FROM BREACH OF THIS WARRANTY OR ANY OTHER REASON.

If any product is defective in material and/or workmanship during the applicable warranty period, return it with proof of purchase, transportation prepaid to any Wagner Authorized Service Center. (Service Center listing is enclosed with this product.) Wagner's Authorized Service Center will either repair or replace the product (at Wagner's option) and return it to you, postage prepaid.

**SOME STATES DO NOT ALLOW LIMITATIONS ON HOW LONG AN IMPLIED WARRANTY LASTS OR THE EXCLUSION OF INCIDENTAL OR CONSEQUENTIAL DAMAGES, SO THE ABOVE LIMITATION AND EXCLUSION MAY NOT APPLY TO YOU.**

**THIS WARRANTY GIVES YOU SPECIFIC LEGAL RIGHTS, AND YOU MAY ALSO HAVE OTHER RIGHTS WHICH VARY FROM STATE TO STATE.**

GARANTIE LIMITÉE  
MATÉRIEL DE PULVÉRISATION DE PEINTURE SANS AIR

Ce produit, fabriqué par la société Wagner Spray Tech (« Wagner »), est garanti au premier acheteur au détail contre toute défectuosité de matériau ou d'exécution, pour une période de 30 jours à compter de la date d'achat pour des fins professionnelles ou pour la location, pourvu que l'on se serve du produit en suivant les recommandations et consignes écrites de Wagner. Dans le cas de l'usage à domicile, la durée de la présente garantie est d'un an à compter de la date d'achat.

La présente garantie ne s'applique pas aux dégâts entraînés par une utilisation incorrecte, par la négligence de l'utilisateur ou par l'usure normale. La présente garantie ne s'applique pas non plus aux défectuosités ou dommages résultant de l'entretien ou de la réparation que fait une personne quelconque qui ne soit pas membre d'un centre d'entretien autorisé pour les produits Wagner. La présente garantie ne s'applique pas aux accessoires.

TOUTE GARANTIE IMPLICITE DE QUALITÉ MARCHANDE OU D'ADAPTATION À UN USAGE PARTICULIER EST LIMITÉE À UNE PÉRIODE DE 30 JOURS POUR UNE UTILISATION PROFESSIONNELLE OU DE LOCATION ET D'UNE ANNÉE POUR L'UTILISATION DOMESTIQUE, À COMPTER DE LA DATE D'ACHAT.

WAGNER NE SERA EN AUCUN CAS RESPONSABLE DE DOMMAGES ACCESSOIRES OU INDIRECTS DE QUELQUE NATURE QUE CE SOIT, À LA SUITE D'UNE NONOBSERVATION DE LA PRÉSENTE GARANTIE OU POUR UNE AUTRE RAISON QUELCONQUE.

Si un produit est défectueux en ce qui concerne les matériaux ou l'exécution pendant la période de garantie applicable, vous devez le retourner, avec une preuve d'achat et frais de port payés, à n'importe quel centre d'entretien autorisé pour les produits Wagner. (Une liste de ces centres d'entretien est jointe à ce produit.) Le centre d'entretien autorisé pour les produits Wagner réparera ou remplacera le produit (à la discrétion de Wagner) et vous le retournera par la poste, avec frais de port payés.

**CERTAINES PROVINCES INTERDISSENT LES RESTRICTIONS SUR LA DURÉE D'UNE GARANTIE IMPLICITE OU L'EXCLUSION DES DOMMAGES ACCESSOIRES OU INDIRECTS. IL SE PEUT DONC QUE LA RESTRICTION ET L'EXCLUSION ÉNONCÉES CI-DESSUS NE S'APPLIQUENT PAS À VOUS. LE PRÉSENTE GARANTIE VOUS ACCORDE DES DROITS JURIDIQUES SPÉCIFIQUES, ET VOUS AVEZ PEUT-ÊTRE D'AUTRES DROITS, QUI PEUVENT VARIER D'UNE PROVINCE À L'AUTRE.**

GARANTÍA LIMITADA  
EQUIPO DE ATOMIZACIÓN DE PINTURA SIN AIRE

Este producto, fabricado por Wagner Spray Tech Corporation (Wagner), se le garantiza al comprador al menudeo original contra defectos de material y mano de obra, durante 30 días a partir de la fecha de la compra para uso profesional/renta, si se opera de acuerdo a las recomendaciones e instrucciones impresas de Wagner. Esta garantía es válida durante un año a partir de la fecha de la compra para uso doméstico.

Esta garantía no cubre los daños que sean resultado de un uso inapropiado, accidentes, negligencia del usuario o un desgaste normal. Esta garantía no cubre ningún defecto o daño que haya sido causado por los servicios o reparaciones llevadas a cabo por alguien que no sea un técnico del Centro de Servicio Autorizado de Wagner. Esta garantía no es válida para ningún accesorio.

CUALQUIER GARANTÍA IMPLÍCITA DE COMERCIABILIDAD E IDONEIDAD PARA UN PROPÓSITO PARTICULAR QUEDA LIMITADA A 30 DÍAS DE USO PROFESIONAL/RENTA O UN AÑO DE USO DOMÉSTICO A PARTIR DE LA FECHA DE COMPRA.

WAGNER NO SERÁ EN NINGÚN CASO RESPONSABLE DE NINGÚN DAÑO INCIDENTAL O DE CONSECUENCIA DE NINGUNA CLASE, QUE RESULTE DE VIOLAR ESTA GARANTÍA O POR CUALQUIER OTRA RAZÓN.

Si algún producto llegara a tener defectos de material y/o mano de obra durante el período de validez de la garantía, devuélvalo junto con el comprobante de compra y flete previamente pagado, a cualquier Centro de Servicio Autorizado de Wagner. (La lista de Centros de Servicio viene adjunta con este producto.) El Centro de Servicio Autorizado de Wagner reparará o reemplazará el producto (según la opción de Wagner) y se lo devolverá, con porte previamente pagado.

**ALGUNOS ESTADOS NO PERMITEN LIMITACIONES EN CUANTO A LA DURACIÓN DE UNA GARANTÍA IMPLÍCITA O LA EXCLUSIÓN DE DAÑOS INCIDENTALES O DE CONSECUENCIA, DE MANERA QUE LA LIMITACIÓN Y EXCLUSIÓN ANTERIORES PODRÍAN NO SER VÁLIDAS PARA USTED. ESTA GARANTÍA LE CONCEDE DERECHOS LEGALES ESPECÍFICOS, PERO USTED PODRÍA TENER DERECHO A OTROS, LOS CUALES VARÍAN DE UN ESTADO A OTRO.**



Wagner Spray Tech Corporation  
1770 Fernbrook Lane  
Minneapolis, Minnesota 55447  
Telephone (612) 553-7000

Copyright © 1996 Wagner Spray Tech Corporation.  
All rights reserved, including right of reproduction  
in whole or in part, in any form. Printed in U.S.A.