

# NETZERO FIRE



[NETZEROFIRE.COM](http://NETZEROFIRE.COM)

# INTRODUCING THE FUTURE OF FIRE

At NetZero Fire, we put our energy into creating beautiful, customizable fire features that enhance your prized spaces and support your sustainability goals.

Our luxurious designs, advanced technologies and flexible installations make our fire features supremely thoughtful alternatives to traditional fireplaces. Each creation will become an extension of your unique aesthetic, providing a remarkable focal point while adding little or nothing to your carbon footprint.

For the elemental beauty of an open flame with the modern convenience, control and efficiency our earth deserves, there's no match to NetZero Fire.



ULTIMATE LED



PREMIUM LED FLOOR



PREMIUM LED GLASS BARRIER



CLASSIC FLOOR

# BEV TECHNOLOGY®

The FLA automatic burner features an **advanced microprocessor** that monitors and controls the device, ensuring its proper and safe functioning. The fireplace construction significantly **reduces the burning surface** and provides more oxygen to the fire, resulting in a **very clean and efficient combustion process** without any unwanted byproducts, such as smoke, unpleasant smell, soot or ash.

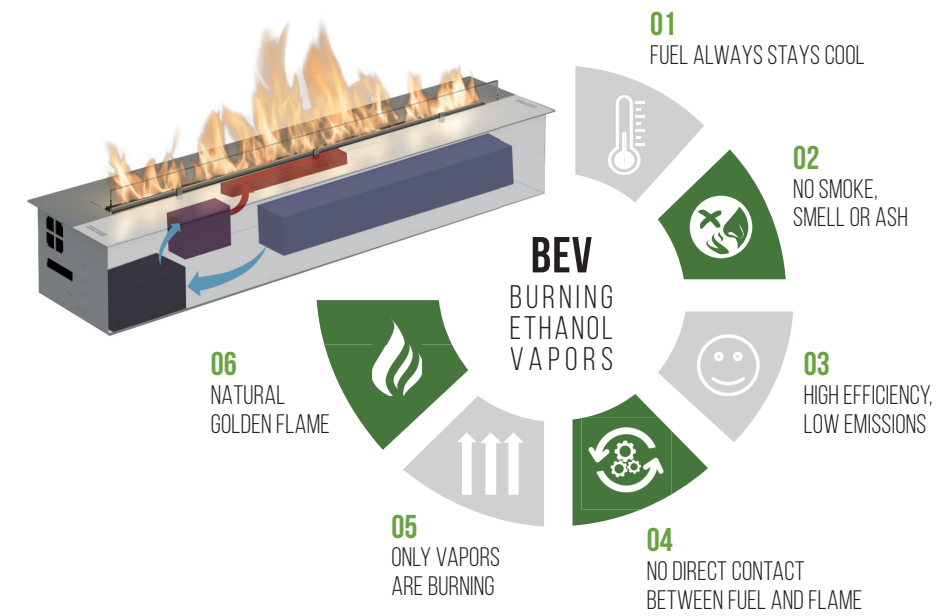

# BEV=SAFETY

The patented and certified **Burning Ethanol Vapors (BEV)** are contained in a **closed and cooled tank**. Once the device is turned on, the fuel is **automatically pumped** to the equalizing vessel and enters the evaporation accelerator where the liquid ethanol **turns into vapor**. You never have any contact with the fuel in NetZero fireplaces. The entire burning process is controlled by the microprocessor and multiple safety sensors.

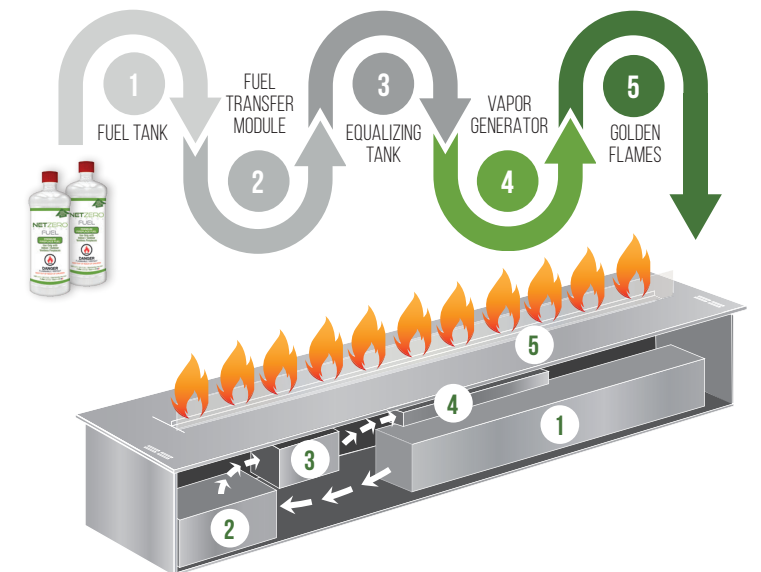

# NETZERO FUEL

To maximize the efficiency and longevity of your NetZero fire feature, NetZero Fire recommends using only NetZero Fuel.

Learn more and order at [NETZEROFUEL.COM](https://www.netzerofuel.com)



# IMAGINE THE POSSIBILITIES

NetZero biofuel fire features are among the most versatile clean-burning fire features in existence. No venting is needed, so your fire feature can be placed nearly anywhere.

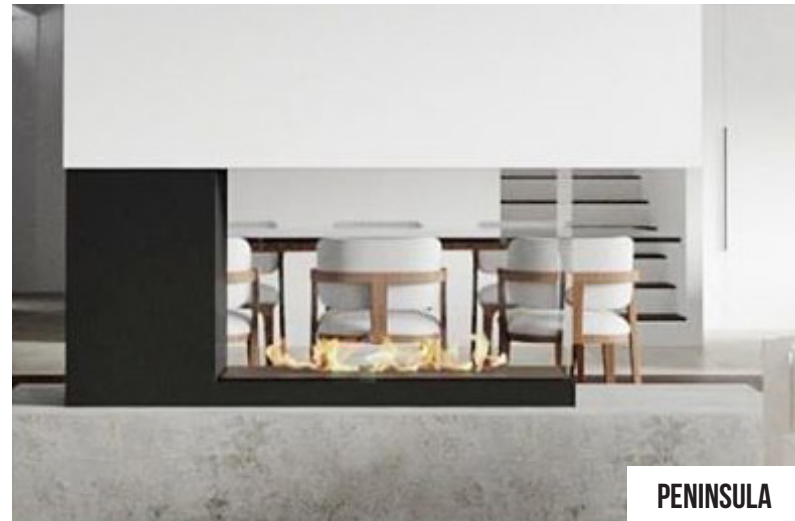

PENINSULA



ISLAND



THREE-SIDED



AGAINST-WALL



LEFT-CORNER/  
RIGHT-CORNER



SINGLE-SIDED



SEE-THROUGH

# THE NETZERO BIOFUEL DIFFERENCE

Add design features that enhance and customize the NetZero fire experience. Create a fire feature to suit your space with dazzling LED lighting and decorative media for a look that's truly yours.

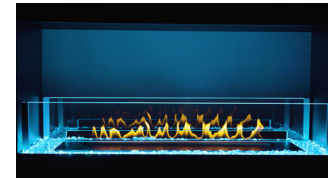

ULTIMATE LED

Go for maximum visual impact by adding both an LED-lit glass barrier and LED media tray to your fire feature.

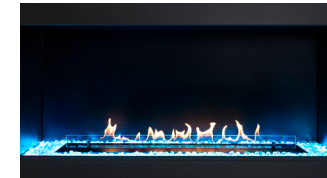

PREMIUM LED FLOOR

Upgrade your fire feature with an array of beautiful LED lights that illuminate the media and complement your flames.

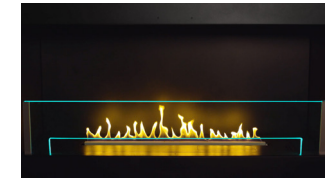

PREMIUM LED GLASS BARRIER

Surround your burner with a transparent glass shield enhanced with full-spectrum LED lighting.



CLASSIC FLOOR

Create a look that's truly yours by adding decorative media such as glass, rocks and marbles.

# NETZERO BIOFUEL BURNERS

Seven sizes to choose from. Multiple burners can be connected for an endless line of fire, or request a non-standard length to fit a specific interior or existing opening.



NZ36B PRIMEFIRE BURNER

Minimum Fireplace Opening: 35" L x 12" W x 8" H  
Max Burn Time: 6.5 hrs/tank  
Tank Capacity: 0.5 gal

NZ40B FLA BURNER

Minimum Fireplace Opening: 40" L x 16" W x 14" H  
Max Burn Time: 29 hrs/tank  
Tank Capacity: 3.5 gal

NZ48B FLA BURNER

Minimum Fireplace Opening: 48" L x 16" W x 14" H  
Max Burn Time: 30 hrs/tank  
Tank Capacity: 4.5 gal

NZ60B FLA BURNER

Minimum Fireplace Opening: 60" L x 16" W x 14" H  
Max Burn Time: 27 hrs/tank  
Tank Capacity: 5.5 gal

NZ72B FLA BURNER

Minimum Fireplace Opening: 72" L x 16" W x 14" H  
Max Burn Time: 28 hrs/tank  
Tank Capacity: 7.1 gal

NZ90B FLA BURNER

Minimum Fireplace Opening: 90" L x 16" W x 14" H  
Max Burn Time: 30 hrs/tank  
Tank Capacity: 9.6 gal

NZ108B FLA BURNER

Minimum Fireplace Opening: 108" L x 16" W x 14" H  
Max Burn Time: 31.5 hrs/tank  
Tank Capacity: 12.1 gal

# SURROUNDED BY BEAUTY

Easy, zero-clearance installations and multiple viewing configurations make our fireboxes a convenient and flexible way to maximize the impact of your fire feature. Or drop the burner into a completely custom site-built enclosure built to your exacting specifications.



ISLAND

AGAINST-WALL

SINGLE-SIDED

LEFT-CORNER

RIGHT-CORNER

THREE-SIDED

SEE-THROUGH

PENINSULA

# INSPIRED DESIGNS FOR PROFESSIONALS

NetZero fire features give professional builders, designers and architects the freedom and flexibility to insert real flames into nearly any home or commercial setting imaginable. A choice of burner sizes, eight firebox configurations, modular scalability and no need for external venting mean a NetZero fire feature can be integrated flawlessly in rooms of any size, either as a built-to-suit feature or retrofit addition.



# SIZED FOR ANY SPACE

The construction of our burners allows for joining several modules together to create an endless line of fire. Non-standard lengths are available to fit unique placements in new builds or to create a stunning focal point out of virtually any existing interior opening.

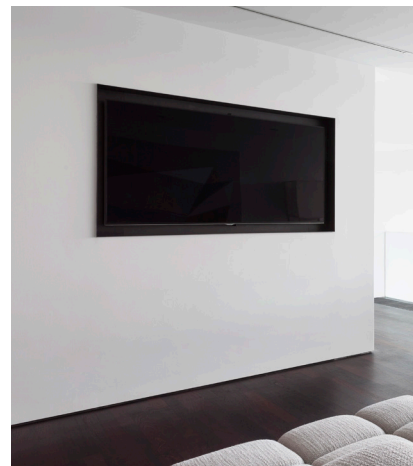

# ENDLESS CUSTOMIZATION

Open the door to unlimited design possibilities by integrating a NetZero fire feature into your new construction project. Our **burners** only require an electrical connection and minimal clearance, so beautiful, natural flames can be placed directly into floors or tabletops, walls, room dividers or anywhere else you or your client can imagine.

CLEARANCES & CAVITY MEASUREMENTS (in.) SITE-BUILT ENCLOSURES								
	A	B	C	D	E	F	G	H
NZ36B	9"	16"	26 3/4"	36"	2"	8"	16"	36"
NZ40B	10 1/4"	16"	30 1/2"	40"	2"	14"	20"	40"
NZ48B	10 1/4"	16"	38 3/8"	48"	2"	14"	20"	40"
NZ60B	10 1/4"	16"	46 1/4"	60"	2"	14"	20"	40"
NZ72B	10 1/4"	16"	58"	72"	2"	14"	20"	40"
NZ90B	10 1/4"	16"	77 3/4"	90"	2"	14"	20"	40"
NZ108B	10 1/4"	16"	97 1/4"	108"	2"	14"	20"	40"

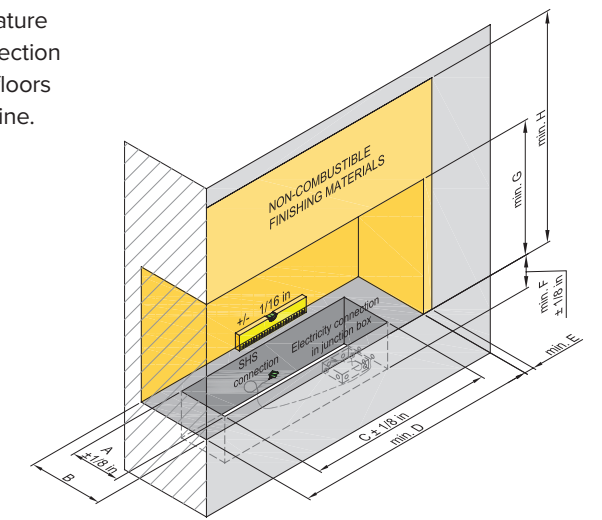

The **media tray** provides a beautiful finish to the burner, allowing you to incorporate decorative media. Tray dimensions are similar to cavity measurements for seamless and easy installation.

MEDIA TRAY DIMENSIONS (in.)				
	A	B	C	D
NZ36B	8 15/16"	15 7/8"	26 3/4"	35 7/8"
NZ40B	10 5/16"	15 7/8"	30 5/16"	39 7/8"
NZ48B	10 5/16"	15 7/8"	38 3/16"	47 7/8"
NZ60B	10 5/16"	15 7/8"	46"	59 7/8"
NZ72B	10 5/16"	15 7/8"	57 7/8"	71 7/8"
NZ90B	10 5/16"	15 7/8"	77 7/8"	89 7/8"
NZ108B	10 5/16"	15 7/8"	97 1/2"	107 7/8"

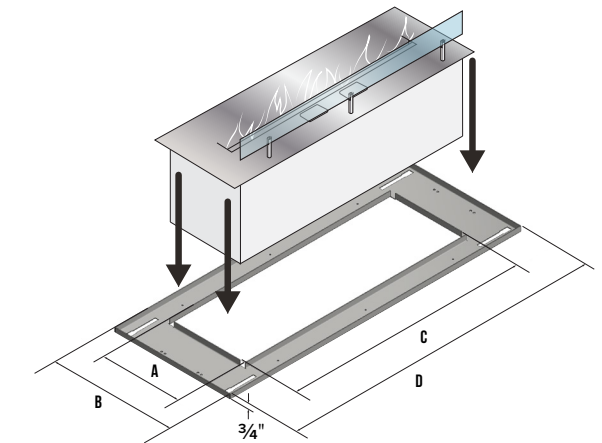

# FLAWLESS INTEGRATION

Easy, zero-clearance installations and multiple viewing configurations make our **fireboxes** a convenient and flexible way to maximize the safety and aesthetic impact of your fire feature.

FIREBOX FRAMING DIMENSIONS (in.) – Single-Sided							
	W	W1 min	W2 max	D	D1 max	H	H1 min
NZ36B	40"	28"	6"	17 1/2"	2"	27 1/2"	14"
NZ40B	44"	28"	6"	17 1/2"	2"	27 1/2"	14"
NZ48B	52"	40"	6"	17 1/2"	2"	27 1/2"	14"
NZ60B	64"	52"	6"	17 1/2"	2"	27 1/2"	14"
NZ72B	76"	64"	6"	17 1/2"	2"	27 1/2"	14"
NZ90B	94"	82"	6"	17 1/2"	2"	27 1/2"	14"
NZ108B	112"	100"	6"	17 1/2"	2"	27 1/2"	14"

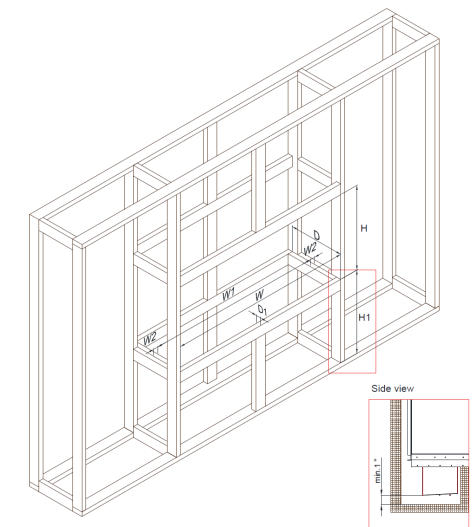

FOR INSTALLATION SPECIFICATIONS AND REQUIRED CLEARANCES TO COMBUSTIBLE MATERIALS, REFER TO THE INSTALLATION MANUAL.

# NETZERO FIRE

*NetZero Fire's mission is to create high-quality fire features that produce little or no impact on the environment. By leading our market with exceptional designs and forward-thinking, energy-neutral technologies, we allow our customers to better manage their carbon footprints while creating beautiful, atmospheric spaces.*



## CONTACT US

[SALES@NETZEROFIRE.COM](mailto:SALES@NETZEROFIRE.COM)

NETZERO FIREPLACES

520 E AVENUE NW

CEDAR RAPIDS, IA 52405

MANUFACTURED TO UL STANDARDS | O-TL CERTIFIED



NETZERO IS A DISTRIBUTOR OF THESE PRODUCTS, WHICH ARE DESIGNED AND MANUFACTURED BY PLANIKA SP. S. R. O.  
THERE ARE NO WARRANTIES WHICH EXTEND BEYOND THE DESCRIPTION ON THE FACE HEREOF AND SUPPLIED  
MANUALS. IMPLIED WARRANTIES OF MERCHANTABILITY, IMPLIED WARRANTIES OF FITNESS, IMPLIED WARRANTIES  
OF WORKMANSHIP AND OTHER IMPLIED WARRANTIES ARE EXCLUDED BY NETZERO.