

INSTALLATION, OPERATION and MAINTENANCE MANUAL

RECREATIONAL VEHICLE DROP-IN COOKTOPS



MODELS:
FC1336

FOR RECREATIONAL
VEHICLE USE ONLY



676 Broadway Street | Dayton, Tennessee 37321
423-775-2131 | Fax: 423-775-7015 | www.airxccl.com/rv/suburban



EURO SERIES



⚠ DANGER

IF THE INFORMATION IN THIS MANUAL IS NOT FOLLOWED EXACTLY, A FIRE OR EXPLOSION MAY RESULT CAUSING PROPERTY DAMAGE, PERSONAL INJURY OR DEATH.

DO NOT STORE OR USE GASOLINE OR OTHER FLAMMABLE VAPORS AND LIQUIDS IN THE VICINITY OF THIS OR ANY OTHER APPLIANCE. AN LP CYLINDER NOT CONNECTED FOR USE SHALL NOT BE STORED IN THE VICINITY OF THIS OR ANY OTHER APPLIANCE.

WHAT TO DO IF YOU SMELL GAS

- DO NOT TRY TO LIGHT ANY APPLIANCE.
- DO NOT TOUCH ANY ELECTRICAL SWITCH (INCLUDING LIGHTS).
- DO NOT USE ANY PHONE IN YOUR RECREATIONAL VEHICLE OR RADIO.
- CLEAR THE RECREATIONAL VEHICLE OF ALL OCCUPANTS.
- TURN OFF THE GAS SUPPLY TANK VALVE(S) OR MAIN GAS SUPPLY.
- IMMEDIATELY CALL YOUR GAS SUPPLIER FROM A NEIGHBOR'S PHONE. FOLLOW THE GAS SUPPLIER'S INSTRUCTIONS.
- IF YOU CANNOT REACH YOUR GAS SUPPLIER, CALL THE FIRE DEPARTMENT.

HAVE THE GAS SYSTEM CHECKED AND LEAKAGE SOURCE CORRECTED BY A QUALIFIED INSTALLER, SERVICE AGENCY, MANUFACTURER, DEALER OR THE GAS SUPPLIER.

THIS APPLIANCE IS NOT TO BE INSTALLED WITH A VENTILATION SYSTEM THAT BLOWS AIR DOWNWARD TOWARDS THE COOKTOP. THIS TYPE OF VENTILATION SYSTEM MAY CAUSE IGNITION AND COMBUSTION PROBLEMS WITH THE GAS COOKING APPLIANCE, RESULTING IN PERSONAL INJURY OR UNINTENDED OPERATION.

THE INFORMATION PROVIDED IN THIS MANUAL IS FOR YOUR USE ONLY. YOU ARE NOT AUTHORIZED TO SHARE OR DUPLICATE THIS INFORMATION. YOU MAY NOT REPRODUCE OR TRANSMIT, IN WHOLE OR IN PART, ANY OF THE INFORMATION IN ANY FORM OR BY ANY MEANS (ELECTRONIC, MECHANICAL, PHOTOCOPYING, RECORDING, OR OTHERWISE) WITHOUT PERMISSION OF SUBURBAN MANUFACTURING COMPANY.

IMPORTANT

INSTALLER: Provide this manual to the owner/user of the recreational vehicle. **OWNER:** Retain these instructions and warranty for future reference. Read this manual carefully before operating appliance. Follow all safety notices and warnings. All technical and warranty questions should be directed to the company listed on the warranty, or rating plate located underneath the main top - Suburban Manufacturing, Dayton, TN 37321. Model: FC1336

INTRODUCTION

1. Your Drop-in Cooktop has been certified by CSA for the U.S.A. and Canada for use with Propane gas only.
2. Your cooktop is the following model: FC1336.
3. The complete model, serial number and stock number are located on the data label located on the burner box bottom. This information will be needed when servicing appliance or ordering parts. Record the information in the space provided on the WARRANTY page in this manual and retain for future reference. Replacement parts can be ordered through your local dealer or Suburban Service Center. To obtain information on locating a local service agency, call Suburban Customer Service at (423) 775-2131. (Ext 7101)
4. The cooktop is designed and certified for use with Propane gas only. **Do not attempt to convert to natural gas.**
5. Gas Supply pressure for checking of the regulator setting shall be at least 1" W.C. above the suggested manifold pressure.
 - Minimum Gas Supply Pressure: 11" W.C.
 - Maximum Gas Supply Pressure: 14" W.C.

INSTALLATION

⚠ WARNING

Installation of this appliance must be made in accordance with the written instructions provided in this manual. No agent, representative or employee of Suburban or other person has the authority to change, modify or waive any provision of the instructions contained in this manual.

1. In the U.S.A., the installation must conform with state or other codes or in the absence of such codes, refer to the latest edition of:
 - a. Standard for Recreational Vehicles NFPA 1192.
 - b. National Fuel Gas Code ANSI Z223.1/NFPA 54
2. In Canada, the installation must be in accordance with:
 - a. Standard CAN/CSA Z240.4.2-08, Installation Requirements for Propane Appliances and Equipment in Recreational Vehicles.
 - b. Any applicable local codes and regulations.

IMPORTANT

Not suitable for use with a hose assembly. Not for installation or operation with aftermarket lids or covers.

3. Minimum clearances from combustible walls above and below counter (See Figure 1):

MODELS	Below Counter Bottom (From Gas Connection)	Edge of Cutout to adjacent vertical combustible material above the cooking surface burners.		
	Sides, Rear, and Bottom	A	B	C
FC1336	0"/0mm	4"/101.6mm	3"/76.2mm	2.5"/63.5mm

4. Cut-out dimensions illustrated in Figure 3 are as follows:

MODEL	DIMENSIONS		
	A	B	Corners
FC1366	20.28"/51.51cm	12.79"/32.49cm	R1.26"/R3.2cm

*Minimum acceptable spacing between adjacent models is 3". **NOTE: The maximum depth of cabinets installed above cooking appliances is 13 inches.**

⚠ WARNING

Installation of cooktop cannot be such that the user is required to reach over any of the burners to reach the knobs.

5. Prepare the countertop cutout per the dimensions above and in Figure 3 or from the cut-out template 194000.
6. Place the template in the desired location on the countertop.
7. Make sure the unit will not interfere with the cabinet.
8. Drill a pilot hole inside the cutting line. Using a jig or keyhole saw, cut along the outline to generate the opening in the countertop.
9. Position the unit in the opening.
 - a. Apply a bead of quality kitchen & bathroom sealant or plumbers putty to the underside of the rim of the unit.
 - b. Carefully lower the unit into the opening.
10. Fasten the unit
 - a. Locate the hardware kit provided with the unit.
 - b. In each corner, thread a #8-32 flat head screw into the threaded mounting plate to draw unit securely to the countertop. Do not overtighten.
 - c. Use a clean, dry cloth to wipe away any excess sealant.
 - d. Verify there are not gaps.
11. Allow sealant to cure according to the manufacturer's instructions.

12. To prevent accidental contact, it is possible to install a divider (separator panel) at least ¼" (but not more than 6") from the bottom of the appliance.

13. Route gas line and connect it to the 3/8" flare fitting on the regulator

NOTE: Be sure to hold the fitting on the regulator with a wrench when tightening the gas connection. Failure to hold fitting secure could result in a gas leak due to fitting being damaged.

⚠ WARNING

Gas supply tubing within the confines of the appliance connection shall be rigid or semi rigid metallic tubing.

⚠ CAUTION

It is imperative that the cabinet in which the cooktop is placed be separated from other appliances so that the combustion air supply to the top burners can not be affected in any way by any forced-air heating appliance or its return air system or by any other source of positive or negative air pressure. A negative air pressure created by another forced air appliance may draw the flame down around the top burners and into the cooktop resulting in damage to the burners and cooktop, as well as possible personal injury and/or damage to vehicle. A positive draft could cause the burner flame to lift-off the burner and go out resulting in an uncontrolled escape of gas. Whenever the gas fumes reach an open flame or another ignition source, an explosion and/or fire will occur resulting in property damage, personal injury and/or loss of life.

14. Be sure all openings in the cabinets around the gas line are sealed at time of installation.
15. Be sure burner knobs are in "OFF" position. Turn on gas supply. Check all connections for leaks according to the manufacturer's instructions. Ensure that the gas connection point is accessible with the appliance installed.

⚠ WARNING

Never check for leaks with an open flame. Apply a soap and water solution to all joints to see if bubbles are formed.

NOTE: The appliance and its individual shutoff must be disconnected from the gas supply piping system during any pressure testing of that system at test pressures in excess of ½ PSIG.

16. Appliance commissioning - installer to check for correct burner test point pressure with at least 50% of cooktop burners operating, and any other appliance in operation. Verify proper ignition of all burners.
17. Check all connections for gas leaks with soap and water. **DO NOT** use a naked flame for detecting leaks. Ignite all burners both individually and concurrently to ensure correct operation of gas valves, burners and ignition. Turn gas valves to low flame position and observe stability of the flame for each burner individually and concurrently. When satisfied with the appliance, please instruct the user on the correct method of operation. In case the appliance fails to operate correctly after all checks have been carried out, refer to the authorized service provider in your area.
18. Your Drop-in cooktop is now ready for operation. Before operation, read the safety information and operation instructions contained in this manual.

ALTERNATE INSTALLATION RECESSED INTO COUNTERTOP

1. Prepare the countertop cutout per the dimensions in Figure 3.
2. Make sure the unit will not interfere with the cabinet.
3. Drill a pilot hole inside the cutting line. Using a jig or keyhole saw, cut the opening following the thick line dimensions and corner radius of 2.76"
4. Using a router set to 0.4" depth, remove the material in the corners between the inside radius of 2.76" and the outside radius of 1.26" as shown in the exploded view of Figure 3.
5. Position the cooktop into the cutout to confirm proper fit as shown in Figure 4.
6. Once the fit is acceptable, apply a bead of quality kitchen & bathroom sealant of plumbers putty to the underside of the rim.
7. Carefully lower the unit into the opening.
8. Fasten the unit using four #8x1 stainless steel wood screws (not included) into each corner as shown in Figure 4.
9. Use a clean dry cloth to wipe away any excess sealant.
10. Verify there are no gaps.
11. Allow the sealant to cure according to the manufacturer's recommendations.
12. To prevent accidental contact, it is possible to install a separator panel not more than 6" from the bottom rim of the appliance.
13. Route gas line and connect it to the 3/8" flare fitting on the regulator.

NOTE: Be sure to hold the fitting on the regulator with a wrench when tightening the gas connection. Failure to hold fitting secure could result in a gas leak due to fitting being damaged.

SAFETY INFORMATION

⚠ WARNING

NEVER use this appliance as a space heater to heat or warm the room. Doing so may result in carbon monoxide poisoning and overheating of the appliance.

Listed below are some very important facts that you should follow. They are listed for your protection and safety.

1. Have your dealer show you where the main gas shut-off valve is located and how to shut it off in an emergency.
2. Use your cooktop only for its intended use.
3. If the cooktop is near a window, proper precautions should be taken to prevent curtains from blowing over burners creating a fire hazard.
4. Keep the area around the cooktop clean and clear of any combustible materials, gasoline or other flammable vapors and liquids.
5. Do not leave children alone or unsupervised in area where cooktop is being used. The top burners, burner grates and other areas near the burners become hot enough to cause severe burns.
6. The cooking surface surrounding the appliance and the portion of appliance under the countertop will become hot during operation.
7. Do not touch the cooking surface or the portion of the appliance under the countertop or allow any items which may be damaged by heat to contact the appliance during operation or before appliance has cooled after use.
8. Children should be taught that the cooktop is not a toy. They should not be allowed to play with the controls or any other parts of the appliance.
9. Do not store items of interest to children in cabinets above or near the cooktop. Children climbing on the appliance to reach items could be seriously injured.
10. Do not wear loose fitting clothing or long-hanging sleeved clothing while using the appliance. If they contact the open flame of the burner, they could ignite and cause severe burns.
11. Use only **dry** pot holders to remove hot utensils. Using damp pot holders on hot surfaces could result in burns to hands. Do not use a towel or bulky cloth for a pot holder. The cloth could contact open flame and catch fire.
12. Never heat an unopened container. Pressure build-up within the container can cause it to explode.
13. Keep cooktop clean. The build-up of grease and food boil-over and/or spillage can create a fire hazard.
14. Avoid using your cooktop or any other appliance if you smell gas. Do not assume that the smell of gas in your RV is normal. Any time you detect the odor of gas, it is to be considered life threatening and corrected immediately. Extinguish any open flames including cigarettes and evacuate all persons from the vehicle. Shut off gas supply at LP gas bottle. (See safety notice on front cover of this manual.)
15. Turn pan handles inward or toward back of cooktop and out of the way of people walking past cooktop and/or out of the reach of children. Do not turn handles to where they are over the burners.
16. Do not use water on grease fires. Never pick up a flaming pan. Smother a flaming pan with a lid or flat pan. Flaming grease outside the pan can be extinguished with baking soda or a multipurpose dry chemical fire extinguisher.
17. Never leave top burner(s) unattended.
 - a. Down drafts could be created by opening and closing cabinets or doors and by positive or negative air pressures within the RV which can affect burner performance if installed improperly. The burner could extinguish resulting in gas escaping into the RV. **Remember, gas to the burners is controlled manually. You must turn gas ON and/or OFF.**
 - b. A boil over could occur and the spill could ignite.
18. Flame size
 - a. Never extend the flame beyond the outer edge of the utensil. A higher flame simply wastes heat and energy. See Figure 2.
 - b. Correct flame size is determined by utensil size and material, what you are cooking and whether or not you are cooking with liquid.

RECOMMENDED PAN SIZE

BURNER	AUXILIARY (Ø2.6"/66.04mm)	MAIN (Ø3.5"/88.9mm)
PAN SIZE	4" TO 4.75" (101.6 TO 120.65mm)	6.5" TO 8.5" (165.1 TO 215.9mm)

19. To prevent damage to the cooktop, top burners, or top grate, never operate a top burner without a pan in place. The top burners should not be operated on high for an extended period of time.

Use the Maximum Flame/Light Position as shown in the Operating Instructions section to begin, then reduce the flame to a lower setting to continue cooking. Never use cookware which extends beyond one inch of the grate, or rests over two operating top burners. This will cause excessive heat build-up which results in damage to the grate, top burner, and cooktop.

OPERATING INSTRUCTIONS

⚠ WARNING

The glass lid on the FC1336 Cooktop is NOT a cooking surface. The top cover must be open when main burner is in operation. See the warning label on the glass lid: **COVER MUST BE IN THE FULL OPEN POSITION WHEN ANY TOP BURNER IS IN OPERATION. AFTER USE OF BURNER(S), LET TOP BURNER GRATE(S) COOL BEFORE REPLACING TOP COVER.**

1. Know which knob controls which burner. Always be sure the correct burner is

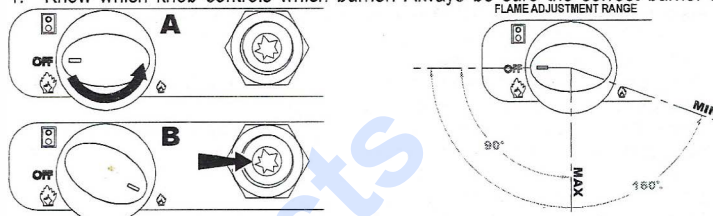

turned on.

2. Press knob and turn counter-clockwise 90° to the detent position (Figure A) so that the knob indicator is between the large flame and small flame icons as shown in the FLAME ADJUSTMENT RANGE above.
3. While holding the knob down;
 - a. Verify sufficient gas supply before attempting to light the burner. Air in the gas line will significantly delay burner ignition. The burner may light unexpectedly as the air in the line clears and is replaced by Propane gas. This unexpected ignition could burn you. Air in the gas lines may occur after the vehicle gas bottle and/or tank is refilled, during and after servicing other appliances on same gas line, etc.
 - b. Do not attempt to light more than one burner at a time.
 - c. Activate the piezoelectric lighting device with several fast, repeated pulses (Figure B).

⚠ CAUTION

Handheld ignitors may be used but be sure they are the type designed for lighting open flame burners.

4. Once the burner is lit, keep the knob pressed down for another 5 seconds and then release it. This operation is necessary to activate the gas safety device (cut-off switch). This is a thermo-electric device which guarantees the cut-off of the gas supply if the flame accidentally goes out.
5. Turn the knob to the small flame icon, then place the pan on the grate. Turn the knob to the desired flame height anywhere between the maximum flame position and the small flame icon.
6. If any burner should extinguish after initial lighting or due to accidental blow-out, turn gas off by turning control knob clockwise C to the off position as shown in the Operating Instructions section, wait five (5) minutes before attempting to relight the burner. Failure to follow these instructions could result in a fire or explosion. If the burner should go out while cooking, or if there is an odor of gas, turn control knob(s) clockwise C to the off position. Wait five (5) minutes for gas odor to disappear. If gas odor is still present - Do not relight burners. See "What To Do If You Smell Gas" on the front cover of this manual.
7. To turn the burner off, turn the burner control knob clockwise C to the off position as shown in the Operating Instructions section.
8. When the appliance is not in use, make sure that the knobs are always in the off position.

⚠ WARNING

Be sure all control knobs are turned "OFF" when you are not cooking. Someone could be burned or a fire could start if a burner is accidentally left on or unattended even if only momentarily.

MAINTENANCE

⚠ WARNING

If the user of this appliance fails to maintain it in the condition in which it was shipped from the factory or if the appliance is not used solely for its intended purpose or if appliance is not maintained in accordance with the instructions in this manual, then the risk of a fire and/or the production of carbon monoxide exists which can cause personal injury, property damage or loss of life.

1. No regular maintenance is required except cleaning.
2. Make sure all controls are "OFF" and the drop-in cooktop is cool before cleaning.
3. Make sure that all cooktop surfaces, burner grates and burners are cool before cleaning or disassembling cooktop.
4. Do not use oven cleaners, bleach or rust removers on the cooktop or burner grates.
5. Do not obstruct the flow of combustion and ventilation air.
6. Clean all surfaces as soon as possible after boil overs or spill overs.
7. Use warm soapy water only to clean the burner grates, cooktops, painted surfaces, porcelain surfaces, stainless steel surfaces and plastic items on your drop-in cooktop. Do not use grit or acid-type cleaners.
8. Do not use steel wool or abrasive cleaners. They will damage your drop-in cooktop. Use only non-abrasive plastic scrubbing pads.
9. Do not allow foods containing acids (such as lemon or tomato juice, or vinegar) to remain on porcelain or painted surfaces. Acids may remove the glossy finish.
10. Do not wash warm porcelain surfaces. Allow these areas to cool before cleaning. You could burn yourself or the porcelain could crack.
11. Pitting and discoloration will result if spills are allowed to remain for any length of time on stainless steel.
12. Do not allow spill overs to remain on the burner caps. The caps could be permanently stained if spill overs are not cleaned up promptly.
13. If any of the burner ports or the orifice are clogged, carefully clean with a small wire or needle. Be sure not to enlarge ports. Never use a wire brush for cleaning burner ports or orifice. Never use any brush which may "shed" bristles, which may become lodged in the orifice or burner ports and cause a fire or explosion.
14. The burner caps and flame dividers must be periodically removed and washed to eliminate encrusted food. Caps and flame dividers must be washed with warm soapy water, rinsed thoroughly and dried.

TO REMOVE THE BURNER CAP AND FLAME SPREADER

1. Carefully lift the grate out of the rubber mounts of the cooktop.
2. Using a number 1 phillips screw driver, remove both phillips screws from the burner cap and remove.
3. The flame spreader can be carefully lifted off the burner cup. Use caution when removing or replacing the flame spreader so as to not damage the ignitor or sensor.
4. To reinstall burner cap and flame spreader, reverse the procedure.

ABNORMAL OPERATION

Any of the following are considered to be abnormal operation and may require servicing:

1. Yellow tipping of the cooktop burner flame.
2. Sooting up of cooking utensils.
3. Burners not igniting properly.
4. Burners failing to remain alight.
5. Burners extinguished by cupboard doors.
6. Gas valves, which are difficult to turn.

In case the appliance fails to operate correctly, contact the authorised service provider in your area.

PARTS AND SERVICE

Contact a conveniently located recommended Suburban Service Center. Describe to them the nature of your problem, make an appointment, if necessary, and provide for delivery of your RV with the appliance installed.

To obtain information on locating a local service agency, contact:

Suburban, a Division of Airxcel
Customer Service Department
676 Broadway Street
Dayton, TN 37321
Phone: (423) 775-2131 Ext. 7101
www.airxcel.com/suburban

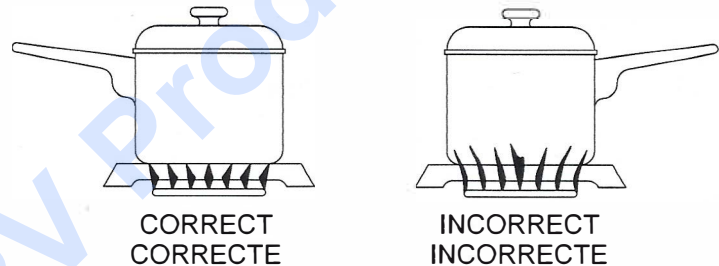

FIGURE 2

MINIMUM DISTANCE TO COMBUSTIBLE SURFACES DIRECTLY ABOVE COOK-TOP 19 1/2"/49.53cm

distance minimale par rapport à la surface combustible
directement au-dessus de la table de cuisson 19 1/2"/49.53cm

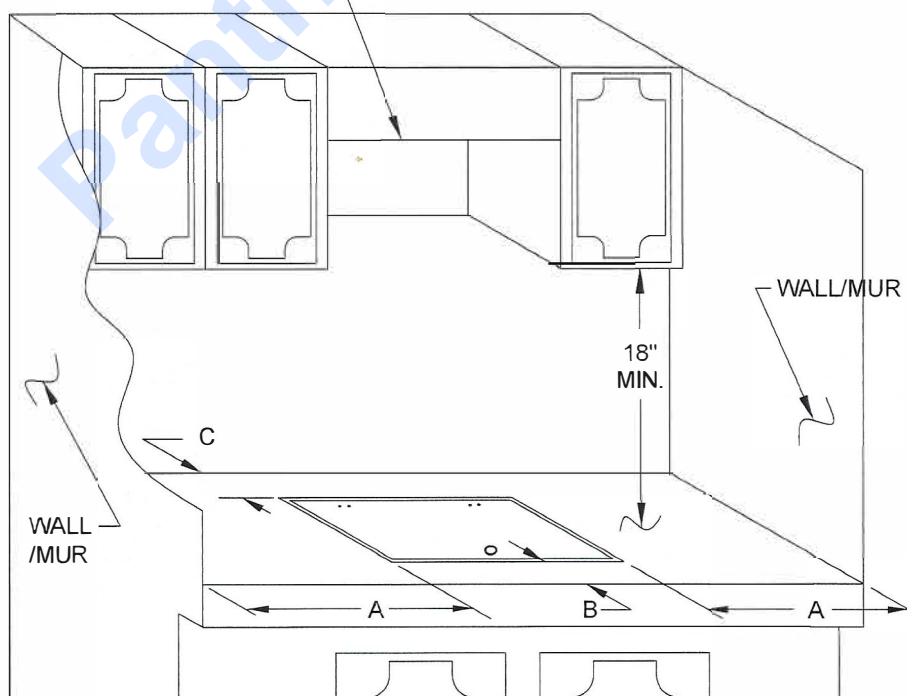

FIGURE 1

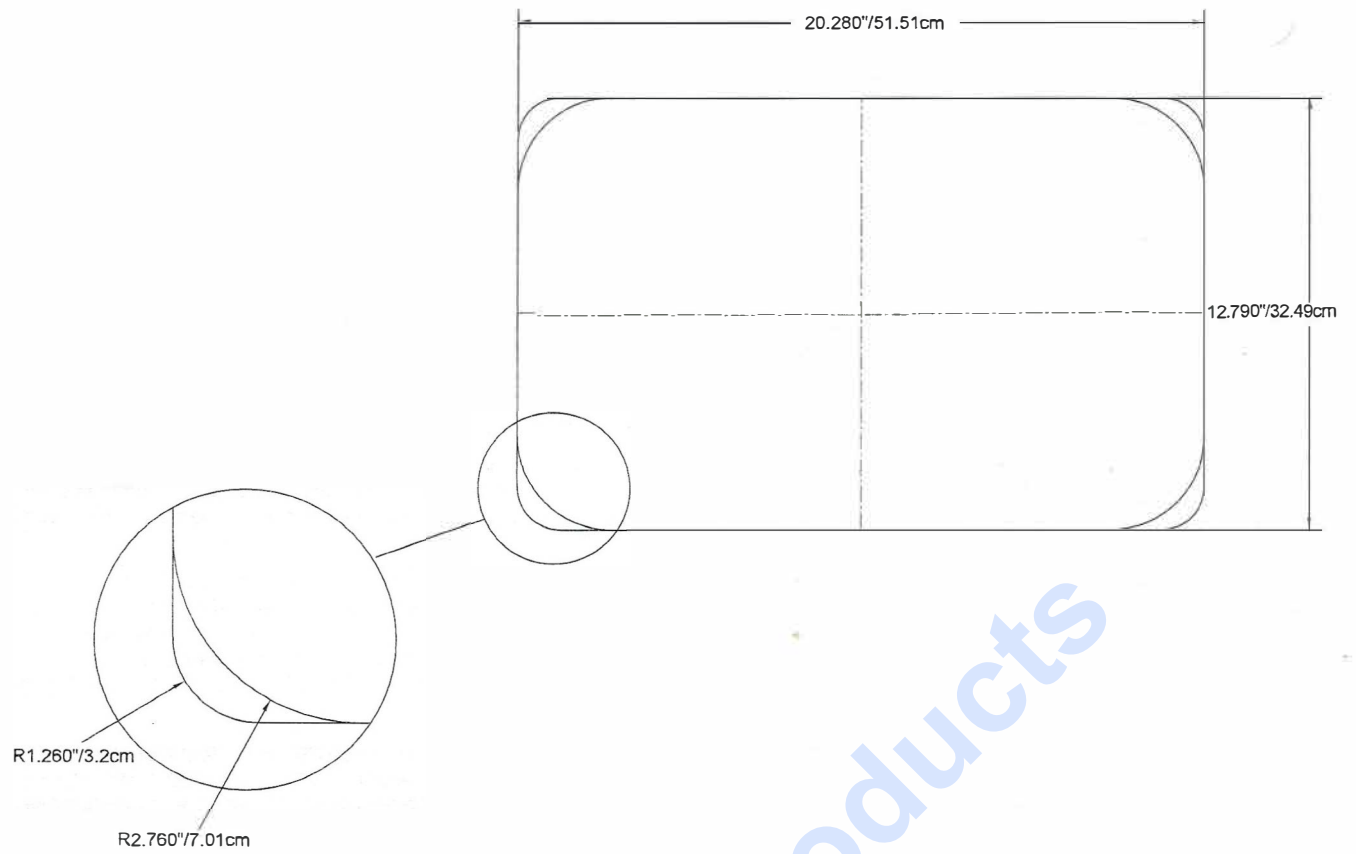

FIGURE 3

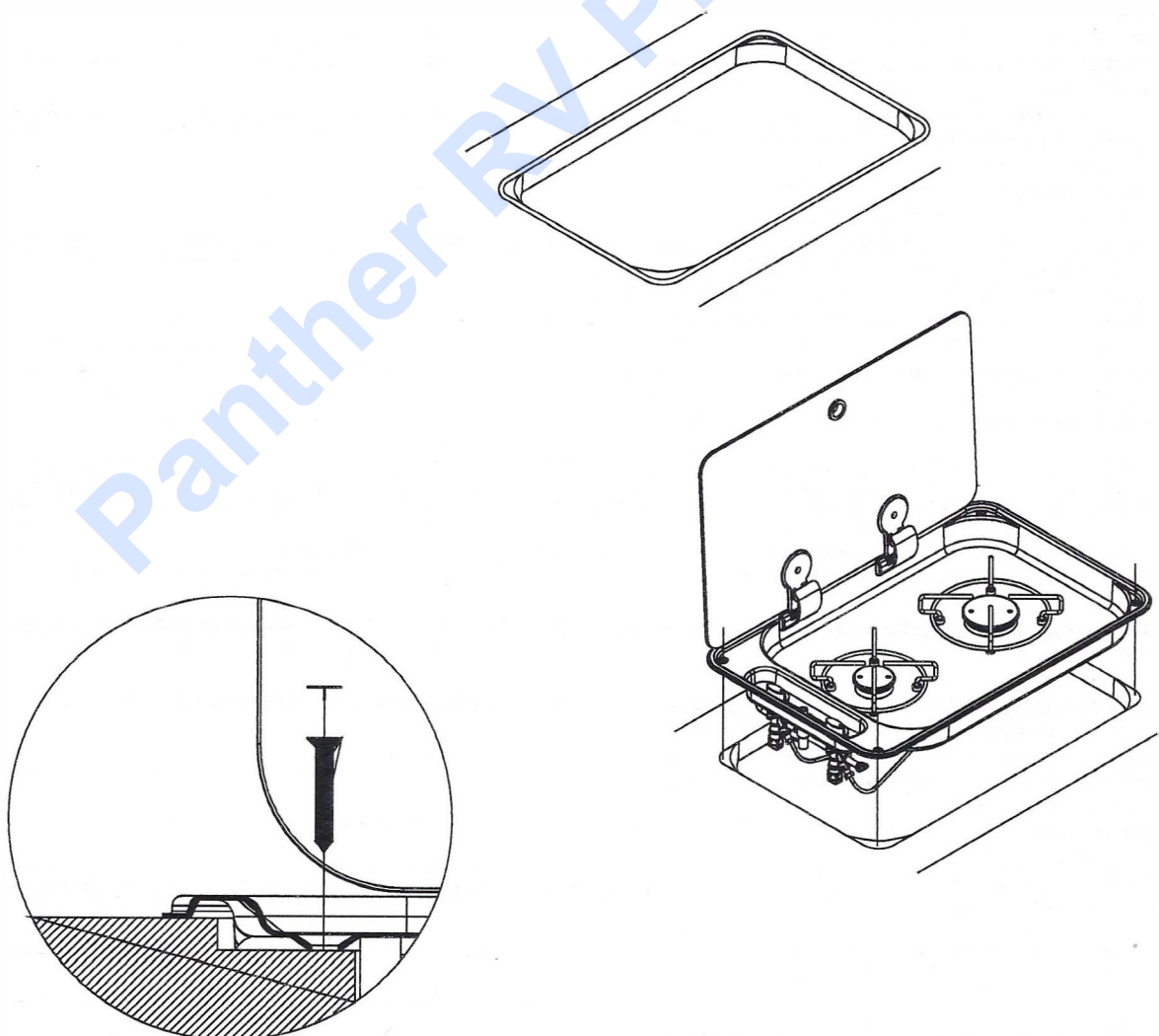

FIGURE 4

LIMITED WARRANTY

SUBURBAN RECREATIONAL VEHICLE COOKING APPLIANCE

TWO YEAR LIMITED WARRANTY

This Suburban product is warranted to the original purchaser to be free from defects in material and workmanship under normal use and maintenance for a period of two years from date of purchase whether or not actual use begins on that date. All porcelain parts, including top burner grates, are warranted as commercially acceptable only as of the date the product was manufactured. It is the responsibility of the consumer/owner to establish the warranty period. Suburban does not use warranty registration cards for its standard warranty. You are required to furnish proof of purchase date through a Bill of Sale or other payment records.

Suburban will replace any parts that are found defective within the first two years and will pay a warranty service allowance directly to the recommended Suburban Service Center at rates mutually agreed upon between Suburban and its recommended service centers. Replacement parts will be shipped FOB the shipping point within the Continental United States, Alaska and Canada to the recommended service center performing such repairs. All freight, shipping and delivery costs shall be the responsibility of the owner. The exchanged part or unit will be warranted for only the unexpired portion of the original warranty. Before having warranty repairs made, confirm that the service agency is a recommended service center for Suburban. **DO NOT PAY THE SERVICE AGENCY FOR WARRANTY REPAIRS; SUCH PAYMENTS WILL NOT BE REIMBURSED.**

Suburban reserves the right to examine the alleged defect in the range appliance or component parts, and it is the owner's obligation to return the range appliance and/or component parts to Suburban or its representative. When returning a range appliance, it must include all component parts and the serial number plate. Returned component parts must be individually tagged and identified with the range appliance's model number, serial number and date of installation.

For warranty service, the owner/user should contact the nearest recommended Suburban Service Center, advising them of the model and serial numbers (located on the burner box bottom) and the nature of the defect. Transportation of the RV to and from the Service Center and/or travel expenses of the Service Center to your location is the responsibility of the owner/user. A current listing of recommended service center may be obtained from Suburban's website: www.Airxcel.com. If you cannot locate a recommended service center locally, the service agency chosen to perform warranty repairs must contact our Service Department at 423-775-2131 for authorization before making repairs. Unauthorized repairs made will not be paid by Suburban.

LIMITATION OF WARRANTIES

ALL IMPLIED WARRANTIES (INCLUDING IMPLIED WARRANTIES OF MERCHANTABILITY) ARE HEREBY LIMITED IN DURATION TO THE PERIOD FOR WHICH EACH LIMITED WARRANTY IS GIVEN. SOME STATES DO NOT ALLOW LIMITATIONS ON HOW LONG AN IMPLIED WARRANTY LASTS SO THE ABOVE LIMITATIONS MAY NOT APPLY TO YOU. THE EXPRESSED WARRANTIES MADE IN THIS WARRANTY ARE EXCLUSIVE AND MAY NOT BE ALTERED, ENLARGED, OR CHANGED BY ANY DISTRIBUTOR, DEALER OR OTHER PERSON WHOMSOEVER.

SUBURBAN WILL NOT BE RESPONSIBLE FOR:

1. Normal maintenance as outlined in the installation, operating and service instructions owner's manual including cleaning of component parts and cleaning or replacement of the burner orifice.
2. Initial checkouts and subsequent checkouts which indicate the range appliance is operating properly, or diagnosis without repair.
3. Damage or repairs required as a consequence of faulty or incorrect installation or application not in conformance with Suburban instructions.
4. Any damage (cracks, chips, scratches, etc.) to any painted or porcelain enamel parts.
5. Failure to operate due to loose or disconnected wires; water or dirt in controls, fuel lines and gas tanks; improper gas pressure; low voltage.
6. Cleaning or adjustment of components; electrode, burner tube, pilot and thermocouple.
7. Costs incurred in gaining access to the range appliance.
8. Parts or accessories not supplied by Suburban.
9. Freight charges incurred from parts replacements.
10. Damage or repairs needed as a consequence of any misapplication, abuse, unreasonable use, unauthorized alteration, improper service, improper operation or failure to provide reasonable and necessary maintenance.
11. Suburban products whose serial number has been altered, defaced or removed.
12. Suburban products installed or warranty claims originating outside the Continental U.S.A., Alaska, Hawaii and Canada.
13. Damage as a result of floods, winds, lightning, accidents, corrosive atmosphere or other conditions beyond the control of Suburban.
14. Any special, indirect or consequential property, economic or commercial damage of any nature whatsoever.

Some states do not allow the exclusion of incidental or consequential damages, so the above limitation may not apply to you.

NO REPRESENTATIVE, DEALER, RECOMMENDED SERVICE CENTER OR OTHER PERSON IS AUTHORIZED TO ASSUME FOR SUBURBAN, AN AIRXCEL BRAND, ANY ADDITIONAL, DIFFERENT OR OTHER LIABILITY IN CONNECTION WITH THE SALE OF THIS SUBURBAN PRODUCT.

This warranty gives you specific legal rights, and you may also have other rights which vary from state to state.

IF YOU HAVE A PRODUCT PROBLEM

FIRST: If your RV has its original range appliance and is still under the RV manufacturer's warranty, follow the steps suggested by your dealer or manufacturer of the RV.

SECOND: Contact a conveniently located recommended Suburban Service Center. Describe to them the nature of your problem, make an appointment, if necessary, and provide for delivery of your RV to the selected service center.

THIRD: To obtain information on locating a local service agency, contact:

Suburban Customer Service
676 Broadway Street
Dayton, Tennessee 37321
(423) 775-2131, Ext. 7101
www.airxcel.com/rv/suburban

FOR FUTURE REFERENCE, YOU SHOULD RECORD THE FOLLOWING INFORMATION:

MODEL NUMBER: _____

SERIAL NUMBER: _____

STOCK NUMBER: _____

DATE OF PURCHASE: _____



A Division of AIRXCEL