

# RAM PROMASTER FOOTREST

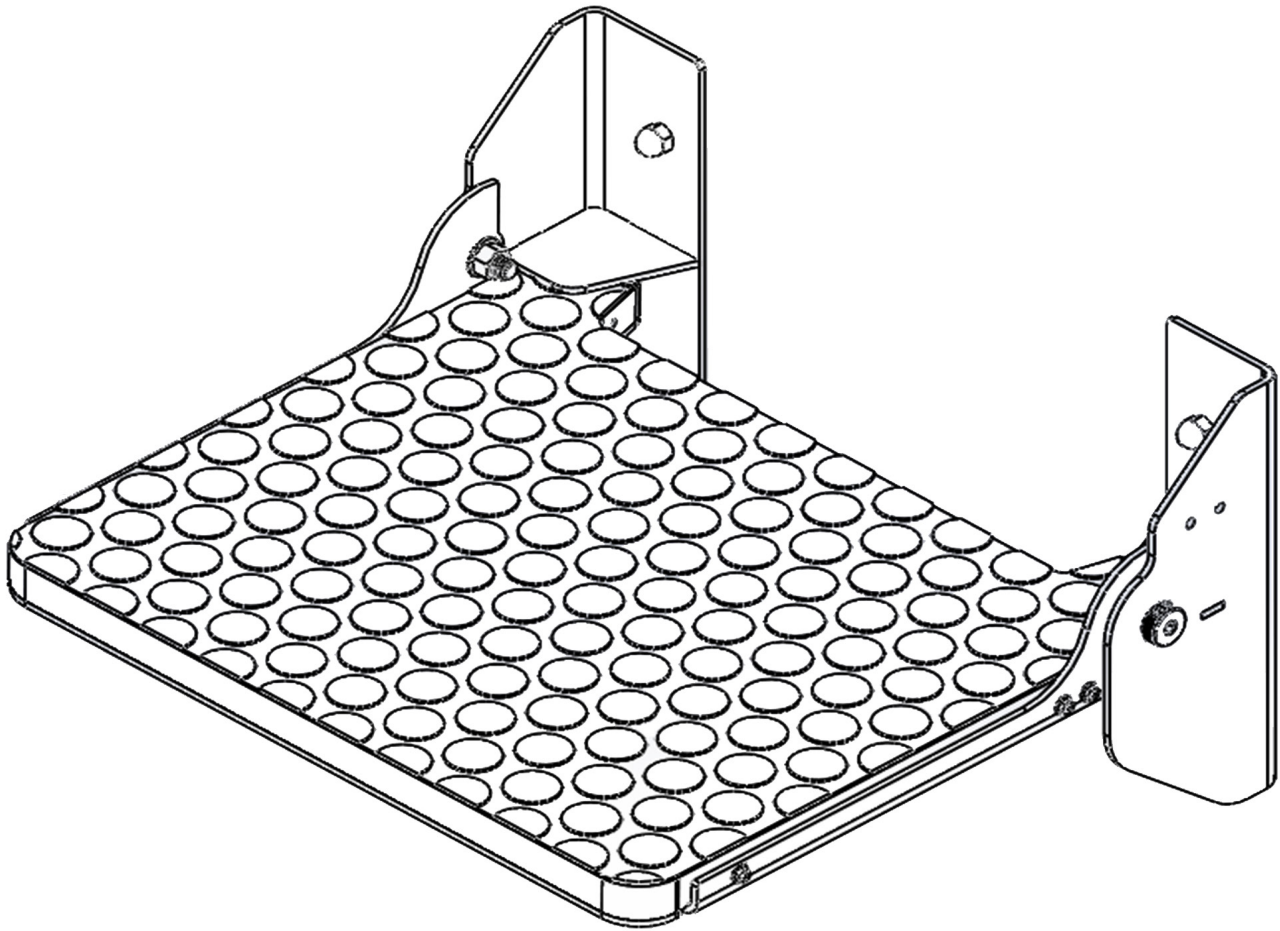

## INSTRUCTION MANUAL

COMPONENTS - TOOLS NEEDED - INSTALLATION

PATENT PENDING

# OVERVIEW

## TOOLS NEEDED



7/16" WRENCH



9/16" WRENCH

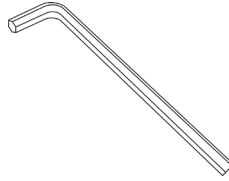

4MM ALLEN KEY

(SUPPLIED)

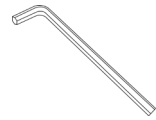

1/4" ALLEN KEY

## HARDWARE

1/4" X 1/2" HEX HEAD BOLT



AXLE BOLT

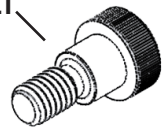

BIG HOLE WASHER

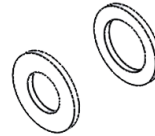

LOCK WASHER



SMALL HOLE WASHER



ACORN NUT



3/8" NUT



X2

X4

## COMPONENTS

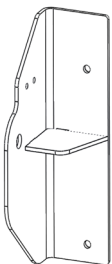

LEFT SIDE BRACKET

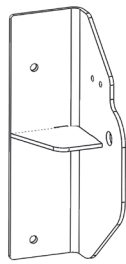

RIGHT SIDE BRACKET

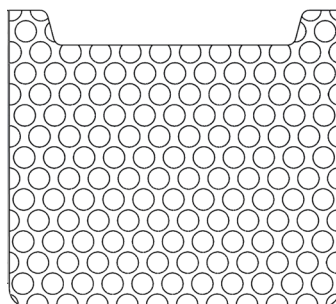

FOOTREST DECK

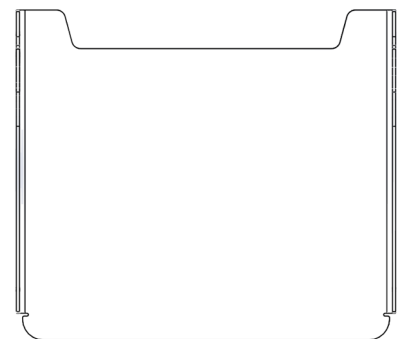

FOOTREST PLATE

# ASSEMBLY INSTRUCTIONS

FIGURE 1: SIDE BRACKET MOUNTING

FIGURE 2: FOOTREST DECK MOUNTING

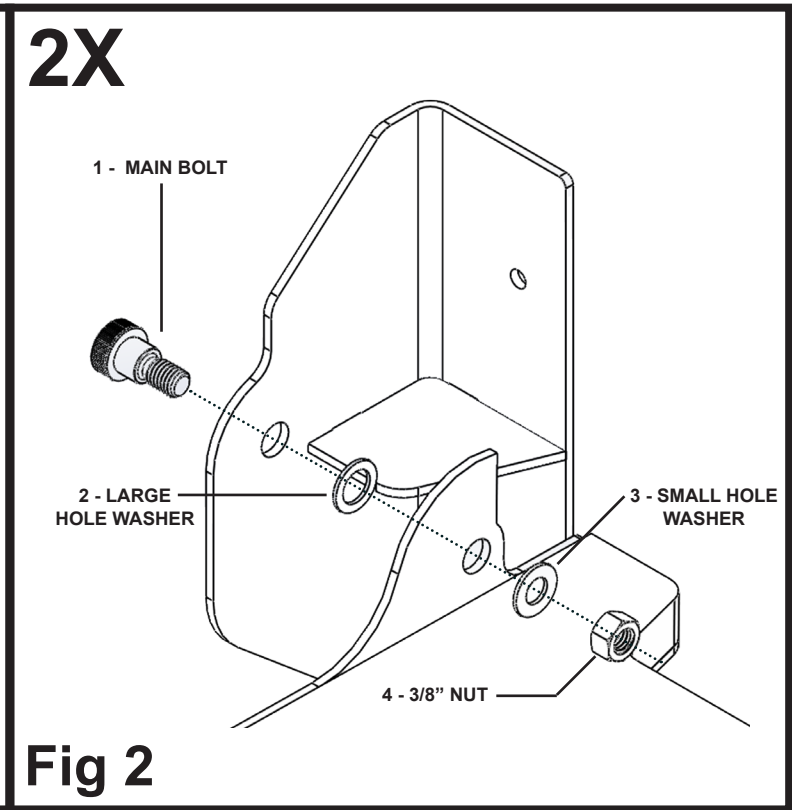
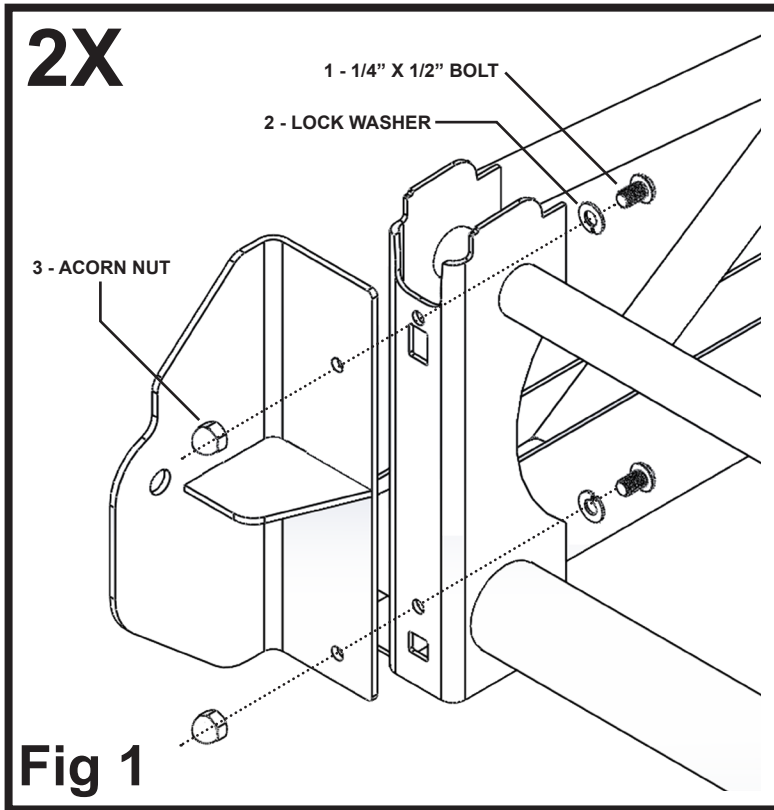

## STEP 1: MOUNT FIXED BRACKETS TO SEAT BASE

### 1. Attach mounting brackets to seat base

- Use provided 1/4" x 1/2" bolts (1), lock washer (2) and acorn nuts (3). Arrange as shown in figure 1.
- Fit bolt to supplied 4mm allen wrench and reach within seat base to fit bolt (1) through the upper factory holes in seat base.
- With upper bolt (1) coming through the seat base mount the footrest side bracket using the acorn nut (3) and lock washer (2).
- Attach the lower bolt (1), lock washer (2), and acorn nut (3).
- Repeat on other side.

## STEP 2: CONNECTING AXLE BOLTS TO FOOTREST

### 2. Attach footrest deck to side brackets

- Following figure 2, start on either side, slide the axle bolt (1) through the axle hole on the side bracket, then slide on the large hole washer (2), footrest deck, small hole washer (3), and 3/8" nut (4), do not fully tighten.
- Move on to the other side and repeat the process. It is helpful to rest the footrest deck on something to help with alignment.
- fully tighten axle bolts (1).
- Installation is complete.