

EcoFlow DELTA Pro

(EV X-Stream Adapter)



EcoFlow

EcoFlow DELTA Pro EV X-Stream Adapter

Product illustration

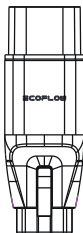
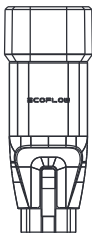
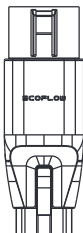

J1772 (Type 1)
For U.S./Japan

Mennekes (Type 2)
For the European
region

GB/T
For the Chinese
region

Product information

- Model number: EFD500-CC
- Output voltage: 100–240 V
50/60 Hz
- Maximum input/output
power: 3400 W max
- Input voltage: 100–240 V
50/60 Hz
- Operating temperature:
-10°C to 45°C

How to connect

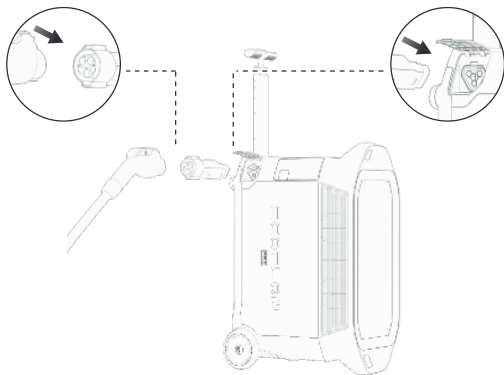

Tip: Pay attention to aligning the connector locations when connecting.

Safety tips

- Make sure that the EV charger, DELTA Pro EV X-Stream Adapter and the Infinity Port are inserted into place before use;
- It is strictly forbidden to allow this product to come into contact with any liquid. Do not immerse this product in water or get it wet.

FCC STATEMENT

This device complies with Part 15 of the FCC Rules. Operation is subject to the following two conditions:

- (1) This device may not cause harmful interference, and
- (2) This device must accept any interference received, including interference that may cause undesired operation.

Warning:

Changes or modifications not expressly approved by the party responsible for compliance could void the user's authority to operate the equipment.

NOTE:

This equipment has been tested and found to comply with the limits for a Class A digital device, pursuant to part 15 of the FCC Rules. These limits are designed to provide reasonable protection against harmful interference when the equipment is operated in a commercial environment. This equipment generates, uses, and can radiate radio frequency energy and, if not installed and used in accordance with the instruction manual, may cause harmful interference to radio communications. Operation of this equipment in a residential area is likely to cause harmful interference in which case the user will be required to correct the interference at his own expense.