

Bug Check® SRB

Sample Collection Methods

Oily Sample: *Special sampling precautions are necessary.* In oil/water systems, the organisms are located in the layer between the oil and water and in the water portion. Samples **must** be taken from these locations because micro-organisms are unable to grow in the absence of water. Collect a sample with a minimal oil layer. Skim excess oil from the sample with the enclosed dropper.

Water Sample: *No special sampling precautions are necessary.*

NOTE: Samples suspected of being heavily contaminated may be pre-diluted with tap water using the dilution container provided.

Dry Sample: *Special sampling precautions are necessary.* Dry surfaces may be sampled by pre-wetting the applicator with tap water and swabbing a representative portion of the test area.

Directions for Use

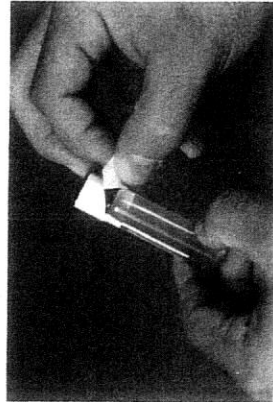

1.

Open Bug Check SRB vial by peeling off the protective seal and removing the cap.

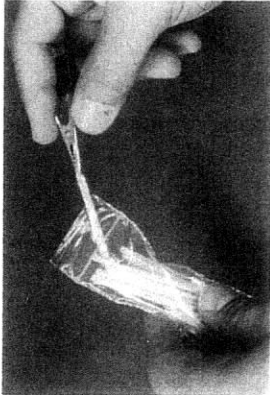

2.

Grip an applicator with the alligator clip.

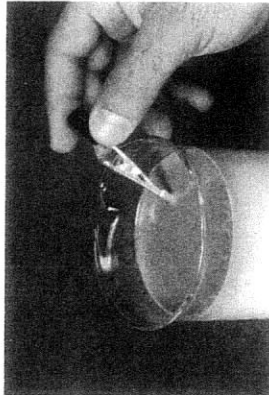

3.

Insert applicator into fluid sample. Immerse for approximately 5 seconds, withdraw, and drain excess fluid without touching any other surface.

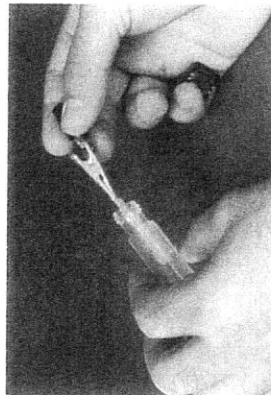

4.

Immediately insert applicator into Bug Check SRB, taking care to center it. Push the applicator into the vial until it is about even with the surface.

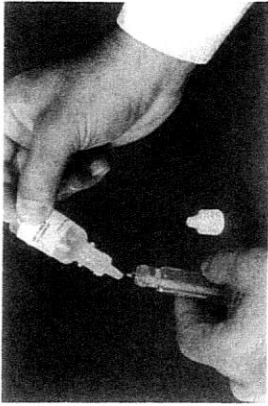

5.

Add 2-3 drops of mineral oil to the vial.

6.

This step is no longer needed. Proceed to the next step.

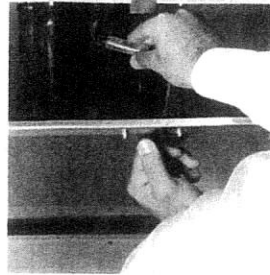

7.

For best results, incubate the sample at a temperature within 5° of the environment from which it was taken and do not reopen vial. Observe the vial regularly for results and compare to the SRB chart on reverse side.

Disposal

Used Bug Check SRB vials can be disposed of by incineration, autoclaving, or disinfection.