

White Compact Crank Height Adjustable Desk Frame Instruction Manual

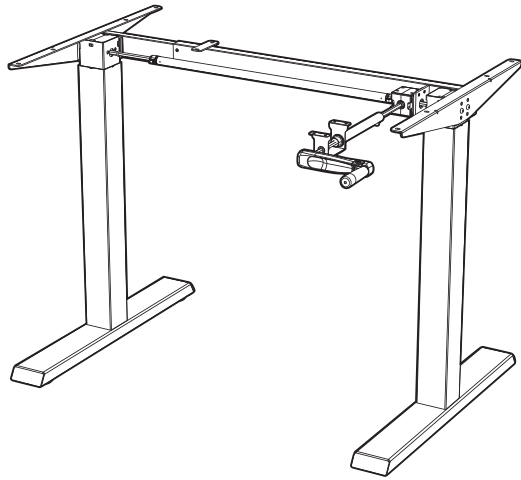

SKU: DESK-M051MW



Scan the QR code with your mobile device or follow the link for helpful videos and specifications related to this product.

<https://vivo-us.com/products/desk-m051mw>

GET IN TOUCH | Monday-Friday from 7:00am-7:00pm CST



help@vivo-us.com



www.vivo-us.com
Chat live with an agent!



309-278-5303

WARNING!

If you do not understand these directions, or if you have any doubts about the safety of the installation, please call a qualified technician. Check carefully to make sure there are no missing or defective parts. Improper installation may cause damage or serious injury. Do not use this product for any purpose that is not explicitly specified in this manual and do not exceed weight capacity. We cannot be liable for damage or injury caused by improper mounting, incorrect assembly, or inappropriate use.

WARNING: CHOKING HAZARD

SMALL PARTS - NOT FOR CHILDREN UNDER 3 YEARS. ADULT SUPERVISION IS REQUIRED.

PACKAGE CONTENTS



A (x1)
Crossbar

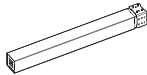

B (x1)
Leg

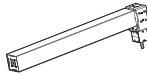

C (x1)
Leg with
Gearbox



D (x1)
Crossbar Spacer



E (x2)
Side Bracket



F (x1)
Sync Rod



G (x1)
Crank

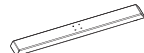

H (x2)
Foot



S-A (x16)
M6x12 Bolt



S-B (x4)
3/4" Screw



S-C (x10)
7/8" Screw



S-D (x10)
Anti-Vibration
Pad



S-E (x1)
Allen Wrench

WARNING **PINCH POINT**

DO NOT place hands on or near support bars. Moving parts can crush and cut. Pinch points are created during lifting and lowering the worksurface. Failure to follow these instructions may result in serious personal injury.



TOOLS NEEDED



**Phillips
Screwdriver**



Level



Drill

DO NOT EXCEED WEIGHT CAPACITY.
Failure to do so may result in serious injury.



ASSEMBLY STEPS

STEP 1

Loosen the two set screws on the telescopic crossbar **(A)** using the Allen wrench **(S-E)**. Adjust the crossbar length to suit the desktop. Retighten all screws.

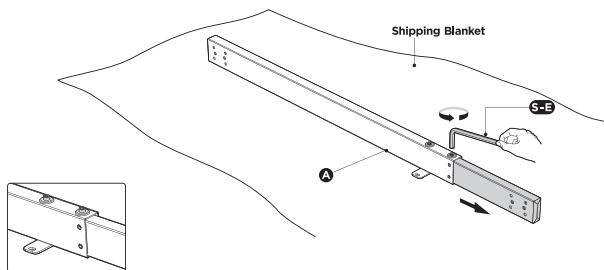

STEP 2

Place the crossbar spacer **(D)** on the leg **(B)** as shown. Attach the telescopic crossbar to the legs **(B, C)** as shown using M6x12mm bolts **(S-A)**, and tighten with the Allen wrench **(S-E)**. **NOTE:** Insert all necessary screws into holes before tightening.

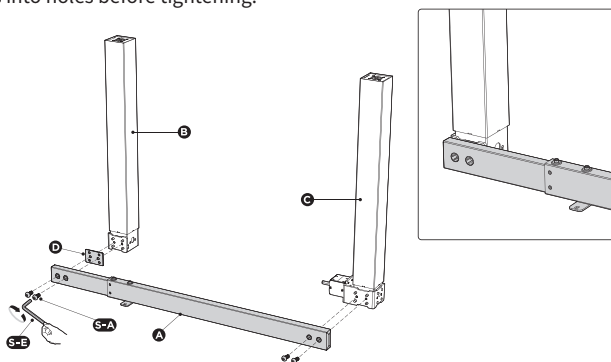

STEP 3

Attach the side brackets **(E)** to both ends of the frame using four M6x12mm bolts **(S-A)**. Tighten with the Allen wrench **(S-E)**.

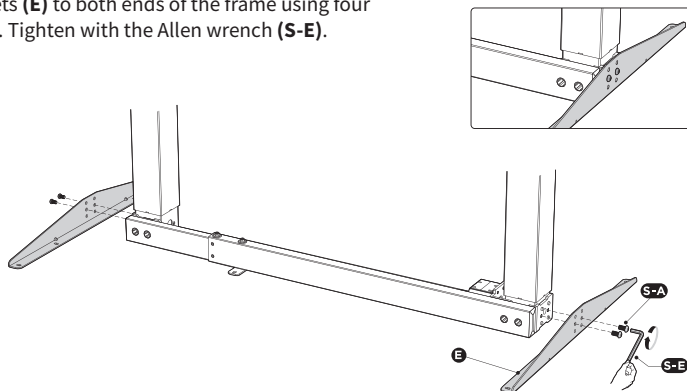

STEP 4

Loosen the knob on the socket end of the sync rod (**F**) and slide the sync rod onto the shaft of the leg with gearbox. Tighten the knob.

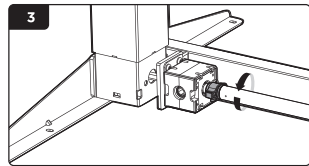
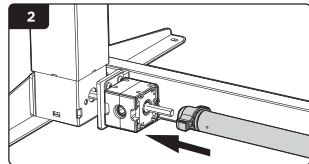
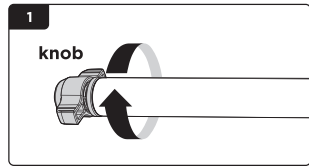
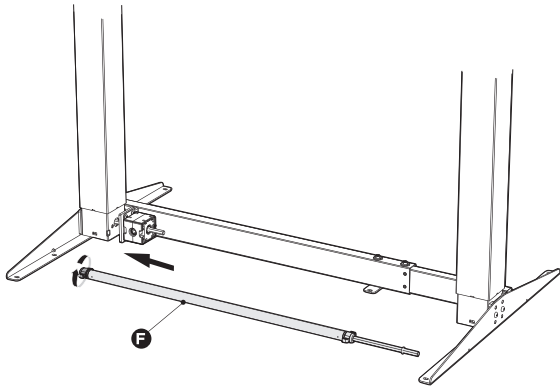

STEP 5

Loosen the knob on the other end of the sync rod and extend the hex shaft into the socket in the leg, making sure the shaft is fully inserted. Tighten the knob.

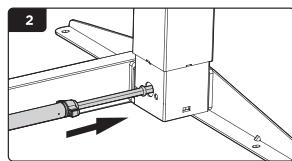
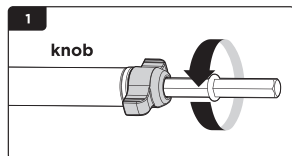
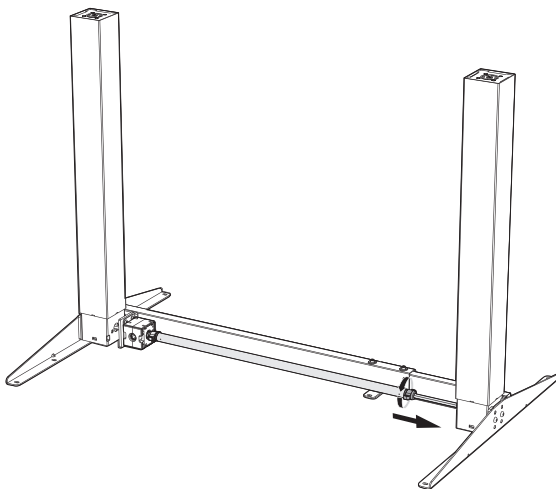

STEP 6

Place the frame upside down on desktop and drill pilot holes for the screws. Use a 3/32" or 3mm bit, and drill holes to a depth of 3/8" (10mm). Readjust the sync rod if necessary.

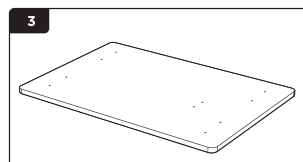
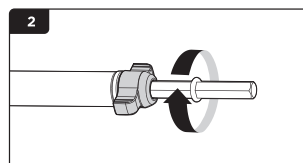
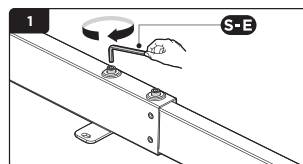
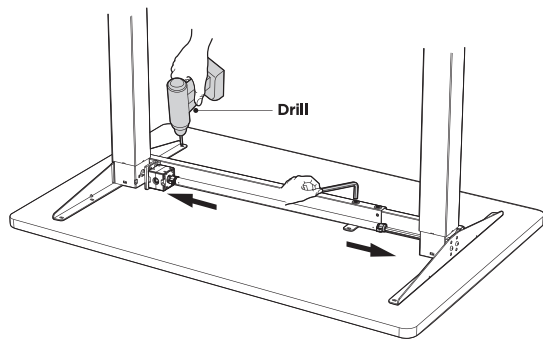

STEP 7

Insert the anti-vibration pads (**S-D**) into the desktop mounting holes in the crossbar and side brackets. Place the assembled frame on the desktop, making sure the pre-drilled holes are aligned with the desk frame, and secure the frame using 7/8" screws (**S-C**).

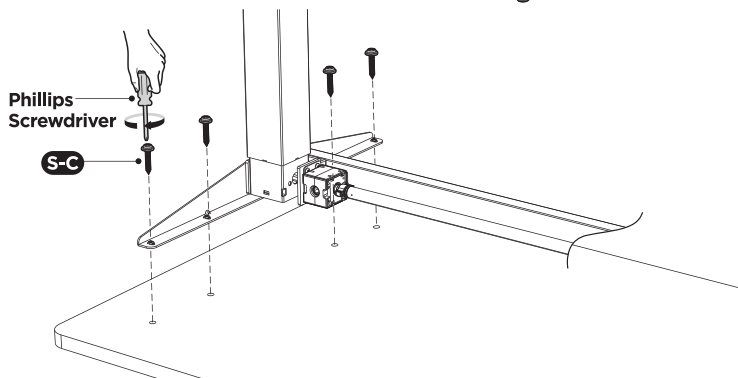
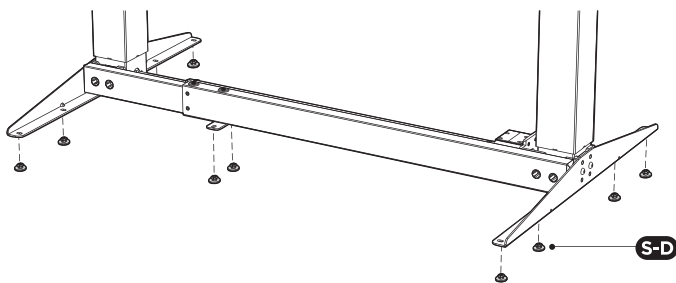

STEP 8

Loosen the set screw on the crank (**E**) using the Allen wrench (**S-E**). Extend the crank into the gearbox, and with the front of the support plate flush with the front of the desktop, retighten the set screw. Using the module support plate, mark drilling locations with a pencil. Drill $3/8"$ (10mm) deep pilot holes under the desktop with a $5/64"$ (or 2mm) drill bit. Secure the support plate to the underside of the desk using $3/4"$ screws (**S-B**).

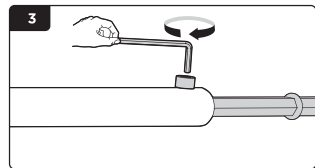
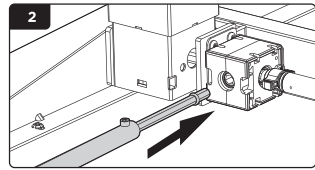
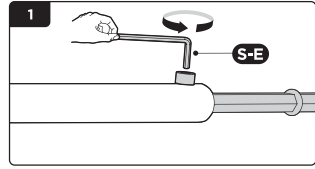
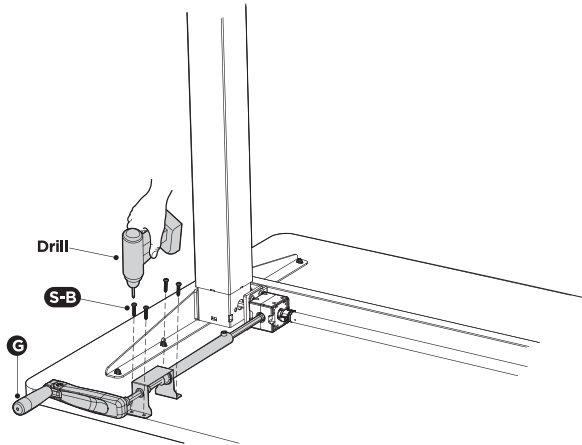

STEP 9

Place the feet (**H**) on the legs as shown. Insert and tighten bolts (**S-A**) using the Allen wrench (**S-E**).

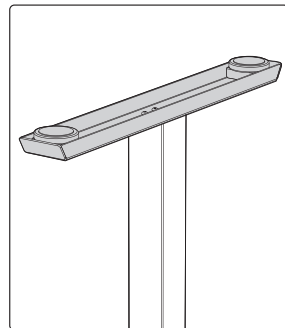
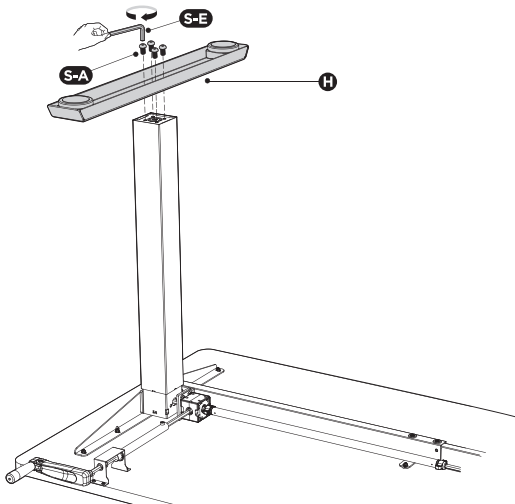

STEP 10

If necessary, adjust foot pads to level desk. To operate the desk, pull out and rotate the crank. When not in use, push the crank back in and fold the handle.

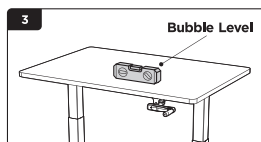
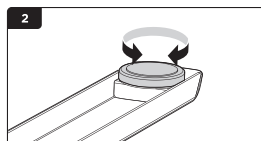
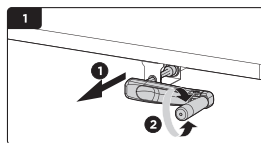
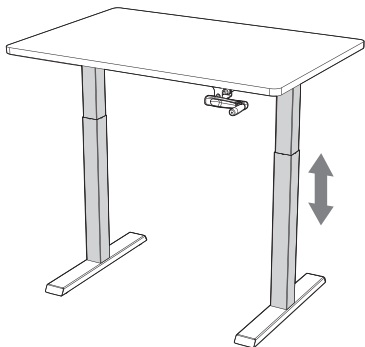

CAUTION!



Do not exceed desk weight limit.

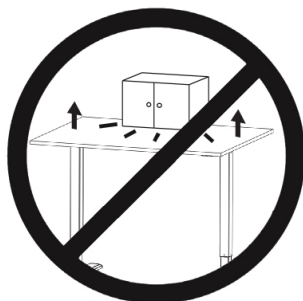

Keep area of vertical motion free of obstacles.



Keep weight on desk balanced for correct operation and longer life of components.



Leave enough slack in cables to allow for full range of vertical motion.

Failure to follow these instructions may result in property damage and/or personal injury.

 Love your new VIVO setup and want to share?
Tag us in your photo! **@vivo_us**

LAST UPDATED: 03/04/2020



Open **Monday - Friday 7:00am - 7:00pm** CST,
our dedicated support team can offer immediate assistance with rapid response times. If any parts are received damaged or defective, please contact us. We are happy to replace parts to ensure you have a fully functioning product.

 help@vivo-us.com

AVG. RESPONSE TIME (*within office hrs*): **1HR 8M**

- 23% within < 15m
- 38% within < 30m
- 61% within < 1hr
- 83% within < 2hr
- 92% within < 3hr

 www.vivo-us.com
Chat live with an agent!

AVG. RESOLUTION TIME (*within office hrs*): **< 15 M**

 309-278-5303

AVG. RESOLUTION TIME (*within office hrs*): **5M 4S**

FOR MORE VIVO PRODUCTS, CHECK OUT OUR WEBSITE AT: www.vivo-us.com