

Freestanding Base

INSTALLATION INSTRUCTIONS

PARTS REQUIRED

- A (1) QuickStand Unit
- B (2) Leg-Covers
- C (1) Stopper
- D (1) Leg
- E (1) Base
- F (1) Spacer
- G (1) Platform (work surface)
- H (8) M6 x 9.5 mm Flat Head Machine Screws
- I (6) M8 x 18 mm Flat Head Machine Screws
- J (2) M8 x 14 mm Button Head Machine Screws

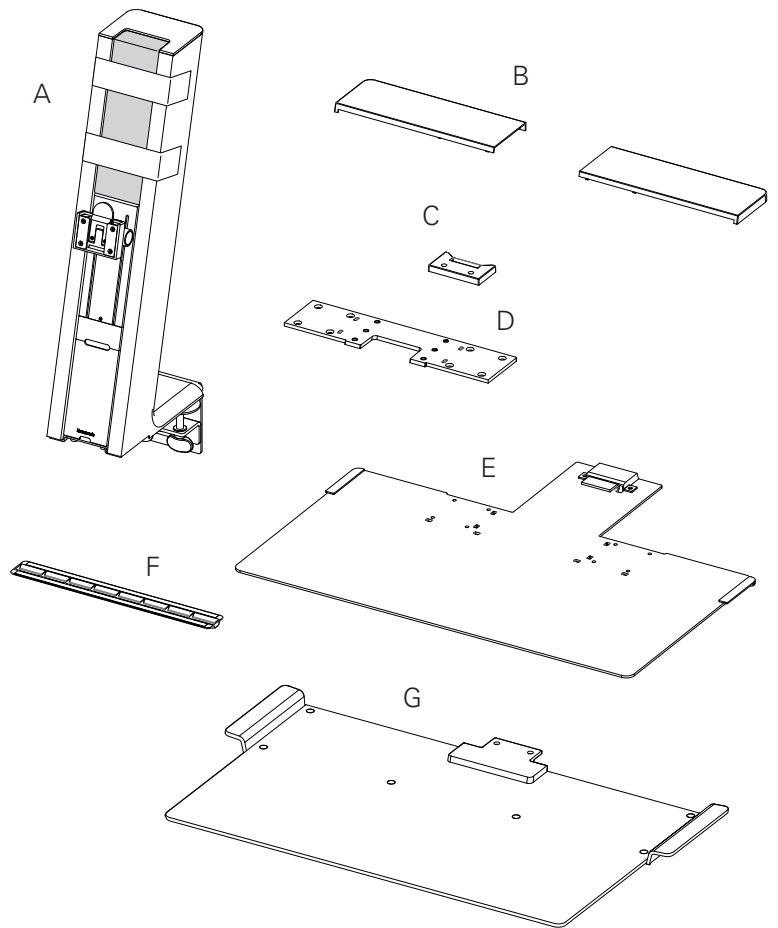

Tools Required

4 mm Hex Key (supplied)



5 mm Hex Key (supplied)



6 mm Hex Key (supplied)



Hardware

H

I

J

WARNING

Read all instructions carefully before installing this product or attempting to use it

This product contains a loaded mechanism that is under tension. Do not attempt to remove or alter any part of this product or in any way modify or tamper with any component of this product other than as set forth in these instructions. Failure to comply with the instructions provided may result in property damage or serious injury.

Do not remove bracing box attached to QuickStand unit until your QuickStand is fully assembled

STEP 1

Assemble Post

Tools: 5 mm Hex Key

- Place the base on the desk and remove the leg (fig A) by unscrewing the two screws and set them aside for use in step 6.
- Place the QuickStand post on the desk laying on its back.
- Carefully remove the shipping plate (fig B) and set aside the (2) M8 x 10 mm Cap Head Machine Screws and the Washers for Step 4.

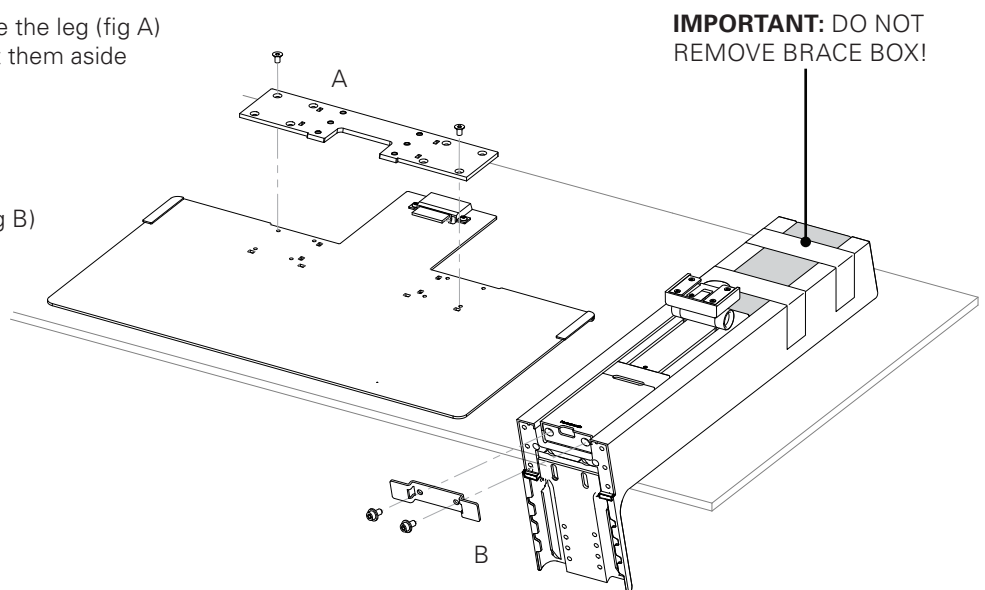

STEP 2

Install Leg

Tools: 5 mm Hex Key

- Secure the leg in place using (6) M8 x 18 mm Flat Head Machine Screws (fig. C)
- Attach stopper using (2) M8 x 14 mm Button Head Machine Screws (fig D) and make sure the edge is parallel with the base

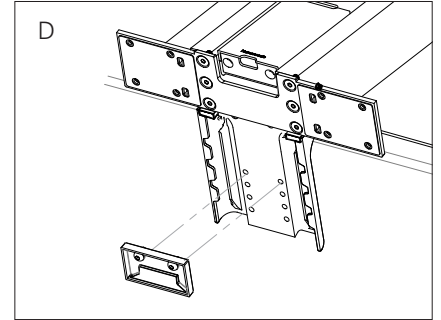
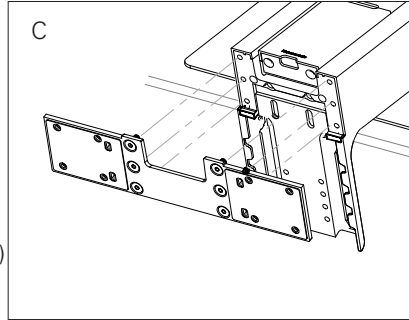

STEP 3

Attach Platform

Tools: 6 mm Hex Key

- Ensure the Platform is parallel and equally spaced from the leg on either side (fig. E)
- Using the (2) M8 x 10 mm Cap Head Machine Screws and the Washers from step 1, secure the Platform to the QuickStand unit

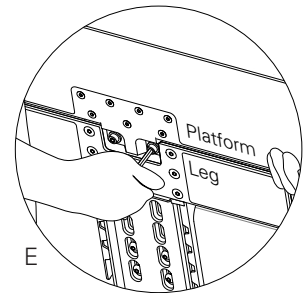
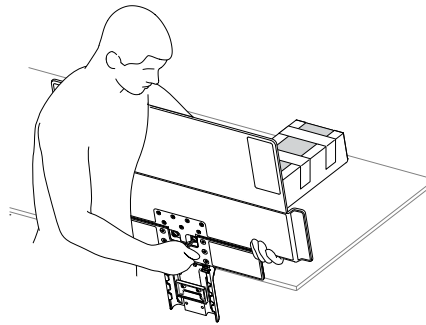

STEP 4

Attaching Spacer Under the Platform

- Peel back paper to expose adhesive and press the spacer firmly into place on the underside of the Platform centered and parallel to the pads (fig. F)

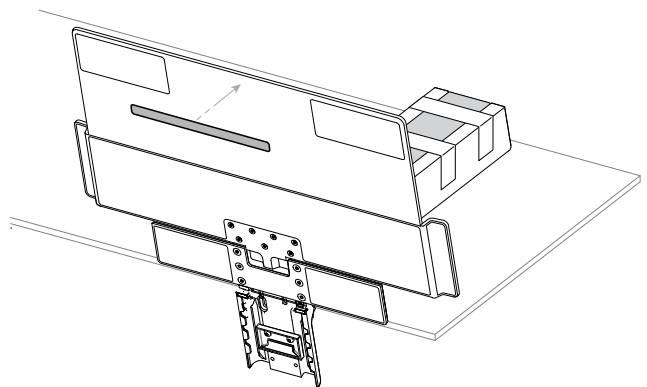
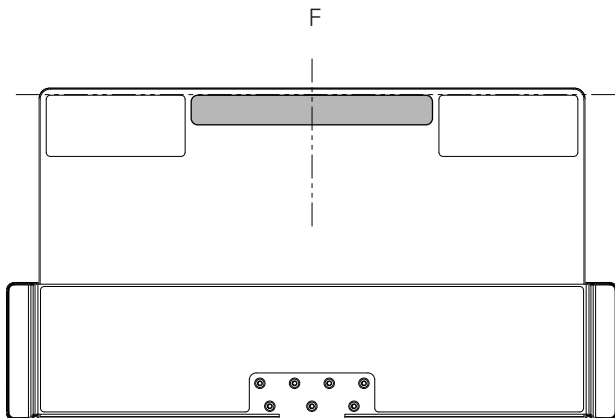

STEP 5

Attaching QuickStand to the Base

IMPORTANT: Your QuickStand unit is heavy. If needed, please have assistance when lifting.

- Carefully lift your QuickStand unit from its horizontal position to its vertical position (fig. G)
- Once your QuickStand is sitting upright on the base slide it back so the stopper hooks into base (fig H)

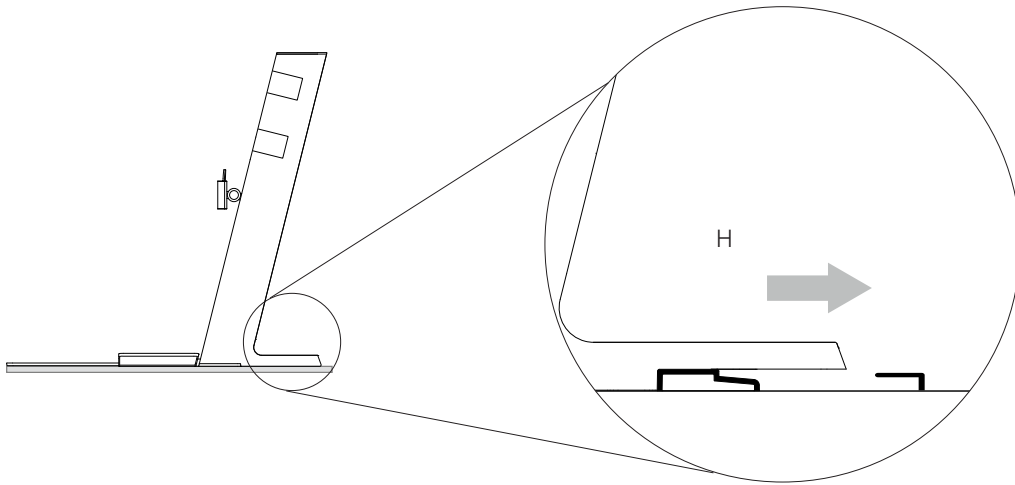
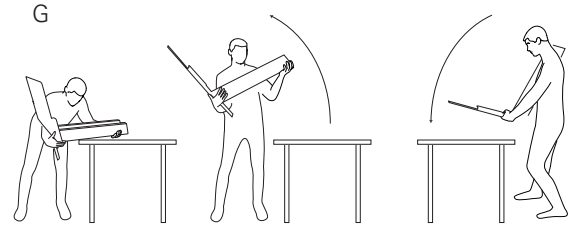

STEP 6

Attach Leg to Base

Tools: 4 mm Hex Key

- Secure the legs to base using (8) M6 x 9.5 mm Flat Head Machine Screws (fig. I)
- Attach the plastic leg-covers by pressing firmly down until they each click into place (fig J)
- Position the unit so the front edge of the work surface aligns with the front edge of the desk when in the low position (fig K)

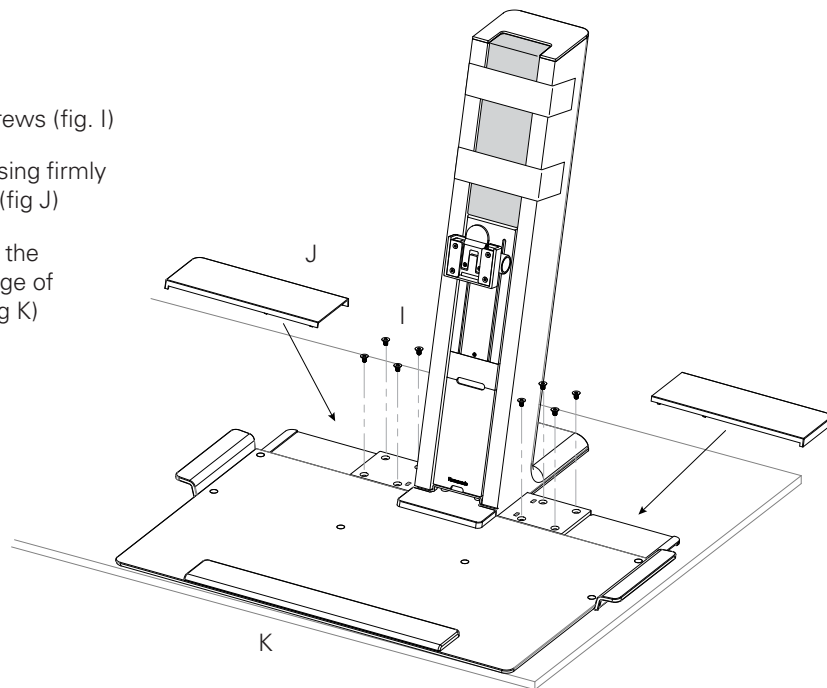

Proceed to the **Monitor Installation** steps in the main QuickStand Assembly Instructions