

Item	Description	Qty
1	Gullwing Bracket	1
2	Bolt, Shock Mount	1
3	Bolt, Cam Mount	1
4	Bolt, Bracket Mount	2
5	over cam bolt	1
6	Nut, Cam Mount	1
7	Nut, Cam Mount	1

PN# 73-35-043-R

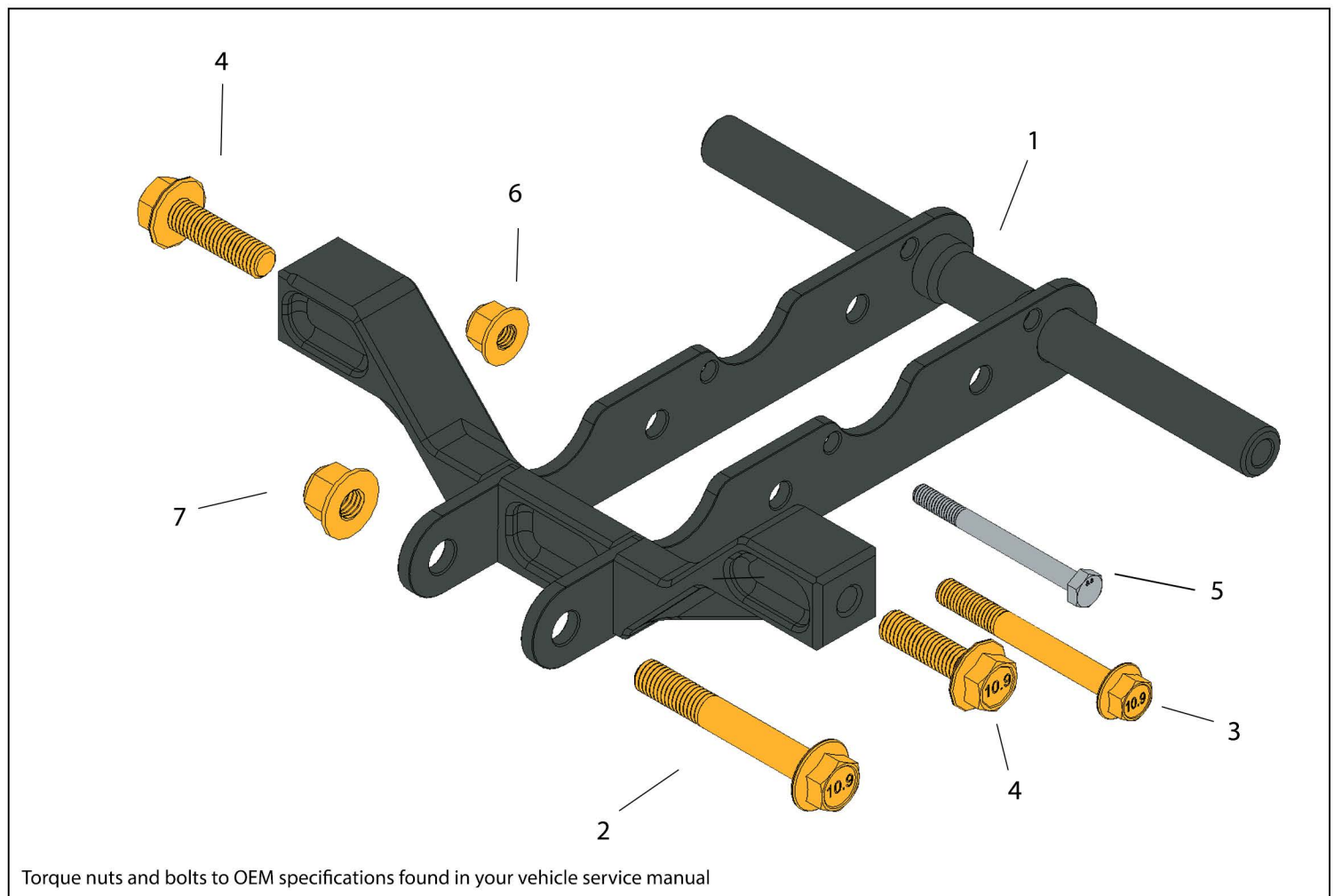

Torque nuts and bolts to OEM specifications found in your vehicle service manual



Important! Read all instructions carefully and double check your work. Failure to follow instructions may result in damage to suspension components. After installation is complete be sure to cycle the suspension through it's motion. We are not responsible for any damage that can occur from improper installation. We are not responsible for any damage that can occur from wear to shock surfaces or related components.

73-35-043-R 1 27/2023 SH

If in doubt, just ask!

The Gullwing Bracket is required for 128/129 applications. It installs directly in place of the OEM mounting Bracket.

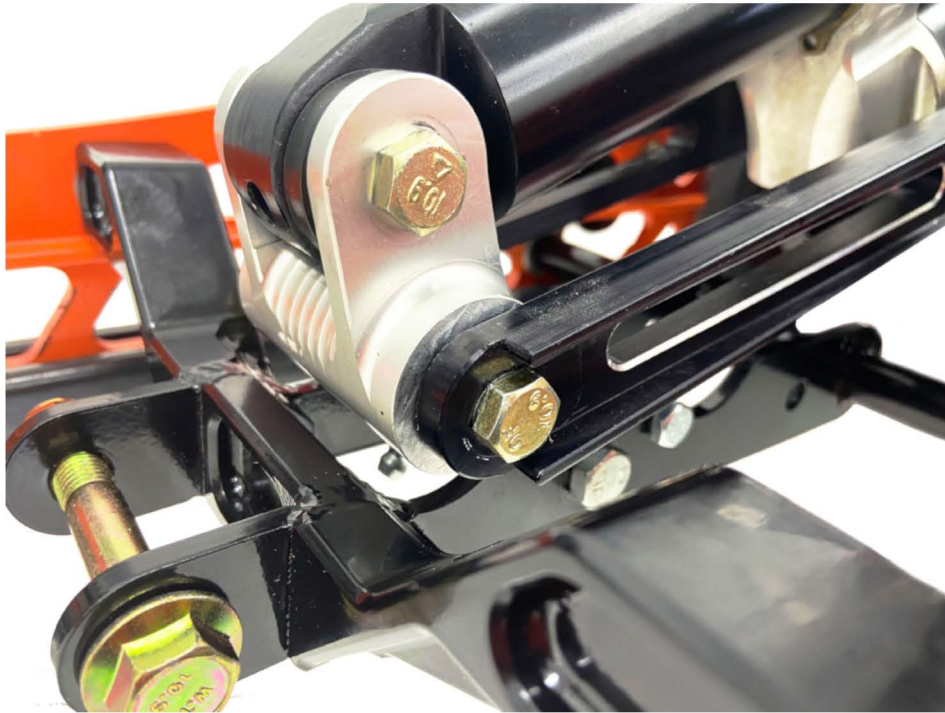

The bracket is needed to provide additional clearance for the cam pivot.



The Gullwing Bracket can also be used for 136/137 applications but not required.

The suspension will need to be removed from the vehicle for installation. We always recommend taking photos of your stock suspension to reference before removal of any components.



(OEM)

No modifications to frame and chassis components are needed. All idler wheels will maintain their original factory position.



Some OEM mounting hardware will need to be reused for installation.

Over Cam Bolt



With a factory length shock the linkage will over cam when the suspension is not installed into the chassis.

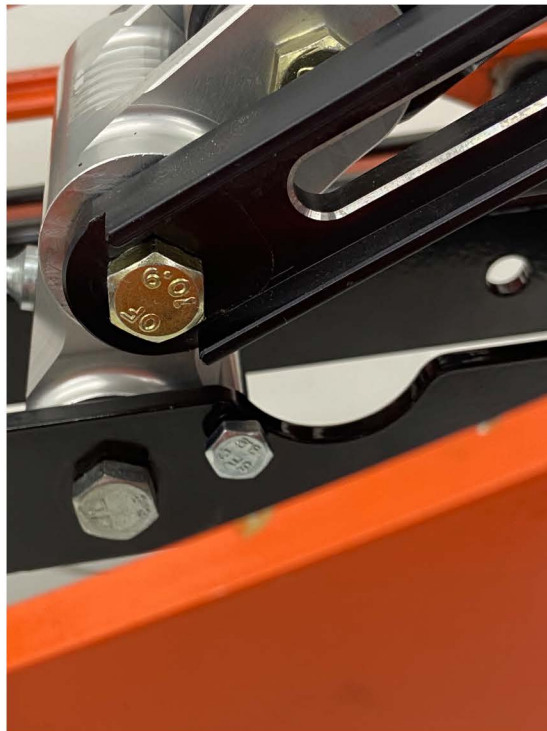

Movement can be restricted by installing a temporary stop (over cam bolt) This bolt needs to be removed once the suspension is installed or damage can occur.



See PN#73-35-042-R ProCC linkage instruction available on line for additional information.