

TBparts CRF110 Stage 2 Clutch Kit TBW1663

For ease of installation, we recommend following steps 1-3 first:

1. Drain the engine oil.
2. Remove peg bar and skid plate if equipped.
3. Move the rear brake pedal out of the way. Remove the kick starter too.

Now, with everything out of the way.

4. Start by taking the nut off the clutch adjuster bolt in the center of the clutch cover. This makes removing the cover easier.
5. COMPLETELY remove all 10 case bolts holding the clutch cover on.
6. Remove clutch the cover.
7. The clutch lifter cam will probably fall off while you remove the cover. If not remove that **(It is not reused)**.
8. Remove the clutch lever off the shift shaft. # 5 below.

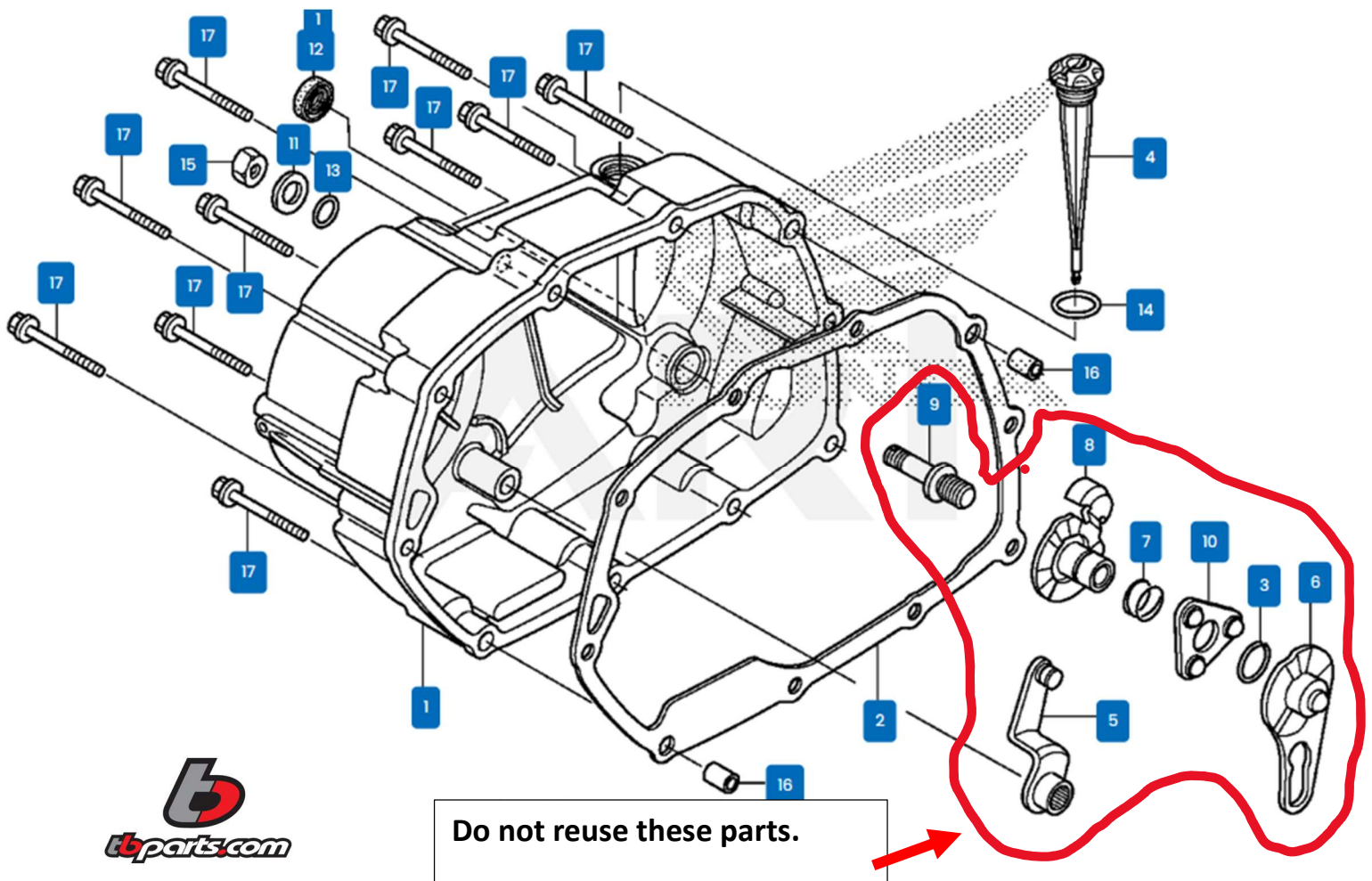

9. For ease of installation, we put the 2 dowel pins in on the engine side and hang the clutch cover gasket on them on the engine side. (Make sure all gasket surfaces are prepped)
10. Install the new clutch cover, everything comes installed except the pushrod/top hat. Be sure that is seated 100%.

We Include 2 clutch pushrods (The top hat looking piece) – The longer pushrod 14.5mm is for the shorter original OEM clutch. The shorter pushrod 13.5mm is for the taller TBparts HD clutch- TBW1599

11. Install supplied clutch cable bracket.

Some aftermarket exhaust may obstruct the cable bracket. If this is the case with your exhaust, you can simply bend the bracket to clear the exhaust. The cable bracket can be bent back to clear pipes after its bolted on the motor using a dead blow hammer or bend it off the motor in a vise with the same hammer.

12. This is a good time to route and install the clutch cable.

With the exhaust bolted on and in the way. It can be difficult to tighten the nuts on the clutch cable when tightening it to the clutch cable bracket. If you can bolt the cable to the bracket before you tighten the cable bracket down, you can avoid removing the exhaust.

13. Tighten all 10 bolts that hold the cover in place. 80 INCH LBS
14. Reinstall your peg bar, skid plate (if equipped), brakes, and kick starter. **Refill with the appropriate amount of wet clutch approved motorcycle oil.** (If you do not use wet clutch approved oil it will prematurely wear your clutch plates)
15. Install the clutch lever, then the new clutch cable into the lever, leave at least 1/8" of slack in cable.
16. Tighten all bolts on your lever and adjust it to your liking.
17. Turn your bars both ways to make sure your cable is not binding up anywhere. Avoid tight bends for a smooth pull.

