



ELITE SERIES REFRIGERATION

SERVING THE FOOD INDUSTRY SINCE 1951

37 CU. FT. TWO-SWING DOOR REFRIGERATION

Model: VRD37 Item 42862

Innovative two-door cooler combines a large display capacity with the maximum energy efficiency



Establishing a NEW STANDARD in the commercial refrigeration industry.

KEY FEATURES

- **BMAD refrigeration system,** allow to cool down the interior and maintain the temperature range with a minimum energy consumption.
- **30 gauge exterior pre-painted steel,** brings years of duration.
- **Electronic temperature controller,** assures an optimal performance of the cooler, making the product temperature ideal for its consumption.
- **High efficiency glass door,** with a double panel and a low-e film reduces the condensation. Self closing system allow the door to get back to its original position, taking care not to damage it.
- **LED lighting system,** uses a portion of the energy of regular fluorescent lights, and need no replacement for seven years.
- **CFC and HFC free Cyclopentane foam,** is eco-friendly and a high efficiency insulator.
- **Electronic fan motors,** allow a better performance, using only a portion of the energy required by a shaded pole motor.
- **Low maintenance condenser,** prevents dust from blocking air flow and thus saving energy and increasing compressor's life.



COMMERCIAL REFRIGERATOR
AND/OR FREEZER
9242



NSF/ANSI 7 COMMERCIAL REFRIGERATOR
AND/OR FREEZER
20YY



Authorized Dealer

ELITE SERIES REFRIGERATION

37 CU. FT. TWO-SWING DOOR REFRIGERATION

NELLA

PRODUCT DIMENSION

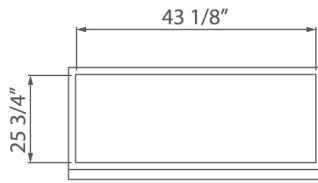

TOP VIEW

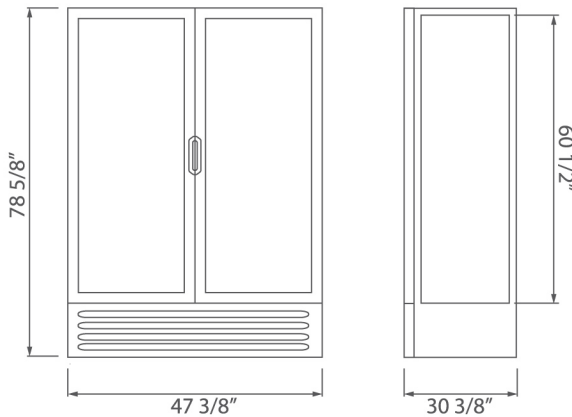

FRONT VIEW

SIDE VIEW

TECHNICAL SPECIFICATIONS

ITEM NUMBER	42862
MODEL	VRD37
DESCRIPTION	37 cu.ft. Two-Swing Door Refrigeration
VOLUME	37.4 ft ³ / 1059.6 liters
DOORS	2
SHELVES	10
SHELF SIZE	20 1/2" x 20 5/8" / 520mm x 524mm
CAPACITY	20 oz. - Total: 490 Front: 7 12 oz. - Total: 882
TEMPERATURE RANGE	0°C - 7°C / 32°F - 44.6°F
ENERGY CONSUMPTION	5.170 kWh/day*
ELECTRICAL	115 V / 60 Hz / 1 Ph
CORD LENGTH	118" / 3000 mm
HORSEPOWER	1/2
AMPS	10
WEIGHT	Gross: 445.3 lbs. / 202 kg. Crated: 449.7 lbs. / 204 kg.
INTERNAL DIMENSIONS (WDH)	43 1/8" x 25 3/4" x 60 1/2" / 1095 x 652 x 1537mm
DIMENSIONS (WDH)	47 3/8" x 30 3/8" x 78 5/8" / 1203 x 770 x 1997mm

* Energy consumption based on ANSI/ASHRAE Standard 72-2005.

OPTIONS

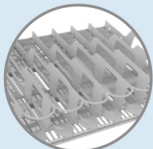

Gravity Kit



Casters

5'9" / 1790mm

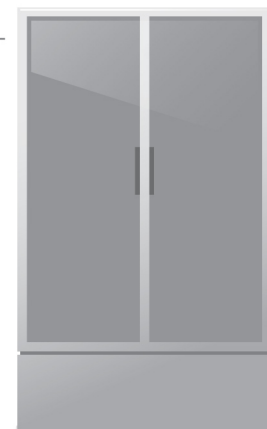
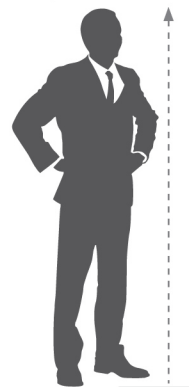

VRD 37



COMMERCIAL REFRIGERATOR
AND/OR FREEZER
9242



NSF/ANSI 7 COMMERCIAL REFRIGERATOR
AND/OR FREEZER
20YY

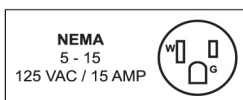

LIMITED
WARRANTY

3 YEAR PARTS AND LABOR
5 YEARS PARTS ONLY ON COMPRESSOR

BMAD System (Low maintenance high performance). Dimensions rounded up to the nearest inch or millimeter. Specifications subject to change without notice.

NELLA

Telephone: 416-740-2424
Email: help@nellaonline.com
Website: www.nellaonline.com