

SERVING THE FOOD INDUSTRY SINCE 1951

11.5 CU. FT. ONE-SWING DOOR REFRIGERATION

Model: VR12 Item 41217

*Most energy efficient cooler in its category.
Specifically designed for convenience stores
and supermarkets*



Establishing a NEW STANDARD in
the commercial refrigeration industry.

KEY FEATURES

- **BMAD Refrigeration System**
Ensures rapid and effective cabinet cool down and maintains consistent temperature range with minimum energy consumption
- **Electronic Temperature Controller**
Assures the optimal performance of the cooler, delivering product temperature ideal for consumption.
- **High Efficiency Glass Door**
Equipped with double panel glass and low-e film to reduce condensation. Door hinge is equipped with a self-closing system to ensure the door closes safely, and returns to original position, without any damages.
- **LED Lighting System**
Our LED system uses a fraction of the energy of regular fluorescent lights and requires no replacement for up seven years.
- **CFC and HFC Free Cyclopentane Foam**
Eco-friendly, recyclable and high efficiency cabinet insulation.
- **Electronic Fan Motors**
Enhances performance and efficiency. Uses only a fraction of the energy than industry standard shaded-pole motor requires. Longer lifespan fan motor.
- **Low Maintenance Condenser**
Imbera's finless condenser designed to minimize maintenance. Drastically reduces Total Cost of Ownership. Prevents dust that blocks air flow, to save energy and extend the life of the compressor.



COMMERCIAL REFRIGERATOR
AND/OR FREEZER
9242



NSF/ANSI 7 COMMERCIAL REFRIGERATOR
AND/OR FREEZER
20YY



Authorized Dealer

ELITE SERIES REFRIGERATION

11.5 CU. FT. SWING DOOR REFRIGERATION

NELLA

PRODUCT DIMENSION

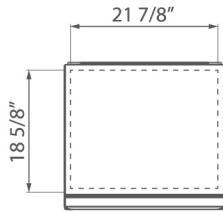

TOP VIEW

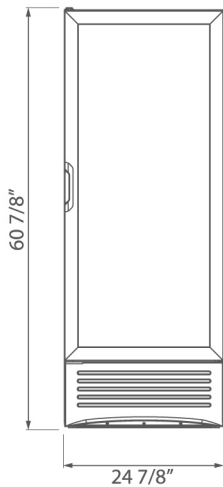

FRONT VIEW

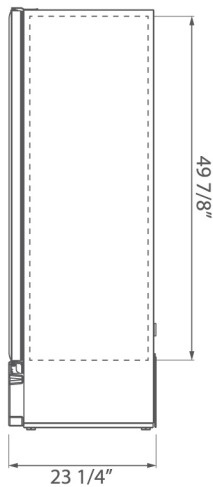

SIDE VIEW

TECHNICAL SPECIFICATIONS

ITEM NUMBER	41217
MODEL	VR12
DESCRIPTION	11.5 cu.ft. One-Swing Door Refrigeration
VOLUME	11.5 ft ³ / 328.2 liters
DOORS	1
SHELVES	4
SHELF SIZE	20 7/8" x 17 3/8" / 530mm x 440mm
CAPACITY	20 oz. - Total: 168 Front: 6 Gravity: 144 12 oz. - Total: 384
TEMPERATURE RANGE	0°C - 7°C / 32°F - 44.6°F
ENERGY CONSUMPTION	2.390 kWh/day*
ELECTRICAL	115 V / 60 Hz / 1 Ph
CORD LENGTH	118" / 3000 mm
HORSEPOWER	1/6
AMPS	4.0
WEIGHT	Gross: 183 lbs. / 83 kg. Crated: 187.4 lbs. / 85 kg.
INTERNAL DIMENSIONS (WDH)	21 7/8" x 18 5/8" x 49 7/8" / 555 x 472 x 1266mm
DIMENSIONS (WDH)	24 7/8" x 23 1/4" x 63 5/8" / 632 x 590 x 1616mm

* Energy consumption based on ANSI/ASHRAE Standard 72-2005.

OPTIONS

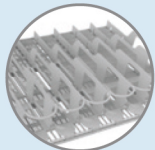

Gravity Kit



Casters



COMMERCIAL REFRIGERATOR
AND/OR FREEZER
9242



NSF/ANSI 7 COMMERCIAL REFRIGERATOR
AND/OR FREEZER
20YY



5'9" / 1790mm

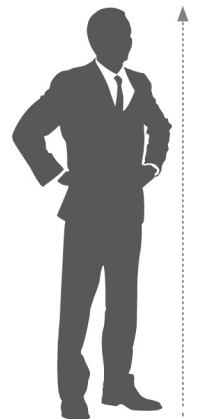

VR 12

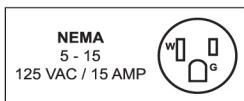

LIMITED WARRANTY
3 YEAR PARTS AND LABOR
5 YEARS PARTS ONLY ON COMPRESSOR

BMAD System (Low maintenance high performance). Dimensions rounded up to the nearest inch or millimeter. Specifications subject to change without notice.

NELLA

Telephone: 416-740-2424
Email: help@nellaonline.com
Website: www.nellaonline.com