



## ELITE SERIES REFRIGERATION

SERVING THE FOOD INDUSTRY SINCE 1951

### 7.7 CU. FT. SWING DOOR REFRIGERATION

Model: VR08 Item 41215

*Great idea to keep products cold for kitchens  
with minimum space*



Establishing a NEW STANDARD in  
the commercial refrigeration industry.

#### KEY FEATURES

- **BMAD refrigeration system**, allow to cool down the interior and maintain the temperature range with a minimum energy consumption.
- **30-gauge exterior pre-painted steel**, brings years of duration.
- **Electronic temperature controller**, assures an optimal performance of the cooler, making the product temperature ideal for its consumption.
- **High efficiency glass door**, with a double panel and a low-e film reduces the condensation. Self closing system allow the door to get back to its original position, taking care not to damage it.
- **LED lighting system**, uses a portion of the energy of regular fluorescent lights, and need no replacement for seven years.
- **CFC and HFC free Cyclopentane foam**, is eco-friendly and a high efficiency insulator.
- **Electronic fan motors**, allow a better performance, using only a portion of the energy required by a shaded pole motor.
- **Low maintenance condenser**, prevents dust from blocking air flow and thus saving energy and increasing compressor's life.



COMMERCIAL REFRIGERATOR  
AND/OR FREEZER  
9242



NSF/ANSI 7 COMMERCIAL REFRIGERATOR  
AND/OR FREEZER  
20YY



Authorized Dealer

# ELITE SERIES REFRIGERATION

7.7 CU. FT. SWING DOOR REFRIGERATION

# NELLA

## PRODUCT DIMENSION

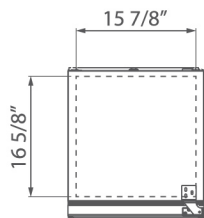

TOP VIEW

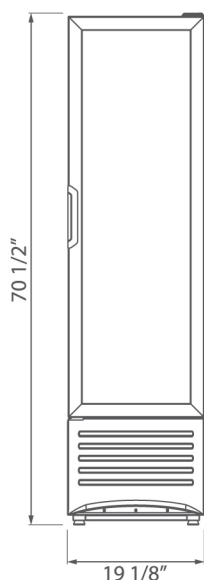

FRONT VIEW

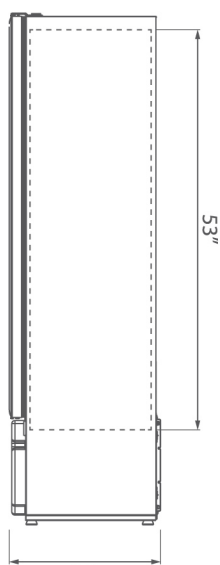

SIDE VIEW

## TECHNICAL SPECIFICATIONS

ITEM NUMBER	41215
MODEL	VR08
DESCRIPTION	7.7 cu.ft. Swing Door Refrigeration
VOLUME	7.7 ft³ / 220 liters
DOORS	1
SHELVES	5
SHELF SIZE	15 1/8" x 14 5/8" / 384mm x 371mm
CAPACITY	20 oz. - Total: 100 Front: 5 12 oz. - Total: 200
TEMPERATURE RANGE	0°C - 7°C / 32°F - 44.6°F
ENERGY CONSUMPTION	2.120 kWh/day*
ELECTRICAL	115 V / 60 Hz / 1 Ph
CORD LENGTH	118" / 3000 mm
HORSEPOWER	1/6
AMPS	3.0
WEIGHT	Gross: 163.1 lbs. / 74 kg. Crated: 173.7 lbs. / 78.8 kg.
INTERNAL DIMENSIONS (WDH)	15 7/8" x 16 5/8" x 53" / 404 x 422 x 1346mm
DIMENSIONS (WDH)	19 1/8" x 21" x 70 1/2" / 485 x 533 x 1792mm

\* Energy consumption based on ANSI/ASHRAE Standard 72-2005.



**LIMITED WARRANTY**  
3 YEAR PARTS AND LABOR  
5 YEARS PARTS ONLY ON COMPRESSOR



COMMERCIAL REFRIGERATOR  
AND/OR FREEZER  
9242



NSF/ANSI 7 COMMERCIAL REFRIGERATOR  
AND/OR FREEZER  
20YY

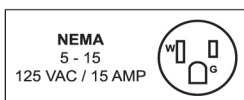

5'9" / 1790mm



VR 08

BMAD System (Low maintenance high performance). Dimensions rounded up to the nearest inch or millimeter. Specifications subject to change without notice.

# NELLA

Telephone: 416-740-2424  
Email: [help@nellaonline.com](mailto:help@nellaonline.com)  
Website: [www.nellaonline.com](http://www.nellaonline.com)