

# SALAD/SANDWICH PREP TABLE

*Signature Series*

NPT-072-SA



## FEATURES



Temperature range (°C): 0.5-5



Natural refrigerant promotes faster cool down and efficient energy consumption



20 clear plastic pans included



Insulated lid maintains food freshness



Digital temperature control



Stainless steel interior and exterior



Adjustable heavy duty shelves



Back mounted compressor

# SPECIFICATIONS

Capacity (Cubic Feet)	17.6
Capacity (Litres)	499
Exterior Unit Dimensions (in)	72.5" (w) x 31.5" (d) x 44" (h)
Exterior Unit Dimensions (cm)	184 (w) x 80 (d) x 112 (h)
Shipping Dimensions with Box (in)	74" (w) x 33" (d) x 50.75" (h)
Shipping Dimensions with Box (cm)	188 (w) x 84 (d) x 129 (h)
Net Weight	341lbs (154.5 kg)
Gross Weight	454lbs (206 kg)
Type of Defrost	Automatic
Cutting Board Included	1
Plastic Pan Dimensions	1/6 PAN   6.93" x 6.38" x 5.91"
Swivel Casters	Yes (3 with brakes)
Adjustable Shelves	3
Voltage	115V/60Hz
Input Power	380
Amperes	3.4
Temperature	0.5-5 °C
Refrigerant (CFC-Free)	R290
Compressor	Embraco (1/4 HP)
Plug Type	Nema 5-15P



**Warranty** 3 years parts and labour,  
2 additional years on the compressor



## REGULAR TOP | 20 X 1/6 PAN

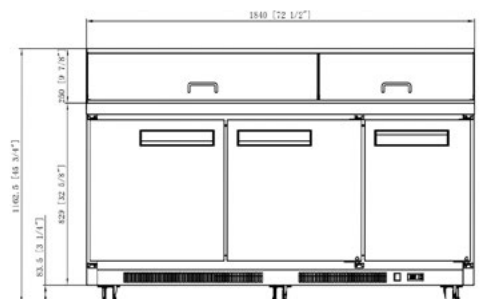
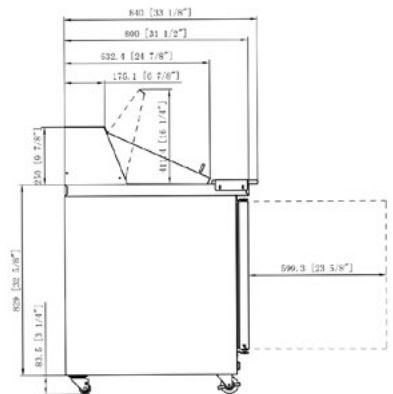

DESIGN AND SPECIFICATIONS CAN CHANGE WITHOUT PRIOR NOTICE FOR PRODUCT IMPROVEMENT