

## 49-INCH HEAVY DUTY GLASS DOOR BOTTLE COOLERS

Serial No.:456516275005800  
Model No.:100-845616



### KEEP BEVERAGES CHILLED AND READY TO SERVE

Perfect for any restaurant and/or bar, the heavy duty glass door bottle coolers are designed with enduring quality and value. The exterior comprises of attractive corrosion resistant vinyl on steel in black finish. Electronic control system makes it easy to adjust temperature set point and defrost frequency.



<https://www.nellaonline.com/products/nella-49-glass-2-door-back-bar-cooler-50058>



### WARRANTY

2 YEARS PARTS & LABOR  
5 YEARS ONLY ON COMPRESSOR

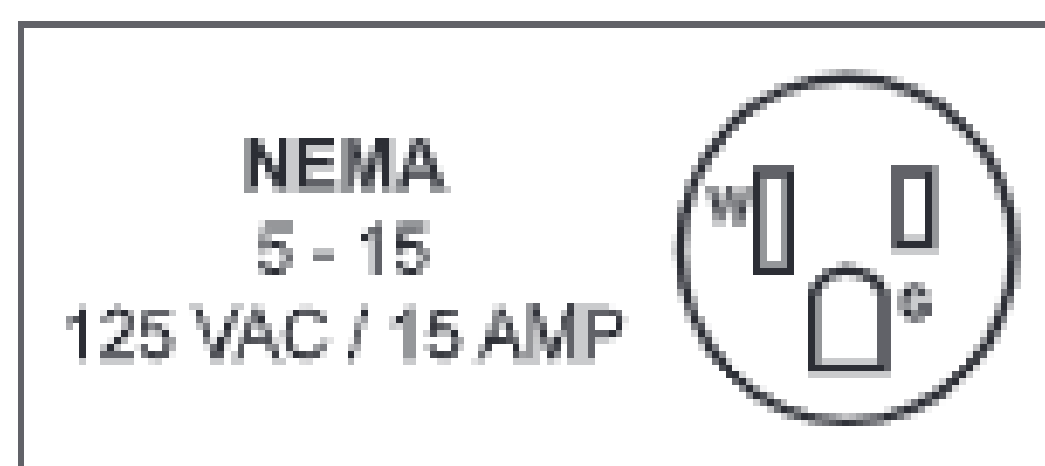

Authorized Dealer

## 49-INCH HEAVY DUTY GLASS DOOR BOTTLE COOLERS

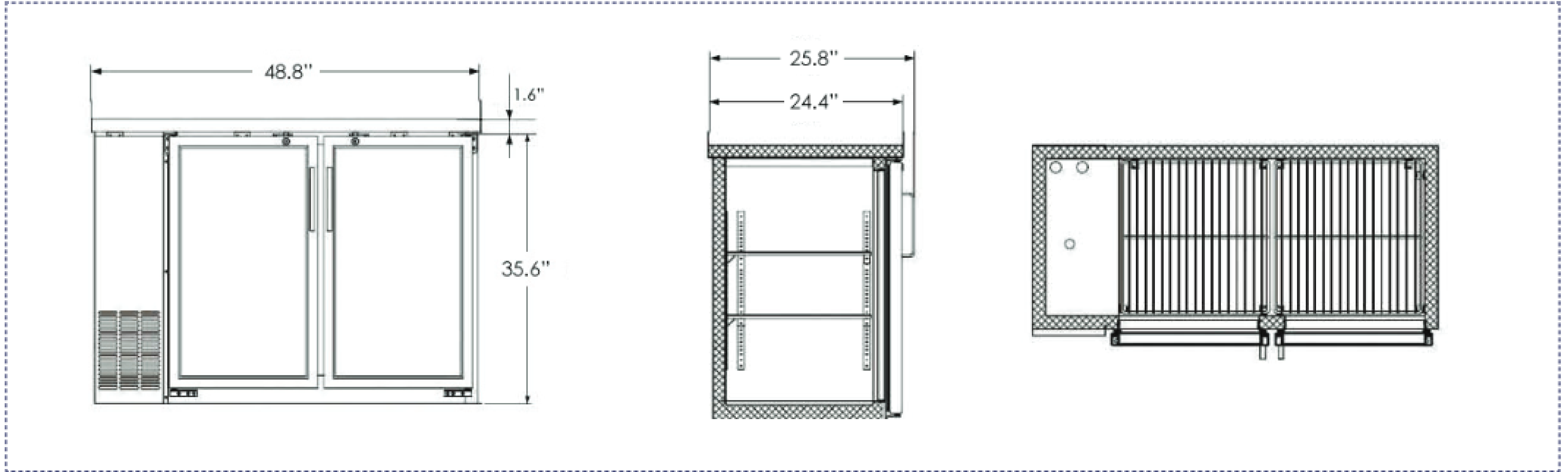

### FEATURES

- Durable stainless steel top, interior walls, floor and ceiling
- Exterior construction is attractive corrosion resistant vinyl on steel in black finish
- Temperature range from 0-5°C and 0°F / 33-41°F
- Self-closing doors with locks
- LED interior lighting
- Adjustable heavy-duty PVC coated shelves
- Electric control system makes it easy to adjust temperature set point and defrost frequency

### TECHNICAL SPECIFICATIONS

Model No.:100-845616

Description	49-inch heavy duty glass door bottle cooler
Power	1/5 HP
Product Capacity	672 - 12 oz. 2 - kegs 384 - 12 oz. Bottles
Number of Doors	2
Temperature Range	33°F - 41°F / 0.5°C - 5°C
Capacity	11.8 cu. ft. / 335 L
Number of Shelves	4
Electrical	115V / 60Hz / 1Ph
Amps	2.88
Refrigerant	R290
Dimensions (DWH)	48.8" x 24.4" x 35.6" 1240 x 620 x 905 mm
Interior Dimensions	36 1/4" x 18 1/2" x 30 1/2" 920 x 470 x 775 mm
Packaging Dimensoins	51 1/8" x 27 4/8" x 42 3/8" 1300 x 700 x 1075 mm
Weight	98 kg. / 216 lbs.
Packaging Weight	118 kg. / 260 lbs.