

FOOD MACHINERY

1-HP TABLETOP BAND SAW



The BS-VE-1981-E features a sliding table on a four wheel carriage base which allows for ease in cutting

*Product Might Not Be Exactly As Shown



EMERGENCY STOP BUTTON



MADE IN VENEZUELA

NEMA
5 - 15R
125 VAC / 15 AMP
RECEPTACLE



1 YEAR

1 YEAR
WARRANTY
PARTS AND LABOUR

1-HP TABLETOP BAND SAW

TECHNICAL DRAWINGS WITH DETAILED DIMENSIONS

It features a four wheel carriage base. This saw is ideal for small to medium applications. Easy to disassemble for quick cleaning and maintenance.

Fabricated in steel with electrostatic oven paint, complete with an aluminum head. Its stainless steel table has a four-wheel base that slides on rails

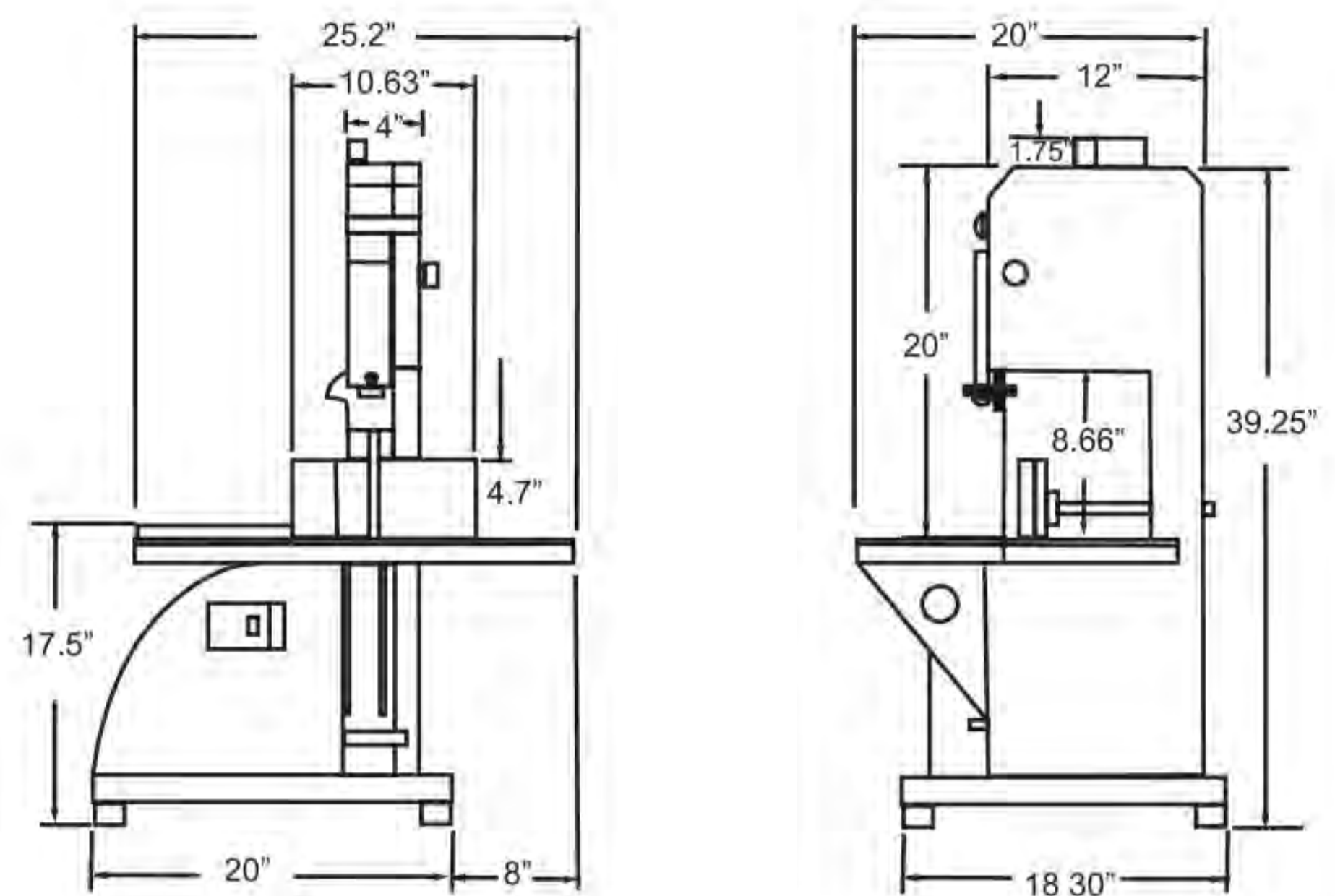

TECHNICAL SPECIFICATIONS

BLADE LENGTH	78" / 1981 mm
CUTTING CAPACITY (H*W)	7.75" x 7.5" / 197 x 190.5 mm
POWER	1 HP / 0.75 kW
ELECTRICAL	110V/60Hz/1
WEIGHT	248 lbs. / 112.73 kg.
PACKAGING WEIGHT	287 lbs. / 130.45 kg
PACKAGING DIMENSIONS	26" x 32" x 46" / 660 x 812.8 x 1168 mm



WWW.NELLAONLINE.COM
HELP@NELLAONLINE.COM

LOCATIONS

**148 NORFINCH DR
NORTH YORK, ON,
M3N 1X8
416-740-2424**

**433 QUEEN ST E.
TORONTO, ON,
M5A 1T5
416-847-1112**

**1164 ELLESMERE ROAD
SCARBOROUGH, ON,
M3N 1X8
416-292-0828**