

QS20 COLLAPSIBLE CHIMNEY STARTER

To Assemble:

1. Open flat chimney starter.
2. Secure inner grate.
3. Hook helper handle to chimney starter.

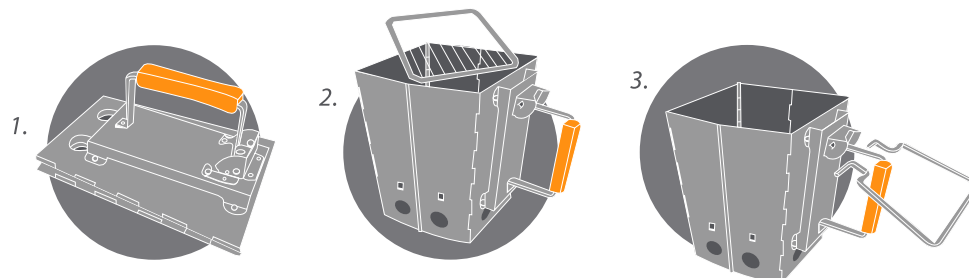

To Use:

1. Assemble product fully.
2. Place crumpled newspaper in bottom of chimney.
3. Place chimney on center of charcoal grate.
4. Fill chimney with charcoal.
5. Light crumpled newspaper through holes in bottom of chimney.
6. Allow coals to heat for 10-15 minutes.
7. Use caution when pouring hot coals into grill.
8. Allow chimney to cool before placing in a safe non-combustible area away from children.

