

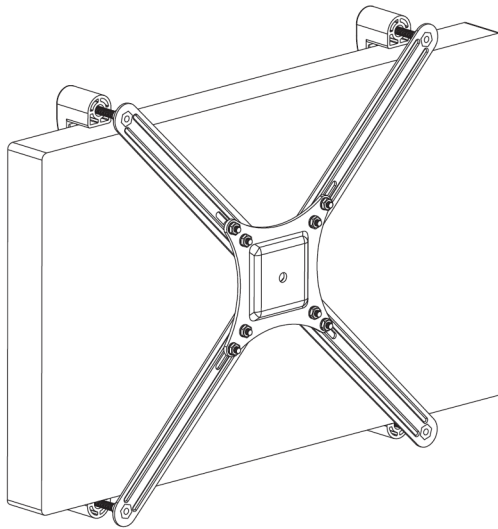

VESA Adapter Bracket Kit

Instruction Manual



SKU: STAND-VAD1



Scan the QR code with your mobile device or follow the link for helpful videos and specifications related to this product.

<https://vivo-us.com/products/stand-vad1>

GET IN TOUCH | Monday-Friday from 7:00am-7:00pm CST



help@vivo-us.com



www.vivo-us.com
Chat live with an agent!



309-278-5303

WARNING!

If you do not understand these directions, or if you have any doubts about the safety of the installation, please call a qualified technician. Check carefully to make sure there are no missing or defective parts. Improper installation may cause damage or serious injury. Do not use this product for any purpose that is not explicitly specified in this manual. Do not exceed weight capacity. We cannot be liable for damage or injury caused by improper mounting, incorrect assembly or inappropriate use.

WARNING: CHOKING HAZARD

SMALL PARTS - NOT FOR CHILDREN UNDER 3 YEARS. ADULT SUPERVISION IS REQUIRED.

PACKAGE CONTENTS



A (x4)
Bracket Arm



B (x4)
"L" Support



C (x4)
Plastic Cover



D (x8)
M4x12



E (x8)
M4 Nut



F (x8)
M4 Washer



G (x4)
M6x50

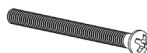

H (x4)
M6x75



I (x6)
Rubber
Spacer

TOOLS NEEDED



**Phillips
Screwdriver**



Wrench

DO NOT EXCEED WEIGHT CAPACITY.

Failure to do so may result in serious injury.

**22lbs
(9.98kg)**

ASSEMBLY STEPS

PRE-ASSEMBLY

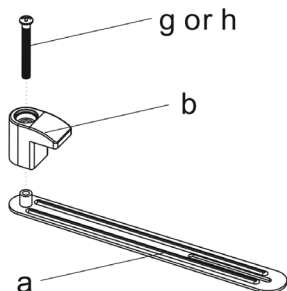

STEP 1

OPTION A

Install arms to your VESA mount in one of the three patterns shown (depending on the size and shape of your monitor) using M4x12 Bolts (**D**), Washers (**F**), and Nuts (**E**). Tighten nuts and screws using a wrench and screwdriver respectively for only the lower two Bracket Arms (**A**) at this time. If needed, use rubber spacers (**I**) to better fit slim monitors. Up to 3 spacers may be stacked on each side to fit very slim monitors.

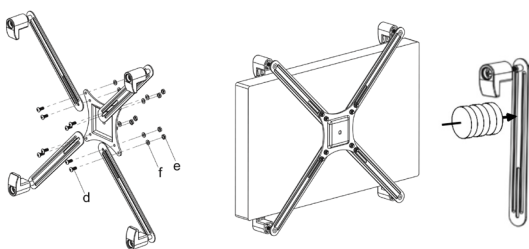

OPTION B

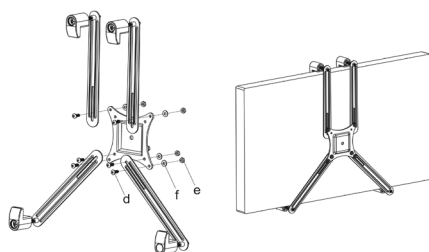

OPTION C

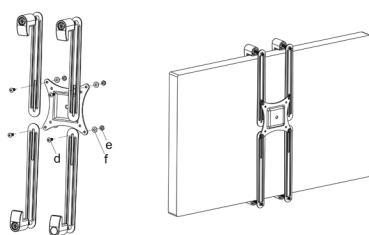

STEP 2

With all supports facing up, place monitor on lower two "L" Supports (**B**) and tighten lower two screws. Slide top two bracket arms down until the supports rest on the monitor. Remove the monitor and tighten the nuts for the top two bracket arms. Place the monitor back on the supports, rotate the top two supports down over the monitor, and tighten the screws. Install covers (**C**) on "L" Supports.

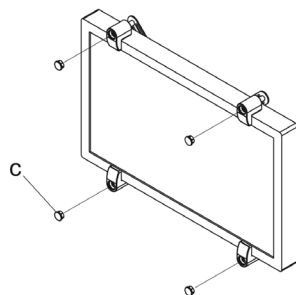
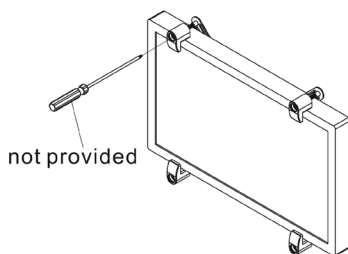
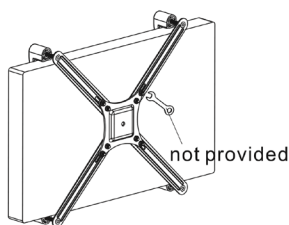



Love your new VIVO setup and want to share?
Tag us in your photo! **@vivo_us**

LAST UPDATED: 03/06/2020



Open **Monday - Friday 7:00am - 7:00pm CST**,
our dedicated support team can offer immediate assistance with rapid response times. If any parts are received damaged or defective, please contact us. We are happy to replace parts to ensure you have a fully functioning product.



help@vivo-us.com

AVG. RESPONSE TIME *(within office hrs): 1HR 8M*

- 23% within < 15m
- 38% within < 30m
- 61% within < 1hr
- 83% within < 2hr
- 92% within < 3hr



www.vivo-us.com
Chat live with an agent!

AVG. RESOLUTION TIME *(within office hrs): < 15 M*



309-278-5303

AVG. RESOLUTION TIME *(within office hrs): 5M 4S*

FOR MORE VIVO PRODUCTS, CHECK OUT OUR WEBSITE AT: www.vivo-us.com