

# Dual Ultrawide Vertical Monitor Desk Mount

SKU: STAND-V202T  
Instruction Manual

---

Assembly Video & Product Info  
[www.vivo-us.com/products/stand-v202t](http://www.vivo-us.com/products/stand-v202t)



[ THIS PAGE INTENTIONALLY LEFT BLANK ]

## ⚠ CAUTION! ⚠

If you do not understand these directions, or if you have any doubts about the safety of the installation, please contact our product support team at 309-278-5303 or [help@vivo-us.com](mailto:help@vivo-us.com) for further assistance. Check carefully to make sure there are no missing or defective parts. Improper installation may cause damage or serious injury. Do not use this product for any purpose that is not explicitly specified in this manual. Do not exceed weight capacity. We cannot be liable for damage or injury caused by improper mounting, incorrect assembly or inappropriate use.



### WARNING: CHOKING HAZARD

SMALL PARTS - NOT FOR CHILDREN UNDER 3 YEARS. ADULT SUPERVISION IS REQUIRED.



### DO NOT EXCEED WEIGHT CAPACITY

FAILURE TO DO SO MAY RESULT IN SERIOUS INJURY.

---

## We're Here for You

Open **Monday - Friday 7:00am - 7:00pm** CST,

our dedicated support team can offer immediate assistance with rapid response times. If any parts are received damaged or defective, please contact us. We are happy to replace parts to ensure you have a fully functioning product.



Give us a Call:  
**309-278-5303**

AVG. RESOLUTION TIME (*within office hrs*): **5M 4S**



Chat Us:  
**[www.vivo-us.com](http://www.vivo-us.com)**

AVG. RESOLUTION TIME (*within office hrs*): **< 15 M**



Email Us:  
**[help@vivo-us.com](mailto:help@vivo-us.com)**

AVG. RESPONSE TIME (*within office hrs*): **1HR 8M**

- 23% within < 15m
- 38% within < 30m
- 61% within < 1hr
- 83% within < 2hr
- 92% within < 3hr

## Package Contents

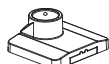

**A** (x1)  
Base

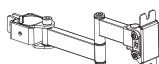

**B** (x2)  
Arm



**C** (x1)  
Lower Pole



**D** (x1)  
Upper Pole



**E** (x2)  
VESAs Plate



**F** (x2)  
Cable Clip



**G** (x1)  
Clamp Plate



**H** (x1)  
Grommet Plate



**I** (x1)  
Soft Pad



**J** (x1)  
Cover



**K** (x1)  
Clamp Brace



**L** (x1)  
Lower Clamp



**M** (x2)  
Pole Cable Clip

---

## Included Hardware & Tools



**S-A** (x4)  
Wing Nut



**S-B** (x4)  
M6x12mm Screw



**M-A** (x8)  
M4x14mm Screw



**M-B** (x8)  
M4x25mm Screw



**M-C** (x8)  
M5x14mm Screw



**M-D** (x8)  
M5x25mm Screw



**M-F** (x16)  
Spacer



**M-E** (x8)  
M5 Washer



**T-A** (x1)  
4mm Allen Wrench



**T-B** (x1)  
6mm Allen Wrench



**T-C** (x1)  
Wrench

---

## Tools Needed:



**Phillips  
Screwdriver**

## Weight Capacity:



## ASSEMBLY STEPS

### STEP 1a

#### Option A - Clamp

Connect Clamp Brace (**K**) to Base (**A**) using M6x12mm Screws (**S-B**) and 4mm Allen Wrench (**T-A**).

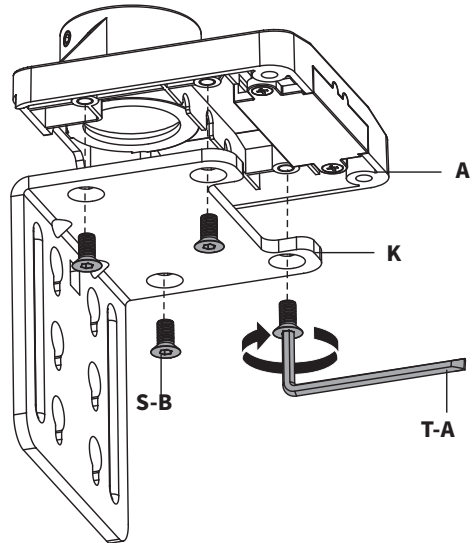

Remove protective film from Soft Pad (**I**) and apply to the underside of Clamp Brace (**K**).

Loosen the screws on the back of Lower Clamp (**L**) using 4mm Allen Wrench (**T-A**), leaving 6mm of thread exposed.

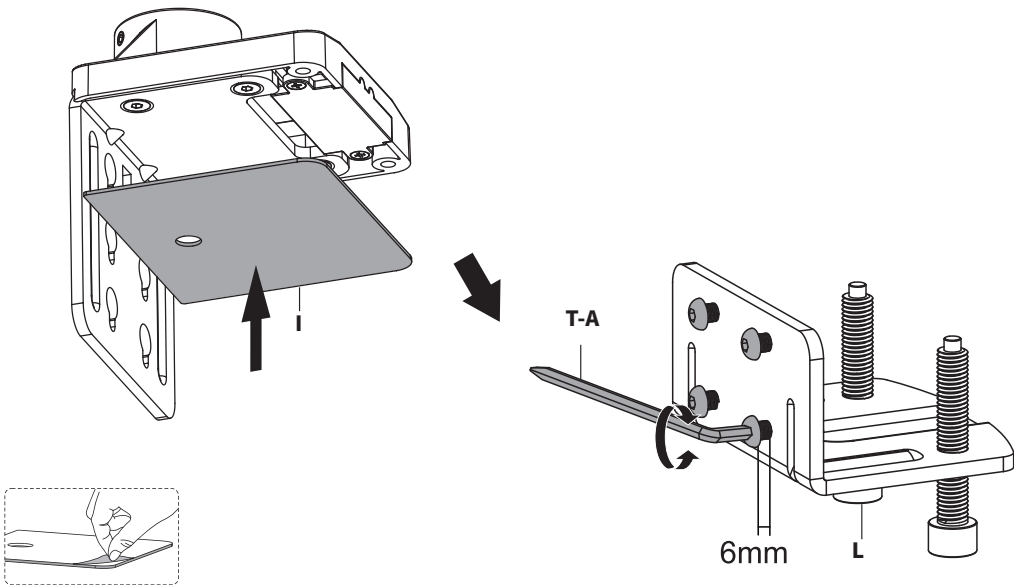

## Option A - Clamp - Cont'd

0.4" to 2.25" (10mm-58mm)  
Desktop Thickness

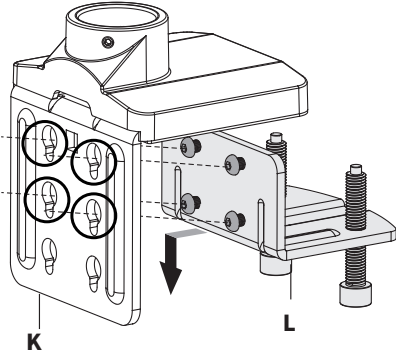

Slide Lower Clamp (**L**) into the top 4 slots on Clamp Brace (**K**).

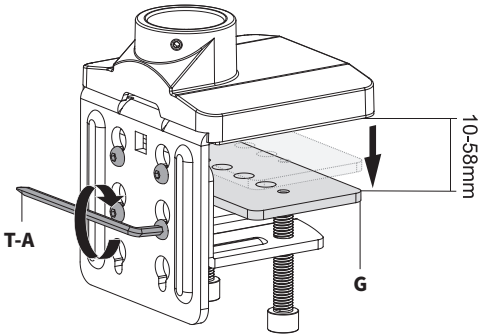

Tighten rear screws with 4mm Allen Wrench (**T-A**).

Place Clamp Plate (**G**) on top of the clamp bolts on Lower Clamp (**L**).

2" to 3.35" (50mm-85mm)  
Desk Thickness

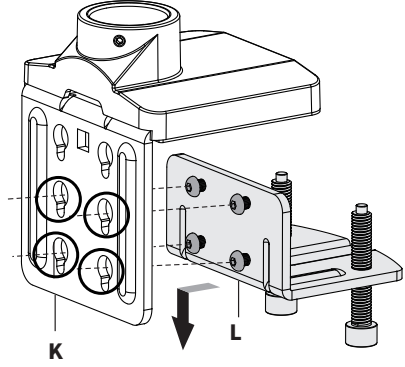

Slide Lower Clamp (**L**) into the lower 4 slots on Clamp Brace (**K**).

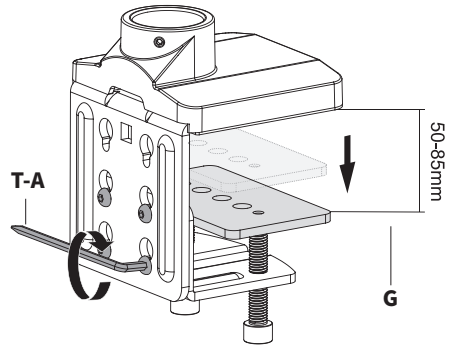

Tighten rear screws with 4mm Allen Wrench (**T-A**).

Place Clamp Plate (**G**) on top of the clamp bolts on Lower Clamp (**L**).

## Option A - Clamp - Cont'd

Install clamp assembly to desk and tighten clamp bolt using 6mm Allen Wrench (**T-B**).

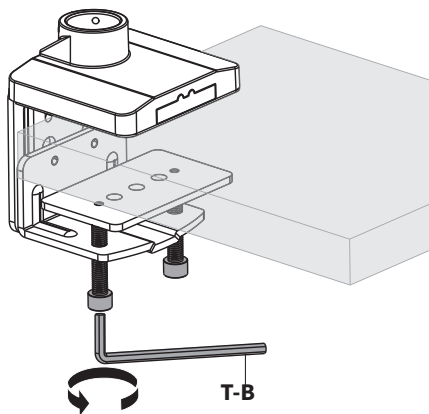

Snap Cover (**J**) onto the back of assembled base.

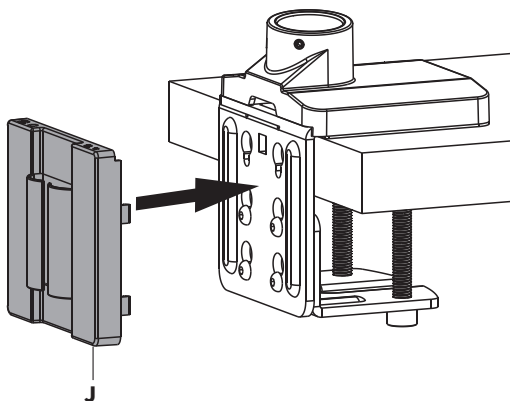

**Proceed to STEP 2 on pg 8**

## STEP 1b

### Option B - Grommet

Attach Grommet Plate (**H**) to Base (**A**) using M6x12mm Screws (**S-B**) and 4mm Allen Wrench (**T-A**). Remove protective film from Soft Pad (**I**) and apply to the underside of Grommet Plate (**H**).

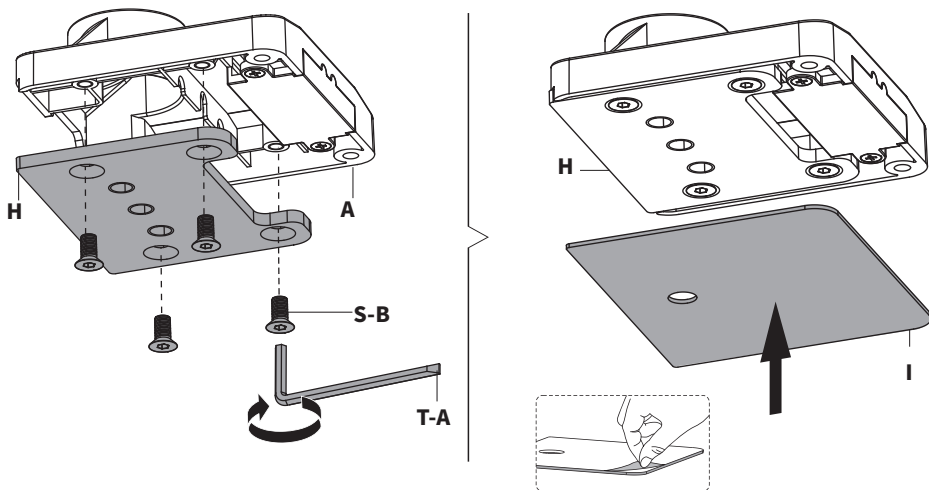

Position Base (**A**) over grommet hole in desk.

Remove a single clamp bolt from Lower Clamp (**L**) using 6mm Allen Wrench (**T-B**). Insert clamp bolt with Clamp Plate (**G**) through the underside of the desk and secure to Base (**A**) using 6mm Allen Wrench (**T-B**).

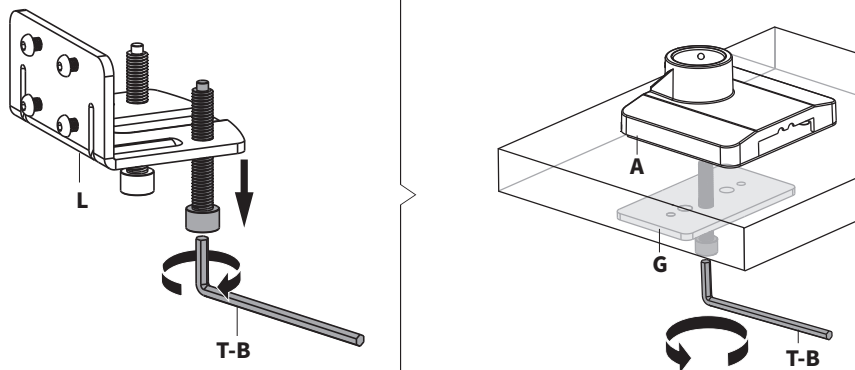

Proceed to STEP 2 on pg 8



#### No Grommet Hole?

If you do not have an existing hole for installation, drill a hole through your desktop in your desired mounting location using a 0.375" (10mm) drill bit.



## STEP 2

Screw Lower Pole (C) into Base (A), and tighten set screws using 4mm Allen Wrench (T-A). Slide Pole Cable Clip (M) onto Lower Pole (C).

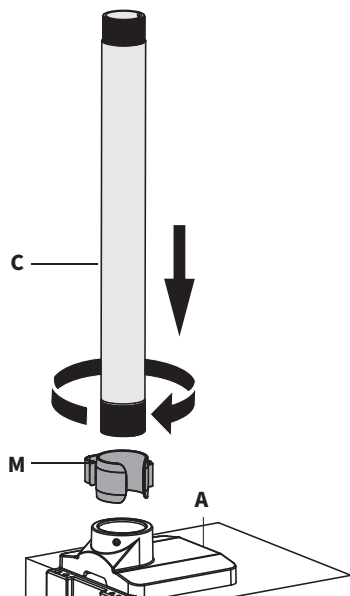
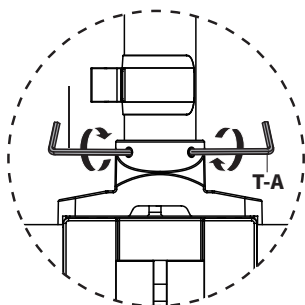

## STEP 3

Slide one Arm (B) onto Lower Pole (C) and secure using 6mm Allen Wrench (T-B).

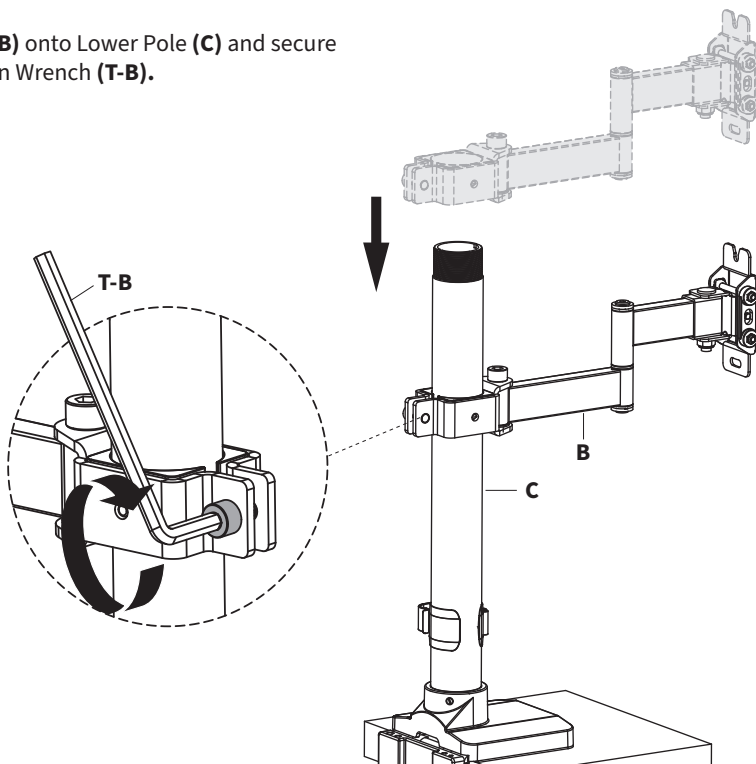

## STEP 4

Thread Upper Pole (**D**) onto Lower Pole (**C**).  
Attach Pole Cable Clip (**M**) to Upper Pole (**D**).

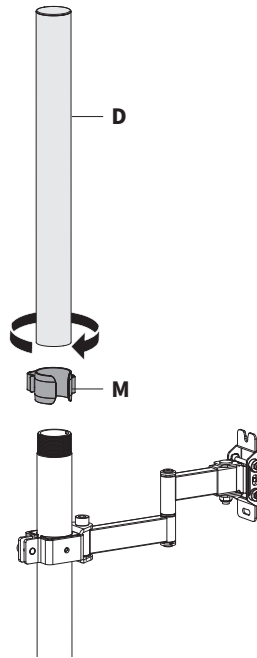

Slide remaining Arm (**B**) onto Upper Pole (**D**) and tighten to the pole using 6mm Allen Wrench (**T-B**). Attach Cable Clips (**F**) to Arms (**B**).

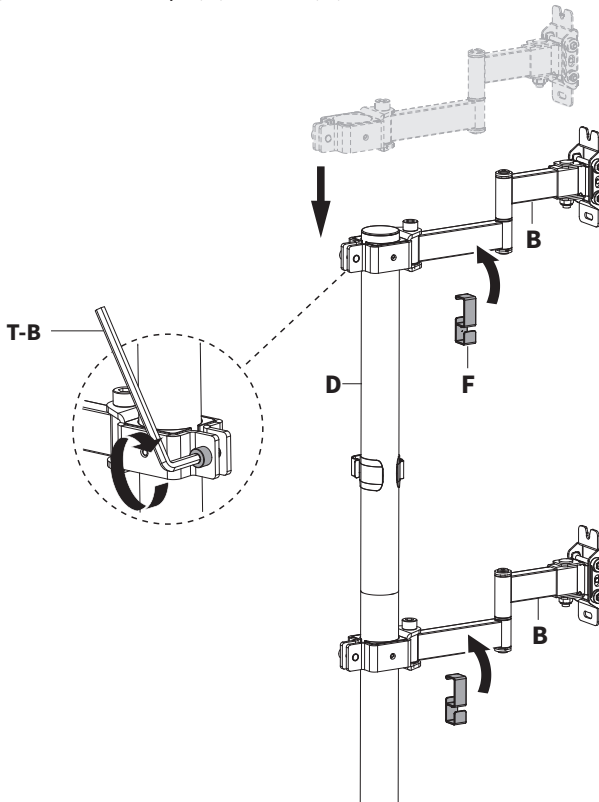

## Securing VESA Plate to Monitors

### Flat Back Monitors

Install VESA Plate (**E**) to your monitor using appropriate Screws (**M-A thru M-D**), M5 Washer (**M-E**) and a Phillips screwdriver. If needed, Spacers (**M-F**) are provided.

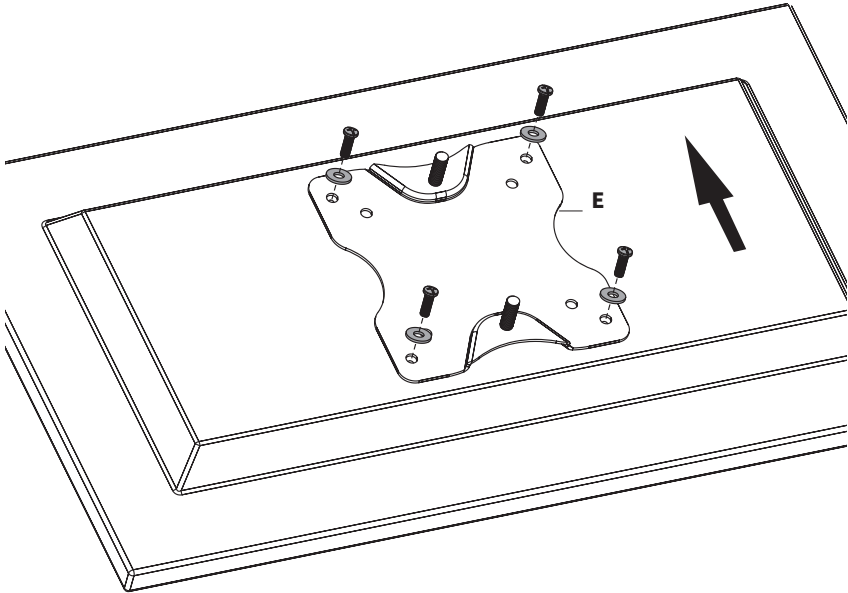

### Mounting Hardware Combinations

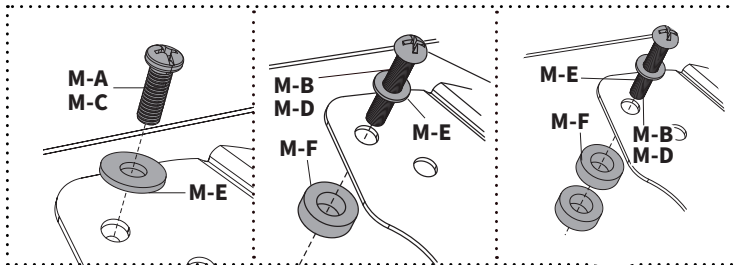

## Recessed Mounting Pocked & Curved Screens

Install VESA Plate (**E**) to your monitor using appropriate Screws (**M-A thru M-D**), M5 Washer (**M-E**), Spacers (**M-F**), and a Phillips screwdriver.

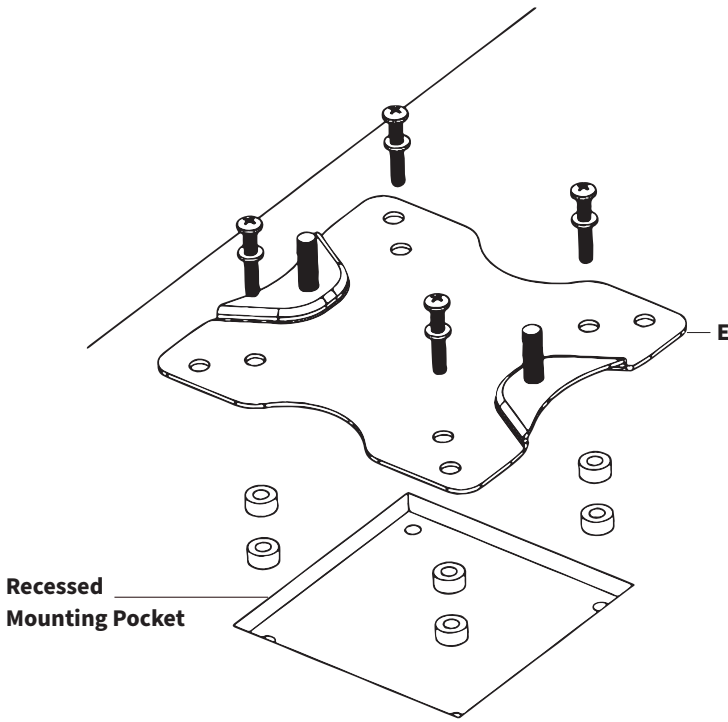

## Mounting Hardware Combinations

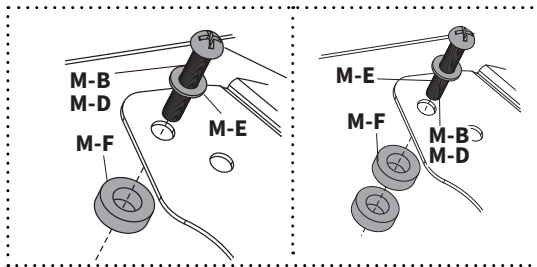

## STEP 6

Partially install one Wing Nut (**S-A**) to the top screw on VESA Plate (**E**) on monitor and hang over the slot in the top of Arm (**B**).

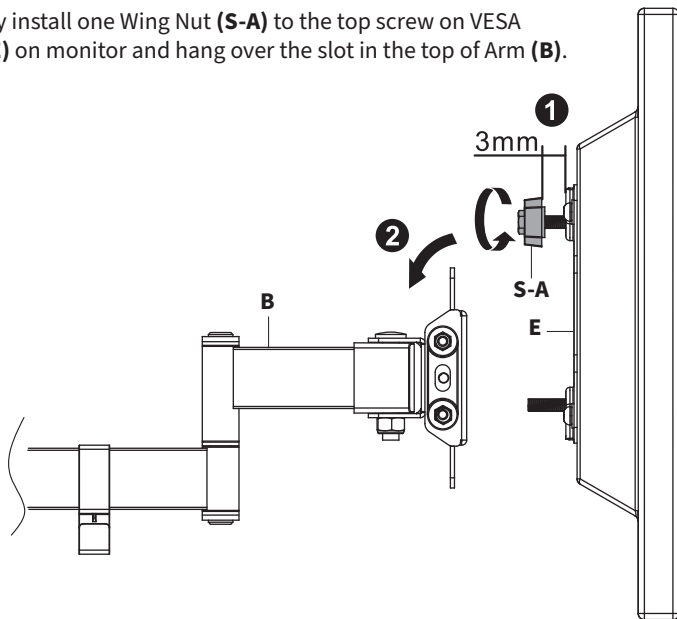

Install the second Wing Nut (**S-A**) to the lower screw on VESA Plate (**E**).

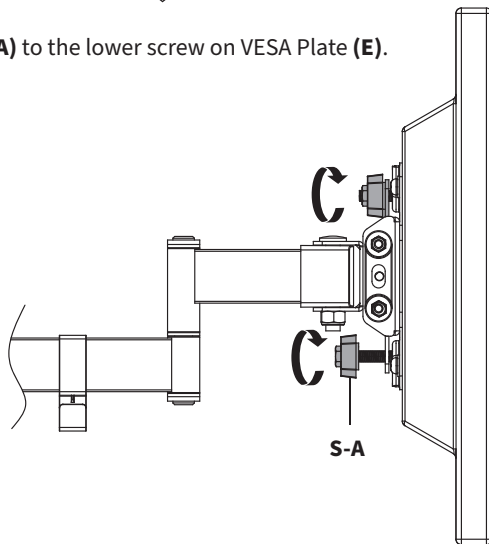

## Adjust as Desired

Adjust the tilt support screws using 4mm Allen Wrench (**T-A**) and swivel joints using Wrench (**T-C**).

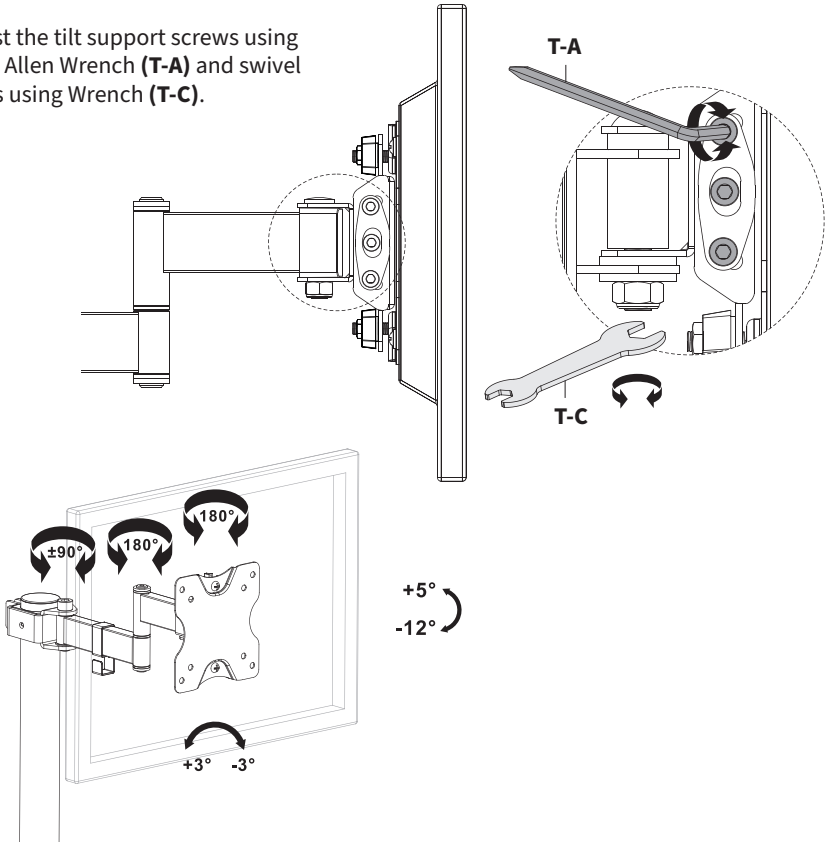

## Cable Management

Organize cables using Cable Clips (**F**), Pole Cable Clips (**M**), and Cover (**J**).

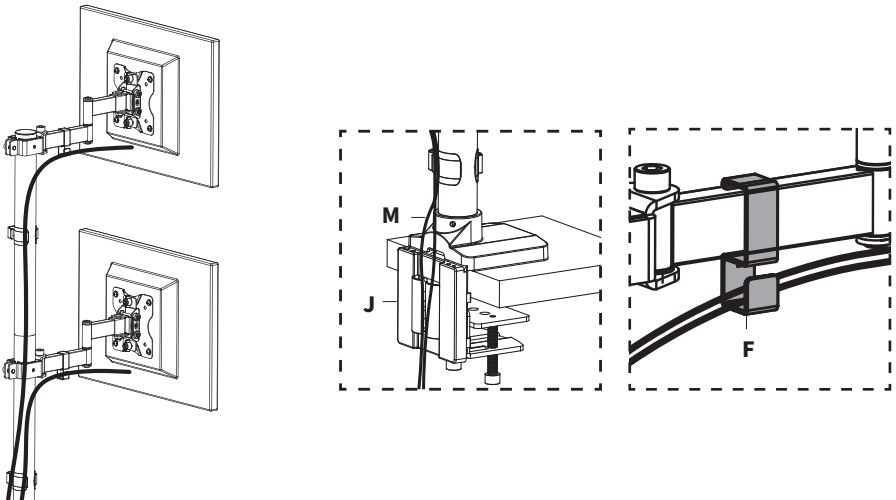

[ THIS PAGE INTENTIONALLY LEFT BLANK ]



## **Need Help? Get In Touch**

Monday-Friday from 7:00am-7:00pm CST



[help@vivo-us.com](mailto:help@vivo-us.com)



[www.vivo-us.com](http://www.vivo-us.com)

*Chat live with an agent!*



309-278-5303



**VIVO-us @vivo\_us**

FOR MORE GREAT VIVO PRODUCTS,  
CHECK OUT OUR WEBSITE AT: [WWW.VIVO-US.COM](http://WWW.VIVO-US.COM)