

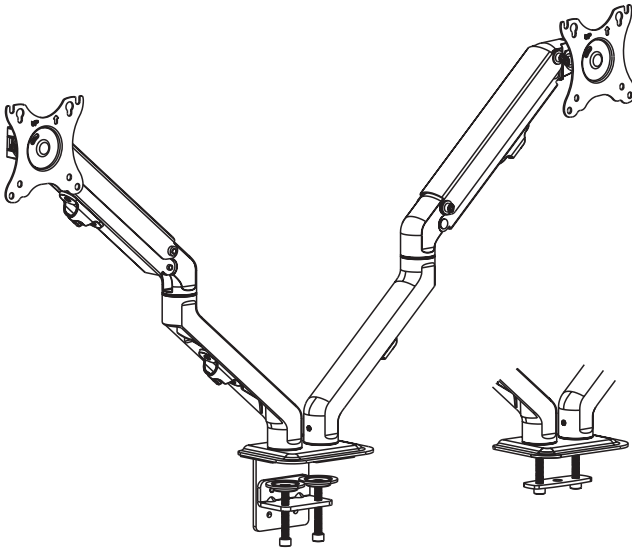

---

## Mechanical Arm Dual Monitor Desk Mount Instruction Manual



**SKU: STAND-V200S**



Scan the QR code with your mobile device or follow the link for helpful videos and specifications related to this product.

<https://vivo-us.com/products/stand-v200s>

---

GET IN TOUCH | Monday-Friday from 7:00am-7:00pm CST



help@vivo-us.com



www.vivo-us.com  
*Chat live with an agent!*



309-278-5303

## **WARNING!**

If you do not understand these directions, or if you have any doubts about the safety of the installation, please call a qualified technician. Check carefully to make sure there are no missing or defective parts. Improper installation may cause damage or serious injury. Do not use this product for any purpose that is not explicitly specified in this manual. Do not exceed weight capacity. We cannot be liable for damage or injury caused by improper mounting, incorrect assembly or inappropriate use.

### **TIPOVER WARNING**

SERIOUS OR FATAL CRUSHING INJURIES CAN OCCUR FROM TIPOVER. TO HELP PREVENT TIPOVER:

- NEVER ALLOW CHILDREN TO CLIMB, STAND, HANG, OR PLAY ON ANY PART OF MONITOR OR STAND.
- USE TIPOVER RESTRAINT OR ANCHOR STAND TO WALL

**USE OF TIPOVER RESTRAINTS MAY ONLY REDUCE, BUT NOT ELIMINATE RISK OF TIPOVER.**

### **WARNING: CHOKING HAZARD**

SMALL PARTS - NOT FOR CHILDREN UNDER 3 YEARS. ADULT SUPERVISION IS REQUIRED.

## **PACKAGE CONTENTS**

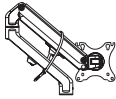

**A (x2)**  
Arm

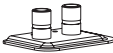

**B (x1)**  
Base



**C (x1)**  
Clamp



**D (x2)**  
Clamp Disk



**E (x2)**  
M6x8



**F (x1)**  
3mm Allen  
Wrench



**G (x1)**  
5mm Allen  
Wrench



**H (x1)**  
Support Plate



**M-A (x8)**  
M4x12



**M-B (x8)**  
M5x12



**M-C (x8)**  
D5 Washer

**NOTE:** SOME HARDWARE INCLUDED MAY NOT BE USED

## TOOLS NEEDED



DO NOT EXCEED WEIGHT CAPACITY.

Failure to do so may result in serious injury.

4.4-15.4lbs  
(2-7kg)

PER ARM

## ASSEMBLY STEPS

### STEP 1

#### OPTION A: Desk Clamp Installation

Assemble base (B) to clamp (C) using M6x8 bolts (E), and tighten with 5mm Allen wrench (G). Unscrew the large clamp bolts to the “open” position.

For 3/8” - 2” (10mm - 50mm) desk thickness, place clamp disks (D) onto the top of the clamp bolts.

Place assembled base onto edge of desk and tighten using the 5mm Allen wrench (G).

For 1-1/2” - 3-1/8” (40mm - 80mm) desk thickness, remove the two bolts from the back of the clamp using the 5mm Allen wrench (G), and then reassemble clamp to the lower position. Place clamp disks (D) onto the top of the clamp bolts. Place assembled base onto edge of desk and tighten using the 5mm Allen wrench (G).

#### OPTION B: Grommet Base Installation

Remove large clamp bolt from clamp (C). If necessary, drill holes in desk 55mm apart using a 3/8” (10mm) drill bit. Secure base (B) to desk using clamp bolts with support plates (H), and tighten using the 5mm Allen wrench (G).

**NOTE:** Grommet option will fit a desk thickness of 3/8” - 1-3/4” (10mm - 45mm).

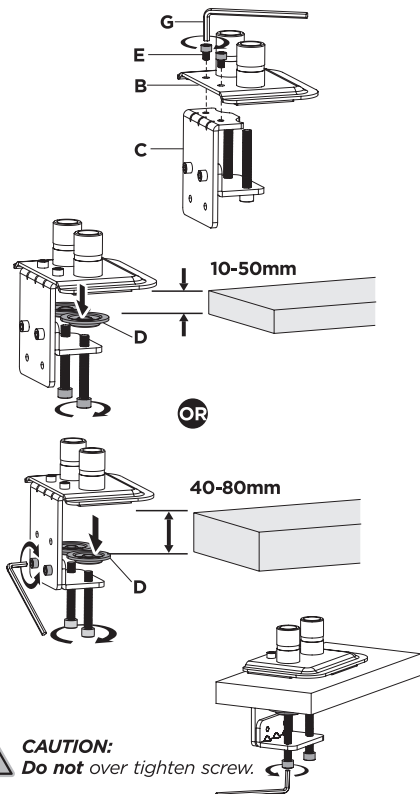

10-45mm

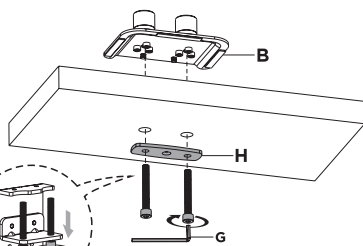
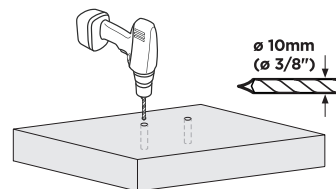
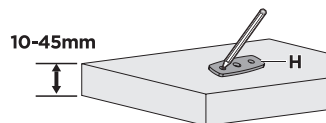

### STEP 2

While holding the arms **(A)** in the closed position, cut the shipping tie from each arm.

1. Firmly hold the two halves of the spring arm together and have another person cut off the cable tie from around the spring arm.
2. Slowly release the pressure on the spring arm and allow it to gradually stretch to its full extension.

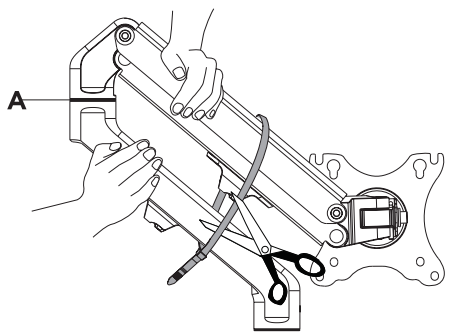

### STEP 3

Place the arms **(A)** onto the base **(B)**. Tighten the screw on the back of each arm using the 3mm Allen wrench **(F)** or a flat blade screwdriver.

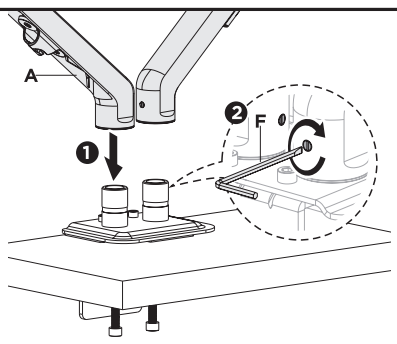

### STEP 4

Attach two bolts **(M-A or M-B)** and washers **(M-C)** to top mounting holes of each monitor, making sure to leave 1/8" (3mm) of threads exposed.

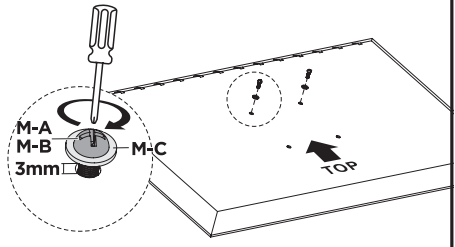
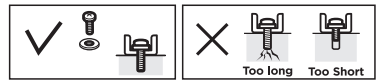

## STEP 5

Align bolts installed to monitors with VESA plate. Secure using two more bolts (**M-A** or **M-B**) and washers (**M-C**) in the bottom two holes. Tighten all four bolts with a Phillips screwdriver.

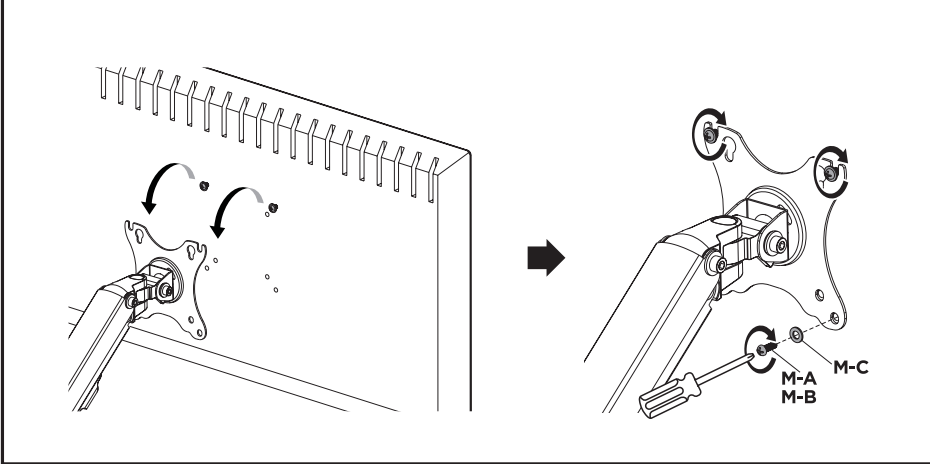

## STEP 6

If the arms (**A**) are not able to maintain a lowered position, tighten bolts on the side of each arm using the 5mm Allen wrench (**G**). Use cable clips on the arm to organize cables.



**CAUTION: DO NOT** loosen two screws that fixed the former arm as shown, or it may cause damage to the product.

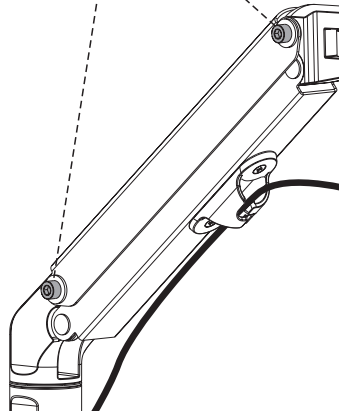

## STEP 7

Tighten or loosen the tilt joint using the 5mm Allen wrench (**G**). Adjust the monitor positions as desired.

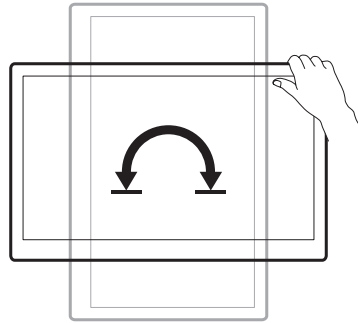
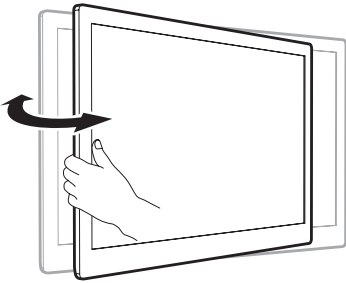
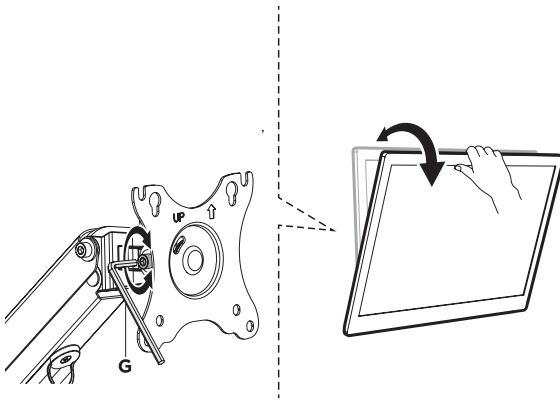





Open **Monday - Friday 7:00am - 7:00pm** CST,  
our dedicated support team can offer immediate assistance with rapid response times. If any parts are received damaged or defective, please contact us. We are happy to replace parts to ensure you have a fully functioning product.

 [help@vivo-us.com](mailto:help@vivo-us.com)

**AVG. RESPONSE TIME** (*within office hrs*): **1HR 8M**

- 23% within < 15m
- 38% within < 30m
- 61% within < 1hr
- 83% within < 2hr
- 92% within < 3hr

 [www.vivo-us.com](http://www.vivo-us.com)  
*Chat live with an agent!*

**AVG. RESOLUTION TIME** (*within office hrs*): **< 15 M**

 309-278-5303

**AVG. RESOLUTION TIME** (*within office hrs*): **5M 4S**