

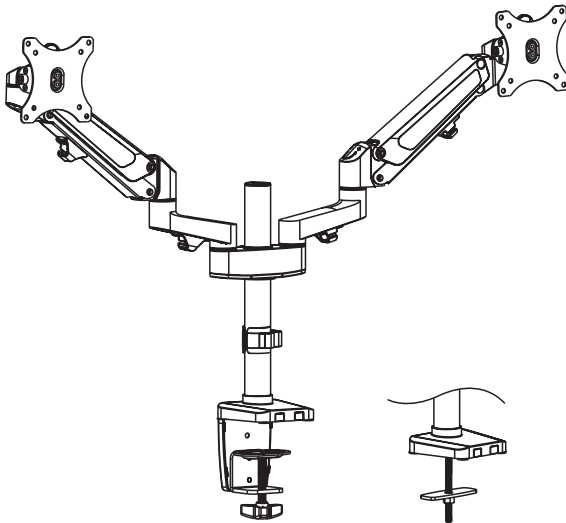

Pneumatic Arm Dual Monitor Desk Mount Instruction Manual



SKU: STAND-V200G



Scan the QR code with your mobile device or follow the link for helpful videos and specifications related to this product.

<https://vivo-us.com/products/stand-v200g>

GET IN TOUCH | Monday-Friday from 7:00am-7:00pm CST



help@vivo-us.com



www.vivo-us.com
Chat live with an agent!



309-278-5303

! WARNING!

If you do not understand these directions, or if you have any doubts about the safety of the installation, please call a qualified technician. Check carefully to make sure there are no missing or defective parts. Improper installation may cause damage or serious injury. Do not use this product for any purpose that is not explicitly specified in this manual. Do not exceed weight capacity. We cannot be liable for damage or injury caused by improper mounting, incorrect assembly or inappropriate use.

! TIPOVER WARNING

SERIOUS OR FATAL CRUSHING INJURIES CAN OCCUR FROM TIPOVER. TO HELP PREVENT TIPOVER:

- NEVER ALLOW CHILDREN TO CLIMB, STAND, HANG, OR PLAY ON ANY PART OF MONITOR OR STAND.
- USE TIPOVER RESTRAINT OR ANCHOR STAND TO WALL

USE OF TIPOVER RESTRAINTS MAY ONLY REDUCE, BUT NOT ELIMINATE RISK OF TIPOVER.

! WARNING: CHOKING HAZARD

SMALL PARTS - NOT FOR CHILDREN UNDER 3 YEARS. ADULT SUPERVISION IS REQUIRED.

PACKAGE CONTENTS

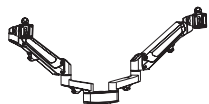

A (x1)
Arm



B (x2)
VESA Plate



C (x1)
Pole



D (x1)
Base



E (x1)
Clamp
Brace



F (x1)
Clamp



G (x1)
Cover



H (x1)
Carriage Bolt



I (x1)
Grommet Base



J (x1)
Support Plate



K (x1)
M8 Nut



L (x1)
M8 Washer



M (x3)
M6x16



N (x3)
M6x12



O (x2)
M6x10



P (x4)
Pad



Q (x1)
Cable Clip



R (x1)
4mm Allen
Wrench



S (x1)
6mm Allen
Wrench



T (x1)
Wrench



M-A (x8)
M4x12



M-B (x8)
M5x12



M-C (x8)
D5 Washer

TOOLS NEEDED



NOTE: SOME HARDWARE INCLUDED MAY NOT BE USED

DO NOT EXCEED WEIGHT CAPACITY.
Failure to do so may result in serious injury.



PER ARM

ASSEMBLY STEPS

STEP 1

OPTION A: Clamp Installation

Attach the pole (C) to the base (D) using M6x16mm bolts (M) and tighten with the 4mm Allen wrench (R). Attach clamp brace (E) to the base using M6x12mm bolts (N), and tighten with the 4mm Allen wrench (R). Apply pads (P) to each corner of the base.

For 3/8" - 2-5/32" (10-55mm) desktop thickness, attach the clamp (F) to the upper position on the clamp brace using M6x10mm bolts (O) and tighten with the 4mm Allen wrench (R).

For 2" - 3-11/32" (50-85mm) desktop thickness, attach the clamp (F) to the lower position on the clamp brace using M6x10mm bolts (O) and tighten with the 4mm Allen wrench (R).

Place the mount with clamp on the desk edge and tighten the hand bolt. Place the cover (G) on the back of the clamp.

OPTION B: Grommet Installation

Drop the carriage bolt (H) down through the center hole of the grommet base (I), making sure the counter-sink holes are on the underside of the base. Attach the grommet base with carriage bolt to the base (D) using M6x12mm bolts (N), and tighten with the 4mm Allen wrench (R). Apply pads (P) to each corner of the base.

If a grommet hole is not present in the desktop, drill a hole through the desktop using a 3/8" (10mm) bit. Place the base over the hole, then secure by attaching the support plate (J) to the carriage bolt protruding from underneath the desk using the M8 nut (K) with M8 washer (L). Tighten the M10 nut using the wrench (T).

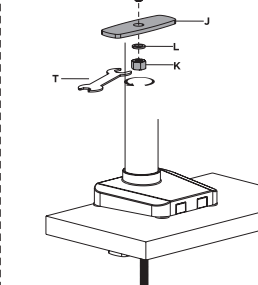
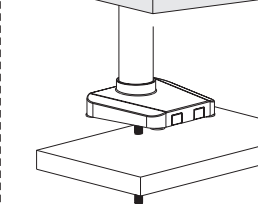
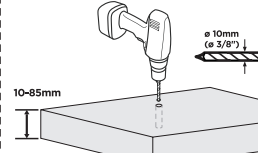
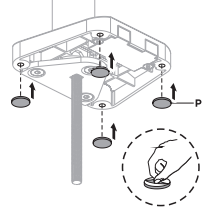
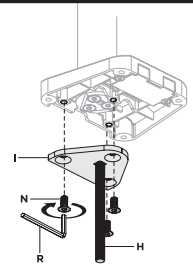
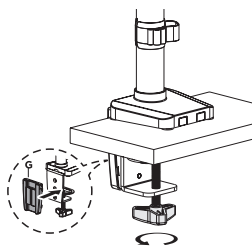
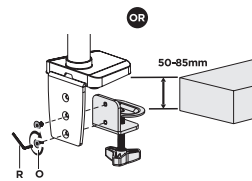
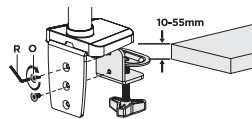
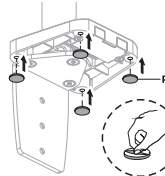
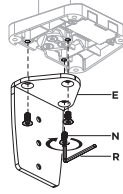
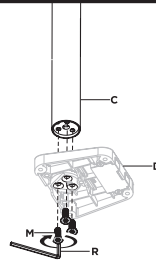

STEP 2

Slide the cable clip (Q) and arm (A) down onto the pole. Tighten the arm to the pole using the 6mm Allen wrench (S).

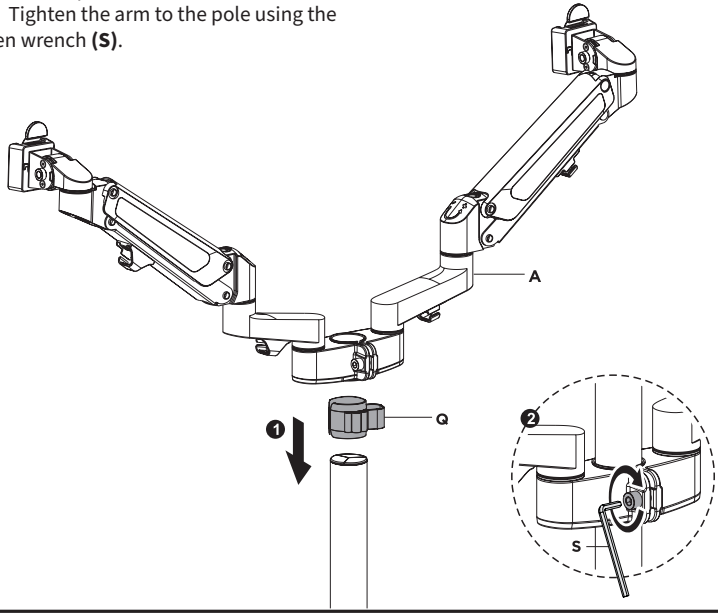

STEP 3

Attach the VESA plates (B) to the monitor using bolts (M-A or M-B) with washers (M-C), making sure the arrow is facing towards the top of the monitor, and tighten with a Phillips screwdriver.

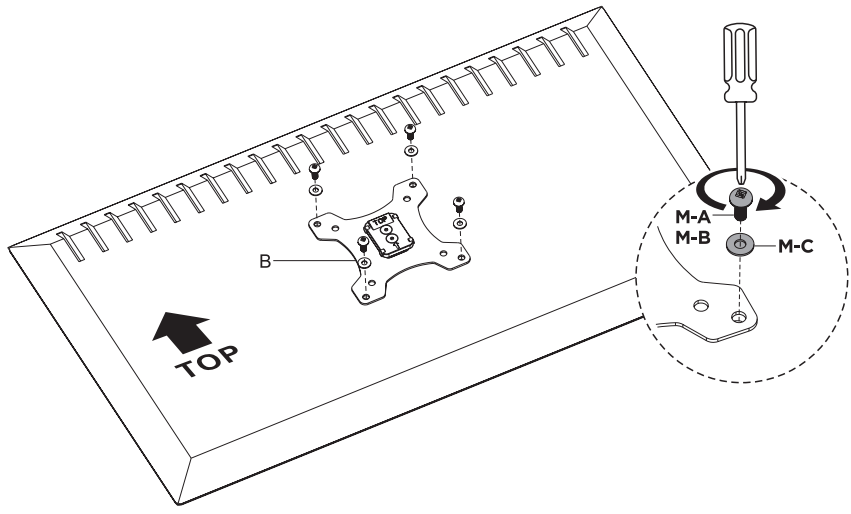
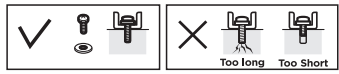

STEP 4

Pull back the release lever on the support bracket, then place the monitor with VESA plate **(B)** into the support.

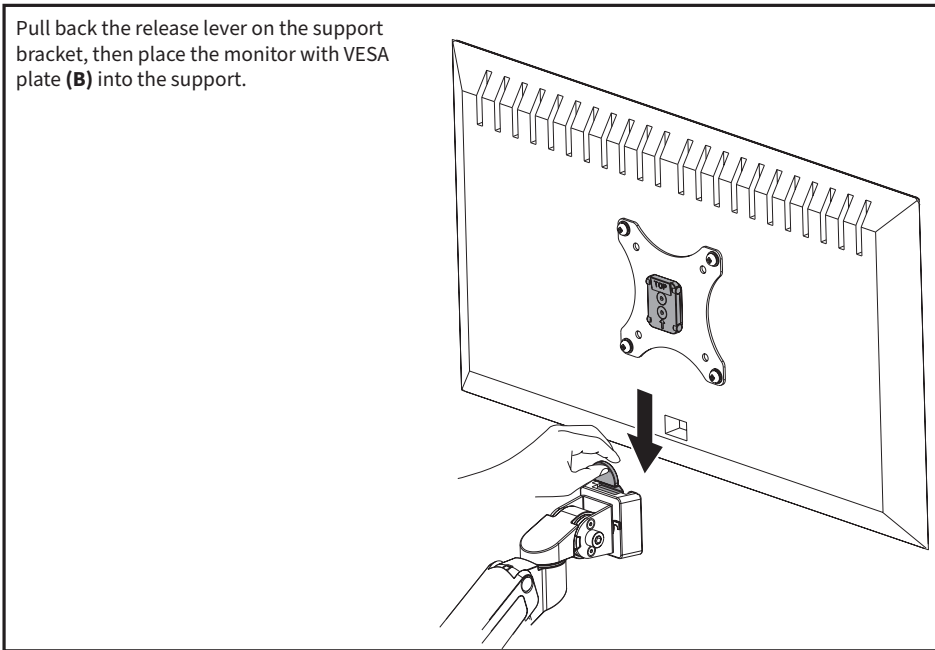

STEP 5

If needed, adjust the gas spring in each arm **(A)** to support the monitors using the 6mm Allen wrench **(S)**. While holding the arm in the straight forward position, turn the screw in back clockwise to decrease support, and counter-clockwise to increase.

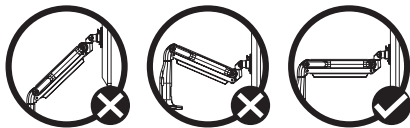
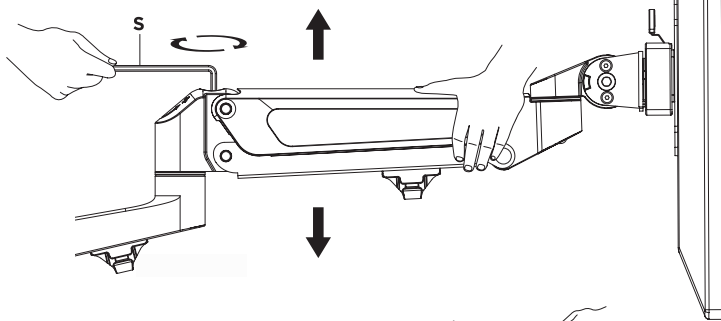

CAUTION - To avoid damage to the monitor and mount, always keep the arm in a horizontal position while making adjustments.



If the arm **drops**, turn the adjustment screw counter-clockwise until it stays in a horizontal position.



If the arm **rises**, turn the adjustment screw clockwise until it stays in a horizontal position.



DO NOT over tighten the screws.

STEP 6

Use the cable clips on the arms and pole to organize cables.

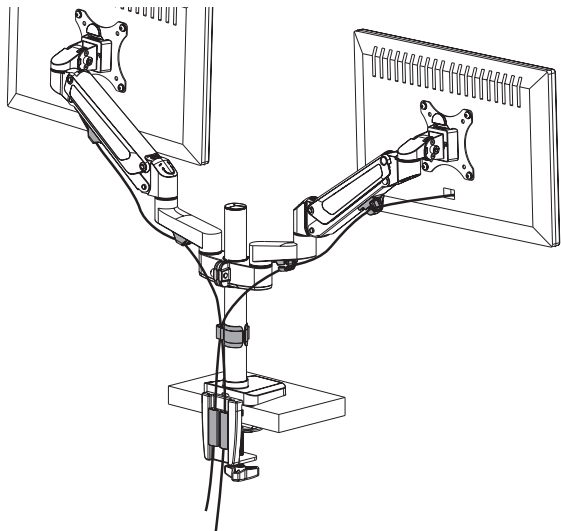

STEP 7

Adjust tilt support by turning the bolt on the side of each tilt joint using the 6mm Allen wrench (S).

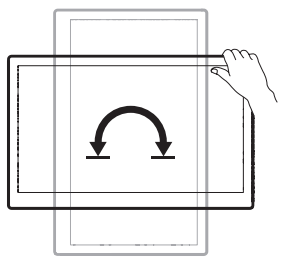
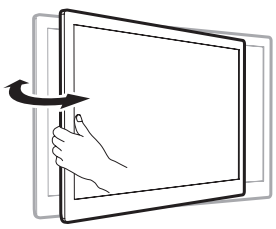
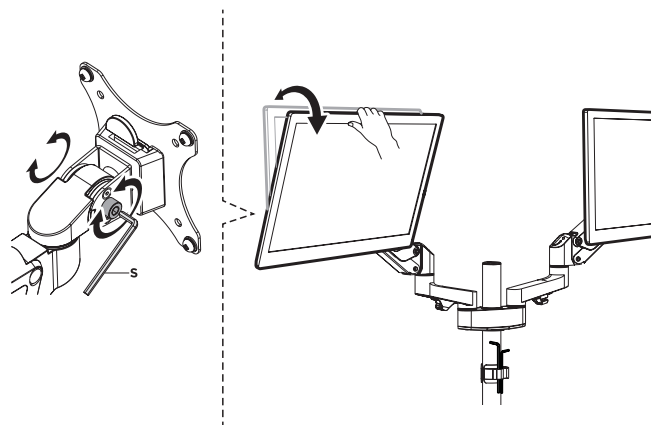



Open **Monday - Friday 7:00am - 7:00pm** CST,
our dedicated support team can offer immediate assistance with rapid response times. If any parts are received damaged or defective, please contact us. We are happy to replace parts to ensure you have a fully functioning product.

 help@vivo-us.com

AVG. RESPONSE TIME (*within office hrs*): **1HR 8M**

- 23% within < 15m
- 38% within < 30m
- 61% within < 1hr
- 83% within < 2hr
- 92% within < 3hr

 www.vivo-us.com
Chat live with an agent!

AVG. RESOLUTION TIME (*within office hrs*): **< 15 M**

 309-278-5303

AVG. RESOLUTION TIME (*within office hrs*): **5M 4S**