

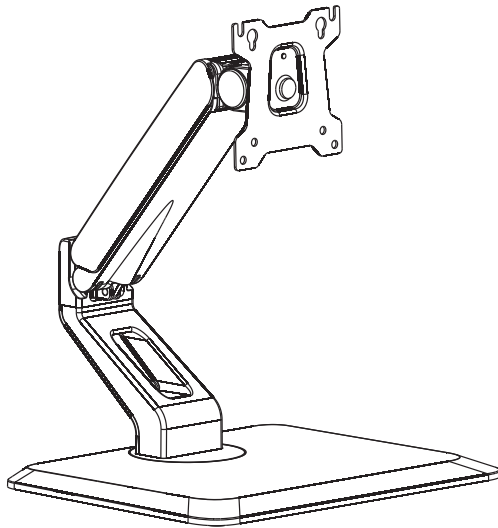

Pneumatic Arm Monitor & Touch Screen Desk Stand Instruction Manual



SKU: STAND-V001R



Scan the QR code with your mobile device or follow the link for helpful videos and specifications related to this product.

<https://vivo-us.com/products/stand-v001r>

GET IN TOUCH | Monday-Friday from 7:00am-7:00pm CST



help@vivo-us.com



www.vivo-us.com
Chat live with an agent!



309-278-5303

WARNING!

If you do not understand these directions, or if you have any doubts about the safety of the installation, please call a qualified technician. Check carefully to make sure there are no missing or defective parts. Improper installation may cause damage or serious injury. Do not use this product for any purpose that is not explicitly specified in this manual. Do not exceed weight capacity. We cannot be liable for damage or injury caused by improper mounting, incorrect assembly or inappropriate use.

TIPOVER WARNING

SERIOUS OR FATAL CRUSHING INJURIES CAN OCCUR FROM TIPOVER. TO HELP PREVENT TIPOVER:

- NEVER ALLOW CHILDREN TO CLIMB, STAND, HANG, OR PLAY ON ANY PART OF MONITOR OR STAND.
- USE TIPOVER RESTRAINT OR ANCHOR STAND TO WALL

USE OF TIPOVER RESTRAINTS MAY ONLY REDUCE, BUT NOT ELIMINATE RISK OF TIPOVER.

WARNING: CHOKING HAZARD

SMALL PARTS - NOT FOR CHILDREN UNDER 3 YEARS. ADULT SUPERVISION IS REQUIRED.

PACKAGE CONTENTS

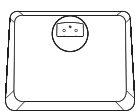

A (x1)
Base

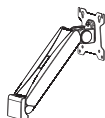

B (x1)
Monitor Arm



C (x1)
Lower Arm



D (x1)
Cover



E (x1)
M4x8



F (x4)
M6x20



G (x1)
4mm Allen
Wrench



H (x1)
6mm Allen
Wrench



M-A (x4)
M4x12



M-B (x4)
M5x12



M-C (x4)
D5 Washer

NOTE: SOME HARDWARE INCLUDED MAY NOT BE USED

TOOLS NEEDED



DO NOT EXCEED WEIGHT CAPACITY.

Failure to do so may result in serious injury.

4.4-22lbs
(2-10kg)

ASSEMBLY STEPS

STEP 1

Assemble the monitor arm **(B)** to the lower arm **(C)** using M6x20 bolts **(F)**, and tighten with the 4mm Allen wrench **(G)**. Attach the cover **(D)** to the lower arm using the M4x8 bolt **(E)**.

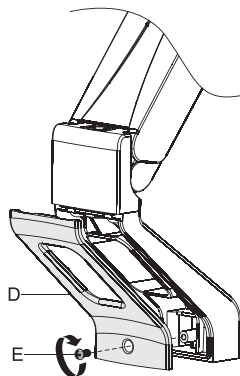
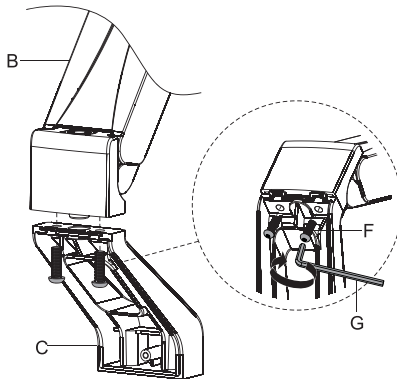

STEP 2

Attach the assembled monitor arm to the base **(A)** using M6x20 bolts **(F)**, and tighten with the 4mm Allen wrench **(G)**.

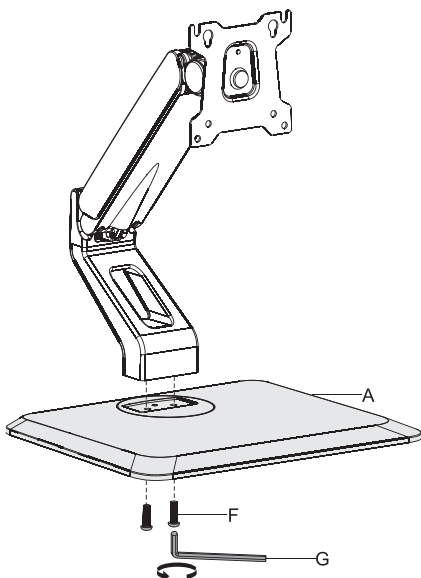

STEP 3

Insert 12mm bolts **(M-A, M-B)** with washers **(M-C)** into the top two mounting holes of the monitor, leaving 3mm of thread exposed.

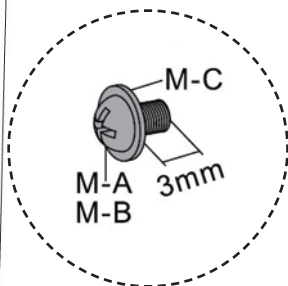
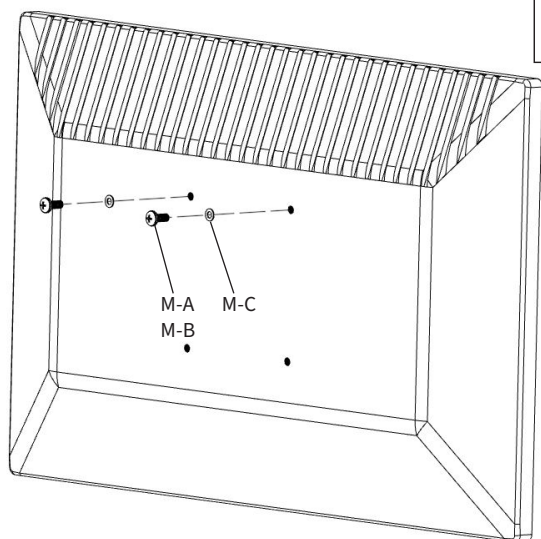
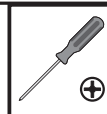

STEP 4

Hang the monitor over the slots in the VESA mounting plate, insert two more bolts (**M-A**, **M-B**) with washers (**M-C**) into the lower two holes, and tighten with a Phillips screwdriver.

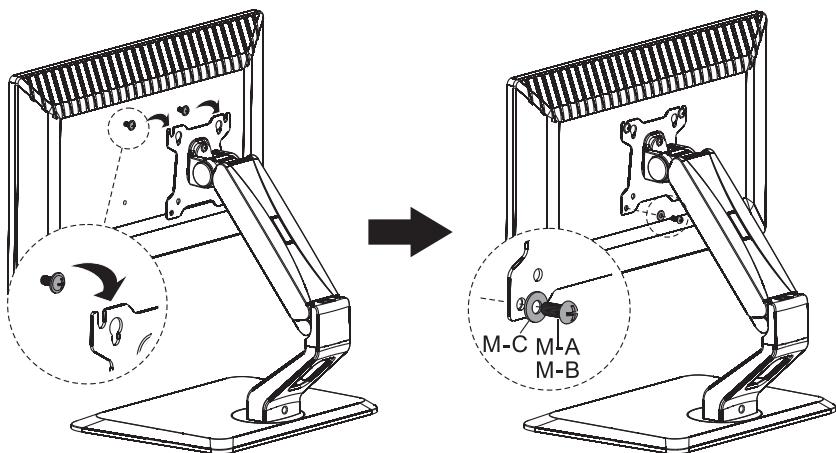

STEP 5

Adjust tilt support by removing the cap from the side and tightening the bolt underneath with the 6mm Allen wrench (**H**), then replace the cap. Route cables through the opening in the lower arm.

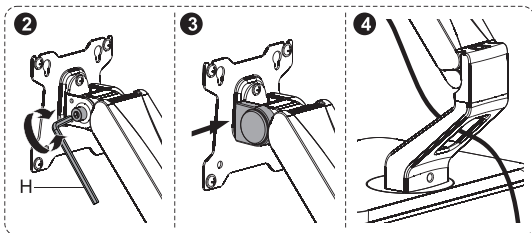
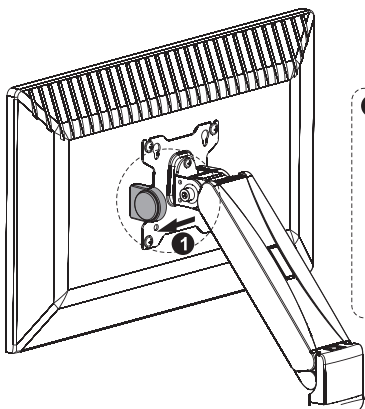

STEP 6

To rotate your monitor, remove the screw and washer from the back of the VESA plate on the Monitor Arm (**B**) using a Phillips screwdriver.

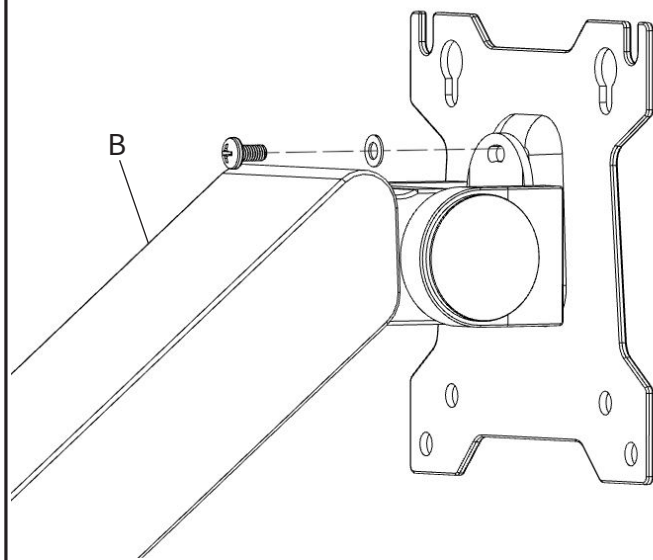

STEP 7

To adjust gas spring support, hold the gas spring arm down to the straight-forward position and turn the adjustment screw using the 6mm Allen wrench (**H**). Clockwise will reduce support, and counter-clockwise will increase support.

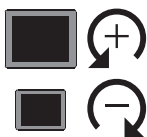
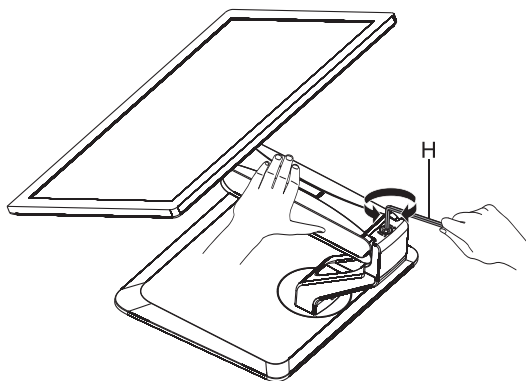

Adjust as Desired

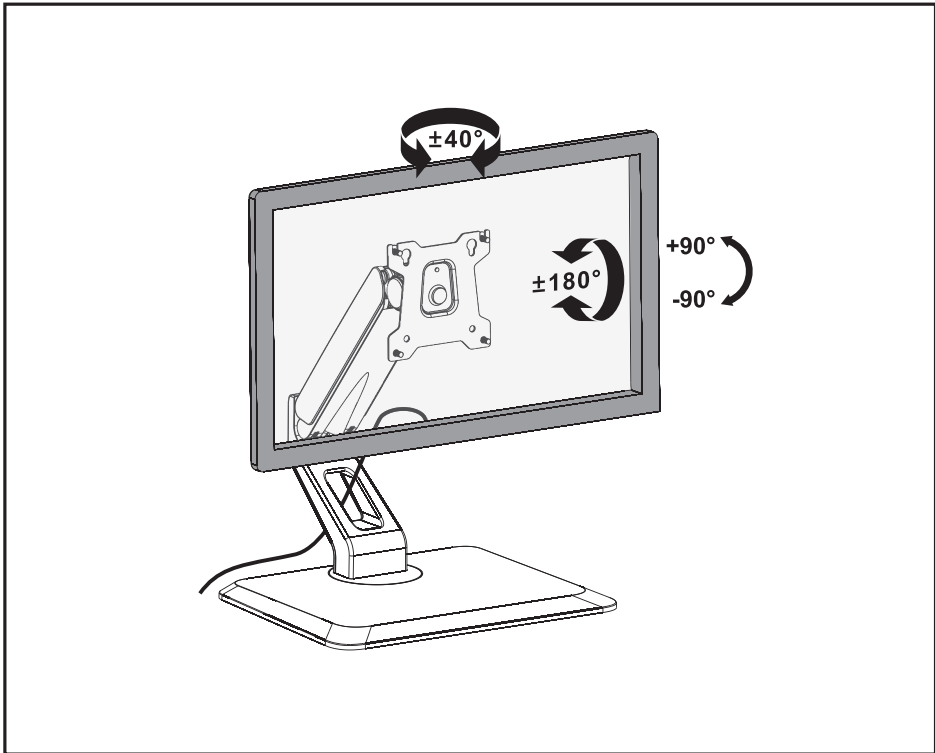



Open **Monday - Friday 7:00am - 7:00pm** CST,
our dedicated support team can offer immediate assistance with rapid response times. If any parts are received damaged or defective, please contact us. We are happy to replace parts to ensure you have a fully functioning product.

 help@vivo-us.com

AVG. RESPONSE TIME (*within office hrs*): **1HR 8M**

- 23% within < 15m
- 38% within < 30m
- 61% within < 1hr
- 83% within < 2hr
- 92% within < 3hr

 www.vivo-us.com
Chat live with an agent!

AVG. RESOLUTION TIME (*within office hrs*): **< 15 M**

 309-278-5303

AVG. RESOLUTION TIME (*within office hrs*): **5M 4S**