

## Black TV Stand with Storage Shelf

### Instruction Manual

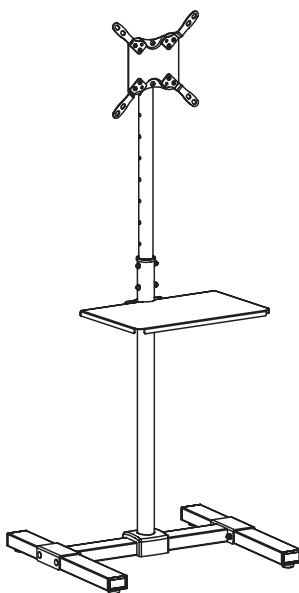

**SKU: STAND-TV07-S**



Scan the QR code with your mobile device or follow the link for helpful videos and specifications related to this product.

<https://vivo-us.com/products/stand-tv07-s>

**GET IN TOUCH** | Monday-Friday from 7:00am-7:00pm CST



help@vivo-us.com



www.vivo-us.com  
*Chat live with an agent!*



309-278-5303



## WARNING!

If you do not understand these directions, or if you have any doubts about the safety of the installation, please call a qualified technician. Check carefully to make sure there are no missing or defective parts. Improper installation may cause damage or serious injury. Do not use this product for any purpose that is not explicitly specified in this manual. Do not exceed weight capacity. We cannot be liable for damage or injury caused by improper mounting, incorrect assembly or inappropriate use.



## TIPOVER WARNING

SERIOUS OR FATAL CRUSHING INJURIES CAN OCCUR FROM TIPOVER. TO HELP PREVENT TIPOVER:

- NEVER ALLOW CHILDREN TO CLIMB, STAND, HANG, OR PLAY ON ANY PART OF TV OR TV CART.
- USE TIPOVER RESTRAINT OR ANCHOR STAND TO WALL

**USE OF TIPOVER RESTRAINTS MAY ONLY REDUCE, BUT NOT ELIMINATE RISK OF TIPOVER.**

## PACKAGE CONTENTS

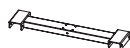

**A** (x1)

Base



**B** (x2)

Feet



**C** (x1)

Center Pole



**D** (x1)

VESA Plate



**E** (x2)

VESA  
Adapter



**F** (x2)

VESA  
Adapter



**G** (x1)

Plastic Cover



**H** (x1)

Shelf



**I** (x1)

Shelf Bracket



**S-A** (x8)

M5x10mm

Screw



**S-B** (x8)

M5 Lock Nut



**S-C** (x5)

M6x65mm

Carriage Bolt



**S-D** (x5)

M6 Washer



**S-E** (x5)

M6 Lock Nut



**S-F** (x1)

M6 Flange

Nut



**S-G** (x4)

M6x12mm

Screw



**S-I** (x2)

M6x60mm

Socket Head  
Bolt



**M-A** (x4)

M4x14mm

Screw



**M-B** (x4)

M5x14mm

Screw



**M-C** (x4)

M6x14mm

Screw



**M-D** (x4)

M8x20mm

Screw



**M-E** (x4)

M5 Washer



**M-F** (x4)

M8 Washer



**M-G** (x8)

Spacer



**T-A** (x1)

4mm Allen  
Wrench



**T-B** (x1)

5mm Allen  
Wrench



**T-C** (x1)

Wrench

**NOTE:** SOME HARDWARE INCLUDED MAY NOT BE USED



## WARNING: CHOKING HAZARD

SMALL PARTS - NOT FOR CHILDREN UNDER 3 YEARS. ADULT SUPERVISION IS REQUIRED.

## TOOLS NEEDED



DO NOT EXCEED WEIGHT CAPACITY.

Failure to do so may result in serious injury.



## ASSEMBLY STEPS

### STEP 1

Attach Base (A) to Feet (B) using M6x65mm Carriage Bolts (S-C), M6 Washers (S-D), and M6 Lock Nuts (S-E). Tighten using provided Wrench (T-C).

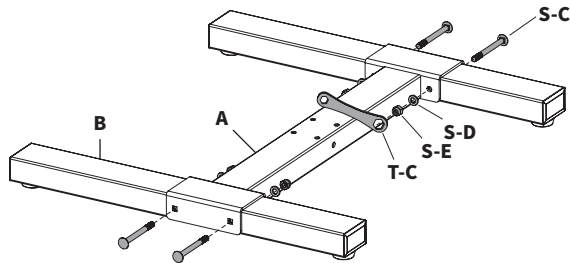

### STEP 2

Remove the two bolts, four washers, and two nuts from the Center Pole (C) using Allen Wrench (T-A) and Wrench (T-C).

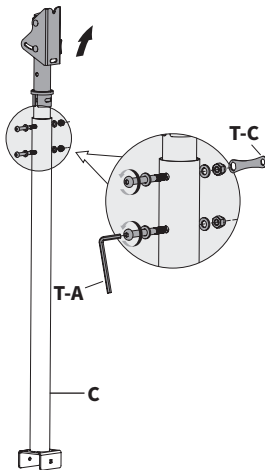

Separate into two halves.

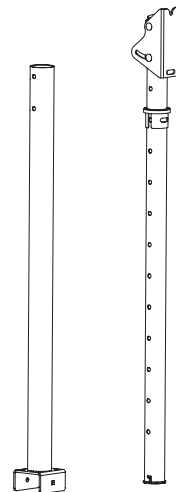

STEP 3

Slide Plastic Cover (**G**) over lower portion of Center Pole (**C**).

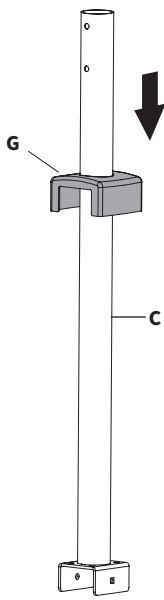

Slide the top half of the pole back into the lower half and secure using the hardware you removed in step 2, Allen Wrench (**T-A**), and Wrench (**T-C**).

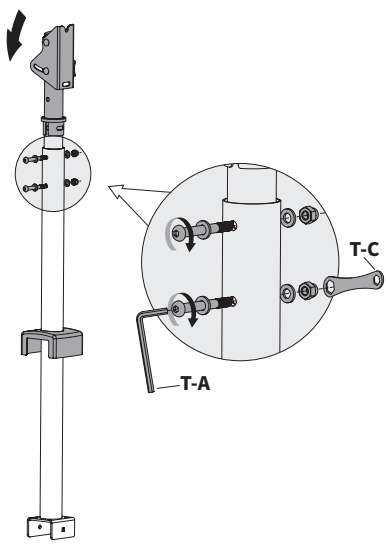

STEP 4

Attach Center Pole (**C**) to Base (**A**) using Carriage Bolt (**S-C**), M6 Washer (**S-D**), and M6 Lock Nut (**S-E**) through the front of the base. Use M6x12mm Screws (**S-G**) to secure the top. Tighten using Allen Wrench (**T-A**) and Wrench (**T-C**).

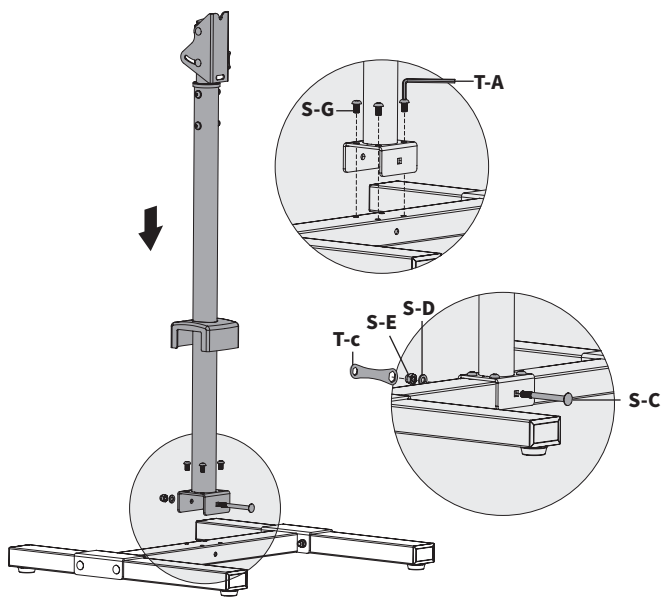

## STEP 5

### OPTION A: VESA Plate Only

Use Screws (**M-A or M-B**) along with Washers (**M-E**) to attach the VESA Plate (**D**) without the adapters to the TV monitor.

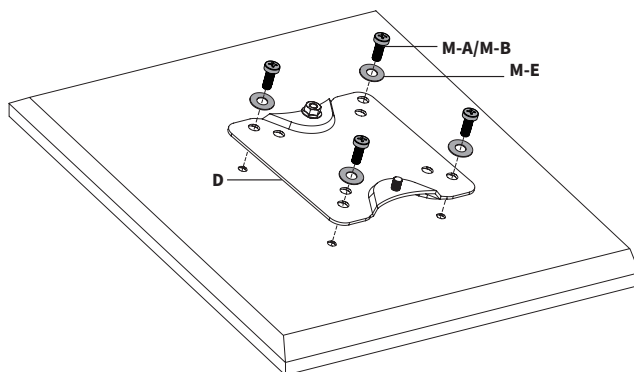

### OPTION B: VESA Plate with Adapters

For TVs with VESA mounts at 200mm x 200mm or 200mm x 100mm, VESA Adapters (**E, F**) are required. Attach Adapters to VESA Plate (**D**) using M5x10mm Screws (**S-A**) and M5 Lock Nuts (**S-B**). Tighten using Wrench (**T-C**) and a Phillips screwdriver.

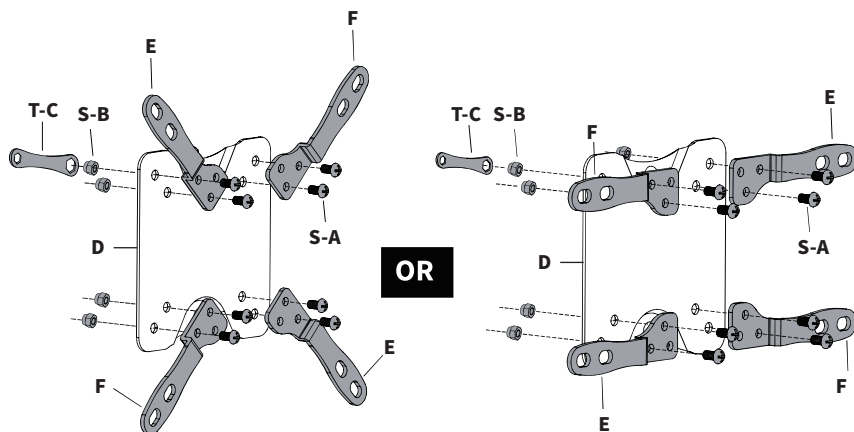

## STEP 5 (Continued)

### OPTION B: VESA Plate with Adapters (Continued)

Use Screws (**M-A thru M-D**) along with Washers (**M-E, M-F**) to secure VESA plate with the adapters to the back of your television. Make sure the “VIVO” logo is right side up. For a curved television, Spacers (**M-G**) may be required.

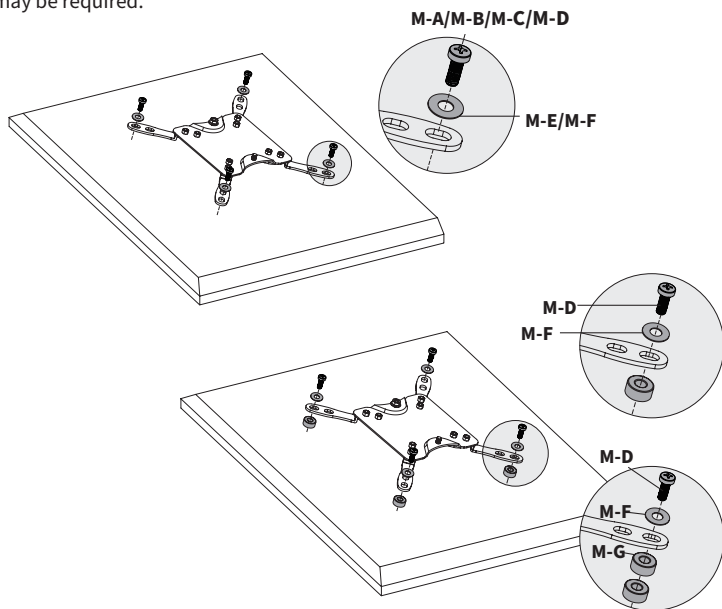

## STEP 6

To attach the TV to the stand, loosen the nut at the top of the VESA assembly, then slide the TV with VESA assembly into the slot on top of the mounting plate on Center Pole (**C**). Place M6 Flange Nut (**S-F**) onto bottom thread of VESA assembly and tighten both nuts using Wrench (**T-C**).

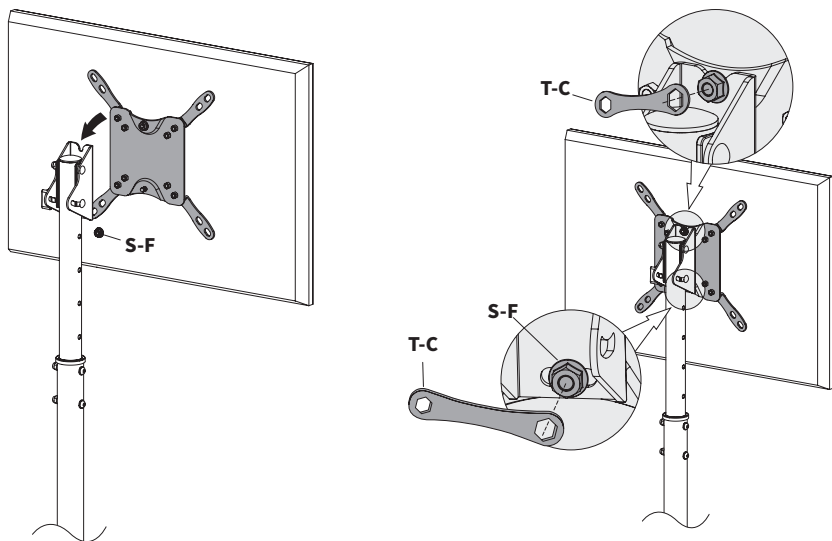

## STEP 7

Remove clear protective film from both the Shelf Clamp Plate (**H**) and Mounting Bracket (**I**). Partially insert M6x60mm Socket Head Bolts (**S-H**) into the shelf using the 5mm Allen Wrench (**T-B**) as shown.

**NOTE:** Do not fully tighten screws at this time.

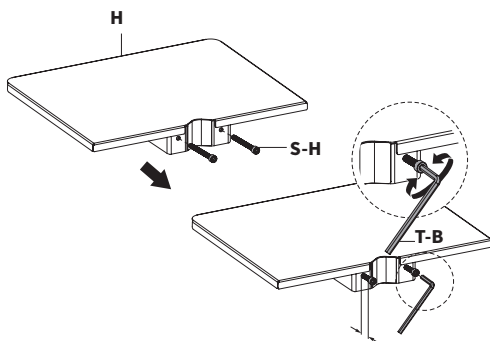

## STEP 8

Hold the Shelf (**H**) to the Pole (**C**). Place the Mounting Bracket (**I**) over the screw heads, then tighten with the 5mm Allen Wrench (**T-B**).

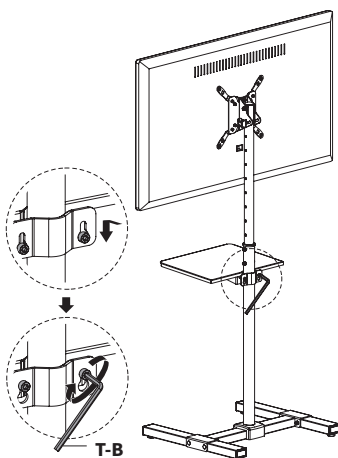
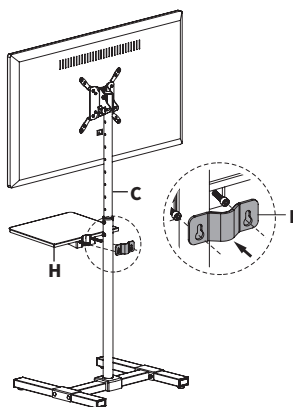

Adjust as desired.

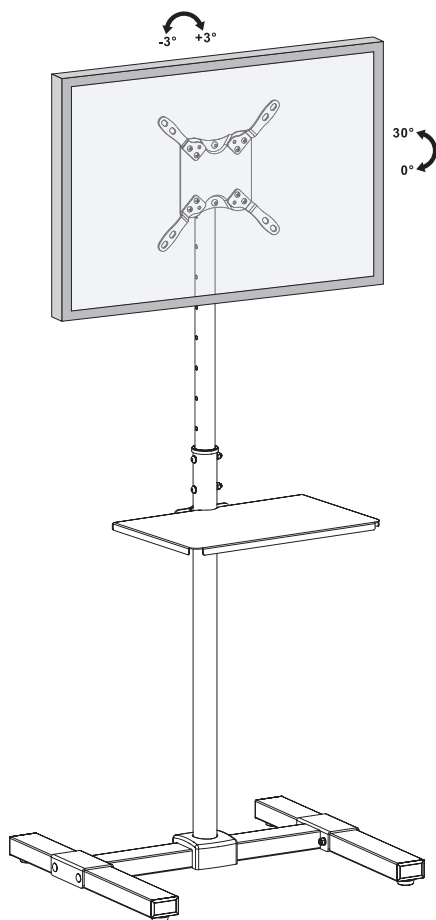



Love your new VIVO setup and want to share?  
Tag us in your photo! **@vivo\_us**

LAST UPDATED: 04/03/2023  
REV1.1



Open **Monday - Friday 7:00am - 7:00pm CST**,  
our dedicated support team can offer immediate assistance with rapid response times. If any  
parts are received damaged or defective, please contact us. We are happy to replace parts to  
ensure you have a fully functioning product.



309-278-5303

**AVG. RESOLUTION TIME** (*within office hrs*): **5M 4S**



[www.vivo-us.com](http://www.vivo-us.com)  
*Chat live with an agent!*

**AVG. RESOLUTION TIME** (*within office hrs*): **< 15 M**



[help@vivo-us.com](mailto:help@vivo-us.com)

**AVG. RESPONSE TIME** (*within office hrs*): **1HR 8M**

- 23% within < 15m
- 38% within < 30m
- 61% within < 1hr
- 83% within < 2hr
- 92% within < 3hr

FOR MORE VIVO PRODUCTS, CHECK OUT OUR WEBSITE AT: [www.vivo-us.com](http://www.vivo-us.com)