

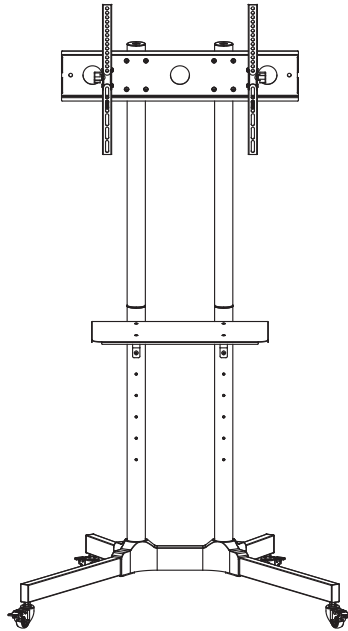

---

## Mobile TV Cart Instruction Manual



**SKU: STAND-TV03E/W**



Scan the QR code with your mobile device or follow the link for helpful videos and specifications related to this product.

<https://vivo-us.com/products/stand-tv03e>

---

GET IN TOUCH | Monday-Friday from 7:00am-7:00pm CST



help@vivo-us.com



www.vivo-us.com  
*Chat live with an agent!*



309-278-5303

## **WARNING!**

If you do not understand these directions, or if you have any doubts about the safety of the installation, please call a qualified technician. Check carefully to make sure there are no missing or defective parts. Improper installation may cause damage or serious injury. Do not use this product for any purpose that is not explicitly specified in this manual. Do not exceed weight capacity. We cannot be liable for damage or injury caused by improper mounting, incorrect assembly or inappropriate use.

### **TIPOVER WARNING**

SERIOUS OR FATAL CRUSHING INJURIES CAN OCCUR FROM TIPOVER. TO HELP PREVENT TIPOVER:

- NEVER ALLOW CHILDREN TO CLIMB, STAND, HANG, OR PLAY ON ANY PART OF TV OR TV CART.
- USE TIPOVER RESTRAINT OR ANCHOR STAND TO WALL

**USE OF TIPOVER RESTRAINTS MAY ONLY REDUCE, BUT NOT ELIMINATE RISK OF TIPOVER.**

### **WARNING: CHOKING HAZARD**

SMALL PARTS - NOT FOR CHILDREN UNDER 3 YEARS. ADULT SUPERVISION IS REQUIRED.

#### TOOLS NEEDED



DO NOT EXCEED WEIGHT CAPACITY.

Failure to do so may result in serious injury.



# PACKAGE CONTENTS

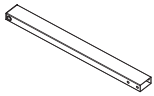

**A (x2)**  
Long Leg



**B (x2)**  
Short Leg

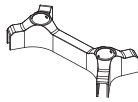

**C (x1)**  
Base w/Cover



**D (x2)**  
Rubber Sleeves

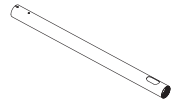

**E (x2)**  
Lower Pole

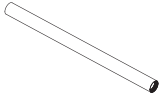

**F (x2)**  
Upper Pole



**G (x2)**  
Pole  
Connector



**H (x4)**  
Pole Cap



**I (x4)**  
Caster



**J (x2)**  
Plastic Pad



**K (x2)**  
Adapter  
Bracket



**L (x4)**  
Threaded  
Plate

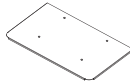

**M (x1)**  
Shelf

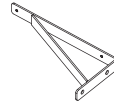

**N (x2)**  
Shelf  
Support

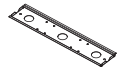

**O (x1)**  
Mounting  
Plate

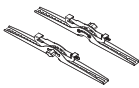

**P (x1)**  
VESA  
Bracket Set



**S-A (x8)**  
M6x60mm  
Screw



**S-B (x14)**  
M6x10mm  
Screw



**S-C (x2)**  
M5x6mm  
Screw



**S-D (x4)**  
M4x6mm  
Screw



**M-A (x4)**  
M4x12mm  
Screw



**M-B (x4)**  
M4x30mm  
Screw



**M-C (x4)**  
M6x20mm  
Screw



**M-D (x4)**  
M6x35mm  
Screw



**M-E (x4)**  
M8x20mm  
Screw



**M-F (x4)**  
M8x35mm  
Screw



**M-G (x4)**  
M8x50mm  
Screw



**M-H (x4)**  
M4 Washer



**M-I (x12)**  
M6 Washer



**M-J (x4)**  
M8 Washer



**M-K (x4)**  
M6 Spacer



**M-L (x4)**  
Large M8  
Spacer



**M-M (x8)**  
Small M8  
Spacer



**T-A (x1)**  
2.5mm Allen  
Wrench



**T-B (x1)**  
4mm Allen  
Wrench



**T-C (x1)**  
5mm Allen  
Wrench



**T-D (x1)**  
Wrench



**T-E (x1)**  
Level

**NOTE:** SOME HARDWARE INCLUDED MAY NOT BE USED

# ASSEMBLY STEPS

## STEP 1

Attach Casters (I) to Long and Short Legs (A, B) using Wrench (T-D).

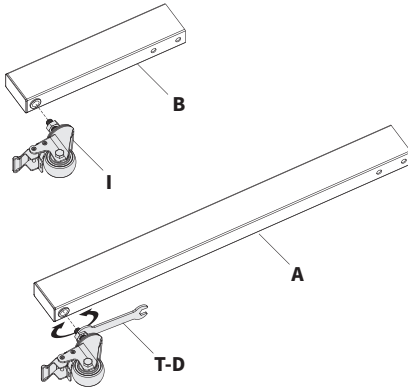

## STEP 2

Separate Base w/Cover (C) into Base (C1) and Cover (C2).

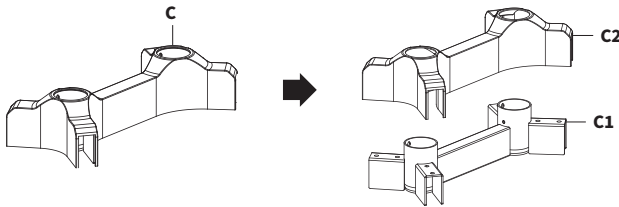

Attach Long and Short Legs (A, B) to Base (C1) using M6x60mm Screws (S-A), Threaded Plates (L), and 5mm Allen Wrench (T-C).

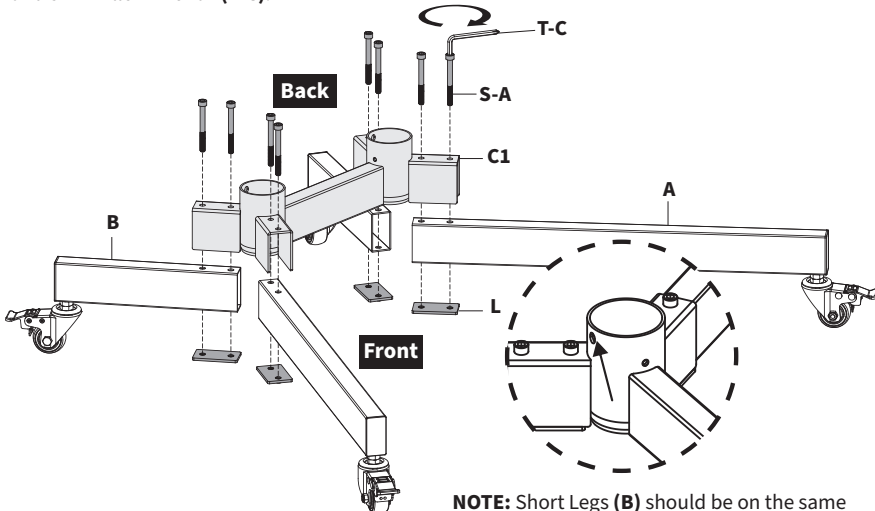

**NOTE:** Short Legs (B) should be on the same side as the large holes on on Base (C), indicated by the arrow above.

## STEP 3

Thread Pole Connectors (**G**) onto Lower Poles (**E**).

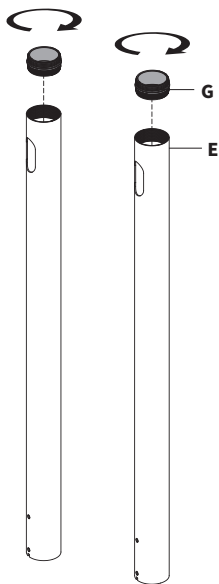

Insert Lower Poles (**E**) into Base (**C**) and secure using M6x10mm Screws (**S-B**) and 4mm Allen Wrench (**T-B**).

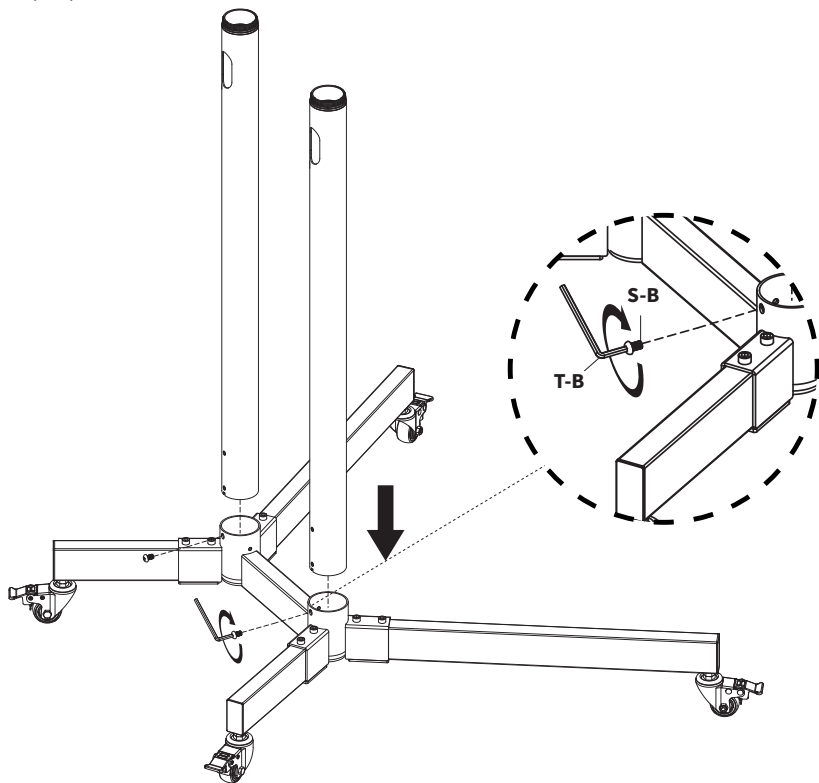

## STEP 4

Slide Cover (C2) over Lower Poles (E) and onto Base (C). To ensure a correct fit, make sure side with logo is facing the front. Place Rubber Sleeves (D) into the holes on the backside Lower Poles (E).

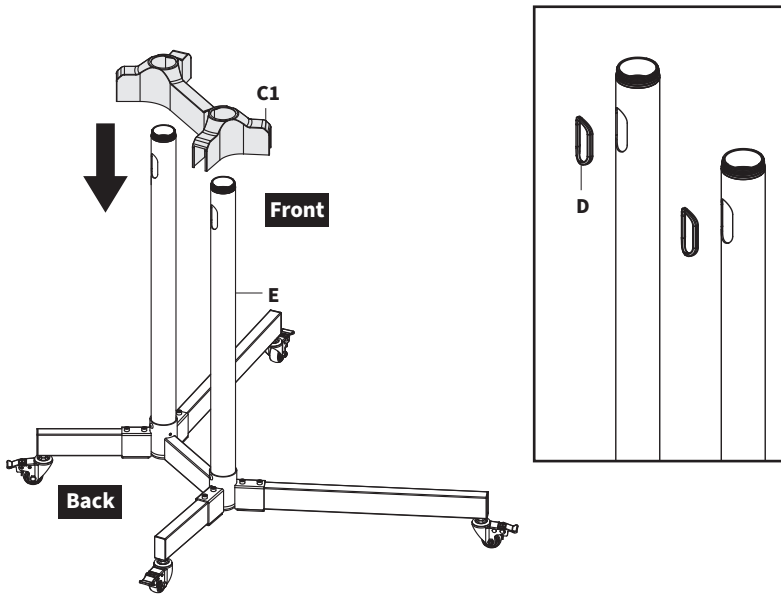

Thread Upper Poles (F) into Pole Connectors (G). Assemble Pole Caps (H) and place onto of Upper Poles (F).

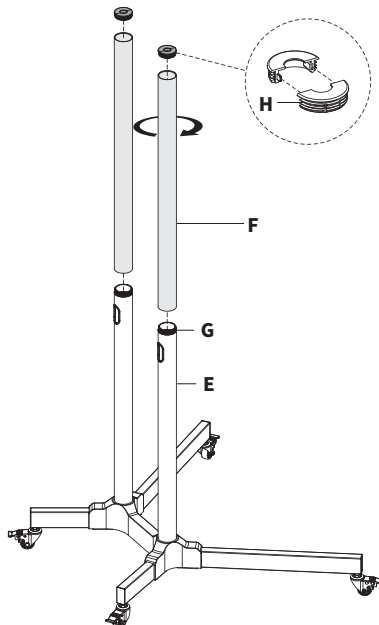

## STEP 5

Hold Plastic Pad (**J**) inside of Adapter Bracket (**K**) and slide onto Upper Pole (**F**). Tighten the set screw on Adapter Bracket (**K**) to secure using 4mm Allen Wrench (**T-B**). When positioning, ensure that the set screw is facing the back and that the mounting holes are facing the front of the assembled cart.

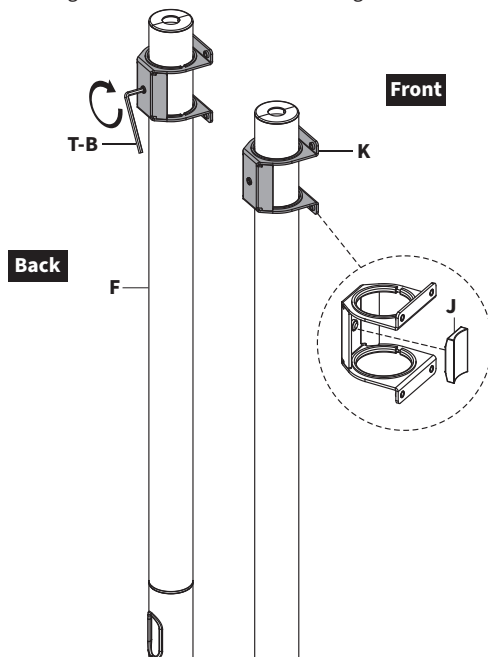

Attach Mounting Plate (**O**) to Adapter Brackets (**K**) using M6x10mm Screws (**S-B**), M6 Washers (**M-I**), and 4mm Allen Wrench (**T-B**).

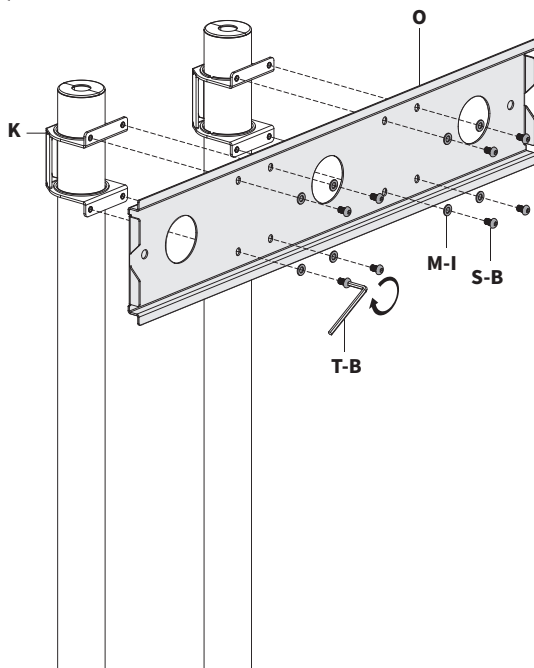

## STEP 6

Clip Level (**T-E**) onto Mounting Plate (**O**).

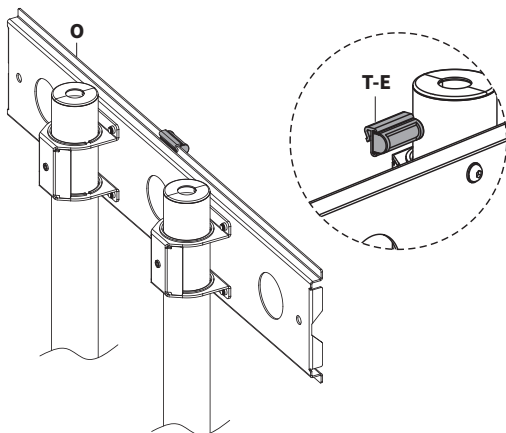

## STEP 7

Secure VESA Bracket Set (**P**) to back of TV using appropriate Screws (**M-A thru M-G**) with Washers (**M-H thru M-J**), and Spacers (**M-K thru M-M**).

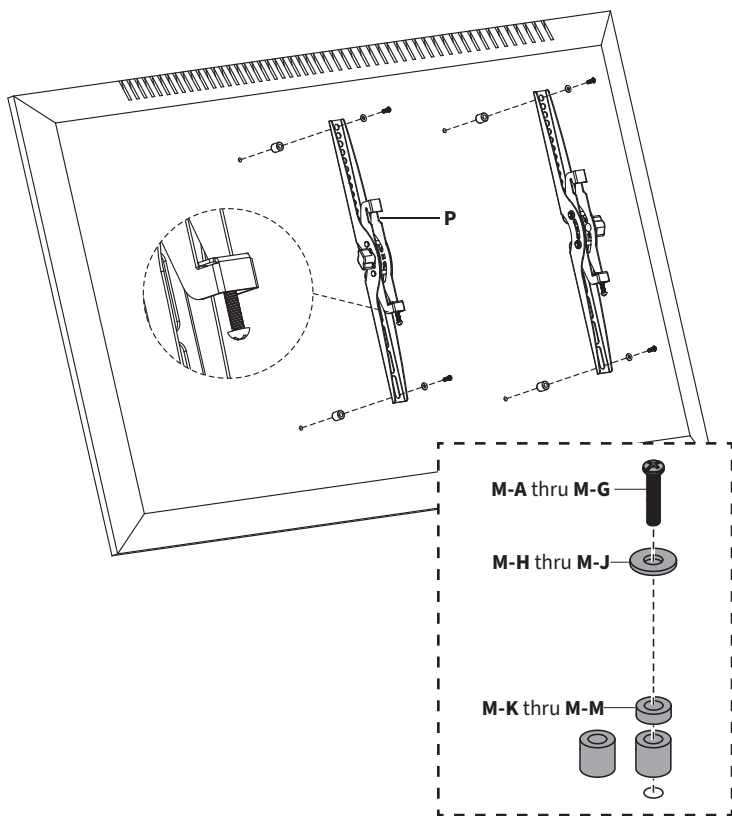



## STEP 8

Make adjustments as necessary to Adapter Brackets (**K**) to level out Mounting Plate (**O**). Tighten set screws on Adapter Brackets (**K**) using 4mm Allen Wrench (**T-B**).

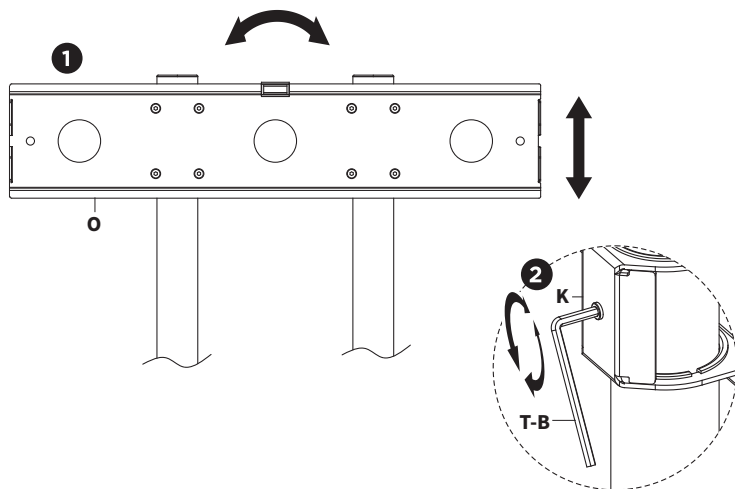

Hang TV with VESA Brackets (**P**) onto Mounting Plate (**O**). Tighten locking screws on VESA Brackets (**P**) using the Phillips end on 5mm Allen Wrench (**T-C**).

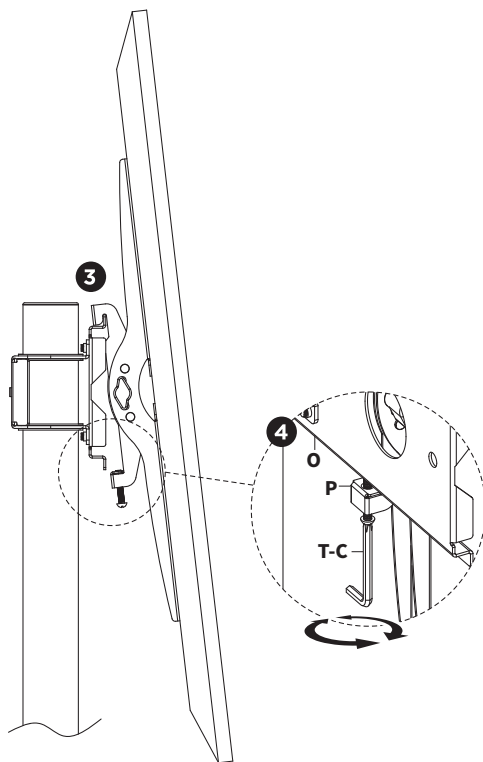

## STEP 9

Attach Shelf Supports (**N**) to Lower Poles (**E**) using M6x10mm Screws (**S-B**) and 4mm Allen Wrench (**T-B**). Do not fully tighten screws yet.

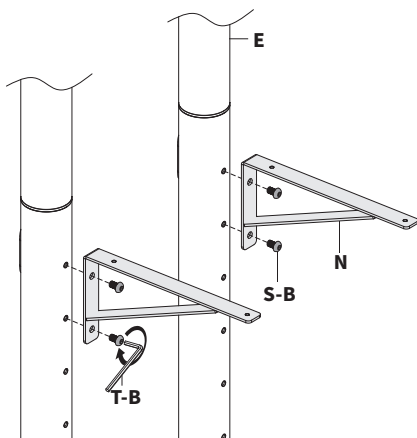

Attach Shelf (**M**) to Shelf Supports (**N**) using M4x6mm Screws (**S-D**) and the Phillips end on 5mm Allen Wrench (**T-C**).

Fully tighten M6x10mm Screws (**S-B**) with 4mm Allen Wrench (**T-B**).

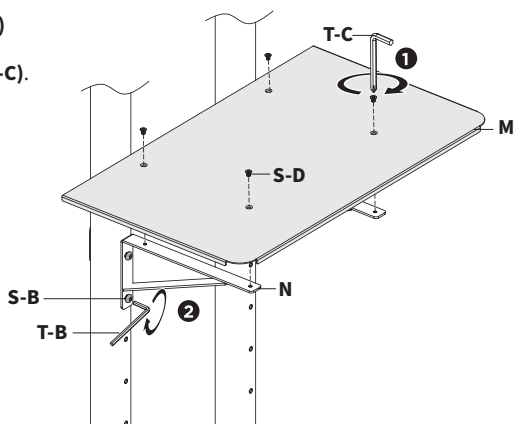

Lift up Base Cover (**D**) and install M5x6mm Set Screws (**S-C**) using 2.5mm Allen Wrench (**T-A**).

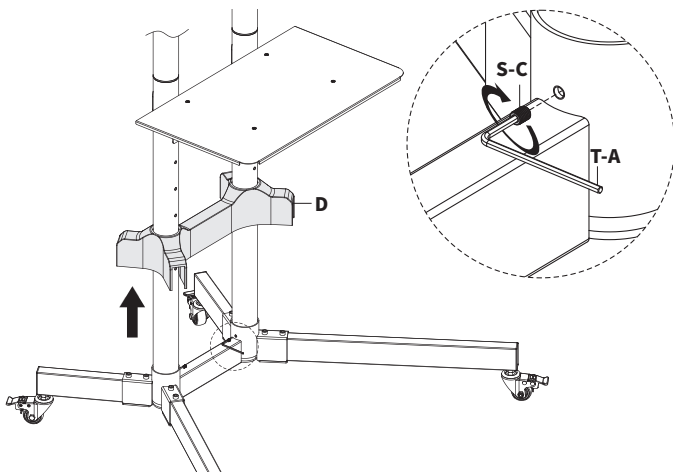

## CABLE MANAGEMENT

Cable manage through the top of Upper Poles (**F**), the slots on Lower Poles (**E**), and through the bottom of Base w/Cover (**C**).

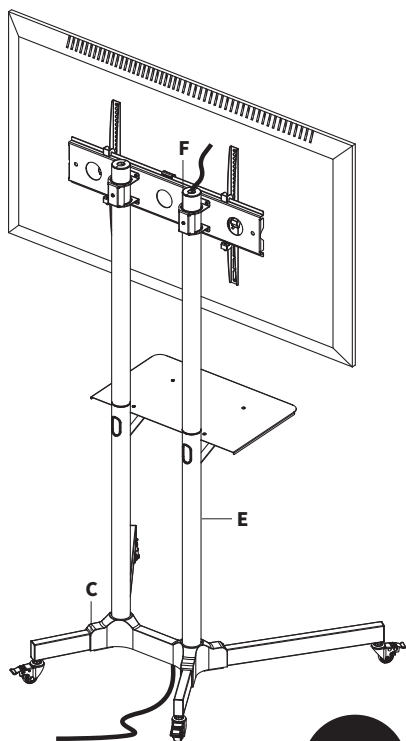

**OR**

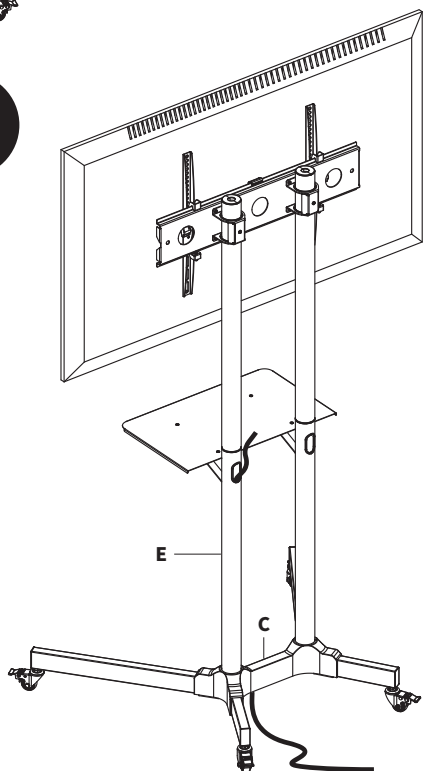



Open **Monday - Friday 7:00am - 7:00pm** CST, our dedicated support team can offer immediate assistance with rapid response times. If any parts are received damaged or defective, please contact us. We are happy to replace parts to ensure you have a fully functioning product.



309-278-5303

**AVG. RESOLUTION TIME** (*within office hrs*): **5M 4S**

---



[www.vivo-us.com](http://www.vivo-us.com)  
*Chat live with an agent!*

**AVG. RESOLUTION TIME** (*within office hrs*): **< 15 M**

---



[help@vivo-us.com](mailto:help@vivo-us.com)

**AVG. RESPONSE TIME** (*within office hrs*): **1HR 8M**

- 23% within < 15m
- 38% within < 30m
- 61% within < 1hr
- 83% within < 2hr
- 92% within < 3hr