

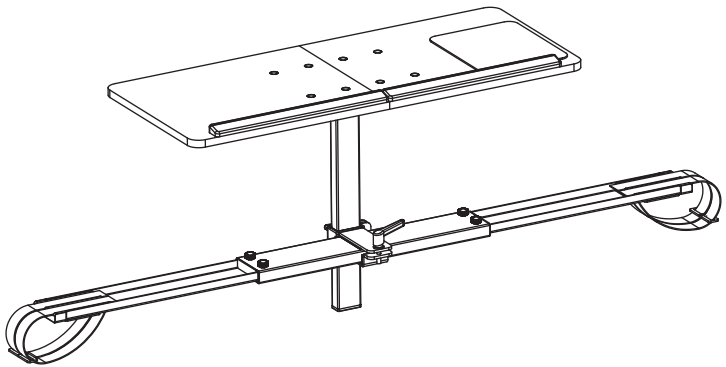

Height Adjustable Laptop Desk for Treadmill Instruction Manual



SKU: STAND-TDML4



Scan the QR code with your mobile device or follow the link for helpful videos and specifications related to this product.

<https://vivo-us.com/products/stand-tdml4>

GET IN TOUCH | Monday-Friday from 7:00am-7:00pm CST



help@vivo-us.com



www.vivo-us.com
Chat live with an agent!



309-278-5303

WARNING!

If you do not understand these directions, or if you have any doubts about the safety of the installation, please call a qualified technician. Check carefully to make sure there are no missing or defective parts. Improper installation may cause damage or serious injury. Do not use this product for any purpose that is not explicitly specified in this manual. Do not exceed weight capacity. We cannot be liable for damage or injury caused by improper mounting, incorrect assembly or inappropriate use.

 **WARNING: CHOKING HAZARD** SMALL PARTS - NOT FOR CHILDREN UNDER 3 YEARS. ADULT SUPERVISION IS REQUIRED.

 **WARNING** THIS MOUNT IS INTENDED FOR USE WHILE WALKING. DO NOT ATTEMPT TO RUN WHILE USING LAPTOP, AS THIS MAY LEAD TO SERIOUS INJURY.

PACKAGE CONTENTS



A (x2)
Crossbar

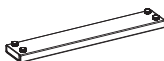

B (x1)
Center Brace



C (x1)
Adjustment
Bracket

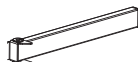

D (x1)
Center Pole

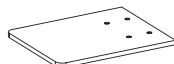

E (x2)
Keyboard Tray

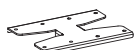

F (x1)
Support Plate



G (x2)
Wrist Pad



H (x1)
Mouse Pad



S-A (x1)
M8x60mm Screw



S-B (x8)
M5x10mm Screw
with Barrel Nut



T-A (x1)
6mm Allen Wrench

8.8lbs
(4kg)

DO NOT EXCEED WEIGHT CAPACITY.
Failure to do so may result in serious injury.

TOOLS NEEDED



**Phillips
Screwdriver**

ASSEMBLY STEPS

STEP 1

Remove the Thumbscrews (**B1**) and End Caps (**B2**) from Center Brace (**B**), and insert the brace into Adjustment Bracket (**C**).

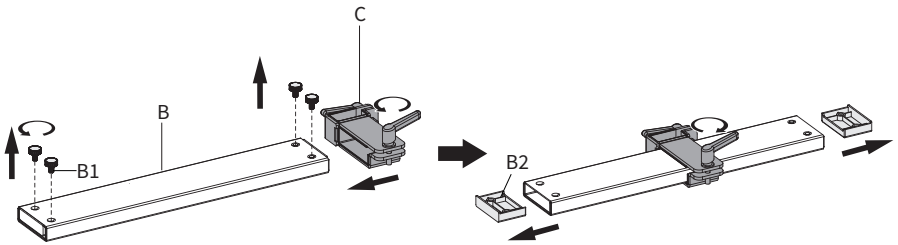

STEP 2

Insert the previously removed End Caps (**B2**) into Crossbars (**A**), and slide the crossbars into Center Brace (**B**).

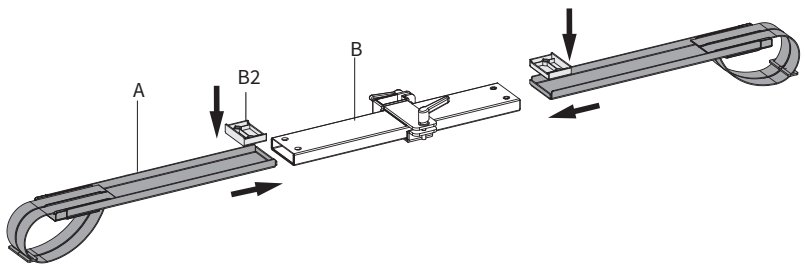

STEP 3

Reinsert the previously removed Thumbscrews (**B1**) back into Center Brace (**B**).

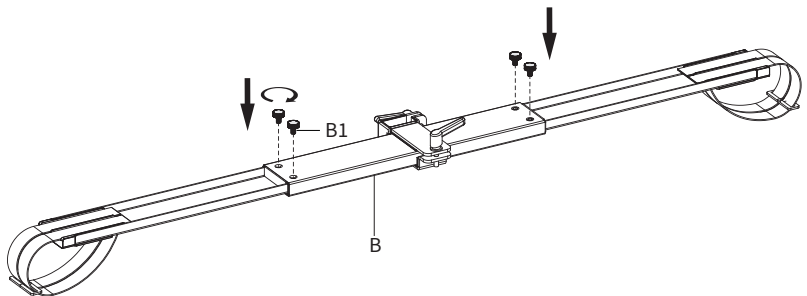

STEP 4

Assemble Support Plate (F) to Center Pole (D) using M8x60mm Screw (S-A) and 6mm Allen Wrench (T-A).

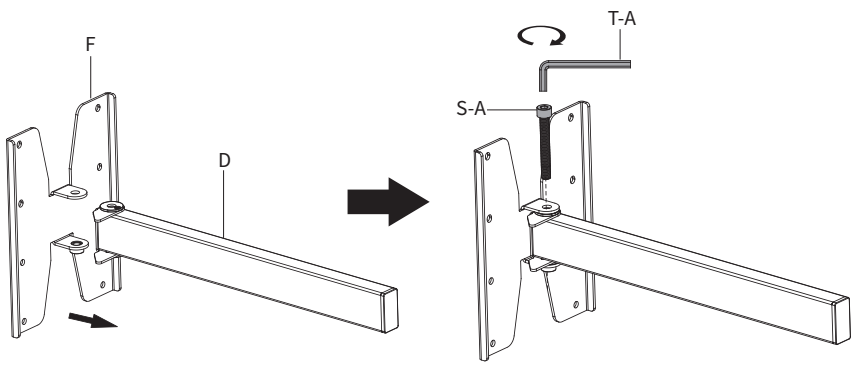

STEP 5

Separate Barrel Nut (S-B1) and Screw (S-B2) from M5x10mm Screw with Barrel Nut (S-B), using a Phillips screwdriver, as shown. Mount Keyboard Trays (E) to Support Plate (F) using Barrel Nuts (S-B1) and Screws (S-B2) and a Phillips screwdriver.

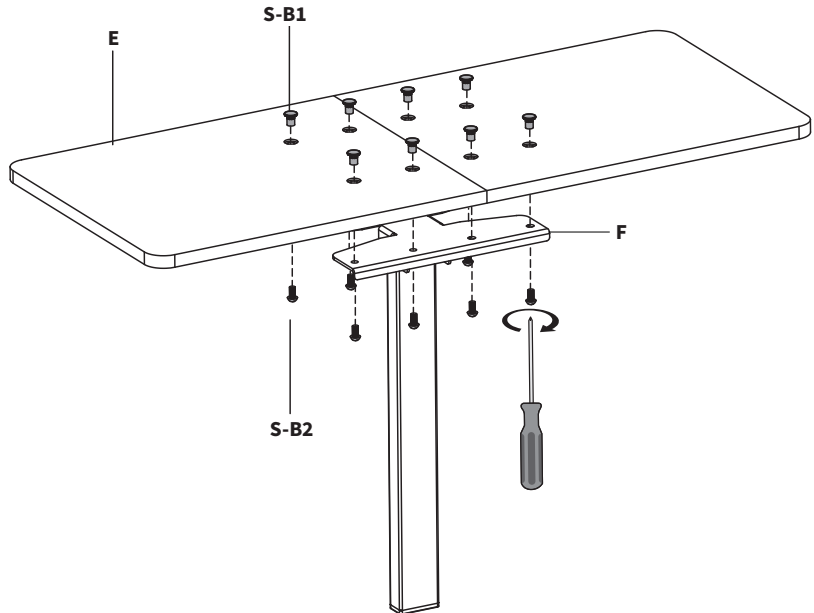
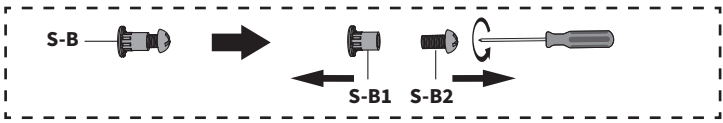

STEP 6

Remove the adhesive backing from Wrist Pads (**G**) and place them on the front edge of Keyboard Trays (**E**).

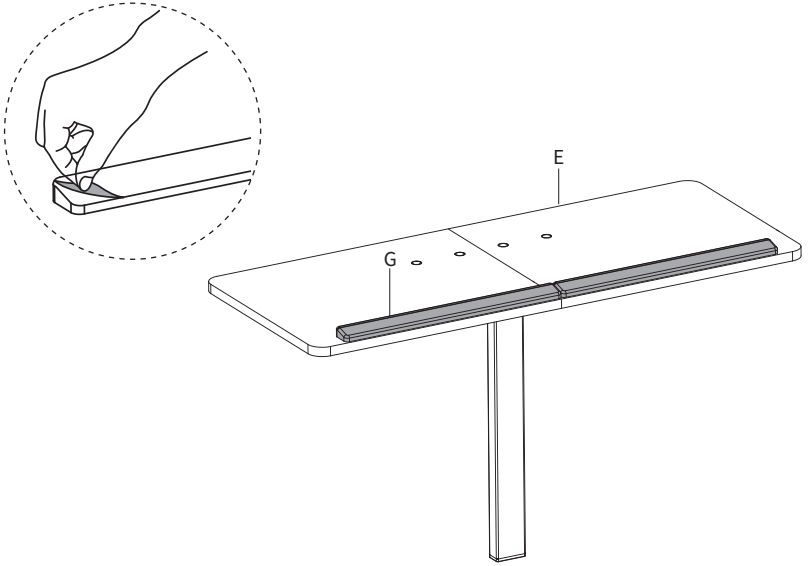

STEP 7

Loosen the knob on the back of Adjustment Bracket (**C**). Then insert Center Pole (**D**) into Adjustment Bracket (**C**).

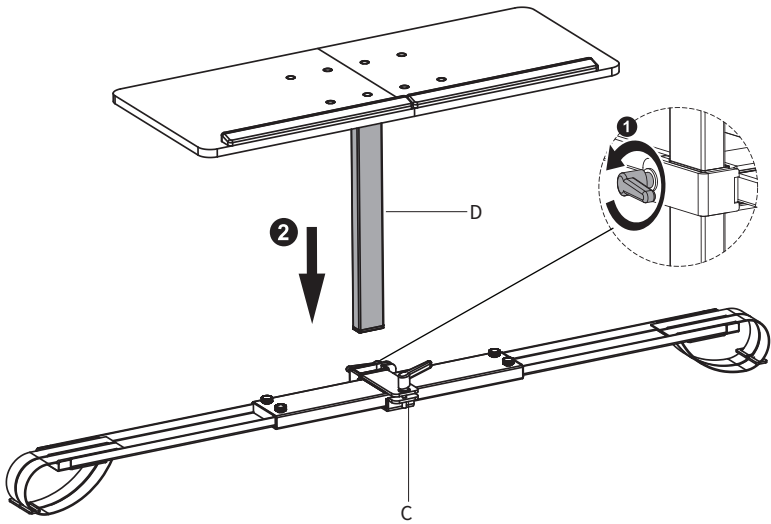

STEP 8

Loosen the thumbscrews on Center Brace (**B**).

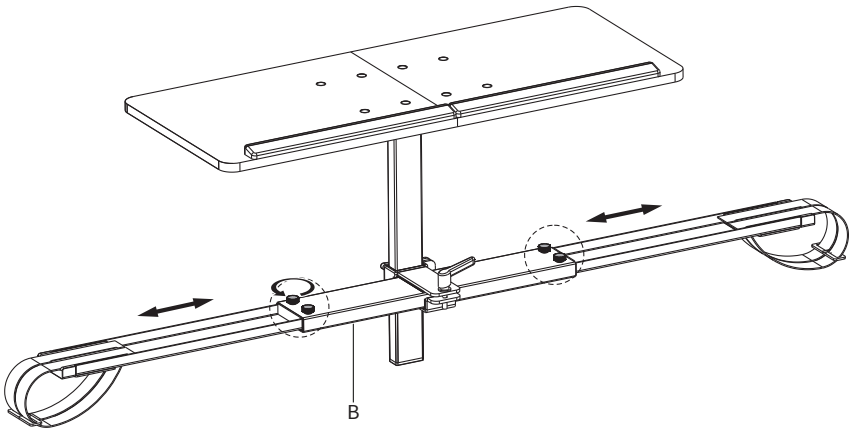

STEP 9

Adjust Crossbars (**A**) to fit the treadmill and then retighten the thumbscrews in Center Brace (**B**) to secure it in place. Tightly fasten the mount to the treadmill's handlebars using the straps on each side of Crossbars (**A**). Place Mouse Pad (**H**) on the tray assembly.

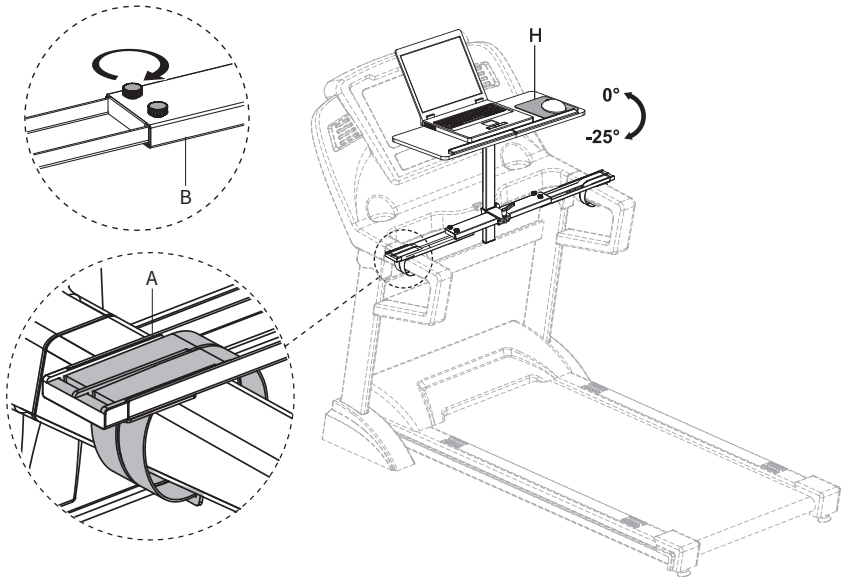

STEP 10

Set the tray assembly at the desired height and tighten the knob on the back of Adjustment Bracket **(C)** to secure it in place.

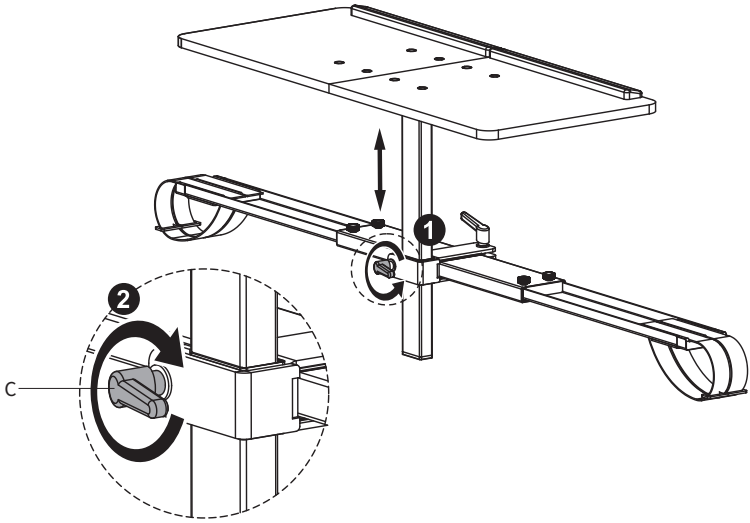

STEP 11

Loosen the adjustment knob on top of Adjustment Bracket **(C)** to center the tray assembly. Once the assembly is in the desired location, retighten the knob.

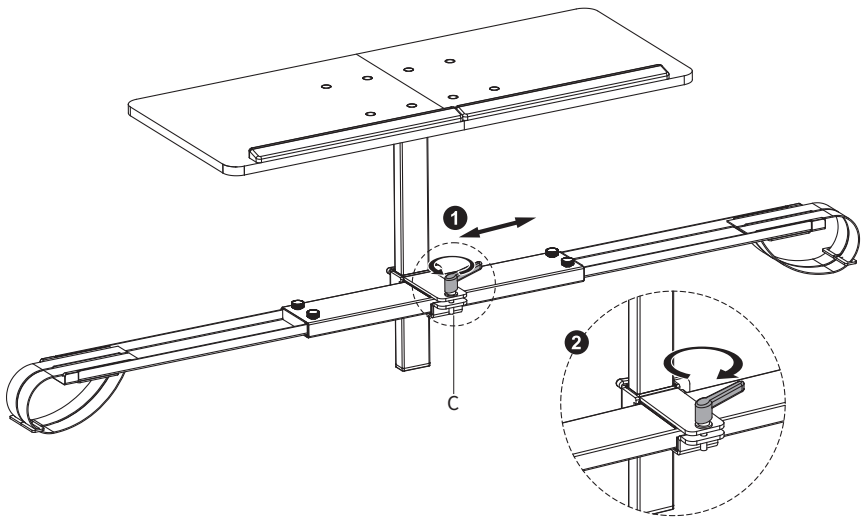



Open **Monday - Friday 7:00am - 7:00pm** CST,
our dedicated support team can offer immediate assistance with rapid response times. If any parts are received damaged or defective, please contact us. We are happy to replace parts to ensure you have a fully functioning product.



309-278-5303

AVG. RESOLUTION TIME (*within office hrs*): **5M 4S**



www.vivo-us.com
Chat live with an agent!

AVG. RESOLUTION TIME (*within office hrs*): **< 15 M**



help@vivo-us.com

AVG. RESPONSE TIME (*within office hrs*): **1HR 8M**

- 23% within < 15m
- 38% within < 30m
- 61% within < 1hr
- 83% within < 2hr
- 92% within < 3hr