

Universal Laptop Desk for Treadmill with Cupholder & Phone Slot

Instruction Manual

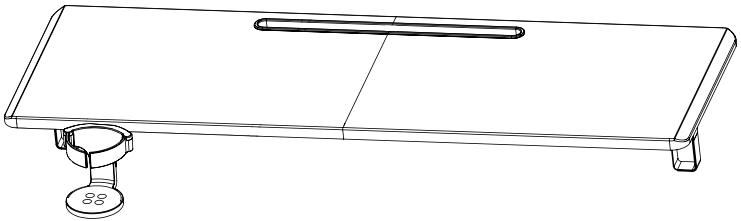

SKU: STAND-TDML2A



Scan the QR code with your mobile device or follow the link for helpful videos and specifications related to this product.

<https://vivo-us.com/products/stand-tdml2a>

GET IN TOUCH | Monday-Friday from 7:00am-7:00pm CST



help@vivo-us.com



www.vivo-us.com
Chat live with an agent!



309-278-5303

WARNING!

If you do not understand these directions, or if you have any doubts about the safety of the installation, please call a qualified technician. Check carefully to make sure there are no missing or defective parts. Improper installation may cause damage or serious injury. Do not use this product for any purpose that is not explicitly specified in this manual and do not exceed weight capacity. We cannot be liable for damage or injury caused by improper mounting, incorrect assembly, or inappropriate use.

WARNING: CHOKING HAZARD

SMALL PARTS - NOT FOR CHILDREN UNDER 3 YEARS. ADULT SUPERVISION IS REQUIRED.

PACKAGE CONTENTS



A (x1)

Keyboard Tray



B (x2)

Connecting Plate



C (x1)

Phone Slot



D (x1)

Cup Holder Bracket



E (x1)

Cup Holder



F (x4)

Rubber Pad



G (x2)

Strap Bracket



H (x2)

Strap

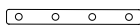

I (x1)

Keyboard Tray
Connector



S-A (x8)

M5x12mm Countersunk
Screw



S-B (x4)

M3x10mm Screw



S-C (x3)

M5x10mm Screw



S-D (x8)

M5x14mm Screw



S-E (x4)

M5x12mm Screw



Phillips
Screwdriver

DO NOT EXCEED WEIGHT CAPACITY.

Failure to do so may result in serious injury.



22lbs
(9.98kg)

Total



3lbs
(1.4kg)

Cup Holder

ASSEMBLY STEPS

STEP 1

Assemble Keyboard Trays (**A**) using Connecting Plates (**B**) with M5x12mm Screws (**S-A**) and Keyboard Tray Connector (**I**) with M5x12mm Screws (**S-E**). Tighten with a Phillips screwdriver.

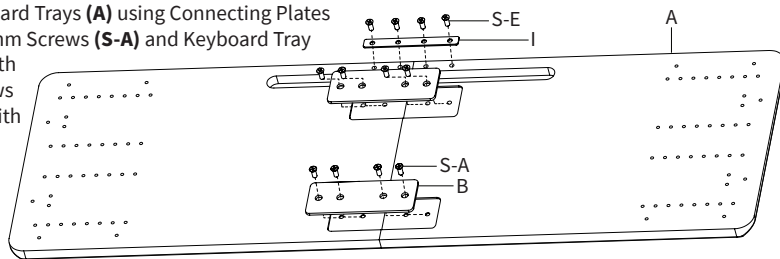

STEP 2

Insert Phone Slot (**C**) into the opening on Keyboard Tray (**A**).

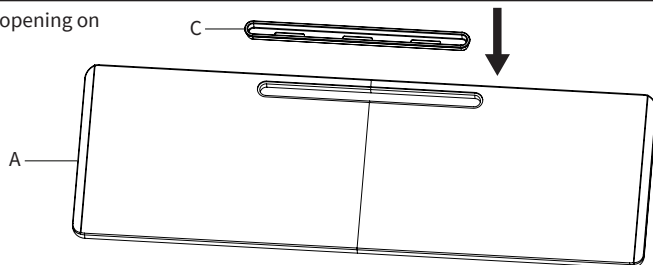

STEP 3

Measure the treadmill handlebar distance, then attach Rubber Pads (F) to Keyboard Tray (A) using M5x14mm Screws (S-D). Tighten with a Phillips screwdriver.

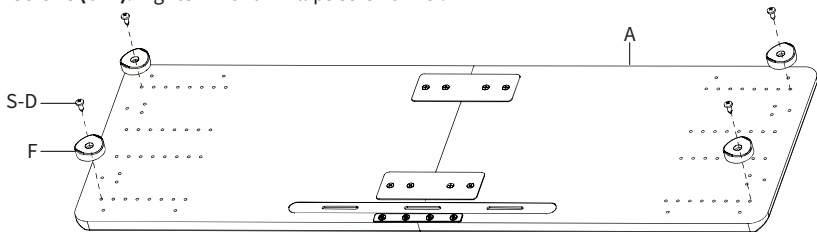

STEP 4

Making sure to match the handlebar distance as closely as possible, mount Strap Brackets (G) to the corresponding middle row holes in Keyboard Tray (A) using M5x14mm Screws (S-D) and a Phillips screwdriver.

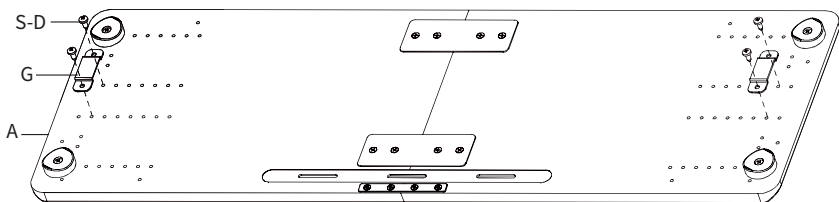

STEP 5

Secure Straps (H) to Strap Brackets (G).

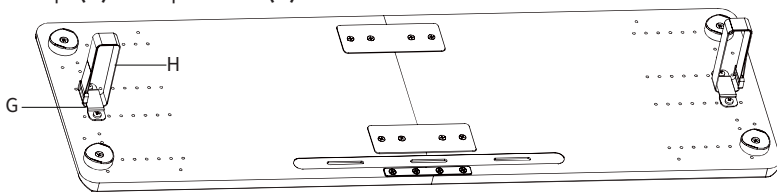

STEP 6

Assemble Cup Holder Bracket (D) to Cup Holder (E) using M3x10mm Screws (S-B) and a Phillips screwdriver. Secure Cup Holder Bracket (D) to Keyboard Tray (A) using M5x10mm Screws (S-C) and a Phillips Screwdriver.

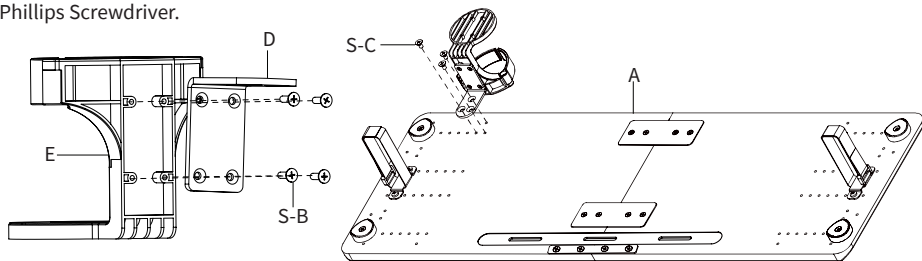

STEP 7

Secure the tray assembly to the treadmill handlebars using Straps (H).

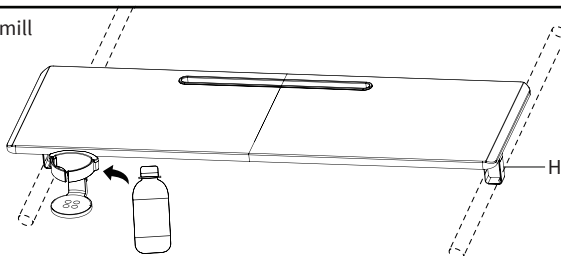



Open **Monday - Friday 7:00am - 7:00pm** CST,
our dedicated support team can offer immediate assistance with rapid response times. If any parts are received damaged or defective, please contact us. We are happy to replace parts to ensure you have a fully functioning product.



309-278-5303

AVG. RESOLUTION TIME (*within office hrs*): **5M 4S**



www.vivo-us.com
Chat live with an agent!

AVG. RESOLUTION TIME (*within office hrs*): **< 15 M**



help@vivo-us.com

AVG. RESPONSE TIME (*within office hrs*): **1HR 8M**

- 23% within < 15m
- 38% within < 30m
- 61% within < 1hr
- 83% within < 2hr
- 92% within < 3hr