

# **Folding Racing Simulator Cockpit**

STAND-RACE2F

Assembly Manual

---



## WARNING



If you do not understand these directions, or if you have any doubts about the safety of the installation, please contact our product support team at 309-278-5303 or [help@vivo-us.com](mailto:help@vivo-us.com) for further assistance. Check carefully to make sure there are no missing or defective parts. Failure to report missing parts within 30 days may result in denial of free replacement. Improper installation may cause damage or serious injury. Do not use this product for any purpose that is not explicitly specified in this manual. Do not exceed weight capacity. We cannot be liable for damage or injury caused by improper mounting, incorrect assembly or inappropriate use.



### WARNING: CHOKING HAZARD

SMALL PARTS - NOT FOR CHILDREN UNDER 3 YEARS. ADULT SUPERVISION IS REQUIRED.



### DO NOT EXCEED WEIGHT CAPACITY

FAILURE TO DO SO MAY RESULT IN SERIOUS INJURY.



### WARNING: PINCH POINT

DO NOT PLACE HANDS ON OR NEAR SUPPORT BARS. MOVING PARTS CAN CRUSH AND CUT.  
FAILURE TO FOLLOW THESE INSTRUCTIONS MAY RESULT IN SERIOUS PERSONAL INJURY.

---

## Need Help? We're Here For You

*US-Based Customer Support from Trained Professionals*

**Monday-Friday from 7am-7pm CST**

**Saturday 8am-4pm CST**



#### Email Us

[help@vivo-us.com](mailto:help@vivo-us.com)



#### Chat with Live Agent

[www.vivo-us.com](http://www.vivo-us.com)



#### Give Us a Call

309-278-5303 ext. 1



Assembly Video & Product Info

[www.vivo-us.com/products/stand-race2f](http://www.vivo-us.com/products/stand-race2f)

## Package Contents



**A (x1)**  
Folding Chair

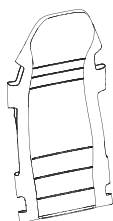

**B (x1)**  
Chair Mesh

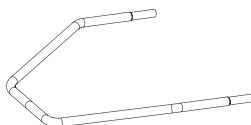

**C (x1)**  
Chair Mesh  
Frame

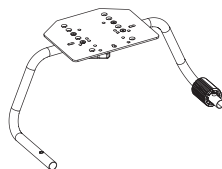

**D (x1)**  
Steering Wheel  
Support



**E (x1)**  
Kickstand

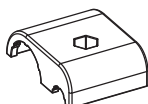

**F (x2)**  
Kickstand  
Bracket

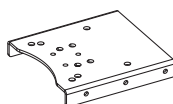

**G (x1)**  
Shifter Mount

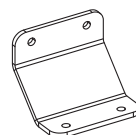

**H (x1)**  
Shifter Bracket

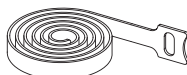

**I (x2)**  
Strap

---

## Included Hardware & Tools

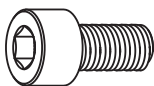

**S-A (x5)**  
M6x12mm  
Screw

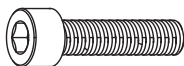

**S-B (x1)**  
M6x25mm  
Screw



**S-C (x1)**  
M6 Nut



**S-D (x1)**  
M6 Washer



**T-A (x1)**  
4mm Allen  
Wrench



**T-B (x1)**  
5mm Allen  
Wrench

### Weight Capacity:



# Assembly Steps

## STEP 1

Install Kickstand (**E**) to the left side of the Folding Chair (**A**) using Kickstand Brackets (**F**), M6x25mm Screw (**S-B**) and M6 Nut (**S-C**). Tighten using 5mm Allen Wrench (**T-B**).

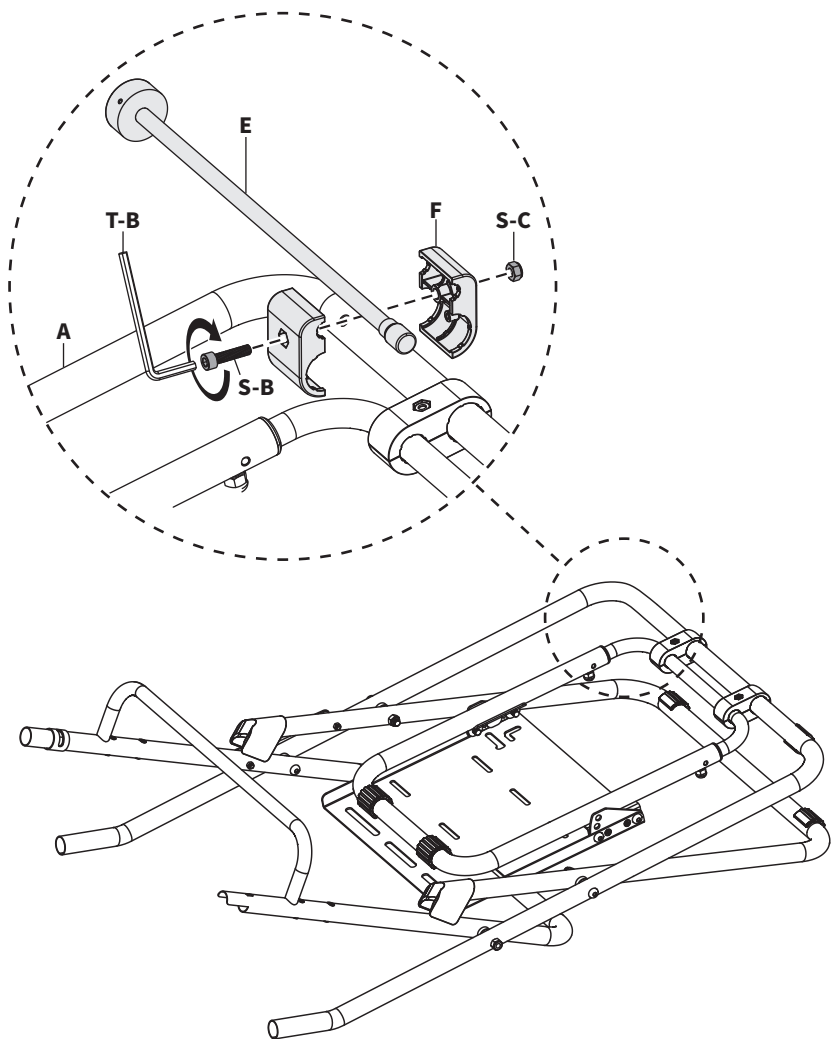

## STEP 2

Extend the Kickstand (**E**) from the Folding Chair (**A**). Unfold the Footrest (**A1**) of the Folding Chair by swinging it forward.

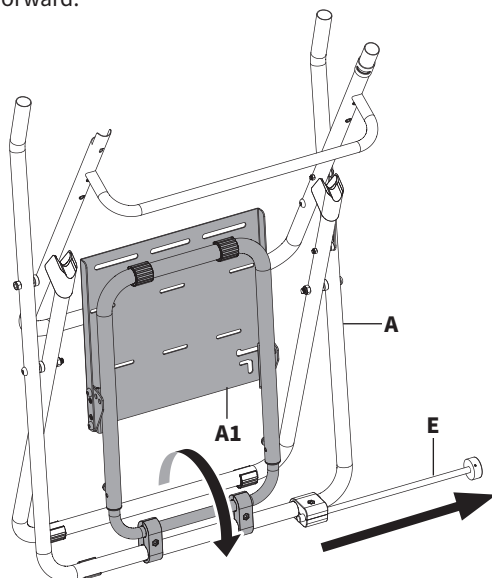

Unfold the Folding Chair (**A**) by grabbing the top as shown and pulling apart.

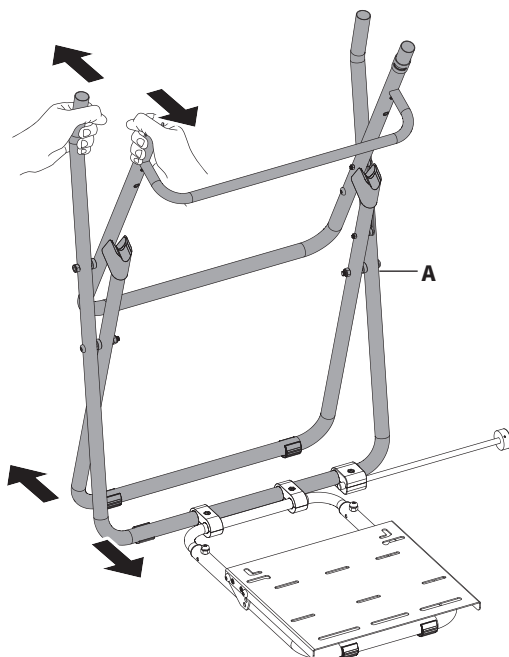

### STEP 3

Insert Steering Wheel Support (**D**) to the front of the Folding Chair (**A**) and secure the left side using M6x12mm Screw (**S-A**), M6 Washer (**S-D**) and 5mm Allen Wrench (**T-B**).

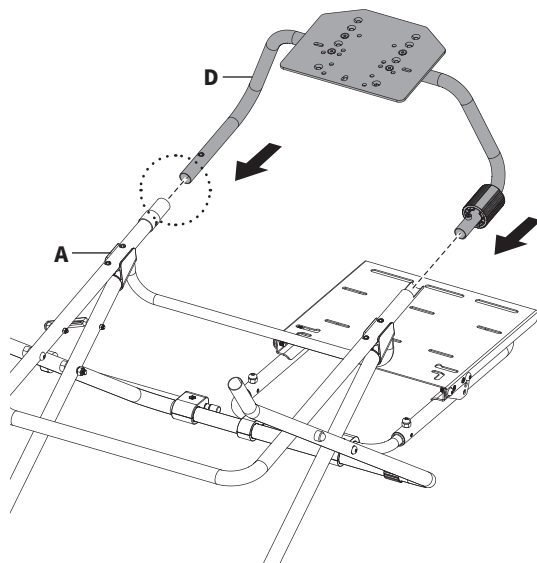
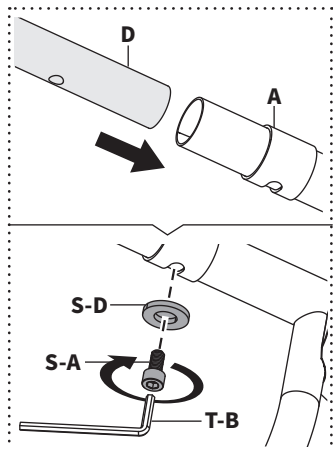

Secure the right side of Steering Wheel Support (**D**) by sliding the smooth side of **Lock** over the **Screw** and rotating outwards.

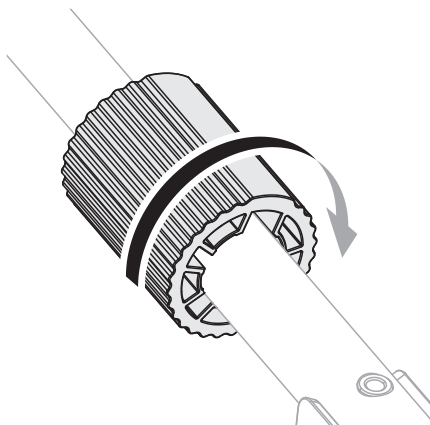
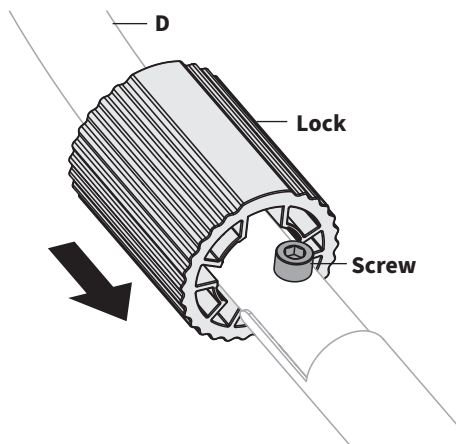

## STEP 4

Attach Shifter Bracket (**H**) to the left or right side of Folding Chair (**A**), then attach Shifter Mount (**G**) to the Shifter Bracket using M6x12mm Screws (**S-A**) and 5mm Allen Wrench (**T-B**).

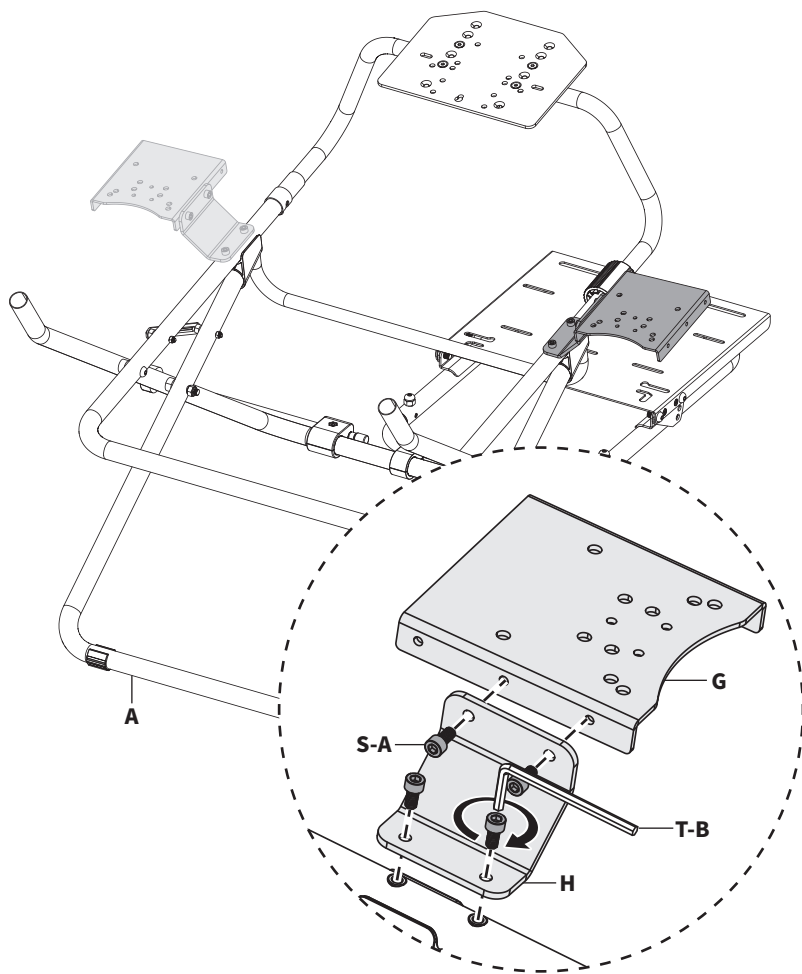

## STEP 5

Insert Chair Mesh Frame (C) into the top of Folding Chair (A).

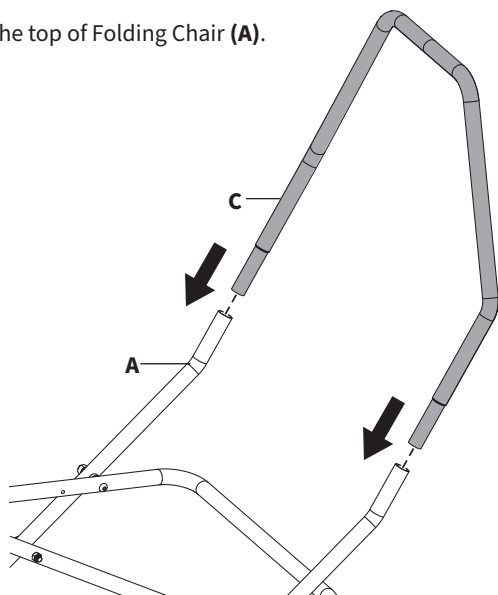

Open the flaps of the Chair Mesh (B).

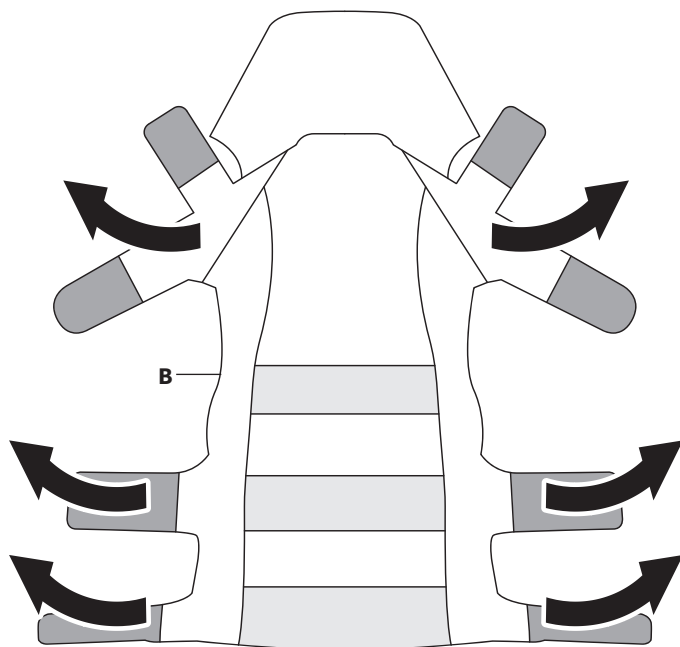

## STEP 6

Place the Chair Mesh (**B**) onto the Folding Chair (**A**) and fasten the velcro straps as shown.

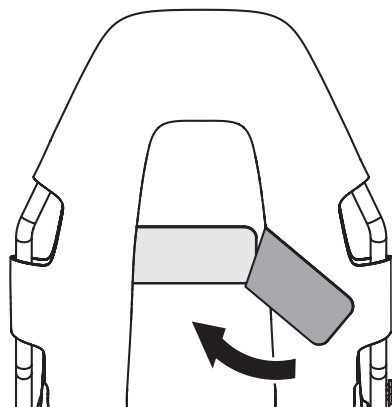
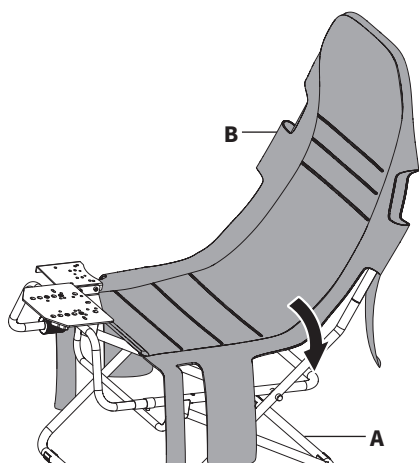

*Fasten straps securely  
for a comfortable fit.*

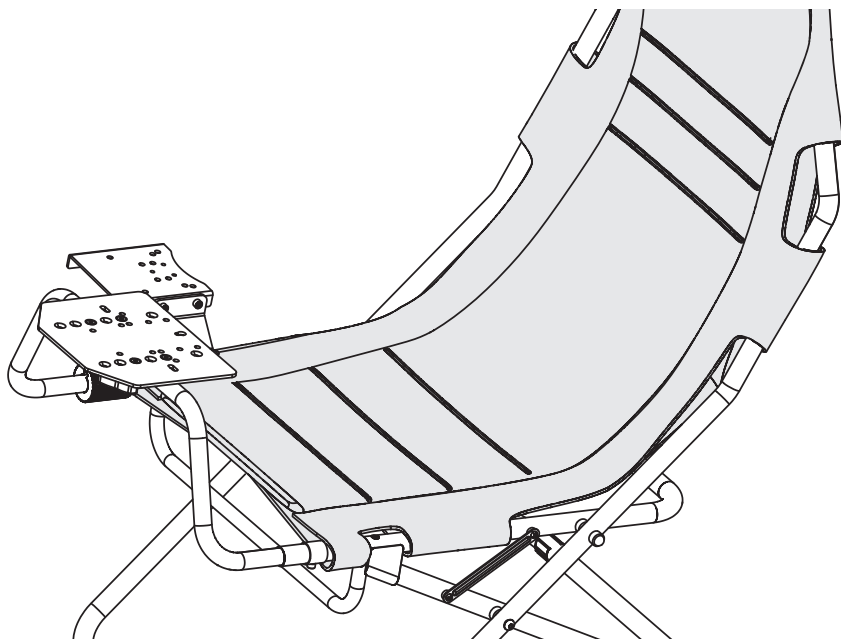

## Accessing the Chair

Turn the **Knob** on the right side inward, then slide it back to unlock.

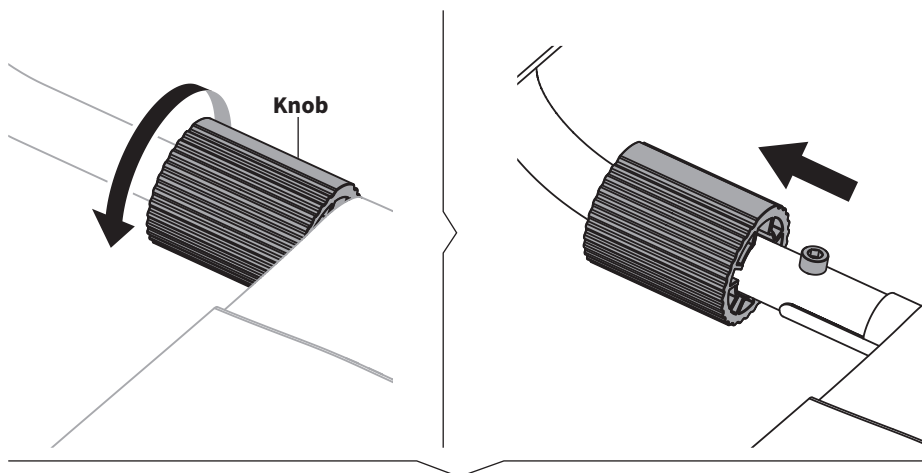

Flip up the Steering Wheel Support (**D**) to access the chair.

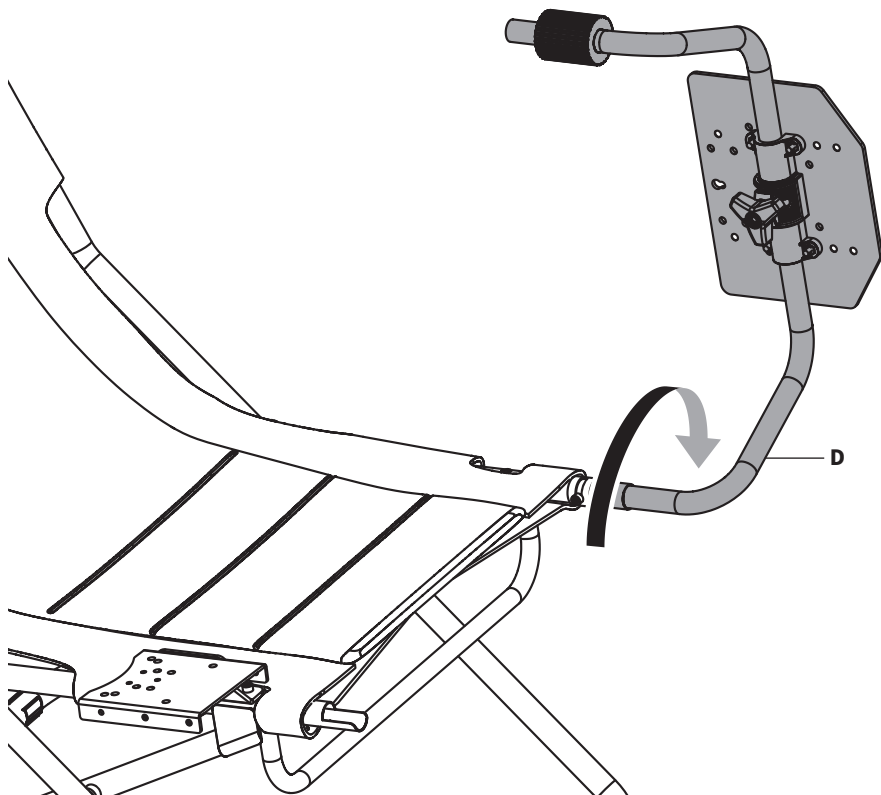

## Adjusting the Pedal Angle

To adjust the foot pedal angle, remove the screws on the sides of foot rest using 5mm Allen Wrench (**T-B**), line up the holes at the desired angle, then reinstall the previously removed screws.

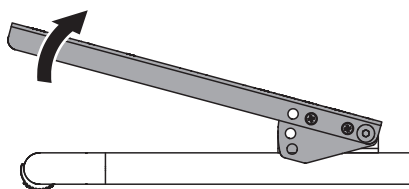
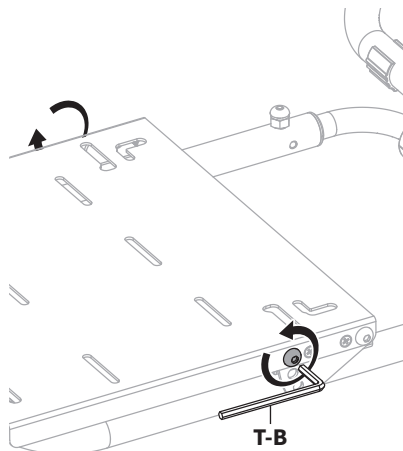

OR

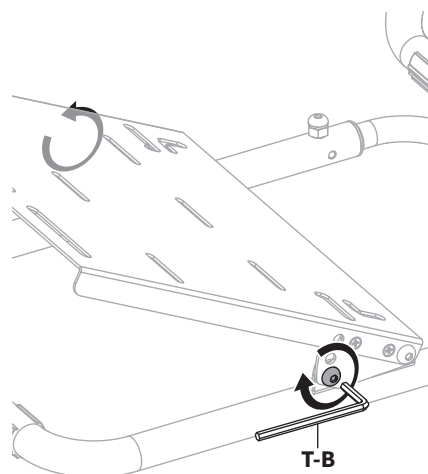
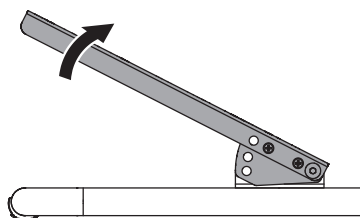

## Adjusting the Pedal Length

To adjust the pedal length, loosen the screws on the top of the footrest using 5mm Allen Wrench (**T-B**), adjust the footrest to the desired length, then retighten the screws.

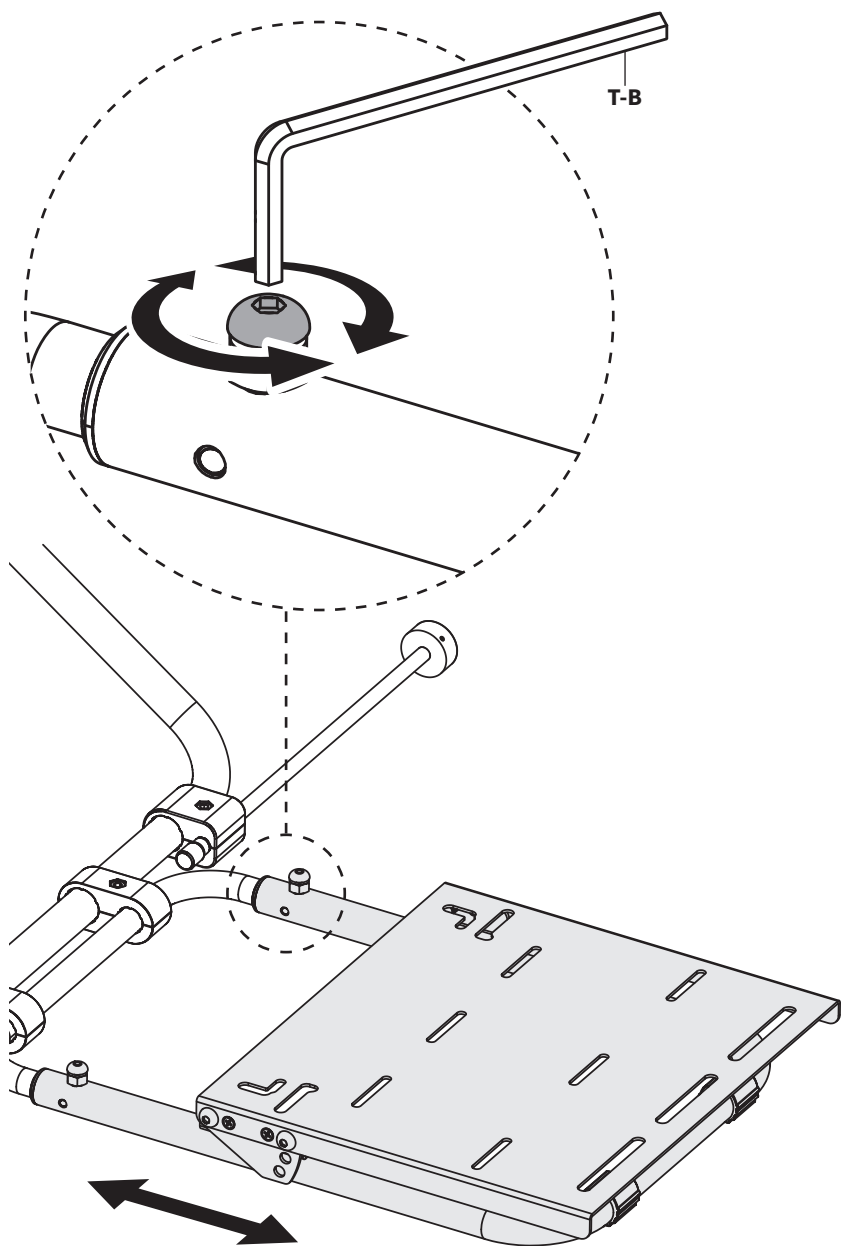

## Adjusting the Steering Wheel Angle

To adjust the steering wheel angle, loosen the **Knob** on the underside of the Steering Wheel Support (**D**), adjust the angle then retighten the **Knob**.

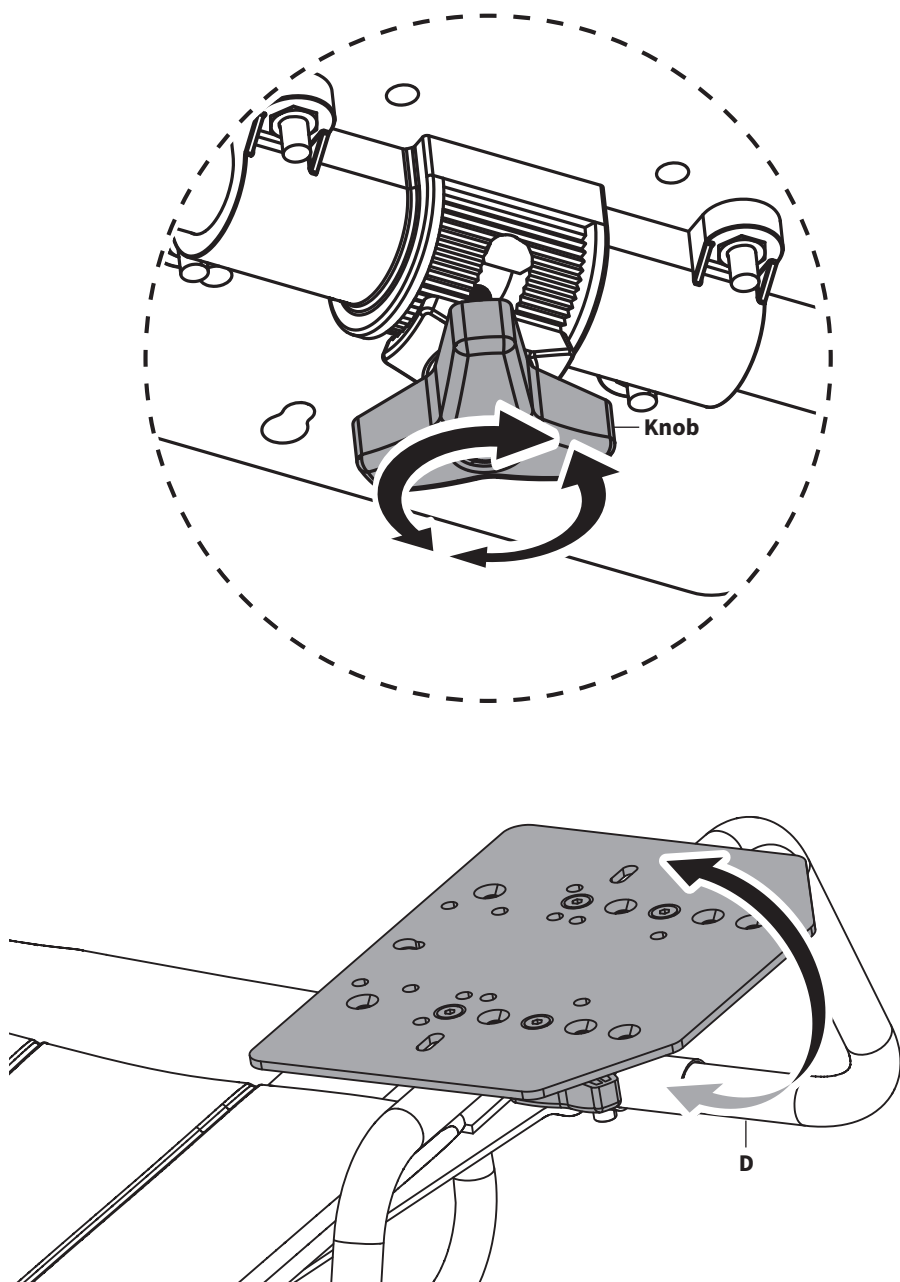

## Adjusting the Steering Wheel Position

To adjust the steering wheel position, remove the preinstalled screws and nuts from Mounting Plate (**D1**) using 4mm Allen Wrench (**T-A**).

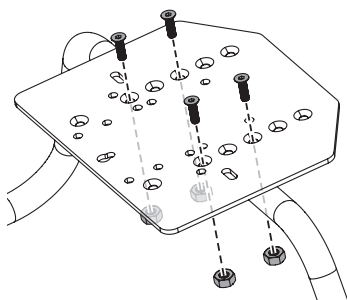
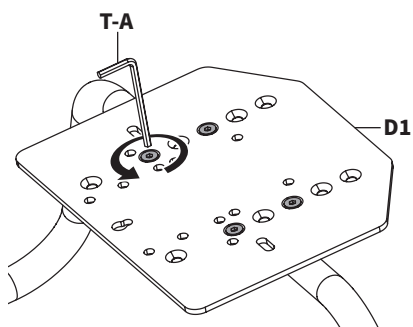

Reposition the Mounting Plate (**D1**) and reinstall the previously removed screws and nuts using 4mm Allen Wrench (**T-A**).

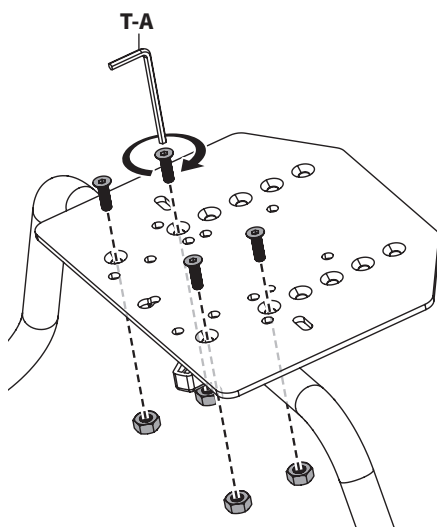
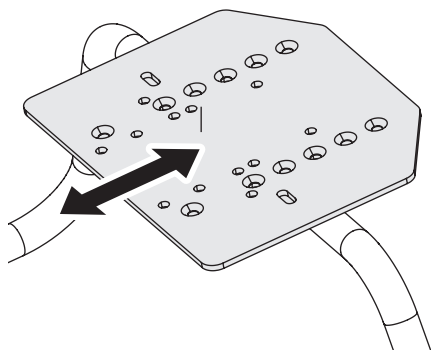

## Stowing the Chair

Pull together the Folding Chair (**A**) to fold and secure using Strap (**I**).

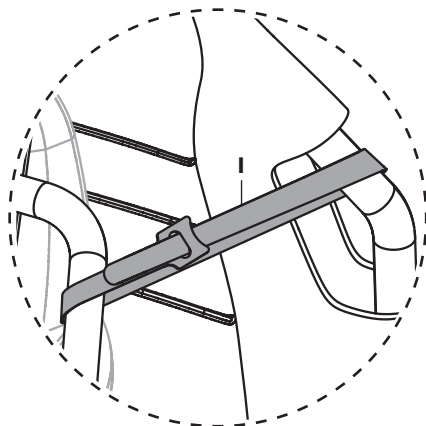
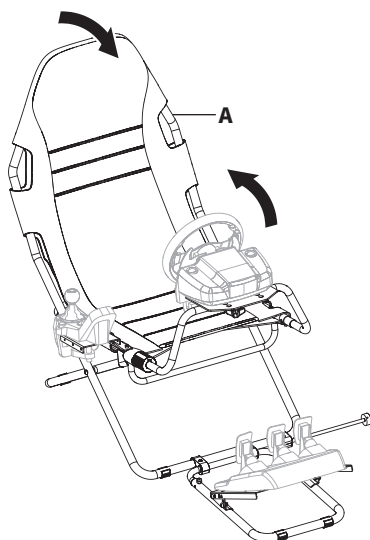

Push in the Kickstand (**E**), fold up the pedal and secure using Strap (**I**). The pedal may need to be extended to be secured. Follow the steps on **Adjusting the Pedal Length** on page 12 to extend the pedal.

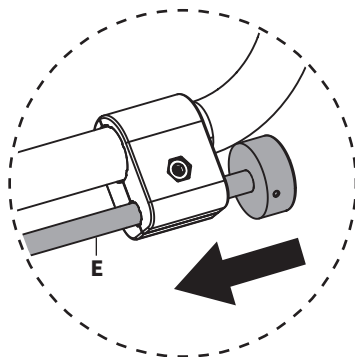
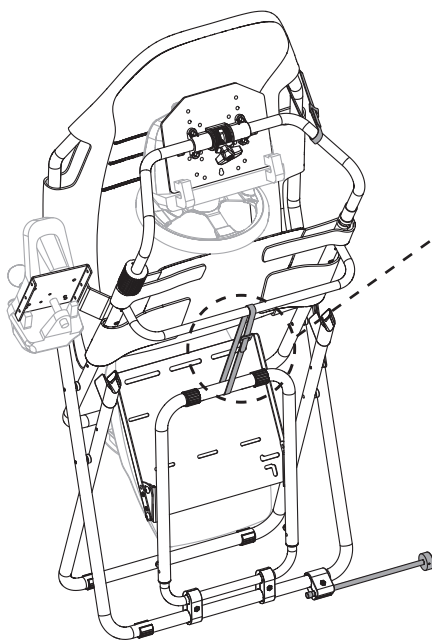



## Need Help? **We're Here For You**

Monday-Friday from 7am-7pm CST  
Saturday 8am-4pm CST



Email Us  
[help@vivo-us.com](mailto:help@vivo-us.com)



Chat with Live Agent  
[www.vivo-us.com](http://www.vivo-us.com)



Give Us a Call  
309-278-5303 ext. 1



VIVO-us



@vivo\_us



@VIVOus



VIVO

FOR MORE GREAT VIVO PRODUCTS,  
CHECK OUT OUR WEBSITE AT: [WWW.VIVO-US.COM](http://WWW.VIVO-US.COM)