

---

## Black Height Adjustable Hand Sanitizer Stand Instruction Manual

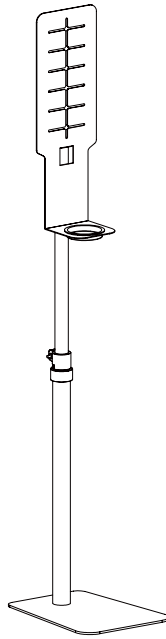

**SKU: STAND-HS01**



Scan the QR code with your mobile device or follow the link for helpful videos and specifications related to this product.

<https://vivo-us.com/products/stand-hs01>

---

GET IN TOUCH | Monday-Friday from 7:00am-7:00pm CST



help@vivo-us.com



www.vivo-us.com  
*Chat live with an agent!*



309-278-5303

# **WARNING!**

If you do not understand these directions, or if you have any doubts about the safety of the installation, please call a qualified technician. Check carefully to make sure there are no missing or defective parts. Improper installation may cause damage or serious injury. Do not use this product for any purpose that is not explicitly specified in this manual. Do not exceed weight capacity. We cannot be liable for damage or injury caused by improper mounting, incorrect assembly or inappropriate use.

## PACKAGE CONTENTS

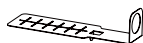

**A** (x1)  
Mount



**B** (x1)  
Drip Tray



**C** (x1)  
Pole



**D** (x1)  
Base



**E** (x3)  
M6x16



**F** (x2)  
M6x16



**G** (x1)  
4mm Allen  
Wrench



**H** (x2)  
Tape



**I** (x4)  
M4x12



**J** (x4)  
15x5.3x1.2  
Washer



**K** (x4)  
M4 Nut

## **WARNING: CHOKING HAZARD**

SMALL PARTS - NOT FOR CHILDREN UNDER 3 YEARS.  
ADULT SUPERVISION IS REQUIRED.

## TOOLS NEEDED



**Phillips  
Screwdriver**

## ASSEMBLY STEPS

### STEP 1

Loosen the knob on the pole (**C**) and extend it out about 12" and re-tighten the knob. This height can be adjusted after fully assembled. Mount the pole (**C**) to the base (**D**) using M6x16 flat head bolts (**E**). Tighten with the Allen wrench (**G**).

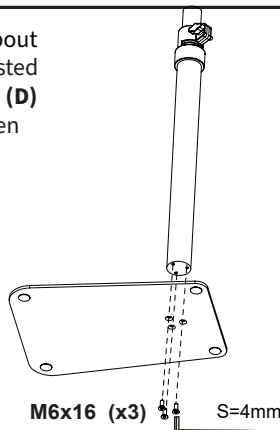

## STEP 2

Place the mounting tab of the mount (A) on top of the pole (C) and secure the mount to the pole using M6x16 bolts (F). Tighten with the Allen wrench (G). Place the drip tray (B) into the hole of the drip tray holder.

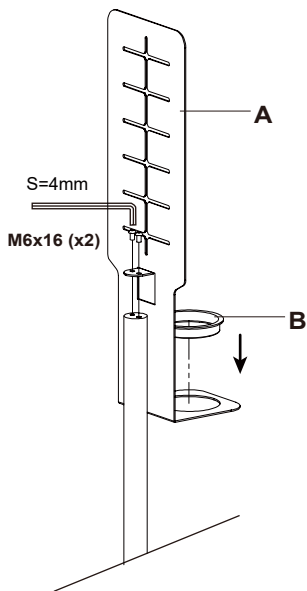

## STEP 3

Partially install M4x12 bolts (I) with washers (J) and M4 nuts (K) to the mount (A), making sure bolts will align with the holes in the dispenser.

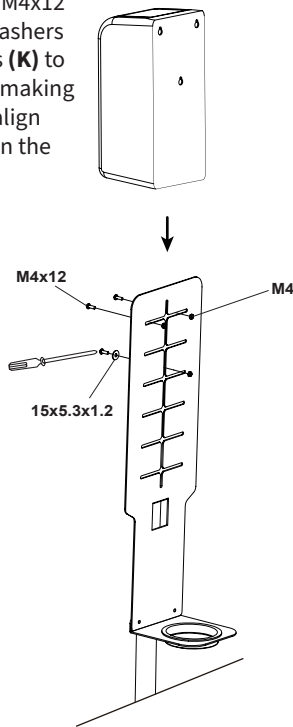

## STEP 4

Hang dispenser over installed bolts onto the front of the mount (A), and tighten with a Phillips screwdriver. If necessary, double sided tape (H) may first be installed to the back of the dispenser for additional support.

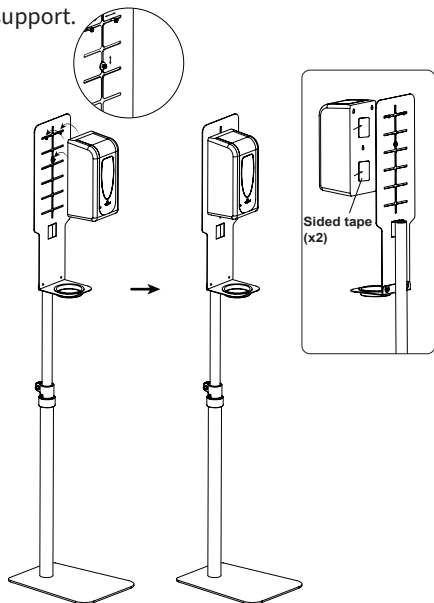



Open **Monday - Friday 7:00am - 7:00pm** CST,  
our dedicated support team can offer immediate assistance with rapid response times. If any parts are received damaged or defective, please contact us. We are happy to replace parts to ensure you have a fully functioning product.

 [help@vivo-us.com](mailto:help@vivo-us.com)

**AVG. RESPONSE TIME** (*within office hrs*): **1HR 8M**

- 23% within < 15m
- 38% within < 30m
- 61% within < 1hr
- 83% within < 2hr
- 92% within < 3hr

 [www.vivo-us.com](http://www.vivo-us.com)  
*Chat live with an agent!*

**AVG. RESOLUTION TIME** (*within office hrs*): **< 15 M**

 309-278-5303

**AVG. RESOLUTION TIME** (*within office hrs*): **5M 4S**