

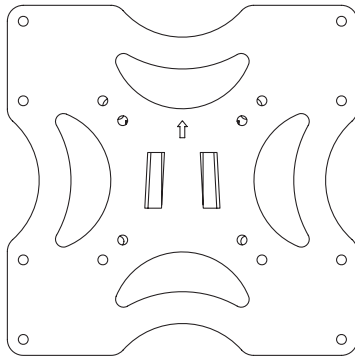

---

## TV VESA Wall Mount

### Instruction Manual



**SKU: MOUNT-VW2X2A**



Scan the QR code with your mobile device or follow the link for helpful videos and specifications related to this product.

<https://vivo-us.com/products/mount-vw2x2a>

---

GET IN TOUCH | Monday-Friday from 7:00am-7:00pm CST



help@vivo-us.com



www.vivo-us.com  
*Chat live with an agent!*



309-278-5303

 **WARNING!**

If you do not understand these directions, or if you have any doubts about the safety of the installation, please call a qualified technician. Check carefully to make sure there are no missing or defective parts. Improper installation may cause damage or serious injury. Do not use this product for any purpose that is not explicitly specified in this manual. Do not exceed weight capacity. We cannot be liable for damage or injury caused by improper mounting, incorrect assembly or inappropriate use.

 **WARNING: CHOKING HAZARD**

SMALL PARTS - NOT FOR CHILDREN UNDER 3 YEARS. ADULT SUPERVISION IS REQUIRED.

**PACKAGE CONTENTS**



**A1** (x4)  
M4x12 Screw

**A2** (x4)  
M4x30 Screw

**B1** (x4)  
M6x12 Screw

**B2** (x4)  
M6x30 Screw

**C1** (x4)  
Spacer



**C2** (x4)  
M8x16 Screw

**D1** (x4)  
ST6x50 Screw

**D2** (x4)  
Concrete Anchor

**E** (x1)  
VESA Plate

**F** (x1)  
Wall Plate

 **CAUTION!**

DO NOT INSTALL INTO DRYWALL ALONE. VERIFY YOUR WALL CONSTRUCTION. USE WOOD STUDS TO MOUNT. We include mounting for brick and concrete walls. If unsure, please contact us at vivo-us.com, email at help@vivo-us.com, or call us at 309-278-5303.

**TOOLS NEEDED**



**Drill**



**Phillips  
Screwdriver**

**DO NOT EXCEED WEIGHT CAPACITY.**

Failure to do so may result in serious injury.



# ASSEMBLY STEPS

## STEP 1

### OPTION A: Wood Stud Installation

Using Wall Plate (F) as a guide, mark drilling locations on wall. Use of a stud finder is recommended if wall is not a solid wood panel, and at least 2 holes should align directly to stud. Drill 2" (50mm) deep holes using a 1/8" (3mm) drill bit, and mount wall plate using ST6x50 Screws (D1). Arrow on wall plate must be facing up.

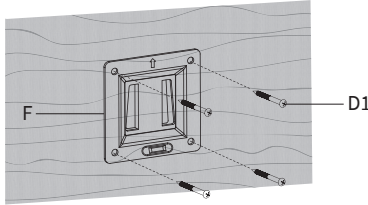

### OPTION B: Concrete/Brick Installation

Using Wall Plate (F) as a guide, mark drilling locations on wall. Drill 2" (50mm) deep holes using a 5/16" (8mm) drill bit, press Concrete Anchors (D2) into holes, and mount wall plate using ST6x50 Screws (D1). Arrow on wall plate must be facing up.

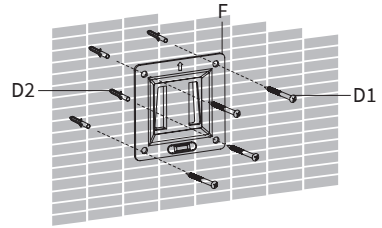

## STEP 2

### OPTION A: Flat Back TV

Attach VESA Plate (E) to back of TV using M4x12 Screws (A1), M6x12 Screws (B1) or M8x16 Screws (C2). Arrow on VESA plate must be facing up.

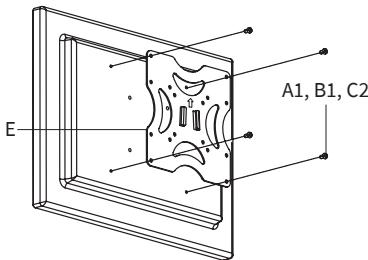
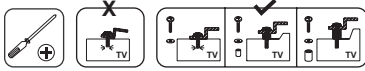

### OPTION B: Curved Back TV

For curved back TV, attach VESA Plate (E) to back of TV using M4x30 Screws (A2) or M6x30 Screws (B2) with Spacers (C1). Arrow on VESA plate must be facing up.

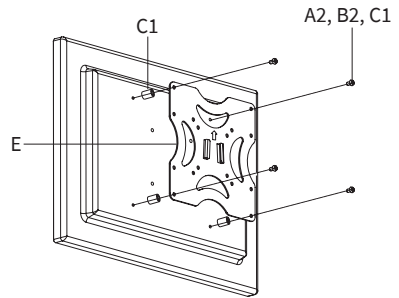

## STEP 3

Slide TV with VESA Plate (E) onto Wall Plate (F).

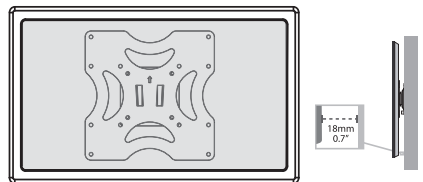
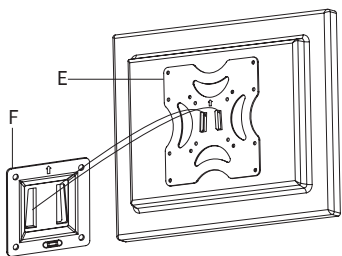



Open **Monday - Friday 7:00am - 7:00pm** CST, our dedicated support team can offer immediate assistance with rapid response times. If any parts are received damaged or defective, please contact us. We are happy to replace parts to ensure you have a fully functioning product.



309-278-5303

**AVG. RESOLUTION TIME** (*within office hrs*): **5M 4S**



[www.vivo-us.com](http://www.vivo-us.com)  
*Chat live with an agent!*

**AVG. RESOLUTION TIME** (*within office hrs*): **< 15 M**



[help@vivo-us.com](mailto:help@vivo-us.com)

**AVG. RESPONSE TIME** (*within office hrs*): **1HR 8M**

- 23% within < 15m
- 38% within < 30m
- 61% within < 1hr
- 83% within < 2hr
- 92% within < 3hr