

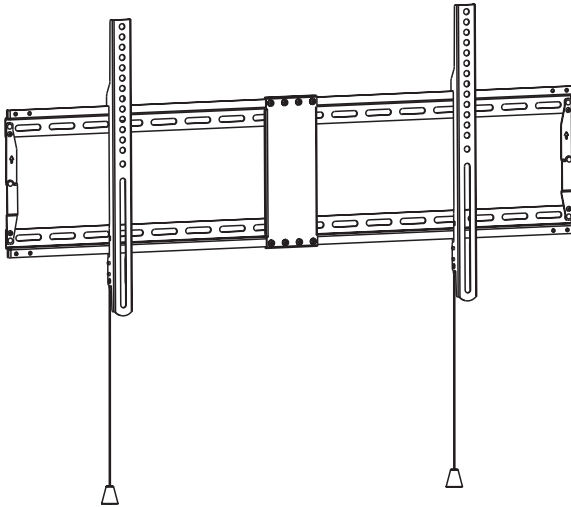

---

## Ultra Heavy Duty TV Wall Mount

### Instruction Manual



**SKU: MOUNT-VW090F**



Scan the QR code with your mobile device or follow the link for helpful videos and specifications related to this product.

<https://vivo-us.com/products/mount-vw090f>

---

GET IN TOUCH | Monday-Friday from 7:00am-7:00pm CST



help@vivo-us.com



www.vivo-us.com  
*Chat live with an agent!*



309-278-5303

# **WARNING!**

If you do not understand these directions, or if you have any doubts about the safety of the installation, please call a qualified technician. Check carefully to make sure there are no missing or defective parts. Improper installation may cause damage or serious injury. Do not use this product for any purpose that is not explicitly specified in this manual. Do not exceed weight capacity. We cannot be liable for damage or injury caused by improper mounting, incorrect assembly or inappropriate use.

## **WARNING: CHOKING HAZARD**

SMALL PARTS - NOT FOR CHILDREN UNDER 3 YEARS. ADULT SUPERVISION IS REQUIRED.

## PACKAGE CONTENTS

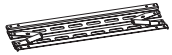

**A (x2)**  
Mount



**B (x1)**  
Center Plate



**C (x8)**  
M5x6



**D (x2)**  
VESA Bracket



**E (x8)**  
M4x6



**F (x1)**  
Bubble Level



**M-A (x4)**  
M5x14



**M-B (x4)**  
M6x14



**M-C (x4)**  
M6x30



**M-D (x4)**  
M8x30



**M-E (x4)**  
M8x50



**M-F (x4)**  
D5 Washer



**M-G (x4)**  
D8 Washer



**M-H (x8)**  
5mm Spacer



**M-I (x8)**  
15mm Spacer



**W-A (x6)**  
Bolt



**W-B (x6)**  
Anchors



**W-C (x6)**  
Washer

**NOTE:** SOME HARDWARE INCLUDED MAY NOT BE USED

## **CAUTION!**

DO NOT INSTALL INTO DRYWALL ALONE. VERIFY YOUR WALL CONSTRUCTION. USE WOOD STUDS TO MOUNT. We include mounting for brick and concrete walls. If unsure, please contact us at vivo-us.com, email at [help@vivo-us.com](mailto:help@vivo-us.com), or call us at 309-278-5303.

## TOOLS NEEDED



Drill



Phillips  
Screwdriver

**DO NOT EXCEED WEIGHT CAPACITY.**

Failure to do so may result in serious injury.



# ASSEMBLY STEPS

## STEP 1

Extend Mounts **(A)** to full height and secure vertical arms with M4x6mm Bolts **(E)**.  
Assemble mounts using Center Plate **(B)** and M5x6mm Bolts **(C)**.

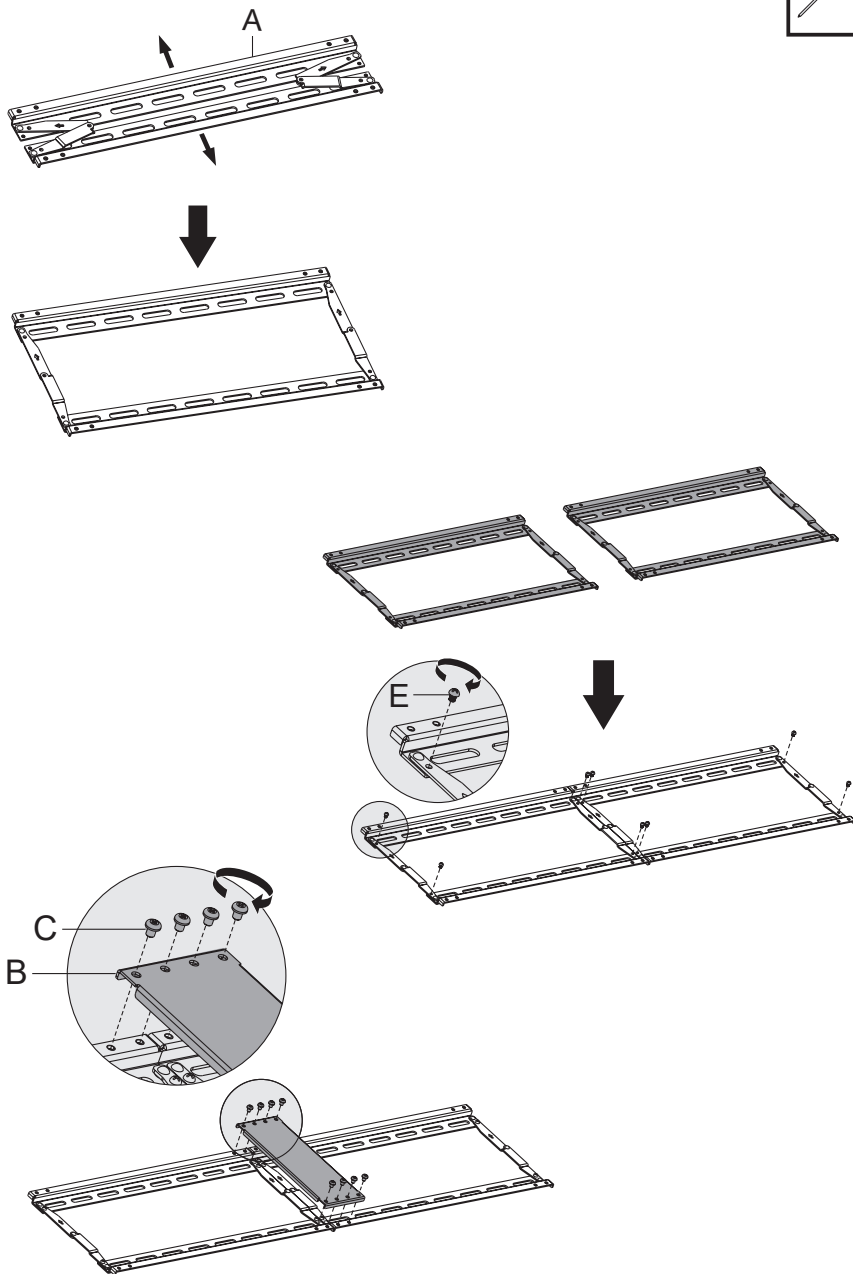

# STEP 2

## OPTION A: Wood Wall

Use mount (A) with Bubble Level (F) to mark drilling locations on wall where studs are located. Using a 5/32" (4mm) drill bit, drill holes at least 2.2" (55mm) deep into marked locations. Secure Mount to wall using Bolts (W-A) and Washers (W-C).

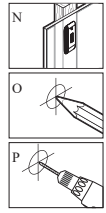
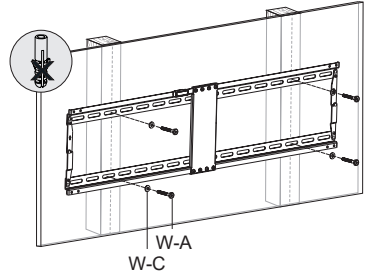
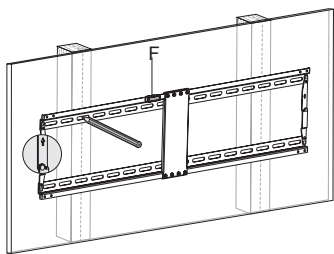
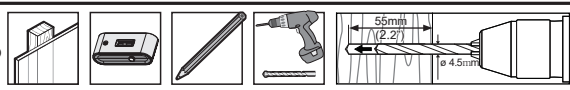

## OPTION B: Concrete/Brick Wall

Use mount (A) with Bubble Level (F) to mark drilling locations on wall. Using a 3/8" (10mm) drill bit, drill holes at least 2.4" (60mm) deep into marked locations and insert Anchors (W-B). Secure Mount to wall using Bolts (W-A) and Washers (W-C).

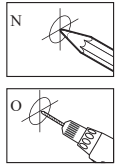
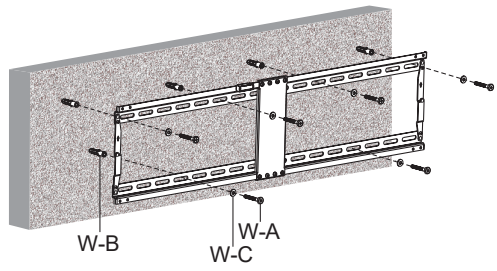
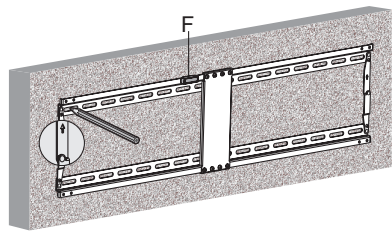
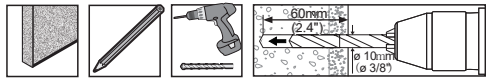

# STEP 3

## OPTION A: Flat Back TV

Attach VESA Brackets (D) to back of TV using Bolts (M-A, M-B) and Washers (M-F, M-G) with a Phillips head screwdriver.

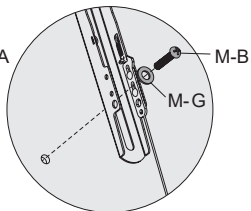
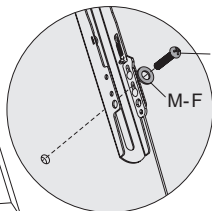
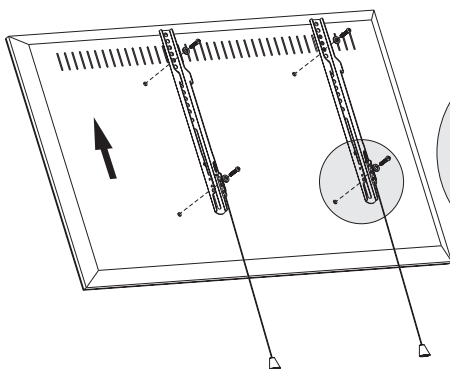
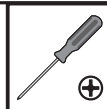
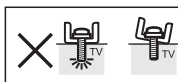
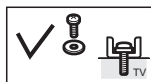

## OPTION B: Curved Back TV

Attach VESA Brackets (D) to back of TV using Bolts (M-C, M-D, M-E), Washers (M-G) and Spacers (M-H, M-I) with a Phillips head screwdriver.

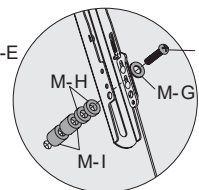
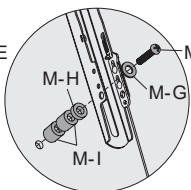
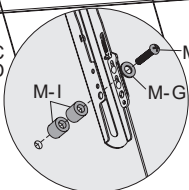
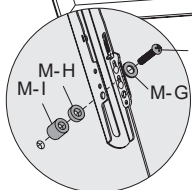
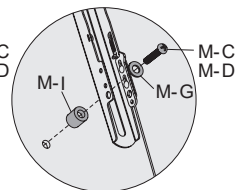
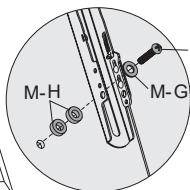
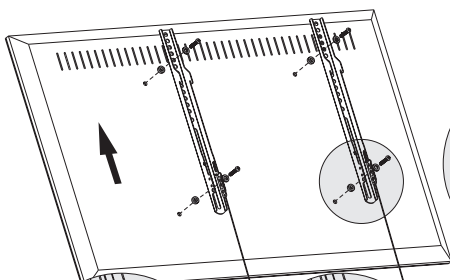
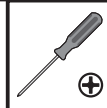
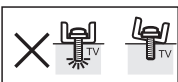

## STEP 4

Hang TV with VESA brackets onto Mount, then push back until you hear a click from each bracket to indicate the locks are engaged. Keep pull cords hidden by attaching magnetic end to any part of the mount.

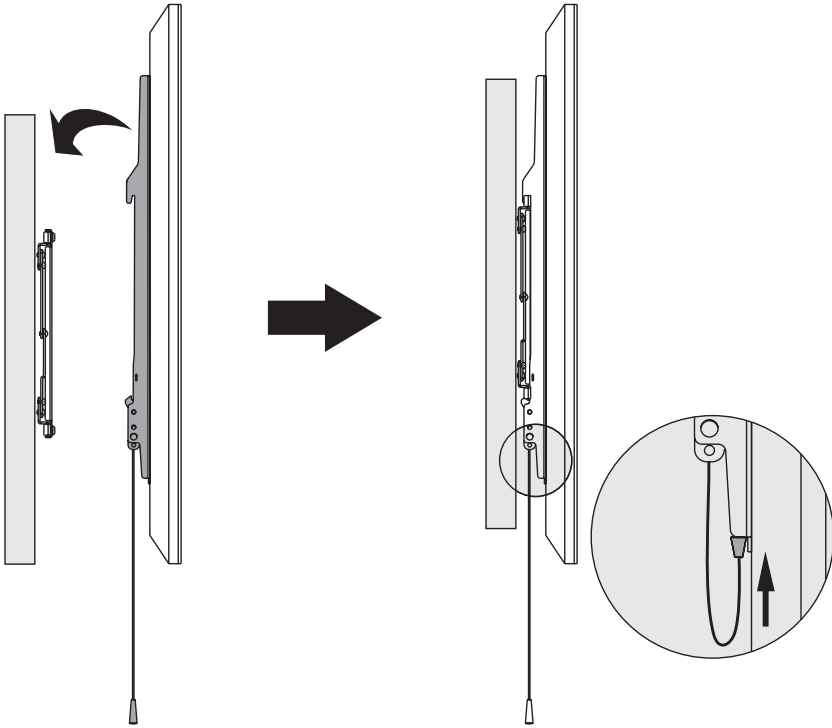

## STEP 5

To remove TV, pull down on pull cords at the same time to release locks, then lift TV off from mount.

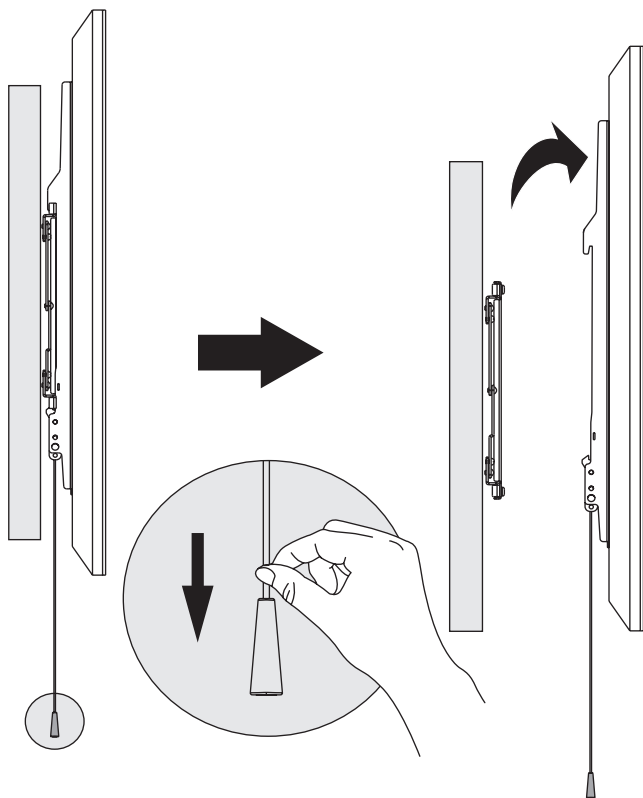
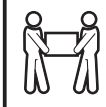



Open **Monday - Friday 7:00am - 7:00pm** CST,  
our dedicated support team can offer immediate assistance with rapid response times. If any parts are received damaged or defective, please contact us. We are happy to replace parts to ensure you have a fully functioning product.

 [help@vivo-us.com](mailto:help@vivo-us.com)

**AVG. RESPONSE TIME** (*within office hrs*): **1HR 8M**

- 23% within < 15m
- 38% within < 30m
- 61% within < 1hr
- 83% within < 2hr
- 92% within < 3hr

 [www.vivo-us.com](http://www.vivo-us.com)  
*Chat live with an agent!*

**AVG. RESOLUTION TIME** (*within office hrs*): **< 15 M**

 309-278-5303

**AVG. RESOLUTION TIME** (*within office hrs*): **5M 4S**