

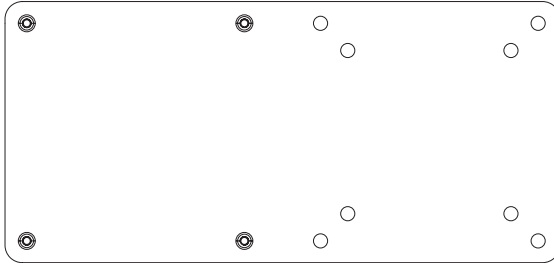

---

VESA Bracket Designed for Intel® NUC  
Instruction Manual



**SKU: MOUNT-VESA01**



Scan the QR code with your mobile device or follow the link for helpful videos and specifications related to this product.

<https://vivo-us.com/products/mount-vesa01>

---

GET IN TOUCH | Monday-Friday from 7:00am-7:00pm CST



help@vivo-us.com



www.vivo-us.com  
*Chat live with an agent!*



309-278-5303

## **WARNING!**

If you do not understand these directions, or if you have any doubts about the safety of the installation, please call a qualified technician. Check carefully to make sure there are no missing or defective parts. Improper installation may cause damage or serious injury. Do not use this product for any purpose that is not explicitly specified in this manual. Do not exceed weight capacity. We cannot be liable for damage or injury caused by improper mounting, incorrect assembly or inappropriate use.

## **WARNING: CHOKING HAZARD**

SMALL PARTS - NOT FOR CHILDREN UNDER 3 YEARS. ADULT SUPERVISION IS REQUIRED.

## PACKAGE CONTENTS

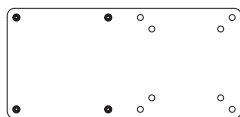

**A** (x1)  
Plate



**M-A** (x4)  
M4x12mm  
Screw



**M-B** (x4)  
M5x12mm  
Screw



**M-C** (x4)  
M4x20mm  
Screw



**M-D** (x4)  
M5x20mm  
Screw



**M-E** (x4)  
M5 Washer



**M-F** (x8)  
Spacer



**M-G** (x4)  
M4x5mm  
Screw

## TOOLS NEEDED



Phillips

## ASSEMBLY STEPS

### STEP 1 (Option A)

#### Flat Back Monitor

Assemble Plate (**A**) to the monitor using Screws (**M-A or M-B**) and M5 Washers (**M-E**).

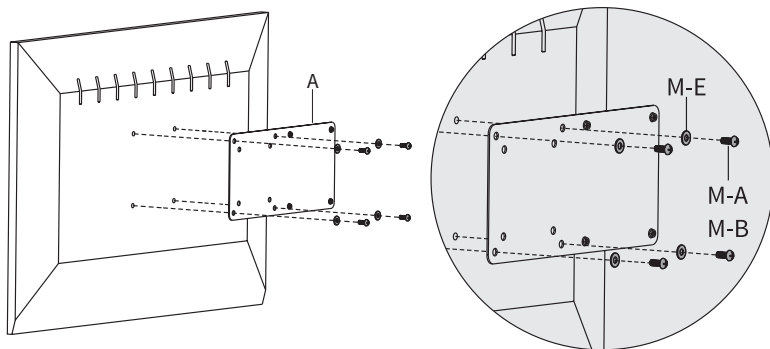

## STEP 1 (Option B)

### Curved Moniors

Assemble Plate **(A)** to the monitor using Screws **(M-C or M-D)** with M5 Washers **(M-E)** and Spacers **(M-F)**.

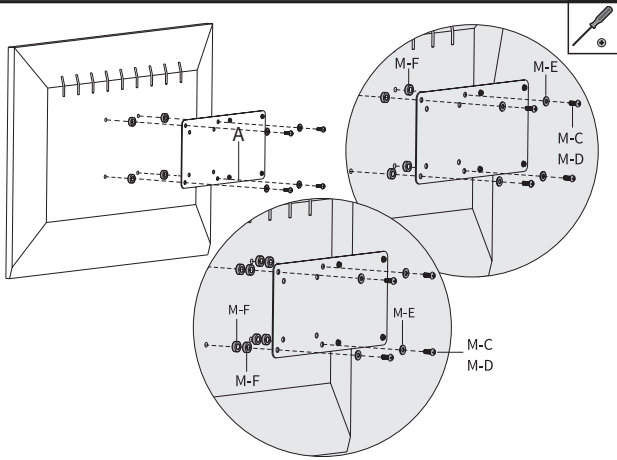

## STEP 2

Secure the NUC VESA plate to Plate **(A)** using M4x5mm Screws **(M-G)**.

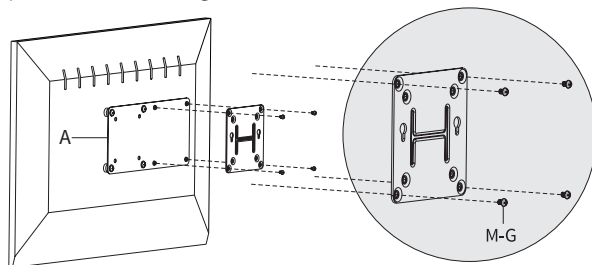

## STEP 3

Attach the M3 screws that came with the device to the bottom of the NUC chassis.

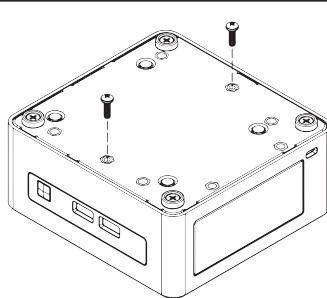

## STEP 4

Insert the heads of the two screws on the chassis into the holes on the NUC VESA bracket. Slide the chassis down to secure.

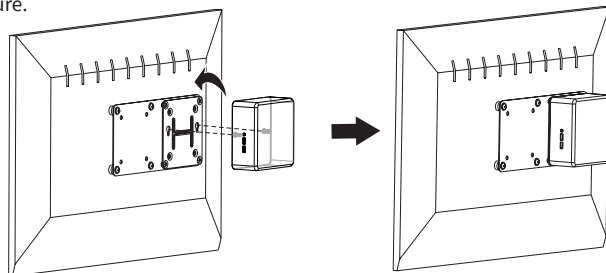



Open **Monday - Friday 7:00am - 7:00pm** CST, our dedicated support team can offer immediate assistance with rapid response times. If any parts are received damaged or defective, please contact us. We are happy to replace parts to ensure you have a fully functioning product.



309-278-5303

**AVG. RESOLUTION TIME** (*within office hrs*): **5M 4S**



[www.vivo-us.com](http://www.vivo-us.com)  
*Chat live with an agent!*

**AVG. RESOLUTION TIME** (*within office hrs*): **< 15 M**



[help@vivo-us.com](mailto:help@vivo-us.com)

**AVG. RESPONSE TIME** (*within office hrs*): **1HR 8M**

- 23% within < 15m
- 38% within < 30m
- 61% within < 1hr
- 83% within < 2hr
- 92% within < 3hr