

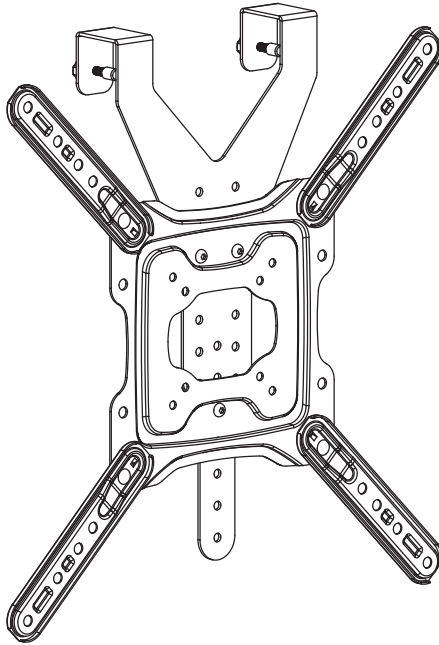

Loft Bed TV Mount

Instruction Manual



SKU: MOUNT-TV01LB



Scan the QR code with your mobile device or follow the link for helpful videos and specifications related to this product.

<https://vivo-us.com/products/mount-tv01lb>

GET IN TOUCH | Monday-Friday from 7:00am-7:00pm CST



help@vivo-us.com



www.vivo-us.com
Chat live with an agent!



309-278-5303

⚠ WARNING!

If you do not understand these directions, or if you have any doubts about the safety of the installation, please call a qualified technician. Check carefully to make sure there are no missing or defective parts. Improper installation may cause damage or serious injury. Do not use this product for any purpose that is not explicitly specified in this manual. Do not exceed weight capacity. We cannot be liable for damage or injury caused by improper mounting, incorrect assembly or inappropriate use.

⚠ WARNING: CHOKING HAZARD

SMALL PARTS - NOT FOR CHILDREN UNDER 3 YEARS. ADULT SUPERVISION IS REQUIRED.

PACKAGE CONTENTS

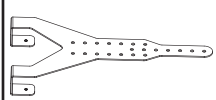

A (x1)
Hanger

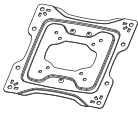

B (x1)
VESA Plate

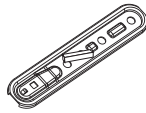

C (x4)
VESA Brackets



D (x2)
Pads



S-A (x2)
Clamp Screw



S-B (x2)
Screw Cap



S-C (x7)
M6 Nut



S-D (x4)
M6x12mm
Carriage Bolt



M-A (x4)
M6x14mm Screw



M-B (x4)
M8x16mm Screw



M-C (x4)
M6x30mm Screw

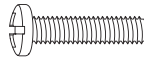

M-D (x4)
M8x35mm Screw



M-E (x4)
M8 Washer



M-F (x4)
Small Spacer



M-G (x4)
Large Spacer



T-A (x1)
Wrench

TOOLS NEEDED



NOTE: SOME HARDWARE INCLUDED MAY NOT BE USED

DO NOT EXCEED WEIGHT CAPACITY.
Failure to do so may result in serious injury.



ASSEMBLY STEPS

STEP 1

Assemble VESA Brackets (C) to VESA Plate (B) in the appropriate configuration to fit your TV's VESA pattern using M6x12mm Carriage Bolts (S-D) and M6 Nuts (S-C). Tighten using Wrench (T-A).

NOTE: For 200x200mm and lower, do not use VESA Brackets (C).

300x300mm, 400x400mm

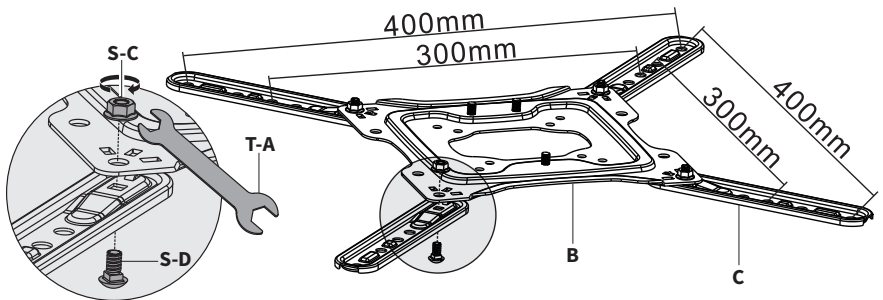

400x200mm, 300x400mm

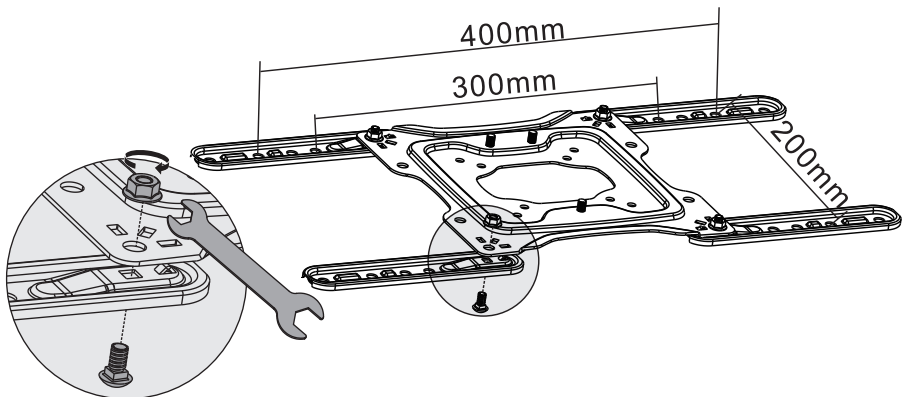

400x300mm

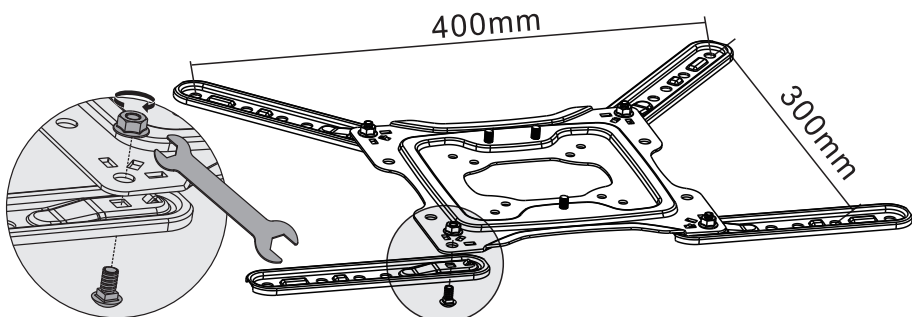

STEP 2

OPTION A: Flat Back Monitor

For flat back monitors, assemble VESA Plate (B) with VESA Brackets (C) using M6x14mm Screws (M-A) or M8x16mm Screws (M-B) with M8 Washers (M-E) and a Phillips screwdriver.

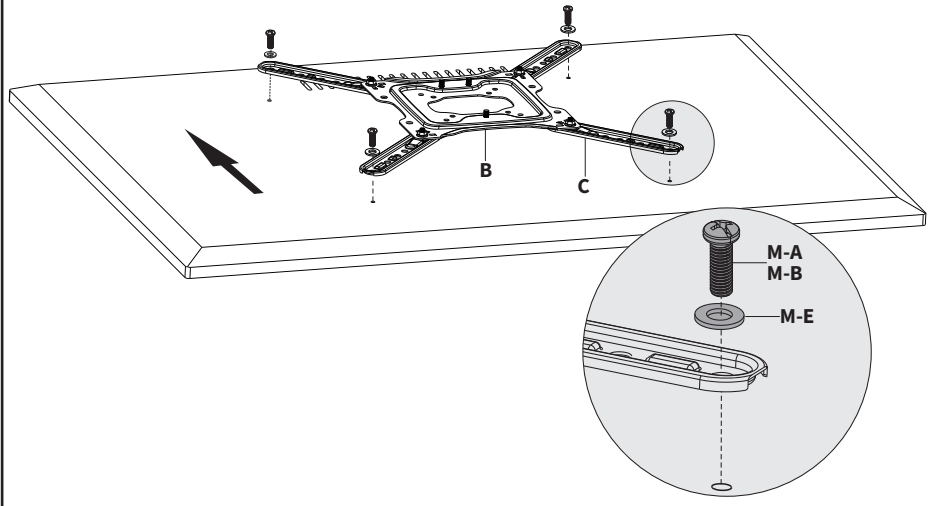

OPTION B: Curved Back Monitor

For curved back monitors, assemble VESA Plate (B) with VESA Brackets (C) using M6x30mm Screws (M-C) or M8x35mm Screws (M-D) with M8 Washers (M-E) and Spacers (M-F and/or M-G). Tighten using a Phillips screwdriver.

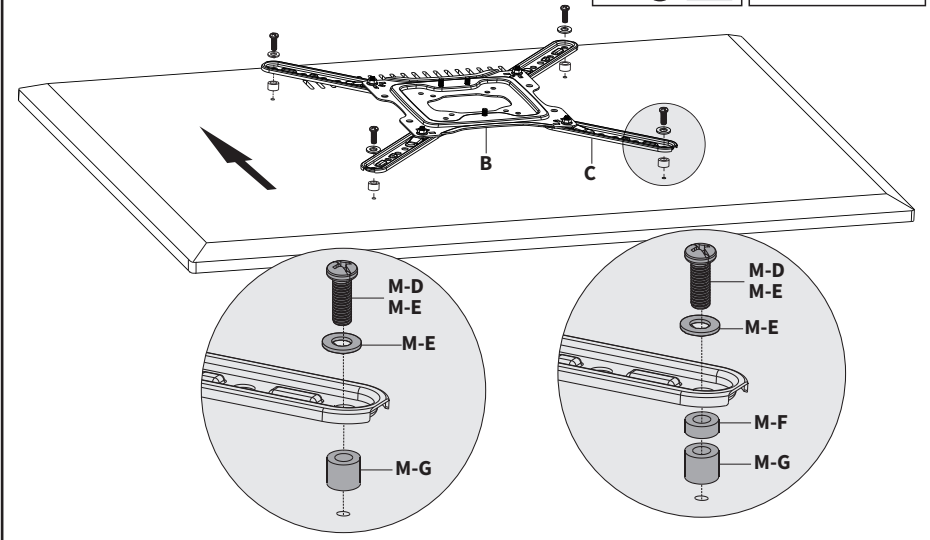

STEP 3

Place Hanger (A) onto VESA Plate (B) at the desired height.

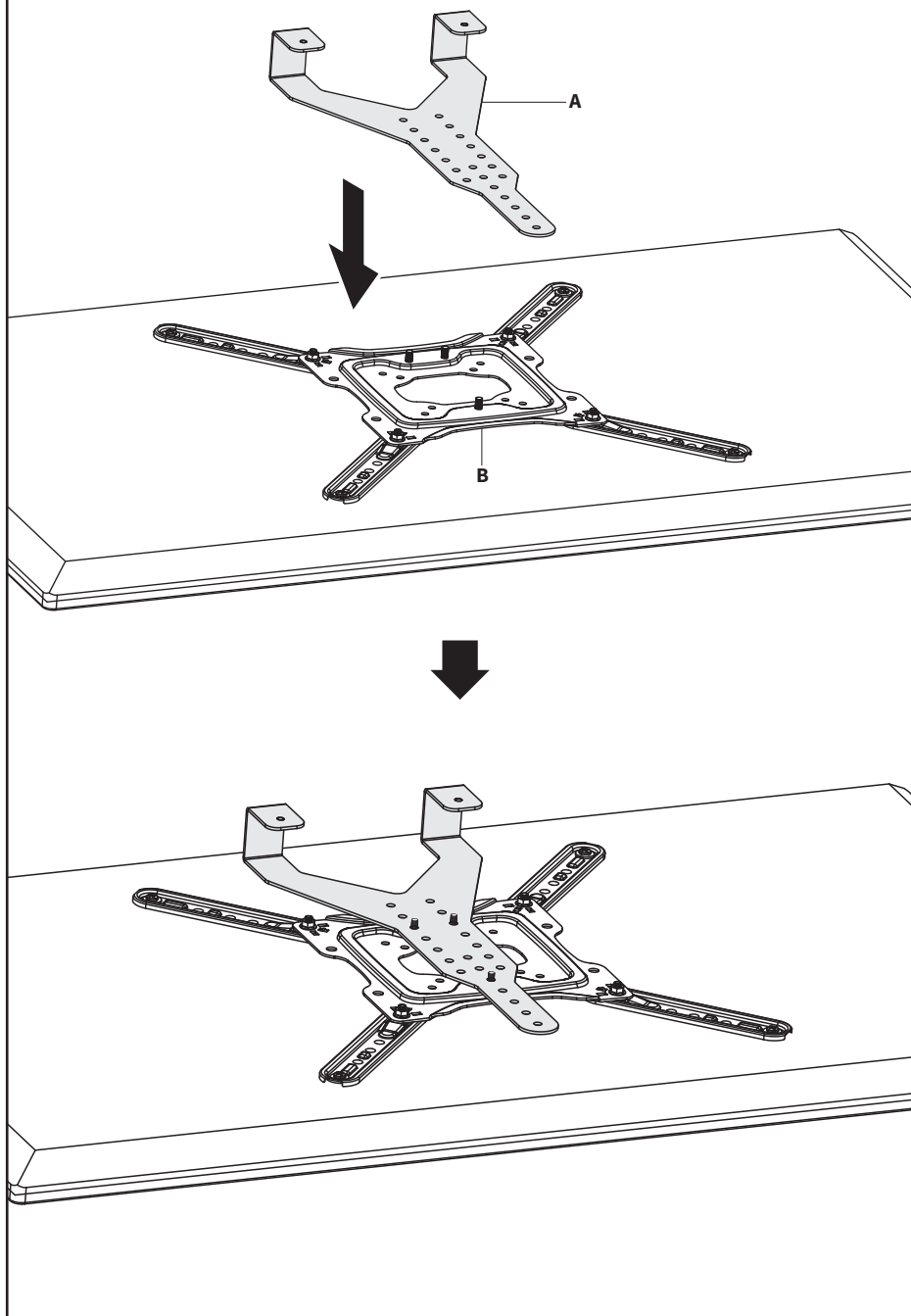

STEP 4

Assemble Hanger (A) to VESA Plate (B) using M6 Nuts (S-C) and Wrench (T-A).

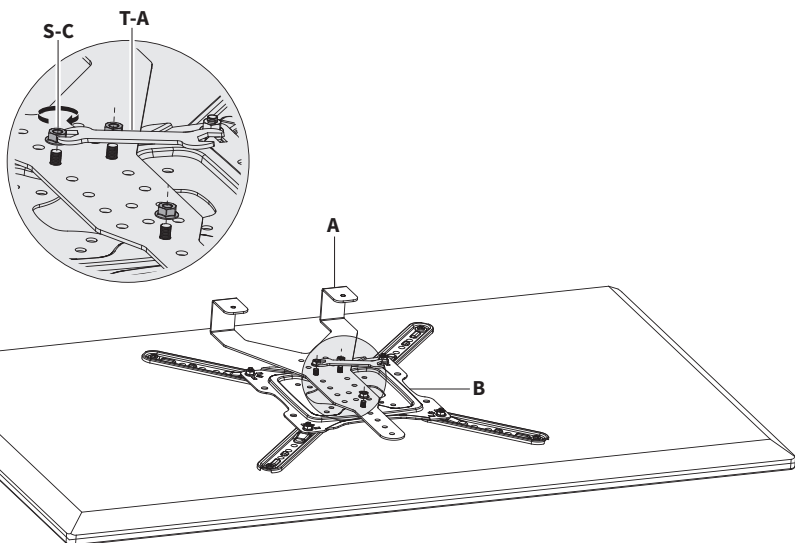

STEP 5

Thread Clamp Screws (S-A) into Hanger (A). Place Screw Caps (S-B) on the ends of Clamp Screws (S-A).

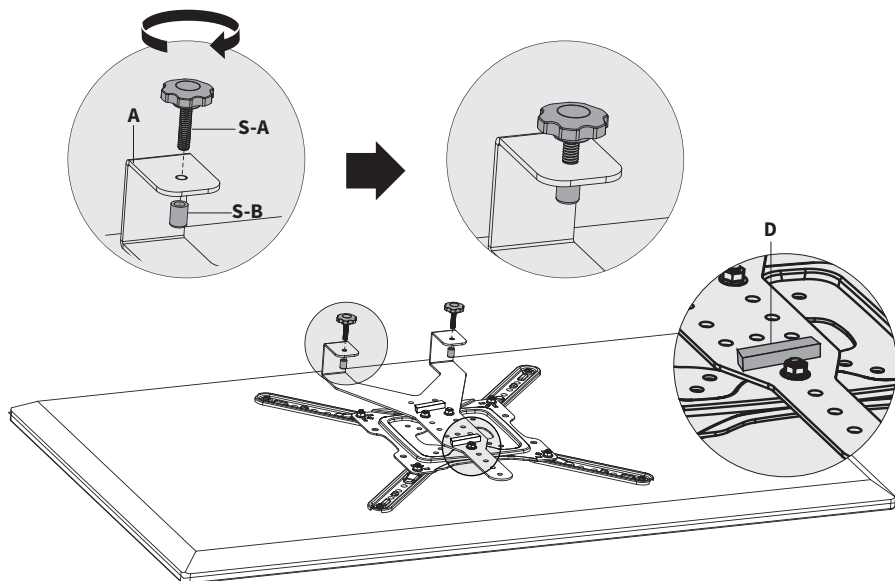

OPTIONAL: Pads (D) have been provided for mounting locations where Hanger (A) will touch or rest against a hard surface when mounted. Peel and remove backing from Pads (D) and install on back of Hanger (A) above both sets of screws, as shown above.

STEP 6

Place Hanger (A) over loft bed frame and tighten Clamp Screws (S-A) to secure the assembly in place.
NOTE: Max clamping thickness is 1.25" (32mm).

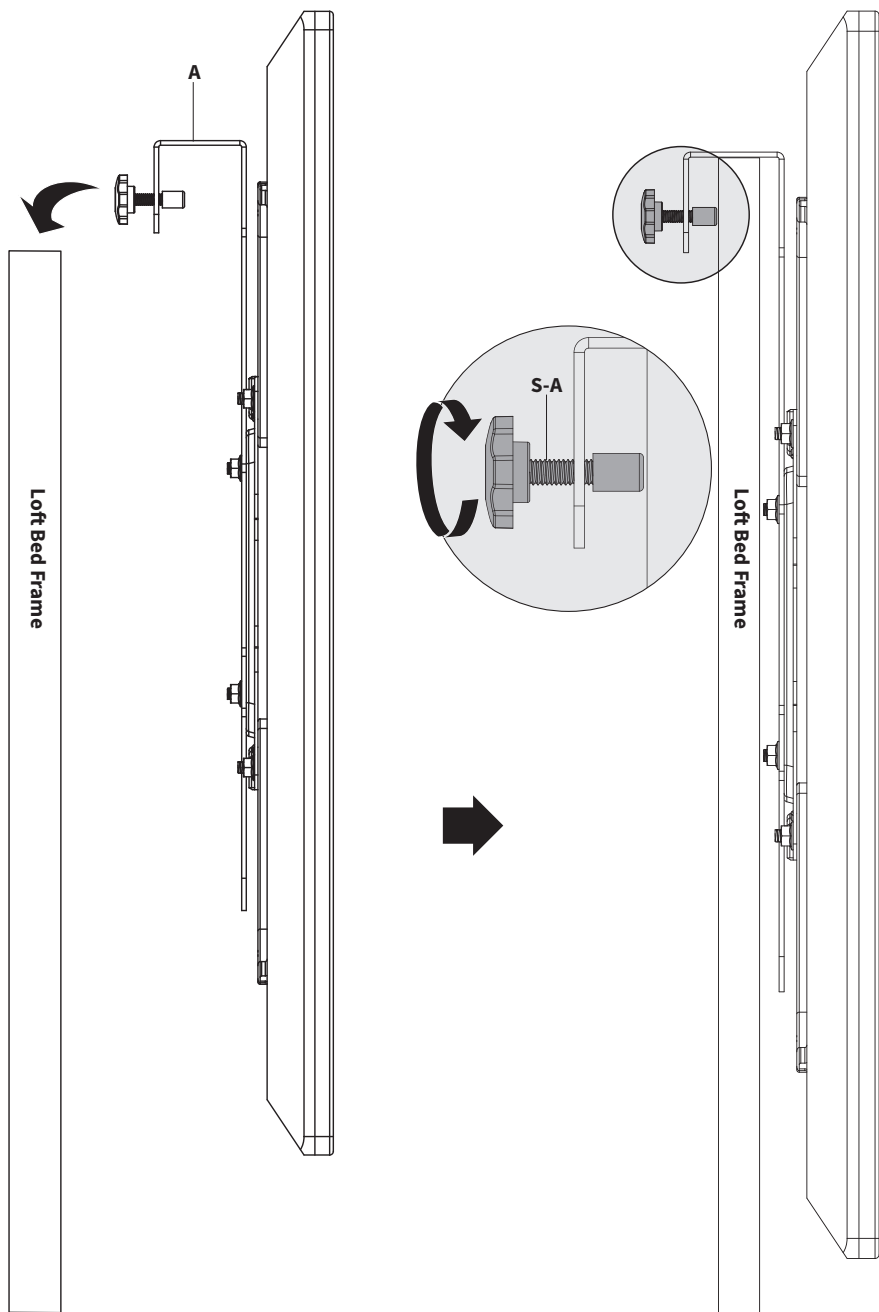



Love your new VIVO setup and want to share?
Tag us in your photo! **@vivo_us**

LAST UPDATED: 06/13/2023
REV1.1



Open **Monday - Friday 7:00am - 7:00pm** CST,
our dedicated support team can offer immediate assistance with rapid response times. If any parts are received damaged or defective, please contact us. We are happy to replace parts to ensure you have a fully functioning product.



www.vivo-us.com
Chat live with an agent!

AVG. RESOLUTION TIME (*within office hrs*): **< 15 M**



309-278-5303

AVG. RESOLUTION TIME (*within office hrs*): **5M 4S**



help@vivo-us.com

AVG. RESPONSE TIME (*within office hrs*): **1HR 8M**

- 23% within < 15m
- 38% within < 30m
- 61% within < 1hr
- 83% within < 2hr
- 92% within < 3hr

FOR MORE VIVO PRODUCTS, CHECK OUT OUR WEBSITE AT: www.vivo-us.com