

# No Stud TV Wall Mount

MOUNT-NS86  
Assembly Manual

---



## Better Products for a Better Workspace Experience

We are dedicated to creating high-end ergonomic solutions  
for the office with top of the industry support.

Explore Endless Workspace Solutions

**[www.vivo-us.com](http://www.vivo-us.com)**



## WARNING



If you do not understand these directions, or if you have any doubts about the safety of the installation, please contact our product support team at 309-278-5303 or [help@vivo-us.com](mailto:help@vivo-us.com) for further assistance. Check carefully to make sure there are no missing or defective parts. Failure to report missing parts within 30 days may result in denial of free replacement. Improper installation may cause damage or serious injury. Do not use this product for any purpose that is not explicitly specified in this manual. Do not exceed weight capacity. We cannot be liable for damage or injury caused by improper mounting, incorrect assembly or inappropriate use.



### WARNING: CHOKING HAZARD

SMALL PARTS - NOT FOR CHILDREN UNDER 3 YEARS. ADULT SUPERVISION IS REQUIRED.



### WEIGHT LIMIT: 132lbs(60kg)

DO NOT EXCEED WEIGHT LIMIT. FAILURE TO DO SO MAY RESULT IN SERIOUS INJURY AND DAMAGE TO PROPERTY.



### DRYWALL WARNINGS:

If installing into drywall only, these warnings must be followed:

- DO NOT install into drywall without using ALL provided Drywall Nails.
- DO NOT use alternative drywall anchors.
- Avoid inserting Drywall Nails into drywall seams.
- If a Drywall Nail hits an obstruction, reposition the Wall Bracket or use the Wood Stud Mounting option.

Failure to do so can result in serious injury and damage to property.

---

## Need Help? We're Here For You

*US-Based Customer Support from Trained Professionals*

**Monday-Friday from 7am-7pm CST**

**Saturday 8am-4pm CST**



#### Email Us

[help@vivo-us.com](mailto:help@vivo-us.com)



#### Chat with Live Agent

[www.vivo-us.com](http://www.vivo-us.com)



#### Give Us a Call

309-278-5303 ext. 1



Assembly Video & Product Info

[www.vivo-us.com/products/mount-ns86](http://www.vivo-us.com/products/mount-ns86)

Package Contents

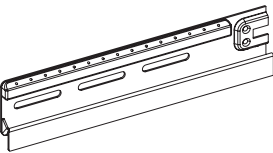

**A (x1)**  
Left Wall Bracket

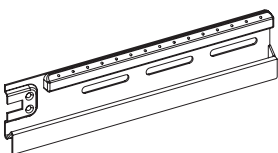

**B (x1)**  
Right Wall Bracket

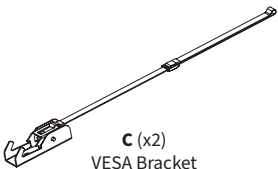

**C (x2)**  
VESA Bracket

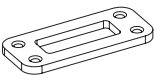

**D (x1)**  
Connector Bracket



**E (x2)**  
VESA Bumper



**F (x1)**  
Bubble Level

Included Hardware & Tools



**S-A (x4)**  
M5x6mm Screw



**S-B (x30)**  
Drywall Nail



**M-A (x4)**  
M6x14mm Screw



**M-B (x4)**  
M8x16mm Screw



**M-C (x4)**  
M6x30mm Screw

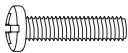

**M-D (x4)**  
M8x35mm Screw



**M-E (x4)**  
M8 Washer



**M-F (x4)**  
Small Spacer



**M-G (x4)**  
Large Spacer

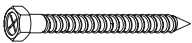

**W-A (x4)**  
ST6.3x55mm  
Screw



**W-B (x4)**  
Concrete Anchor



**W-C (x4)**  
M6 Washer



**T-A (x1)**  
3mm Allen Wrench

Tools Needed



**Phillips  
Screwdriver**

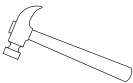

**Hammer**



**\*Pencil**



**\*Socket  
Wrench**



**\*Drill**



**\*Drill Bit**  
Wood Stud: 3/16" (4.5mm)  
Concrete/Brick: 3/8" (10mm)



**\*\*Stud  
Finder**

*\*If installing into Wood Stud, Concrete, or Brick  
\*\*If installing into Wood Stud*

Weight Limit: 132lbs (60kg)

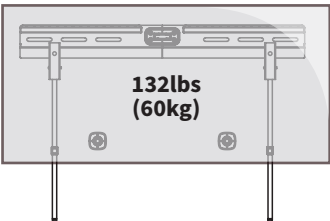

# Assembly Steps

## STEP 1

Connect the Left Wall Bracket (**A**) and the Right Wall Bracket (**B**) together using the Connector Bracket (**D**) and the M5x6mm Screws (**S-A**). Tighten using 3mm Allen Wrench (**T-A**).

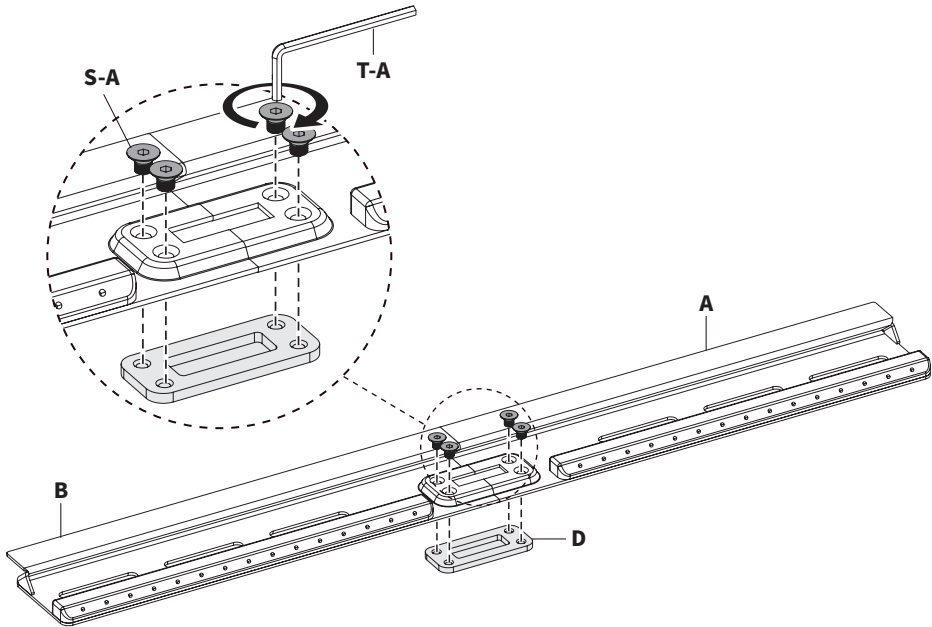

Insert the Bubble Level (**F**) through the Connector Bracket (**D**).

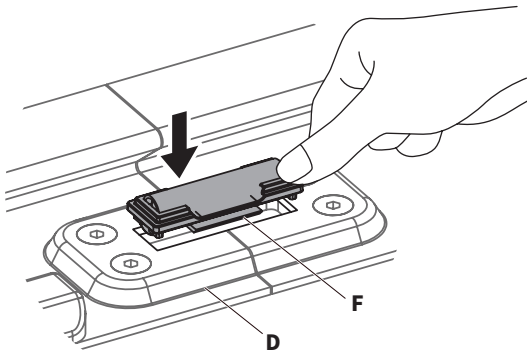

\*\*\*Read Before Proceeding\*\*\*

## Mounting Options

---

*Determine your intended mounting surface and follow instructions as identified below.*

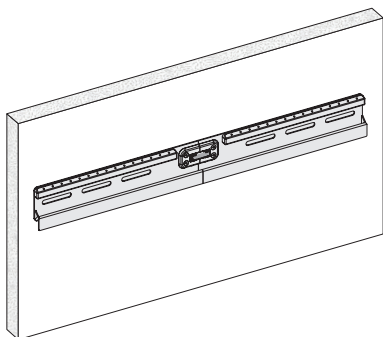

- Option 1 -  
**Drywall Only**  
Page 7

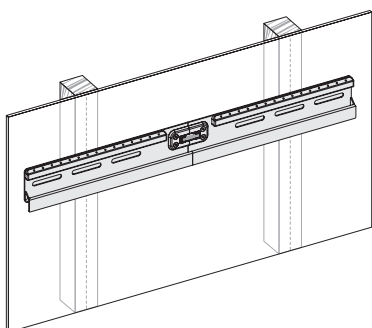

- Option 2 -  
**Wood Stud**  
Pages 10-13

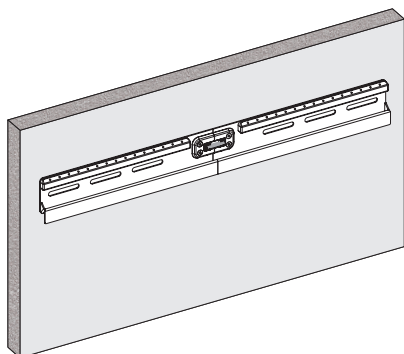

- Option 3 -  
**Concrete/Brick**  
Pages 14-17

- Mounting Option 1 -  
**Drywall Only Mounting**

**STEP 2**

Hold the Wall Bracket Assembly onto the wall using the Bubble Level (**F**) to ensure it is level. Use a hammer to tap the Drywall Nails (**S-B**) down into the small holes on the Wall Brackets (**A,B**).

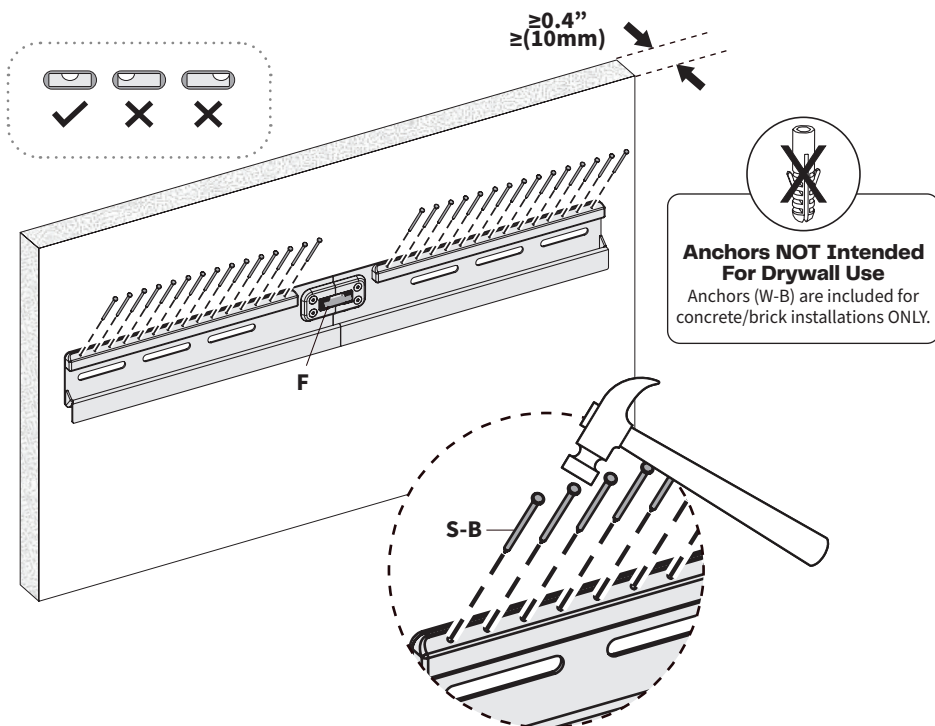

**\*\* WARNINGS \*\***



- **DO NOT** install into drywall without using ALL Drywall Nails.
- **DO NOT** use alternative drywall anchors.
- Avoid tapping the Drywall Nails into drywall seams.
- If a Drywall Nail is blocked, reposition the Wall Bracket or use the Wood Stud option (pg. 7).

**NOTE**

If a Drywall Nail contacts a wood stud, simply tap the Nail into the stud.

Proceed to **STEP 3**  
on **Page 12**

– Mounting Option 2 –  
**wood Stud Mounting**

**STEP 2**

Hold the Wall Bracket Assembly onto the wall using the Bubble Level (**F**) to ensure it is level. Use a stud finder and pencil to mark two hole locations aligned with wood studs.

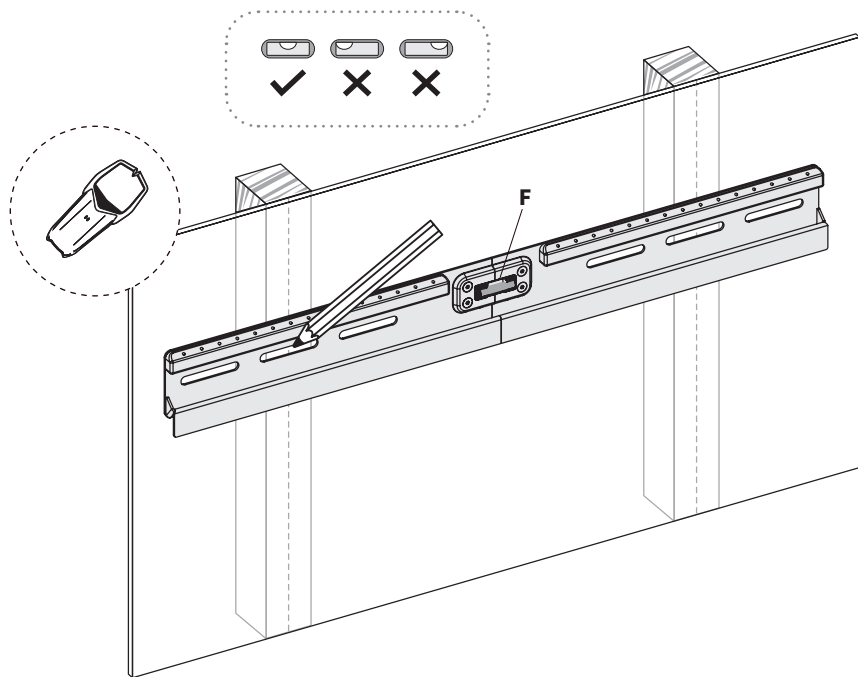

Drill mounting holes at marked locations using the infographic below.

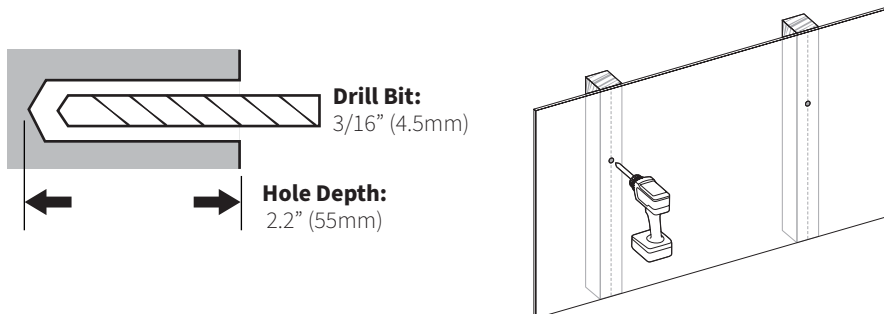



## Option 2: Wood Stud Mounting - *Cont'd*

Attach the Wall Bracket Assembly to the wall using ST6.3x55mm Screws (**W-A**) with M6 Washers (**W-C**). Tighten using a socket wrench.

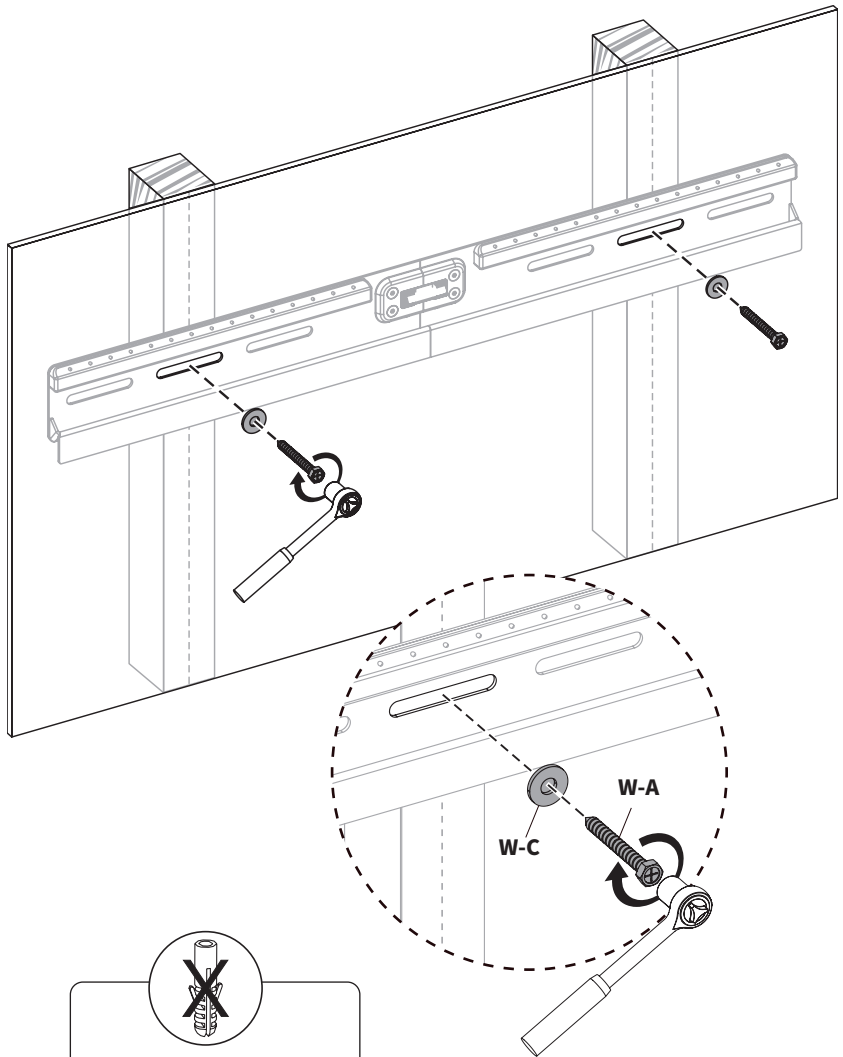

### **Anchors NOT Intended For Drywall Use**

Anchors (W-B) are included for  
concrete/brick installations ONLY.

Proceed to STEP 3  
on **Page 12**

– Mounting Option 3 –  
**Concrete/Brick Mounting**

**STEP 2**

Hold the Wall Bracket Assembly onto the wall using the Bubble Level (**F**) to ensure it is level. Use a pencil to mark four hole locations as shown.

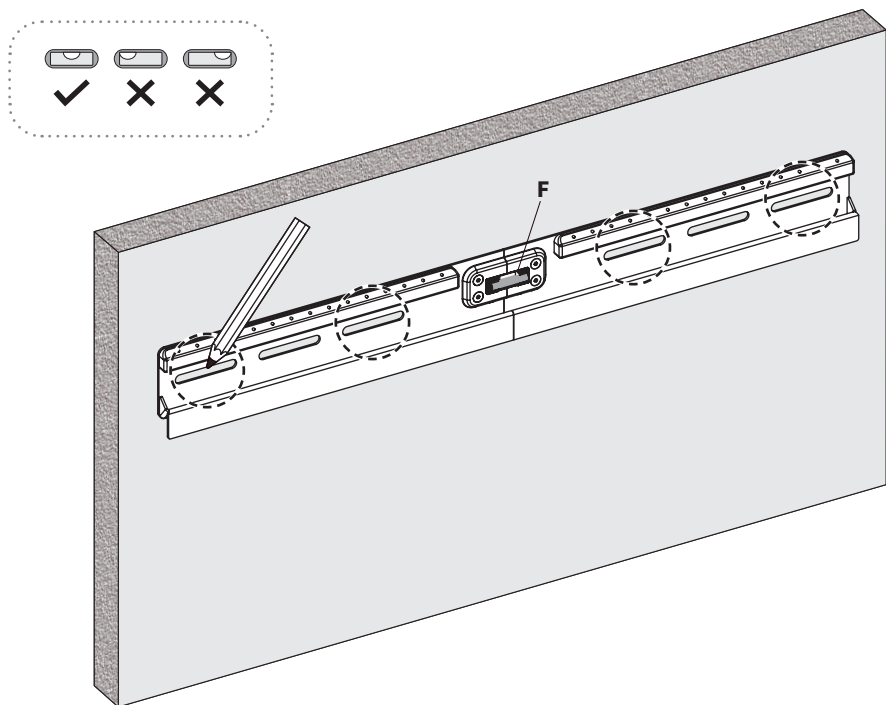

Drill mounting holes at marked locations using the infographic below.

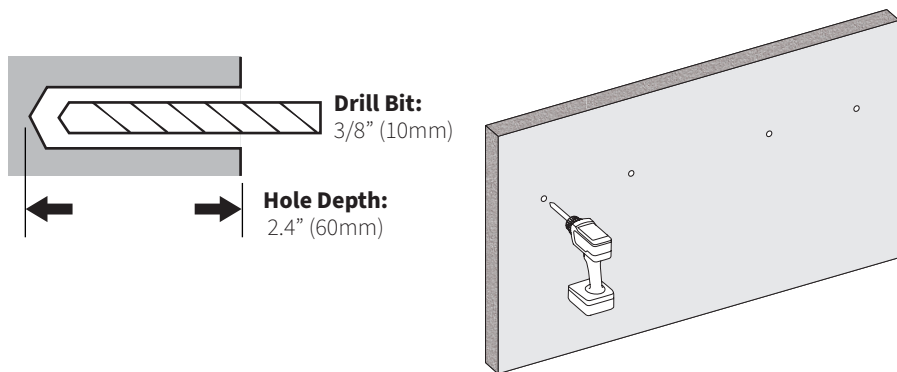

### Option 3: Concrete/Brick Mounting - *Cont'd*

Insert Concrete Anchors (**W-B**) into the drilled holes and attach the Wall Brackets Assembly to the wall using ST6.3x55mm Screws (**W-A**) with M6 Washers (**W-C**). Tighten using a socket wrench.

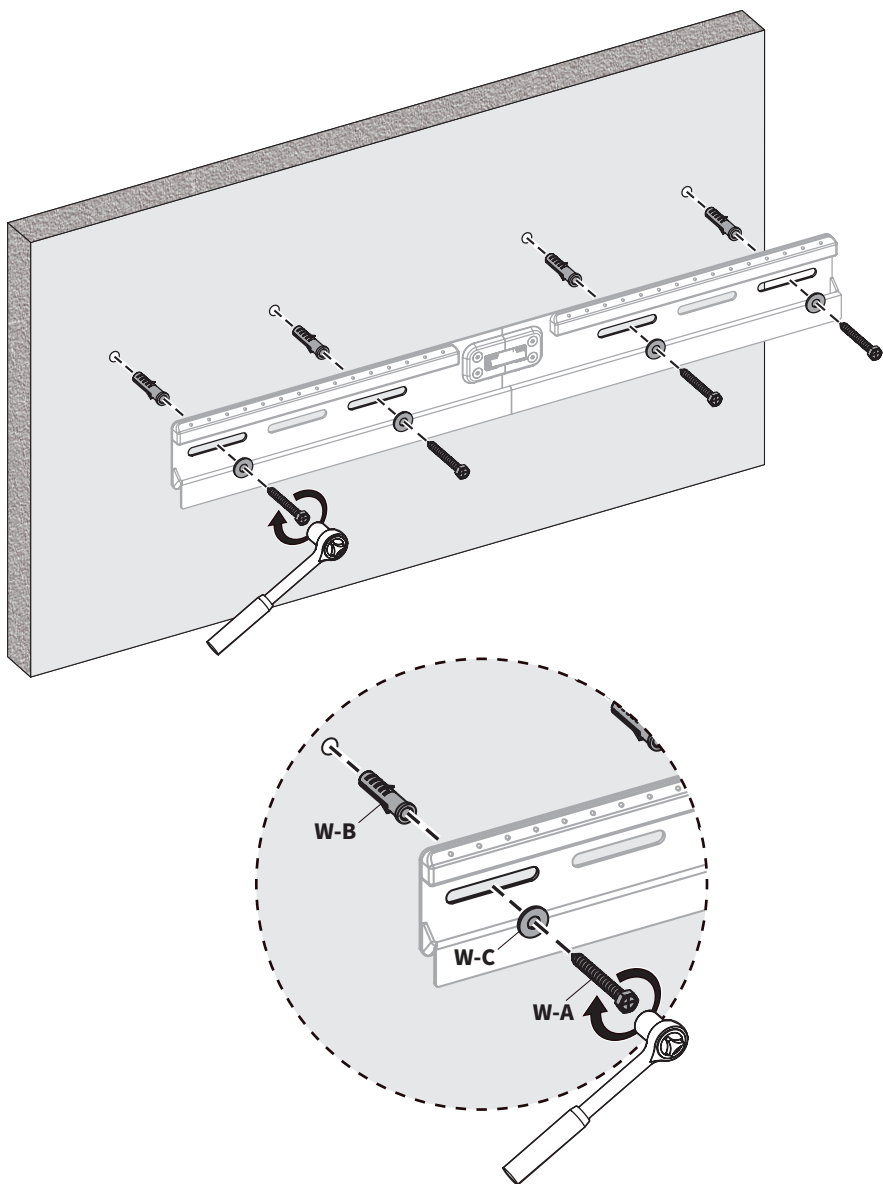

## STEP 3

Attach the VESA Brackets (**C**) to the *top* VESA holes on your TV using appropriate Screws (**M-A~M-D**) with M8 Washers (**M-E**). Spacers (**M-F, M-G**) can be used if the VESA holes are recessed. Tighten using a Phillips screwdriver.

Attach the VESA Bumpers (**E**) to the *bottom* VESA holes on your TV using appropriate Screws (**M-A~M-D**) with M8 Washers (**M-E**). Spacers (**M-F, M-G**) can be used if the VESA holes are recessed. Tighten using a Phillips screwdriver.

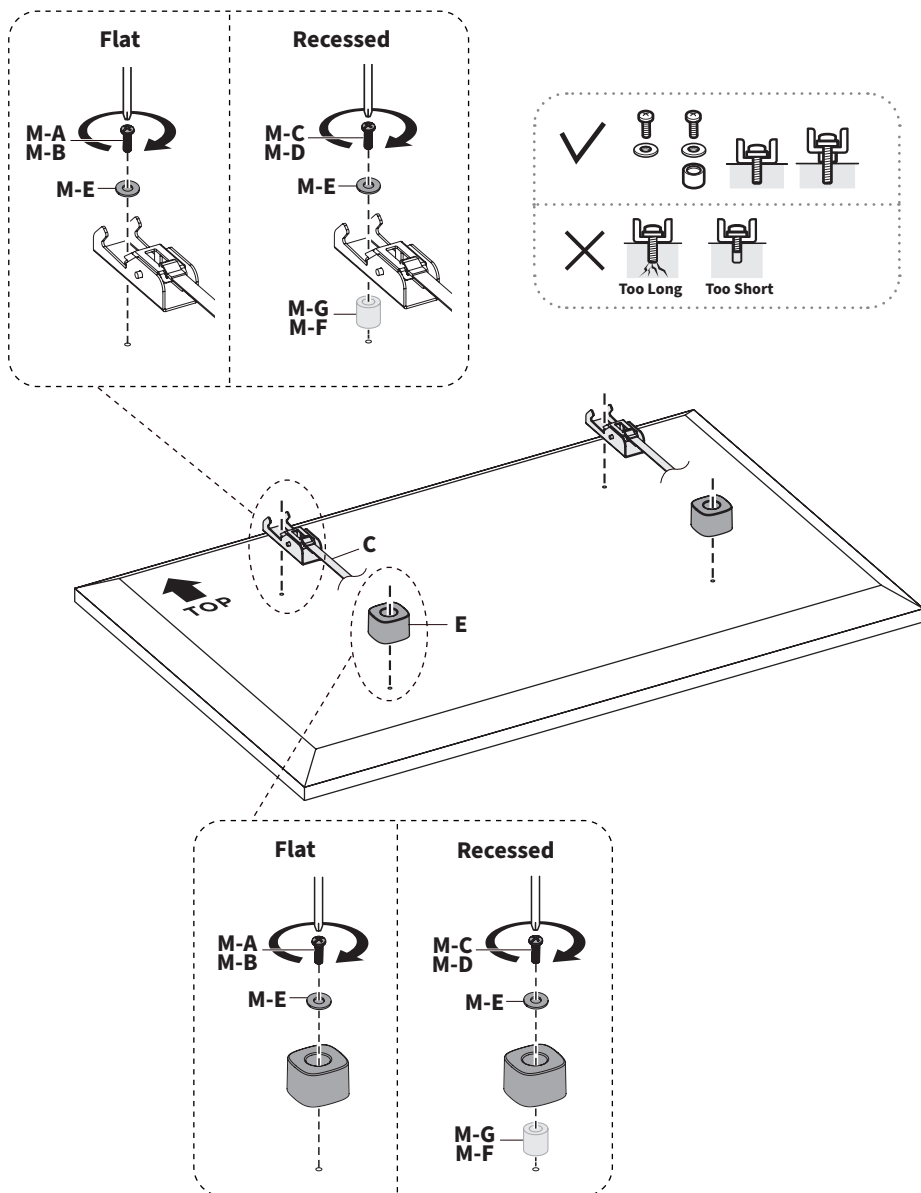

## STEP 4

With the help from another person, hook the VESA Brackets **(C)** with TV onto the Wall Brackets **(A,B)** so that the Latches click shut. Press the TV flat against the wall so that the VESA Bumper contacts the wall.



**2 Person Mounting  
Recommended**

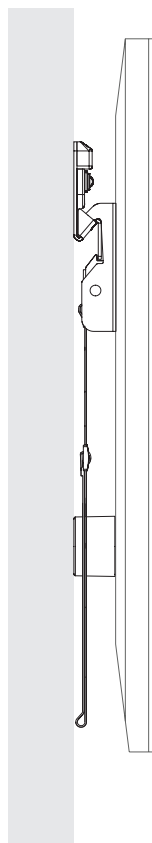
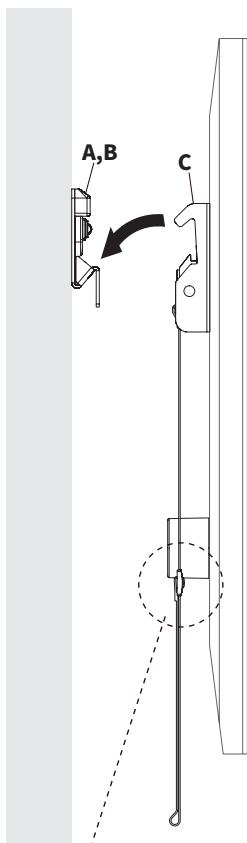

**- Assembly Complete! -**

*Go to page 14 for instructions  
on detaching your TV.*

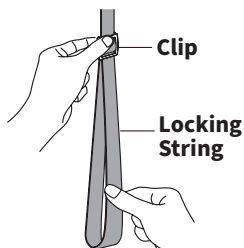

The **Locking Strings** can  
be stowed behind the TV  
by sliding up the **Clip**.

## Detaching the TV

To remove the TV from the wall, pull down on both **Locking Strings**. Then with the help of another person, lift the TV off of the Wall Brackets (**A,B**).



**2 Person Mounting  
Recommended**

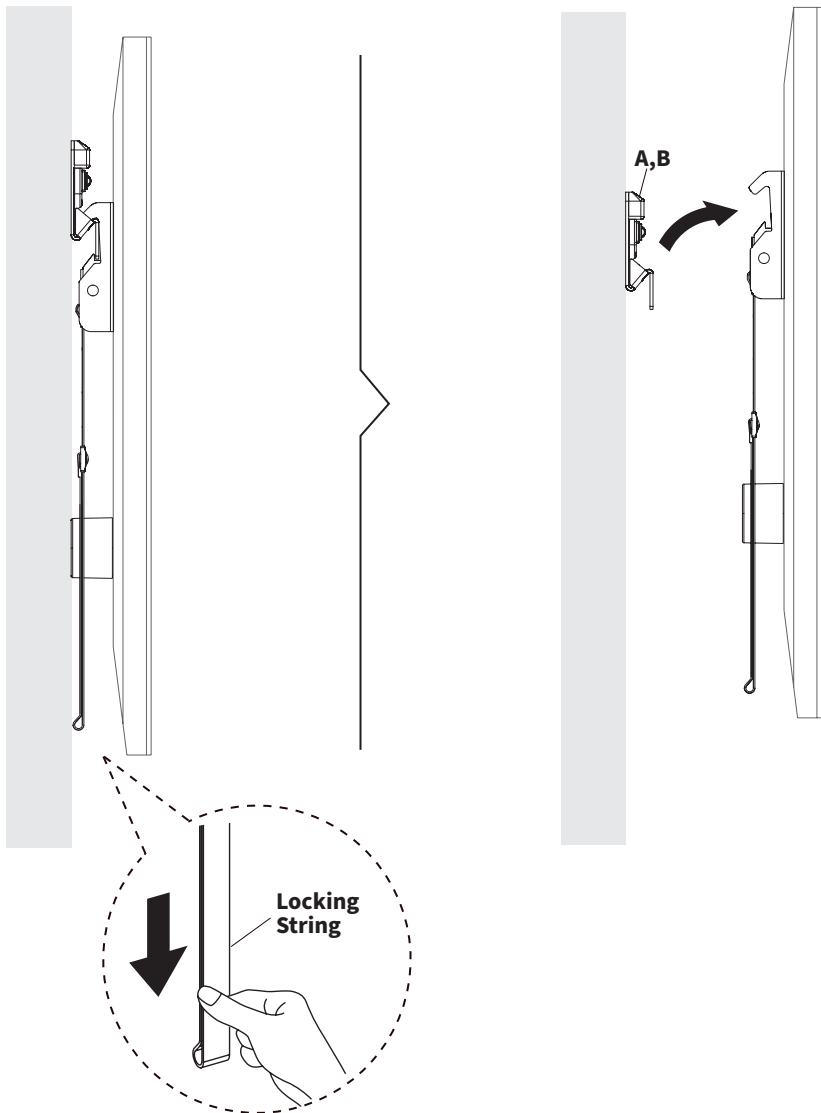

V·I·V·



Love Your New Setup?  
**Tag Us on Social!**



@ VIVO-us



@ vivo\_us



@VIVOus



VIVO



## Need Help? **We're Here For You**

Monday-Friday from 7am-7pm CST  
Saturday 8am-4pm CST



Email Us  
[help@vivo-us.com](mailto:help@vivo-us.com)



Chat with Live Agent  
[www.vivo-us.com](http://www.vivo-us.com)



Give Us a Call  
309-278-5303 ext. 1



VIVO-us



@vivo\_us



@VIVOus



VIVO