

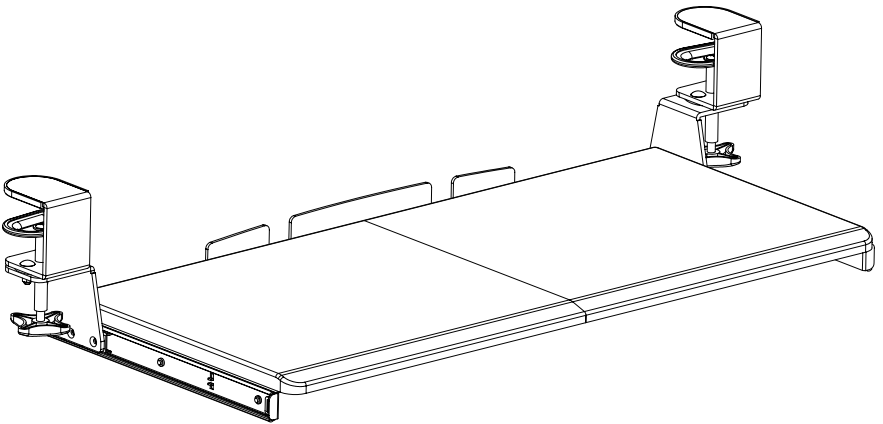

---

## Clamp-on Keyboard Tray for Corner Desk Instruction Manual



**SKU: MOUNT-KB10C**



Scan the QR code with your mobile device or follow the link for helpful videos and specifications related to this product.

**<https://vivo-us.com/products/mount-kb10c>**

---

**GET IN TOUCH** | Monday-Friday from 7:00am-7:00pm CST



help@vivo-us.com



www.vivo-us.com  
*Chat live with an agent!*



309-278-5303

# ⚠ WARNING!

If you do not understand these directions, or if you have any doubts about the safety of the installation, please call a qualified technician. Check carefully to make sure there are no missing or defective parts. Improper installation may cause damage or serious injury. Do not use this product for any purpose that is not explicitly specified in this manual. Do not exceed weight capacity. We cannot be liable for damage or injury caused by improper mounting, incorrect assembly or inappropriate use.

## ⚠ WARNING: CHOKING HAZARD

SMALL PARTS - NOT FOR CHILDREN UNDER 3 YEARS. ADULT SUPERVISION IS REQUIRED.

## PACKAGE CONTENTS

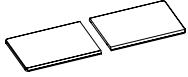

**A** (x2)  
Keyboard Tray

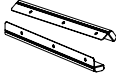

**B** (x2)  
Sliding Rails

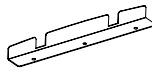

**C** (x1)  
Baffle



**D** (x2)  
Support Plates

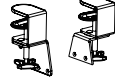

**E** (x2)  
Clamps



**F** (x2)  
Clamp Pads



**S-A** (x12)  
M5x12mm  
Flathead Screw



**S-B** (x8)  
M4x7mm Screw



**S-C** (x8)  
M5x12mm  
Screw



**T-A** (x1)  
Wrench

## TOOLS NEEDED



Phillips  
Screwdriver

**NOTE:** SOME HARDWARE INCLUDED MAY NOT BE USED

**DO NOT EXCEED WEIGHT CAPACITY.**  
Failure to do so may result in serious injury.



## ASSEMBLY STEPS

### STEP 1

Attach Sliding Rails (**B**) to Keyboard tray (**A**) using M5x12mm Screws (**S-C**) and a Phillips screwdriver. Attach Baffle (**C**), and Supporting Plates (**D**) to Keyboard Tray (**A**) using M5x12mm Flathead Screws (**S-A**) and a Phillips screwdriver.

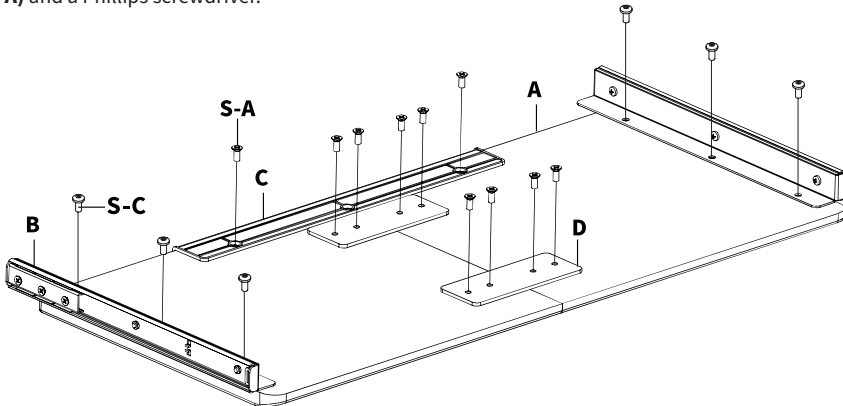

## STEP 2

Install Clamp Pads (F) to Clamps (E), then attach Clamps (E) to Sliding Rails (B) using M4x7mm Screws (S-B) and a Phillips screwdriver.

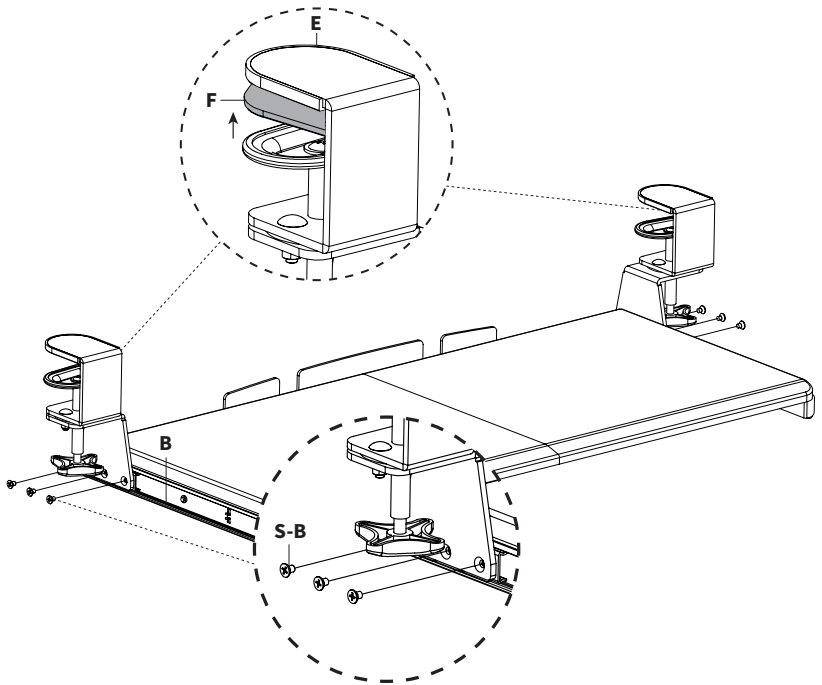

## STEP 3

Use Wrench (T-A) to adjust Clamps (E) to the desired angle. Place keyboard tray in desired location so that Clamp faces are flush with the desktop and tighten clamps.

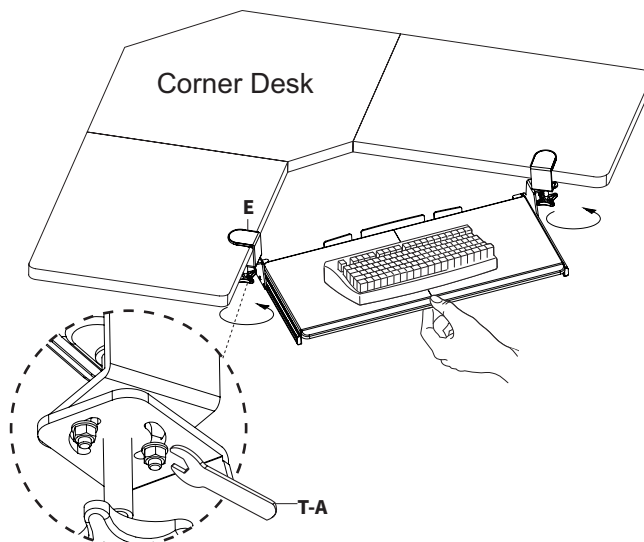



Open **Monday - Friday 7:00am - 7:00pm** CST,  
our dedicated support team can offer immediate assistance with rapid response times. If any parts are received damaged or defective, please contact us. We are happy to replace parts to ensure you have a fully functioning product.



309-278-5303

**AVG. RESOLUTION TIME** (*within office hrs*): **5M 4S**



[www.vivo-us.com](http://www.vivo-us.com)  
*Chat live with an agent!*

**AVG. RESOLUTION TIME** (*within office hrs*): **< 15 M**



[help@vivo-us.com](mailto:help@vivo-us.com)

**AVG. RESPONSE TIME** (*within office hrs*): **1HR 8M**

- 23% within < 15m
- 38% within < 30m
- 61% within < 1hr
- 83% within < 2hr
- 92% within < 3hr