

# EV Charger Box with Lock

MOUNT-EVCG1

Assembly Manual

---



## WARNING



If you do not understand these directions, or if you have any doubts about the safety of the installation, please contact our product support team at 309-278-5303 or [help@vivo-us.com](mailto:help@vivo-us.com) for further assistance. Check carefully to make sure there are no missing or defective parts. Failure to report missing parts within 30 days may result in denial of free replacement. Improper installation may cause damage or serious injury. Do not use this product for any purpose that is not explicitly specified in this manual. Do not exceed weight capacity. We cannot be liable for damage or injury caused by improper mounting, incorrect assembly or inappropriate use.



### WARNING: CHOKING HAZARD

SMALL PARTS - NOT FOR CHILDREN UNDER 3 YEARS. ADULT SUPERVISION IS REQUIRED.



### WARNING: PINCH POINT

DO NOT PLACE HANDS ON OR NEAR SUPPORT BARS. MOVING PARTS CAN CRUSH AND CUT. FAILURE TO FOLLOW THESE INSTRUCTIONS MAY RESULT IN SERIOUS PERSONAL INJURY.



### DO NOT INSTALL INTO DRYWALL ALONE

DRYWALL ALONE CANNOT SUPPORT WEIGHT OF YOUR EV CHARGER. Mount must be installed into wood stud or concrete/brick walls ONLY. Failure to follow instructions may result in damage to property and/or serious personal injury. Please verify intended mounting location before proceeding. If unsure, please contact us at 309-278-5353 or [help@vivo-us.com](mailto:help@vivo-us.com).

---

## Need Help? We're Here For You

*US-Based Customer Support from Trained Professionals*

**Monday-Friday from 7am-7pm CST**

**Saturday 8am-4pm CST**



### Email Us

[help@vivo-us.com](mailto:help@vivo-us.com)



### Chat with Live Agent

[www.vivo-us.com](http://www.vivo-us.com)



### Give Us a Call

309-278-5303 ext. 1



Assembly Video & Product Info

[www.vivo-us.com/products/mount-evcg1](http://www.vivo-us.com/products/mount-evcg1)

# Package Contents

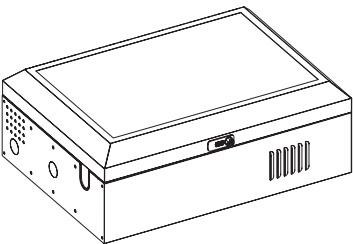

**A (x1)**  
Charger Box

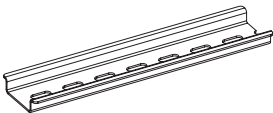

**B (x1)**  
Accessory Rail



**C (x1)**  
Key

---

## Included Hardware & Tools

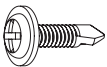

**S-A (x6)**  
ST4.2x15mm  
Screw



**W-A (x4)**  
ST6.3x55mm  
Screw



**W-B (x4)**  
Concrete  
Anchor

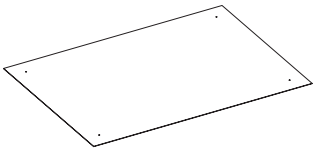

**T-A (x1)**  
Template

---

## Tools Needed:



**Pencil**



**Drill**



**Drill Bit**



**Level**



**Stud  
Finder**



**Socket  
Wrench**

# Assembly Steps

## STEP 1

Unlock and open the Charger Box **(A)** using the Key **(C)** or by using the Padlock numbers.

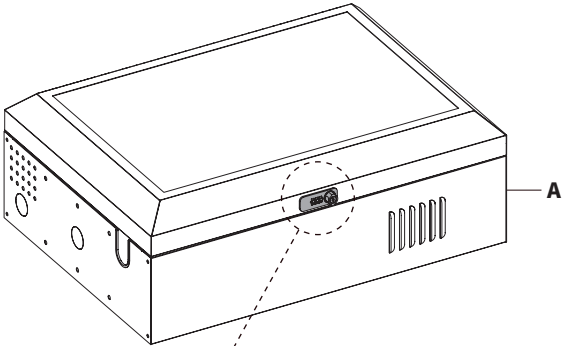

The initial password combination to unlock the box is "000".

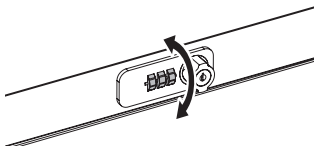

OR

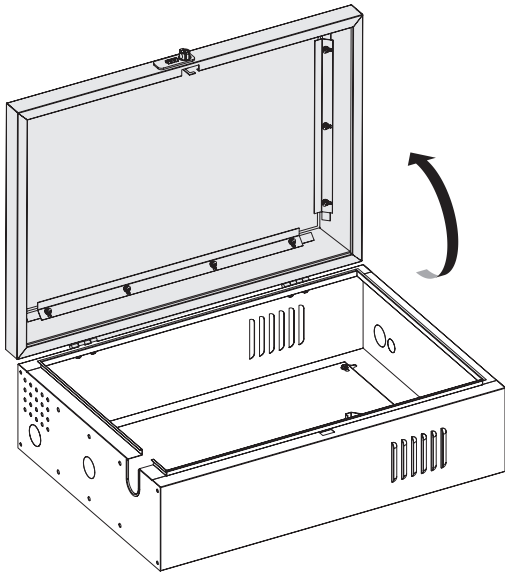
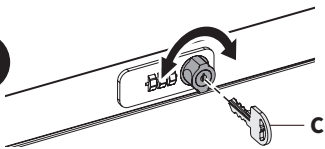

## STEP 2

Push the set button on the back of the lock from “Position A” to “Position B”.

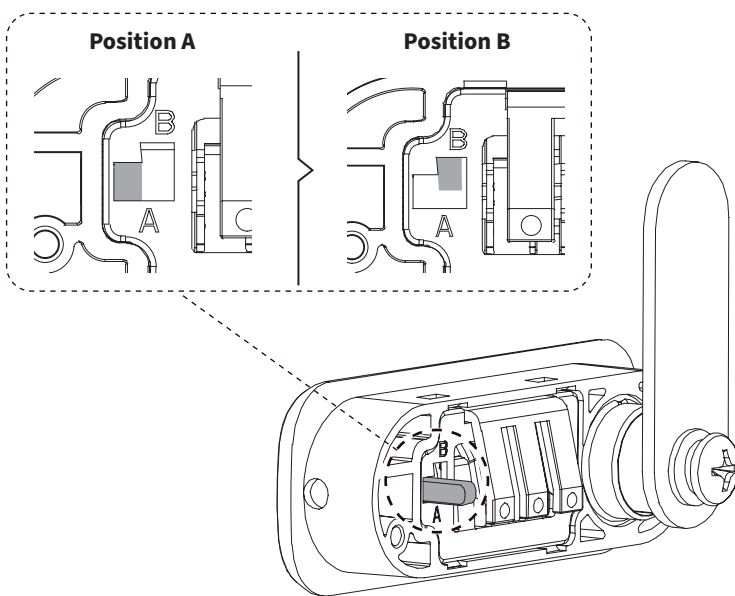

Enter your new desired password combination on the Padlock, then return the set button to “Position A”.

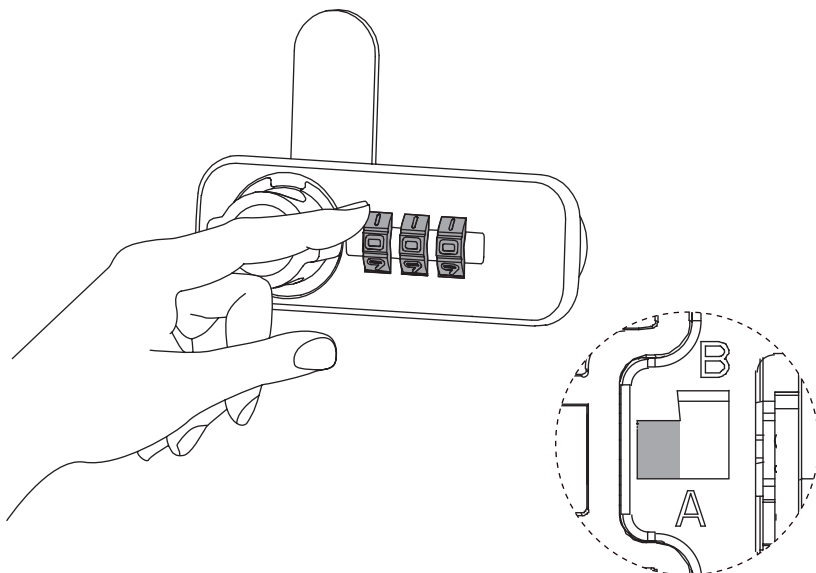

## STEP 3

- Option 1 -

### Wood Stud Mounting

For Concrete/Brick Mounting, go to **Page 9**

Using the Template (**T-A**) and a pencil, mark the desired mounting location aligned with wood studs. Use of a stud finder and a level is recommended.

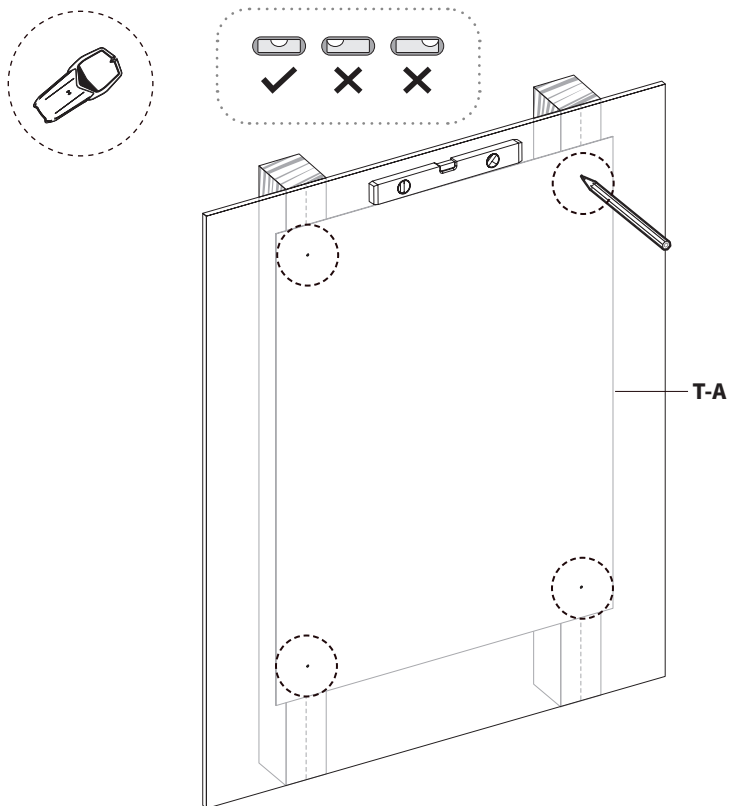

Drill mounting holes at marked locations using the infographic below.

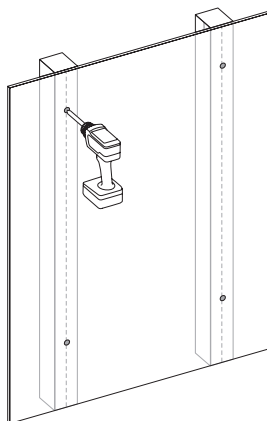
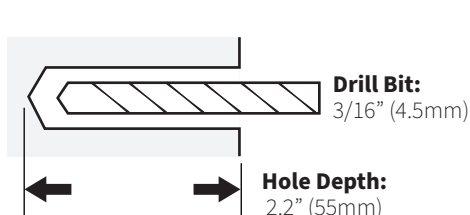

### Step 3, Wood Stud Mounting - Cont'd

Thread the ST6.3x55mm Screws (**W-A**) into the two top drilled holes using a socket wrench, leaving 3mm of exposed threading.

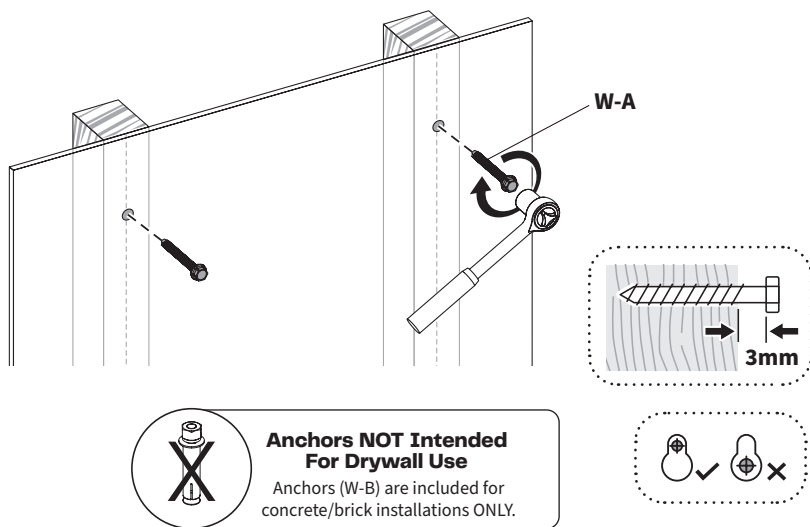

Hang the Charger Box (**A**) onto the two top exposed screw heads.

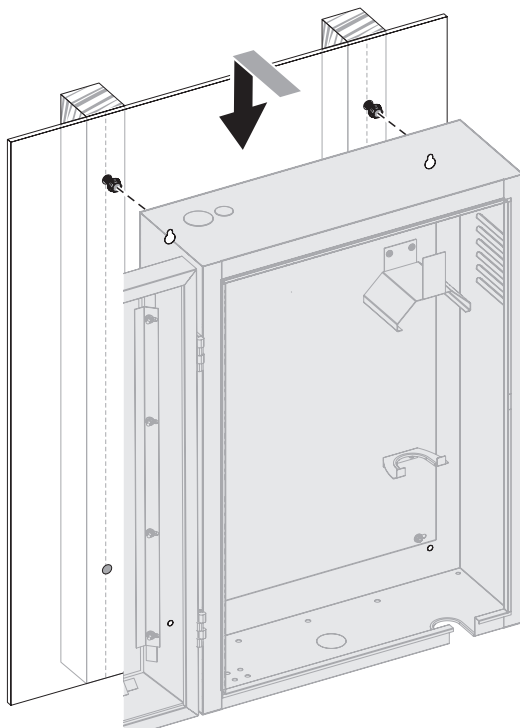

### Step 3, Wood Stud Mounting - Cont'd

Thread remaining ST6.3x55mm Screws (**W-A**) into the bottom holes and tighten all Screws with a socket wrench.

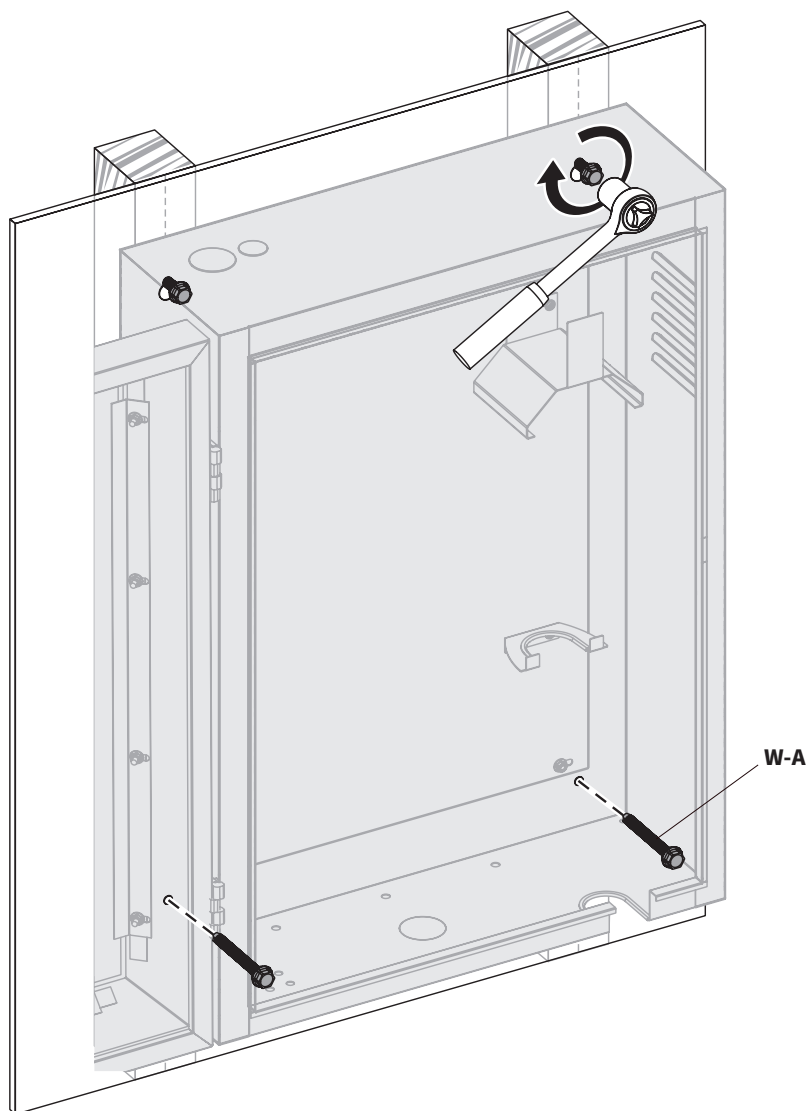

Proceed to STEP 4  
on **Page 11**



## STEP 3

### - Option 2 - Concrete/Brick Mounting

Using the Template (**T-A**) and a pencil, mark the desired mounting location. Use of a level is recommended.

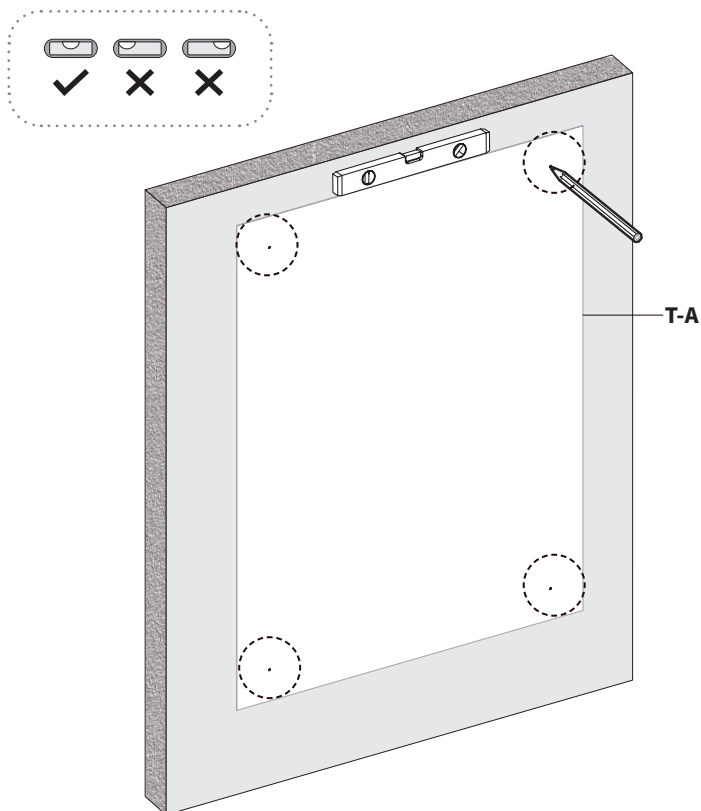

Drill mounting holes at marked locations using the infographic below.

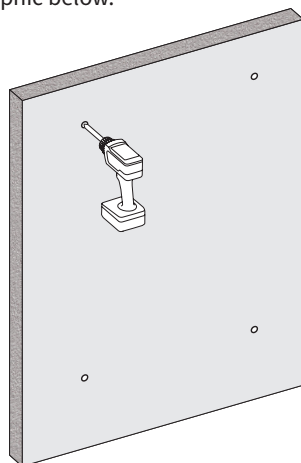
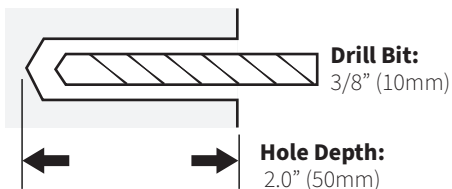

**Step 3, Concrete/Brick Mounting - Cont'd**

Remove the pre-installed nuts and washers from Concrete Anchors (**W-B**), then use a hammer to tap in the Concrete Anchors flush with the wall.

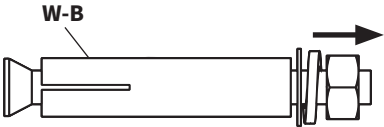

Place the Charger Box (**A**) onto the Concrete Anchors and reinstall the previously removed nuts and washers. Tighten nuts using a wrench to expand the anchor into the concrete.

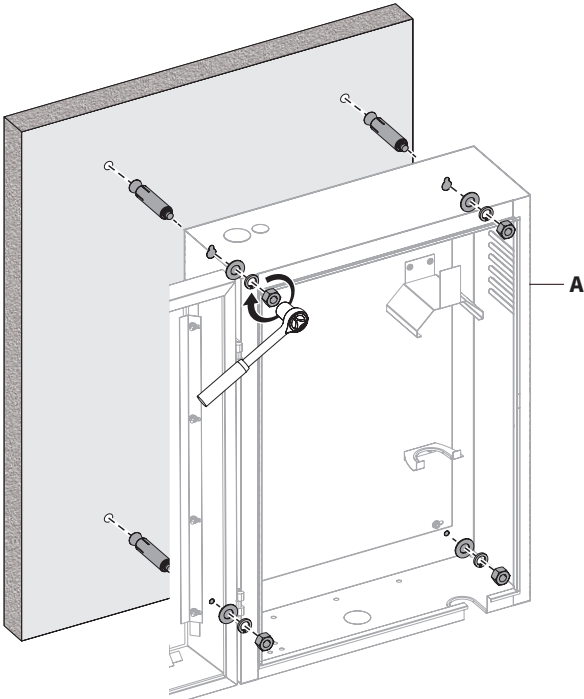
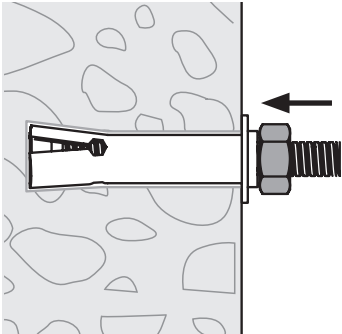

## STEP 4

Secure the Accessory Rail **(B)** to the Charger Box **(A)** at the position that best fits your charger, using the remaining ST4.2x15mm Screws **(S-A)**.

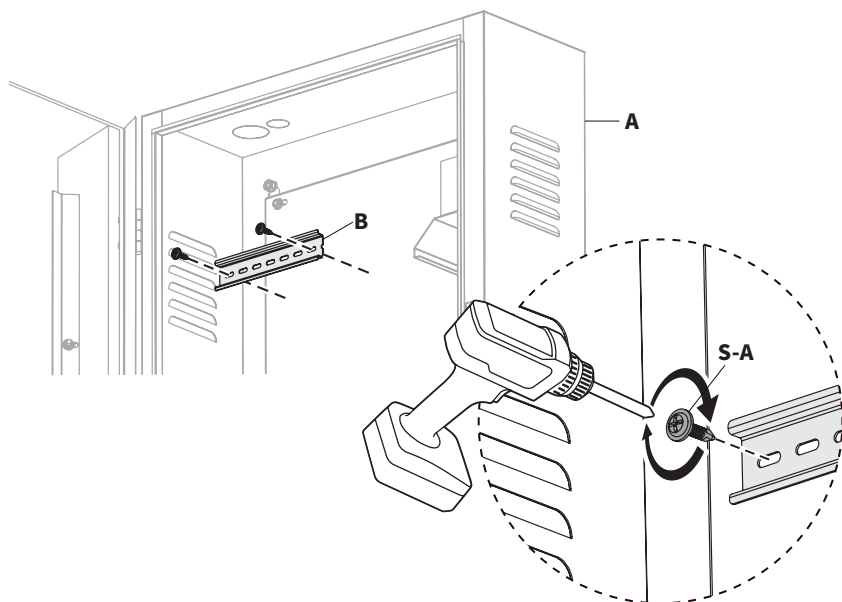

## STEP 5

Secure your charger to the Charger Box **(A)** using the ST4.2x15mm Screws **(S-A)**.



*Refer to your charger's manual for mounting instructions, as mounting patterns vary.*

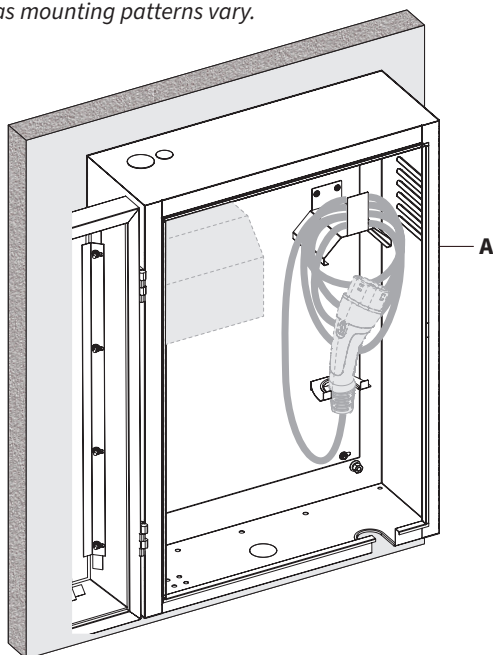



## Need Help? **We're Here For You**

Monday-Friday from 7am-7pm CST  
Saturday 8am-4pm CST



Email Us  
[help@vivo-us.com](mailto:help@vivo-us.com)



Chat with Live Agent  
[www.vivo-us.com](http://www.vivo-us.com)



Give Us a Call  
309-278-5303 ext. 1



VIVO-us



@vivo\_us



@VIVOus



VIVO