

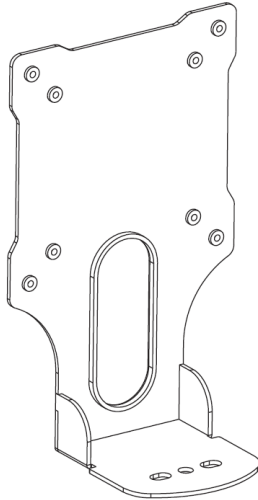

---

## VESA Adapter for Compatible Acer Monitors

### Instruction Manual



**SKU: MOUNT-AR02**



Scan the QR code with your mobile device or follow the link for helpful videos and specifications related to this product.

**<https://vivo-us.com/products/mount-ar02>**

---

**GET IN TOUCH** | Monday-Friday from 7:00am-7:00pm CST



[help@vivo-us.com](mailto:help@vivo-us.com)



[www.vivo-us.com](https://www.vivo-us.com)  
*Chat live with an agent!*



309-278-5303

## **WARNING!**

If you do not understand these directions, or if you have any doubts about the safety of the installation, please call a qualified technician. Check carefully to make sure there are no missing or defective parts. Improper installation may cause damage or serious injury. Do not use this product for any purpose that is not explicitly specified in this manual. Do not exceed weight capacity. We cannot be liable for damage or injury caused by improper mounting, incorrect assembly or inappropriate use.

## **WARNING: CHOKING HAZARD**

SMALL PARTS - NOT FOR CHILDREN UNDER 3 YEARS. ADULT SUPERVISION IS REQUIRED.

## PACKAGE CONTENTS



**A** (x1)  
Adapter Bracket



**B** (x4)  
M4x12



**C** (x4)  
M6 Washer



**D** (x2)  
M2x10



**E** (x2)  
M3x10



**F** (x2)  
M4x10



**G** (x1)  
M6x20



**H** (x2)  
M3 Washer



**I** (x2)  
M4 Washer



**J** (x2)  
M4x100



**K** (x2)  
Pad

## TOOLS NEEDED



## ASSEMBLY STEPS

### STEP 1

Remove the screw in the bottom of the base, and detach the base from the monitor.

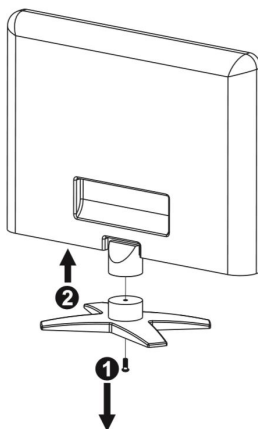

## STEP 2

Position the base clip on the adapter bracket **(A)** and insert the screw from step 1 or the M6x20 bolt **(G)** into the center hole in the bottom of bracket. Tighten securely. If needed, use the included washers **(C)** to enable a more secure fit. Depending on what size is required, install the self-tapping screws **(D, E or F)** with washers **(H or I)** into the side holes in the bottom of the bracket.

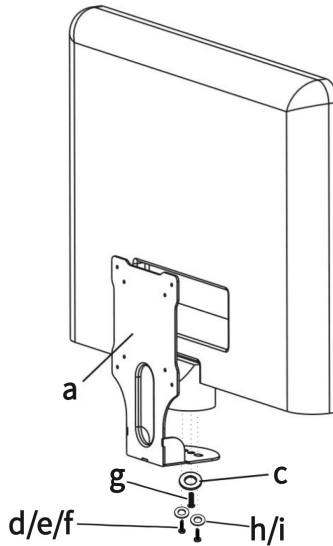

## STEP 3

Connect the VESA plate to the adapter bracket **(A)** using four M4x12 thumb bolts **(B)**. Partially insert M4x100 bolts **(J)** into top two unused holes of the VESA plate and adapter. Place pads **(K)** on the ends of the screws, and tighten until pads press lightly against the monitor.

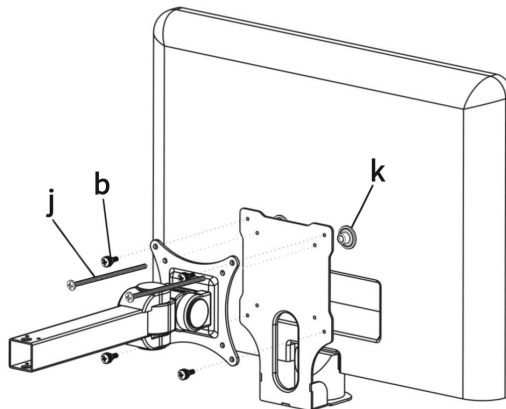



Love your new VIVO setup and want to share?  
Tag us in your photo! **@vivo\_us**

LAST UPDATED: 08/24/2020  
REV1



Open **Monday - Friday 7:00am - 7:00pm CST**,  
our dedicated support team can offer immediate assistance with rapid response times. If any  
parts are received damaged or defective, please contact us. We are happy to replace parts to  
ensure you have a fully functioning product.



[help@vivo-us.com](mailto:help@vivo-us.com)

**AVG. RESPONSE TIME** (*within office hrs*): **1HR 8M**

- 23% within < 15m
- 38% within < 30m
- 61% within < 1hr
- 83% within < 2hr
- 92% within < 3hr



[www.vivo-us.com](http://www.vivo-us.com)  
*Chat live with an agent!*

**AVG. RESOLUTION TIME** (*within office hrs*): **< 15 M**



309-278-5303

**AVG. RESOLUTION TIME** (*within office hrs*): **5M 4S**

FOR MORE VIVO PRODUCTS, CHECK OUT OUR WEBSITE AT: [www.vivo-us.com](http://www.vivo-us.com)